

T10S R4W

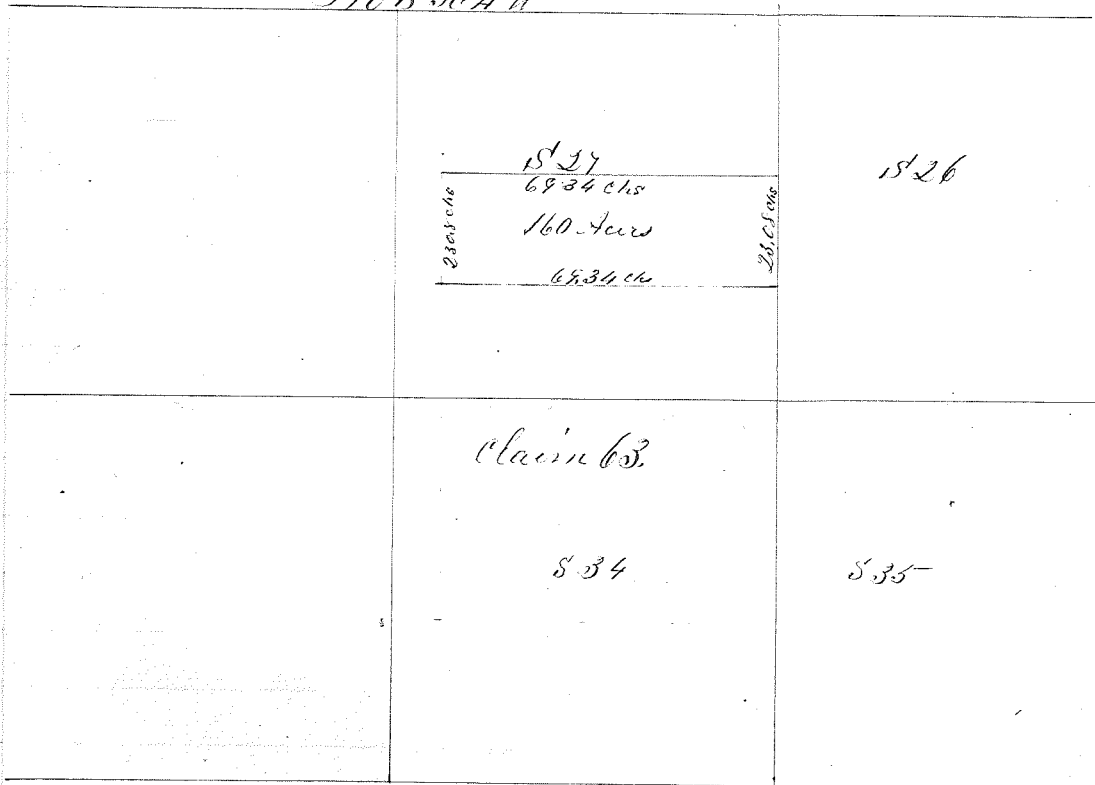

Wm H Johnson to Galliton Adkins  
 Survey No 13 #13

Beginning at the N.E. corner of Claim 63, T10S R4W 753 chs North of the 1/4 corner on the West boundary of Section 26, T10S R4W on the E boundary of Claim 63, T10S R4W

South

23.08 chs to a post A. W. Oak Tree 13 inches in dia bars N 46° 30' W 2.65 chs distant

West

69.34 chs to a post & mound on the W boundary line Claim 63

North

23.05 " to the N.W. corner of Claim 63, T10S R4W

East

69.34 " to place of beginning containing 160 Acres

Territory of Oregon  
 County of Benton

Sherey certifies that on the 20th day March AD 1856 I surveyed the above described tract of land assisted by J. Allen & Clay born Hughes as chainmen that the above diagram and notes are correct of said survey

J. A. Davis County Surveyor