

T. 10. S. R. 4. W.

T. 10. S. R. 3. W.

Sec 25

Sec 30

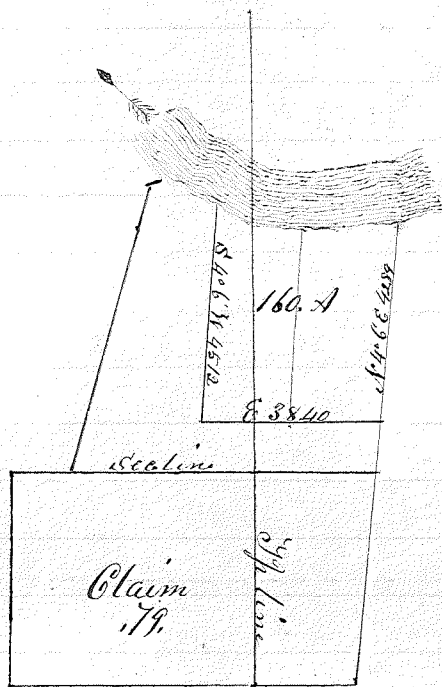

Survey No. 16 # 16

Galliton Adkins To Wm W Johnson

Beginning at a post on the left Bank of the Willamette River A white Fir Tree 18 inches dia. bears S 50° W. 31

Links distant,

S 4° 6' W 45.12 chs. To a post A white Oak Tree 2 Feet in dia. bears
 N 75° 45' W 3.25 chs. dist. do, 30 inches in dia. bears
 S 74° W. 236 chs. dist.

East 38.40 chs. To a post on the E. boundary line Claim 79,

N 4° 6' E. 4289 chs To the N.E. corner of Claim 79 T. 10. S. R. 3. W.

Measured on the left Bank of the Willamette River

S 77° W. 12.00 chs } down stream
 S 87° W. 6.50 chs }
 N 79° W. 16.50 chs }
 N 62° W. 4.50 chs To place of beginning containing 160 A

Territory of Oregon }
County of Benton }

I hereby certify that on the 2^d day of April A.D. 1856 I surveyed the above described tract of land. The above notes & diagram are a correct record of said Survey.

L A Davis County Surveyor