

104140400

CORNER FILE TRACKING

S:\Survey Corners\CORNERS\Templates\Filetrac2.doc
10/04/2010

CORNER NUMBER
104140400

STEP	HISTORY()	RESTORATION()
Form Prepared, DB	12/14/2011	12/29/2011
Field Inspection, DB	12/28/2011	12/29/2011
Finish index (count unit)	12/14/2011	12/28/2011
Counter Index	12/28/2011	12/28/2011
GIS Index Form	12/29/2011	12/29/2011
Checked, DB	1/03/2012	1/03/2012
Form Edited, DB	1/03/2012	1/03/2012
Form Signed, DB	1/03/2012	1/03/2012
Authorize Payment, DB	—	—
Archive Digital Files	1/03/2012	1/03/2012
Collect Documents	1/03/2012	1/03/2012
PDF File	1/03/2012	1/03/2012
Copy For Filming	1/03/2012	1/03/2012
Scanned (pdf to laserfiche)	1/03/2012	1/03/2012
Filmed (Archived), DB	3/06/12	3/06/2012
Filed, DB	3/06/12	3/06/12

(DB) = Entry needed in database (Access).

COMMENTS:

DATE 12/14/2011TOWNSHIP 10 SOUTH, RANGE 04 WEST, WILLAMETTE MERIDIAN; SECTION 18 CORNER SOUTH 1/4DONATION LAND CLAIM N/A CORNER N/A**COMMON CORNER(S):**

NORTH 1/4 CORNER OF SECTION 19

RECORDS (INFORMATION IN *BOLD ITALICS* IS COUNTY STAFFS' INTERPRETATION OF THE RECORD)

BASED ON EXTENSIVE RESEARCH AND RECOVERY OF EVIDENCE, THIS OFFICE HAS DETERMINED THAT MOST GENERAL LAND OFFICE SURVEYORS MEASURED TO THE FACE OF BEARING TREES.

- [01] GENERAL LAND OFFICE (GLO) NOTES BY JAMES E. FREEMAN, D.S., DATED JULY 10, 1852. *SET POST FROM WHICH A W. OAK 10" DIA BEARS S45-1/4°E, 102 LINKS (67.32 FEET); A W. OAK 20" DIA BEARS N5-1/2°W, 98 LINKS (64.68 FEET).*
- [02] GLO NOTES OF THE MONROE HODGES DONATION LAND CLAIM NO. 46 BY M. VANDERPOOL, D.S., DATED FEBRUARY 14, 1854. *CORNER NOT DESCRIBED.*
- [03] BENTON COUNTY MAP NO. 10-4-00010 BY W. C. GALLOWAY, C.S., DATED DECEMBER 18, 1922. *1" GALVANIZED PIPE; OAK 20", N84-1/2°W, 0.98 CHAINS (64.68 FEET); OAK 12", S22°W, 0.374 CHAINS (24.68 FEET).*
- [04] BENTON COUNTY SURVEY NO. 848 BY W. C. GALLOWAY, C.S., DATED DECEMBER 18, 1922. *1" GALVANIZED PIPE; OAK 20", N84-1/2°W, 0.98 CHAINS (64.68 FEET); OAK 12", S22°W, 0.374 CHAINS (24.68 FEET).*
- [05] BENTON COUNTY SURVEY NO. 848 (OLD NO. 188) FIELD NOTES (FIELD BOOK 33, PAGE 15) BY W. C. GALLOWAY, C.S., DATED JANUARY 30, 1923. *SET 1" GALV. PIPE, STAKE PRINT DIM. FOUND AN OAK STUMP BEARS S45-1/2°E, 1.02 CHAINS (67.32 FEET); AN OAK 20" DIA BEARS N84-1/2°W, 0.98 CHAINS (64.68 FEET) STANDING, REMARKED "BT" ON SAP; MARKED AN OAK 12" DIA BEARS S22°W, 0.374 CHAINS (24.68 FT.).*
- [06] BENTON COUNTY CORNER RESTORATION BOOK NO. 1, PAGE 165, BY W. C. GALLOWAY, C.S., DATED JANUARY 31, 1923. *SET 1" GALV. PIPE, STAKE PRINT DIM. FOUND AN OAK STUMP BEARS S45-1/2°E, 1.02 CHAINS (67.32 FEET), LOWER PART OF BLAZE FOUND; AN OAK 20" DIA BEARS N84-1/2°W, 0.98 CHAINS (64.68 FEET), REMARKED "BT" ON SAP; MARKED AN OAK 12" DIA BEARS S22°W, 0.374 CHAINS (24.68 FEET).*
- [07] SKETCH IN BENTON COUNTY FIELD NOTES (FIELD BOOK 41, PAGE 4), NO DATE OR DRAFTSMAN GIVEN. *1" PIPE. THIS IS A COPY OF RECORD [03].*
- [08] BENTON COUNTY SURVEY NO. 2146 LOOSE LEAF FIELD NOTES BY CURTIS C. HANSON, D.C.S., DATED OCTOBER 10, 1949. *FOUND 1" PIPE. TREES OK.*
- [09] BENTON COUNTY SURVEY NO. 2146 BY CURTIS C. HANSON, C.S., DATED OCTOBER 21, 1949. *1" PIPE.*
- [10] BENTON COUNTY CORNER RESTORATION NO. 46 BY RAYMOND C. MCWHINNEY, P.L.S., DATED NOVEMBER 20, 1979. *FOUND 1" PIPE. REMAINS OF STUMP CALLED BY GALLOWAY (ORIGINAL) BEARS N45°42'W (SIC), 68.4 FEET; OAK 16" DIA BEARS N22°01'W (SIC), 24.2 FEET WITH BLAZE; OAK 24" DIA BEARS N84°07'W, 66.0 FEET WITH CAT FACE.*
- [11] BENTON COUNTY SURVEY NO. 7016 BY RAYMOND C. MCWHINNEY, P.L.S., DATED JANUARY 4, 1980. *FOUND 1" PIPE. FOUND REMAINS OF ORIGINAL BT STUMP BEARS S45°42'E, 68.4 FEET; A WHITE OAK 24" DIA BEARS N84°07'W, 66.0 FEET; A WHITE OAK 16" DIA BEARS S22°01'W, 24.2 FEET.*

NOTES:

THIS IS A MICROSOFT WORD 2003 DOCUMENT NAMED "04140400" CREATED FROM A BOILER PLATE DOCUMENT NAMED "CORNER".

FIRM/AGENCY: BENTON COUNTY SURVEYOR'S OFFICE
ADDRESS: 360 S.W. AVERY AVE. CORVALLIS OR 97333; PH. 766-6821
RESEARCH BY: DAVID L. MALONE, P.L.S.
DATA ENTRY BY: SAME

BENTON COUNTY CORNER RESTORATION FORM, PAGE 1 OF 2, 104140400R2

SEE CORNER HISTORY FORM FOR RECORDS ETC.

CORNER RESTORATION FIELD BOOK NUMBER 29 PAGE(S) 30 DATE 12/29/2011
TOWNSHIP 10 SOUTH, RANGE 4 WEST, WILLAMETTE MERIDIAN; SECTION 18 CORNER SOUTH 1/4
DONATION LAND CLAIM N/A CORNER N/A
CONDITION REPORT ; REFERENCED OUT ; RENEWED XX; SURVEYED IN

LOCATION AND COMMENTS:

CORNER IS LOCATED ON A NORTH FACING SLOPE IN A STAND OF ± 70 YEAR OLD CONIFERS WEST OF HIGHWAY 99W AND SOUTH OF COFFIN BUTTE LANDFILL. TO REACH CORNER FROM THE INTERSECTION OF HIGHWAY 99W AND COFFIN BUTTE ROAD, DRIVE WESTERLY ON COFFIN BUTTE ROAD FOR 0.29 MILES TO A GRAVEL ACCESS ROAD ON THE LEFT. TURN LEFT AND FOLLOW GRAVEL ACCESS ROAD THROUGH 2 LOCKED GATES 0.31 MILES TO A WIDE LANDING AND PARK. WALK EASTERLY 600 FEET TO THE CORNER. CORNER IS BAD FOR PREMARKING AND GPS CONTROL. FOR GATE ACCESS CONTACT THE LANDFILL OFFICE AT 28972 COFFIN BUTTE ROAD.

MONUMENTS AND ACCESSORIES FOUND (CONDITION AND SOURCE):

1. FOUND 1" INSIDE DIAMETER IRON PIPE AT GROUND LEVEL AND UNDISTURBED FOR CORNER POSITION.
(SET POST PER RECORD [01]).
(FOUND DIM STAKE PRINT AND SET 1" GALV. PIPE PER RECORDS [05] AND [06]).
(1" GALV. PIPE PER RECORDS [03] AND [04]).
(1" PIPE PER RECORDS [07] THRU [11]).
2. FOUND 16" W. OAK WITH HEALED FACE, S22°00'W, 24.56 FEET TO CENTER. SET ALUMINUM NAIL AND PLASTIC WASHER IN NORTHWESTERLY BASE FOR DISTANCE MEASUREMENT. **BASIS OF BEARINGS FOR THIS RESTORATION.**
(MARKED 12" OAK, S22°W, 0.374 CHAINS [24.68 FEET] PER RECORDS [05] AND [06]).
(12" OAK, S22°W, 0.374 CHAINS [24.68 FEET] PER RECORDS [03] AND [04]).
(FOUND 16" OAK, N22°01'W (SIC), 24.2 FEET WITH BLAZE PER RECORD [10]).
(FOUND 16" WHITE OAK, S22°01'W, 24.2 FEET PER RECORD [11]).
3. FOUND 12' TALL 26" W. OAK HOLLOW STUMP WITH ROTTED OUT FACE, N84°32'W, 65.86 FEET TO CENTER. THIS TREE WAS HELD AS THE ORIGINAL GENERAL LAND OFFICE (GLO) NORTHWEST BEARING TREE BY W. C. GALLOWAY EVEN THOUGH THE BEARING IS DIFFERENT FROM THE GLO FIELD NOTES.
(MARKED A 20" W. OAK, N5-1/2°W, 98 LINKS [64.68 FEET] PER RECORD [01]).
(FOUND 20" OAK, N84-1/2°W, 0.98 CHAINS [64.68 FEET] PER RECORDS [03] AND [04]).
(FOUND 20" OAK, N84-1/2°W, 0.98 CHAINS [64.68 FEET] STANDING, REMARKED "BT" ON SAP PER RECORDS [05] AND [06]).
(FOUND 24" OAK, N84°07'W, 66.0 FEET WITH CAT FACE PER RECORD [10]).
(FOUND 24" WHITE OAK, N84°07'W, 66.0 FEET PER RECORD [11]).

MONUMENT SET (PROCEDURES AND DESCRIPTION):

W. C. GALLOWAY SET THE 1" IRON PIPE FROM A DIM STAKE PRINT AND THE STUMP OF THE SOUTHEAST GLO BEARING TREE, AS WELL AS THE NORTHWEST GLO BEARING TREE THAT HE RE-MARKED. THE GLO BEARING TO THIS TREE IS N5-1/2°W VERSUS GALLOWAY'S BEARING OF N84-1/2°W. APPARENTLY THE GLO HAD THE BEARING IN ERROR AS GALLOWAY HAD THE CORRECT SIZE TREE AT THE CORRECT DISTANCE WITH MARKINGS ON IT, AS WELL AS THE OTHER GLO BEARING TREE LOCATION AND THE ORIGINAL POST LOCATION. I FIND THE IRON PIPE IN GOOD AGREEMENT WITH THE REMAINING ACCESSORIES AND HELD IT FOR THE TRUE CORNER POSITION.

REFERENCED AND LOWERED THE 1" IRON PIPE AND OVER SAID IRON PIPE SET A 2" X 31-1/2" GALVANIZED IRON PIPE WITH A 3-1/4" BRASS DISK CONCRETED IN THE TOP, FLUSH WITH GROUND LEVEL AND MARKED AS SHOWN ON PAGE 2 OF 2. SET A 6 FOOT ORANGE CARSONITE "SURVEY MARKER" POST 1.0 FEET EAST OF NEW MONUMENT.

±70 YEAR OLD CONIFERS

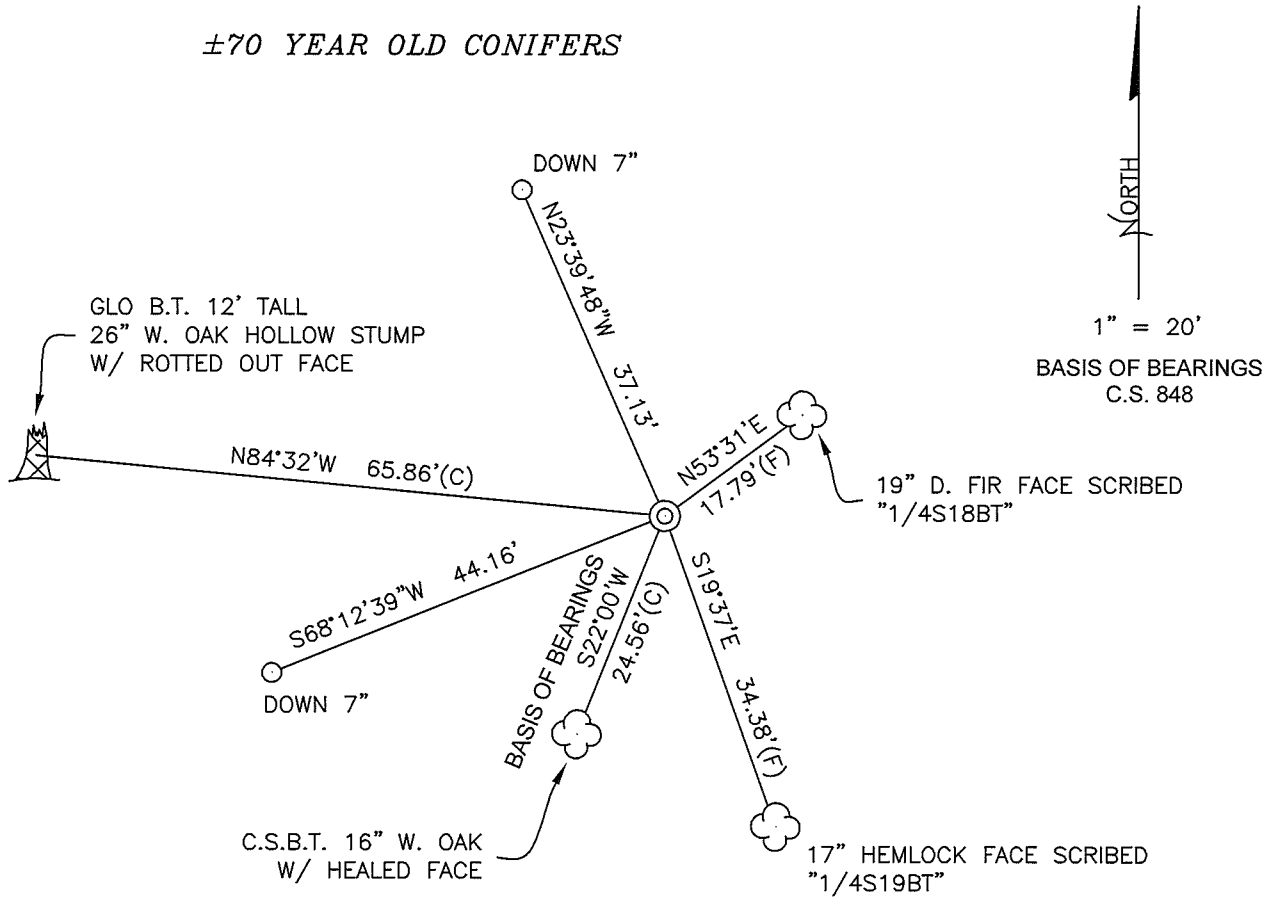

±70 YEAR OLD CONIFERS

LEGEND

MONUMENT DETAIL

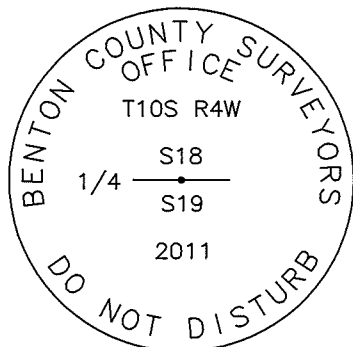

3-1/4" BRASS DISK

- SET 5/8" X 30" REBAR WITH YELLOW PLASTIC CAP MARKED "BENTON COUNTY SURVEYOR"
- (F) MEASUREMENT TO FACE
- (C) MEASUREMENT TO CENTER
- ⊙ GOVERNMENT MONUMENT SET AS SHOWN
- C.S. COUNTY SURVEY
- C.S.B.T. COUNTY SURVEYOR'S BEARING TREE
- GLO GENERAL LAND OFFICE
- B.T. BEARING TREE
- ☁ BEARING TREE AS NOTED
- 🏠 BEARING TREE STUMP AS NOTED

NEW ACCESSORIES:

1. SET REBAR (SEE LEGEND) S68°12'39"W, 44.16 FEET AND 7 INCHES BELOW GROUND LEVEL.
2. SET REBAR (SEE LEGEND) N23°39'48"W, 37.13 FEET AND 7 INCHES BELOW GROUND LEVEL.
3. 17" HEMLOCK FACE SCRIBED "1/4S19BT", S19°37'E, 34.38 FEET TO FACE. SET ALUMINUM NAIL AND PLASTIC WASHER BELOW SCRIBING FOR DISTANCE AND ANGLE MEASUREMENT.
4. 19" D. FIR FACE SCRIBED "1/4S18BT", N53°31'E, 17.79 FEET TO FACE. SET ALUMINUM NAIL AND PLASTIC WASHER BELOW SCRIBING FOR DISTANCE AND ANGLE MEASUREMENT.

NOTES:

COMPASS DECLINATION IS 20° EAST. ALL MEASURED DISTANCES AND BEARINGS ARE TO THE CENTER OF THE OBJECT, UNLESS OTHERWISE NOTED. ALL BEARING TREES ARE PAINTED AND HAVE A B.T. TAG ATTACHED, FACING THE CORNER UNLESS OTHERWISE NOTED. ALL NEW BEARING TREES HAVE A PLASTIC WASHER (STAMPED "SURVEYOR MARKER DO NOT REMOVE") ATTACHED BY AN ALUMINUM NAIL TO THE FACE, BELOW THE "BT" FOR DISTANCE AND ANGLE MEASUREMENT UNLESS OTHERWISE NOTED. THE DRAWING IS FROM AUTOCAD RELEASE 2010.

THIS RESTORATION WAS PERFORMED AT THE DIRECTION AND APPROVAL OF THE BENTON COUNTY SURVEYOR *[Signature]*

REGISTERED
PROFESSIONAL
LAND SURVEYOR

1-03-2012 *David L. Malone*

FIRM/AGENCY: BENTON COUNTY SURVEYOR'S OFFICE
 ADDRESS: 360 S.W. AVERY AVE. CORVALLIS, OR. 97333; PH. 766-6821
 PRESENT: DAVID L. MALONE, P.L.S. AND BERNIE ALTENBACH, SURVEY TECH.
 EQUIPMENT: NIKON NIV03.C AND SURVEY PRO ONBOARD.

OREGON
 JANUARY 12, 1999
 DAVID L. MALONE
 51523

RENEWAL DATE: 12/31/12

C.S. #134

Continued

by W.C. Galloway

Witnesses

Jos. C. Smith and

E.E. DeArmond

Corner to Tps. $\frac{T. 9-5}{T. 10-5}$ $\frac{T. 9-4}{T. 10-4}$

Set heart oak stake 12" under the surface about 15' N. of Postage fence.
Remarked trees Ash 12" in dia. bears S. 60° E. 1.33 chs. std.
" 13" " " " S. 20° W. .72 " "

Corner To secs. 35, 36 Tp. 9 S. R. 5 W. and 1+2 T. 10 S. R. 5 W.

Set $\frac{5}{8}$ " x 2" x 14" iron 12" under the surface
Set $\frac{1}{2}$ " galv. pipe on Tp. line S. 89° 52' E. 3.32 chs., fence 3.33.
S. edge of chimney of C.A. Voss' house N. 49° 04' E.
N.W. corner of J. V. Johnson's house S. 7° 13' W. about 40 chs.
N. edge of chimney of E.E. DeArmond's house S. 72° W.
N. " " School house N. 57° 03' W.

$\frac{1}{4}$ sec. corner between secs. 1 and 2 T. 10 S. R. 5 W.

Set a brick flat under a stone 8" x 10" x 12", stone 12" under the surface
Set from correct distance south of Tp. line and a proportional distance
from $\frac{1}{4}$ sec. cor. 80.234 chs. West and $\frac{1}{4}$ sec. cor. 40.248 chs. East
and 40.13 chs. south. (Stone that was found by Polk. C.S. was on top of ground.)

Cherry tree 8" in dia. bears S. 6° 25' E. 19.34 chs.
Apple " 14" " " " S. 84° 46' W. 7.44 "
Oak " 40" " " " N. 31° 25' W. 50.10 "
Comb of barn N. 1° 45' W. about 60 chs.
S.W. edge of chimney N. 54° 44' W. about 7.00 chs.

Corner to sections 17, 18, 19 & 20 T. 10 S. R. 4 W.

Set Qt. bottle 14" under surface. (Maybe under part of Mat in Post for
~~Oak 20" in dia. now 48" bears N. 29° E. 4.21 chs. std. (C)~~
~~Comb of house N. 24° 07' E.~~ (C. reset 10-19-19 C. Hanson)
~~S. " School house N. 40° 40' E. Out due to Corp. Adair.~~
S. edge of barn S. 74° 16' E. about 3 Miles distant ✓
~~N.E. cor. of fire place chimney on Doodle's house S. 39° 39' E.~~
N. edge of " " " S. 54° 52' W. ?

$\frac{1}{4}$ sec. cor. bet. secs. 18 & 19 T. 10-4

Set 1" galv. pipe stake print dim.
Oak stump S. 45 1/2° E. 10.2 chs. lower part of blaze found.
Remkd " 20" india. bears N. 84 1/2° W. 98 chs. (Bot. on sap.)
Marked " 12" " " S. 22° W. 3.74 "

$\frac{1}{4}$ sec. corner between secs. 8 & 17 T. 10-4

Set $\frac{3}{4}$ " galv. iron pipe in center of road on line from
the corner to sections 7, 8, 17 & 18 and the S.E. cor. of John Rodgers C. 66.
Set a $\frac{3}{4}$ " pipe South at LHS to line 20 feet.
Witness C. L. Williamson Feb. 1, 1923.

Proportions of corners

T. 11-5 Road

E. side

5

Week

C.S. 188 cont.
by W.C. G.
Witnesses
E.C. Stelmacker
C.L. Williamson
Jan. 31, 1923

11-5

has blaze

3

5



BENTON COUNTY SURVEYORS OFFICE - CORNER RESTORATION

C.S. 7016
46

T 10 S, R 4 W, W. B. & M., BENTON COUNTY, OREGON

REPORTED BY Raymond C McWhinney

SECTION 18

TITLE Land Surveyor

DATE 20 November 1979

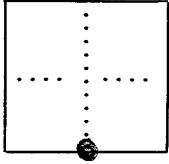

✓ ● OFFICIAL CORNER FOUND

○ CORNER SET

5/4 CORNER COMMON TO SEC. 18, 19, & _____
IS 1" Pipe

DESCRIBE

ADDITIONAL INFORMATION

on wooded Hillside North
slope

OVER

LEGIBLE MARKS ON BEARING OBJECTS

	cut face	Blaze	Remains of Stump called "By Gallows" (original)
KIND	OAK	OAK	
SIZE	24"	16"	
BEARING	N84-07W	N22-01W	N45-42W
DISTANCE	66 ± ft	24 ± ft	68 ± ft
BT TAG POSTED	yes	yes	NO

