

TOWNSHIP 10 SOUTH, RANGE 4 WEST, WILLAMETTE MERIDIAN; SECTION 25 CORNER**DONATION LAND CLAIM GALLATIN ADKINS NO. 43****CORNER N-NW****COMMON CORNER(S):****UPDATES AND REVISIONS:****CORNER RECORDS (PREVIOUS RENEWALS, SURVEYS, ETC.)**

- [01] ORIGINAL GLO SURVEY BY HARVEY GORDON DATED AUGUST OF 1861.
- [02] COUNTY SURVEY NO. 58 BY BENTON COUNTY SURVEYOR'S OFFICE DATED OCTOBER 10, 1867 (BOOK OF SURVEYS NO. 1 PAGES 72 AND 73).
- [03] COUNTY SURVEY NO. 332 BY W.C. GALLOWAY DATED JULY 12, 1912 (FIELD BOOK 12 PAGE 56).
- [04] COUNTY SURVEY NO. 334 BY W.C. GALLOWAY DATED JULY 26, 1912 (FIELD BOOK 12 PAGE 62).
- [05] OLD CORNER RESTORATION BOOK NO. 1 PAGE 40 BY W.C. GALLOWAY DATED AUGUST 7, 1912.
- [06] CORNER RESTORATION NO. 78 BY W.C. GALLOWAY DATED AUGUST 7, 1912 (TRANSCRIBED FROM RECORD [05]).
- [07] COUNTY SURVEY NO. 702 BY W.C. GALLOWAY DATED APRIL 23, 1920 (FIELD BOOK 27 PAGES 66 AND 67).
- [08] COUNTY SURVEY NO. 702 MAP BY W.C. GALLOWAY DATED OCTOBER OF 1920.
- [09] OLD CORNER RESTORATION BOOK NO. 1 PAGE 40 BY W.C. GALLOWAY (NO DATE GIVEN) (SEPARATE ENTRY FROM RECORD [05]).
- [10] MAP NO. 10-4-00016 BY W.C. GALLOWAY DATED APRIL 28, 1920.
- [11] COUNTY SURVEY NO. 4364 BY CURTIS C. HANSON DATED MARCH OF 1967.
- [12] COUNTY SURVEY NO. 4487 BY AUGUST C. GIERING DATED DECEMBER 29, 1967.
- [13] COUNTY SURVEY NO. 5587 BY VERLE MOORE DATED NOVEMBER 7, 1973.

COMMENTS/LOCATION/ETC:**NOTES:**

THIS IS A MICROSOFT WORD (VERSION 5.0) DOCUMENT NAMED "04843060" CREATED FROM A BOILER PLATE DOCUMENT NAMED "HISTORY", WHICH HAS A STYLESHEET NAMED "CORNER" ATTACHED TO IT.

FIRM/AGENCY: BENTON COUNTY SURVEYOR'S OFFICE**ADDRESS:** 360 S.W. AVERY AVE. CORVALLIS OR 97333; PH. 757-6821**RESEARCH BY:** CURTIS J. LIESENFELT/MARK E. ANDERSON**DATA ENTRY BY:** COLETTE MONACO

**BENTON COUNTY CORNER RESTORATION FORM, PAGE 1 OF 1, 104843060R2
SEE CORNER HISTORY FORM FOR RECORDS ETC.**

CORNER RESTORATION FIELD BOOK NUMBER 15 PAGE(S) 8

DATE 1/20/1994

TOWNSHIP 10 SOUTH, RANGE 4 WEST, WILLAMETTE MERIDIAN; SECTION 25 CORNER

DONATION LAND CLAIM GALLATIN ADKINS NO. 43

CORNER N-NW

CONDITION REPORT _____;

REFERENCED OUT _____;

RENEWED XX _____;

SURVEYED IN _____

LOCATION AND COMMENTS:

THE CORNER IS LOCATED IN A PASTURE, 141 FEET SOUTHWESTERLY AT RIGHT ANGLES TO THE PHYSICAL CENTERLINE OF SPRINGHILL DRIVE (COUNTY ROAD NO. 13470), 2 FEET NORTHWESTERLY AT RIGHT ANGLES TO A WOVEN, BARBED WIRE, AND ELECTRIC FENCE ALONG THE NORTHWESTERLY SIDE OF AN ASPHALT DRIVE TO ADDRESS NO. 3440 SPRINGHILL DRIVE. IT IS UNSUITABLE FOR PREMARKING AND G.P.S. CONTROL.

MONUMENTS AND ACCESSORIES FOUND (CONDITION AND SOURCE):

- FOUND: TAPERED IRON SHAFT, 1" AT TOP TO 1 1/4" AT BASE, 12" LONG FOR THE CORNER, 8" BELOW GROUND SURFACE. THERE IS NO RECORD OF THIS BEING SET OR RECOVERED. SAID SHAFT WAS DRIVEN IN THE CENTER OF A 5" THICK X 16" DIAMETER IRON FLYWHEEL ASSEMBLY, 13" BELOW GROUND SURFACE. FOUND PIECES OF AN APPROXIMATELY 8" X 8" X 6" GRANITE STONE DIRECTLY UNDERNEATH SAID FLYWHEEL (8" X 8" X 10" STONE AS PER RECORD [03]).
 - FOUND: A SLAB OF CONCRETE, 18" X 20" X 22", 3" THICK LYING FLAT WITH AN ARROW MARKED NEAR THE NORTHEASTERLY CORNER, BEARS S 52° W 0.45 FEET (STONE MARKED BY ARROW AS PER [11]).
 - FOUND: 3/8" INSIDE DIAMETER IRON PIPE WITH A NAIL IN THE TOP CENTER, 3" BELOW GROUND SURFACE, BEARS S 14° 19' W* 132.04 FEET, BASIS OF BEARINGS (1/2" PIPE S 14° 19' W 132.00 FEET AS PER RECORD [07]). SAID PIPE IS 7 FEET WEST-NORTHWESTERLY AT RIGHT ANGLES TO A WOVEN, BARBED WIRE, AND ELECTRIC FENCE.
 - FOUND: THE MOSTLY ROTTED REMAINS OF A 24" FIR STUMP WITH THE SCRIBING "83", BEARS S 15° 23' W* 34.2 FEET (15", S-16° W-34.19 FEET AS PER RECORD [07]).
 - FOUND: 39" DOUGLAS FIR WITH A HEALED HACK MARK, BEARS S 16° 54' W* 20.99 FEET (15", S 16° W 20.99 FEET AS PER RECORD [07]). SET 5 1/2" SPIKE AND BRASS WASHER IN THE TOP OF AN EXPOSED ROOT NEAR THE BASE OF THE TREE ON THE WESTERLY SIDE.
 - FOUND: 5/8" REBAR (AS PER RECORD [13]), BEARS S 68° 13' W* 19.51 FEET. SAID REBAR IS 13 FEET NORTHWESTERLY AT RIGHT ANGLES TO A WOVEN, BARBED WIRE, AND ELECTRIC FENCE.
 - FOUND: 5/8" REBAR, 12" BELOW GROUND SURFACE (AS PER RECORD [13]), BEARS S 36° 59' E* 32.84 FEET. SAID REBAR IS 2.2 FEET SOUTHEASTERLY AT RIGHT ANGLES TO A WOVEN, BARBED WIRE, AND ELECTRIC FENCE.
- NO OTHER RECORD EVIDENCE WAS RECOVERED.

MONUMENT SET (PROCEDURES AND DESCRIPTION):

SET: 2" INSIDE DIAMETER X 36" LONG IRON PIPE WITH A 3 1/4" BENTON COUNTY BRASS CAP, 6" BELOW GROUND SURFACE, STAMPED AS SHOWN, IN THE COORDINATE POSITION AS THE RECOVERED IRON SHAFT. PLACED THE GRANITE STONE PIECES AROUND THE NEW PIPE. BURIED THE CONCRETE SLAB UPSIDE DOWN ALONG THE SOUTHWESTERLY SIDE OF THE NEW MONUMENT. PLACED THE FLYWHEEL OVER THE NEW PIPE AND 6" BELOW GROUND SURFACE. PLACED THE TAPERED IRON SHAFT INSIDE THE NEW PIPE.

NEW ACCESSORIES:

- SET: REBAR (SEE NOTES), 10" BELOW GROUND SURFACE, BEARS N 13° 28' E* 33.90 FEET.
- SET: A LOCATION TAG ON A FENCE POST, BEARS S 14° 22' E 2.9 FEET.

MONUMENT DETAIL

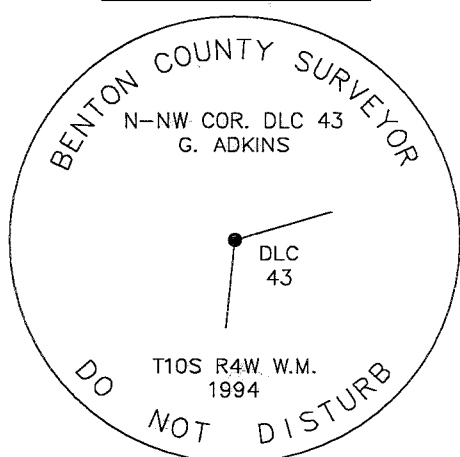

3 1/4" BRASS CAP

*=BEARINGS BASED ON RECORD [07].



NOT TO SCALE

SKETCH

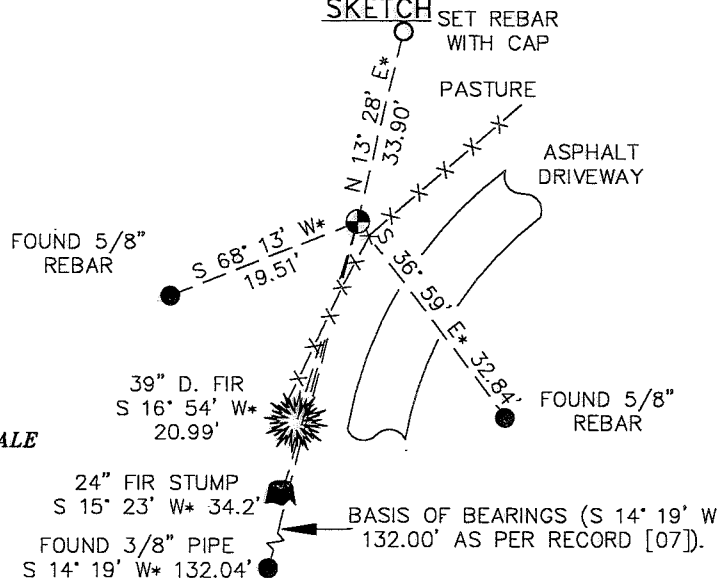

NOTES:

COMPASS DECLINATION IS 20° EAST. ALL MEASURED DISTANCES AND COMPASS BEARINGS ARE TO THE CENTER OF THE OBJECT, UNLESS OTHERWISE NOTED. ALL BEARING TREES ARE PAINTED AND HAVE A B.T. TAG ATTACHED, FACING THE CORNER UNLESS OTHERWISE NOTED. ALL BEARING TREES HAVE A BRASS WASHER (STAMPED "BENTON COUNTY SURVEYOR") ATTACHED TO A SIDE CENTER UNLESS OTHERWISE NOTED. ALL LIVE BEARING TREES HAVE A PLASTIC WASHER (STAMPED "BENTON COUNTY SURVEYOR CORNER RESTORATION") ATTACHED TO THE BACK OF THE TREE OPPOSITE THE CORNER UNLESS OTHERWISE NOTED. ALL SET REBAR ARE 5/8" X 30" AND HAVE A YELLOW PLASTIC CAP (STAMPED "BENTON COUNTY SURVEYOR") ATTACHED TO THE TOP. THIS DOCUMENT WAS NAMED AND CREATED IN A MANNER SIMILAR TO THE HISTORY FORM. THE NAME OF THE BOILER PLATE IS "MONUMENT". THE BORDER, STAMP AND SKETCH ARE FROM AUTOCAD RELEASE 12.

THIS RESTORATION WAS PERFORMED AT THE DIRECTION AND APPROVAL OF THE BENTON COUNTY/DEPUTY COUNTY SURVEYOR JB

FIRM/AGENCY: BENTON COUNTY SURVEYOR'S OFFICE
ADDRESS: 360 S.W. AVERY AVE. CORVALLIS OR 97333; PH. 757-6821
SURVEYOR: CURTIS J. LIESENFELT
SURVEY CREW: MARK E. ANDERSON

REGISTERED
PROFESSIONAL
LAND SURVEYOR

Curtis J. Liesenfelt
OREGON
JULY 17, 1986
CURTIS J. LIESENFELT
2213

LICENSE EXPIRES 12/31/1994

Northwest corner of Gallatin Adkins DLC 43, Twp. 10-4

Reestablishment by W. C. Galloway

August 7, 1912

Set stone 8" x 8" x 10"	Fir stump and Maple root found	
Oak 8" in diam bears N. 5° 10' E		1.576 chains
Fir 30" in diam bears N. 28° 30' E		.872 chains
Fir 15" in diam bears S. 16° W		.518 chains
Fir 15" in diam bears S. 16° W		.318 (not marked)(chains)

843060

T105 R4 W SEC 25 N-MW COR. GALATIN ADAMS NO. 43
 ENG: TAPERED IRON SHAFT 1" c TOP TO 1 1/4" c BASE 12" LONG
 FOR THE COP, 8" OGS. THERE IS NO RECORD OF THIS BEING
 SET OR RECOVERED. SAND SHAFT WAS DRIVEN IN THE CR.
 OF A 5" THICK X 18" DIA. IRON FLYWHEEL ASSEMBLY 13" OGS.
 FND. PIECES OF AN APPROX. 8" X 6" X 6" GRANITE STONE
 DIRECTLY UNDERNEATH SAND FLYWHEEL (8" X 10" STONE AS PER
 REC. [02])
 " 18" X 20" X 22" SLAB OF CONC. 3" THICK @ AN ARROW MARKED
 NEAR THE NEW COP, BEARS S 52° W O. 45' (STONE MARKED BY
 ARROW AS PER C11).
 " 3/8" I.D. I.P. @ A NAIL IN THE TOP STR. 3" OGS, BEARS S 14° 19' W
 BASIS OF BEARINGS S 14° 19' W ~ 132.00' AS PER REC. [07]. SAND
 PIPE IS 7' L. - NW 1/4 @ PT. 23 TO A W. W. B. W. E. E. C. FREE.
 " THE MOSTLY BATTERED REMAINS OF AN I.P. STONE @ BEARS S 15° 23' W ~
 34.2 (15' S 18° 0' W ~ 34.19' AS PER REC. [07]).
 " 3 1/2" B.F.C. @ A HEADED HACK MARK, BEARS S 16° 55' W ~ 20.99'
 (15' S 16° 1' W ~ 20.99' AS PER REC. [07]) SET 5 1/2" SPLET BRASS
 WASHER IN THE TOP OF AN FOOT NEAR THE DATE OF THE TREE
 ON THE W. W. SIDE
 (C115807)
 " 5/8" REBAR @ BEARS S 60° 13' W ~ 11.51'. SAND RECORD IS 15'
 NW 1/4 @ PT. 23 TO A W. W. B. W. E. E. C. FREE.
 " 5/8" REBAR (C115507) BEARS S 36° 55' E ~ 32.04' SAND RECORD
 IS 2.2' @ PT. 23 TO A W. W. B. W. E. E. C. FREE.
 NO OTHER RECORD FOUND. W.D.S. RECOVERED
 SET: 2 1/2" I.D. X 30" LONG IRON PIPE @ A 3 1/4" B.F.C. CO. 18" c. STRIPED
 " OGS

15/8

12/20/94. C.L.M. M.F.A. W.L.O. / L.F.A. T110. O.I.F. 100 F0667. 303

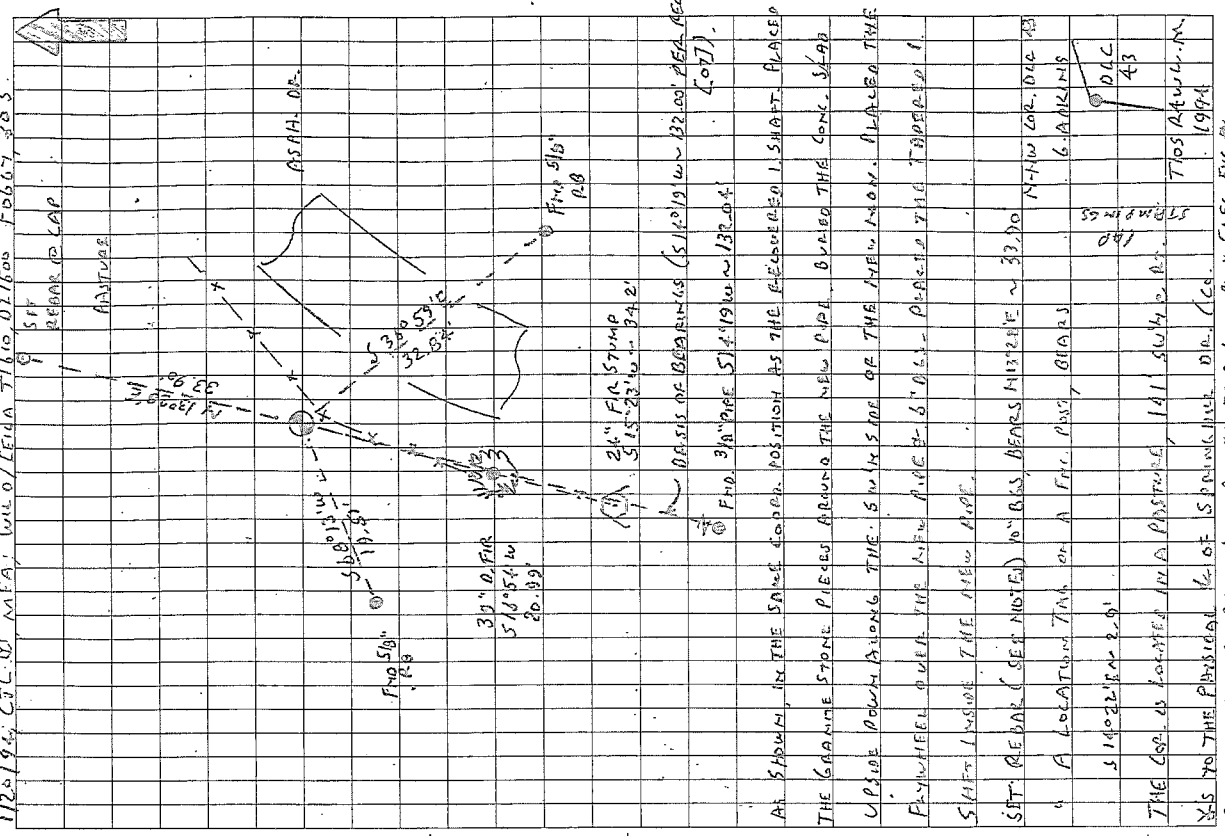

AS SHOWN, IN THE SAME CORNER POSITION AS THE RECORDED 1. SHAFT PLACED
 THE GRANITE STONE PIECES AROUND THE NEW PIPE. DURING THE CONC. POUR
 UPLOVE POWH ALONG THE S W. 1/4 SIDE OF THE NEW W. W. B. W. E. E. C. THE
 FLYWHEEL OVER THE NEW PIPE 6" OGS. BEARS THE TAPERED I.
 SHAFT INSIDE THE NEW PIPE.
 SET REBAR (SEE NOTE) @ BEARS BEARS N 11° 15' E ~ 32.00' N-NW COR. 1042 AS
 A LOCATION TAKEN ON A FTL. PLOT, BEARS
 S 14° 22' E ~ 2.9'
 THE COP IS LOCATED IN A PASSAGE, 141' S W. 1/4 @ PT. 23
 AS TO THE PHYSICAL COSE IS SPARKING THE DIR. (C115507)
 R.O. NO. 13470) 2' NW 1/4 @ PT. 23 TO A W. W. B. W. E. E. C. FREE. AS
 ALONG THE NW 1/4 SIDE OF AN ASPH. DR. TO 13470 SPRING HOLE OR 17 IS
 POOR FOR RECOVERING BUT CAN BE FOR THE CONTENTS