

CORNER FILE TRACKING

F:\Survey\Corners\Misc\Filetrac.doc

8/11/97

CORNER NUMBER

104845010

STEP	HISTORY(1)	RESTORATION()
Form Prepared, DB	11/4/97	—
Field Inspection, DB	—	—
Form Checked, DB	7/8/98	—
Form Edited, DB	7/7/98	—
Form Signed, DB	—	—
Authorize Payment, DB	—	—
Archive Digital Files	7/7/98	—
Collect Documents	7/8/98	7/8/98
Copy For Filming	—	—
Filmed	7/28/98	7/28/98
Scanned (Archived), DB	8/20/98	8/20/98
Indexed	9/30/98	—
Update Database	9/30/98	—
Filed, DB	9/30/98	—

(DB) = Entry needed in database (Access).

COMMENTS:

12/15/97 WAITING FOR RAY TO FILE THE GUSDEA PROJECT

7/8/98 MAKE CHANGE, PRINT FINAL & UPDATE DB

TOWNSHIP 10 SOUTH, RANGE 4 WEST, WILLAMETTE MERIDIAN; SECTION 22 CORNER

DONATION LAND CLAIM TOLBERT CARTER NO. 45CORNER E-NE

COMMON CORNER(S):
THE CENTER NORTHWEST CORNER OF DLC NO. 71.
THE SOUTHWEST CORNER OF DLC NO. 48.

UPDATES AND REVISIONS:

- CORNER RECORDS (PREVIOUS RENEWALS, SURVEYS, ETC.)**
- [01] ORIGINAL GLO SURVEY BY MADDEN VANDERPOOL DATED AUGUST 12, 1856.
 - [02] GLO SURVEY BY MADDEN VANDERPOOL DATED AUGUST 12, 1857.
 - [03] COUNTY SURVEY NO. 265 BY W.C. GALLOWAY DATED AUGUST 31, 1911.
 - [04] OLD CORNER RESTORATION BOOK NO. 1 PAGE 25 BY W.C. GALLOWAY DATED SEPTEMBER 1, 1911.
 - [05] CORNER RESTORATION NO. 92 BY W.C. GALLOWAY DATED SEPTEMBER 1, 1911.
 - [06] MAP NO. 10-4-00009 BY W.C. GALLOWAY (NO DATE GIVEN).
 - [07] COUNTY SURVEY NO. 357 BY BENTON COUNTY SURVEYOR'S OFFICE DATED JANUARY 21, 1913.
 - [08] MAP NO. 10-4-00013 BY BURT WILKES DATED NOVEMBER 12, 1917.
 - [09] MAP NO. 10-4-00008 BY W.C. GALLOWAY DATED MARCH 18, 1918.
 - [10] COUNTY SURVEY NO. 5555 BY VERLE MOORE DATED JUNE 14, 1973.
 - [11] CORNER RESTORATION NO. 4112 BY CURTIS J. LIESENFELT DATED SEPTEMBER 9, 1992.
 - [12] GPS SKYCHART BY BENTON COUNTY SURVEYOR'S OFFICE DATED MARCH 24, 1994.

COMMENTS/LOCATION/ETC:
THE SURVEYOR OF RECORD [01] MEASURED DISTANCES TO THE FACE OF BEARING TREES.
RECORD [05] IS A TRANSCRIBED FROM RECORD [04] AND MAY CONTAIN ERRORS AND OMISSIONS.

NOTES:
THIS IS A MICROSOFT WORD (VERSION 5.0) DOCUMENT NAMED "04845010" CREATED FROM A BOILER PLATE DOCUMENT NAMED "HISTORY", WHICH HAS A STYLESHEET NAMED "CORNER" ATTACHED TO IT.

FIRM/AGENCY: BENTON COUNTY SURVEYOR'S OFFICE
ADDRESS: 360 S.W. AVERY AVE. CORVALLIS OR 97333; PH. 757-6821
RESEARCH BY: CURTIS J. LIESENFELT/MARK E. ANDERSON

TOWNSHIP 10 SOUTH, RANGE 4 WEST, WILLAMETTE MERIDIAN; SECTION 22 CORNER

DONATION LAND CLAIM TOLBERT CARTER NO. 45CORNER E-NE

COMMON CORNER(S):
THE CENTER NORTHWEST CORNER OF DLC NO. 71.
THE SOUTHWEST CORNER OF DLC NO. 48.

- CORNER RECORDS (PREVIOUS RENEWALS, SURVEYS, ETC.)
- [01] ORIGINAL GLO SURVEY BY MADDEN VANDERPOOL DATED AUGUST 12, 1856. SET POST WITH 3 BEARING TREES MEASURED TO THE FACE.
 - [02] GLO SURVEY BY MADDEN VANDERPOOL DATED AUGUST 12, 1857. SET POST WITH 3 BEARING TREES MEASURED TO THE FACE. MAY BE A DIFFERENT POSITION.
 - [03] COUNTY SURVEY NO. 265 BY W. C. GALLOWAY DATED AUGUST 31, 1911. FOUND POST AND 2 BEARING TREES, SET STONE WITH 1 NEW BEARING TREE (FIELD BOOK NO. 10, PAGE 16).
 - [04] OLD CORNER RESTORATION BOOK NO. 1 PAGE 25 BY W. C. GALLOWAY DATED SEPTEMBER 1, 1911. SAME INFORMATION AS RECORD [03].
 - [05] CORNER RESTORATION NO. 92. THIS IS A TRANSCRIBED COPY OF RECORD [04] AND MAY CONTAIN ERRORS AND OMISSIONS.
 - [06] MAP NO. 10-4-00009 BY W. C. GALLOWAY (NO DATE GIVEN). STONE WITH 2 BEARING TREES.
 - [07] COUNTY SURVEY NO. 357 BY BENTON COUNTY SURVEYOR'S OFFICE DATED JANUARY 21, 1913. NO DESCRIPTION (FIELD BOOK NO. 14, PAGE 34).
 - [08] MAP NO. 10-4-00013 BY BURT WILKES DATED NOVEMBER 12, 1917. STONE
 - [09] MAP NO. 10-4-00008 BY W. C. GALLOWAY DATED MARCH 18, 1918. STONE
 - [10] COUNTY SURVEY NO. 5555 BY VERLE MOORE DATED JUNE 14, 1973. FOUND STONE, SET ROD ALONGSIDE.
 - [11] CORNER RESTORATION NO. 4112 BY CURTIS J. LIESENFELT DATED SEPTEMBER 9, 1992. FOUND STONE AND ACCESSORIES, SET BRASS CAP.
 - [12] GPS SKYCHART BY BENTON COUNTY SURVEYOR'S OFFICE DATED MARCH 24, 1994. FOUND BRASS CAP.
 - [13] BY RAY WILSON, DATED. FOUND BRASS DISK, ESTABLISHED STATE PLANE COORDINATES.

COMMENTS/LOCATION/ETC:

NOTES:
THIS IS A MICROSOFT WORD (VERSION 6.0) DOCUMENT NAMED "04845010" CREATED FROM A BOILER PLATE DOCUMENT NAMED "HISTORY", WHICH HAS A STYLESHEET NAMED "CORNER" ATTACHED TO IT.
INFORMATION IN **ITALICS** IS COUNTY STAFFS' INTERPRETATION OF THE RECORD.

FIRM/AGENCY: BENTON COUNTY SURVEYOR'S OFFICE
ADDRESS: 360 S.W. AVERY AVE. CORVALLIS OR 97333; PH. 757-6821
RESEARCH BY: CURTIS J. LIESENFELT
DATA ENTRY BY: CURTIS J. LIESENFELT

BENTON COUNTY CORNER RESTORATION FORM

4112

TOWNSHIP 10 SOUTH, RANGE 4 WEST, WILLAMETTE MERIDIAN; SECTION 22 CORNER
DONATION LAND CLAIM TOLBERT CARTER NO. 45 CORNER E-NE
DATE 9/09/92 CORNER RESTORATION FIELD BOOK NUMBER 13 PAGE(S) 25-26
CONDITION REPORT ONLY; REFERENCED OUT; XX RENEWED; SURVEYED IN

LOCATION AND COMMENTS:

THE CORNER IS LOCATED IN A TRASH AND BURN PILE, 2.5 FEET NORTHEASTERLY FROM THE NORTHEAST WOODEN CORNER POST TO A SOUTH AND WEST-SOUTHWESTERLY WOVEN WIRE FENCE AT THE NORTHEAST CORNER OF THE PALESTINE CEMETERY AND 45± FEET WESTERLY FROM THE GRAVEL DRIVEWAY TO THE RESIDENCE AT 5017 NW PALESTINE AVENUE (COUNTY ROAD NO. 04406).

PREVIOUS RENEWALS/SURVEYS, ETC:

- [01] ORIGINAL GLO SURVEY BY MADDEN VANDERPOOL DATED AUGUST 12, 1856.
- [02] GLO SURVEY BY MADDEN VANDERPOOL DATED AUGUST 12, 1857.
- [03] COUNTY SURVEY NO. 265 BY W.C. GALLOWAY DATED AUGUST 31, 1911.
- [04] OLD CORNER RESTORATION BOOK NO. 1 PAGE 25 BY W.C. GALLOWAY DATED SEPTEMBER 1, 1911.
- [05] CORNER RESTORATION NO. 92 BY W.C. GALLOWAY DATED SEPTEMBER 1, 1911.
- [06] MAP NO. 10-4-00009 BY W.C. GALLOWAY (NO DATE GIVEN).
- [07] COUNTY SURVEY NO. 357 BY BENTON COUNTY SURVEYOR'S OFFICE DATED JANUARY 21, 1913.
- [08] MAP NO. 10-4-00013 BY BURT WILKES DATED NOVEMBER 12, 1917.
- [09] MAP NO. 10-4-00008 BY W.C. GALLOWAY DATED MARCH 18, 1918.
- [10] COUNTY SURVEY NO. 5555 BY VERLE MOORE DATED JUNE 14, 1973.

MONUMENTS AND ACCESSORIES FOUND (CONDITION AND SOURCE):

- FOUND: 16" X 16" X 8" STONE WITH A PUNCH HOLE IN THE TOP CENTER FOR THE CORNER. THE STONE IS MARKED "CS" ON THE SOUTHWESTERLY SIDE AND IS 12" BELOW GROUND SURFACE (STONE 8" X 16" X 16" AS PER [3]).
- FOUND: 5/8" REBAR, 12" BELOW GROUND SURFACE, BEARS N 40° W 0.29 FOOT (5/8" IRON ROD NORTH EDGE OF STONE AS PER [10]). NOT SHOWN ON SKETCH.
- FOUND: 5/8" REBAR, BEARS S 3° 42' 20" E 195.56 FEET (5/8" ROD S 0° 32' W 195.36 FEET AS PER [10]). THE REBAR IS 1.1 FEET EASTERLY FROM A NORTH-SOUTH WOVEN WIRE FENCE.
- FOUND: 1" IRON ROD, 9" BELOW GROUND SURFACE, BEARS S 49° 53' W 2.21 FEET. THERE IS NO RECORD OF THIS BEING SET OR RECOVERED. THE RECORD PLAT OF NORTH PALESTINE CEMETERY CALLS FOR A BEGINNING CORNER AT THIS CLAIM CORNER, BUT IT DOES NOT DESCRIBE THE MONUMENT. THE 1" ROD IS ON THE NORTH SIDE OF A WOODEN CORNER POST TO A WEST-SOUTHWEST BY SOUTH WOVEN WIRE FENCE.

NO OTHER RECORD BEARING OBJECTS WERE RECOVERED.

MONUMENT SET (PROCEDURES AND DESCRIPTION):

- SET: 2" INSIDE DIAMETER X 32" LONG IRON PIPE WITH A MAGNETIC BREAK-OFF BASE AND A 3 1/4" BENTON COUNTY BRASS CAP, STAMPED AS SHOWN, 4" ABOVE GROUND SURFACE AND IN THE SAME COORDINATE POSITION AS SAID RECOVERED STONE. BURIED THE STONE HORIZONTALLY ALONG THE WESTERLY SIDE OF THE NEW MONUMENT. LEFT THE RECOVERED 5/8" REBAR IN PLACE AS FOUND.

NEW ACCESSORIES:

- A DOUGLAS FIR 29" IN DIAMETER, BEARS N 74° 31' E 34.82 FEET, FACED AND SCRIBED "DLC 71 BT". SET A PK NAIL AND B.C.B.W. IN THE NORTHERLY BASE. SET A B.T. TAG ON THE WESTERLY FACE.
- A DOUGLAS FIR 25" IN DIAMETER, BEARS S 4° 06' E 42.66 FEET, FACED AND SCRIBED "DLC 45 BT". SET A PK NAIL AND B.C.B.W. IN THE WESTERLY BASE. SET A B.T. TAG ON THE NORTHERLY FACE.
- SET: 5/8" X 30" REBAR WITH A YELLOW PLASTIC CAP MARKED "BENTON COUNTY SURVEYOR", BEARS S 77° 01' W 18.43 FEET. THE REBAR IS 2 FEET NORTHERLY FROM AN EAST-WEST WOVEN WIRE FENCE.
- SET: 5/8" X 30" REBAR WITH A YELLOW PLASTIC CAP MARKED "BENTON COUNTY SURVEYOR", BEARS N 13° 06' W 17.79 FEET.
- SET: ORANGE FIBERGLASS "SURVEY STAKE" POST 1 FOOT NORTHERLY.

MONUMENT DETAIL

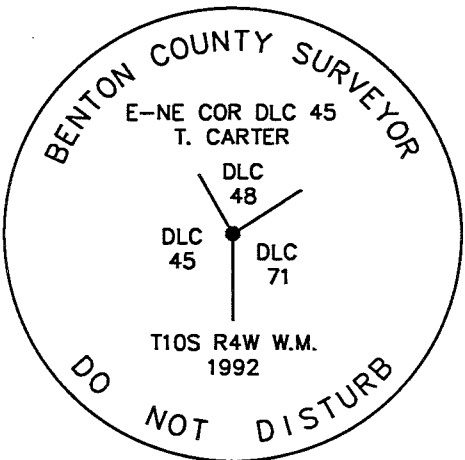

3 1/4" BRASS CAP

SKETCH

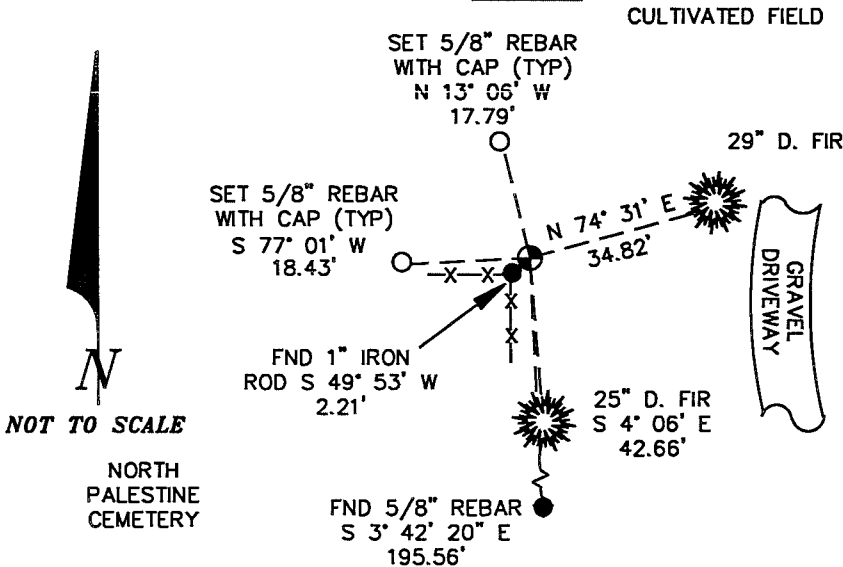

NOTES:

- B.C.B.W. IS A BRASS WASHER STAMPED "BENTON COUNTY SURVEYOR". COMPASS DECLINATION IS 20° EAST. ALL MEASURED DISTANCES AND COMPASS BEARINGS ARE TO THE CENTER OF THE OBJECT, UNLESS OTHERWISE NOTED.
- THIS RESTORATION WAS PERFORMED AT THE DIRECTION AND APPROVAL OF THE BENTON COUNTY SURVEYOR. *DB*

FIRM/AGENCY: BENTON COUNTY SURVEYOR
ADDRESS: 360 S.W. AVERY AVE. CORVALLIS OR 97333; PH. 757-6821
SURVEY CREW: CURTIS J. LIESENFELT/MARK E. ANDERSON

REGISTERED
PROFESSIONAL
LAND SURVEYOR

Curtis J. Liesenfelt

OREGON
JULY 17, 1986
CURTIS J. LIESENFELT
2213

- 14 sec. cor. between secs. 16 & 17. Tp. 14-6
 Set stake ~~to be~~ replaced by an ^{iron} ~~iron~~ ^{pipe} ~~1939~~ ^{W.C. Callahan F.H. Cox} other tree fallen.
 Fir 15" in dia. bears N. 59° 50' E. .601
 " 13" " " N. 80° 30' W. .73
 " 6" " " N. 30° E. 4.3 ft. .065 ^{std. Non-stump}
 Witnesses C.L. McCreedy & Chs. Johnson Aug. 29, 1911.
- C.S. #116 S.E. cor. of John Haskins' D.L.C. #71 Tp. 10-4.
 Set a qt. bottle rock near.
 Oak 12" in dia. bears N. 4° E. .18' std.
 " 20" " " N. 43° 20' E. .421
 " 11" " " S. 58° 10' W. .468
 Witnesses W.E. Rodgers, D.F. Kay & W.F. Holman Aug. 31, 1911.
- " N.E. corner of John Haskins' D.L.C. #71 Tp. 10-4.
 Set 1/2" bolt, orig. cor. stump std.
 Oak 6" in dia. bears S. 31° W. .680
 Fir 6" " " N. 68° 36' W. .441
 Witnesses W.E. Rodgers, D.F. Kay & W.F. Holman Aug. 31, 1911.
- " N.E. Ext. cor. of John Haskins' D.L.C. #71 Tp. 10-4 or Cor. along
 the south side of Hedges' D.L.C. #48
 Set a landslide to a flew. Orig. cor.
 Fir 10" in dia. bears S. 60° E. .188
 Oak 40" " " S. 60° E. .51' std. dead
 " 20" " " S. 54° W. 1.63' "
 Fir 11" " " N. 5° W. .089
 Witnesses W.E. Rodgers, W.F. Holman Sept. 1, 1911.
- " S.W. corner of Drury Hedges' D.L.C. #48 Tp. 10-4.
 Set a stone 18" x 16" x 16". Orig. cor. S.E. stump found.
 Oak 5" in dia. bears N. 29° E. .12' std. not mtd.
 " 11" " " N. 82° W. .064
 Witnesses W.E. Rodgers & D.F. Kay Sept. 1, 1911.
- " S.E. corner of Tabert Carter's D.L.C. #45 Tp. 10-4.
 Set a 1/2" galvanized pipe iron in top ^{changed to 3/4" x 40" shaft} Orig. cor. ^{std. stump} hole N. 16° E. .88
 Fir 14" in dia. bears North .390 ^{3/4" iron rod West 18'}
 Oak 13" " " S. 53° W. .255
 Witnesses W.E. Rodgers & D.F. Kay Sept. 1, 1911.
- " N.W. corner of John Haskins' D.L.C. #71 Tp. 10-4.
 Set two qt. bottles one under the other. ^{3/4" Pipe S. 20 ft.}
 Witness Chs. H. Leonard ^{3/4" Pipe W. 4.606 also 4.909 W. and 20 ft. S.} Sept. 2, 1911.
- C.S. 117 Sec. cor. to secs. 3, 4, 9 & 10 Tp. 13-5.
 Set a 1/4" pipe Orig. cor.
 no trees near.
 Witnesses T.G. Buchanan & Herald Whithy Sept. 21, 1911.

Southwest corner of Drury Hodges DLC 48, Twp. 10-4

Reestablishment by W. C. Galloway

September 1, 1911

Set a stone 8" x 16" x 16" original corner S. E. stump found
Oak 5" in diam bears N. 21° E. .12 chains (standing not marked)
Oak 11" in diam bears N. 82° W. .067 chains
Witnesses W. E. Rodgers, and D. F. Kay

TIOS RAW SEC. 22, E-NE COR. TOLBERT CARTER DCL 45
 FMD. 16" x 16" x 8" STONE @ A PUNCH HOLE IN THE TOP CIR.
 " C/S MARKED ON THE SWth SIDE Y. 12" BES FOR THE
 COR. (STONE 8" x 16" x 6" AS PER [37])
 " 5/8" REBAR 12" BLS, BEARS N 40° W ~ 0.29' (5/8")
 1. ROD N. FACE OF STONE AS PER [107]
 " 5/8" REBAR, BEARS S 30° E 20" E ~ 195.56' (5/8" ROD
 S 50° 33' W ~ 195.36' AS PER [107]) THE REBAR IS 1.1'
 Eth FROM A N-S WOOD WIRE FNC.
 " 1" 1. ROD 9" BLS, BEARS S 49° 53' W ~ 2.21 THERE IS
 NO RECORD OF THIS BEING SET OR RECOVERED THE
 RECORD PLAT OF NORTH PALESTINE CEMETERY CALLS FOR A BEG-
 INNING COR. AT THIS CLAIM COR BUT IT DOES NOT DESCRIBE
 THE MON. THE 1" ROD IS ON THE N. SIDE OF A WOODEN COR.
 POST TO A W-SW 84 S WOOD WIRE FNC.
 NO OTHER RECORD BEARING OBJECTS WERE RECOVERED.
 SET: 2" 1.0 x 32" LONG IRON PIPE @ A MAGNETIC BREAK-OFF
 BASE " A 3/4" BEN. CO. B.L. STAMPED AS SHOWN, 4"
 ALS " IN THE SAME COORD. POSITION AS SAID RECOVERED
 STONE BURIED THE STONE HORIZ. ALONG THE Wth SIDE OF
 THE NEW MON. LEFT THE RECOVERED 5/8" REBAR IN PLACE.
 A D. FIR 2 1/2" IN DIAM., BEARS N 74° 31' E ~ 34.02', FACED &
 SCRIBED "DCL 71 BT". SET A PL. Y. BLOW IN THE Nth BASE
 SET A BT TAG ON THE Wth FACE.

1.03 SE (COR) N 40° W 0.29'
 1.71 NE

13/25

9/9/92, JUL 9 MEAD, T 1100, D 1600 USHIKOTA STAFF 1° COMP. 20° E

DCL, SUNNY 70°

CULTIVATED FIELD

SET 5/8" REBAR
@ CAP (7-10)

29" D. BAR

GRAVEL
DRIVEWAY

N 74° 31' E
34.02'

S 49° 53' E

NORTH
PALESTINE
CEMETERY

S 30° E 20" E

195.56'

FIND 5/8" REBAR

A D. FIR 2 1/2" IN DIAM., BEARS S 49° E ~ 42.66', FACED & SCRIBED

" DCL 45 BT" SET A PL. Y. BLOW IN THE Wth BASE SET A BT

TAG ON THE Nth FACE.

SET 5/8" x 30" REBAR @ A Y.P.C. MKO "BENTON COUNTY SURVEYOR"

BEARS S 77° 01' W ~ 16.43' THE REBAR IS

2' Nth FROM AN E.W. WOOD WIRE FNC.

5/8" x 30" REBAR @ A Y.P.C. MKO, "BENTON

COUNTY SURVEYOR", BEARS N 13° 01' W ~

17.79'

TIOS RAW Wth

CONT. ON PG. 26

13/26

(CONT. FROM Pg. 25)

SET. GRANGE FIBERGLASS "JURY STAKE" POST 1' N 1/4

THE COR. IS LOCATED IN A TRASH & RUBBLE PILE, 25' N 1/4

WOODEN POST TO A S 1/4 - 40' W WOODEN FENCE &

THE NE COR. OF THE PALESTINE CEMETERY & 45' E 1/4

FROM THE GRAVEL DRIVEWAY TO THE RESIDENCE &

5017 PALESTINE AVE. IT IS GOOD FOR PERMANENT

& GPS CONTROL.