

105100440

BENTON COUNTY CORNER HISTORY FORM, PAGE 1 OF 1, 105100440H

DATE 04/01/2009

TOWNSHIP 10 SOUTH, RANGE 05 WEST, WILLAMETTE MERIDIAN; SECTION 18 CORNER WEST 1/4
DONATION LAND CLAIM N/A CORNER

COMMON CORNER(S):

THE EAST 1/4 CORNER OF SECTION 13 IN TOWNSHIP 10 SOUTH, RANGE 6 WEST.

RECORDS (INFORMATION IN BOLD ITALICS IS COUNTY STAFFS' INTERPRETATION OF THE RECORD)

- [01] ORIGINAL GLO SURVEY BY BUTLER IVES, D.S., APPROVED MAY 5, 1853. SET QR SEC POST FROM WHICH A MAPLE 6 IN DIA BEARS ***N54°E, 61 LKS (40.26 FEET)***; A FIR 38 IN DIA BEARS ***N32°W, 68 LKS (44.88 FEET)***.
- [02] COUNTY SURVEY NO. 861 NOTES (FIELD BOOK NO. 30, PAGE 23) BY WALTER W. LARSEN, D.C.S., DATED MAY 28, 1923. ***1 1/2" PIPE; FIR 60" N32°W, .680 CHS (44.88 FEET); FIR 5" S76°E, .185 CHS (12.21 FEET)***.
- [03] MAP NO. 10-6-00002 BY WALTER W. LARSEN, DATED MAY 28, 1923. SAME INFORMATION AS RECORD [02].
- [04] OLD CORNER RESTORATION BOOK NO. 1, PAGE 169, BY WALTER W. LARSEN, DATED JUNE, 1923. SET ***1 1/2" PIPE; FIR 60" N32°W, .680 CHS (44.88 FEET) STANDING; FIR 5" S76°E, .185 CHS (12.21 FEET)***.
- [05] CORNER RESTORATION NO. 213. THIS IS A TRANSCRIBED COPY OF RECORD [04] AND CONTAINS ERRORS AND/OR OMISSIONS.
- [06] COUNTY SURVEY NO. 1200 (OLD NO. 134) FIELD NOTES (FIELD BOOK NO. 38, PAGE 54) BY W. C. GALLOWAY, C.S., DATED MARCH 2, 1933. SET ***1 1/4" PIPE***.
- [07] MAP NO. 10-5-00006 BY W. C. GALLOWAY, DATED MARCH, 1933. ***1 1/4" PIPE; FIR 60" N32°W, .680 CHS (44.88 FEET) STANDING; FIR 5" S76°E, .185 CHS (12.21 FEET)***.
- [08] COUNTY SURVEY NO. 9514, BY TED LANGTON, P.L.S., DATED DECEMBER 31, 1999. FOUND ***1 1/4" LYING LOOSE. SET N" MON IN 2" HOLE FOUND VERY CLOSE TO THE RECORD BEARINGS AND DISTANCES FROM THE BT'S PER BCCR 213. MONUMENT LIES 1.5' EAST OF A NORTH-SOUTH FENCE ON A NORTHEAST SLOPE. 58" D. FIR STUMP N36°W (N32°W) 45.8 FT. (68 LKS) TO CENTER, FACE NOT OPENED; 12" D. FIR SNAG S74°E (76°E 12.3 FT. (18.5 LKS) TO CENTER, SCRIBING VISIBLE; 9" D. FIR S12°W 30.1 FT. SCRIBED "1/4S13" ABOVE "BT"; 10" D. FIR S21°E 23.7 FT. SCRIBED "1/4S18" ABOVE "BT" 7" D. FIR N21°E 17.2 FT. SCRIBED "1/4S18" ABOVE "BT"; 8" D. FIR N6°W 32.3 FT. SCRIBED "1/4S13" ABOVE "BT"***.

NOTES:

THIS IS A MICROSOFT WORD 97 DOCUMENT NAMED "05100440" CREATED FROM A BOILER PLATE DOCUMENT NAMED "HISTORY", WHICH HAS A STYLESHEET NAMED "CORNER" ATTACHED TO IT.

FIRM/AGENCY: BENTON COUNTY SURVEYOR'S OFFICE

ADDRESS: 360 S.W. AVERY AVE. CORVALLIS OR 97333; PH. 766-6821

RESEARCH BY: DAVID M. DEAN, P.L.S.

DATA ENTRY BY: SAME

**BENTON COUNTY CORNER RESTORATION FORM, PAGE 1 OF 2, 105100440R2
SEE CORNER HISTORY FORM FOR RECORDS ETC.**

CORNER RESTORATION FIELD BOOK NUMBER 27 PAGE(S) 73 DATE 04/07/2009
TOWNSHIP 10 SOUTH, RANGE 5 WEST, WILLAMETTE MERIDIAN; SECTION 18 CORNER WEST 1/4
DONATION LAND CLAIM NONE CORNER NONE
CONDITION REPORT ; REFERENCED OUT ; RENEWED XX; SURVEYED IN

LOCATION AND COMMENTS:

CORNER IS LOCATED ON A GENTLE NORTHEAST SLOPE AND 1.5 FEET EAST OF A MOSTLY DOWN WOVEN AND BARBED WIRE FENCE. TO REACH CORNER FROM THE JUNCTION OF WARD ROAD AND MAXFIELD CREEK ROAD, TRAVEL EASTERLY ON MAXFIELD CREEK ROAD FOR 1.41 MILES; THEN RIGHT ON PRIVATE ACCESS ROAD (PASSING THROUGH LOCKED GATE) FOR 0.06 MILES; THEN BEAR LEFT FOR 0.60 MILES; THEN BEAR RIGHT FOR 0.48 MILES; THEN BEAR RIGHT FOR 0.68 MILES; THEN BEAR RIGHT FOR 0.23 MILES; THEN BEAR RIGHT STAYING ON MAIN ROCKED ROAD FOR 0.21 MILES; THEN BEAR LEFT FOR 0.27 MILES AND PARK; THEN WALK APPROXIMATELY N37°W, ±600 FEET TO CORNER. CORNER IS POOR FOR PREMARKING AND GPS CONTROL.

MONUMENTS AND ACCESSORIES FOUND (CONDITION AND SOURCE):

1. FOUND 5/8" X 30" IRON ROD WITH A RED PLASTIC CAP MARKED "NORTHSTAR PLS 1823", 2" ABOVE GROUND LEVEL FOR CORNER POSITION. A 1 1/2" X 24" IRON PIPE WAS FOUND IN A HORIZONTAL POSITION ON THE EAST SIDE OF 5/8" IRON ROD AND 3" BELOW GROUND LEVEL.
(SET POST PER RECORD [01]).
(1 1/2" PIPE PER RECORDS [02] AND [03]).
(SET 1 1/2" PIPE PER RECORD [04]).
(SET 1 1/4" PIPE PER RECORD [06]).
(1 1/4" PIPE PER RECORD [07]).
(FOUND 1 1/4" PIPE LYING LOOSE, SET 5/8" X 30" IRON ROD WITH RED PLASTIC CAP MARKED "NORTHSTAR PLS 1823" IN 2" HOLE AGREEING VERY CLOSE TO THE RECORD BEARINGS AND DISTANCES FROM THE BT'S PER BCCR 213 PER RECORD [08]).
2. FOUND ±62" ROTTEN D. FIR STUMP WITH COVERED FACE, N32°00'W, 45.72 FEET TO CENTER. BASIS OF BEARINGS FOR THIS RESTORATION.
(A FIR 38" IN DIAM. BEARS N32°W, 44.88 FEET PER RECORD [01]).
(FIR 60", N32°W, 44.88 FEET PER RECORDS [02], [04] AND [07]).
(58" D. FIR STUMP N36°W, 45.8 FEET TO CENTER, FACE NOT OPENED PER RECORD [08]).
3. FOUND ±12" D. FIR STUMP WITH ROTTEN FACE BUT NO VISIBLE SCRIBING, S69°38'E, 12.25 FEET TO CENTER.
(FIR 5", S76°E, 12.21 FEET PER RECORDS [02], [04] AND [07]).
(12" D. FIR SNAG, S74°E, (18.5 LINKS) TO CENTER PER RECORD [08]).

MONUMENT SET (PROCEDURES AND DESCRIPTION):

"WE HELD THE 5/8" IRON ROD SET PER RECORD [08] AS A GOOD FAITH EFFORT TO PERPETUATE THE SUBJECT CORNER, WHICH IS CONSISTENT WITH THE RECOVERED GLO AND C.S. 861 ACCESSORIES. REMOVED THE 5/8" X 30" IRON ROD AND SET A 2" X 3/4" GALVANIZED IRON PIPE WITH A 3 1/4" ALUMINUM DISK CONCRETE IN THE TOP, 3" BELOW GROUND LEVEL AND MARKED AS SHOWN ON PAGE 2 OF 2. BURIED IRON ROD AND IRON PIPE ON THE EASTERLY SIDE OF NEW MONUMENT AND 10" BELOW GROUND LEVEL. SET A 6 FOOT ORANGE CARSONITE "SURVEY MARKER" POST 0.5 FEET NORTH OF NEW MONUMENT.

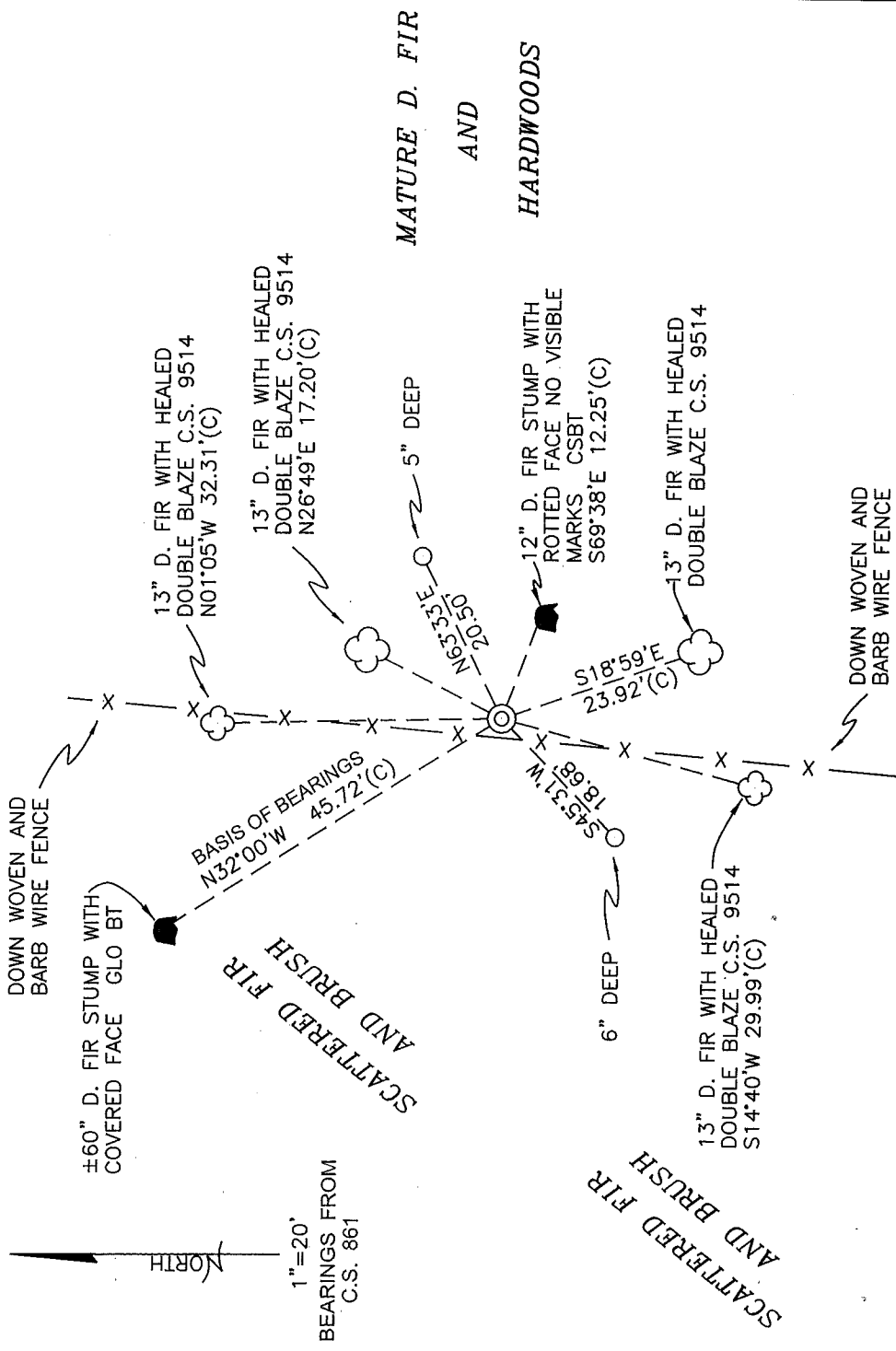

MONUMENT DETAIL

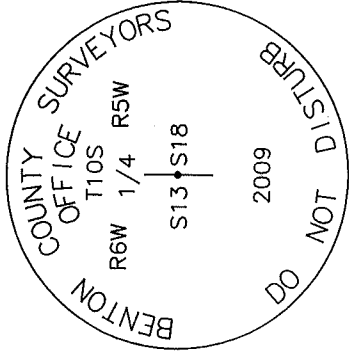

3 1/4" ALUMINUM DISK

LEGEND

- SET 5/8" X 30" REBAR WITH YELLOW PLASTIC CAP MKD "BENTON COUNTY SURVEYOR"
- (F) MEASUREMENT TO FACE
- (C) MEASUREMENT TO CENTER
- ◎ GOVERNMENT MONUMENT SET AS SHOWN
- ☁ BEARING TREE AS NOTED
- C.S.B.T. COUNTY SURVEYORS BEARING TREE
- GLO GENERAL LAND OFFICE
- C.S. COUNTY SURVEY
- BEARING TREE STUMP AS NOTED

NEW ACCESSORIES:

1. SET REBAR (SEE LEGEND) 5" BELOW GROUND LEVEL N63°33'E, 20.50 FEET.
2. SET REBAR (SEE LEGEND) 6" BELOW GROUND LEVEL S45°31'W, 18.68 FEET.

NOTES:

COMPASS DECLINATION IS 20° EAST. ALL MEASURED DISTANCES AND BEARINGS ARE TO THE CENTER OF THE OBJECT, UNLESS OTHERWISE NOTED. ALL BEARING TREES ARE PAINTED AND HAVE A B.T. TAG ATTACHED, FACING THE CORNER UNLESS OTHERWISE NOTED. ALL NEW BEARING TREES HAVE A PLASTIC WASHER (STAMPED "SURVEYOR MARKER DO NOT REMOVE") ATTACHED BY AN ALUMINUM NAIL TO THE FACE, BELOW THE "BT" FOR DISTANCE AND ANGLE MEASUREMENT UNLESS OTHERWISE NOTED. THE DRAWING IS FROM AUTOCAD RELEASE 2008.

THIS RESTORATION WAS PERFORMED AT THE DIRECTION AND APPROVAL OF THE BENTON COUNTY SURVEYOR *MD*

REGISTERED
PROFESSIONAL
LAND SURVEYOR

4/20/09 *David M. Dean*
OREGON
JULY 13, 1984
DAVID M. DEAN
2090

FIRM/AGENCY: BENTON COUNTY SURVEYOR'S OFFICE
ADDRESS: 360 S.W. AVERY AVE. CORVALLIS, OR. 97333; PH. 766-6821
PRESENT: DAVID M. DEAN, P.L.S. AND BERNIE ALTENBACH, SURVEY TECH.
EQUIPMENT: LECIA TCR 1105 WITH TDS ON BOARD