

105300340

CORNER FILE TRACKING

S:\Survey Corners\CORNERS\Templates\Filetrac2.doc
10/04/2010

| |
|----------------------|
| CORNER NUMBER |
| 105300340 |

| STEP | HISTORY | RESTORATION |
|-----------------------------|-----------|-------------|
| Form Prepared, DB | 3/21/2013 | 5/4/10 |
| Field Inspection, DB | 5/2/10 | 5/2/10 |
| Finish index (count unit) | 3/21/13 | 5/2/10 |
| Counter Index | 5/2/10 | 5/2/10 |
| GIS Index Form | 5/3/10 | 5/3/10 |
| Checked, DB | 5/14/10 | 5/14/10 |
| Form Edited, DB | 5/15/10 | 5/15/10 |
| Form Signed, DB | 5/15/10 | 5/15/10 |
| Authorize Payment, DB | — | — |
| Archive Digital Files | 5/15/10 | 5/15/10 |
| Collect Documents | 5/15/10 | 5/15/10 |
| PDF File | 5/16/10 | 5/16/10 |
| Copy For Filming | 5/16/10 | 5/16/10 |
| Scanned (pdf to laserfiche) | 5/16/10 | 5/16/10 |
| Filmed (Archived), DB | | |
| Filed, DB | | |

(DB) = Entry needed in database (Access).

COMMENTS:

DATE 03/21/2013TOWNSHIP 10 SOUTH, RANGE 5 WEST, WILLAMETTE MERIDIAN; SECTION 20 CORNER EAST 1/4
DONATION LAND CLAIM NONE CORNER NONE**COMMON CORNER(S):**

WEST 1/4 SECTION 21

RECORDS (INFORMATION IN *BOLD ITALICS* IS COUNTY STAFFS' INTERPRETATION OF THE RECORD)

BASED ON EXTENSIVE RESEARCH AND RECOVERY OF EVIDENCE, THIS OFFICE HAS DETERMINED THAT MOST GENERAL LAND OFFICE SURVEYORS IN BENTON COUNTY MEASURED TO THE FACE OF BEARING TREES.

- [01] GENERAL LAND OFFICE (GLO) NOTES BY GEORGE MERCER, D.S., DATED MAY 13, 1882. *SET POST 3 FEET LONG AND 3 INCHES SQUARE WITH MARKED STONE 12 INCHES IN THE GROUND FOR 1/4 SECTION CORNER MARKED "1/4 S" ON WEST SIDE FROM WHICH A FIR 8" DIA BEARS N70°E, 7 LINKS (4.62 FEET) MARKED "1/4 S BT"; A FIR 10" DIA BEARS S70°W, 9 LINKS (5.94 FEET) MARKED "1/4 S BT".*
- [02] BENTON COUNTY CORNER RESTORATION BOOK NO. 1, PAGE 170, BY WALTER W. LARSEN, D.C.S., NO DATE GIVEN. *SET 1/2" PIPE FROM WHICH A FIR 10" DIA (GLO BT) BEARS S70°W, 0.09 CHAINS (5.94 FEET); A FIR 8" DIA (GLO BT) BEARS N70°E, 0.07 CHAINS (4.62 FEET).*
- [03] BENTON COUNTY CORNER RESTORATION NO. 218. *TRANSCRIBED FROM RECORD [02] AND MAY CONTAIN ERRORS AND/OR OMISSIONS.*
- [04] LETTER FROM MARVIN L. ROWLEY, P.E., DATED JANUARY 31, 1968, WITH CORNER RESTORATION NOTES BY RONALD A. BRANDT, E.I.T., DATED SEPTEMBER 10, 1967. *FOUND 1/2" IRON PIPE FROM WHICH ROTTEN REMAINS OF D. FIR STUMP (GLO BT) BEARS N70°E, 0.07 CHAINS (4.62 FEET); ROTTEN REMAINS OF D. FIR STUMP (GLO BT) BEARS S70°W, 0.09 CHAINS (5.94 FEET). REPLACED PIPE WITH 3/4" IRON PIPE AND BRASS CAP MARKED "DUNN S20 S21 FOREST" WITH A WHITE CEDAR POST 24" ABOVE GROUND NEXT TO THE BRASS CAP.*
- [05] BENTON COUNTY CORNER RESTORATION NO. 219 BY CURTIS J. LIESENFELT, P.L.S., DATED JUNE 28, 1990. *TRANSCRIBED FROM RECORD [04] AND MAY CONTAIN ERRORS AND/OR OMISSIONS.*
- [06] BENTON COUNTY SURVEY NO. 8491 BY THEODORE JAMES LANGTON, P.L.S., DATED FEBRUARY 5, 1991. *FOUND 2-1/2" BRASS CAP ON 3/4" PIPE 80 FEET NORTHWEST OF ROAD 130. A WHITE 4 X 4 POST STANDS NEARBY WITH A 1/2" PIPE ALONGSIDE IT. FOUND D. FIR 12" DIA BEARS N70°E, 2.8 FEET, NO MARKS; FIR (GLO BT) AT S70°W, 5.94 FEET IS GONE; D. FIR 12" DIA BEARS S50°W, 20.8 FEET, FACE SCAR.*
- [07] OREGON STATE UNIVERSITY RESEARCH FORESTS CORNER CONDITION REPORT BY UNKNOWN PERSON, DATED JUNE 19, 1991, AND TAKEN FROM PROPERTY LINE INSPECTION NOTEBOOKS DATED 03/1991 BY STU MITCHELL AND 06/1991 BY PAT GAYLORD. *FOUND 2-1/2" BRASS DUNN FOREST CAP MARKED "DUNN S20 S21 FOREST" WITH A 2' WHITE POST AND AN 18" X 3/4" OUTER DIAMETER IRON PIPE ALONGSIDE. FOUND NO EVIDENCE OF BEARING TREES. IRON PIPE IS NOT SET, BUT IS JUST STANDING ALONGSIDE ABOUT 2" INTO THE GROUND.*
- [08] OREGON STATE UNIVERSITY RESEARCH FORESTS CORNER CONDITION REPORT BY CHARLES E. MCMURRY, DATED APRIL 29, 1993. *IRON PIPE WITH BRASS CAP MARKED "DUNN FOREST S20 S21". WHITE CEDAR POST ALONGSIDE. ORANGE CARSONITE POST ALONGSIDE.*

FIRM/AGENCY: BENTON COUNTY SURVEYOR'S OFFICE**ADDRESS:** 360 S.W. AVERY AVE. CORVALLIS OR 97333; PH. 766-6821**RESEARCH BY:** DAVID L. MALONE, P.L.S.**DATA ENTRY BY:** SAME

BENTON COUNTY CORNER RESTORATION FORM, PAGE 1 OF 2, 105300340R2

SEE CORNER HISTORY FORM FOR RECORDS ETC.

CORNER RESTORATION FIELD BOOK NUMBER 31 PAGE(S) 77 DATE 05/02/2018
TOWNSHIP 10 SOUTH, RANGE 5 WEST, WILLAMETTE MERIDIAN; SECTION 20 CORNER EAST 1/4
DONATION LAND CLAIM N/A CORNER N/A
CONDITION REPORT ___; REFERENCED OUT X; RENEWED ___; SURVEYED IN ___

LOCATION AND COMMENTS:

CORNER IS LOCATED ON A MODERATE EAST FACING SLOPE WITH ±15 YEAR OLD D. FIR REPROD TO THE WEST, ±10 YEAR OLD D. FIR REPROD TO THE NORTHEAST AND MIXED AGE FIRS AND SCATTERED HARDWOODS TO THE SOUTHEAST. TO REACH CORNER FROM THE INTERSECTION OF TAMPICO ROAD AND OSU RESEARCH FORESTS ROAD 100, FOLLOW ROAD 100 FOR 0.38 MILES TO A WYE, STAY RIGHT FOR 0.47 MILES TO A WYE WITH ROAD 130, TURN LEFT AND FOLLOW ROAD 130 FOR 0.36 MILES TO A WYE, STAY RIGHT FOR 0.22 MILES TO A WYE, STAY LEFT FOR 0.22 MILES TO A WYE, STAY RIGHT FOR 0.07 MILES TO A WYE, STAY RIGHT FOR 0.29 MILES TO A WYE, STAY RIGHT FOR 0.35 MILES AND PARK. WALK NORTHWEST FOR ABOUT 100 FEET TO THE CORNER. CORNER IS BAD FOR PREMARKING AND POOR FOR GPS CONTROL.

MONUMENTS AND ACCESSORIES FOUND (CONDITION AND SOURCE):

1. FOUND 2-5/8" BRASS CAP MARKED AS SHOWN ON PAGE 2 OF 2, ON 3/4" IRON PIPE, FIRMLY SET AND UNDISTURBED, FLUSH WITH GROUND SURFACE FOR THE CORNER.
(SET POST 3 FEET LONG AND 3 INCHES SQUARE WITH MARKED STONE 12 INCHES IN THE GROUND MARKED "1/4S" ON WEST SIDE AS PER RECORD [01]).
(SET 1/2" PIPE AS PER RECORD [02]).
(FOUND 1/2" IRON PIPE. REPLACED PIPE WITH 3/4" IRON PIPE AND BRASS CAP MARKED "DUNN S20 S21 FOREST" AS PER RECORD [04]).
(FOUND 2-1/2" BRASS CAP ON 3/4" PIPE AS PER RECORD [06]).
(FOUND 2-1/2" BRASS CAP MARKED "DUNN FOREST S20 S21" AS PER RECORD [07]).
2. FOUND ROTTEN REMAINS OF FIR STUMP 16" DIA BEARS S50°00'W, 21.10 FEET TO CENTER, WITH NO VISIBLE MARKS. **BASIS OF BEARINGS FOR THIS RESTORATION.**
(D. FIR 12" DIA BEARS S50°W, 20.8 FEET, FACE SCAR AS PER RECORD [06]).
3. FOUND D. FIR 17" DIA WITH NO VISIBLE MARKS BEARS N89°31'E, 2.83 FEET TO CENTER. SET ALUMINUM NAIL AND PLASTIC WASHER IN NORTHERLY BASE FOR DISTANCE MEASUREMENT.
(FOUND D. FIR 12" DIA BEARS N70°E, 2.8 FEET, NO MARKS AS PER RECORD [06]).

MONUMENT SET (PROCEDURES AND DESCRIPTION):

FOUND 2-5/8" BRASS CAP MARKED AS SHOWN ON PAGE 2 OF 2, ON 3/4" IRON PIPE, FIRMLY SET AND UNDISTURBED, FLUSH WITH GROUND SURFACE FOR THE CORNER. THE BRASS CAP AND IRON PIPE WERE SET BY MARVIN L. ROWLEY, P.E., IN 1968, TO REPLACE A 1/2" IRON PIPE SET BY WALTER W. LARSEN, D.C.S., FROM BOTH ORIGINAL GENERAL LAND OFFICE (GLO) BEARING TREES. ROWLEY ALSO FOUND EVIDENCE OF BOTH ORIGINAL GLO BEARING TREES. THE BRASS CAP IS ACCEPTED AS A PERPETUATION OF THE ORIGINAL GLO CORNER POSITION.

SET THREE NEW IRON ROD ACCESSORIES AS SHOWN ON PAGE 2 OF 2. FOUND STEEL T-POST 10 INCHES NORTH OF BRASS CAP. FOUND ORANGE CARSONITE "SURVEY MARKER" POST 7 INCHES SOUTHWEST OF BRASS CAP. FOUND WHITE PAINTED WOOD POST 8 INCHES SOUTH OF BRASS CAP. FOUND 1/2" IRON PIPE BURIED HORIZONTALLY 15 INCHES SOUTH OF BRASS CAP.

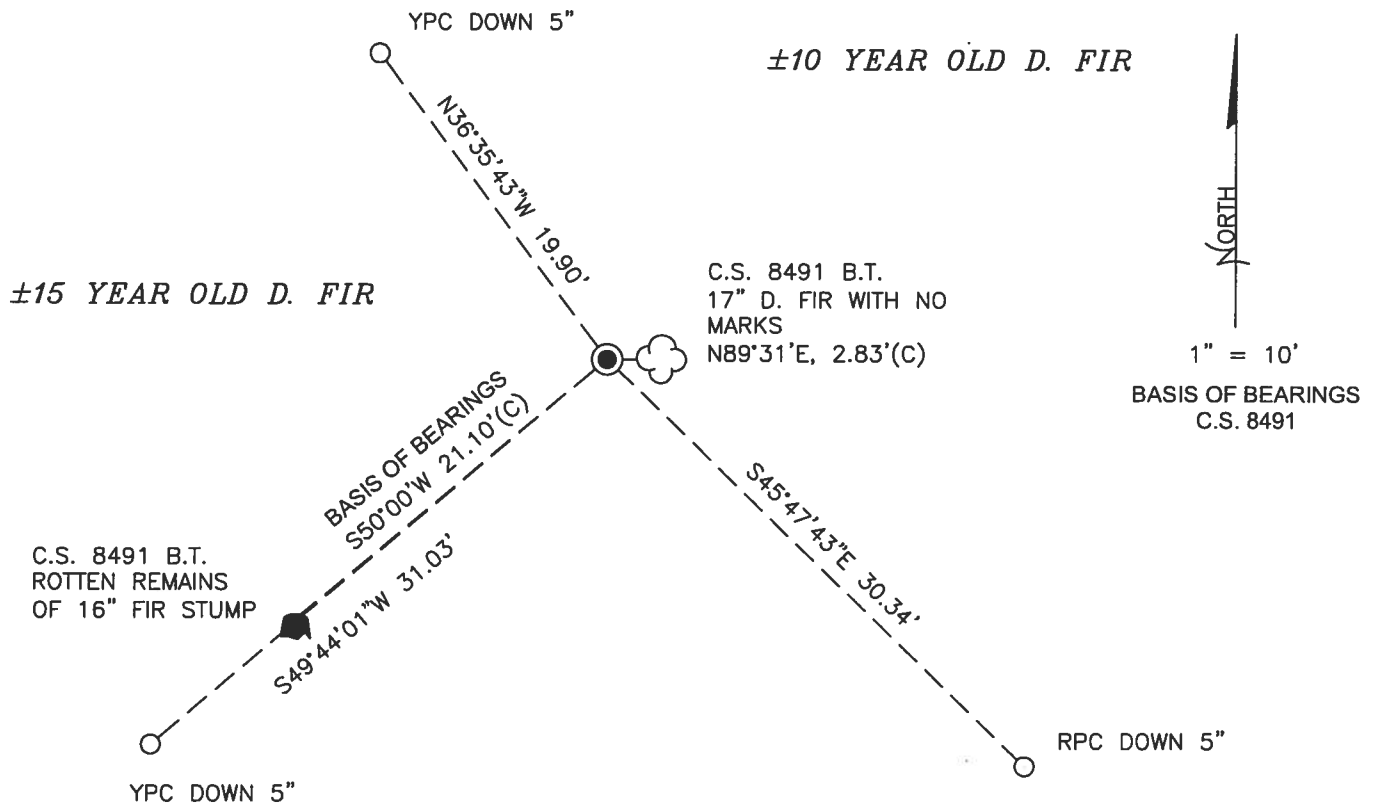

SCATTERED HARDWOODS
AND MIXED AGE FIRS

MONUMENT DETAIL

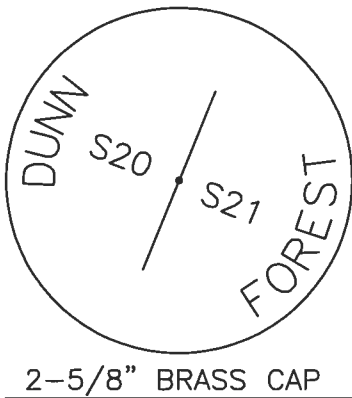

LEGEND

- SET 5/8" X 30" REBAR WITH PLASTIC CAP
- YPC YELLOW PLASTIC CAP MARKED "BENTON COUNTY SURVEYOR"
- RPC RED PLASTIC CAP MARKED "BENTON COUNTY SURVEYOR"
- (C) MEASUREMENT TO CENTER
- GOVERNMENT MONUMENT FOUND AS SHOWN
- C.S. COUNTY SURVEY
- B.T. BEARING TREE
- BEARING TREE STUMP AS NOTED
- ☼ BEARING TREE AS NOTED

NEW ACCESSORIES:

1. SET REBAR (SEE LEGEND) S45°47'43"E, 30.34 FEET AND 5 INCHES BELOW GROUND LEVEL.
2. SET REBAR (SEE LEGEND) S49°44'01"W, 31.03 FEET AND 5 INCHES BELOW GROUND LEVEL.
3. SET REBAR (SEE LEGEND) N36°35'43"W, 19.90 FEET AND 5 INCHES BELOW GROUND LEVEL.

NOTES:

COMPASS DECLINATION IS 15° EAST. ALL MEASURED DISTANCES AND BEARINGS ARE TO THE CENTER OF THE OBJECT, UNLESS OTHERWISE NOTED. ALL BEARING TREES ARE PAINTED AND HAVE A B.T. TAG ATTACHED, FACING THE CORNER UNLESS OTHERWISE NOTED. ALL NEW BEARING TREES HAVE A PLASTIC WASHER (STAMPED "SURVEY MARKER DO NOT REMOVE") ATTACHED BY AN ALUMINUM NAIL TO THE SIDE CENTER OF THE TREE FOR DISTANCE MEASUREMENT, UNLESS OTHERWISE NOTED.

THIS RESTORATION WAS PERFORMED AT THE DIRECTION AND APPROVAL OF THE BENTON COUNTY SURVEYOR *[Signature]*

REGISTERED
PROFESSIONAL
LAND SURVEYOR

FIRM/AGENCY: BENTON COUNTY SURVEYOR'S OFFICE
 ADDRESS: 360 S.W. AVERY AVE., CORVALLIS, OR 97333; PH. 541-766-6821
 PRESENT: DAVID L. MALONE, P.L.S., AND BERNARD ALTENBACH, SURVEY TECH.
 EQUIPMENT: NIKON NIVO3.C WITH SURVEY PRO ONBOARD.

9/15/18 David L. Malone

OREGON
JANUARY 12, 1999
DAVID L. MALONE
51523

RENEWAL DATE: 12/31/18

3/77

5/2/18
D. MARONE
B. ALTENBERG

COOL, UNDERCAST
Nikon nivole
SURVEY PRO ON BOARD

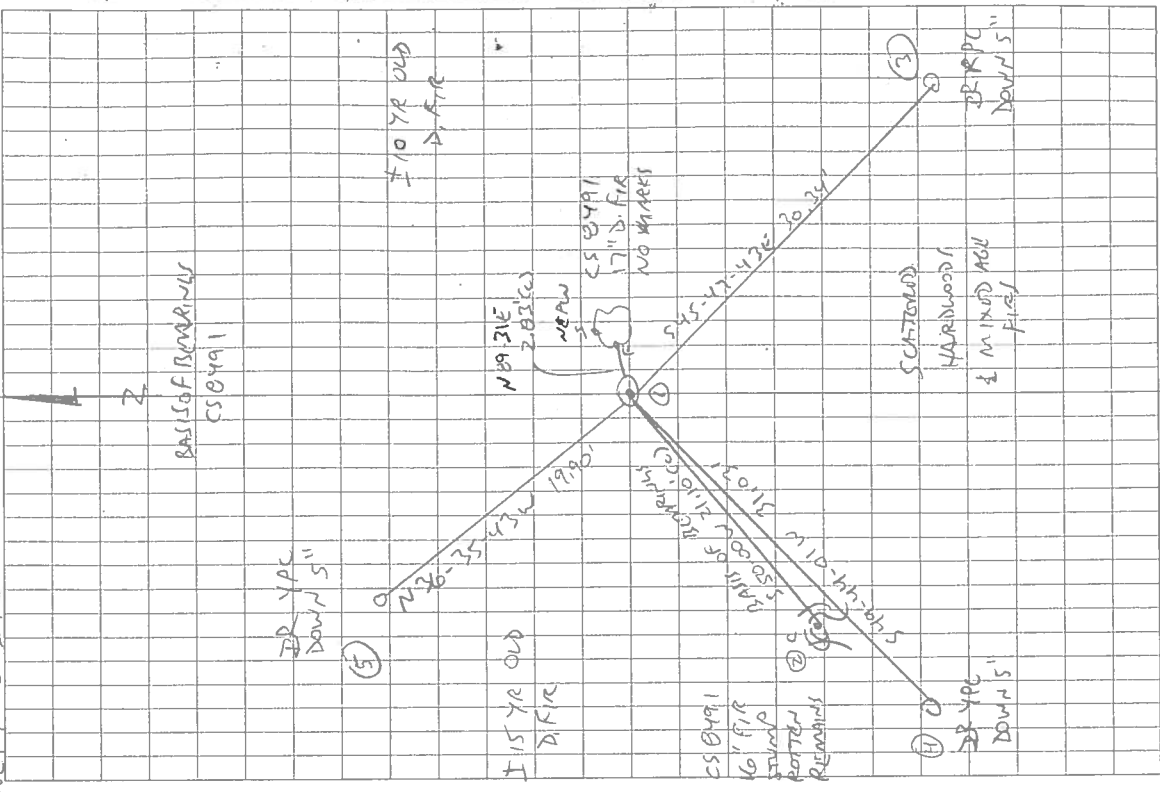

REFERENCE
REMARKS T10 S R SW 20 21

FD 2-5/8" BRASS CAP ON 3/4" DP, FIRMLY SET & UNDISTURBED, FRESH W/ GROUND SURFACE, FOR THE CORNER. FD STEEL T-POST 10" NORTH, FD ORANGE CARBONITE "SURVEY MARKER" POST 7" SW. FD WHITE PAINTED WOOD POST 8" SOUTH. FD 1/2" DP BURIED HORIZONTALLY 15" SOUTH OF BRASS CAP. HELD REMAINS OF SW BT NOTED BY CS 8491. ALSO NOTED NE BT NOTED BY CS 8491. SET THREE NEW IRON ROD ACCESSORIES.

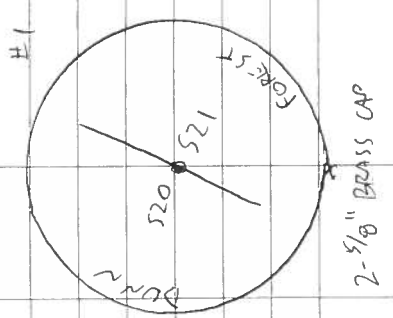

DR = 5/8" x 30" IRON ROD
YPC OR RPC = YELLOW OR RED
PLASTIC CAP MARKED
"SEXTON COUNTY SURVEYOR"
N&PW = NAIL & PLASTIC WASHED
MARKED "SURVEY MARKER"
DO NOT REMOVE

Rowley & Parker

Tree Farm Service

P.O. BOX 270, PHILOMATH, OREGON 97370



JANUARY 31, 1968

BENTON COUNTY ENGINEER:

THE FOLLOWING WORK HAS BEEN PERFORMED FOR OREGON STATE UNIVERSITY,
SCHOOL OF FORESTRY, IN A PROGRAM TO RENEW ALL EXTERIOR BOUNDARY CORNERS
ON MCDONALD AND DUNN FORESTS.

THE ATTACHED RENEWED CORNER DATA HAS BEEN DONE BY RONALD A. BRANDT,
ENGINEER-IN-TRAINING, UNDER MY DIRECTION AND SUPERVISION.

MARVIN L. ROWLEY

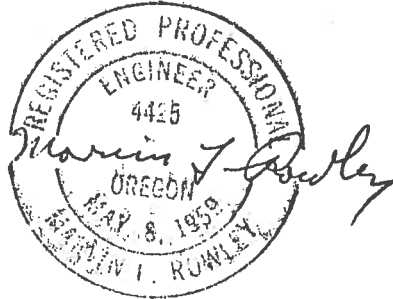

1/4 Corner Sec. 20 and 21

Date: Sept. 10, 1967

Found:

1/2 in. iron pipe

Rotten remains of fir stump B.T.'s -
Douglas Fir, N 70°E, .07 ch.
" " , S 70°W .09 ch.

Replaced pipe with:

3/4 in. iron pipe and brass cap

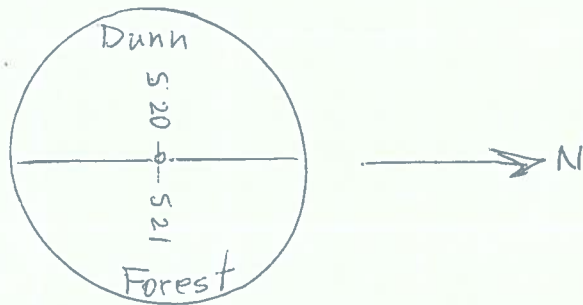

white cedar post 24 in. above ground
next to the brass cap.

FOREST CORNER CONDITION REPORT

Section 20 Township 10S Range 5W
County BENTON Date 4/29/93

CORNER DESIGNATION

20/21 1/4 CORNER

Previous Renewals/Surveys, etc. _____

Monument(s) & Accessories Found: (Condition and Source)

IRON PIPE WITH BRASS CAP

WHITE CEDAR POST ALONGSIDE

ORANGE CARBONITE POST ALONGSIDE

Monument Detail

Sketch

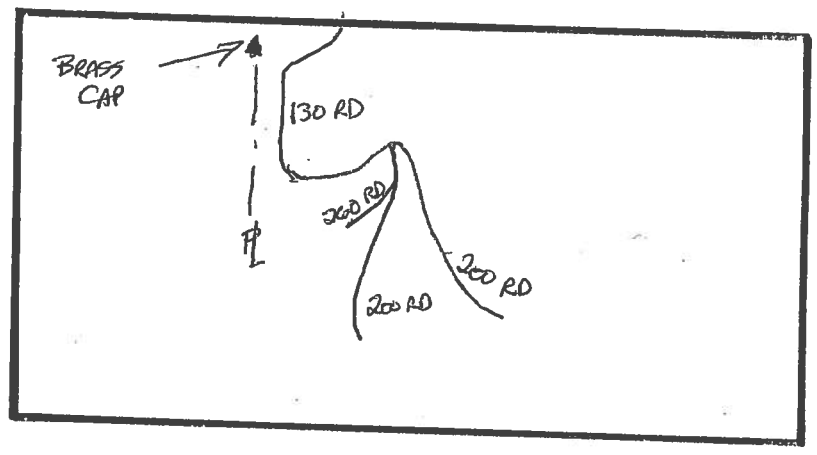
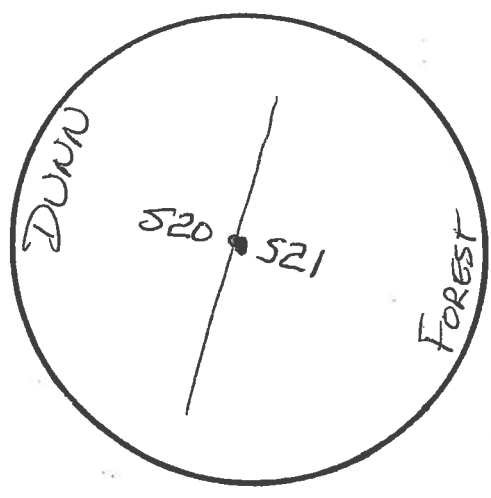

MONUMENT AND ACCESSORY CONDITION

Location & Comments

Compass Declination 20° E

Charles E. Henry

OREGON STATE UNIVERSITY
RESEARCH FORESTS CORNER CONDITION REPORT

Section 21 Township 10S Range 5W
County BENTON Date JUNE 19, 1991

CORNER DESIGNATION

WEST 1/4 CORNER SECTION 21

Previous Renewals/Surveys, etc. PROP. LINE INSPECTION NOTEBOOKS DATED 3/91 AND 6/91 CARRIED OUT BY STU MITCHELL AND PAT GAYLORD, RESPECTUVELY.

Monument(s) & Accessories Found: (Condition and Source)

FOUND 2 1/2" BRASS DUNN FOREST CAP WITH A 2' WHITE POST AND AN 18" X 3/4" (O.D.I.A) IRON PIPE ALONG SIDE. FOUND NO EVIDENCE OF BEARING TREES.

I.P. IS NOT SET, BUT IS JUST STANDING ALONGSIDE ABOUT 2" INTO THE GROUND

Monument Detail

Sketch

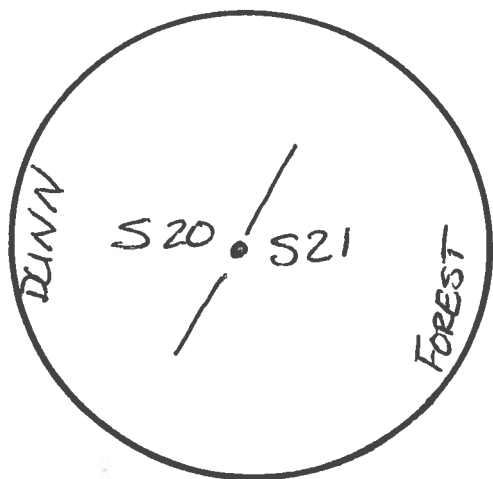

2 1/2" DIA

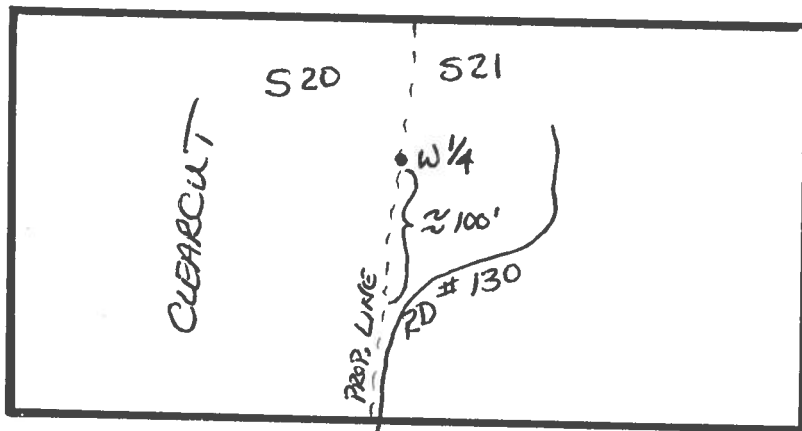

MONUMENT AND ACCESSORY CONDITION CAP AND POST ARE IN GOOD CONDITION THEY RECEIVED NO DAMAGE FROM LOGGING ACTIVITY ON THE WEST SIDE OF THE LINE.

* FOR BT INFORMATION SEE ALSO; FEB 5, 1991 SURVEY BY NORTHSTAR SURVEYING WHICH WAS UNAVAILABLE AT THE TIME THIS WORK WAS COMPLETED

Location & Comments

CORNER IS LOCATED Compass Declination 20°
≈ 1 1/4 MILES FROM THE JUNCTION OF RD 130 & 131 WHERE THE 130 ROAD INTERSECTS THE CLEARCUT BOUNDARY.

CORNER IS LOCATED ≈ 100' UPHILL NORTH OF THE ROAD ALONG THE CLEARCUT BOUNDARY.

BENTON COUNTY SURVEYORS OFFICE - CORNER RESTORATION

219

T 10 S, R 5 W, W. B. & M., BENTON COUNTY, OREGON
SECTION 20

REPORTED BY Marvin L. Rowley
TITLE P. E.
DATE Jan 31, 19~~8~~68 9/10/1967
(CJL 6/28/90)

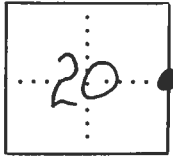

● OFFICIAL CORNER FOUND
○ CORNER SET

LEGIBLE MARKS ON BEARING OBJECTS

1/4 CORNER COMMON TO SEC. 20 & 21
IS 3/4" iron pipe with brass cap
DESCRIBE

ADDITIONAL INFORMATION

Brass cap is marked as follows
Dunn
S20 S21
Forest white cedar post 24"
above ground next to the
brass cap.

FOUND:

1/2 IN. IRON PIPE

(OVER)

KIND
SIZE
BEARING
DISTANCE
BT TAG POSTED

| | | | |
|--|--|--|--|
| | | | |
| | | | |
| | | | |
| | | | |
| | | | |
| | | | |
| | | | |
| | | | |

ROTTEN REMAINS OF FIR STUMP B.T.'S -
DOUGLAS FIR, N 70°E, .07 CH.
" " S 70°W - .09 CH.

REPLACED PIPE WITH:

THE MONUMENT AS DESCRIBED ON THE FRONT OF THIS CARD.

THIS INFORMATION WAS TAKEN FROM THE T10S R5W FILE IN THE CORNER RESTORATION CORRESPONDENCE FILE DRAWER (CJL 6/28/90).

CORNER RESTORATION BOOK NO. 1

C.S. 330
W.W. L.
June 1923
Wit.
Ira Brooks
John Noble
Arnold

1/4 sec. cor. betw. sec's. 13 + 24 T10 S R6W. W.M.

Set 2 bricks + stake

Dead Oak 12" in dia. bears S15° E .09 chs. std.
" " 16" " " " N20° W .45 "
Fir 30" " " " " N36° W .340 "
W. " 24" " " " " S 67 1/2° W .310 "

Sec. corner to sec's 13, 14, 23, + 24 - T10 S R6W

Set stone mld X.

Fir 30" in dia. bears N. 30° E .14
" 24" " " " S. 60° W .232
" 20" " " " S 20° E .115

1/4 sec. cor. to sec's. 13 + 14 T10 S R6W W.M.

Set stone 8" x 8" x 10" + blue can

Fir 24" S 30° W. .203 chs.
" 30" N 41 1/2° W .353 "

N.E. Cor. of A.M. Rainwater Cl. 39, T11 S R4W.

Set 1" shaft + pinnon

Cherry 10" N. 52° 30' W. .421
" 10" brs. N 3° W. .253
Apple 6" " S. 38° E. .60
Walnut 8" N 0° 30' W 1.105

1/4 Sec. cor. betw. sec's. 20 + 21 T. 12 S. R. 6 W. W.M.

Set 1" rod 12" below surf.

Oak 8" East .652
" 8" N 30° E .595
" 6" S 82° W. 1.488

Sec. cor. to sec's. 16, 17, 20, 21, T. 10 S R5W. W.M.

Set buggy axle from which

Fir 14" in dia. bears N 71 1/2° E .27 chs.
" 15" " " " S 41° E 1.76 "
" 10" " " " N 41° W. 1.60 "
W. Oak 10" " " " S 55° W. 1.15

1/4 cor. betw. sec's 20 + 21 T. 10 S R5W.

Set 1/2" pipe from which

Fir 10" in dia. bears S. 70° W .09 chs.
" 8" " " " N. 70° E. .09 "

Most N. N.E. Cor. Arnold Fuller Cl. 38 T. 11 S R5W

Set 1/2" pipe + oak stk.

Oak 12" N. 78° W. .265 chs.
Fir 8" N 78° E. .256 "
Maple 6" S 89° E. 1.190 "

$\frac{1}{4}$ -Corner between sections 20 and 21, Twp. 10 S., R. 5 W.

218

Reestablishemtn by W. C. Galloway

June 1923

Set $\frac{1}{2}$ " pipe

Fir 10" in diam bears S 70° W

.09 chains

Fir 8" in diam bears N 70° E

.07 chains

Witnesses Ira Brooks and John Noble