

105300440

CORNER FILE TRACKING

S:\Survey Corners\CORNERS\Templates\Filetrac2.doc
10/04/2010

CORNER NUMBER
105300440

STEP	HISTORY	RESTORATION
Form Prepared, DB	3-22-13	5/3/18
Field Inspection, DB	5/2/18	5/2/18
Finish index (count unit)	3/22/13	5/2/18
Counter Index	5/2/18	5/2/18
GIS Index Form	5/2/18	5/2/18
Checked, DB	5/14/18	5/14/18
Form Edited, DB	5/15/18	5/15/18
Form Signed, DB	5/15/18	5/15/18
Authorize Payment, DB	—	—
Archive Digital Files	5/15/18	5/15/18
Collect Documents	5/15/18	5/15/18
PDF File	5/16/18	5/16/18
Copy For Filming	5/16/18	5/16/18
Scanned (pdf to laserfiche)	5/16/18	5/16/18
Filmed (Archived), DB		
Filed, DB		

(DB) = Entry needed in database (Access).

COMMENTS:

DATE 03/22/2013TOWNSHIP 10 SOUTH, RANGE 5 WEST, WILLAMETTE MERIDIAN; SECTION 16 CORNER WEST 1/4
DONATION LAND CLAIM NONE CORNER NONE**COMMON CORNER(S):**

EAST 1/4 OF SECTION 17

RECORDS (INFORMATION IN *BOLD ITALICS* IS COUNTY STAFFS' INTERPRETATION OF THE RECORD)

BASED ON EXTENSIVE RESEARCH AND RECOVERY OF EVIDENCE, THIS OFFICE HAS DETERMINED THAT MOST GENERAL LAND OFFICE SURVEYORS IN BENTON COUNTY MEASURED TO THE FACE OF BEARING TREES.

- [01] GENERAL LAND OFFICE (GLO) NOTES BY ROBERT ELDER, D.S., DATED MARCH 10, 1853. *SET POST FROM WHICH A W. OAK 12" DIA BEARS S35°W, 54 LINKS (35.64 FEET); AN OAK 30" DIA BEARS S56°E, 63 LINKS (41.58 FEET).*
- [02] BENTON COUNTY SURVEY NO. 254 (OLD NO. 131) FIELD NOTES (FIELD BOOK 6, PAGE 73) BY F. MARION WILKES, C.S., DATED MAY 30, 1911. *BOTH TREES DEAD. SOUTHWEST DOWN. REESTABLISH FIR 11" DIA FOR CORNER. FIR 14" DIA BEARS S46°E, 0.215 CHAINS (14.19 FEET); FIR 15" DIA BEARS S46°W, 0.257 CHAINS (16.96 FEET).*
- [03] BENTON COUNTY CORNER RESTORATION BOOK NO. 1, PAGE 63, BY F. MARION WILKES, C.S., NO DATE GIVEN. *MARKED FIR 11" DIA FOR CORNER. BOTH TREES DEAD. SW TREE DOWN. MARKED FIR 14" DIA BEARS S46°E, 0.215 CHAINS (14.19 FEET); FIR 15" DIA BEARS S46°W, 0.257 CHAINS (16.96 FEET). A NOTE WAS ADDED LATER: CAR AXLE IN NORTH SIDE OF STUMP.*
- [04] BENTON COUNTY CORNER RESTORATION NO. 203. *TRANSCRIBED FROM RECORD [03] AND MAY CONTAIN ERRORS AND/OR OMISSIONS.*
- [05] BENTON COUNTY SURVEY NO. 1136 (OLD NO. 134) FIELD NOTES (FIELD BOOK 38, PAGE 22) BY W.C. GALLOWAY, C.S., DATED JUNE 23, 1930. *FIR 11" DIA DEAD. CUT SAME AND PUT NAIL IN TOP, ALSO CAR AXLE AT NORTH SIDE IN PLACE FOR CORNER. AXLE INTERSECTS GROUND AT CORNER.*
- [06] BENTON COUNTY SURVEY NO. 1200 (OLD NO. 134) FIELD NOTES (FIELD BOOK 38, PAGE 49) BY W.C. GALLOWAY, C.S., DATED MARCH 2, 1933. *LINE RUN FROM WEST 1/4 OF SECTION 16 TO SOUTHWEST CORNER OF SECTION 16.*
- [07] BENTON COUNTY MAP NO. 10-5-00006 BY W.C. GALLOWAY, C.S., DATED MARCH 1933. *SPIKE IN STUMP. CAR AXLE AT THE GROUND. FIR 14" DIA (CSBT) BEARS S46°E, 0.215 CHAINS (14.19 FEET); FIR 15" DIA (CSBT) BEARS S46°W, 0.257 CHAINS (16.96 FEET).*
- [08] LETTER FROM MARVIN L. ROWLEY, P.E., DATED JANUARY 31, 1968, WITH CORNER RESTORATION NOTES BY RONALD A. BRANDT, E.I.T., DATED SEPTEMBER 8, 1967. *FOUND CAR AXLE. FOUND D. FIR STUMP 14" DIA (CSBT) BEARS S46°E, 14.19 FEET; D. FIR STUMP 15" DIA (CSBT) BEARS S46°W, 16.96 FEET. A 10 FOOT HIGH D. FIR STUB 14" DIA BEARS S60°E, 21.4 FEET. REPLACED AXLE WITH 3/4" IRON PIPE AND BRASS CAP MARKED "DUNN S16 S17 FOREST" WITH WHITE CEDAR POST 24" ABOVE GROUND PLACED NEXT TO BRASS CAP.*
- [09] BENTON COUNTY CORNER RESTORATION NO. 207 BY CURTIS J. LIESENFELT, P.L.S., DATED JUNE 28, 1990. *TRANSCRIBED FROM RECORD [08] AND MAY CONTAIN ERRORS AND/OR OMISSIONS.*
- [10] OREGON STATE UNIVERSITY RESEARCH FORESTS CORNER CONDITION REPORT BY PATRICK M. GAYLORD, DATED AUGUST 28, 1991. *FOUND DUNN FOREST BRASS CAP MARKED "DUNN S17 S16 FOREST" ON 1" IRON PIPE WITH WITNESS POST AND 4" X 4" WHITE POST ALONGSIDE. 15" FIR BEARS NORTH, 120 FEET WITH LOCATION POSTER. 12" FIR SNAG BEARS S60°E, 25 FEET, 7 FEET TALL, WITH CRUISERS BLAZE AND LOCATION POSTER. APPROXIMATELY 14" FIR STUMP BEARS S2°W, 22.6 FEET, HIGH STUMPED, WITH CRUISERS BLAZE. PAINTED ALL TREES WITH BLUE BANDS.*
- [11] BENTON COUNTY SURVEY NO. 9001 BY THEODORE JAMES LANGTON, P.L.S., DATED JULY 5, 1995. *FOUND 1" PIPE WITH 2-3/4" BRASS CAP MARKED "DUNN S17 S16 FOREST" FROM WHICH A D. FIR STUMP 16" DIA BEARS S5°W, ABOUT 25 FEET; A D. FIR STUMP 14" DIA BEARS S60°E, ABOUT 24 FEET.*

FIRM/AGENCY: BENTON COUNTY SURVEYOR'S OFFICE
ADDRESS: 360 S.W. AVERY AVE. CORVALLIS OR 97333; PH. 766-6821
RESEARCH BY: DAVID L. MALONE, P.L.S.
DATA ENTRY BY: SAME

BENTON COUNTY CORNER RESTORATION FORM, PAGE 1 OF 2, 105300440R2

SEE CORNER HISTORY FORM FOR RECORDS ETC.

CORNER RESTORATION FIELD BOOK NUMBER 32 PAGE(S) 2 DATE 05/02/2018
TOWNSHIP 10 SOUTH, RANGE 5 WEST, WILLAMETTE MERIDIAN; SECTION 16 CORNER WEST 1/4
DONATION LAND CLAIM N/A CORNER N/A
CONDITION REPORT ; REFERENCED OUT X; RENEWED ; SURVEYED IN

LOCATION AND COMMENTS:

CORNER IS LOCATED IN A FLAT AREA WITH ±20 YEAR OLD D. FIR REPROD TO THE WEST AND ±15 YEAR OLD D. FIR REPROD TO THE EAST. TO REACH CORNER FROM THE INTERSECTION OF TAMPICO ROAD AND OSU RESEARCH FORESTS ROAD 100, FOLLOW ROAD 100 FOR 0.38 MILES TO A WYE, STAY RIGHT FOR 0.47 MILES TO A WYE, STAY RIGHT FOR 0.06 MILES TO A WYE WITH ROAD 150, TURN LEFT ON ROAD 150 FOR 0.31 MILES TO THE PROPERTY LINE WHERE THE ROAD HAS BEEN MADE IMPASSABLE TO VEHICLES. PARK AND WALK ALONG OLD ROAD SOUTHWESTERLY FOR ABOUT 230 FEET, THEN EAST THROUGH THE TREES FOR ABOUT 80 FEET TO THE CORNER. CORNER IS BAD FOR PREMARKING AND POOR FOR GPS CONTROL.

MONUMENTS AND ACCESSORIES FOUND (CONDITION AND SOURCE):

1. FOUND 2-5/8" BRASS CAP MARKED AS SHOWN ON PAGE 2 OF 2, ON 3/4" IRON PIPE, FIRMLY SET AND UNDISTURBED, UP 4" ABOVE GROUND SURFACE FOR THE CORNER.
(SET POST AS PER RECORD [01]).
(MARKED FIR 11" DIA FOR CORNER AS PER RECORDS [02] AND [03]).
(FIR 11" DIA DEAD. CUT SAME AND PUT NAIL IN TOP, ALSO CAR AXLE AT NORTH SIDE IN PLACE FOR CORNER. AXLE INTERSECTS GROUND AT CORNER AS PER RECORD [05]).
(SPIKE IN STUMP. CAR AXLE AT THE GROUND AS PER RECORD [07]).
(FOUND CAR AXLE. REPLACED AXLE WITH 3/4" IRON PIPE AND BRASS CAP MARKED "DUNN S16 S17 FOREST" AS PER RECORD [08]).
(FOUND DUNN FOREST BRASS CAP MARKED "DUNN FOREST S17 S16" ON 1" IRON PIPE AS PER RECORD [10]).
(FOUND 1" PIPE WITH 2-3/4" BRASS CAP MARKED "DUNN S17 S16 FOREST" AS PER RECORD [11]).
2. FOUND ROTTEN REMAINS OF FIR STUMP 14" DIA BEARS S5°00'W, 23.54 FEET TO CENTER, WITH NO VISIBLE MARKS. **BASIS OF BEARINGS FOR THIS RESTORATION.**
(APPROXIMATELY 14" FIR STUMP BEARS S2°W, 22.6 FEET, HIGH STUMPED, WITH CRUISERS BLAZE AS PER RECORD [10]).
(D. FIR STUMP 16" DIA BEARS S5°W, ABOUT 25 FEET AS PER RECORD [11]).

MONUMENT SET (PROCEDURES AND DESCRIPTION):

FOUND 2-5/8" BRASS CAP MARKED AS SHOWN ON PAGE 2 OF 2, ON 3/4" IRON PIPE, FIRMLY SET AND UNDISTURBED, UP 4" ABOVE GROUND SURFACE FOR THE CORNER. BRASS CAP AND IRON PIPE WERE SET BY MARVIN L. ROWLEY, P.E., IN 1968, IN PLACE OF A CAR AXLE THAT WAS SET BY W. C. GALLOWAY, C.S., IN 1930. THE CAR AXLE WAS SET IN PLACE OF A CORNER TREE MARKED BY F. MARION WILKES, C.S., WHICH WAS ESTABLISHED FROM THE ORIGINAL GENERAL LAND OFFICE (GLO) BEARING TREES. THE BRASS CAP IS ACCEPTED AS A PERPETUATION OF THE ORIGINAL GLO CORNER POSITION.

SET TWO NEW IRON ROD ACCESSORIES AND BLAZED AND SCRIBED TWO NEW BEARING TREES AS SHOWN ON PAGE 2 OF 2. FOUND ORANGE CARSONITE "SURVEY MARKER" POST 8 INCHES NORTHWEST OF BRASS CAP.

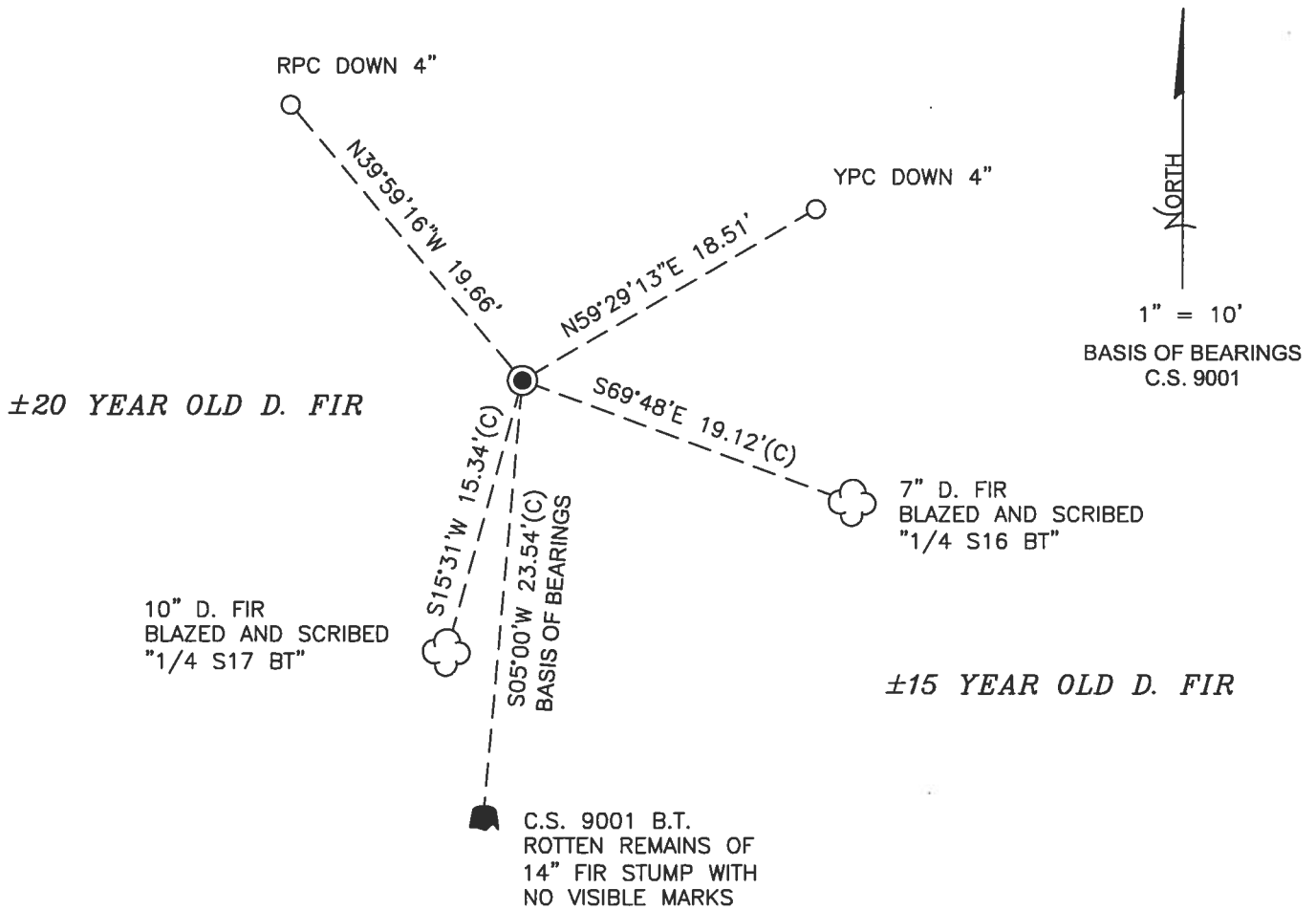

MONUMENT DETAIL

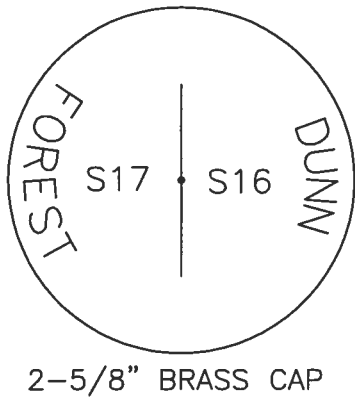

LEGEND

- SET 5/8" X 30" REBAR WITH PLASTIC CAP
- YPC YELLOW PLASTIC CAP MARKED "BENTON COUNTY SURVEYOR"
- RPC RED PLASTIC CAP MARKED "BENTON COUNTY SURVEYOR"
- (C) MEASUREMENT TO CENTER
- GOVERNMENT MONUMENT FOUND AS SHOWN
- C.S. COUNTY SURVEY
- B.T. BEARING TREE
- BEARING TREE STUMP AS NOTED
- ☼ BEARING TREE AS NOTED

NEW ACCESSORIES:

1. SET REBAR (SEE LEGEND) N59°29'13"E, 18.51 FEET AND 4 INCHES BELOW GROUND LEVEL.
2. SET REBAR (SEE LEGEND) N39°59'16"W, 19.66 FEET AND 4 INCHES BELOW GROUND LEVEL.
3. D. FIR 10" DIA BEARS S15°31'W, 15.34 FEET TO CENTER, FACE SCRIBED "1/4 S17 BT". SET ALUMINUM NAIL AND PLASTIC WASHER ON EASTERLY BASE FOR DISTANCE MEASUREMENT.
4. D. FIR 7" DIA BEARS S69°48'E, 19.12 FEET TO CENTER, FACE SCRIBED "1/4 S16 BT". SET ALUMINUM NAIL AND PLASTIC WASHER ON SOUTHWESTERLY BASE FOR DISTANCE MEASUREMENT.

NOTES:

COMPASS DECLINATION IS 15' EAST. ALL MEASURED DISTANCES AND BEARINGS ARE TO THE CENTER OF THE OBJECT, UNLESS OTHERWISE NOTED. ALL BEARING TREES ARE PAINTED AND HAVE A B.T. TAG ATTACHED, FACING THE CORNER UNLESS OTHERWISE NOTED. ALL NEW BEARING TREES HAVE A PLASTIC WASHER (STAMPED "SURVEY MARKER DO NOT REMOVE") ATTACHED BY AN ALUMINUM NAIL TO THE SIDE CENTER OF THE TREE FOR DISTANCE MEASUREMENT, UNLESS OTHERWISE NOTED.

THIS RESTORATION WAS PERFORMED AT THE DIRECTION AND APPROVAL OF THE BENTON COUNTY SURVEYOR *[Signature]*

REGISTERED
PROFESSIONAL
LAND SURVEYOR

5/15/18 David L. Malone

FIRM/AGENCY: BENTON COUNTY SURVEYOR'S OFFICE
 ADDRESS: 360 S.W. AVERY AVE., CORVALLIS, OR 97333; PH. 541-766-6821
 PRESENT: DAVID L. MALONE, P.L.S., AND BERNARD ALTENBACH, SURVEY TECH.
 EQUIPMENT: NIKON NIVO3.C WITH SURVEY PRO ONBOARD.

OREGON
 JANUARY 12, 1999
 DAVID L. MALONE
 51523

RENEWAL DATE: 12/31/18

105100440

REFERENCE T105 R5W 17 1/2 16

FD 2-5/8" BRASS CAP ON 3/4" IRON PIPE, FLIENTLY SET & UNDISTURBED, UP 4" ABOVE GROUND SURFACE, FOR THE CORNER, FD ORANGE CARBONITE "SURVEY MARKER" POST 8" NW OF BRASS CAP. FD WHITE PAINTED WOOD POST LYING ON GROUND. FD SW BT ASPEN C.S. 9001 & HEAD FOR BASIS OF BEARINGS. BRASS & SCREWED TWO NEW BROWN TREES AND SET TWO NEW IRON ROD ACCESSORIES. AT REAR PORTION OF SW CORNER FOUND PIECE OF WOOD W/ V.S. "C" & "BT" LYING ON GROUND. PLACE WOOD PIECE NEXT TO BRASS CAP.

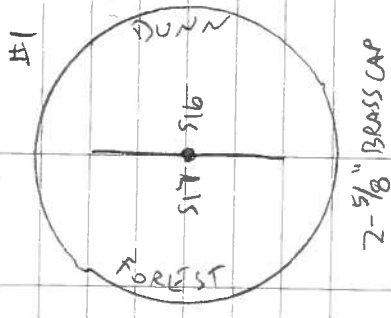

IR = 5/8" x 30" IRON ROD
 YPC OR APC = YELLOW OR RED PLASTIC CAP MARKED
 "VENTON COUNTY SURVEYOR"
 N.E.W. = NAIL & PLASTIC WASHOR
 MARKED "SURVEY MARKER"
 DO NOT REMOVE

WARM, CLEAR

5/2/18
 DIANEANE
 B. ABENAKH
 MIKON N.W. 3.C
 SURVEY PRO CONTINUED

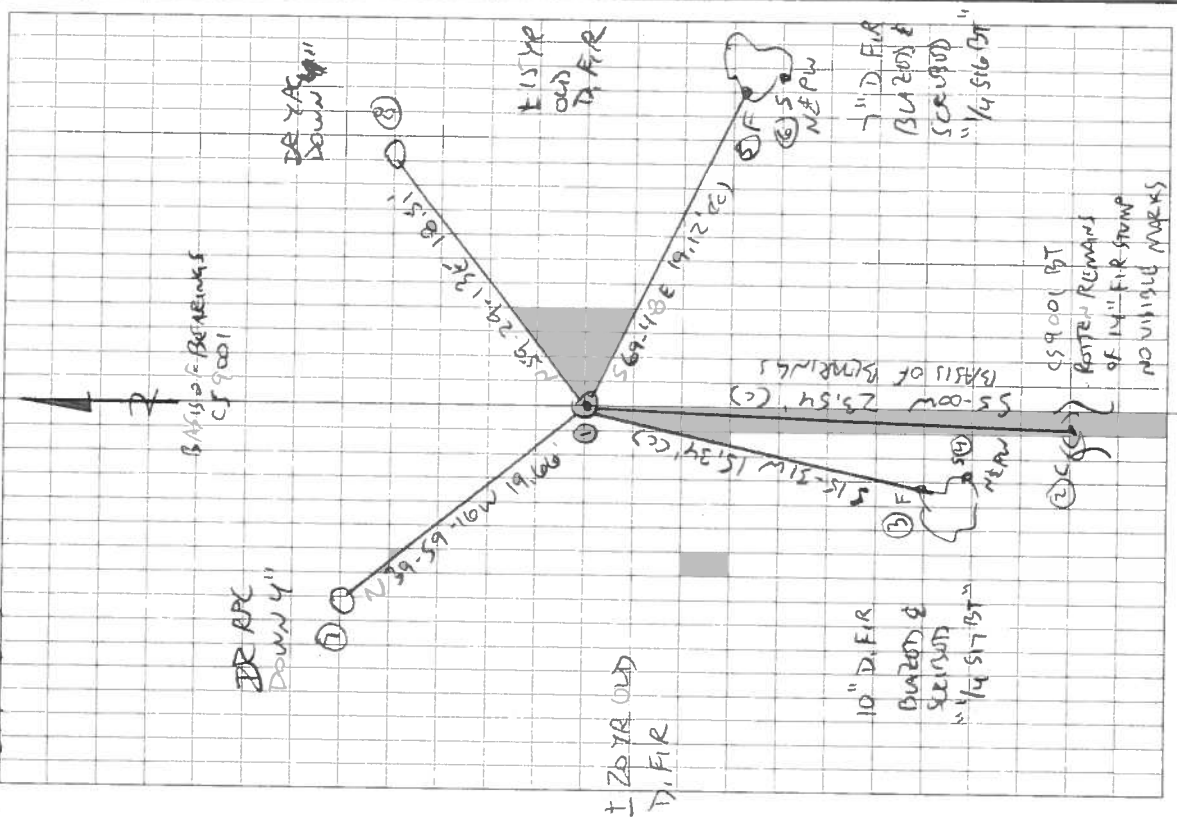

3 1/2

Rowley & Parker

Tree Farm Service

P.O. BOX 270, PHILOMATH, OREGON 97370



JANUARY 31, 1968

BENTON COUNTY ENGINEER:

THE FOLLOWING WORK HAS BEEN PERFORMED FOR OREGON STATE UNIVERSITY,
SCHOOL OF FORESTRY, IN A PROGRAM TO RENEW ALL EXTERIOR BOUNDARY CORNERS
ON MCDONALD AND DUNN FORESTS.

THE ATTACHED RENEWED CORNER DATA HAS BEEN DONE BY RONALD A. BRANDT,
ENGINEER-IN-TRAINING, UNDER MY DIRECTION AND SUPERVISION.

MARVIN L. ROWLEY

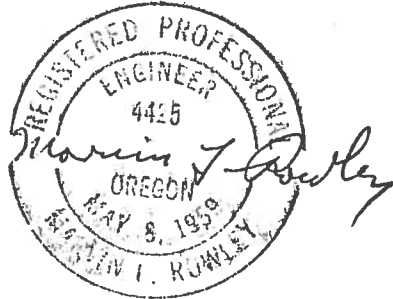

1/4 Corner Sec. 16 and 17

Date: Sept. 8, 1967

found:

Car axle

B.T. Stumps -

Douglas Fir 14 in. dia. S 46° E 14.19 ft.

" " 15 in. dia. S 46° W 16.96 ft.

B.T. stub 10 ft. high -

Douglas Fir 14 in. dia. S 60° E 21.4 ft.

Replaced Axle with:

3/4" pipe (iron) and brass cap

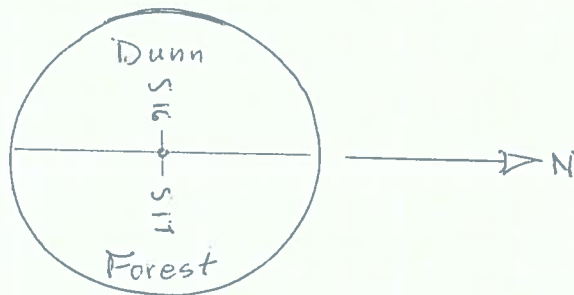

white Cedar post 24" above ground placed
next to brass cap.

BENTON COUNTY SURVEYORS OFFICE - CORNER RESTORATION

207

T 10 S, R 5 W, W. B. & M., BENTON COUNTY, OREGON
SECTION 16

REPORTED BY Marvin L. Rowley
TITLE P.E.
DATE Jan 31, 1968 9/8/1967
(CJL 6/28/90)

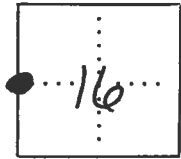

● OFFICIAL CORNER FOUND
○ CORNER SET

44 CORNER COMMON TO SEC. 16 & 17
IS 3/4" Iron pipe with brass cap
DESCRIBE

ADDITIONAL INFORMATION
Brass cap is marked as follows

<u>Dunn</u>	<u>S16</u>	<u>S17</u>
		<u>16</u>

White cedar post 24" above ground is placed next to brass cap.

LEGIBLE MARKS ON BEARING OBJECTS

KIND			
SIZE			
BEARING			
DISTANCE			
BT TAG POSTED			

OVER

FOUND:

CAR AXLE

B.T. STUMPS-

DOUGLAS FIR 14 IN. DIA. S46°E 14.19 FT.

" " 15 IN. DIA. S46°W 16.96 FT.

B.T. STUB 10 FT. HIGH -

DOUGLAS FIR 14 IN. DIA. S60°E 21.4 FT.

REPLACED AXLE WITH:

MONUMENT DESCRIBED ON FRONT OF CARD.

THIS INFORMATION WAS TAKEN FROM THE T10S R&5W FILE IN THE CORNER RESTORATION CORRESPONDENCE FILE DRAWER (CJL 6/28/90).

OREGON STATE UNIVERSITY
RESEARCH FORESTS CORNER CONDITION REPORT

Section 17 Township 10 S Range 5 W
County BENTON Date AUG 28, 1991

CORNER DESIGNATION

EAST 1/4

REFERENCES

MONUMENT(S) & ACCESSORIES FOUND: (CONDITION)

- DUNN FOREST BRASS CAP ON 1" IRON PIPE
- 15" FIR W/ LOCATION POSTER
- 1/4" 14" FIR STUMP WITH CRUISERS BLAZE
- 12" FIR SNAG WITH CRUISERS BLAZE & LOCATION POSTER
- * PAINTED ALL TREES WITH BLUE BANDS *

Monument Detail

Sketch

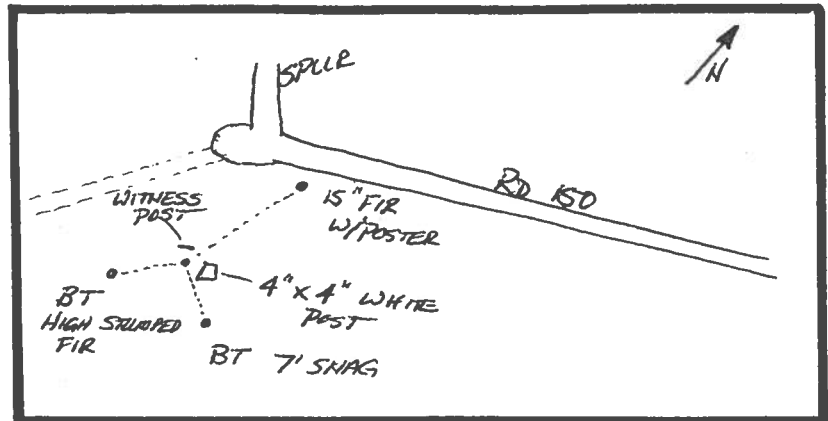
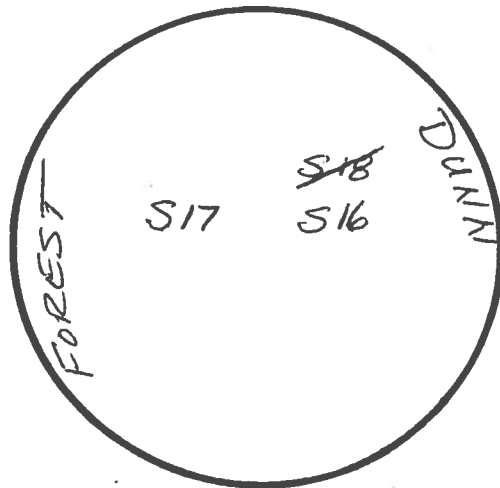

ACCESSORY DESCRIPTION (ALL BEARINGS FROM ACCESSORIES TO MONUMENTS)

- 15" FIR 120' SOUTH
- 12" FIR SNAG N 60° W 25'
- 1/4" 14" FIR STUMP N 02° E 22'

LOCATIONS & COMMENTS

ENTER THROUGH RD 100 GATE, GO 1/2 1.5 MILES TO THE JUNCTION OF
ROADS 100, 150 & 170. FOLLOW THE 150 ROAD TO ITS END. THE CORNER
IS LOCATED 120 FEET SOUTH OF THE ROAD.

SIGNATURE

$\frac{1}{4}$ -Section corner between sections 16 and 17, Twp. 10 S R 5 W

203

Reestablishment by W. C. Galloway

Date 5-30-1911

Marked Fir 11" in diam for corner, both trees dead, S. W. tree down

Fir 14" in diam bears S 46° E

.215 chains dist.

Fir 15" in diam bears S 46° W

.257 chains dist.

Witnesses Joseph C. Smith and Philip Switzer

Car axle in north side of stump of original 11" tree