

105340200

CORNER FILE TRACKING

S:\Survey Corners\CORNERS\Templates\Filetrac2.doc
10/04/2010

CORNER NUMBER
105340200

STEP	HISTORY	RESTORATION
Form Prepared, DB	4/22/2013	2/23/10
Field Inspection, DB	2/12/10	2/12/10
Finish index (count unit)	4/22/13	2/12/10
Counter Index	2/12/10	2/12/10
GIS Index Form	2/12/10	2/12/10
Checked, DB	2/23/10	2/23/10
Form Edited, DB	2/23/10	2/23/10
Form Signed, DB	2/23/10	2/23/10
Authorize Payment, DB	—	—
Archive Digital Files	2/23/10	2/23/10
Collect Documents	2/23/10	2/23/10
PDF File	2/26/10	2/26/10
Copy For Filming	2/23/10	2/23/10
Scanned (pdf to laserfiche)	2/26/10	2/26/10
Filmed (Archived), DB		
Filed, DB		

(DB) = Entry needed in database (Access).

COMMENTS:

DATE 04/22/2013TOWNSHIP 10 SOUTH, RANGE 5 WEST, WILLAMETTE MERIDIAN; SECTION 28 CORNER SOUTH 1/4
DONATION LAND CLAIM NONE CORNER N/A**COMMON CORNER(S):**
NORTH 1/4 CORNER SECTION 33**RECORDS (INFORMATION IN BOLD ITALICS IS COUNTY STAFFS' INTERPRETATION OF THE RECORD)**

BASED ON EXTENSIVE RESEARCH AND RECOVERY OF EVIDENCE; THIS OFFICE HAS DETERMINED THAT MOST GENERAL LAND OFFICE SURVEYORS IN BENTON COUNTY MEASURED TO THE FACE OF BEARING TREES.

- [01] GENERAL LAND OFFICE (GLO) NOTES BY GEORGE MERCER, D.S., DATED MAY 13, 1882. SET POST 3 FEET LONG AND 3 INCHES SQUARE WITH MARKED STONE 12 INCHES IN GROUND MARKED "1/4S" ON NORTH FOR 1/4 SECTION CORNER FROM WHICH AN OAK 10" DIA BEARS S5°E, 296 LINKS (195.36 FEET) MARKED "1/4S BT"; AN OAK 8" DIA BEARS N15°W, 230 LINKS (151.80 FEET) MARKED "1/4S BT".
- [02] BENTON COUNTY SURVEY NO. 189 (OLD NO. 91) FIELD NOTES (FIELD BOOK 7, PAGE 26) BY F. MARION WILKES, C.S., DATED OCTOBER 24, 1910. STRIKING 1/4 SECTION.
- [03] BENTON COUNTY SURVEY NO. 189 (OLD NO. 91) MAP (RECORD OF SURVEYS BOOK NO. 1, PAGE 84), NO DATE OR DRAFTSMAN GIVEN. MAP SHOWS AN OAK STAKE FROM WHICH A FIR 16" DIA BEARS S55°45'E, 0.230 CHAINS (15.18 FEET); AND A FIR 10" DIA BEARS S30°W, 0.180 CHAINS (11.88 FEET). THIS APPEARS TO BE IN ERROR, AS THE FIELD NOTES INDICATE THIS OAK STAKE AND BEARING TREES SHOULD BE LOCATED AT THE CN 1/16 CORNER OF SECTION 33.
- [04] BENTON COUNTY SURVEY NO. 189 (OLD NO. 91) MAP, NO DRAFTSMAN GIVEN, DATED OCTOBER 24, 1910. STONE 6" X 6" X 8". OAK 4" DIA BEARS N89°E, 3.045 CHAINS (200.97 FEET); OAK 10" DIA (GLO BT) BEARS S5°E, 2.96 CHAINS (195.36 FEET); OAK 8" DIA (GLO BT) BEARS N15°W, 2.30 CHAINS (151.80 FEET).
- [05] BENTON COUNTY CORNER RESTORATION BOOK NO. 1, PAGE 40, NO DATE OR DRAFTSMAN GIVEN. SET STONE 6" X 6" X 8" FOR CORNER FROM WHICH AN OAK 4" DIA (CSBT) BEARS N89°E, 304.5 LINKS (200.97 FEET). NORTHWEST AND SOUTHEAST ORIGINAL TREES STANDING.
- [06] BENTON COUNTY CORNER RESTORATION NO. 238. TRANSCRIBED FROM RECORD [05] AND MAY CONTAIN ERRORS AND/OR OMISSIONS.
- [07] BENTON COUNTY SURVEY NO. 1291 (OLD NO. 337) FIELD NOTES (FIELD BOOK 58, PAGE 11) BY W. C. GALLOWAY, C.S., DATED SEPTEMBER 10, 1936. SET FORD AXLE. AN OAK 8" DIA (GLO BT) BEARS N15°W, 2.30 CHAINS (151.80 FEET) STANDING DEAD, CHECKS; AN OAK 10" DIA (GLO BT) BEARS S5°E, 2.96 CHAINS (195.36 FEET) STANDING, CHECKS; AN OAK 6" DIA BEARS N11°45'W, 0.245 CHAINS (16.17 FEET); AND A FIR 20" DIA BEARS S57°20'W, 0.672 CHAINS (44.35 FEET).
- [08] BENTON COUNTY CORNER RESTORATION BOOK NO. 1, PAGE 210, BY W. C. GALLOWAY, C.S., DATED SEPTEMBER 10, 1936. SET A FORD AXLE. AN OAK 8" DIA (GLO BT) BEARS N15°W, 2.30 CHAINS (151.80 FEET) STANDING DEAD, CHECKS; AN OAK 10" DIA (GLO BT) BEARS S5°E, 2.96 CHAINS (195.36 FEET) STANDING, CHECKS; MARKED AN OAK 6" DIA (CSBT) BEARS N11-3/4°W, 0.245 CHAINS (16.17 FEET); AND MARKED A FIR 20" DIA (CSBT) BEARS S57-1/2°W, 0.672 CHAINS (44.35 FEET).
- [09] BENTON COUNTY CORNER RESTORATION NO. 240. TRANSCRIBED FROM RECORD [08] AND MAY CONTAIN ERRORS AND/OR OMISSIONS.
- [10] BENTON COUNTY MAP NO. 10-5-00007 BY W. C. GALLOWAY, C.S., DATED DECEMBER 22, 1936. FORD AXLE. AN OAK 10" DIA (GLO BT) BEARS S5°E, 2.96 CHAINS (195.36 FEET); AN OAK 6" DIA (CSBT) BEARS N11°45'W, 0.245 CHAINS (16.17 FEET); AND A FIR 20" DIA (CSBT) BEARS S57°20'W, 0.672 CHAINS (44.35 FEET).

FIRM/AGENCY: BENTON COUNTY SURVEYOR'S OFFICE
ADDRESS: 360 S.W. AVERY AVE., CORVALLIS, OR 97333; PH. 541-766-6821
RESEARCH BY: DAVID L. MALONE, P.L.S.
DATA ENTRY BY: SAME

**BENTON COUNTY CORNER RESTORATION FORM, PAGE 1 OF 2, 105340200R3
SEE CORNER HISTORY FORM FOR RECORDS ETC.**

CORNER RESTORATION FIELD BOOK NUMBER 31 PAGE(S) 60
TOWNSHIP 10 SOUTH, RANGE 5 WEST, WILLAMETTE MERIDIAN; SECTION 28 CORNER SOUTH 1/4
DONATION LAND CLAIM N/A CORNER N/A
CONDITION REPORT ; REFERENCED OUT ; RENEWED X; SURVEYED IN

DATE 02/12/2018

LOCATION AND COMMENTS:

CORNER IS LOCATED IN A ±40 YEAR OLD MIXED STAND OF FIRS AND HARDWOODS. TO REACH CORNER FROM THE INTERSECTION OF SOAP CREEK ROAD AND WRITSMAN CREEK DRIVE, FOLLOW WRITSMAN CREEK DRIVE FOR 0.25 MILES TO INTERSECTION WITH MOSS ROCK DRIVE, CONTINUE TO FOLLOW WRITSMAN CREEK DRIVE FOR 0.04 MILES TO INTERSECTION WITH ZEOLITE HILLS ROAD, CONTINUE TO FOLLOW WRITSMAN CREEK DRIVE FOR 0.40 MILES TO A STARKER FORESTS GATE, CONTINUE THROUGH GATE FOR 0.04 MILES TO A WYE, STAY RIGHT ON MAIN ROAD FOR 0.18 MILES TO A WYE, STAY LEFT ON MAIN ROAD FOR 0.10 MILES TO A GATE, CONTINUE FOR 0.10 MILES TO A WYE, STAY RIGHT ON MAIN ROAD FOR 0.05 MILES TO A WYE, STAY LEFT ON MAIN ROAD FOR 0.09 MILES TO A WYE, STAY LEFT ON MAIN ROAD FOR 0.14 MILES AND PARK. WALK NORTH ABOUT 195 FEET TO THE CORNER. CORNER IS BAD FOR PREMARKING AND GPS CONTROL.

MONUMENTS AND ACCESSORIES FOUND (CONDITION AND SOURCE):

1. FOUND 30" LONG FORD AXLE FOR THE CORNER, FIRMLY SET AND UNDISTURBED, UP 4" ABOVE GROUND SURFACE. (SET POST 3 FEET LONG AND 3 INCHES SQUARE WITH MARKED STONE 12 INCHES IN GROUND MARKED "1/4S" ON NORTH AS PER RECORD [01]).
(STONE 6" X 6" X 8" AS PER RECORD [04]).
(SET STONE 6" X 6" X 8" FOR CORNER AS PER RECORD [05]).
(SET FORD AXLE AS PER RECORDS [07] AND [08]).
(FORD AXLE AS PER RECORD [10]).
2. FOUND ROTTEN D. FIR STUMP 38" DIA BEARS S57°30'W, 44.56 FEET TO CENTER, OPENED TO VISIBLE SCRIBING "BT". BASIS OF BEARINGS FOR THIS RESTORATION.
(FIR 20" DIA BEARS S57°20'W, 0.672 CHAINS [44.35 FEET] AS PER RECORDS [07] AND [10]).
(MARKED FIR 20" DIA BEARS S57-1/2°W, 0.672 CHAINS [44.35 FEET] AS PER RECORD [08]).
3. FOUND OAK STUMP 8" DIA BEARS N13°41'W, 16.15 FEET TO CENTER, OPENED TO VISIBLE SCRIBING "BT". TREE LYING ON GROUND OPENED TO VISIBLE SCRIBING "CS 337".
(OAK 6" DIA BEARS N11°45'W, 0.245 CHAINS [16.17 FEET] AS PER RECORDS [07] AND [10]).
(OAK 6" DIA BEARS N11-3/4°W, 0.245 CHAINS [16.17 FEET] AS PER RECORD [08]).

MONUMENT SET (PROCEDURES AND DESCRIPTION):

FOUND 30" LONG FORD AXLE FOR THE CORNER, FIRMLY SET AND UNDISTURBED, UP 4" ABOVE GROUND SURFACE. AXLE WAS SET BY W. C. GALLOWAY, C.S., IN 1936, FROM TWO ORIGINAL GENERAL LAND OFFICE (GLO) BEARING TREES. THE AXLE IS ACCEPTED AS A PERPETUATION OF THE ORIGINAL GLO CORNER POSITION.

REMOVED AXLE FROM AREA AND IN SAME HORIZONTAL POSITION SET 2" X 31-1/2" GALVANIZED IRON PIPE WITH 3-1/4" BRASS DISK CEMENTED IN THE TOP, UP 2" ABOVE GROUND SURFACE AND MARKED AS SHOWN ON PAGE 2 OF 2. SET TWO NEW IRON ROD ACCESSORIES AND BLAZED AND SCRIBED TWO NEW BEARING TREES AS SHOWN ON PAGE 2 OF 2. SET 6 FOOT ORANGE CARSONITE "SURVEY MARKER" POST 1 FOOT SOUTH OF BRASS DISK.

**±40 YEAR OLD MIXED
FIR AND HARDWOODS**

C.S.B.T.
8" OAK STUMP WITH TREE
LYING ON GROUND
OPENED TREE TO V.S. "CS
337" AND STUMP TO V.S. "BT"

6" D. FIR
BLAZED AND SCRIBED
"1/4 S28 BT"

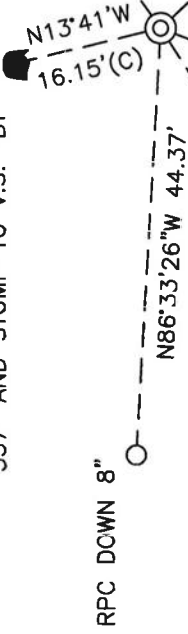

RPC DOWN 8"

C.S.B.T.
38" D. FIR
ROTTEN STUMP
OPENED TO V.S. "BT"

11" D. FIR
BLAZED AND SCRIBED
"1/4 S33 BT"

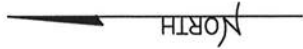

1" = 20'

BASIS OF BEARINGS
COR. REST. BOOK 1, PAGE 210

**±40 YEAR OLD MIXED
FIR AND HARDWOODS**

MONUMENT DETAIL

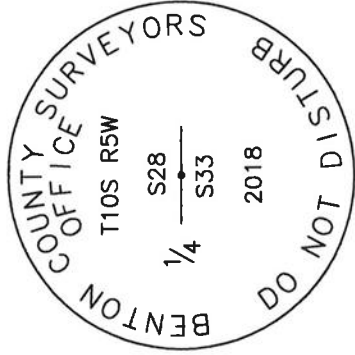

3-1/4" BRASS DISK

LEGEND

- SET 5/8" X 30" REBAR WITH PLASTIC CAP
- YPC YELLOW PLASTIC CAP MARKED "BENTON COUNTY SURVEYOR"
- RPC RED PLASTIC CAP MARKED "BENTON COUNTY SURVEYOR"
- (C) MEASUREMENT TO CENTER
- ⊙ GOVERNMENT MONUMENT SET AS SHOWN
- V.S. VISIBLE SCRIBING
- C.S.B.T. COUNTY SURVEYOR'S BEARING TREE
- ☐ BEARING TREE STUMP AS NOTED
- ☐ BEARING TREE AS NOTED

NEW ACCESSORIES:

1. SET REBAR (SEE LEGEND) N86°33'26"W, 44.37 FEET AND 8 INCHES BELOW GROUND LEVEL.
2. SET REBAR (SEE LEGEND) S21°49'04"W, 63.04 FEET AND 5 INCHES BELOW GROUND LEVEL.
3. D. FIR 11" DIA BEARS S42°31'E, 32.05 FEET TO CENTER, FACE SCRIBED "1/4 S33 BT". SET ALUMINUM NAIL AND PLASTIC WASHER ON SOUTHWESTERLY BASE FOR DISTANCE MEASUREMENT.
4. D. FIR 6" DIA BEARS N54°10'E, 49.82 FEET TO CENTER, FACE SCRIBED "1/4 S28 BT". SET ALUMINUM NAIL AND PLASTIC WASHER ON NORTHWESTERLY BASE FOR DISTANCE MEASUREMENT.

NOTES:

COMPASS DECLINATION IS 15' EAST. ALL MEASURED DISTANCES AND BEARINGS ARE TO THE CENTER OF THE OBJECT, UNLESS OTHERWISE NOTED. ALL BEARING TREES ARE PAINTED AND HAVE A B.T. TAG ATTACHED, FACING THE CORNER UNLESS OTHERWISE NOTED. ALL NEW BEARING TREES HAVE A PLASTIC WASHER (STAMPED "SURVEY MARKER DO NOT REMOVE") ATTACHED BY AN ALUMINUM NAIL TO THE SIDE CENTER OF THE TREE FOR DISTANCE MEASUREMENT, UNLESS OTHERWISE NOTED.

THIS RESTORATION WAS PERFORMED AT THE DIRECTION AND APPROVAL OF
THE BENTON COUNTY SURVEYOR *[Signature]*

REGISTERED
PROFESSIONAL
LAND SURVEYOR

2/23/18 David L. Malone

FIRM/AGENCY: BENTON COUNTY SURVEYOR'S OFFICE
ADDRESS: 360 S.W. AVERY AVE., CORVALLIS, OR 97333; PH. 541-766-6821
PRESENT: DAVID L. MALONE, P.L.S., BERNARD ALTENBACH, SURVEY TECH.,
AND DAN FAAS, SURVEY TECH.

OREGON
JANUARY 12, 1999
DAVID L. MALONE
51523

EQUIPMENT: NIKON NIV03.C WITH SURVEY PRO ONBOARD.

RENEWAL DATE: 12/31/18

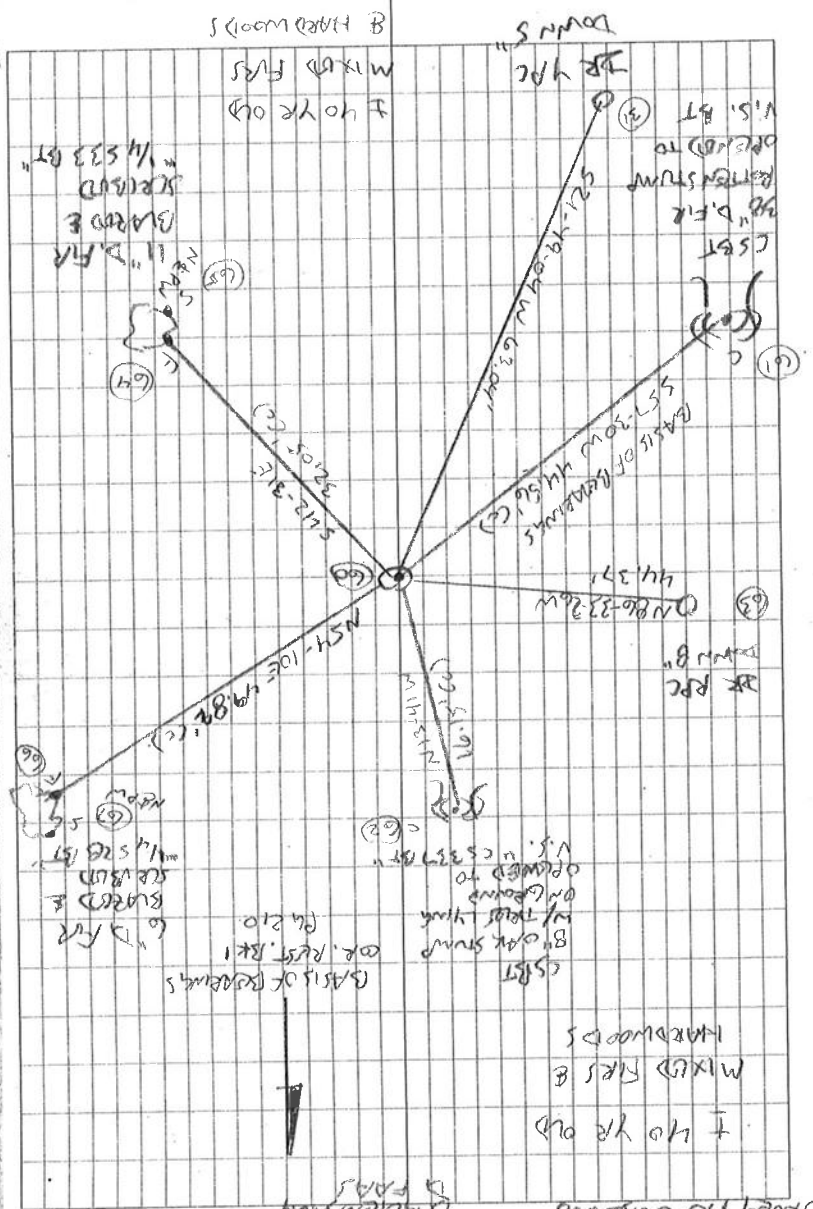

31/60

2/12/18

LOD CLEAR

D. MCKONE
B. MCKONE
D. FAS

WILSON MCKONE
SUNSET PRO OVERSEER

F 40 YR OLD
MIXED FIRS B
HARDWOODS

CST STUMP
BASIS OF BENCHMARKS
OR. REST. BK1
Pa 210

60
59
58
57
56
55
54
53
52
51
50
49
48
47
46
45
44
43
42
41
40
39
38
37
36
35
34
33
32
31
30
29
28
27
26
25
24
23
22
21
20
19
18
17
16
15
14
13
12
11
10
9
8
7
6
5
4
3
2
1

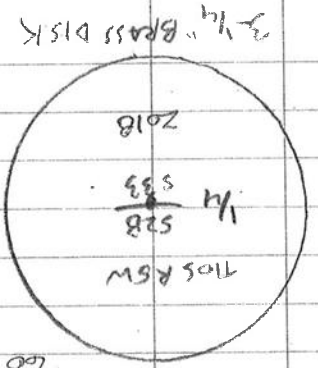

#60

105340200

REMOVEMENT THOS RSW 1/4 33

FD 30" FOOD AXLE, FIRMLY SET & UNDISTURBED,

UP 4" ABOVE GROUND, FOR THE CORNER, FD SW

CST STUMP & HEAD FOR BASIS OF BENCHMARKS,

FD NW CST STUMP, AXLE IS BETWEEN TWO

8" MAPLES, GRABED MAPLES, REMOVED AXLE

FROM AREA AND IN SAME HORIZONTAL POSITION

SET 2" x 31-1/2" GIP W/ 3-1/4" BRASS DISK

CEMENTED IN THE TOP, UP 2" ABOVE GROUND

SURFACE, SET 2 YR OLD ACCESSORIES AND

BARRED & SKEWED 2 NEW BENCHMARK TIES;

SET 6" ORANGE CARBONITE "SUNVEY MARKER" POST

1' SOUTH OF BRASS DISK.

BR = 5/8" x 30" BEAN ROD

YPC OR RPC = YELLOW OR RED

PLASTIC CAP MARKED

"GENERAL COUNTY SURVEYOR"

N&P U = NAIL & PLASTIC W/ OTHER

MARKED "SUNVEY MARKER"

DO NOT REMOVE

¼-Corner 28 and 33, Twp. 10 S R 5 W

238

Reestablishment by W. C. Galloway

July 1912

Set stone 6 x 6 x 8" for corner

Oak 4" in diam bears N. 89° E 304.5 lks dist
N. W. and S. E. original trees standing

C.S. #337

by M.C. Galloway C.S.

J.W. Both end

R.J. Stewart

Sept., 1936

"

"

R.J. Stewart

Witness

"

"

"

Sept. 26, 1936

C.S. #337

Sept. 10, 1936

"



"

CORNER RESTORATION BOOK NO. 1

S.E. Corner of Ephriam Garrison D.L.C. #49 T10S.R5W.

We re-set the orig. Stone 6'x6'x18"

Oak 17" in dia. N.82°5'E. 1.357 std. (Mtd. by F.M.W.)

" 17" " " N.73°E. .190 cor. of stump.

The most West S.W. Cor. of Ephriam Garrison D.L.C. #49 T10-5
Orig. Stone 6'x10'x20"

Corner to Secs. 22, 23, 26 & 27 T.10 S. R. 5 W.

Set 3/4" iron rod in 1 3/4" pipe, All trees out. Set by proportional dist. between
claim corners on claim line.

Mtd. Oak 10" in dia. bears N.89°54'E. 2.422

Stone (C.I. cor.) 8'x10'x15" bears N.89°52'E. 5.031

" " 6'x10'x20" " S. 89°52'W. 11.558

1/4 Sec. Cor. bet. Secs. 22 & 27 T10-5

Set a ^(C.I. cor.) Huck axle 18" long

Oak 24" in dia. bears S. 86°E. 2.01 std.

" 12" " " N.45°36'W. 2.06 "

Mtd. fir 3" " " S. 27° W. .036

1/4 Sec. Cor. bet. Secs. 15 & 22 T10-5

Set a 1" x 40" Oak pipe, from both trees which were down. Also check

Mtd. fir 17" in dia. bears N. 24°E. .150

" 18" " " S. 19 3/4° W. .160

N. 16° 45'E. to N.W. cor. of School House.

1/4 Sec. Cor. bet. Secs. 22 & 23 T10-5

Set a 3/4" x 18" bolt

Oak 10" in dia. N. 81°4'E. 1.08 std.

" 30" " " S. 86 3/4° W. 1.09 "

Mtd. fir 4" " bears N. 48° W. .114

1/4 Sec. Cor. bet. Secs. 28 & 33 T10-5

Set a Ford axle

Oak 8" in dia. bears N. 15° W. 2.30 std. dead checks.

" 10" " " S. 5° E. 2.96 "

Mtd. " 6" " " N. 11 3/4° W. .245

" fir 20" " " S. 57 1/2° W. .072

1/4 Sec. Cor. bet. Secs. 28 & 29 T10-5

Set a Ford axle, found stake.

Maple 8" in dia. bears N. 30° W. .58 chs. both bases open

Bunch of dynamite " S. 60° E. .31 "

Mtd. fir 60" " " S. 84° W. .683 " Nail in N side

$\frac{1}{4}$ -Section corner between sections 28 and 33, Twp. 10-5

29240

Reestablishment by W. C. Galloway

September 10, 1936

Set a Ford axle

Oak 8" in diam bears N 15° W
Oak 10" in diam bears S 5° E
Oak 6" in diam bears N 11 $\frac{1}{4}$ ° W
Fir 20" in diam bears S 57 $\frac{1}{2}$ ° W

2.30 chains
2.96 chains
.245 chains
.672 chains