

105400300

CORNER FILE TRACKING

S:\Survey Corners\CORNERS\Templates\Filetrac2.doc
10/04/2010

CORNER NUMBER
105400300

STEP	HISTORY	RESTORATION
Form Prepared, DB	7/01/13	6/19/15
Field Inspection, DB	3/24/15	3/24/15
Finish index (count unit)	7/01/13	3/24/15
Counter Index	3/24/15	3/24/15
GIS Index Form	6/22/15	6/22/15
Checked, DB	6/23/15	6/23/15
Form Edited, DB	6/23/15	6/23/15
Form Signed, DB	6/23/15	6/23/15
Authorize Payment, DB	—	—
Archive Digital Files	6/23/15	6/23/15
Collect Documents	6/23/15	6/23/15
PDF File	6/23/15	6/23/15
Copy For Filming	6/23/15	6/23/15
Scanned (pdf to laserfiche)	6/23/15	6/23/15
Filmed (Archived), DB		
Filed, DB		

(DB) = Entry needed in database (Access).

COMMENTS:

DATE 07/01/2013

TOWNSHIP 10 SOUTH, RANGE 5 WEST, WILLAMETTE MERIDIAN; SECTION 21 CORNER SOUTHEAST DONATION LAND CLAIM N/A CORNER N/A

COMMON CORNER(S):SOUTHWEST CORNER SECTION 22
NORTHWEST CORNER SECTION 27
NORTHEAST CORNER SECTION 28**RECORDS (INFORMATION IN BOLD ITALICS IS COUNTY STAFFS' INTERPRETATION OF THE RECORD)**

BASED ON EXTENSIVE RESEARCH AND RECOVERY OF EVIDENCE, THIS OFFICE HAS DETERMINED THAT MOST GENERAL LAND OFFICE SURVEYORS IN BENTON COUNTY MEASURED TO THE FACE OF BEARING TREES.

- [01] GENERAL LAND OFFICE (GLO) NOTES BY ROBERT ELDER, D.S., DATED MARCH 10, 1853. SET POST FROM WHICH A FIR 13" DIA BEARS S19°W, 27 LINKS (17.82 FEET); A FIR 20" DIA BEARS N18-1/2°W, 107 LINKS (70.62 FEET); A CHERRY 12" DIA BEARS S50°E, 80 LINKS (52.80 FEET); A CHERRY 8" DIA BEARS N77-1/2°E, 63 LINKS (41.58 FEET).
- [02] GENERAL LAND OFFICE NOTES BY GEORGE MERCER, D.S., DATED MAY 13, 1882. STAKE AND TREES STILL STANDING BUT SO MUCH DECAYED THAT I DEEMED IT BEST TO REESTABLISH CORNER. SET POST 4 FEET LONG AND 4 INCHES SQUARE FOR CORNER MARKED "T10S SEC 22" ON NORTHEAST FACE, "R5W S27" ON SOUTHEAST FACE, "S28" ON SOUTHWEST FACE, AND "S21" ON NORTHWEST FACE WITH 2 NOTCHES ON SOUTH EDGE AND 3 NOTCHES ON EAST EDGE, FROM WHICH A WILLOW 10" DIA BEARS N50°E, 50 LINKS (33.00 FEET) MARKED "T10S R5W S22 BT"; A MAPLE 6" DIA BEARS S60°E, 18 LINKS (11.88 FEET) MARKED "T10S R5W S27 BT"; A MAPLE 6" DIA BEARS S55°W, 20 LINKS (13.20 FEET) MARKED "T10S R5W S28 BT"; AND A WILLOW 8" DIA BEARS N22°W, 28 LINKS (18.48 FEET) MARKED "T10S R5W S21 BT".
- [03] BENTON COUNTY SURVEY NO. 436 (OLD NO. 187) FIELD NOTES (FIELD BOOK 16, PAGE 43) BY W. C. GALLOWAY, C.S., DATED APRIL 9, 1914. SET 3/4" GALVANIZED PIPE, ORIGINAL CORNER. MAPLE 14" DIA BEARS N69°E, 0.100 CHAINS (6.60 FEET); HOLLOW MAPLE 16" DIA BEARS S54°E, 0.161 CHAINS (10.63 FEET); MAPLE 6" DIA BEARS S51°W, 0.19 CHAINS (12.54 FEET) STANDING; ASH 9" DIA BEARS N77°30'W, 0.170 CHAINS (11.22 FEET); WILLOW NORTHWEST.
- [04] BENTON COUNTY CORNER RESTORATION BOOK NO. 1, PAGE 81, BY W. C. GALLOWAY, C.S., DATED APRIL 25, 1914. SET 3/4" PIPE, ORIGINAL CORNER, WILLOW NORTHWEST DOWN. MAPLE 14" DIA BEARS N69°E, 0.100 CHAINS (6.60 FEET); HOLLOW MAPLE 16" DIA BEARS S54°E, 0.161 CHAINS (10.63 FEET); MAPLE 6" DIA BEARS S51°W, 0.19 CHAINS (12.54 FEET) STANDING; ASH 9" DIA BEARS N77°30'W, 0.170 CHAINS (11.22 FEET).
- [05] BENTON COUNTY CORNER RESTORATION NO. 220. TRANSCRIBED FROM RECORD [04] AND MAY CONTAIN ERRORS/OMISSIONS.
- [06] BENTON COUNTY SURVEY NO. 1291 (OLD NO. 337) FIELD NOTES (FIELD BOOK 58, PAGE 17) BY W. C. GALLOWAY, C.S., DATED SEPTEMBER 4, 1936. CORNER NOT DESCRIBED.
- [07] BENTON COUNTY SURVEY NO. 436 (OLD NO. 337) MAP BY W. C. GALLOWAY, C.S., DATED DECEMBER 22, 1936. 3/4" PIPE. MAPLE 14" DIA BEARS N69°E, 0.10 CHAINS (6.60 FEET); MAPLE 16" DIA BEARS S54°E, 0.161 CHAINS (10.63 FEET); MAPLE 6" DIA BEARS S51°W, 0.19 CHAINS (12.54 FEET); ASH 9" DIA BEARS N77-1/2°W, 0.170 CHAINS (11.22 FEET).
- [08] BENTON COUNTY MAP NO. 10-5-00007 BY W. C. GALLOWAY, C.S., DATED DECEMBER 22, 1936. 3/4" PIPE. MAPLE 14" DIA BEARS N69°E, 0.10 CHAINS (6.60 FEET); MAPLE 16" DIA BEARS S54°E, 0.161 CHAINS (10.63 FEET); MAPLE 6" DIA BEARS S51°W, 0.19 CHAINS (12.54 FEET); ASH 9" DIA BEARS N77-1/2°W, 0.170 CHAINS (11.22 FEET).
- [09] BENTON COUNTY SURVEY NO. 1528 (OLD NO. 337) FIELD NOTES (FIELD BOOK 58, PAGE 67) BY BURTT WILKES, DATED JUNE 27, 1941. PIPE.
- [10] LETTER FROM MARVIN L. ROWLEY, P.E., DATED JANUARY 31, 1968, WITH CORNER RESTORATION NOTES BY RONALD A. BRANDT, E.I.T., DATED JANUARY 9, 1968. FOUND 3/4" PIPE. MAPLE 16" DIA BEARS N69°E, 0.100 CHAINS (6.60 FEET); HOLLOW MAPLE 20" DIA BEARS S54°E, 0.161 CHAINS (10.63 FEET); MAPLE 10" DIA BEARS S57°W, 0.171 CHAINS (11.29 FEET); ASH WAS GONE. REPLACED PIPE WITH 3/4" PIPE AND BRASS CAP MARKED "DUNN S21 S22 S27 S28 FOREST" WITH A WHITE CEDAR POST 24" ABOVE GROUND PLACED NEXT TO BRASS CAP.
- [11] BENTON COUNTY CORNER RESTORATION NO. 223 BY CURTIS J. LIESENFELT, P.L.S., DATED JUNE 28, 1990. TRANSCRIBED FROM RECORD [10] AND MAY CONTAIN ERRORS AND/OR OMISSIONS.
- [12] BENTON COUNTY CORNER RESTORATION NO. 3638 BY DANNA L. INGRAM-FEHRENBACHER, C.S., DATED JULY 31, 1989. FOUND A 2-3/4" BRASS CAP MARKED "DUNN S21 S22 S27 S28 FOREST" WITH A WHITE 4" X 3" CEDAR POST 0.5 FEET EASTERLY. A MAPLE 20" DIA BEARS N69°E, 6.60 FEET WITH A HEALED FACE. SET A P.K. NAIL AND A BENTON COUNTY BRASS WASHER (BCBW) IN THE NORTHWESTERLY BASE. A HOLLOW MAPLE 27" DIA BEARS S47°E, 11.05 FEET, TREE IN POOR CONDITION ALMOST DEAD. A MAPLE 17" DIA BEARS S54°W, 12.54 FEET WITH A HEALED FACE. SET A P.K. NAIL AND A BCBW IN THE SOUTHEASTERLY BASE. A FIR 10" DIA BEARS N42°W, 13.34 FEET, FACED AND SCRIBED "T10S R5W S21 BT". SET A P.K. NAIL AND A BCBW IN THE SOUTHWESTERLY BASE. A FIR 11" DIA BEARS S15°E, 16.76 FEET, FACED AND SCRIBED "T10S R5W S27 BT". SET A P.K. NAIL AND A BCBW IN THE SOUTHWESTERLY BASE.
- [13] OREGON STATE UNIVERSITY RESEARCH FORESTS CORNER CONDITION REPORT BY PATRICK M. GAYLORD, DATED AUGUST 28, 1991. FOUND 2-1/2" BRASS CAP MARKED "DUNN S21 S22 S27 S28 FOREST" WITH WHITE PVC STAKE, WHITE OAK POST AND ORANGE CARSONITE POST ALONGSIDE. 21" MAPLE BEARS N69°E, 6.0 FEET WITH HEALED FACE. 11" GRAND FIR BEARS S15°E, 16.76 FEET WITH VISIBLE SCRIBING "10S R5W S27 BT". 18" MAPLE BEARS S54°W, 12.54 FEET WITH OPEN FACE BUT NO VISIBLE SCRIBING. 11" GRAND FIR BEARS N42°W, 13.34 FEET WITH VISIBLE SCRIBING "10S R5W S21 BI". TREES HAVE BT TAG DATED 7/31/89 POSTED BY LS 1995.

DATE 07/01/2013

[14] OREGON STATE UNIVERSITY RESEARCH FORESTS CORNER CONDITION REPORT BY CHARLES E. MCMURRY, DATED AUGUST 23, 1993. **FOUND 3/4" IRON PIPE WITH BRASS CAP. 4 BEARING TREES IN GOOD CONDITION: MAPLE 18" DIA BEARS N69°E, 6.0 FEET; D. FIR 12" DIA BEARS N42°W, 13.34 FEET; MAPLE 18" DIA BEARS S54°W, 12.54 FEET; D. FIR 12" DIA BEARS S15°E, 16.76 FEET.**

[15] BENTON COUNTY SURVEY NO. 9936 BY JIM S. PETERSON, P.L.S., DATED JANUARY 5, 1999. **FOUND OSU BRASS CAP. FOUND A MAPLE 24" DIA BEARS N69°E, 6.60 FEET WITH A HEALED FACE; A MAPLE 27" DIA BEARS S47°E, 11.05 FEET WITH A HOLLOW CENTER; A MAPLE 20" DIA BEARS S54°W, 12.54 FEET WITH A HEALED FACE; A W. FIR 12" DIA BEARS N42°W, 13.34 FEET WITH A HEALED FACE; AND A W. FIR 12" DIA BEARS S15°E, 16.76 FEET WITH A HEALED FACE.**

FIRM/AGENCY: BENTON COUNTY SURVEYOR'S OFFICE
ADDRESS: 360 S.W. AVERY AVE., CORVALLIS OR 97333; PH. 766-6821
RESEARCH BY: DAVID L. MALONE, P.L.S.
DATA ENTRY BY: SAME

**BENTON COUNTY CORNER RESTORATION FORM, PAGE 1 OF 3, 105400300R4
SEE CORNER HISTORY FORM FOR RECORDS ETC.**

CORNER RESTORATION FIELD BOOK NUMBER 30 PAGE(S) 36

DATE 03/24/2015

TOWNSHIP 10 SOUTH, RANGE 5 WEST, WILLAMETTE MERIDIAN; SECTION 21 CORNER SOUTHEAST

DONATION LAND CLAIM N/A CORNER N/A

CONDITION REPORT ; REFERENCED OUT X ; RENEWED ; SURVEYED IN

LOCATION AND COMMENTS:

CORNER IS LOCATED ON A SOUTH FACING SLOPE IN A CREEK DRAW ABOUT 30 FEET WEST OF A CREEK IN AN AREA OF MIXED HARDWOODS AND CONIFERS. TO REACH CORNER FROM THE INTERSECTION OF TAMPICO ROAD AND DUNN FOREST ROAD 300, TRAVEL THROUGH GATE AND FOLLOW ROAD 300 FOR 0.35 MILES TO WYE AT ROAD 320, STAY LEFT ON ROAD 300 FOR 0.98 MILES TO WYE AT ROAD 420, STAY RIGHT ON ROAD 300 FOR 0.27 MILES TO WYE AT ROAD 360, STAY LEFT ON ROAD 300 FOR 0.19 MILES TO WYE AT ROAD 380, STAY LEFT ON ROAD 300 FOR 0.43 MILES TO WYE AT ROAD 114, STAY LEFT ON ROAD 300 FOR 0.07 MILES TO WYE AT ROAD 400, TAKE LEFT ON ROAD 400 FOR 0.12 MILES TO WYE AT ROAD 490, STAY LEFT ON ROAD 400 FOR 0.33 MILES TO ROCK QUARRY ACCESS ROAD, STAY LEFT ON ROAD 400 FOR 0.18 MILES TO WYE AT ROAD 470X, STAY LEFT ON ROAD 400 FOR 0.06 MILES AND PARK. WALK WEST ABOUT 250 FEET, CROSSING THE CREEK, TO THE CORNER. CORNER IS BAD FOR PREMARKING AND GPS CONTROL.

MONUMENTS AND ACCESSORIES FOUND (CONDITION AND SOURCE):

1. FOUND 2-5/8" BRASS CAP ON A 3/4" IRON PIPE, FIRMLY SET, 2" ABOVE GROUND SURFACE FOR THE CORNER. (SET POST PER RECORD [01]).
(SET POST 4 FEET LONG AND 4 INCHES SQUARE FOR CORNER MARKED "T10S SEC 22" ON NORTHEAST FACE, "R5W S27" ON SOUTHEAST FACE, "S28" ON SOUTHWEST FACE, AND "S21" ON NORTHWEST FACE WITH 2 NOTCHES ON SOUTH EDGE AND 3 NOTCHES ON EAST EDGE PER RECORD [02]).
(SET 3/4" GALVANIZED PIPE, ORIGINAL CORNER PER RECORD [03]).
(SET 3/4" PIPE, ORIGINAL CORNER PER RECORD [04]).
(3/4" PIPE PER RECORDS [07] AND [08]).
(PIPE PER RECORD [09]).
(FOUND 3/4" PIPE. REPLACED PIPE WITH 3/4" PIPE AND BRASS CAP MARKED "DUNN S21 S22 S27 S28 FOREST" WITH A WHITE CEDAR POST 24" ABOVE GROUND PLACED NEXT TO BRASS CAP PER RECORD [10]).
(FOUND A 2-3/4" BRASS CAP MARKED "DUNN S21 S22 S27 S28 FOREST" WITH A WHITE 4" X 3" CEDAR POST 0.5 FEET EASTERLY PER RECORD [12]).
(FOUND 2-1/2" BRASS CAP MARKED "DUNN S21 S22 S27 S28 FOREST" WITH WHITE PVC STAKE, WHITE OAK POST AND ORANGE CARSONITE POST ALONGSIDE PER RECORD [13]).
(FOUND 3/4" IRON PIPE WITH BRASS CAP PER RECORD [14]).
(FOUND OSU BRASS CAP PER RECORD [15]).
2. FOUND GRAND FIR 19" DIA WITH HEALED FACE BEARS N42°00'W, 13.40 FEET TO CENTER. SET ALUMINUM NAIL AND PLASTIC WASHER IN SOUTHWESTERLY BASE FOR DISTANCE MEASUREMENT. BASIS OF BEARINGS FOR THIS RESTORATION.
(FIR 10" DIA BEARS N42°W, 13.34 FEET, FACED AND SCRIBED "T10S R5W S21 BT" PER RECORD [12]).
(GRAND FIR 11" DIA BEARS N42°W, 13.34 FEET WITH VISIBLE SCRIBING "10S R5W S21 BI" PER RECORD [13]).
(D. FIR 12" DIA BEARS N42°W, 13.34 FEET PER RECORD [14]).
(W. FIR 12" DIA BEARS N42°W, 13.34 FEET WITH A HEALED FACE PER RECORD [15]).
3. FOUND MAPLE 19" DIA WITH HEALED FACE BEARS S51°42'W, 12.57 FEET TO CENTER. SET ALUMINUM NAIL AND PLASTIC WASHER IN NORTHWESTERLY BASE FOR DISTANCE MEASUREMENT.
(MAPLE 6" DIA BEARS S55°W, 20 LINKS [13.20 FEET] MARKED "T10S R5W S28 BT" PER RECORD [02]).
(MAPLE 6" DIA BEARS S51°W, 0.19 CHAINS [12.54 FEET] STANDING PER RECORDS [03] AND [04]).
(MAPLE 6" DIA BEARS S51°W, 0.19 CHAINS [12.54 FEET] PER RECORDS [07] AND [08]).
(MAPLE 10" DIA BEARS S57°W, 0.171 CHAINS [11.29 FEET] PER RECORD [10]).
(MAPLE 17" DIA BEARS S54°W, 12.54 FEET WITH A HEALED FACE PER RECORD [12]).
(MAPLE 18" DIA BEARS S54°W, 12.54 FEET WITH OPEN FACE BUT NO VISIBLE SCRIBING PER RECORD [13]).
(MAPLE 18" DIA BEARS S54°W, 12.54 FEET PER RECORD [14]).
(MAPLE 20" DIA BEARS S54°W, 12.54 FEET WITH A HEALED FACE PER RECORD [15]).
4. FOUND GRAND FIR 15" DIA WITH HEALED FACE BEARS S15°30'E, 16.59 FEET TO CENTER. SET ALUMINUM NAIL AND PLASTIC WASHER IN NORTHEASTERLY BASE FOR DISTANCE MEASUREMENT.
(FIR 11" DIA BEARS S15°E, 16.76 FEET, FACED AND SCRIBED "T10S R5W S27 BT" PER RECORD [12]).
(GRAND FIR 11" DIA BEARS S15°E, 16.76 FEET WITH VISIBLE SCRIBING "10S R5W S27 BT" PER RECORD [13]).
(D. FIR 12" DIA BEARS S15°E, 16.76 FEET PER RECORD [14]).
(W. FIR 12" DIA BEARS S15°E, 16.76 FEET WITH A HEALED FACE PER RECORD [15]).
5. FOUND MAPLE 22" DIA WITH HEALED FACE BEARS N70°37'E, 6.59 FEET TO CENTER. SET ALUMINUM NAIL AND PLASTIC WASHER IN NORTHWESTERLY BASE FOR DISTANCE MEASUREMENT.
(MAPLE 14" DIA BEARS N69°E, 0.100 CHAINS [6.60 FEET] PER RECORDS [03] AND [04]).
(MAPLE 14" DIA BEARS N69°E, 0.10 CHAINS [6.60 FEET] PER RECORDS [07] AND [08]).
(MAPLE 16" DIA BEARS N69°E, 0.100 CHAINS [6.60 FEET] PER RECORD [10]).
(MAPLE 20" DIA BEARS N69°E, 6.60 FEET WITH A HEALED FACE PER RECORD [12]).
(MAPLE 21" DIA BEARS N69°E, 6.0 FEET WITH HEALED FACE PER RECORD [13]).
(MAPLE 18" DIA BEARS N69°E, 6.0 FEET PER RECORD [14]).
(MAPLE 24" DIA BEARS N69°E, 6.60 FEET WITH A HEALED FACE PER RECORD [15]).

BENTON COUNTY CORNER RESTORATION FORM, PAGE 2 OF 3, 105400300R4

6. FOUND HOLLOW MAPLE SNAG 28" DIA WITH FACE OF TREE GONE AND NO VISIBLE MARKS BEARS S51°57'E, 10.03 FEET TO CENTER.
(MAPLE 6" DIA BEARS S60°E, 18 LINKS [11.88 FEET] MARKED "T10S R5W S27 BT" PER RECORD [02]).
(HOLLOW MAPLE 16" DIA BEARS S54°E, 0.161 CHAINS [10.63 FEET] PER RECORDS [03] AND [04]).
(MAPLE 16" DIA BEARS S54°E, 0.161 CHAINS [10.63 FEET] PER RECORDS [07] AND [08]).
(HOLLOW MAPLE 20" DIA BEARS S54°E, 0.161 CHAINS [10.63 FEET] PER RECORD [10]).
(HOLLOW MAPLE 27" DIA BEARS S47°E, 11.05 FEET, TREE IN POOR CONDITION ALMOST DEAD PER RECORD [12]).
(MAPLE 27" DIA BEARS S47°E, 11.05 FEET WITH A HOLLOW CENTER PER RECORD [15]).

MONUMENT SET (PROCEDURES AND DESCRIPTION):

FOUND 2-5/8" BRASS CAP, MARKED AS SHOWN ON PAGE 3 OF 3, ON A 3/4" IRON PIPE, FIRMLY SET, 2" ABOVE GROUND SURFACE FOR THE CORNER. THIS PIPE WAS SET BY MARVIN L. ROWLEY IN 1968 TO PERPETUATE THE 3/4" GALVANIZED PIPE SET BY W. C. GALLOWAY, C.S., IN 1914, WHICH WAS SET AS A PERPETUATION OF THE CORNER FROM GLO BEARING TREES. I HELD THE BRASS CAP AS THE PERPETUATION OF THE CORNER POSITION.

SET TWO NEW IRON ROD ACCESSORIES AS SHOWN ON PAGE 3 OF 3. FOUND AN ORANGE CARSONITE "SURVEY MARKER" POST 1.2 FEET SOUTH AND A WHITE FIBERGLASS POST 0.7 FEET WEST OF BRASS CAP.

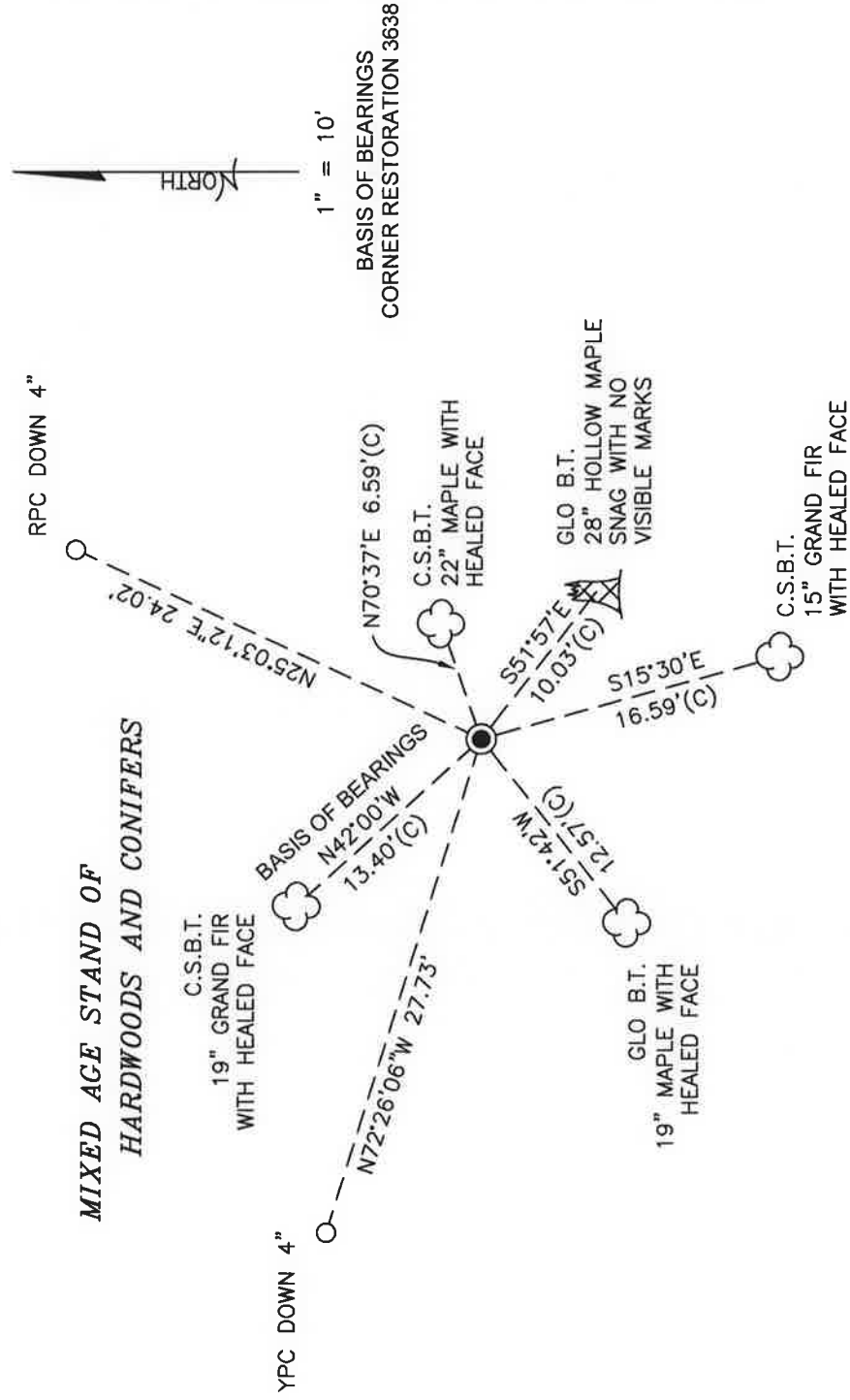

MONUMENT DETAIL

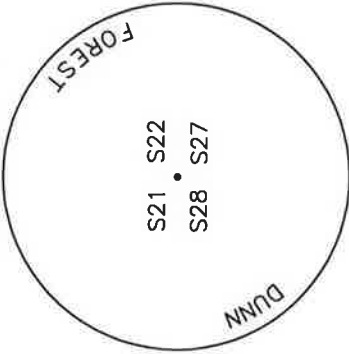

2-5/8" BRASS CAP

LEGEND

- SET 5/8" X 30" REBAR WITH PLASTIC CAP
- YPC YELLOW PLASTIC CAP MARKED "BENTON COUNTY SURVEYOR"
- RPC RED PLASTIC CAP MARKED "BENTON COUNTY SURVEYOR'S OFFICE"
- (C) MEASUREMENT TO CENTER
- GOVERNMENT MONUMENT FOUND AS SHOWN
- C.S.B.T. COUNTY SURVEYOR'S BEARING TREE
- GLO GENERAL LAND OFFICE
- B.T. BEARING TREE
- BEARING TREE AS NOTED
- BEARING TREE SNAG AS NOTED

NEW ACCESSORIES:

1. SET REBAR (SEE LEGEND) N25°03'12"E, 24.02 FEET AND 4 INCHES BELOW GROUND LEVEL.
2. SET REBAR (SEE LEGEND) N72°26'06"W, 27.73 FEET AND 4 INCHES BELOW GROUND LEVEL.

NOTES:

COMPASS DECLINATION IS 16° EAST. ALL MEASURED DISTANCES AND BEARINGS ARE TO THE CENTER OF THE OBJECT, UNLESS OTHERWISE NOTED. ALL BEARING TREES ARE PAINTED AND HAVE A B.T. TAG ATTACHED, FACING THE CORNER UNLESS OTHERWISE NOTED. ALL NEW BEARING TREES HAVE A PLASTIC WASHER (STAMPED "SURVEY MARKER DO NOT REMOVE") ATTACHED BY AN ALUMINUM NAIL TO THE SIDE CENTER OF THE TREE FOR DISTANCE MEASUREMENT, UNLESS OTHERWISE NOTED.

THIS RESTORATION WAS PERFORMED AT THE DIRECTION AND APPROVAL OF THE BENTON COUNTY SURVEYOR *gen*

REGISTERED PROFESSIONAL LAND SURVEYOR

6/23/15 David L. Malone

OREGON
JANUARY 12, 1999
DAVID L. MALONE
51523

FIRM/AGENCY: BENTON COUNTY SURVEYOR'S OFFICE
ADDRESS: 360 S.W. AVERY AVE., CORVALLIS, OR 97333; PH. 541-766-6821
PRESENT: DAVID L. MALONE, P.L.S. AND BERNARD ALTENBACH, SURVEY TECH.
EQUIPMENT: NIKON NIV03.C WITH SURVEY PRO ONBOARD.

RENEWAL DATE: 12/31/16

COOL, OVERCAST
 3/24/2015
 D. MARSH
 B. METSMA/CH
 30/36

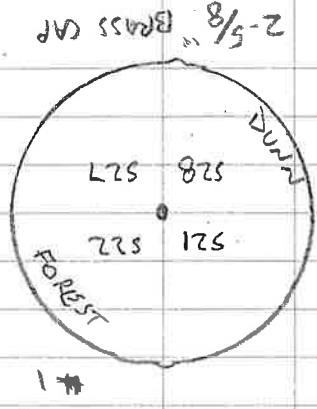
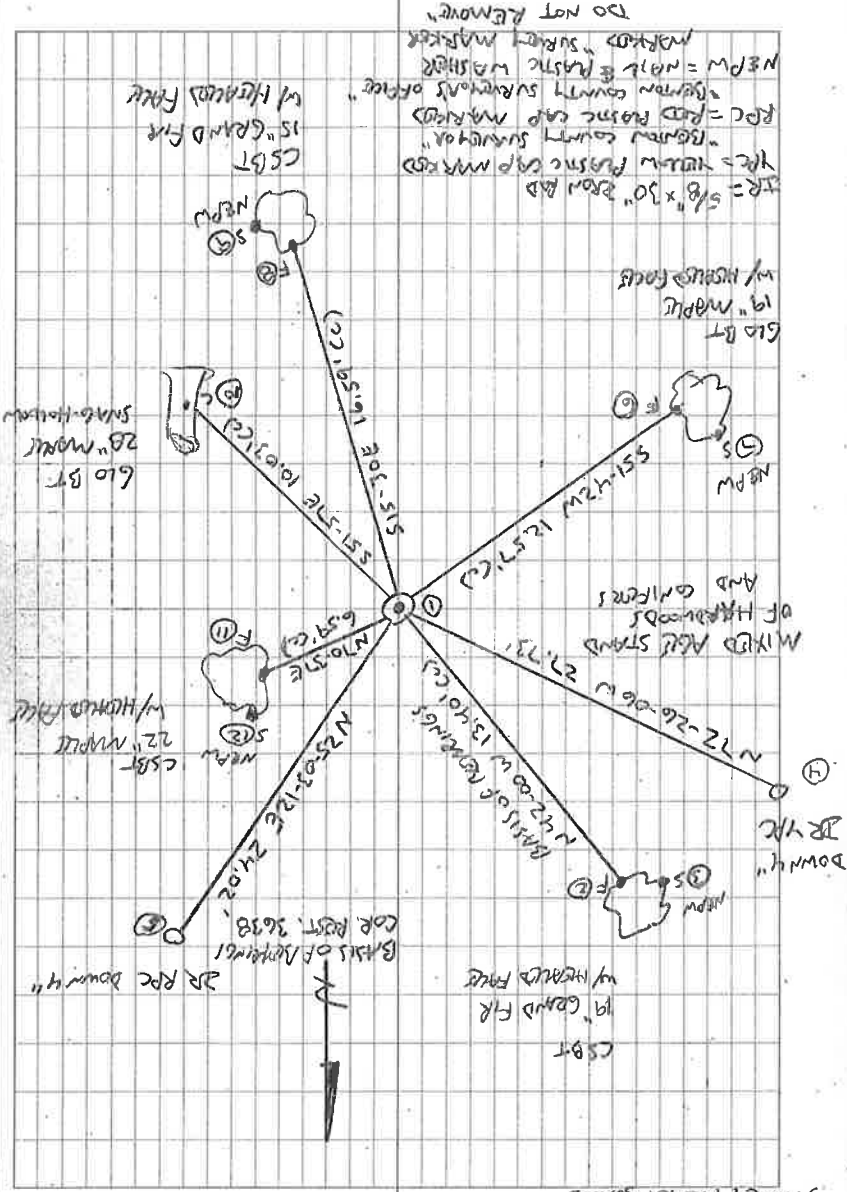

FD 2-5/8" BRASS CAP ON 3/4" BRON PIPE, FINALLY SET,
 2" ABOVE GROUND SURFACE, FOR THE CORNER, DRABBLE
 CARSONITE "SURVEY MARKER" POST 1.2' SOUTH AND
 WHITE FIBERGLASS POST 0.7' WEST. FD SW 1882
 610 BT AND SE 1882 610 BT, NE 1914 CSBT, NW E.
 SE 1989 CSBT, SET 2 NEW 1/2" ROD ACCESSORIES.
 HAD NW 1989 CSBT FOR BASIS OF REGRANGES.
 CORNER IS ABOUT 30' WEST OF A CORNER.

105400300
 REFERENCE T105 RSW
 21.22
 28.27

OREGON STATE UNIVERSITY
RESEARCH FORESTS CORNER CONDITION REPORT

Section 27 Township 10S Range 56W
County BENTON Date AUG 28, 1991

CORNER DESIGNATION

NORTH WEST SECTION CORNER

REFERENCES

CR 3638

MONUMENT(S) & ACCESSORIES FOUND: (CONDITION)

2 1/2" BRASS CAP WITH WHITE PVC STAKE, WHITE OAK POST AND CARBONITE POST ALONGSIDE
21" MAPLE WITH HEALED FACE & BT TAG DATED 7/31/89
11" GRAND FIR, U.S. " 10SR5WS27 BT "
18" MAPLE, OPEN FACE BUT NO VISIBLE SCRIBING
11" GRAND FIR, U.S. " 110SR5WS21 BT "
ORANGE
" ALSO HAS STARKER LOCATION
" POSTER & PROPERTY SIGN.

Monument Detail

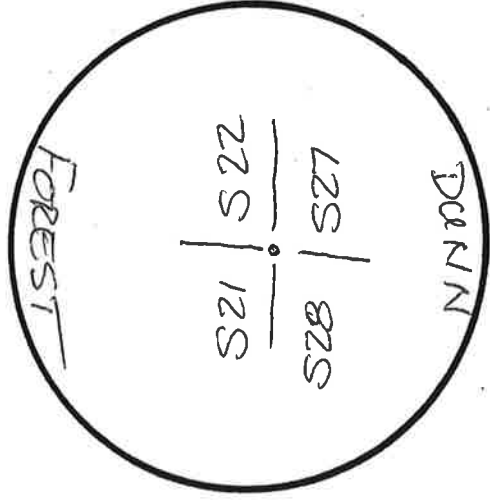

Sketch

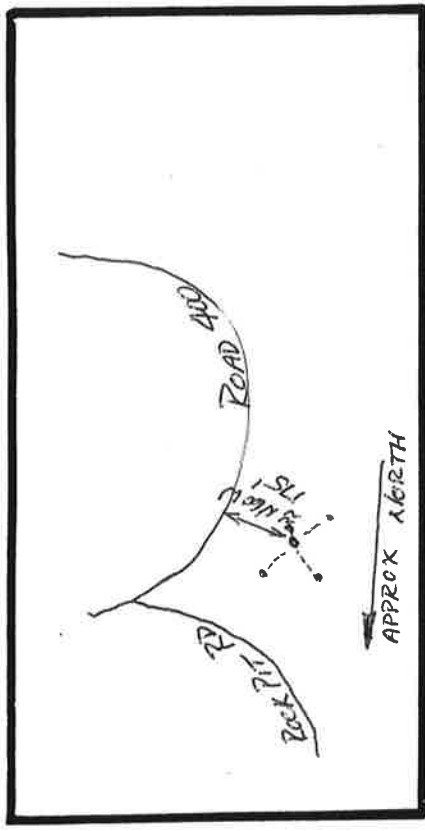

ACCESSORY DESCRIPTION (ALL BEARINGS FROM ACCESSORIES TO MONUMENTS)

21" MAPLE S 69° W, 6°
11" G.F. N 15° W, 16 7/8
18" MAPLE N 54° E, 12 5/4
11" G.F. S 42° E, 13 3/4
ALL TAGS POSTED BY LS 1995

LOCATIONS & COMMENTS

FOLLOW THE 400 RD FROM TAMMICO RD TO THE ROCK PIT RD. FROM
THE ROCK PIT ROAD GO BACK TO THE START OF THE TURN ON THE
400 RD. THEN GO NORTH 60° WEST ABOUT 175 FT TO THE
CORNER.

SIGNATURE

RESEARCH FORESTS CORNER CONDITION REPORT

Section 21 Township 10S Range 5W
County Benton Date 8/23/93

CORNER DESIGNATION

21 / 22
20 / 27

Previous Renewals/Surveys, etc.

Monument(s) & Accessories Found: (Condition and Source) £
3/4" IRON PIPE WITH BRASS CAP

- 4 BEARING TREES IN GOOD CONDITION:
(ALL BEARINGS FROM ACCESSORY TO MONUMENT)
- 1) 18" MAPLE S 69° W 6.0'
 - 2) 18" DOUGLAS-FIR S 42° E 13.34'

Monument Detail

Sketch

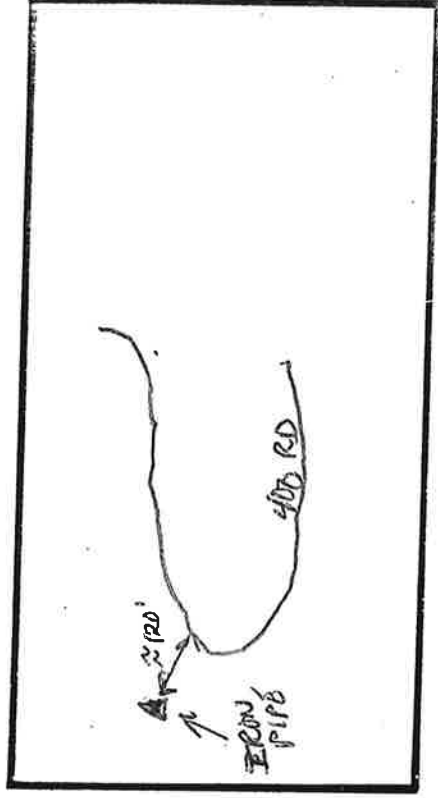
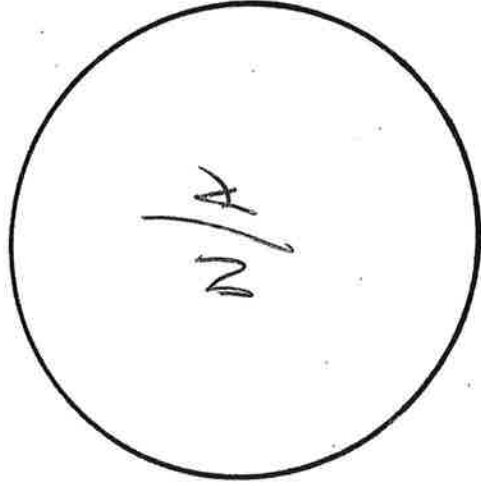

MONUMENT AND ACCESSORY CONDITION

- 3) 18" MAPLE N 54° E 12.54'
- 4) 18" DOUGLAS-FIR N 15° W 16.76'

Location & Comments

Compass Declination 20° E

Charles E. Perry

BENTON COUNTY CORNER RESTORATION FORM

3638

105400300
CORNER NE

SECTION 28 TOWNSHIP 10 S RANGE 5 W DLC. DATE 7/31/89 CORNER RESTORATION FIELD BOOK NUMBER 5 PAGE 5

CORNER DESIGNATION:

CONDITION REPORT ONLY
REFERENCED OUT
XX RENEWED
SURVEYED IN



THE NORTHEAST CORNER OF SECTION 28,
T 10 S R 5 W, WILLAMETTE MERIDIAN.

LOCATION AND COMMENTS:

THE CORNER IS LOCATED ON A SOUTHEASTERLY SLOPING, WOODED HILLSIDE APPROXIMATELY 150 FEET NORTHERLY OF THE NORTHEAST CORNER OF A CLEAR CUT, 6 FEET WESTERLY OF A DOWN WIRE FENCE AND 30 FEET WESTERLY OF A SMALL CREEK.

PREVIOUS RENEWALS/SURVEYS, ETC.:

G.L.O. SURVEY BY G. MERCER IN 1882.
CORNER RESTORATION NO. 220 BY W. C. GALLOWAY IN 1914.
CORNER RESTORATION NO. 223 BY M. ROWLEY IN 1968.

MONUMENTS AND ACCESSORIES FOUND (CONDITION AND SOURCE):

- FOUND: A 2 3/4" DUNN FOREST BRASS CAP MONUMENT, STAMPED AS SHOWN, FOR THE CORNER, (CORNER RESTORATION NO. 223).
 - FOUND: A WHITE 4" X 3" CEDAR POST 0.5 FOOT EASTERLY (CORNER RESTORATION NO. 223).
 - FOUND: A MAPLE 20" IN DIAMETER WITH A HEALED FACE, BEARS N 69° E 6.60 FEET (N 69° E 6.60 FEET, CORNER RESTORATION NO. 220). SET A P.K. NAIL AND A B.C.B.W. IN THE NORTH-WESTERLY FACE. SET A B.T. TAG ON THE SOUTHWESTERLY FACE.
 - FOUND: A HOLLOW MAPLE 27" IN DIAMETER BEARS S 47° E 11.05 FEET (S 54° E 10.63 FEET, CORNER RESTORATION NO. 220). THE TREE IS IN POOR CONDITION, ALMOST DEAD. DID NOT SET A B.C.B.W. OR B.T. TAG.
 - FOUND: A MAPLE 17" IN DIAMETER WITH A HEALED FACE, BEARS S 54° W 12.54 FEET (S 51° W 12.54 FEET, CORNER RESTORATION NO. 220). THE TREE HAS A LOCATION POSTER MARKED "NE 1/4 S51°W 12 1/2 SEC 28 T10S R5W MPZ". THE TREE HAS A STARKER FOREST BOUNDARY NOTICE TAG. SET A P.K. NAIL AND A B.C.B.W. IN THE SOUTHEASTERLY BASE. SET A B.T. TAG ON THE NORTHEASTERLY FACE.
- NO OTHER RECORD BEARING OBJECTS WERE RECOVERED.

MONUMENT DETAIL

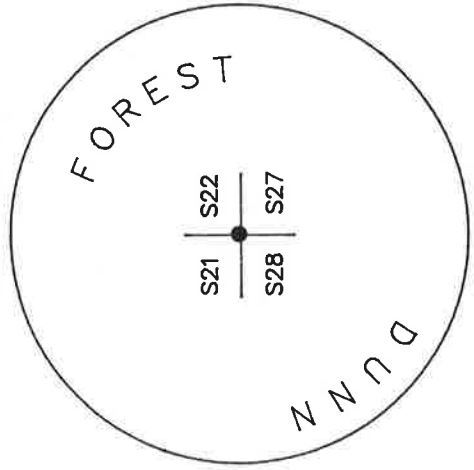

SKETCH

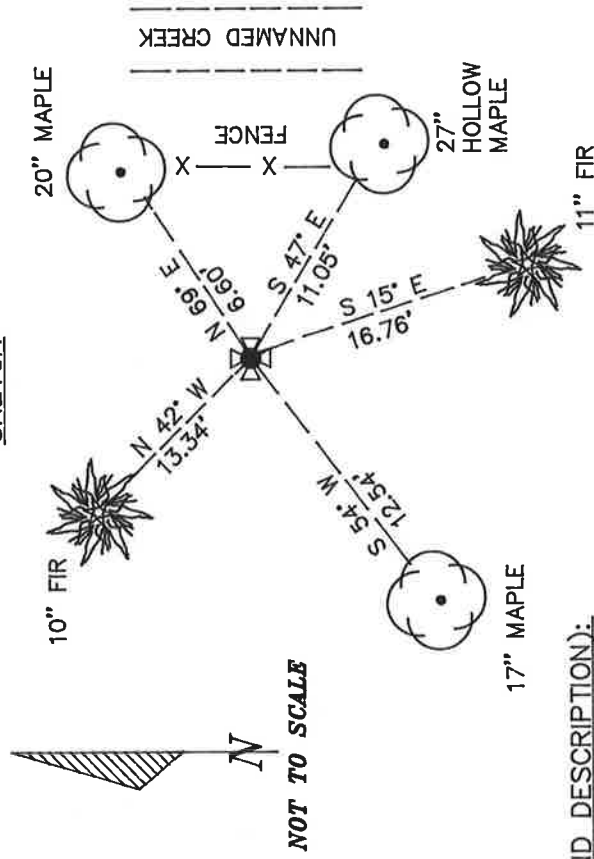

2 3/4" BRASS CAP

MONUMENT SET (PROCEDURES AND DESCRIPTION):

FOUND 2 3/4" DUNN FOREST BRASS CAP MONUMENT USED FOR THE CORNER.

NEW ACCESSORIES :

- A FIR 10" IN DIAMETER BEARS N 42° W 13.34 FEET. FACED AND SCRIBED "T10S R5W S21 BT". SET A P.K. NAIL AND A B.C.B.W. IN THE SOUTHWESTERLY BASE. SET A B.T. TAG ON THE SOUTH-EASTERLY FACE. HAS AN ORANGE PLASTIC O.S.U. PROPERTY BOUNDARY TAG.
- A FIR 11" IN DIAMETER BEARS S 15° E 16.76 FEET. FACED AND SCRIBED "T10S R5W S27 BT". SET A P.K. NAIL AND A B.C.B.W. IN THE SOUTHWESTERLY BASE. SET A B.T. TAG ON THE NORTHWESTERLY FACE. THE TREE HAS AN ORANGE PLASTIC O.S.U. PROPERTY BOUNDARY TAG.
- SET: AN ORANGE CARSONITE "SURVEY MARKER" POST 1 FOOT SOUTHERLY.

NOTES:

B.C.B.W. IS A BRASS WASHER STAMPED "BENTON COUNTY SURVEYOR". COM-PASS DECLINATION IS 20° EAST. ALL MEASURED DISTANCES AND COMPASS BEARINGS ARE TO THE CENTER OF THE OBJECT, UNLESS OTHERWISE NOTED.

REGISTERED
PROFESSIONAL
LAND SURVEYOR

Danna L. Ingram-Fehrenbacher

FIRM/AGENCY: BENTON COUNTY PUBLIC WORKS

ADDRESS: 360 S.W. AVERY AVE. CORVALLIS OR. 97333; PH. 757-6821

PARTY CHIEF: CURTIS J. LISENFELT

CREW: MARY BARRON

WITNESS:

OREGON
JULY 16, 1982
DANNA L. INGRAM-FEIRENBACHER
1995

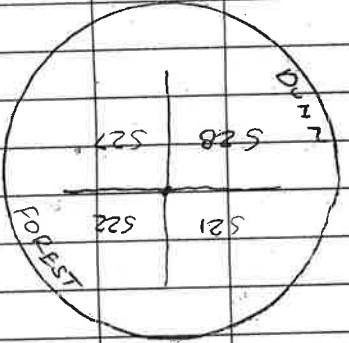

SET AN ORANGE CHESNUTE "SURVEY MARKER" POST 1 1/2" DIA.
 THE COP IS LOCATED ON A SE 1/4 SLIP IN WOODED HILLSIDE
 150' ± N 1/4 OF NE COR. OF A CLEARCUT 8' W 1/4 OF BR
 DOWN WITH FENCE + 30' W 1/4 OF A SMALL C&K IT
 WOULD BE POOR FOR PREMIXING + GPS CONTROL

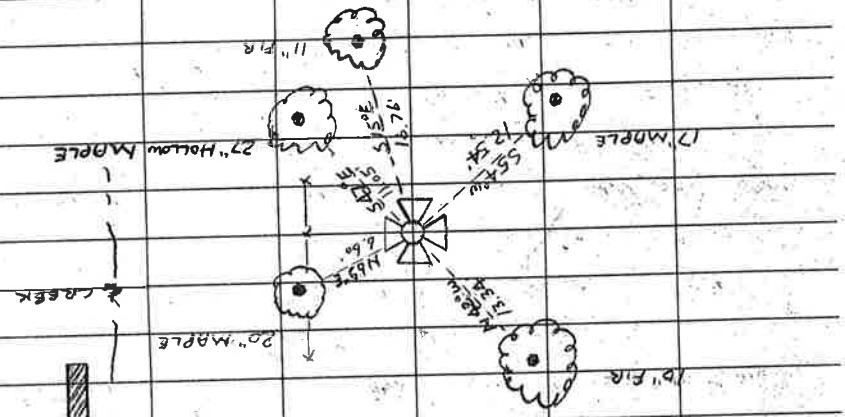

7/31/89. CALN M.B.D. Silver Camp. 20° E. DEC. 5 HRS. WARM

T105 R5W Sec 28 N.E. COR.

FND: 2 3/4" DURN FOREST B.F. MON. STAMPED AS SHOWN

FOR THE COP (COR REST NO. 223)

" A WHITE 4" x 3" POST 0.5' E 1/4 (COR REST NO. 223)

" A MAPLE 20" IN DIA. @ A HEALED FACE BEARS

N 89° E ~ 6.60' (N 89° E ~ 6.60' COR REST. NO. 220)

SET PK + B.C.B.W. IN NW 1/4 BASE SET B.T. TAB ON SW 1/4

" A Hollow MAPLE 27" IN DIA. BEARS 347° E ~ 11.05'

(S 54° E ~ 10.63' COR REST NO. 220) TREE IS IN GDB

SHAPE + ALMOST DEAD. DID NOT SET WASHER OR TAG

" A MAPLE 17" IN DIA. @ A HEALED FACE BEARS

S 54° W ~ 12.54' (S 51° W ~ 12.54' COR REST. NO. 220)

TREE HAS A LOCATION POSTER MADE "NE 1/4 S51W 12 1/2"

SEC. 28 T105 R5W MPZ " TREE ALSO HAS A STRIKER

FOREST BOUNDARY NOTICE TAG. SET A PK + B.C.B.W. IN

SE 1/4 BASE. SET BT TAB ON NE 1/4 FACE.

NO OTHER RECORD BEARING OBJECTS WERE RECOVERED

A FIR 10" IN DIA BEARS N42° W ~ 13.34' FACE +

SCRIBED "T105 R5W S21 BT". SET A PK + B.C.B.W. IN

SW 1/4 BASE. SET B.T. TAB ON SE 1/4 FACE

A FIR 1" IN DIA BEARS S 15° E ~ 16.76' FACE +

SCRIBED "T105 R5W S27 BT". SET A PK + B.C.B.W. IN

BASE SET B.T. TAB ON NW 1/4 FACE

NOTE: BOTH THE NEW RR B.T'S HAVE AN ORANGE PLASTIC O.S.V. PROP. BOUNDARY TAG ON THEM

CORNER RESTORATION BOOK NO. 1

- C. Survey # 187
 1/4 sec. cor. between secs. 14 & 15 Tp. 10 S. R. 5 W. W. M.
 Oak 20" in dia. bears S. 56° 30' E. .88 cks. std.
 " 30" " " S 80° 00' W. .38 " "
 Witnesses Jas. C. Smith, R. E. L. Brown, Robinson and Carl Carter Apr. 9, 1914.
- " 187
 Sec. cor. to secs. 15, 16, 21 & 22 Tp. 10-5
 Set 3/4" pipe 4 oaks dead
 Fir 15" in dia. bears N 63° 05' E. .608 cks.
 " 24" " " S 26° 30' E. .495 " "
 " 22" " " N. 73° 50' W. .344 " "
 " 22" " " N. 25° 45' W. .196 " "
 Witness Carl Carter April 25, 1914.
- " 187
 1/4 sec. cor. between secs. 21 & 22 Tp. 10-5.
 Set a 1 1/4" galv. pipe oak down.
 Fir 36" in dia. bears N. 5° E. .170 cks.
 " 14" " " S. 84° 30' W. .36 " std.
 Witnesses Robinson & R. E. L. Brown. October 22, 1914.
- " 187
 Sec. cor. to secs. 21 & 22, 27 & 28 Tp. 10-5.
 3/4" pipe 1 1/2" in dia. bears N. 69° E. .100 cks.
 Maple 14" in dia. bears N. 69° E. .161 " "
 Willow " 16" " " S. 54° E. .19 " std.
 " 6" " " " S. 51° W. .19 " "
 " 9" " " " N. 77° 30' W. .170 " "
 Witness Carl Carter April 25, 1914.
- " 187
 1/4 sec. cor. between secs. 27 & 28 Tp. 10-5.
 Set 1 1/4" galv. pipe from two stumps.
 Oak 4" in dia. bears N. 16° E. 3.546 cks.
 " 2" " " S. 16 1/2° E. October 23, 1914.
 Witness R. E. L. Brown
- " # 188
 N.E. corner of Monroe Hodges D.L.C. # 46, Tp. 10-4
 Set 1 1/4" galv. pipe Two stamps
 Double Ash 22" in dia. bears N. 59° 10' E. 1.199 cks.
 Witnesses Ward Wilkes April 10, 1914.
- " 188
 S.E. corner of Monroe Hodges D.L.C. # 46 Tp. 10-4.
 1 1/4" pipe already set
- Cons. in Polk Co.
 # 189
 N.W. cor. of Croghan Rhodes C.I. # 68 Tp. 10-4.
 1 1/4" pipe Oak 18" in dia. bears N. 89° 47' W. 3.121 cks. one stamp.
 N.E. cor. of Croghan Rhodes C.I. # 68 Tp. 10-4.
 Set 1 3/4" pipe 2 stump holes one stamp.
 S.E. of Amon Ryburn C.I. # 67 Tp. 10-4
 Stone already set trees std.
 N.E. cor. of Amon Ryburn C.I. # 67 Tp. 10-4.
 Stone set.

Section corner to sections 21, 22, 27 and 28, Twp. 10-5

Reestablishment by W. C. Galloway

April 25, 1914

Set $\frac{3}{4}$ " galvanized pipe

Original corner,

Willow N. W. down

Maple 14" in diam bears N 69° E

.100 chains

Hollow Maple 16" in diam bears S 54° E

.161 chains

Maple 6" in diam bears S 51° W

.19 chains (standing)

Ash 9" in diam bears N 77° 30' W

.170 chains

Witness Carl Carter

Rowley & Parker



Tree Farm Service

P.O. BOX 270, PHILOMATH, OREGON 97370

JANUARY 31, 1968

BENTON COUNTY ENGINEER:

THE FOLLOWING WORK HAS BEEN PERFORMED FOR OREGON STATE UNIVERSITY,
SCHOOL OF FORESTRY, IN A PROGRAM TO RENEW ALL EXTERIOR BOUNDARY CORNERS
ON MCDONALD AND DUNN FORESTS.

THE ATTACHED RENEWED CORNER DATA HAS BEEN DONE BY RONALD A. BRANDT,
ENGINEER-IN-TRAINING, UNDER MY DIRECTION AND SUPERVISION.

MARVIN L. ROWLEY



Section Corner 21, 22, 27, and 28

Date : Jan. 9, 1968

found :

3/4" iron pipe

Maple 16" N 69°E .100 d.

(hollow) Maple 20" S 54°E .161

Maple 10" S 57°W .171

Ash was gone.

Replaced pipe with :

3/4" pipe and brass cap

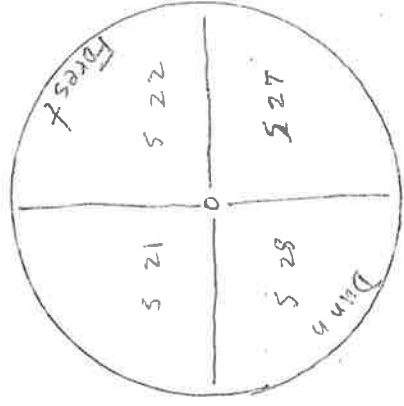

White Cedar post 24" above ground placed
next to brass cap.

BENTON COUNTY SURVEYORS OFFICE - CORNER RESTORATION

223

T. 10 S, R. 5 W, W. B. & M., BENTON COUNTY, OREGON
SECTION 21

REPORTED BY MARVIN L. ROWLEY
TITLE P. E.
DATE JAN 31, 1968

105400300⁹ (CJL 6/28/90)

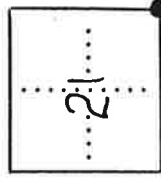

● OFFICIAL CORNER FOUND
○ CORNER SET

SEC. CORNER COMMON TO SEC. 21 22 27 & 28
IS 3/4" iron pipe with brass cap
DESCRIBE

ADDITIONAL INFORMATION
Brass cap is marked as follows

S21	S22
S28	S27 S26x

white cedar post 24" above ground
placed next to brass cap.

OVER

LEGIBLE MARKS ON BEARING OBJECTS

KIND	Maple	Hollow Maple	
SIZE	16"	20"	10"
BEARING	N 69° E	S 54° E	S 57° W
DISTANCE	.100 ch	.161 ch	.171 ch

BT TAG POSTED

Found:

3/4" IRON PIPE AND THE 3 MAPLE B.T.'S AS SHOWN ON THE
FRONT OF THIS CARD
ASH WAS GONE

REPLACED PIPE WITH:

THE MONUMENT AS DESCRIBED ON THE FRONT OF THIS CARD

THIS INFORMATION WAS TAKEN FROM THE T10S R5W FILE IN THE
CORNER RESTORATION CORRESPONDENCE FILE DRAWER (CJL 6/28/90).