

105600200

CORNER FILE TRACKING

S:\Survey Corners\CORNERS\Templates\Filetrac2.doc
10/04/2010

CORNER NUMBER
105600200

STEP	HISTORY	RESTORATION
Form Prepared, DB	8/20/13	2/16/16
Field Inspection, DB	2/02/2016	2/02/16
Finish index (count unit)	8/20/13	2/02/16
Counter Index	2/02/16	2/02/16
GIS Index Form	2/12/16	2/12/16
Checked, DB	2/18/16	2/18/16
Form Edited, DB	3/07/16	3/07/16
Form Signed, DB	3/07/16	3/07/16
Authorize Payment, DB	—	—
Archive Digital Files	03/07/16	3/07/16
Collect Documents	3/07/16	3/07/16
PDF File	3/07/16	3/07/16
Copy For Filming	3/07/16	3/07/16
Scanned (pdf to laserfiche)	3/07/16	3/07/16
Filmed (Archived), DB	3/07/16	3/07/16
Filed, DB		

(DB) = Entry needed in database (Access).

COMMENTS:

DATE 08/28/2013TOWNSHIP 10 SOUTH, RANGE 5 WEST, WILLAMETTE MERIDIAN; SECTION 25 CORNER SOUTHWEST
DONATION LAND CLAIM N/A CORNER N/A**COMMON CORNER(S):**SOUTHEAST CORNER SECTION 26
NORTHEAST CORNER SECTION 35
NORTHWEST CORNER SECTION 36**RECORDS (INFORMATION IN BOLD *ITALICS* IS COUNTY STAFFS' INTERPRETATION OF THE RECORD)**

BASED ON EXTENSIVE RESEARCH AND RECOVERY OF EVIDENCE, THIS OFFICE HAS DETERMINED THAT MOST GENERAL LAND OFFICE SURVEYORS IN BENTON COUNTY MEASURED TO THE FACE OF BEARING TREES.

- [01] GENERAL LAND OFFICE (GLO) NOTES BY ROBERT ELDER, D.S., DATED MARCH 10, 1853. SET POST FROM WHICH A W. OAK 18" DIA BEARS S46°E, 60 LINKS (39.60 FEET); A W. OAK 18" DIA BEARS N24°E, 88 LINKS (58.08 FEET); A W. OAK 24" DIA BEARS N59°W, 143 LINKS (94.38 FEET); A W. OAK 14" DIA BEARS S68-1/4°W, 630 LINKS (415.80 FEET).
- [02] BENTON COUNTY SURVEY NO. 973 (OLD NO. 337) FIELD NOTES (FIELD BOOK 35, PAGE 48) BY WALTER L. LARSEN, D.C.S., DATED JANUARY, 1926. HUB ON COLLEGE SURVEY. STONE 8" X 8" X 12". FIR 20" DIA BEARS N2°E, 0.40 CHAINS (26.40 FEET); FIR 24" DIA BEARS N2°E, 0.40 CHAINS (26.40 FEET); FIR 24" DIA (GLO BT) BEARS S46°E, 0.60 CHAINS (39.60 FEET) STANDING.
- [03] BENTON COUNTY CORNER RESTORATION BOOK NO. 1, PAGE 178 BY WALTER L. LARSEN, D.C.S., NO DATE GIVEN. SET STONE 8" X 8" X 12". FIR 20" DIA (CSBT) BEARS N2°E, 0.40 CHAINS (26.40 FEET); FIR 24" DIA (CSBT) BEARS N56°W, 0.245 CHAINS (16.17 FEET); OAK 20" DIA (GLO BT) BEARS S46°E, 0.60 CHAINS (39.60 FEET) STANDING.
- [04] BENTON COUNTY CORNER RESTORATION NO. 234. TRANSCRIBED FROM RECORD [03] AND MAY CONTAIN ERRORS AND/OR OMISSIONS.
- [05] BENTON COUNTY MAP NO. 10-5-00010, NO DATE OR DRAFTSMAN GIVEN. STONE 8" X 8" X 12". FIR 20" DIA (CSBT) BEARS N2°E, 0.400 CHAINS (26.40 FEET); FIR 24" DIA (CSBT) BEARS N56°W, 0.245 CHAINS (16.17 FEET); OAK 20" DIA (GLO BT) BEARS S46°E, 0.60 CHAINS (39.60 FEET) STANDING.
- [06] BENTON COUNTY SURVEY NO. 9041 TRACED BY W. C. GALLOWAY, C.S., DATED MARCH 30, 1927. STONE 8" X 8" X 12". FIR 20" DIA (CSBT) BEARS N2°E, 0.40 CHAINS (26.40 FEET); FIR 24" DIA (CSBT) BEARS N56°W, 0.245 CHAINS (16.17 FEET); OAK 20" DIA (GLO BT) BEARS S46°E, 0.60 CHAINS (39.60 FEET).
- [07] BENTON COUNTY SURVEY NO. 1966 BY MARTIN L. BEYERLEIN, D.C.S., DATED NOVEMBER 17, 1947. STONE WITH "4" ON IT WAS FOUND THROWN ABOUT 15' FROM TRUE POINT. REPLACED BY CHAIN TIE FROM 2 MARKED FIR STUMPS, ORIGINAL OAK SOUTHEAST DOWN.
- [08] OREGON STATE UNIVERSITY RESEARCH FORESTS CORNER CONDITION REPORT BY MICHEL L. RECTOR, DATED NOVEMBER 21, 1991. STONE 8" X 12" X 12". ORIGINAL ACCESSORIES GONE. 3 MORE RECENT BEARING TREES FOUND WITH BEARING TAGS, BUT NOT SCRIBING. STONE WAS PAINTED YELLOW AND BEARING TREES PAINTED BLUE BY OSU SURVEY CREW. ORANGE CARSONITE WITNESS POST ALSO SET BY OSU SURVEY CREW 8/91. FIR 15" DIA BEARS N17-1/2°E, 9.11 FEET TO CENTER OF TREE; FIR 14" DIA BEARS N89°W, 13.59 FEET TO CENTER OF TREE; FIR 15" DIA BEARS S13-1/2°W, 31.7 FEET.
- [09] OREGON STATE UNIVERSITY RESEARCH FORESTS CORNER CONDITION REPORT BY UNKNOWN PERSON, DATED SEPTEMBER 16, 1993. 8" X 12" STONE PAINTED YELLOW WITH "X" SCRIBED ON TOP. D. FIR 16" DIA BEARS N19°E, 8.4 FEET; D. FIR 15" DIA BEARS N88°W, 13 FEET; D. FIR 15" DIA BEARS S13°W, 32 FEET; 8" DIA POST BEARS SOUTH, 5 FEET.
- [10] BENTON COUNTY SURVEY NO. 9369 BY HARVEY M. CHRISTENSEN, P.L.S., DATED DECEMBER 15, 1998. FOUND 8" X 8" X 12" STONE WITH "X", NO ORIGINAL BEARING TREES FOUND. SET 1998 3" MCDONALD FOREST BRASS CAP ON 2.5" X 30" GALVANIZED IRON PIPE, 0.1 FOOT ABOVE GROUND WITH STONE ALONGSIDE (0.6 FEET EAST). D. FIR 16" DIA BEARS N87°W, 13.6 FEET BLAZED AND SCRIBED "T10S R5W S26 BT"; D. FIR 17" DIA BEARS N21°E, 9.0 FEET BLAZED AND SCRIBED "T10S R5W S25 BT"; D. FIR 17" DIA BEARS S14°W, 32.3 FEET BLAZED AND SCRIBED "T10S R5W S35 BT"; D. FIR 21" DIA BEARS S68°E, 38.0 FEET BLAZED AND SCRIBED "T10S R5W S36 BT". FOUND ORANGE CORNER POST 1 FOOT EAST.

FIRM/AGENCY: BENTON COUNTY SURVEYOR'S OFFICE**ADDRESS:** 360 S.W. AVERY AVE., CORVALLIS, OR 97333; PH. 766-6821**RESEARCH BY:** DAVID L. MALONE, P.L.S.**DATA ENTRY BY:** SAME

**BENTON COUNTY CORNER RESTORATION FORM, PAGE 1 OF 2, 105600200R2
SEE CORNER HISTORY FORM FOR RECORDS ETC.**

CORNER RESTORATION FIELD BOOK NUMBER 30 PAGE(S) 64

DATE 02/02/2016

TOWNSHIP 10 SOUTH, RANGE 5 WEST, WILLAMETTE MERIDIAN; SECTION 25 CORNER SOUTHWEST

DONATION LAND CLAIM N/A CORNER N/A

CONDITION REPORT ; REFERENCED OUT X; RENEWED ; SURVEYED IN

LOCATION AND COMMENTS:

CORNER IS LOCATED ON A MODERATE NORTHWEST FACING SLOPE IN AN AREA OF ±60 YEAR OLD D. FIR. TO REACH CORNER FROM THE INTERSECTION OF TAMPICO ROAD AND SOAP CREEK ROAD, TRAVEL WESTERLY ALONG SOAP CREEK ROAD 1.26 MILES TO OSU RESEARCH FORESTS ROAD 582 ON THE LEFT. TRAVEL THROUGH GATE AND FOLLOW ROAD 582 FOR 0.25 MILES PAST ROAD 5824 ON THE LEFT, FOR 0.13 MILES PAST ROAD 5823 ON THE RIGHT, FOR 0.42 MILES PAST ROAD 5822 ON THE LEFT, FOR 0.16 MILES PAST ROAD 5821 ON THE RIGHT, FOR 0.20 MILES PAST ROAD 580 ON THE RIGHT, FOR 0.04 MILES TO ROAD 560 ON THE LEFT. TURN LEFT AND FOLLOW ROAD 560 FOR 0.23 MILES AND PARK. WALK WEST ABOUT 100 FEET TO THE CORNER. CORNER IS BAD FOR PREMARKING AND GPS CONTROL.

MONUMENTS AND ACCESSORIES FOUND (CONDITION AND SOURCE):

1. FOUND 3" BRASS DISK ON 2-1/2" IRON PIPE, STAMPED AS SHOWN ON PAGE 2 OF 2, 3" ABOVE GROUND SURFACE, FIRMLY SET AND UNDISTURBED FOR THE CORNER. FOUND STONE WITH "X" ON TOP ABOUT 9" SOUTHEAST OF CORNER.
(SET POST PER RECORD [01]).
(HUB ON COLLEGE SURVEY. STONE 8" X 8" X 12" PER RECORD [02]).
(SET STONE 8" X 8" X 12" PER RECORD [03]).
(STONE 8" X 8" X 12" PER RECORDS [05] AND [06]).
(STONE WITH "+" ON IT WAS FOUND THROWN ABOUT 15' FROM TRUE POINT. REPLACED BY CHAIN TIE FROM 2 MARKED FIR STUMPS PER RECORD [07]).
(STONE 8" X 8" X 12" PAINTED YELLOW PER RECORD [08]).
(8" X 12" STONE PAINTED YELLOW WITH "X" SCRIBED ON TOP PER RECORD [09]).
(FOUND 8" X 8" X 12" STONE WITH "X". SET 1998 McDONALD FOREST BRASS CAP ON 2.5" X 30" GALVANIZED IRON PIPE, 0.1 FOOT ABOVE GROUND WITH STONE ALONGSIDE (0.6 FEET EAST) PER RECORD [10]).
2. FOUND D. FIR 21" DIA BEARS S14°00'W, 32.21 FEET TO CENTER, WITH HEALED FACE. SET ALUMINUM NAIL AND PLASTIC WASHER IN NORTHWESTERLY BASE FOR DISTANCE MEASUREMENT. **BASIS OF BEARINGS FOR THIS RESTORATION.**
(BEARING TREE FOUND WITH BEARING TAG BUT NOT SCRIBING. FIR 15" DIA BEARS S13-1/2°W, 31.7 FEET PER RECORD [08]).
(D. FIR 15" DIA BEARS S13°W, 32 FEET PER RECORD [09]).
(D. FIR 17" DIA BEARS S14°W, 32.3 FEET BLAZED AND SCRIBED "T10S R5W S35 BT" PER RECORD [10]).
3. FOUND D. FIR 27" DIA BEARS S69°38'E, 37.98 FEET TO CENTER, WITH HEALED FACE. SET ALUMINUM NAIL AND PLASTIC WASHER IN NORTHEASTERLY BASE FOR DISTANCE MEASUREMENT.
(D. FIR 21" DIA BEARS S68°E, 38.0 FEET BLAZED AND SCRIBED "T10S R5W S36 BT" PER RECORD [10]).
4. FOUND D. FIR 19" DIA BEARS N19°27'E, 8.94 FEET TO CENTER, WITH HEALED FACE. SET ALUMINUM NAIL AND PLASTIC WASHER IN NORTHWESTERLY BASE FOR DISTANCE MEASUREMENT.
(BEARING TREE FOUND WITH BEARING TAG BUT NOT SCRIBING. FIR 15" DIA BEARS N17-1/2°E, 9.11 FEET TO CENTER OF TREE PER RECORD [08]).
(D. FIR 16" DIA BEARS N19°E, 8.4 FEET PER RECORD [09]).
(D. FIR 17" DIA BEARS N21°E, 9.0 FEET BLAZED AND SCRIBED "T10S R5W S25 BT" PER RECORD [10]).
5. FOUND D. FIR 20" DIA BEARS N86°59'W, 13.52 FEET TO CENTER, WITH HEALED FACE. SET ALUMINUM NAIL AND PLASTIC WASHER IN NORTHEASTERLY BASE FOR DISTANCE MEASUREMENT.
(BEARING TREE FOUND WITH BEARING TAG BUT NOT SCRIBING. FIR 14" DIA BEARS N89°W, 13.59 FEET TO CENTER OF TREE PER RECORD [08]).
(D. FIR 15" DIA BEARS N88°W, 13 FEET PER RECORD [09]).
(D. FIR 16" DIA BEARS N87°W, 13.6 FEET BLAZED AND SCRIBED "T10S R5W S26 BT" PER RECORD [10]).
6. FOUND OAK REMAINS AT APPROXIMATE GLO BEARING TREE LOCATION. SET REBAR AT REMAINS, AS NOTED ON PAGE 2 OF 2, BEARS S44°25'38"E, 38.96 FEET.
(W. OAK 18" DIA BEARS S46°E, 60 LINKS [39.60 FEET] PER RECORD [01]).
(OAK 20" DIA BEARS S46°E, 0.60 CHAINS [39.60 FEET] PER RECORDS [02] AND [06]).
(OAK 20" DIA BEARS S46°E, 0.60 CHAINS [39.60 FEET] STANDING PER RECORDS [03] AND [05]).
(ORIGINAL OAK SOUTHEAST DOWN PER RECORD [07]).
(NO ORIGINAL BEARING TREES FOUND PER RECORD [10]).

MONUMENT SET (PROCEDURES AND DESCRIPTION):

FOUND 3" BRASS DISK ON 2-1/2" IRON PIPE, 3" ABOVE GROUND SURFACE, STAMPED AS SHOWN ON PAGE 2 OF 2, FIRMLY SET AND UNDISTURBED FOR THE CORNER. FOUND STONE WITH "X" ON TOP ABOUT 9" SOUTHEAST OF BRASS DISK. ORIGINALLY THE STONE WAS SET FOR THE CORNER BY WALTER L. LARSEN, D.C.S., IN 1926 FROM THE SOUTHEAST GLO BEARING TREE. LARSEN MARKED TWO ADDITIONAL FIR BEARING TREES. IN 1947 MARTIN L. BEYERLEIN, D.C.S., FOUND THE STONE ABOUT 15 FEET FROM THE TRUE POINT, AND REPLACED THE STONE BY TIES FROM 2 MARKED FIR STUMPS, WITH THE SOUTHEAST GLO BEARING TREE BEING DOWN. THE PIPE AND BRASS DISK WERE SET BY HARVEY M. CHRISTENSEN, P.L.S., IN 1998 TO REPLACE THE STONE, WITH THE STONE ALONGSIDE. I HAVE ACCEPTED THE BRASS DISK AS THE PERPETUATION OF THE CORNER.

SET TWO NEW IRON ROD ACCESSORIES AS SHOWN ON PAGE 2 OF 2. FOUND ORANGE FIBERGLASS "SURVEY MARKER" POST 9" EAST OF BRASS DISK.

±60 YEAR OLD D. FIR

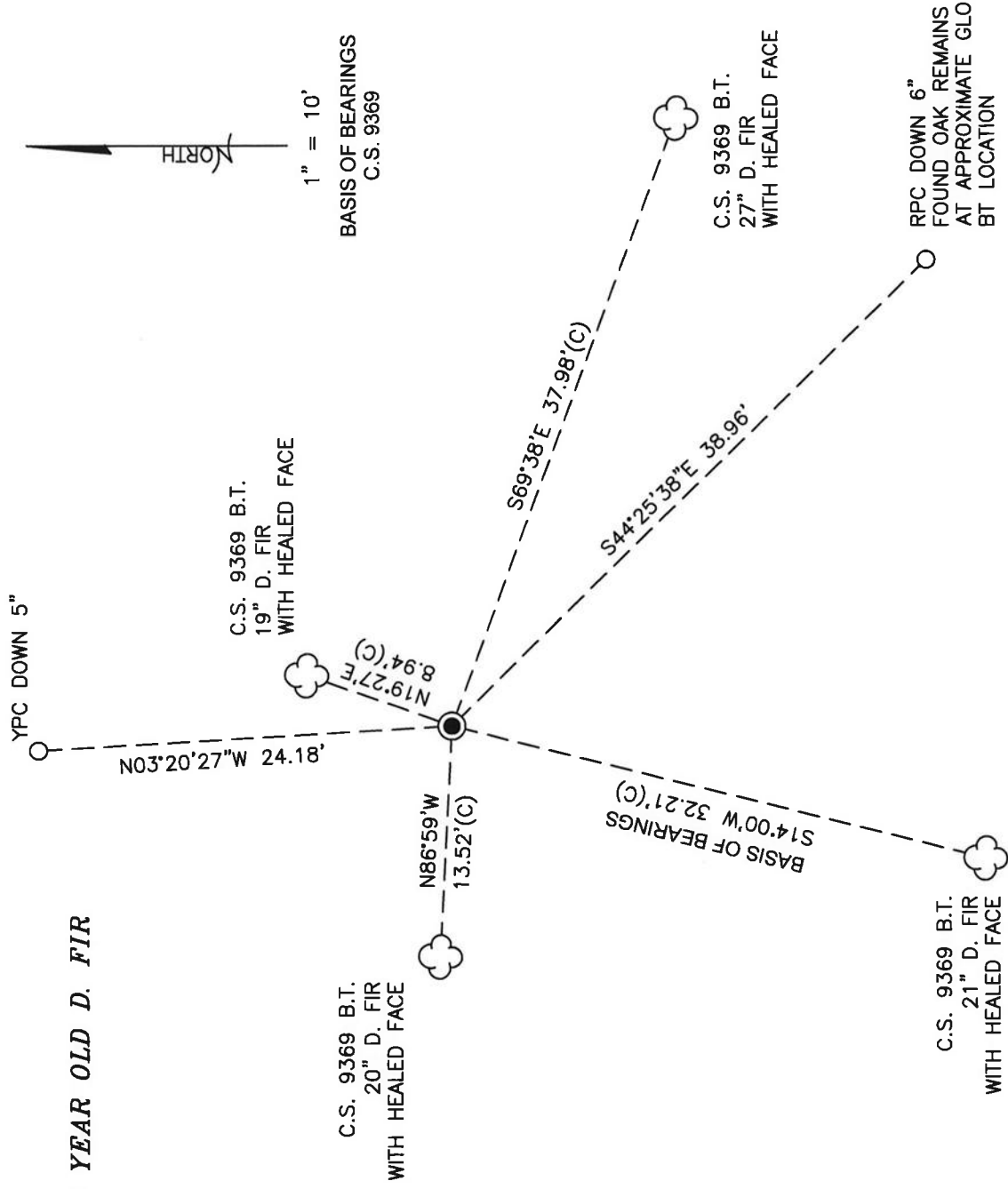

MONUMENT DETAIL

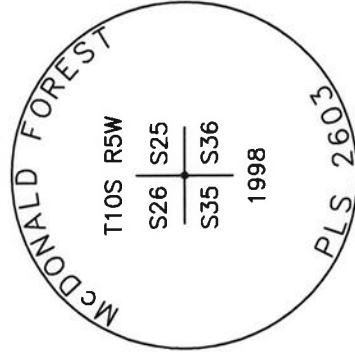

3" BRASS DISK

LEGEND

- SET 5/8" X 30" REBAR WITH PLASTIC CAP YELLOW PLASTIC CAP MARKED "BENTON COUNTY SURVEYOR"
- RPC RED PLASTIC CAP MARKED "BENTON COUNTY SURVEYOR"
- (C) MEASUREMENT TO CENTER
- GOVERNMENT MONUMENT FOUND AS SHOWN COUNTY SURVEY
- C.S. GENERAL LAND OFFICE
- GLO BEARING TREE
- B.T. BEARING TREE AS NOTED

NEW ACCESSORIES:

1. SET REBAR (SEE LEGEND) S44°25'38"E, 38.96 FEET AND 6 INCHES BELOW GROUND LEVEL.
2. SET REBAR (SEE LEGEND) N3°20'27"W, 24.18 FEET AND 5 INCHES BELOW GROUND LEVEL.

NOTES:

COMPASS DECLINATION IS 16" EAST. ALL MEASURED DISTANCES AND BEARINGS ARE TO THE CENTER OF THE OBJECT, UNLESS OTHERWISE NOTED. ALL BEARING TREES ARE PAINTED AND HAVE A B.T. TAG ATTACHED, FACING THE CORNER UNLESS OTHERWISE NOTED. ALL NEW BEARING TREES HAVE A PLASTIC WASHER (STAMPED "SURVEY MARKER DO NOT REMOVE") ATTACHED BY AN ALUMINUM NAIL TO THE SIDE CENTER OF THE TREE FOR DISTANCE MEASUREMENT, UNLESS OTHERWISE NOTED.

THIS RESTORATION WAS PERFORMED AT THE DIRECTION AND APPROVAL OF THE BENTON COUNTY SURVEYOR *glenn*

REGISTERED PROFESSIONAL LAND SURVEYOR

03/01/16 David L. Malone

OREGON
JANUARY 12, 1999
DAVID L. MALONE
51523

FIRM/AGENCY: BENTON COUNTY SURVEYOR'S OFFICE
ADDRESS: 360 S.W. AVERY AVE., CORVALLIS, OR 97333; PH. 541-766-6821
PRESENT: DAVID L. MALONE, P.L.S., BERNARD ALTENBACH, SURVEY TECH,
AND STEVE PILKERTON, P.E., OSU COLLEGE FORESTS.
EQUIPMENT: NIKON NIV03.C WITH SURVEY PRO ONBOARD.

RENEWAL DATE: 12/31/16

RESEARCH FORESTS CORNER CONDITION REPORT

Section 25 Township 10S Range 5W
County Benton Date 7/16/83

CORNER DESIGNATION

SW CORNER

Previous Renewals/Surveys, etc. _____

Monument(s) & Accessories Found: (Condition and Source)

8x12 STONE PAINTED YELLOW WITH "X" SCRIBED
ON TOP

BEARINGS FROM ACCESSORIES TO MONUMENT

16" DOUGLAS-FIR S 19° W 8.4'

15" DOUGLAS-FIR S 88° E 13'

Monument Detail

Sketch

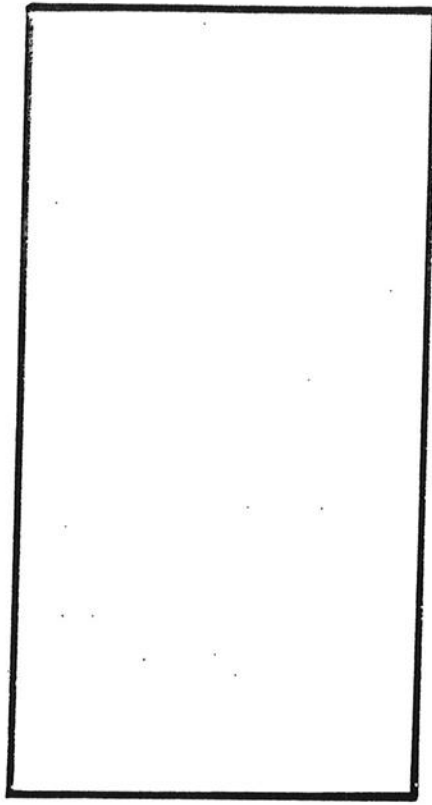
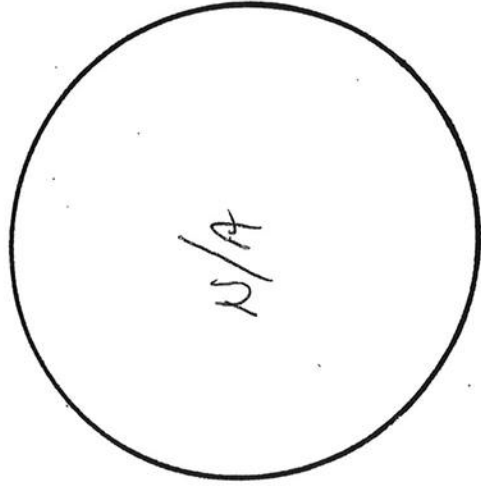

MONUMENT AND ACCESSORY CONDITION

15" DOUGLAS-FIR N 13° E 32'

8" DIAMETER POST 5' SOUTH

Location & Comments

Compass Declination 20° E

OREGON STATE UNIVERSITY
RESEARCH FORESTS CORNER CONDITION REPORT

Section 35 Township 10S Range 5W
County BENTON Date 11/21/91

CORNER DESIGNATION

NE 1/4 SECTION 35

REFERENCES

C.S. 337

MONUMENT(S) & ACCESSORIES FOUND: (CONDITION)

STONE 8"X8"X12" PER C.S.337: ORIGINAL ACCESSORIES GONE; 3 MORE RECENT
B.T.'S FOUND W/ BEARING TAPS, BUT NOT SCRIBING. STONE WAS PAINTED YELLOW &
B.T.'S PAINTED BLUE BY OSU SURVEY CREW. ORANGE CARSONITE WITNESS POST ALSO SET
BY OSU SURVEY CREW ~~5/11/91~~

Monument Detail

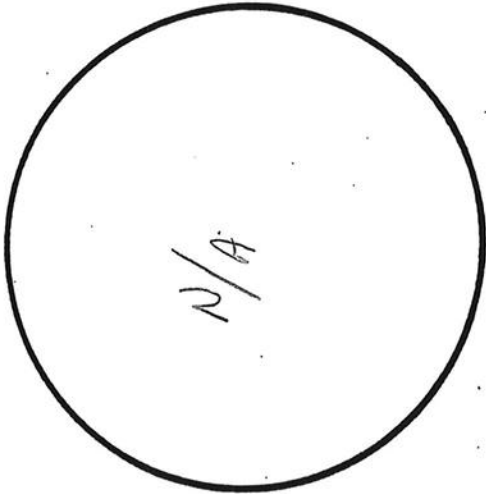

Sketch

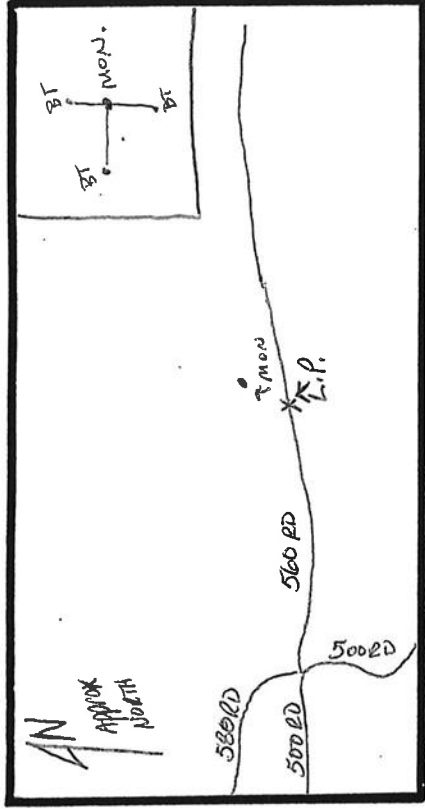

ACCESSORY DESCRIPTION (ALL BEARINGS FROM ACCESSORIES TO MONUMENTS)

FIR 15" DBH TAKEN N20°E @ 8.4' : MEASURED @ S 17 1/2° W 9.11' FROM CENTER OF TREE
FIR 14" DBH TAKEN N88W @ 13.1' : MEASURED @ S 89° E 13.59' FROM CENTER OF TREE
FIR 15" DBH TAKEN S13 1/2° W @ 31.7' : MEASURED E. SAME

LOCATIONS & COMMENTS

TAKE 500 RD FROM PEAVY ARBORETUM APPROX 1 1/2 MI. TO JUNC. W/ 560 RD. PROCEED
1200' ON 560 TO STUMP W/ LOCATION POSTER NAILED ON TOP. FOLLOW BEARING &
DISTANCE ON L.P. TO MON.

SIGNATURE

July 30, 1922

CORNER RESTORATION BOOK NO. 1

1/4 Sec. cor betw. Secs. 11 & 12 T. 115 S. R. 7 W. W.M.
 Set Oak stake June 28, 1935, state fork
 Set Fire oak 30' N. 400' E. 1378 eds
 Set Fire oak 36' N. 700' W. 12598
 by McGowan & S. D. G.
 Oak 24" in dia. bears N. 89° E. 2.56
 East comb of barn " N 20° 30' W
 Margs Peak " S. 14° 38' W
 Oak 36" " N 79° 25' W. 12.598

Survey for
 B.P. Noisic
 W. W. Hancock
 det. C.S.

S.E. cor Sec. 9 T. 12 S. R. 7 W. W.M.
 Set 1" pipe
 Fir 10" in dia. bears S. 32° W. 70 eds
 " 10" " " N 83° W. 74 " "
 " 18" " " S 17° E. 72 " "
 " 30" " " East 36" staking
 Margs Peak T S 19 1/2° W 1 1/4 ft -

1/4 cor between Secs. 18 & 19 T. 12 S. R. 7 W.
 Set 2"x2" angle iron
 Fir 16" in dia. bears N. 12° W. 35 eds
 " 24" " " S 35° E. 11 "

Survey for
 Shrigley
 W.M.D.

S.W. cor. P. Gilbert Ch. 61 T. 14 S. R. 3 W. W.M.
 Set spring & chip
 Oak 20" in dia. bears N 56° E. 11.90 eds
 " 24" " " N 57° E 13.50

Survey for
 Gomer Est
 Witnessed by
 Gomer boys
 Alias -
 W.M.R.

N.W. cor R.A. Belknap Ch. 61 T. 14 S. R. 3 W. W.M.
 Set Fire dog 100 East of above cor.

N.W. cor. Dana Carson Ch. 45 T. 10 S. R. 1 W. W.M.
 Found stone 10"x12" x?
 Oak 12" in dia. bears S 70° W. 1.537 eds
 " post 12" " " S 9° E. 0.82

1/4 Sec cor betw. Secs. 26 & 35 T. 10 S. R. 5 W.
 Set pipe & stake
 Oak 17" in dia. bears N 60° E. 0.62
 " (36") " " S 54° E 1.27 eds
 " 22" " " N 80° W 1.19 eds

Sec. cor. 26, 27, 34, 35 T. 10 S. R. 5 W. W.M.
 Set 2 1/4" iron rod
 Oak 15" in dia. bears N 65° E 2.04 eds
 1" pipe. 203 for Road bears N 58° 22' W 1.247

Sec. cor. to Secs. 26, 35, 25, 26 T. 10 S. R. 5 W.
 Set Stone 8"x8"x2"
 Fir 20" in dia. bears N 20° E 1.40 eds
 " 24" " " N 56° W 2.45 "
 Oak 20" " " S 46° E 1.60 eds



10-5 25

Section corner to sections 26, 35, 25, and 36, Twp. 10 S., R. 5 W.

234

Reestablishment by W. C. Galloway

Date 1-1-1926

Set stone 8" x 8" x 12"

Fir 20" in diam bears N 2° E

Fir 24" in diam bears N 56° W

Oak 20" in diam bears S 46° E

.40 chains

.245 chains

.60 chains (standing)