

105848050

DATE 04/04/2022

TOWNSHIP 10 SOUTH, RANGE 5 WEST, WILLAMETTE MERIDIAN; SECTION 27 CORNER N/A
 DONATION LAND CLAIM SILAS M. JONES NO. 48 CORNER SOUTHWEST

COMMON CORNER(S):

POINT ON THE NORTH LINE OF THE ALFRED WRITSMAN DONATION LAND CLAIM (DLC) NO. 47

RECORDS (INFORMATION IN *BOLD ITALICS* IS COUNTY STAFFS' INTERPRETATION OF THE RECORD)

BASED ON EXTENSIVE RESEARCH AND RECOVERY OF EVIDENCE, THIS OFFICE HAS DETERMINED THAT MOST GENERAL LAND OFFICE SURVEYORS IN BENTON COUNTY BEFORE 1890 MEASURED TO THE FACE OF BEARING TREES.

- [01] GENERAL LAND OFFICE (GLO) NOTES OF THE ALFRED WRITSMAN DONATION LAND CLAIM (DLC) NO. 47 BY DENNIS HATHORN, D.S., DATED AUGUST 15, 1854. *S. M. JONES' SOUTHWEST CORNER.*
- [02] GENERAL LAND OFFICE (GLO) NOTES OF THE SILAS M. JONES DONATION LAND CLAIM (DLC) NO. 48 BY DENNIS HATHORN, D.S., DATED AUGUST 17, 1854. *SET STONE POST 8" X 10" X 20" FROM WHICH AN OAK 20" DIA BEARS S78°E, 192 LINKS (126.72 FEET); OAK 20" DIA BEARS N10°W, 282 LINKS (186.12 FEET).*
- [03] BENTON COUNTY SURVEY NO. 1291 (OLD NO. 337) FIELD NOTES (FIELD BOOK 58, PAGE 7) BY W. C. GALLOWAY, C.S., DATED SEPTEMBER 4, 1936. *STONE 8" X 10" X 20". OAK 20" DIA (GLO BT) BEARS S78°E, 1.92 CHAINS (126.72 FEET), DOWN; OAK 20" DIA (GLO BT) BEARS N10°W, 2.82 CHAINS (186.12 FEET), DOWN; OAK 15" DIA BEARS S68°W, 0.431 CHAINS (28.45 FEET); MARKED THORN 12" DIA BEARS WEST, 0.030 CHAINS (1.98 FEET); MARKED THORN 10" DIA BEARS S70°E, 0.075 CHAINS (4.95 FEET).*
- [04] BENTON COUNTY CORNER RESTORATION BOOK NO. 1, PAGE 209, BY W. C. GALLOWAY, C.S., DATED SEPTEMBER, 1936. *ORIGINAL STONE 8" X 10" X 20" IN PLACE. CHECKED FROM OAK 20" DIA (GLO BT) BEARS S78°E, 1.92 CHAINS (126.72 FEET), DOWN; OAK 20" DIA (GLO BT) BEARS N10°W, 2.82 CHAINS (186.12 FEET), DOWN. MARKED OAK 15" DIA (CSBT) BEARS S68°W, 0.431 CHAINS (28.45 FEET); MARKED THORN 12" DIA (CSBT) BEARS WEST, 0.030 CHAINS (1.98 FEET); MARKED THORN 10" DIA (CSBT) BEARS S70°E, 0.075 CHAINS (4.95 FEET).*
- [05] BENTON COUNTY CORNER RESTORATION NO. 286. *TRANSCRIBED FROM RECORD [04] AND MAY CONTAIN ERRORS/OMISSIONS.*
- [06] BENTON COUNTY MAP NO. 10-5-00007 BY W. C. GALLOWAY, C.S., DATED DECEMBER 22, 1936. *STONE 8" X 10" X 20". OAK 15" DIA (CSBT) BEARS S68°W, 0.431 CHAINS (28.45 FEET); THORN 12" DIA (CSBT) BEARS WEST, 0.030 CHAINS (1.98 FEET); THORN 10" DIA (CSBT) BEARS S70°E, 0.075 CHAINS (4.95 FEET).*
- [07] BENTON COUNTY MAP NO. 10-5-00010 BY UNKNOWN DRAFTSMAN, NO DATE GIVEN. *STONE 8" X 10" X 20". OAK 15" DIA (CSBT) BEARS S68°W, 0.431 CHAINS (28.45 FEET); THORN 12" DIA (CSBT) BEARS WEST, 0.030 CHAINS (1.98 FEET); THORN 10" DIA (CSBT) BEARS S70°E, 0.075 CHAINS (4.95 FEET).*
- [08] BENTON COUNTY SURVEY NO. 4153 BY R. M. MORRIS, P.E., DATED JULY, 1965. *STONE. SET 1" X 30" PIPE BEARS N89°45'41"W, 149.21 FEET.*
- [09] BENTON COUNTY SURVEY NO. 4300 BY B. OSBURN SHAW, P.L.S., DATED AUGUST 17, 1966. *FOUND STONE. FOUND 1" PIPE BEARS N89°45'41"W, 149.21 FEET.*
- [10] BENTON COUNTY SURVEY NO. 4375 BY B. OSBURN SHAW, P.L.S., DATED APRIL 17, 1967. *STONE. 1" PIPE BEARS N89°45'41"W, 149.21 FEET.*
- [11] BENTON COUNTY SURVEY NO. 5483 BY FRED I. LEMKE, P.L.S., DATED JUNE 15, 1973. *STONE. FOUND 1" PIPE BEARS N89°45'41"W, 149.43 FEET. SET 1/2" ROD BEARS N89°39'34"E, 64 FEET.*
- [12] BENTON COUNTY SURVEY NO. 8212 BY NORMAN D. SPRINGER, P.L.S., DATED JANUARY 5, 1989. *FOUND STONE 8" X 10" X 20".*
- [13] BENTON COUNTY CORNER RESTORATION FORM NO. 4032 BY CURTIS J. LIESENFELT, P.L.S., DATED FEBRUARY 24, 1992. *FOUND 9" X 10" X ? STONE 3" ABOVE GROUND SURFACE FOR THE CORNER. THE STONE IS MARKED "C48" ON THE NORTHERLY SIDE AND "C47" ON THE SOUTHERLY SIDE. FOUND A DOWNED OAK 18" DIA (GLO BT), THE CENTER OF THE ROOT HOLE BEARS N8°W, 187 FEET. FOUND A DEAD STANDING BLACK HAWTHORN 11" DIA (CSBT) WITH A ROTTED OUT FACE BEARS S58°E, 4.95 FEET. FOUND A 1" INSIDE DIAMETER IRON PIPE 4" ABOVE GROUND SURFACE BEARS N84°45'W, 149.28 FEET. FOUND 1/2" IRON ROD 4" ABOVE GROUND SURFACE BEARS S85°30'E, 64.05 FEET. FOUND AN OAK 28" DIA (CSBT) WITH A HEALED FACE BEARS S72°W, 28.45 FEET. SET A PK NAIL AND BRASS WASHER STAMPED "BENTON COUNTY SURVEYOR" (BCBW) IN THE NORTHWESTERLY BASE. NO OTHER RECORD BEARING OBJECTS WERE RECOVERED. DRILLED A 1/4" DIAMETER HOLE IN THE TOP CENTER OF THE STONE AND SET A TACK IN LEAD FOR THE CORNER POINT. SET 5/8" X 30" REBAR WITH A YELLOW PLASTIC CAP MARKED "BENTON COUNTY SURVEYOR" BEARS S7°E, 13.67 FEET. A DOUGLAS FIR 18" DIA BEARS N21°30'W, 49.04 FEET, FACED AND SCRIBED "XBT". SET A PK NAIL AND BCBW IN THE SOUTHWESTERLY BASE. A DOUGLAS FIR 8" DIA BEARS N56°45'E, 32.10 FEET, FACED AND SCRIBED "DLC 48 BT". SET A PK NAIL AND BCBW IN THE NORTHWESTERLY BASE. SET ORANGE FIBERGLASS "SURVEY STAKE" POST 1 FOOT SOUTHERLY.*
- [14] BENTON COUNTY SURVEY NO. 9355 BY NORMAN D. SPRINGER, P.L.S., DATED OCTOBER 28, 1998. *FOUND STONE 8" X 10" X 20", HOLE IN TOP.*
- [15] BENTON COUNTY SURVEY NO. 10867 BY DAVID LEE SCHLOSSER, JR, P.L.S., DATED AUGUST 30, 2016. *FOUND STONE. FIR 30" DIA (CSBT) BEARS N22°W, 49.0 FEET. OAK 30" DIA (CSBT) BEARS S68°W, 27.3 FEET. HAWTHORN 10" DIA (CSBT) BEARS S53°E, 5.00 FEET, LYING DOWN.*

FIRM/AGENCY: BENTON COUNTY SURVEYOR'S OFFICE
ADDRESS: 360 S.W. AVERY AVE., CORVALLIS, OR 97333; PH. 541-766-6821
RESEARCH BY: DAVID L. MALONE, P.L.S. **DATA ENTRY BY:** SAME

BENTON COUNTY CORNER RESTORATION FORM

4032

TOWNSHIP 10 SOUTH, RANGE 5 WEST, WILLAMETTE MERIDIAN; SECTION 27 CORNER
DONATION LAND CLAIM SILAS M. JONES NO. 48 CORNER SW
DATE 2/24/92 CORNER RESTORATION FIELD BOOK NUMBER 11 PAGE(S) 53
CONDITION REPORT ONLY; XX REFERENCED OUT; RENEWED; SURVEYED IN

LOCATION AND COMMENTS:

THE CORNER IS LOCATED AT THE BASE OF AN EAST-WEST WOVEN AND BARBED WIRE FENCE NOW DOWN, 3.5 FEET NORTHEASTERLY FROM A SMALL DITCH, 9 FEET SOUTHERLY FROM THE CENTERLINE OF AN OLD DIRT ROAD AND 60 FEET WEST-NORTHWESTERLY FROM A SMALL WOODEN SHED AT 27494 SOUTH BOUNDARY ROAD (PRIVATE ROAD NO. 3112).

PREVIOUS RENEWALS/SURVEYS, ETC.:

- [01] ORIGINAL GLO SURVEY BY DENNIS HATHORN DATED SEPTEMBER 16, 1856.
- [02] COUNTY SURVEY NO. 189 BY J.A. GANONG DATED OCTOBER 24, 1910.
- [03] COUNTY SURVEY NO. 1291 BY W.C. GALLOWAY DATED SEPTEMBER 4, 1936.
- [04] OLD CORNER RESTORATION BOOK NO. 1 PAGE 209 BY W.C. GALLOWAY DATED SEPTEMBER OF 1936.
- [05] CORNER RESTORATION NO. 286 BY W.C. GALLOWAY DATED SEPTEMBER OF 1936.
- [06] MAP NO. 10-5-00007 BY W.C. GALLOWAY DATED DECEMBER 22, 1936.
- [07] MAP NO. 10-5-00010 BY BENTON COUNTY SURVEYOR'S OFFICE (NO DATE GIVEN).
- [08] COUNTY SURVEY NO. 4153 BY R.M. MORRIS DATED JULY OF 1965.
- [09] COUNTY SURVEY NO. 4300 BY B. OSBURN SHAW DATED AUGUST 17, 1966.
- [10] COUNTY SURVEY NO. 5483 BY FRED LEMKE DATED JUNE 15, 1973.
- [11] COUNTY SURVEY NO. 8212 BY NORMAN SPRINGER DATED JANUARY 5, 1989.

MONUMENTS AND ACCESSORIES FOUND (CONDITION AND SOURCE):

- FOUND: 9" X 10" X ? STONE 3" ABOVE GROUND SURFACE FOR THE CORNER (8" X 10" X 20" AS PER [1]). THE STONE IS MARKED "C48" ON THE NORTHERLY SIDE AND "C47" ON THE SOUTHERLY SIDE. THESE MARKS ARE BELIEVED TO HAVE BEEN MADE BY THE ORIGINAL SURVEYOR.
- FOUND: A DOWNED OAK 18" IN DIAMETER. THE CENTER OF THE ROOT HOLE BEARS N 8° W 187 FEET (20" DIAMETER, N 10° W 186.12 FACE MEASURE AS PER [1]). SET A B.T. TAG ON THE BASE OF THE DOWNED OAK.
- FOUND: A DEAD STANDING BLACK HAWTHORN 11" IN DIAMETER WITH A ROTTED OUT FACE, BEARS S 58° E 4.95 FEET (10" DIAMETER S 70° E 4.95 FEET AS PER [2]). SET A B.T. TAG ON THE NORTHWESTERLY FACE.
- FOUND: A 1" INSIDE DIAMETER IRON PIPE 4" ABOVE GROUND SURFACE, BEARS N 84° 45' W 149.28 FEET (N 89° 45' 41" W 149.21 FEET AS PER [8]). THE PIPE IS 0.4 FOOT SOUTHERLY FROM AN EAST-WEST WOVEN AND BARBED WIRE FENCE.
- FOUND: 1/2" IRON ROD 4" ABOVE GROUND SURFACE, BEARS S 85° 30' E 64.05 FEET (N 89° 39' 34" E 64 FEET AS PER [10]). THE ROD IS IN AN EAST-WEST WOVEN AND BARBED WIRE FENCE AND 5.5 FEET EASTERLY FROM A SOUTHERLY WOOD RAIL FENCE.
- FOUND: AN OAK 28" IN DIAMETER WITH A HEALED FACE, BEARS S 72° W 28.45 (15" DIAMETER S 68° W 28.45 FEET AS PER [3]). SET A PK NAIL AND B.C.B.W. IN THE NORTHWESTERLY BASE. SET A B.T. TAG ON THE NORTHEASTERLY FACE. NO OTHER RECORD BEARING OBJECTS WERE RECOVERED.

MONUMENT SET (PROCEDURES AND DESCRIPTION):

DRILLED A 1/4" IN DIAMETER HOLE IN THE TOP CENTER OF THE STONE AND SET A TACK IN LEAD FOR THE CORNER POINT.

NEW ACCESSORIES:

- SET: 5/8" X 30" REBAR WITH A YELLOW PLASTIC CAP MARKED "BENTON COUNTY SURVEYOR" BEARS S 7° E 13.67 FEET. THE REBAR IS 3.5 FEET SOUTHWESTERLY FROM A SMALL DITCH.
- A DOUGLAS FIR 18" IN DIAMETER, BEARS N 21° 30' W 49.04 FEET, FACED AND SCRIBED "XBT". SET A PK NAIL AND B.C.B.W. IN THE SOUTHWESTERLY BASE. SET A B.T. TAG ON THE SOUTHEASTERLY FACE.
- A DOUGLAS FIR 8" IN DIAMETER, BEARS N 56° 45' E 32.10 FEET, FACED AND SCRIBED "DLC 48 BT". SET A PK NAIL AND B.C.B.W. IN THE NORTHWESTERLY BASE. SET A B.T. TAG ON THE SOUTHWESTERLY FACE.
- SET: ORANGE FIBERGLASS "SURVEY STAKE" POST 1 FOOT SOUTHERLY.

NO BRASS CAP WAS SET

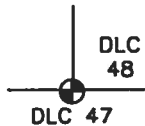

NOT TO SCALE

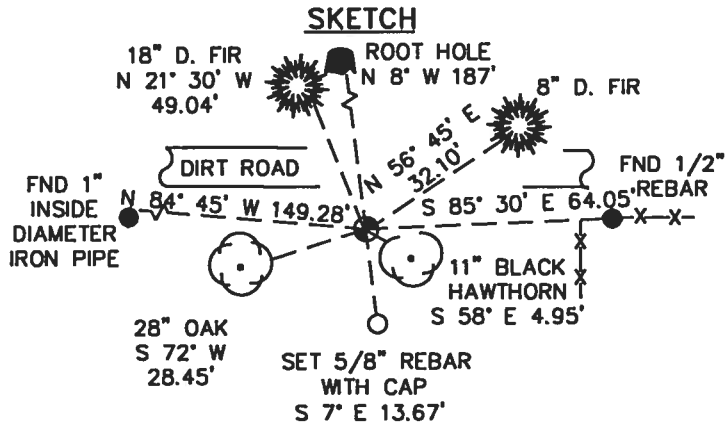

NOTES:

B.C.B.W. IS A BRASS WASHER STAMPED "BENTON COUNTY SURVEYOR". COMPASS DECLINATION IS 20' EAST. ALL MEASURED DISTANCES AND COMPASS BEARINGS ARE TO THE CENTER OF THE OBJECT, UNLESS OTHERWISE NOTED. THIS RESTORATION WAS PERFORMED AT THE DIRECTION AND APPROVAL OF THE BENTON COUNTY SURVEYOR. *df*

FIRM/AGENCY: BENTON COUNTY SURVEYOR
ADDRESS: 360 S.W. AVERY AVE. CORVALLIS OR 97333; PH. 757-6821
SURVEY CREW: CURTIS J. LIESENFELT/MARK E. ANDERSON

REGISTERED PROFESSIONAL LAND SURVEYOR

Curtis J. Liesenfelt

OREGON
JULY 17, 1986
CURTIS J. LIESENFELT
2213

T105 R5W SEC. 27 SW COR SILAS M JONES DLG DLG 48
 FND 9" X 10" X 3" STONE 3" AGS FOR THE COR. (Ø" X 10" X 20"
 AS PER [7]). THE STONE IS MKD. "CAB" ON THE
 N W SIDE Y 'C47" ON THE S W SIDE THESE MARKS
 ARE BELIEVED TO HAVE BEEN MADE BY THE ORIGINAL
 SURVEYOR.
 " A DOWNED OAK 18" IN DIAM. V BEARS N 80° W ~ 1870'
 (20" DIAM. V N 10° W ~ 18612 FACE MEAS. AS PER [7]) SET A
 BT TAG ON THE BASE OF THE DOWNED OAK.
 " A DEAD STANDING BLACK HAWTHORN 11" IN DIAM. Ø
 A ROTTED OUT FACE BEARS S 50° E ~ 4.95' (10" DIAM. Ø
 4.95' AS PER [37]) SET A B.T. TAG ON THE NW 1/4
 FACE.
 " A 1" I.O.L.P. 4 A.G.S. BEARS N 80° 45' W ~ 14220' (
 N 109° 45' 41" W ~ 149.21 AS PER [8]) THE PIPE IS Ø 4'
 5 1/4 FROM AN E-W L.W.V. * B.W. FMC.
 " 1/2" I. ROD 4 A.G.S. BEARS S 85° 30' E ~ 14.05' (N 109°
 39' 34" E ~ 64' AS PER [10]) THE ROD IS IN AN E-W L.W.V.
 * B.W. FMC. 4 5 5' E'Y FROM A S'Y WOOD PAIL FMC.
 " AN OAK 28" IN DIAM. Ø A HEALED FACE, BEARS
 S 72° W ~ 28.45 (15" S 18° W ~ 28.45' AS PER [37]). SET
 A PKT & BEAR IN THE NW 1/4 BASE. SET A BT TAG ON THE
 FACE
 NE'Y BASE.
 NO OTHER RECORD BEARING OBJECTS WERE RECOVERED
 DRILLED A 1/4" IN DIAM. HOLE IN THE TOP CTR. OF
 THE STONE & SET A TACK IN LEAD FOR THE
 COR. PT.

2/24/92: GILBERT, NEAR Ø, KERN DKM2-A, DM.503, KVH DATASCOPE

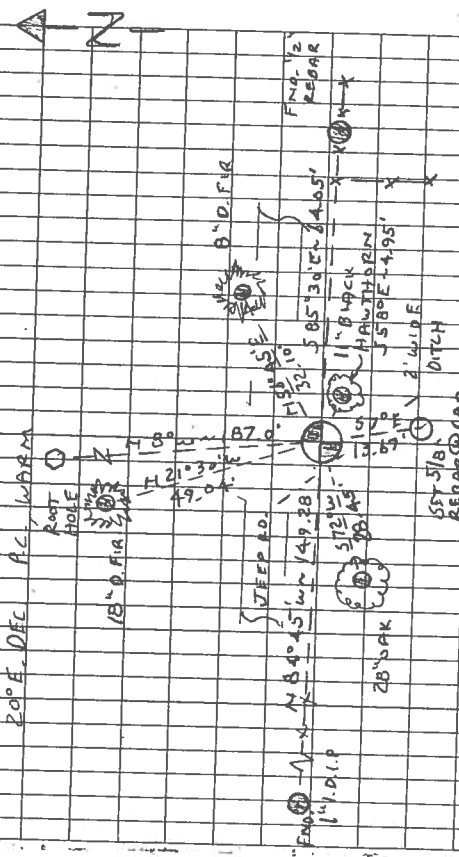

SET: 5/8" X 30" REBAR @ A Y PC MKD. "BENTON COUNTY SURVEYOR"
 BEARS S 70° E ~ 13.67'. THE REBAR IS 3' 5" S 4 1/4' FROM A
 SMALL DITCH
 A D. FIR 18" IN DIAM. BEARS N 21° 30' W ~ 49.02'. FACED *
 SCRIBED 1" X BT. SET A PKT & B.W. IN THE SW 1/4 BASE
 SET A BT TAG ON THE SE'Y FACE
 A D. FIR Ø" IN DIAM. BEARS N 56° 45' E ~ 32.10'. FACED *
 SCRIBED "DLG 48 BT". SET A PKT & B.W. IN THE NW 1/4 BASE.
 SET A BT TAG ON THE SW 1/4 FACE
 SET ORANGE FINGER GLASS "SURVEY STAKE" POST 1' 5 1/4"
 THE COR. IS LOCATED Ø THE BASE OF AN E-W L.W.V. * B.W. FMC.
 NOW DOWN, 3.5' NE'Y FROM A SMALL DITCH,
 9' 5 1/4 FROM THE Ø OF AN OLD DEEP ROAD & NO GRASS
 B'D' W-MAIN'Y FROM A SMALL WOODEN FHEG Ø CAP WAS
 2749A SUNDAY, RD (PRIVATE RA-NO 3112) SET
 IT IS POOR FOR PREMARKING & GAS CONTROL.

C.W.

C.S. 214
 W.C.G. June 19, '36
 Witnesses
 Adrian Seits and
 I.W. Bath

1/4 Sec. cor. bet. Secs. 34 & 35 T. 10 S. R. 6 W.
 Set a 1 1/4" Iron rod Orig. cor.
 From which A cedar 4" in dia. (now 16") bears S. 28 1/2° E. .116 std.
 A dogwood 4" " " (sprout of orig) " S. 58 1/2° W. .490 chs.
 Cedar 3 1/2" " " " N. 57° E. .308 chs. Nail in S. for measure
 " 3 1/2" " " " S. 46 1/2° E. .526 " " " E. " "

C.S. #360
 W.C.G. July 2, 1936
 Witness
 Adrian Seits

1/4 Sec. cor. bet. Secs 3 & 10 T 12-7
 Set 3/8" x 1 1/2" x 17" Iron bar, Orig. cor.
 Fir 30" in dia. bears N. 7° E. 10 lks. std. Orig. 1/4 S on bark, Remke near
 " 30 " " " S. 61° W. 25 " " " 1/4 S on bark burned off. 1 remke

"

1/4 Sec. cor. bet. Secs. 3 & 4 T 12-7
 Set a 1 1/2" x 3 1/2" x 40" channel iron, looked like orig. print of stake.
 Fir 60" in dia. bears S. 60° E. .39 chs. std. Broken top.
 " 50" " " " S. 58° W. 1.66 " stump 6' tall, good condition.
 Mkd. " 16" " " " S. 41° 20' W. 1.649 chs.

C.S. #337
 W.C.G. Sept. 1936
 R.J. Stewart and
 H.H.H. Hillebrand

N.E. cor. of Alfred Writsman D.L.C. #47 T. 10 S. R. 5 W.
 Stone 12" x 12" x 24", Orig. stone in corner of fence.
 From which a Stone 10" x 15" x 20", the most S. SE. cor. of Silas M. Jones
 D.L.C. #48 bears S. 89° 41' E. 2.481

"

N.W. Corner of Alfred Writsman D.L.C. #47 T10-5
 Stone 15" x 18" x 24", Orig. stone. Oak 20" S. 83° W. 3.06 down. Oak 24" N. 70° W. 2.01 down.
 Oak 6" S. 12° E. .393
 " 14" N. 85° W. 1.104

"

N.E. Cor. of Silas M. Jones D.L.C. #48 T. 10 S. R. 5 W.
 Orig. Stone Mkd. C 49 & C 48 Witness trees gone
 Marked Oak 19" in dia. bears S. 5° 20' W. .624
 " Cherry 10" " " " S. 14° W. .042
 " Oak 10" " " " S. 89° W. 2.609

"

Most East S.E. Cor. of Silas M. Jones D.L.C. #48 T10-5
 Orig. Stone 8" x 10" x 24"
 Oak 12" in dia. bears N. 3° 10' E. 4.938 chains.

"

Most South S.E. cor. of Silas M. Jones D.L.C. #48 T10-5
 Orig. Stone 10" x 15" x 20" in place
 an oak 18" in dia. bears N. 3° E. 2.606 to face std.
 Marked " 6" " " " N. 15° W. .073

"

S.W. Cor. of Silas M. Jones D.L.C. #48 T10-5
 Orig. Stone 8" x 10" x 20" in place. Checked from Oak 28" S. 78° E. 1.92 down
 Mkd. Oak 15" in dia. bears S. 68° W. .731 " 20" N. 10° W. 2.82 "
 " Thorn 13" " " West .030
 " " 18" " " S. 70° E. .075



and gone
 S.H.
 for measure
 Mks.
 ve
 down
 Mkd. on bark

S. W. corner of Silas M. Jones DLC 48, Twp. 10-5

286

Reestablishment by W. C. Galloway

September 1936

Original stone 8" x 10" x 20" in place from	Oak 20" S 78°E	1.92 chains (down)
Oak 15" in diam bears S 68° W		.431 chains
Thorn 12" in diam bears West		.030 chains
Thorn 10" in diam bears S 70° E		.075 chains