

**106100240**

DATE 03/02/2018TOWNSHIP 10 SOUTH, RANGE 6 WEST, WILLAMETTE MERIDIAN; SECTION 30 CORNER WEST 1/4  
DONATION LAND CLAIM N/A CORNER N/A**COMMON CORNER(S):**

EAST 1/4 CORNER SECTION 25, TOWNSHIP 10 SOUTH, RANGE 7 WEST

**RECORDS (INFORMATION IN BOLD ITALICS IS COUNTY STAFFS' INTERPRETATION OF THE RECORD)**

BASED ON EXTENSIVE RESEARCH AND RECOVERY OF EVIDENCE, THIS OFFICE HAS DETERMINED THAT MOST GENERAL LAND OFFICE SURVEYORS IN BENTON COUNTY MEASURED TO THE FACE OF BEARING TREES.

- [01] GENERAL LAND OFFICE (GLO) NOTES BY DANIEL MURPHY, D.S., DATED JUNE 15, 1854. SET POST FROM WHICH A MAPLE 14" DIA BEARS N85°W, 68 LINKS (44.88 FEET); FIR 4" DIA BEARS N29°E, 18 LINKS (11.88 FEET).
- [02] BENTON COUNTY LOOSE LEAF ROAD NOTES FOR BOTTGER-BONNER MTN. SECTION SUMMIT HOSKINS ROAD BY W. C. GALLOWAY, C.S., DATED 1941. MAPLE 14" DIA (GLO BT) BEARS N85°W, 0.68 CHAINS (44.88 FEET) GONE; FIR 4" DIA (GLO BT) BEARS N29°E, 0.18 CHAINS (11.88 FEET) STUMP, MAPLE GONE). W. FIR 8" DIA BEARS N22°E, 0.316 CHAINS (20.86 FEET); MARKED R. FIR 15" DIA BEARS N70°E, 0.464 CHAINS (30.62 FEET), MARKED "S"; MARKED W. FIR 8" DIA BEARS S48°W, 0.386 CHAINS (25.48 FEET).
- [03] BENTON COUNTY CORNER RESTORATION BOOK NO. 1, PAGE 249, BY W. C. GALLOWAY, C.S., DATED 1941. SET 1-1/4" GALVANIZED PIPE FROM FIR 4" DIA (GLO BT) BEARS N29°E, 0.18 CHAINS (11.88 FEET) (STUMP, MAPLE GONE). W. FIR 8" DIA BEARS N22°E, 0.316 CHAINS (20.86 FEET); W. FIR 8" DIA BEARS S48°W, 0.386 CHAINS (25.48 FEET); R. FIR 15" DIA BEARS N70°E, 0.464 CHAINS (30.62 FEET), MARKED "S".
- [04] BENTON COUNTY CORNER RESTORATION NO. 384. TRANSCRIBED FROM RECORD [03] AND MAY CONTAIN ERRORS AND/OR OMISSIONS.
- [05] BENTON COUNTY CORNER RESTORATION NO. 385. TRANSCRIBED FROM RECORD [03] AND MAY CONTAIN ERRORS AND/OR OMISSIONS.
- [06] BENTON COUNTY MAP NO. 10-7-00013 BY W. C. GALLOWAY, COUNTY ENGINEER, DATED DECEMBER 9, 1947. 1-1/4" GALVANIZED PIPE. FIR 4" DIA (GLO BT) BEARS N29°E, 0.18 CHAINS (11.88 FEET), STUMP; W. FIR 8" DIA BEARS N22°E, 0.316 CHAINS (20.86 FEET); W. FIR 9" DIA BEARS S48°W, 0.386 CHAINS (25.48 FEET); FIR 15" DIA BEARS N70°E, 0.464 CHAINS (30.62 FEET), MARKED "S". 1/2" IRON PIPE BEARS N2°49-1/2'E, 405.6 FEET.
- [07] BENTON COUNTY SURVEY NO. 2952 BY LOUIS W. AMORT, P.E., DATED MARCH, 1957. FOUND 1-1/4" IRON PIPE.
- [08] BENTON COUNTY SURVEY NO. 3983 BY HOWARD E. TAYLOR, P.E., DATED JULY 11, 1964. FOUND 1" PIPE. NEW 4" X 4" WHITE POST. 2 NEW SCRIBED BEARING TREES.
- [09] BENTON COUNTY SURVEY NO. 7793 BY NORMAN D. SPRINGER, P.L.S., DATED JANUARY 6, 1986. FOUND 1-1/4" IRON PIPE.
- [10] BENTON COUNTY SURVEY NO. 8120 BY MARK E. STEELE, P.L.S., DATED MARCH 16, 1988. FOUND 1-1/2" OUTSIDE DIAMETER GALVANIZED PIPE, 5 BEARING TREES.
- [11] BENTON COUNTY CORNER RESTORATION NO. 3504 BY MARK E. STEELE, P.L.S., DATED MARCH 16, 1988. ROTTEN FIR STUMP 34" DIA (GLO BT) BEARS N29°E, 18 LINKS (11.88 FEET). 1-1/4" GALVANIZED IRON PIPE FROM WHICH 12.5" GRAND FIR WITH HEALED FACE (CSBT) BEARS N22°E, 0.316 CHAINS (20.86 FEET); ROTTEN GRAND FIR STUMP (CSBT) BEARS S48°W, 0.386 CHAINS (25.48 FEET); D. FIR 38" DIA (CSBT) WITH HEALED FACE BEARS N70°E, 0.464 CHAINS (30.62 FEET). D. FIR 5" DIA BEARS S18°W, 38.15 FEET TO A WASHER NAILED IN FACE, SCRIBED "1/4 S25 BT", WASHER IS MARKED "RS 2016".
- [12] BENTON COUNTY CORNER RESTORATION NO. 3504. TRANSCRIBED FROM RECORD [11] AND MAY CONTAIN ERRORS AND/OR OMISSIONS.
- [13] BENTON COUNTY CORNER RESTORATION NO. 3870 BY DANNA L. FEHRENBACHER, C.S., DATED JANUARY 9, 1991. FOUND 1-1/2" INSIDE DIAMETER IRON PIPE FOR THE CORNER. THERE IS A WHITE 4" X 4" WOOD POST 4.5 FEET HIGH LOCATED 1.3 FEET SOUTHWESTERLY FROM THE STONE. FOUND MOSTLY ROTTED FIR STUMP ABOUT 36" DIA WITH SOME CHOP MARKS VISIBLE (GLO BT) BEARS N33°E, 11.9 FEET. FOUND GRAND FIR 13" DIA WITH A HEALED FACE (CSBT) BEARS N26°E, 20.86 FEET. SET PK NAIL AND BRASS WASHER STAMPED "BENTON COUNTY SURVEYOR" (BCBW) IN THE SOUTHEASTERLY BASE. FOUND PARTLY ROTTED GRAND FIR STUMP 16" DIA (CSBT) BEARS S49°W, 25.5 FEET. FOUND FIR 40" DIA WITH A HEALED FACE ON THE WESTERLY AND SOUTHERLY SIDES (CSBT) BEARS N74°E, 30.62 FEET. SET PK NAIL AND BCBW IN THE SOUTHERLY BASE. FOUND FIR 8" DIA WITH A PARTLY HEALED OVER FACE AND SOME ILLEGIBLE SCRIBING VISIBLE BEARS S13°W, 38.30 FEET. FOUND PK NAIL AND WASHER IN THE BASE OF THE FACE. SET PK NAIL AND BCBW IN THE EASTERLY BASE. SET 3-1/4" BENTON COUNTY BRASS CAP STAMPED "T10S R7W R6W S25 1/4 S30 1/4 1991" CENTERED IN THE RECOVERED 1-1/2" PIPE. AN ALDER 13" DIA BEARS S68°E, 48.45 FEET, FACED AND SCRIBED "1/4 S30 BT". SET PK NAIL AND BCBW IN THE SOUTHERLY BASE. AN ALDER 20" DIA BEARS N45°W, 44.03 FEET, FACED AND SCRIBED "1/4 S25 BT". SET A PK NAIL AND BCBW IN THE NORTHEASTERLY BASE. SET ORANGE FIBERGLASS "SURVEY MARKER" POST 1 FOOT NORTHERLY.

**FIRM/AGENCY:** BENTON COUNTY SURVEYOR'S OFFICE**ADDRESS:** 360 S.W. AVERY AVE., CORVALLIS, OR 97333; PH. 541-766-6821**RESEARCH BY:** DAVID L. MALONE, P.L.S.**DATA ENTRY BY:** SAME

BENTON COUNTY CORNER RESTORATION FORM

3870

SECTION 30 TOWNSHIP 10 S RANGE 6 W DLC

106100240  
CORNER W 1/4

DATE 1/9/91 CORNER RESTORATION FIELD BOOK NUMBER 2 PAGE 24

CORNER DESIGNATION:

R7W | R6W | \_\_\_\_\_ CONDITION REPORT ONLY  
THE WEST 1/4 CORNER FOR SECTION 30, IN T 10 S, R 6 W, S25 REFERENCED OUT  
AND THE EAST 1/4 CORNER FOR SECTION 25, IN T 10 S, 1/4 S30  
R 7 W, WILLAMETTE MERIDIAN. 1/4 1/4 RENEWED XX

LOCATION AND COMMENTS: \_\_\_\_\_ SURVEYED IN \_\_\_\_\_

THE CORNER IS LOCATED ON A MODERATE NORTHERLY SLOPE AT THE NORTHERLY EDGE OF A CLEAR CUT. APPROXIMATELY 100 FEET WESTERLY FROM A SMALL UNNAMED CREEK. THE CLEAR CUT WAS REPLANTED ABOUT 15 YEARS AGO.

PREVIOUS RENEWALS/SURVEYS, ETC.:

ORIGINAL GLO SURVEY BY DENNIS MURPHY IN 1854.  
CORNER RESTORATION NO. 384 BY W.C. GALLOWAY IN 1941.  
COUNTY SURVEY NO. 2952 BY LOUIS W. AMORT IN MARCH OF 1957.  
COUNTY SURVEY NO. 7793 BY NORM SPRINGER ON JANUARY 6, 1986.  
COUNTY SURVEY NO. 8120 BY MARK STEELE ON MARCH 16, 1988.  
CORNER RESTORATION NO. 3504 BY MARK STEELE ON MARCH 16, 1988.

MONUMENTS AND ACCESSORIES FOUND (CONDITION AND SOURCE):

- FOUND: 1 1/2" INSIDE DIAMETER IRON PIPE FOR THE CORNER (CORNER RESTORATION NO. 384). THERE IS A WHITE 4" X 4" WOOD POST 4.5 FEET HIGH LOCATED 1.3 FEET SOUTHWESTERLY FROM THE STONE.
- FOUND: A MOSTLY ROTTED FIR STUMP ABOUT 36" IN DIAMETER WITH SOME CHOP MARKS VISIBLE BEARS N 33° E 11.9 FEET (N 29° E 11.88 11.9 FEET ORIGINAL GLO SURVEY). SET A B.T. TAG ON THE SOUTHWESTERLY FACE.
- FOUND: A GRAND FIR 13" IN DIAMETER WITH A HEALED FACE BEARS N 26° E 20.86 FEET (N 22° E 20.86 FEET CORNER RESTORATI NO. 384). SET A PK NAIL AND B.C.B.W. IN THE SOUTHEASTERLY BASE. SET A B.T. TAG ON THE SOUTHWESTERLY FACE.
- FOUND: A PARTLY ROTTED GRAND FIR STUMP 16" IN DIAMETER BEARS S 49° W 25.5 FEET (S 48° W 25.48 FEET CORNER RESTORATION NO. 384). SET A B.T. TAG ON TOP.
- FOUND: A FIR 40" IN DIAMETER WITH A HEALED FACE ON THE WESTERLY AND SOUTHERLY SIDES BEARS N 74° E 30.62 FEET (N 70° E 30.62 FEET CORNER RESTORATION NO. 384). SET A PK NAIL AND B.C.B.W. IN THE SOUTHERLY BASE. FOUND A B.T. TAG ON THE WESTERLY FACE, SET A NEW TAG BELOW IT.
- FOUND: A FIR 8" IN DIAMETER WITH A PARTLY HEALED OVER FACE AND SOME ILLEGIBLE SCRIBING VISIBLE BEARS S 13° W 38.30 FEET (S 18° W 38.15 FEET TO A NAIL AND WASHER IN THE FACE CORNER RESTORATION NO. 3504). FOUND A PK NAIL AND WASHER IN THE BASE OF THE FACE. SET A PK NAIL AND B.C.B.W. IN THE EASTERLY BASE. FOUND A B.T. TAG ON THE NORTHERLY FACE, SET A NEW B.T. TAG BELOW IT.

NO OTHER RECORD BEARING OBJECTS WERE RECOVERED.

MONUMENT DETAIL

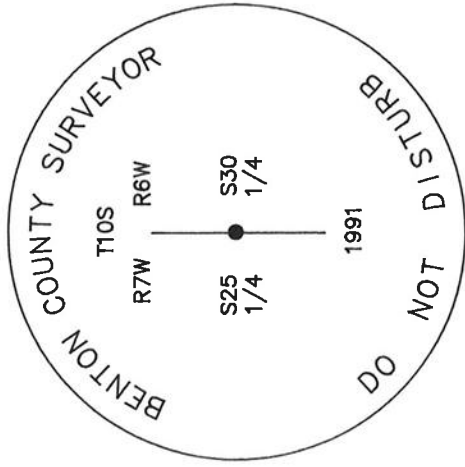

3 1/4" BRASS CAP

SKETCH

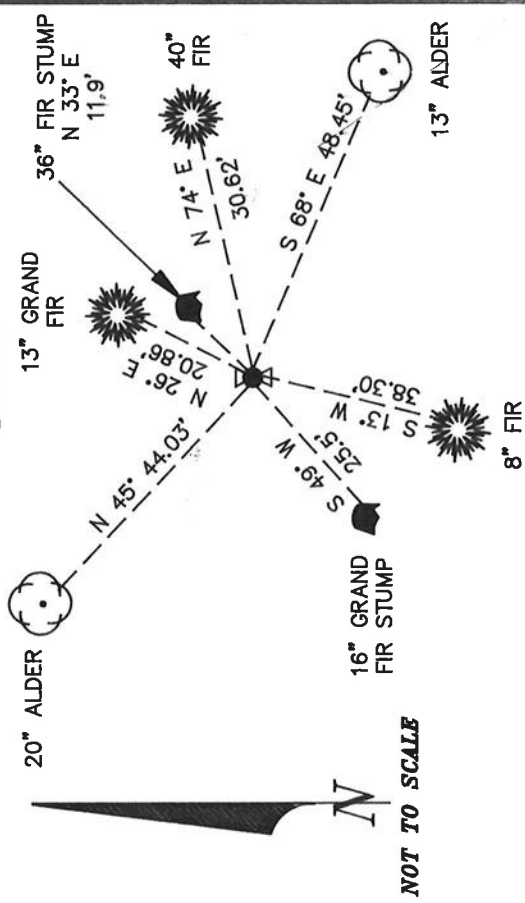

NOT TO SCALE

MONUMENT SET (PROCEDURES AND DESCRIPTION):

SET: A 3 1/4" BENTON COUNTY BRASS CAP STAMPED AS SHOWN CENTERED IN THE RECOVERED 1 1/2" PIPE.

NEW ACCESSORIES:

- AN ALDER 13" IN DIAMETER BEARS S 68° E 48.45 FEET FACED AND SCRIBED \*1/4 S30 BT". SET A PK NAIL AND B.C.B.W. IN THE SOUTHERLY BASE. SET A B.T. TAG ON THE WESTERLY FACE.
- AN ALDER 20" IN DIAMETER BEARS N 45° W 44.03 FEET FACED AND SCRIBED \*1/4 S25 BT". SET A PK NAIL AND B.C.B.W. IN THE NORTHEASTERLY BASE. SET A B.T. TAG ON THE SOUTHEASTERLY FACE.

SET: ORANGE FIBERGLASS "SURVEY MARKER" POST 1 FOOT NORTHERLY.

NOTES:

B.C.B.W. IS A BRASS WASHER STAMPED "BENTON COUNTY SURVEYOR". COM-PASS DECLINATION IS 20° EAST. ALL MEASURED DISTANCES AND COMPASS BEARINGS ARE TO THE CENTER OF THE OBJECT, UNLESS OTHERWISE NOTED.

REGISTERED  
PROFESSIONAL  
LAND SURVEYOR

*Danna G. Jehrensbafer*

OREGON  
JULY 16, 1982  
DANNA L. FEHRENBACHER  
1995

FIRM/AGENCY: BENTON COUNTY PUBLIC WORKS  
ADDRESS: 360 S.W. AVERY AVE. CORVALLIS OR. 97333; PH. 757-6821  
PARTY CHIEF: CURTIS J. LIESENFELT  
CREW: MARK E. ANDERSON  
WITNESS:

1/9/91, CTR W, MEAD, SILVER CORR 20°E, DEC, CLOY, COLD 2/24

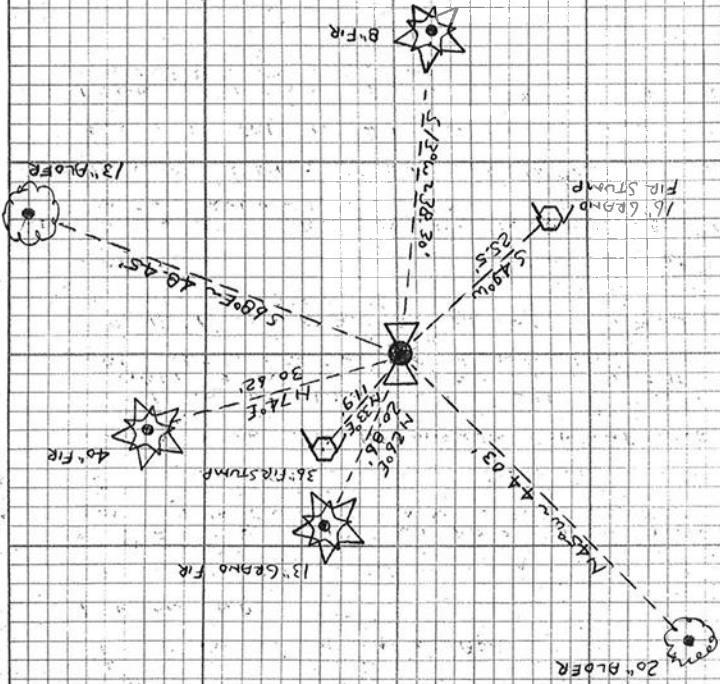

1991  
 525 530  
 1/4 114  
 C/P  
 STAMPINGS  
 T105  
 R7W R6W

T105 R6W SEC 30 W 1/4 COR

FNO: 1/2" 1.0 I.P. FOR THE COR. (COR. REST. NO. 384)

THERE IS A WHITE 4" x 4" WOOD POST 4.5" HIGH THAT IS 1.3 SWLY & IS A GUARD.

" A MOSTLY ROTTED FIR STUMP ABOUT 3.8" IN DIA. @ SOME TOP MARKS VISIBLE GEARS N 33° E ~ 11.9' (N 29° E ~ 11.88' ORIG. 6.10. SURVEY). SET A B.T. TAB ON THE SWLY FACE.

" A 60MM FIR 13" IN DIA. @ A HEALED FACE GEARS N 26° E ~ 20.86' (N 22° E ~ 20.86' COR. REST. NO. 384). SET A PK & B.C. BLW IN THE SWLY FACE. SET A B.T. TAB ON THE SWLY FACE.

" A PARTLY ROTTED GERANO FIR STUMP 18" IN DIA. BEARS S 49° W ~ 25.15' (S 48° W ~ 25.48 COR. REST. NO. 384). SET A B.T. TAB ON TOP.

" A FIR 40" IN DIA. @ A HEALED FACE ON THE WLY & SWLY SIDES BEARS N 74° E ~ 30.62' (N 70° E ~ 30.62' COR. REST. NO. 384). SET A PK & B.C. BLW IN THE SWLY FACE. FNO. A B.T. TAB ON THE WLY FACE. SET A NEW TAB BELOW IT.

" A FIR 40" IN DIA. @ A HEALED OVER FACE GEARS & SOME VISIBLE SCRAPING VISIBLE GEARS S 13° W ~ 38.30' (S 18° W ~ 38.15, TO A NAIL & WASHER IN THE FACE COR. REST. NO. 3504). FNO A PK & WASHER IN THE BASE OF THE FACE. SET A PK & B.C. BLW IN THE SWLY FACE. SET A B.T. TAB BELOW IT.

NO OTHER RECORDED BEARINGS OR POINTS WERE RECOVERED.

SET: A B.T. TAB ON THE SWLY FACE AS SHOWN IN CENTERED IN THE RECOVERED 1 1/2" PIPE.

AN BLOER 13" IN DIA. BEARS S 88° E ~ 48.45' FACED & SCRIEDED "114.530 BT. SET A PK & B.C. BLW IN THE SWLY FACE. SET A B.T. TAB ON THE WLY FACE.

AN BLOER 20" IN DIA. BEARS N 45° W ~ 44.03' FACED & SCRIEDED "114.525 BT. SET A PK & B.C. BLW IN THE NWLY BASE. SET A B.T. TAB ON THE SWLY FACE.

SET: ORANGE FIBERGLASS "SURVIVY MARKER" POST 1" IN DIA. THE COR. IS LOCATED ON A MODERATE NLY SLOPE AT THE NLY EDGE OF A CLEAR CUT 100' WLY FROM A SMALL UNMOWN CREEK. THE CLEAR CUT WAS REPLENTED ABOUT 15 YEARS AGO. IT IS POOR FOR PRE-MARKING & GPS CONTROL.

## REWITNESSED CORNER FOR STATE OF OREGON-DEPARTMENT OF FORESTRY

One quarter corner common to Sections 25 and 30, Township 10 South, Ranges 6 & 7 West, W.M., Benton County, Oregon.

## ORIGINAL

Post, (missing) from which a:

- 4" Fir bears N29°E 18 lks.; now 34" rotten stump in place.
- 14" Maple bears N85°W 68 lks.; now missing.

RESTORED by W.C. Galloway, C.S., 1941.

- 1½" galvanized iron pipe, (now in place) from which a:
  - 8" W.Fir bears N22°E 0.316 chs.; now 12.5" green tree (Grand Fir) in place, face healed over.
  - 8" W.Fir bears S48°W 0.386 chs.; now 16" rotten stump in place (Grand Fir).
  - 15" R.Fir bears N70°E 0.464 chs.; now 38" green tree in place, face healed over (Douglas-fir).

## REWITNESSED

- 5" Douglas-fir bears S18°W 38.15' to a washer nailed in face, scribed 1/4 S 25 B.T., the washer is marked R.S.2016.

Oregon State Forestry Department metal location posters on the S.W. and 38" N.E. B.T.s.

Dated March 16, 1988

Rewitnessed by:



Present and witnessed by Jeff Classen

BENTON COUNTY SURVEYORS OFFICE - CORNER RESTORATION 3504

NOTE: ORIGINAL MYLAR IN NOTEBOOK

T 10 S, R 6 W, W. B. & M., BENTON COUNTY, OREGON

SECTION 30

REPORTED BY M. E. STEELE

TITLE RS 2016

DATE 3-21-88

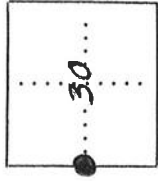

OFFICIAL CORNER FOUND

CORNER SET

1/4 CORNER COMMON TO SEC. 25 & 30  
IS 1/4" GALV. PIPE

DESCRIBE

ADDITIONAL INFORMATION

DISTANCE TO NEW BT IS  
MEASURED TO WASHER NAILED IN  
FACE.

LEGIBLE MARKS ON BEARING OBJECTS

(ORIG)	(C.S.)	(New)	(C.S.) (C.S.)
NO	Healed face	1/4 S25 BT washer & nail marked RS 2016	face Healed NO
ROTTEN FIR STUMP	D. FIR	D. FIR	G. FIR
34"	38"	5"	12" 16"
BEARING N29°E	N70°E	S18°W	N22°E S48W
DISTANCE 18 LKS	0.467 CHS	38.15'	0.316 CHS 0.386 CL
BT TAG POSTED	✓	✓	

OVER

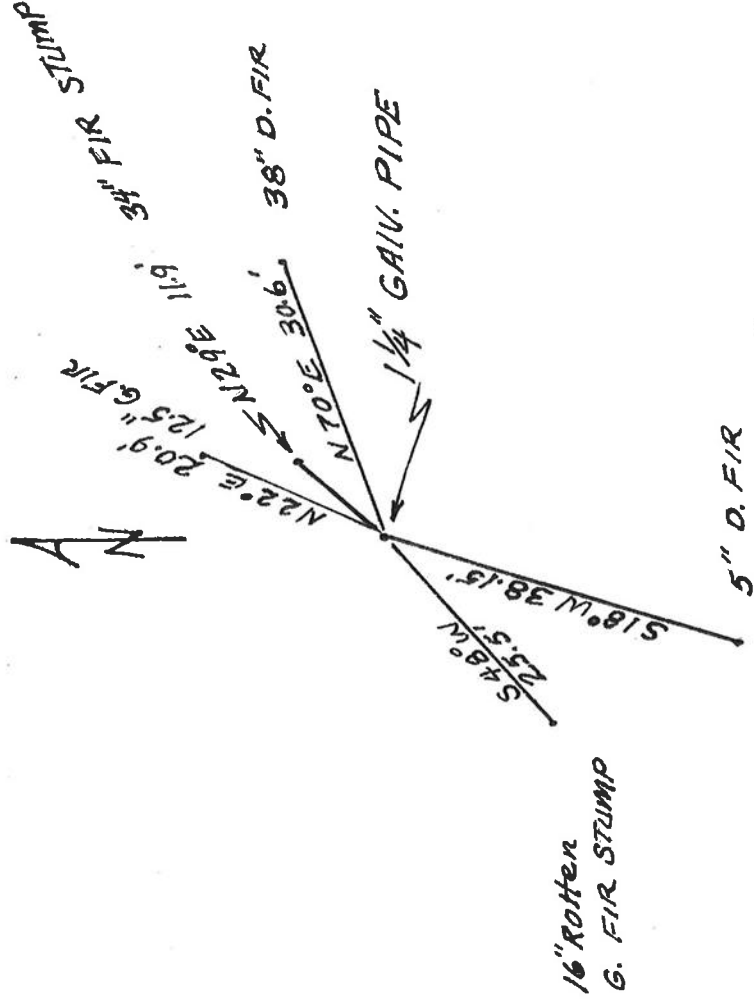



C.S. #278  
M.L. Beyerlein  
Otto Ziemke  
2-9-51

S. S.E. Cor. James L. Bounds D.L.C. # 69, Twp. 12 S., R. 6 W.  
Found accepted Stone (Orig was post)  
Oak 20" N. 87° 48' E. 0.867 to center (N 85° E. 0.87 orig)  
" 18" N. 11° 29' E. 0.667 " " stump (N. 12° E. 0.67 orig)

"

Int. Cor. James L. Bounds D.L.C. # 69, Twp. 12 S., R. 6 W.  
Set ¾" rod in part. 6.6' so of E of oil.  
No trees near.

"

E. S. E. Cor. James L. Bounds D.L.C. # 69, Twp. 12 S., R. 6 W.  
Set ¾" rod in place of old out stake  
Fir 36" S. 90° W. 0.17 Dead snag  
Alder 9" N. 8° 43' W. 0.27 (In old B.T. hole)  
Fir 8" S. 28° 19' E. 0.198

C.S. #198  
M.L. Beyerlein  
Otto Ziemke  
3-15-51

N.-E. Cor. Robert Barrett D.L.C. # 71, Twp. 12 S., R. 6 W.

Set Car Axle

Oak 11" S. 88° 20' W. 39.3'  
" 8" N. 41° 10' E. 70'  
" 13" S. 8° 40' E. 35.0'

Route 59  
W.C.G.

¼ Sec. Cor. between Sec 30, Twp. 10 S., R. 6 W. & 25, Twp. 10 S., R. 7 W.

1981

Set 14" Galv. Pipe from Fir 4" N. 29° E. 0.18 (Stump, - Maple gone)

W. Fir 8" N. 22° E. 0.316  
" " S. 48° W. 0.386  
R. " 15" N. 70° E. 0.464 M.S.

(Road # 626-016)



C.S. #294  
W.C.G.  
3-17-53

N.W. Cor. John Clifton D.L.C. No. 42, Twp. 13 S., R. 6 W.

Set 1¼" Shaft

(Prostrate Distance)  
No B.T.s

C.S. No. 55  
M.L. Beyerlein  
C.H. Ames

¼ Sec. Cor. between Secs 7 & 8, Twp. 14 S., R. 8 W.

Set ¾" rod

Fir 24" N. 56° W. 0.56 std  
" Stump 29" S. 40° E. 0.12 "  
" 18" N. 87° E. 414 (0.39) "

1/4 Section Corner between Section 30, Twp. 10S., R. 6 W., and Section 25,  
Twp. 10 S., R. 7 W.

Established by W. C. Galloway -- 1941

Set 1 $\frac{1}{4}$ " Galv. pipe from Fir 4" N. 29° E. 0.18 (Stump--Maple gone)

W. Fir 8" N. 22° E. 0.316

W. Fir 8" S. 48° W. 0.386

R. Fir 15"N. 70° E. 0.464 Mk S.



1/4-Section corner between section 30, Twp. 10-6 and 25, Twp. 10-7

285

Reestablishment by W. C. Galloway

1941,

Set 1 1/4" galvanized pipe from Fir 4" bearing N 29° E

0.18 chains

W. Fir 8" in diam bears N 22° E

0.316 chains

W. Fir 8" in diam bears S 48° W

0.386 chains

R. Fir 15" in diam bears N 70° E

0.464 chains