

**106140200**

DATE 05/04/2021TOWNSHIP 10 SOUTH, RANGE 6 WEST, WILLAMETTE MERIDIAN; SECTION 30 CORNER SOUTH 1/4  
DONATION LAND CLAIM N/A CORNER N/A**COMMON CORNER(S):**

NORTH 1/4 CORNER SECTION 31

**RECORDS (INFORMATION IN *BOLD ITALICS* IS COUNTY STAFFS' INTERPRETATION OF THE RECORD)**

BASED ON EXTENSIVE RESEARCH AND RECOVERY OF EVIDENCE, THIS OFFICE HAS DETERMINED THAT MOST GENERAL LAND OFFICE SURVEYORS IN BENTON COUNTY BEFORE 1890 MEASURED TO THE FACE OF BEARING TREES.

- [01] GENERAL LAND OFFICE (GLO) NOTES BY ALLECK C. SMITH, D.S., DATED MAY 28, 1857. *SET POST FROM WHICH A MAPLE 4" DIA BEARS N87°W, 40 LINKS (26.40 FEET); FIR 4 FEET DIA BEARS S80°E, 25 LINKS (16.50 FEET).*
- [02] BENTON COUNTY SURVEY NO. 252 (OLD NO. 98) FIELD NOTES (FIELD BOOK 7, PAGE 74) BY J. A. GANONG, D.C.S., DATED MAY 19, 1911. *SET STONE 4" X 8" X 12". SOUTHEAST TREE STANDING. MARKED FIR 5 FEET DIA BEARS N29-3/4°E, 0.930 CHAINS (61.38 FEET).*
- [03] BENTON COUNTY CORNER RESTORATION BOOK NO. 1, PAGE 4, BY J. A. GANONG, D.C.S., DATED MAY 19, 1911. *SET MARKED STONE 12" X 8" X 4" FOR CORNER FROM WHICH A FIR 60" DIA (CSBT) BEARS N29-3/4°E, 93 LINKS (61.38 FEET). SOUTHEAST TREE STANDING.*
- [04] BENTON COUNTY CORNER RESTORATION NO. 383. *TRANSCRIBED FROM RECORD [03] AND MAY CONTAIN ERRORS AND/OR OMISSIONS.*
- [05] BENTON COUNTY SURVEY NO. 651-A (OLD NO. 276) MAP BY W. C. GALLOWAY, C.S., DATED MARCH 26, 1919. *STONE 4" X 8" X 12". FIR 60" DIA (CSBT) BEARS N29°45'E, 0.93 CHAINS (61.38 FEET), MARKED 1911; FIR 4" DIA (GLO BT) BEARS S80°E, 0.25 CHAINS (16.50 FEET), MARKED ABOUT 1852.*
- [06] BENTON COUNTY MAP NO. 10-6-00014 BY W. C. GALLOWAY, C.S., DATED MARCH 26, 1919. *STONE 4" X 8" X 12". FIR 60" DIA (CSBT) BEARS N29°45'E, 0.93 CHAINS (61.38 FEET); FIR 4" DIA (GLO BT) BEARS S80°E, 0.25 CHAINS (16.50 FEET), STANDING.*
- [07] BENTON COUNTY CORNER RESTORATION NO. 3506, REWITNESSED CORNER FOR STATE OF OREGON DEPARTMENT OF FORESTRY BY MARK E. STEELE, P.L.S., DATED MARCH 16, 1988. *HOLLOW BURNED OUT FIR STUMP 60" DIA (GLO BT) BEARS S81°15'E, 16.75 FEET TO CENTER, NO SCRIBES VISIBLE. STONE 12" X 8" X 4" IN PLACE WITH "X" MARKED ON TOP, FROM WHICH A HOLLOW BURNT OUT FIR STUMP 60" DIA (CSBT) BEARS N31°55'E, 53.6 FEET TO CENTER, NO SCRIBE VISIBLE. FIR 19" DIA BEARS S80°W, 41.7 FEET TO A WASHER NAILED IN FACE, SCRIBED "1/4 S31 BT", WASHER MARKED "R.S.2016"; FIR 15" DIA BEARS S55°E, 50.5 FEET TO A WASHER NAILED IN FACE, SCRIBED "1/4 S31 BT", WASHER MARKED "R.S.2016".*
- [08] BENTON COUNTY CORNER RESTORATION NO. 3506. *TRANSCRIBED FROM RECORD [07] AND MAY CONTAIN ERRORS AND/OR OMISSIONS.*
- [09] BENTON COUNTY SURVEY NO. 8120 BY MARK E. STEELE, P.L.S., DATED MARCH 16, 1988. *FOUND 11" X 8" X 12" STONE "X", 4 BEARING TREES.*
- [10] BENTON COUNTY SURVEY NO. 8422 BY JIM S. PETERSON, P.L.S., DATED MAY 18, 1990. *FOUND MARKED STONE. SET 5/8" X 30" IRON ROD WITH PLASTIC CAP MARKED "LS1084" BEARS S89°41'31"E, 6.01 FEET.*
- [11] BENTON COUNTY CORNER RESTORATION NO. 3869 BY DANNA L. FEHRENBACHER, C.S., DATED JANUARY 8, 1991. *FOUND A 4" X 8" X ? STONE WITH AN "X" CUT IN THE TOP CENTER FOR THE CORNER. THERE IS A "CS" CARVED IN THE WESTERLY SIDE. FOUND A BURNT OUT AND HOLLOW ROOT CROWN FOR A FIR ABOUT 60" DIA (GLO BT) BEARS S76°E, 17.5 FEET. FOUND A BURNT OUT AND HOLLOW FIR STUMP ABOUT 60" DIA (CSBT) BEARS N35°E, 54 FEET. FOUND A FIR 16" DIA WITH A PARTLY HEALED FACE BEARS S58°E, 50.95 FEET. SET A PK NAIL AND BRASS WASHER STAMPED "BENTON COUNTY SURVEYOR" (BCBW) IN THE NORTHEASTERLY BASE. FOUND A FIR 21" DIA WITH A PARTLY HEALED FACE WITH SOME ILLEGIBLE SCRIBING AND A PK NAIL AND WASHER VISIBLE BEARS S80°W, 42.65 FEET. SET A PK NAIL AND BCBW IN THE NORTHWESTERLY BASE. FOUND 5/8" REBAR WITH A YELLOW PLASTIC CAP MARKED "LS 1084" BEARS S90°E, 6.00 FEET. USED THE STONE AS RECOVERED FOR THE CORNER MONUMENT. FIR 7" DIA BEARS N11°E, 49.95 FEET, FACED AND SCRIBED "1/4 S30 BT". SET A PK NAIL AND BCBW IN THE EASTERLY BASE. FIR 15" DIA BEARS N67°W, 40.42 FEET, FACED AND SCRIBED "1/4 S30 BT". SET A PK NAIL AND BCBW IN THE SOUTHWESTERLY BASE. SET ORANGE FIBERGLASS " SURVEY MARKER" POST 1 FOOT NORTHERLY.*
- [12] BENTON COUNTY PARTITION PLAT 1993-35 BY JIM S. PETERSON, P.L.S., DATED OCTOBER 1, 1993. *FOUND BENTON COUNTY BRASS CAP. FOUND 5/8" IRON ROD BEARS S89°41'22"E, 6.01 FEET.*

**FIRM/AGENCY:** BENTON COUNTY SURVEYOR'S OFFICE  
**ADDRESS:** 360 S.W. AVERY AVE., CORVALLIS, OR 97333; PH. 541-766-6821  
**RESEARCH BY:** DAVID L. MALONE, P.L.S.  
**DATA ENTRY BY:** SAME

BENTON COUNTY CORNER RESTORATION FORM

3869  
106140200  
CORNER S 1/4

SECTION 30 TOWNSHIP 10 S RANGE 6 W DLC \_\_\_\_\_  
DATE 1/8/91 CORNER RESTORATION FIELD BOOK NUMBER 2 PAGE 23

CORNER DESIGNATION:

THE QUARTER CORNER COMMON TO SECTIONS 30 AND 31,  
IN T 10 S, R 6 W, WILLAMETTE MERIDIAN.



- \_\_\_\_\_ CONDITION REPORT ONLY
- REFERENCED OUT
- \_\_\_\_\_ RENEWED
- \_\_\_\_\_ SURVEYED IN

LOCATION AND COMMENTS:

THE CORNER IS LOCATED ON A STEEP NORTHERLY SLOPING WOODED HILLSIDE, APPROXIMATELY 100 FEET SOUTHEASTERLY FROM THE BOTTOM OF A DRAW AND APPROXIMATELY 1000 FEET SOUTHWESTERLY FROM ALEXANDER ROAD (COUNTY ROAD NO. 16530).

PREVIOUS RENEWALS/SURVEYS, ETC:

- ORIGINAL GLO SURVEY BY ALLECK C. SMITH IN 1856.
- CORNER RESTORATION NO. 383 BY J.A. GANONG ON MAY 19, 1911.
- CORNER RESTORATION NO. 3506 BY MARK STEELE ON MARCH 16, 1988.
- COUNTY SURVEY NO. 8120 BY MARK STEELE ON MARCH 16, 1988.
- COUNTY SURVEY NO. 8422 BY JIM S. PETERSON ON JUNE 13, 1990.

MONUMENTS AND ACCESSORIES FOUND (CONDITION AND SOURCE):

- FOUND: 4" X 8" X ? STONE WITH AN "X" CUT IN THE TOP CENTER FOR THE CORNER (CORNER RESTORATION NO. 383). THERE IS A "CS" CARVED IN THE WESTERLY SIDE.
- FOUND: A BURNT OUT AND HOLLOW ROOT CROWN FOR A FIR ABOUT 60" IN DIAMETER BEARS S 76° E 17.5 FEET (S 80° E 16.5 FEET ORIGINAL GLO SURVEY).
- FOUND: A BURNT OUT AND HOLLOW FIR STUMP ABOUT 60" IN DIAMETER BEARS N 35° E 54 FEET (N 31° 55' E 53.6 FEET CORNER RESTORATION NO. 3506).
- FOUND: A FIR 16" IN DIAMETER WITH A PARTLY HEALED FACE BEARS S 58° E 50.95 FEET (S 55° E 50.5 FEET TO A NAIL AND WASHER IN THE FACE CORNER RESTORATION NO. 3506). SET A PK NAIL AND B.C.B.W. IN THE NORTHEASTERLY BASE. FOUND A B.T. TAG ON THE NORTHWESTERLY FACE, SET A NEW TAG BELOW IT.
- FOUND: A FIR 21" IN DIAMETER WITH A PARTLY HEALED FACE WITH SOME ILLEGIBLE SCRIBING AND A PK NAIL AND WASHER VISIBLE BEARS S 80° W 42.65 FEET (S 80° W 41.7 FEET TO THE PK NAIL AND WASHER CORNER RESTORATION NO. 3506). SET A PK NAIL AND B.C.B.W. IN THE NORTHWESTERLY BASE. FOUND A B.T. TAG ON THE EASTERLY FACE, SET A NEW TAG BELOW IT.
- FOUND: 5/8" REBAR WITH A YELLOW PLASTIC CAP MARKED "LS 1084" BEARS S 90° E 6.00 FEET (S 89° 41' 31" E 6.01 FEET COUNTY SURVEY NO. 8422).

NO OTHER RECORD BEARING OBJECTS WERE RECOVERED.

MONUMENT DETAIL



SKETCH

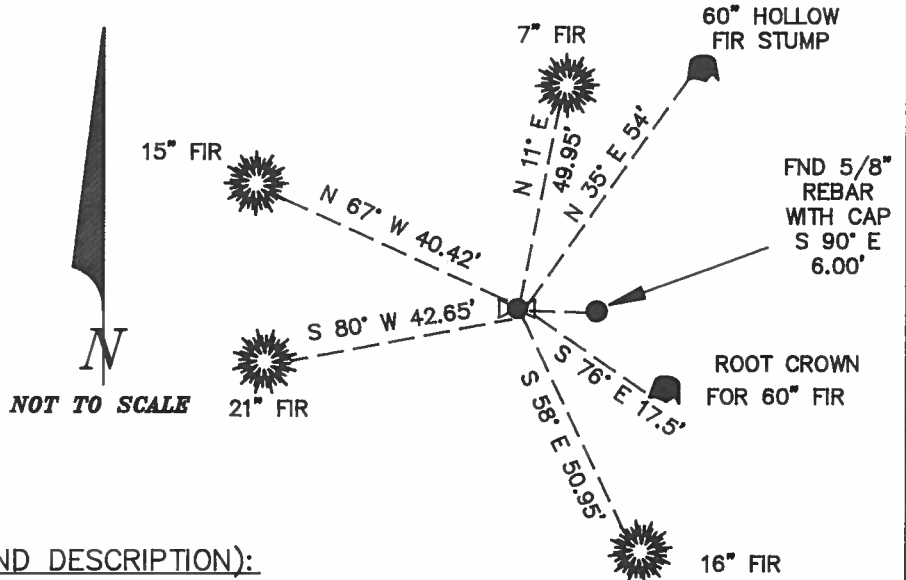

MONUMENT SET (PROCEDURES AND DESCRIPTION):

USED THE STONE AS RECOVERED FOR THE CORNER MONUMENT.

NEW ACCESSORIES:

- A FIR 7" IN DIAMETER BEARS N 11° E 49.95 FEET FACED AND SCRIBED "1/4 S 30 BT". SET A PK NAIL AND B.C.B.W. IN THE EASTERLY BASE. SET A B.T. TAG ON THE SOUTHERLY FACE.
- A FIR 15" IN DIAMETER BEARS N 67° W 40.42 FEET FACED AND SCRIBED "1/4 S 30 BT". SET A PK NAIL AND B.C.B.W. IN THE SOUTHWESTERLY BASE. SET A B.T. TAG ON THE SOUTHEASTERLY FACE.
- SET: ORANGE FIBERGLASS "SURVEY MARKER" POST 1 FOOT NORTHERLY.

NOTES:

B.C.B.W. IS A BRASS WASHER STAMPED "BENTON COUNTY SURVEYOR". COMPASS DECLINATION IS 20° EAST. ALL MEASURED DISTANCES AND COMPASS BEARINGS ARE TO THE CENTER OF THE OBJECT, UNLESS OTHERWISE NOTED.

FIRM/AGENCY: BENTON COUNTY PUBLIC WORKS  
 ADDRESS: 360 S.W. AVERY AVE. CORVALLIS OR. 97333; PH. 757-6821  
 PARTY CHIEF: CURTIS J. LIESENFELT  
 CREW: MARK E. ANDERSON  
 WITNESS:

REGISTERED  
PROFESSIONAL  
LAND SURVEYOR

*Danna L. Fehrenbacher*

OREGON  
JULY 16, 1982  
DANNA L. FEHRENBACHER  
1995

11/18/19 CUTLY AREA @ SILVA CAMP 20° E DEC, EUDY 2723

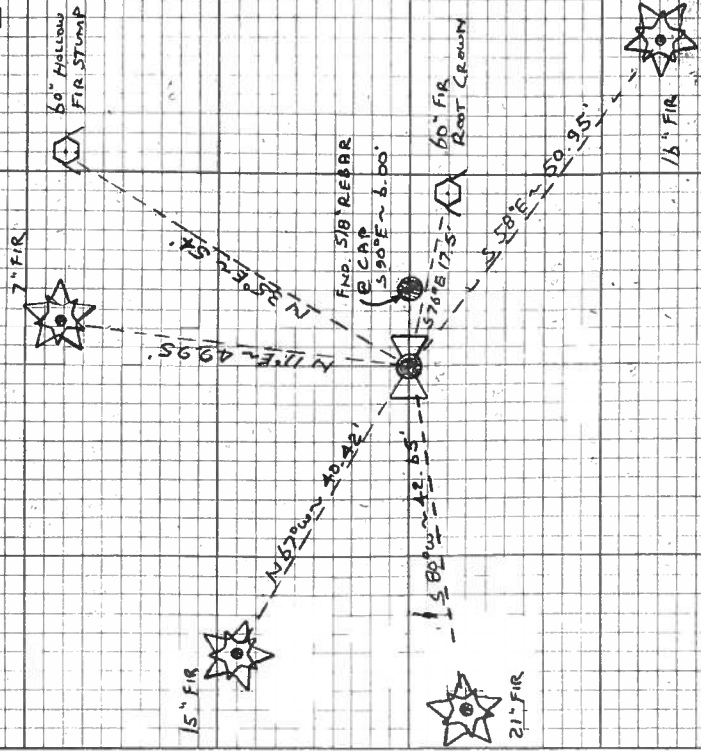

NO BRASS  
CAP WAS  
SET

THOSE RAIL SEE TO SILVA CAMP

1. A BURNT STONE AT CUT IN THE SWA  
COR FOR THE CAR REST NO. 303. THERE IS A  
KEY CARVED IN THE SW SIDE.

2. A BURNT OUT HOLLOW ROOT CROWN FOR A FIR ABOUT  
60" IN DIA BEARS S 76° E 17.5' (S 80° E 17.5'  
ORIG GLO SURVEY)

3. A BURNT OUT HOLLOW FIR STUMP ABOUT 10" IN  
DIA BEARS N 35° E 58' (N 31° S 58' COR  
REST NO. 3526)

4. A FIR 16" IN DIA A PARTLY HEALED FACE BEARS  
S 50° E 50.95' (S 55° E 50.5' TO NAIL QUARTER IN FACE  
COR REST NO. 3508) SET A PK W B.C. B.W. IN THE NE 1/4  
BASE END A B.T. TAG ON THE NW 1/4 FACE SET A NAIL  
TAG BELOW IT

5. A FIR 21" IN DIA @ A PARTLY HEALED FACE @ SOME  
ILLEGIBLE SCRIBING & A PK NAIL W WASHER VISIBLE  
BEARS S 80° W 42.05' (S 80° W 41.7' TO THE PK  
NAIL W WASHER COR REST NO. 3508) SET A PK W  
B.C. B.W. IN THE NW 1/4 BASE END A B.T. TAG ON  
THE SW FACE SET A NEW TAG BELOW IT.

6. A REBAR @ A Y.P.C. MID "BENTLS 1084" BEARS  
S 90° E 6.00' (E 58° 41' 31" E ~ 6.01' C.S. B. 22)

NO OTHER RECORD BEARING OBJECTS WERE RECOVERED

USED THE STONE AS RECOVERED FOR THE MONUMENT

A FIR 7" IN DIA BEARS N 11° E 49.95' FACED & SCRIBED  
"16530 BT" SET A PK W B.C. B.W. IN THE SW 1/4 BASE  
SET A B.T. TAG ON THE SW FACE

A FIR 15" IN DIA BEARS N 17° W 40.42' FACED & SCRIBED  
"16530 BT" SET A PK W B.C. B.W. IN THE SW 1/4 BASE  
SET A B.T. TAG ON THE SW FACE

SET ORANGE FIBERGLASS SURVEY MARKER POST 1' IN 1/4

THE COR IS LOCATED ON A STEEP N W SLOPING WOODED  
HILLSIDE 100' ± SW FROM THE BOTTOM OF A DRAW  
& 100' ± SW FROM ALEXANDER RD (CO. RD. NO.  
16520) IT IS POOR FOR REMARKING & GAS CONTROL.

**REWITNESSED CORNER FOR STATE OF OREGON-DEPARTMENT OF FORESTRY**

One quarter corner common to Sections 30 and 31, Township 10 South, Range 6 West, W.M., Benton County, Oregon.

**ORIGINAL**

Post, (now missing) from which a:

- 4" Maple bears N87°W 40 lks.; now missing.
- 4" Fir bears S80°E 25 lks.; now a 60" hollow burned out stump S81° 15'E 16.75' to center, no scribe visible.

**RESTORATION** by J.A. Ganong, C.S., 5-19-1911.

Stone (12" X 8" X 4"), (now in place with X marked on top) from which a:

- 60" Fir bears N29-3/4°E 93 lks.; now a 60" hollow burnt out stump N31-55'E 53.6' to center, no scribe visible.

**REWITNESSED**

- 19" Fir bears S80°W 41.7' to a washer nailed in face, scribed 1/4 S31 BT, the washer is marked R.S.2016.
- 15" Fir bears S55°E 50.5' to a washer nailed in face, scribed 1/4 S31 BT, the washer is marked R.S.2016.

Oregon State Forestry Department metal location poster on 15" S.E. BT.

Dated March 16, 1988

Rewitnessed by:

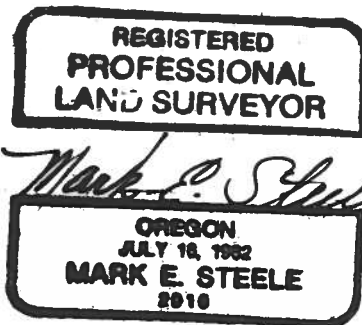

Present and witnessed by Jeff Classen

BENTON COUNTY SURVEYORS OFFICE - CORNER RESTORATION

3506

NOTE: ORIGINAL MYLAR IN

Note Book

T 10 S, R 6 W, W. B. & M., BENTON COUNTY, OREGON

REPORTED BY M. E. STEELE

SECTION 30

TITLE R.S. 2016

DATE 3-21-88

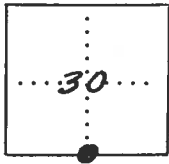

● OFFICIAL CORNER FOUND

○ CORNER SET

1/4 CORNER COMMON TO SEC. 30 & 31  
 is Stone 12"x8"x4"  
 DESCRIBE

ADDITIONAL INFORMATION

*The distance to Burned BTs was measured to center. The N.E. BT was marked by J.A. Ganong 5-19-1911 (Rest. card 383) and the distance was called 93 Lks. (now is 81 Lks.). DISTANCES TO NEW TREES ARE MEASURED TO WASHER NAILED IN FACE.*

OVER

LEGIBLE MARKS ON BEARING OBJECTS

		(NEW)	(NEW)
	NO	NO	NO
		1/4 S31 BT washer & nail marker RS2016	1/4 S31 BT washer & nail marker RS2016
KIND	Burned FIR STUMP	Burned FIR STUMP	D. FIR
SIZE	60"	60"	19"
BEARING	S81°15'E	N31°35'E	S80°W
DISTANCE	16.75'	53.61'	41.7'
BT TAG POSTED		##	✓

Survey # 98  
Jos. A. Gandy

Cor. of secs. 29-30-31+32 Tp. 10 S. R. 6 W.  
Set marked stone 10" X 8" X 6" for cor. from which  
a Fir 14 in. in dia. bears S 40° W 28 lbs. distant.  
" Fir 12 " " " N 78 3/4° W 36.5 " "  
NE tree and S.E. stump standing.  
Witnesses John Fowler, G.A. Fowler, and O. Davis May 19th 1911

1/4 cor. between secs. 30+31 Tp. 10 S. R. 6 W.  
Set marked stone 12" X 8" X 4" for cor. from which  
a Fir 60" in dia bears N 29 3/4° E 73 lbs. distant  
S.E. tree standing. Witnesses G.A. Fowler J. Fowler & O. Davis.  
May 19th 1911

CS # 97  
J. A. G.

N.W. cor. Hiram Allen D.L.C. # 55. Tp. 12 S. R. 5 W.  
Set stone 12" X 10" X 8" for cor. from which a  
W. Oak 14" in dia. bears N 49 3/4° E 77.4 lbs. distant.  
S.E. tree <sup>in road ordered out</sup> and one stump. Witnesses O.P. Davis and A. Stegerwald.  
April, 21st 1911

Int. cor. Solomon K. Brown's D.L.C. # 5K Tp. 12 S. R. 5 W.  
Set oak stake 24" X 4" X 4" for cor. from which a  
W. Oak 10" in dia. bears N 55 1/2° E 33.6 lbs. distant  
a W. Oak 16" " " " N 62 1/2° W 44.4 " "  
both stumps standing. Witnesses O.P. Davis and A. Stegerwald.  
April 21st 1911

CS # 5 (cont.)  
J. A. G.

cor. of secs 15-16-21+22 Tp. 10 S. R. 7 W.  
Set fir stake 36" X 3" X 3" for cor. from which a  
Fir 20" in dia. bears S 14 1/4° W 95.8 lbs distant.  
" 18" " " " S 78 1/2° W 265.3 " "  
" 20" " " " N 13 1/2° W 244.4 " "  
SE tree standing NE. + N.W. stump.

Witnesses Alva Dawes, A.L. Patton, Austin Shaggs.  
April, 15th 1911

1/4 cor. secs 16+21 Tp. 10 S. R. 7 W.  
Set cedar stake <sup>1 1/2" Galena found stake and replaced with 1 1/2" X 1 1/2" Skofl. Oct. 2, 1933.</sup> 36" X 4" X 4" for cor. from which a  
Fir 18" in dia. bears N 64 3/4° W E 100.5 lbs. distant  
a Fir 30" " " " S 38° E 137.2 " "  
Witnesses Alva Dawes, A.L. Patton, Austin Shaggs.  
April 15th 1911

# 58  
W.C. Galloway

S.E. cor. Mary Sylvester D.L.C. 97 Tp. 11 S. R. 4 W.  
Set <sup>Pipe</sup> stake 4" X 4" X 24" Fir stump std. <sup>in Jan. 5, 1939</sup> <sup>W. Fir 16" S 67° E 73.46 " S.</sup>  
W. fir 20" in dia. bears S 9° 45' E. 131' rotten  
" 30" " " " S. 56° 30' W. 174' gone

Witnesses Birt Reed & Elmer Maxfield Mar. 14, 1910.

Int. cor. J. W. Cook D.L.C. 86 Tp. 11- 4. Set <sup>Pipe</sup> ~~stake~~  
Maple 10" in dia. bears N. 91° 30' E. 12' std.  
W. fir 20" " " " S. 5° E. 360'  
" 24" " " " N. 76° 40' W. 680'

Witnesses Birt Reed & Elmer Maxfield Mar. 15, 1910.

1/4-Section Corner between Sections 30 and 31, Twp. 10 S R 6 W

Reestablishment by J. A. Ganong

May 19, 1911

Set marked stone 12" x 8" x 4" for corner

Fir 60" in diam bears N 29 3/4° E

93 lks. distant

S. E. tree standing

Witnesses C. A. Fowler, J. Fowler, and O. Caves