

Survey # 98
Jos. A. Gandy

Cor. of secs. 29-30-31+32 Tp. 10 S. R. 6 W.
Set marked stone 10" X 8" X 6" for cor. from which
a Fir 14 in. in dia. bears S 40° W 28 lbs. distant.
" Fir 12 " " " " N 78 3/4° W 36.5 " "
NE tree and S.E. stump standing.
Witnesses John Fowler, G.A. Fowler, and O. Joyce May 14th 1911

1/4 cor. between secs. 30+31 Tp. 10 S. R. 6 W.
Set marked stone 12" X 8" X 4" for cor. from which
a Fir 60" in dia bears N 29 3/4° E 73 lbs. distant
S.E. tree standing. Witnesses G.A. Fowler & J. Fowler & O. Joyce.
May 19th 1911

OS # 97
J.A.G.

N.W. cor. Hiram Allen D.L.C. # 55. Tp. 12 S. R. 5 W.
Set stone 12" X 10" X 8" for cor. from which a
W. Oak 14" in dia. bears N 49 3/4° E 77.4 lbs. distant.
S.E. tree ^{in road} and one stump ^{ordered out}. Witnesses O.P. Davis and A. Stegerwald.
April, 21st 1911

Int. cor. Solomon K. Brown's D.L.C. # 5X Tp. 12 S. R. 5 W.
Set oak stake 24" X 4" X 4" for cor. from which a
W. Oak 10" in dia. bears N 55 1/2° E 33.6 lbs. distant
a W. Oak 16" " " " N 62 1/2° W 44.4 " "
both stumps standing. Witnesses O.P. Davis and A. Stegerwald.
April 21st 1911

OS # 5 (cont.)
J.A.G.

cor. of secs 15-16-21+22 Tp. 10 S. R. 7 W.
Set fir stake 36" X 3" X 3" for cor. from which a
Fir 20" in dia. bears S 14 1/2° W 95.8 lbs distant.
" 18" " " " S 78 1/2° W 265.3 " "
" 20" " " " N 13 1/2° W 244.4 " "
SE tree standing NE. + N.W. stump.
Witnesses Alva Dawes, A.L. Patton, Austin Shaggs.
April, 15th 1911

1/4 cor. secs 16+21 Tp. 10 S. R. 7 W.
Set cedar stake ^{1 1/2" galvanized found stake and replaced with 1 1/2" X 3" stake.} 36" X 4" X 4" for cor. from which a ^{Oct. 2, 1933.}
Fir 18" in dia. bears N 67 3/4° W E 100.5 lbs distant
a Fir 30" " " " S 38° E 137.2 " "
Witnesses Alva Dawes, A.L. Patton, Austin Shaggs.
April 15th 1911

58
W.C. Galloway

S.E. cor. Mary Sylvester D.L.C. 97 Tp. 11 S. R. 4 W.
Set ^{Pipe} stake 4" X 24" Fir stump std. ^{in Jan. 5, 1933. 18" X 30" X 57" E 49.96' nail SE. W. fir 16" X 57" E 23.46 " S.}
W. fir 20" in dia. bears S 4° 45' E. 131' rotten
" 30" " " " S 56° 30' W. 174' gone
Witnesses Bert Reed & Oliver Maxfield Mar. 14, 1910.
Int. cor. J. W. Cook D.L.C. 86 Tp. 11 S. R. 4. Set ^{Pipe} ^{stake}
Maple 10" in dia. - bears N. 41° 30' E. 12' std.
W. fir 20" " " " S. 5° E. 360'
" 24" " " " N. 76° 40' W. 680'
Witnesses Bert Reed & Oliver Maxfield Mar. 15, 1910.

Corner of Sections 29, 30, 31, and 32, Twp. 10 S. R. 6 W

Reestablishment by J. A. Ganong

May 19, 1911

Set marked stone 10" x 8 x 6" for corner

Fir 14" in diam bears S40° W 28 lks. distant

Fir 12" in diam bears N78 3/4°W 36.5 lks. distant

N. E. Tree and S. E. stump standing

Witnesses John Fowler, C. A. Fowler, and O. Caves

382

7/2/11

BENTON COUNTY SURVEYORS OFFICE - CORNER RESTORATION

3354

T 10 S, R 6 W, W. B. & M., BENTON COUNTY, OREGON

SECTION 29

REPORTED BY Norman D. Springer

TITLE Land Surveyor

DATE January 6, 1986

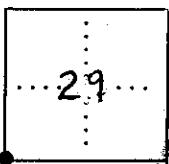

● OFFICIAL CORNER FOUND

○ CORNER SET

Sec. CORNER COMMON TO SEC. 29 30 31 & 32
 IS 5/8" X 30" Iron Rod w/Yellow Plastic Cap "LS 1102"
DESCRIBE

ADDITIONAL INFORMATION

Found Stone 10" x 8" x 6" marked
"X" on top (Hardcopy 10-6-30, 00014)

Corner is 200'± West of Creek
and 400'± S. of Alexander Rd.

OVER

LEGIBLE MARKS ON BEARING OBJECTS

	Heated face	Heated face	Wedgeable Scribing Visible	T105 R6W S30 BT
KIND	<u>Fir Stump</u>	<u>Fir Stump</u>	<u>Fir Stump</u>	<u>Fir</u>
SIZE	<u>48"</u>	<u>45"</u>	<u>20"</u>	<u>14"</u>
BEARING	<u>N 87° E</u>	<u>S 45° E</u>	<u>S 40° W</u>	<u>N 79° W</u>
DISTANCE	<u>75.9 ft</u>	<u>50.8 ft</u>	<u>18.5 ft</u>	<u>11.8 ft</u>
BT TAG POSTED	<u>NO</u>	<u>NO</u>	<u>NO</u>	<u>Yes</u>

T103 R6W SEC 29 SW COR
 FND 5/8" REBAR @ A Y.P.C. MKD. "LS 1102" FOR THE COR. (CS 7793)

" 10" x 12" x 7" STONE @ A "F" CUT LAYING ON ITS SIDE ALONG THE N SIDE OF THE RECOVERED REBAR AS PER CS 7793.

" A FIR STUMP 45" IN DIA @ A ROTTED OUT FACE BEARS S 41° E ~ 52.1' (S 45° E ~ 50.82' ORIG. G.L.O. FACE MEAS.) SET A B.T. TAG ON THE N.W. FACE.

" A FIR STUMP 52" IN DIA @ A ROTTED OUT FACE & A NOTCH AT THE BASE OF THE FACE BEARS S 89° E ~ 77.4' (N 87° E ~ 75.9' ORIG. G.L.O. FACE MEAS.) SET A B.T. TAG ON THE W. IN FACE.

" A FIR STUMP 16" IN DIA @ A HEALED OVER FACE BEARS S 40° W ~ 18.5' (S 40° W ~ 18.48' COR REST. NO. 382) SET A B.T. TAG ON THE N.E. FACE.

" A FIR STUMP 15" IN DIA @ A PARTLY HEALED FACE & SOME VISIBLE SCRIBING VISIBLE BEARS N 79° W ~ 11.8' (N 79° W ~ 11.8' CS 7793) FND. A B.T. TAG ON THE E. IN FACE SET A NEW TAG ABOVE IT.

NO OTHER RECORD BEARING OBJECTS WERE RECOVERED

SET: 2" I.D. x 30" LONG IRON PIPE @ A 3/4" BEN. CO. B.C. STAMPED AS SHOWN CENTERED OVER THE RECOVERED 5/8" REBAR. BURIED THE STONE HORIZ. ALONG THE N. IN SIDE OF THE NEW MON.

" 5/8" x 30" REBAR @ A Y.P.C. MKD. "BENTON COUNTY SURVEYOR" BEARS N 00° E ~ 11.25'

" 5/8" x 30" REBAR @ A Y.P.C. MKD. "BENTON COUNTY SURVEYOR" BEARS S 20° E ~ 14.41'

" 5/8" x 30" REBAR @ A Y.P.C. MKD. "BENTON COUNTY SURVEYOR" BEARS S 80° W ~ 8.78'

" 5/8" x 30" REBAR @ A Y.P.C. MKD. "BENTON COUNTY SURVEYOR" BEARS N 36° W ~ 14.39'

" ORANGE FIBERGLASS "SURVEY MARKER" POST 1' NE'ly

THE COR. IS LOCATED 200 ± W'ly FROM A SMALL UNNAMED CREEK & 325 ± SW'ly FROM THE PHYSICAL E. OF ALEXANDER RD. (Co. Rd. NO. 16530). IT IS GOOD FOR PREMARKING & GPS CONTROL

11/7/91, G.T.L.W. MEAS. SILLA COMP. 20° E. DEC. WIND, RAIN & COLD 2/21

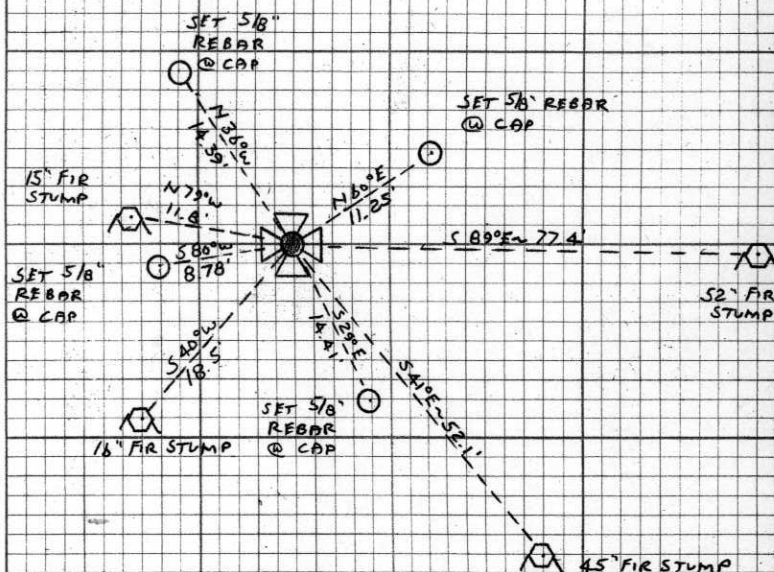

T103 R6W

CAP STAMPINGS

S30 | S29

S31 | S32

1991

BENTON COUNTY CORNER RESTORATION FORM

3867
106200200
CORNER SW

SECTION 29 TOWNSHIP 10 S RANGE 6 W DLC _____
DATE 1/7/91 CORNER RESTORATION FIELD BOOK NUMBER 2 PAGE 21

CORNER DESIGNATION:

THE SECTION CORNER COMMON TO SECTIONS 29, 30, 31 AND 32, IN T 10 S, R 6 W, WILLAMETTE MERIDIAN.

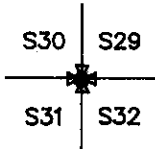

- _____ CONDITION REPORT ONLY
- _____ REFERENCED OUT
- XX RENEWED
- _____ SURVEYED IN

LOCATION AND COMMENTS:

THE CORNER IS LOCATED IN A RECENT CLEAR CUT APPROXIMATELY 200 FEET WESTERLY FROM A SMALL UNNAMED CREEK AND APPROXIMATELY 325 FEET SOUTHWESTERLY FROM THE PHYSICAL CENTER LINE OF ALEXANDER ROAD (COUNTY ROAD NO. 16530).

PREVIOUS RENEWALS/SURVEYS, ETC.:

- ORIGINAL GLO SURVEY BY DANIEL MURPHY IN 1853.
- CORNER RESTORATION NO. 382 BY J. A. GANONG ON MAY 19, 1911.
- COUNTY SURVEY NO. 2486 BY CURTIS C. HANSON ON JUNE 22, 1953.
- COUNTY SURVEY NO. 7793 BY NORMAN D. SPRINGER ON JANUARY 6, 1986.
- CORNER RESTORATION NO. 3354 BY NORMAN D. SPRINGER ON JANUARY 6, 1986.
- COUNTY SURVEY NO. 8120 BY MARK STEELE ON MARCH 16, 1988.

MONUMENTS AND ACCESSORIES FOUND (CONDITION AND SOURCE):

- FOUND: 5/8" REBAR WITH A YELLOW PLASTIC CAP MARKED "LS 1102" FOR THE CORNER (COUNTY SURVEY NO. 7793).
- FOUND: A 10" X 12" X 7" STONE WITH AN "X" CUT ON ITS FACE, LAYING ABOVE GROUND ON ITS SIDE ALONG THE NORTH SIDE OF THE RECOVERED REBAR AS PER COUNTY SURVEY NO. 7793.
- FOUND: A FIR STUMP 45" IN DIAMETER WITH A ROTTED OUT FACE BEARS S 41° E 52.1 FEET (S 45° E 50.82 FEET ORIGINAL GLO FACE MEASUREMENT). SET A B.T. TAG ON THE NORTHWESTERLY FACE.
- FOUND: A FIR STUMP 52" IN DIAMETER WITH A PARTLY ROTTED OUT FACE AND A NOTCH AT THE BASE OF THE FACE, BEARS S 89° E 77.4 FEET (N 87° E 75.9 FEET ORIGINAL GLO FACE MEASUREMENT). SET A B.T. TAG ON THE WESTERLY FACE.
- FOUND: A FIR STUMP 16" IN DIAMETER WITH A HEALED OVER FACE BEARS S 40° W 18.5 FEET (S 40° W 18.48 FEET CORNER RESTORATION NO. 382). SET A B.T. TAG ON THE NORTHEASTERLY FACE.
- FOUND: A FIR STUMP 15" IN DIAMETER WITH A PARTLY HEALED FACE AND SOME ILLEGIBLE SCRIBING VISIBLE, BEARS N 79° W 11.8 FEET (N 79° W 11.8 FEET COUNTY SURVEY NO. 7793). FOUND A B.T. TAG ON THE EASTERLY FACE, SET A NEW TAG ABOVE IT.

NO OTHER RECORD BEARING OBJECTS WERE RECOVERED.

MONUMENT DETAIL

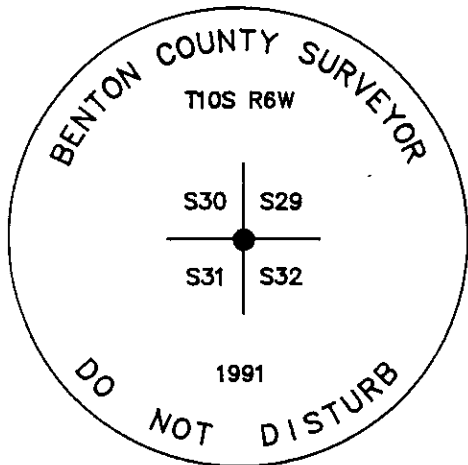

3 1/4" BRASS CAP

SKETCH

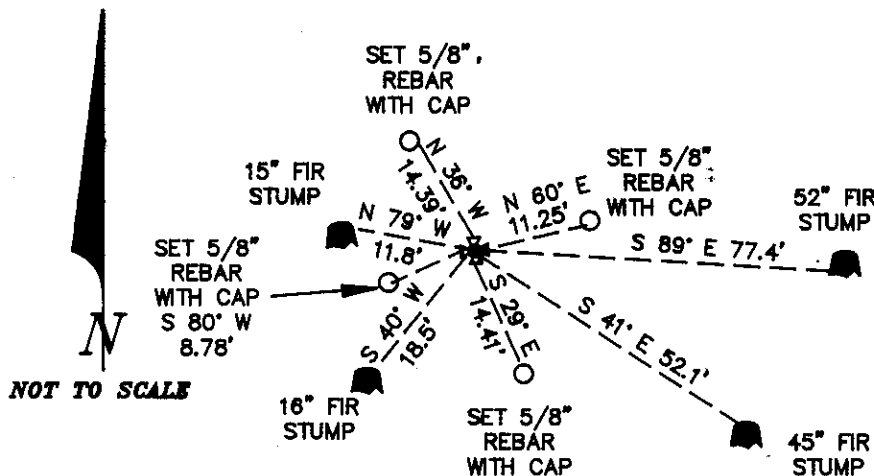

MONUMENT SET (PROCEDURES AND DESCRIPTION):

SET: 2" INSIDE DIAMETER X 36" LONG IRON PIPE WITH A 3 1/4" BENTON COUNTY BRASS CAP STAMPED AS SHOWN CENTERED OVER THE RECOVERED 5/8" REBAR. BURIED THE STONE HORIZONTALLY ALONG THE NORTHERLY SIDE OF THE NEW MONUMENT.

NEW ACCESSORIES

- SET: 5/8" X 30" REBAR WITH A YELLOW PLASTIC CAP MARKED "BENTON COUNTY SURVEYOR", BEARS N 60° E 11.25 FEET.
- SET: 5/8" X 30" REBAR WITH A YELLOW PLASTIC CAP MARKED "BENTON COUNTY SURVEYOR", BEARS S 29° E 14.41 FEET.
- SET: 5/8" X 30" REBAR WITH A YELLOW PLASTIC CAP MARKED "BENTON COUNTY SURVEYOR", BEARS S 80° W 8.78 FEET.
- SET: 5/8" X 30" REBAR WITH A YELLOW PLASTIC CAP MARKED "BENTON COUNTY SURVEYOR", BEARS N 36° W 14.39 FEET.

SET ORANGE FIBERGLASS "SURVEY MARKER" POST 1 FOOT NORTHEASTERLY.

NOTES:

B.C.B.W. IS A BRASS WASHER STAMPED "BENTON COUNTY SURVEYOR". COMPASS DECLINATION IS 20° EAST. ALL MEASURED DISTANCES AND COMPASS BEARINGS ARE TO THE CENTER OF THE OBJECT, UNLESS OTHERWISE NOTED.

REGISTERED
PROFESSIONAL
LAND SURVEYOR

Danna L. Fehrenbacher
OREGON
JULY 16, 1982
DANNA L. FEHRENBACHER
1995

FIRM/AGENCY: BENTON COUNTY PUBLIC WORKS
ADDRESS: 360 S.W. AVERY AVE. CORVALLIS OR. 97333; PH. 757-6821
PARTY CHIEF: CURTIS J. LIESENFELT
CREW: MARK E. ANDERSON
WITNESS: