

**106400100**

DATE 10/04/2018TOWNSHIP 10 SOUTH, RANGE 6 WEST, WILLAMETTE MERIDIAN; SECTION 33 CORNER SOUTHEAST  
DONATION LAND CLAIM N/A CORNER N/A**COMMON CORNER(S):**SOUTHWEST CORNER OF SECTION 34, TOWNSHIP 10 SOUTH, RANGE 6 WEST  
POINT ON NORTH LINE OF SECTION 4, TOWNSHIP 11 SOUTH, RANGE 6 WEST**RECORDS (INFORMATION IN *BOLD ITALICS* IS COUNTY STAFFS' INTERPRETATION OF THE RECORD)**

BASED ON EXTENSIVE RESEARCH AND RECOVERY OF EVIDENCE, THIS OFFICE HAS DETERMINED THAT MOST GENERAL LAND OFFICE SURVEYORS IN BENTON COUNTY MEASURED TO THE FACE OF BEARING TREES.

- [01] GENERAL LAND OFFICE (GLO) NOTES BY DANIEL MURPHY, D.S., DATED SEPTEMBER 22, 1854. *SET POST FROM WHICH AN OAK 8" DIA BEARS N73°E, 23 LINKS (15.18 FEET); OAK 24" DIA BEARS N32°W, 152 LINKS (100.32 FEET).*
- [02] BENTON COUNTY SURVEY NO. 1024 (OLD NO. 352) FIELD NOTES (FIELD BOOK 36, PAGE 30) BY W. C. GALLOWAY, C.S., DATED MAY 2, 1927. *SET 1" FORD AXLE. BOTH OAKS DEAD, CHECK. FIR 50" DIA BEARS S60°E, 0.370 CHAINS (24.42 FEET); FIR 9" DIA BEARS N8°W, 0.084 CHAINS (5.54 FEET).*
- [03] BENTON COUNTY CORNER RESTORATION BOOK NO. 1, PAGE 185, BY W. C. GALLOWAY, C.S., DATED MAY 2, 1927. *SET 1" FORD AXLE. BOTH OAKS DEAD, CHECK. FIR 50" DIA (CSBT) BEARS S60°E, 0.370 CHAINS (24.42 FEET) TO CENTER; FIR 9" DIA (CSBT) BEARS N8°W, 0.084 CHAINS (5.54 FEET) TO CENTER.*
- [04] BENTON COUNTY CORNER RESTORATION NO. 389. *TRANSCRIBED FROM RECORD [03] AND MAY CONTAIN ERRORS AND/OR OMISSIONS.*
- [05] BENTON COUNTY MAP NO. 10-6-00016 BY UNKNOWN DRAFTSMAN, NO DATE GIVEN. *FORD AXLE. FIR 50" DIA (CSBT) BEARS S60°E, 0.37 CHAINS (24.42 FEET); FIR 9" DIA (CSBT) BEARS N8°W, 0.084 CHAINS (5.54 FEET).*
- [06] BENTON COUNTY CORNER RESTORATION NO. 106400100R2 BY DAVID M. DEAN, P.L.S., DATED OCTOBER 8, 2008. *FOUND 1" X 30" AXLE, 3" BELOW GROUND LEVEL FOR CORNER POSITION. FOUND ±54" ROTTEN D. FIR STUMP (CSBT) BEARS S60°E, 24.43 FEET TO CENTER, NO VISIBLE SCRIBING. FOUND ROOT HOLE OF DOWN AND VERY ROTTEN AND BURNT ±12" D. FIR (CSBT) BEARS N8°W, 5.5 FEET TO APPROXIMATE CENTER OF ROOT HOLE. REMOVED AXLE AND SET A 2" X 31-1/2" GALVANIZED IRON PIPE WITH A 3-1/4" ALUMINUM DISK CONCRETED IN THE TOP, 1" BELOW GROUND LEVEL AND MARKED "T10S R6W S33 S34 2008". BURIED AXLE ON THE SOUTH SIDE OF NEW MONUMENT, 3" BELOW GROUND LEVEL IN HORIZONTAL POSITION. SET A 6 FOOT ORANGE CARSONITE "SURVEY MARKER" POST 0.5 FEET NORTH OF NEW MONUMENT. MAPLE 6" DIA BARK SCRIBED "T10SR6WS34BT" BEARS N64°07'E, 17.14 FEET TO FACE. SET ALUMINUM NAIL AND PLASTIC WASHER BELOW SCRIBING FOR DISTANCE AND ANGLE MEASUREMENT. D. FIR 20" DIA FACE SCRIBED "XBT" BEARS S30°19'E, 9.30 FEET TO FACE. SET ALUMINUM NAIL AND PLASTIC WASHER BELOW SCRIBING FOR DISTANCE AND ANGLE MEASUREMENT. D. FIR 15" DIA FACE SCRIBED "XBT" BEARS S86°53'W, 15.13 FEET TO FACE. SET ALUMINUM NAIL AND PLASTIC WASHER BELOW SCRIBING FOR DISTANCE AND ANGLE MEASUREMENT. D. FIR 20" DIA FACE SCRIBED "T10SR6WS33BT" BEARS N30°45'W, 11.17 FEET TO FACE. SET ALUMINUM NAIL AND PLASTIC WASHER BELOW SCRIBING FOR DISTANCE AND ANGLE MEASUREMENT.*

**FIRM/AGENCY:** BENTON COUNTY SURVEYOR'S OFFICE  
**ADDRESS:** 360 S.W. AVERY AVE., CORVALLIS, OR 97333; PH. 541-766-6821  
**RESEARCH BY:** DAVID L. MALONE, P.L.S.  
**DATA ENTRY BY:** SAME

DATE 01/20/2004TOWNSHIP 10 SOUTH, RANGE 06 WEST, WILLAMETTE MERIDIAN; SECTION 33 CORNER SOUTHEAST  
DONATION LAND CLAIM N/A CORNER N/A**COMMON CORNER(S):**

SOUTHWEST OF SECTION 34.

**RECORDS (INFORMATION IN *BOLD ITALICS* IS COUNTY STAFFS' INTERPRETATION OF THE RECORD)**

BASED ON EXTENSIVE RESEARCH AND RECOVERY OF EVIDENCE, THIS OFFICE HAS DETERMINED THAT MOST GENERAL LAND OFFICE SURVEYORS MEASURED TO THE FACE OF BEARING TREES.

- [01] GENERAL LAND OFFICE (GLO) NOTES BY D. MURPHY, D.S., DATED OCTOBER 31, 1853. SET A POST. MARKED A **8" OAK N73°E 23 LKS. (15.18 FEET)** AND A **24" OAK N32°W 152 LKS. (100.32 FEET)**.
- [02] COUNTY SURVEY NO. 1024 (OLD NO. 352) FIELD NOTES (FIELDBOOK 36, PAGE 30) BY W. C. GALLOWAY, C.S., DATED MAY 2, 1927. SET 1" FORD AXLE. FOUND BOTH GLO OAK BTS. DEAD. MARKED A **50" FIR S60°E 0.370 CHS. (24.42 FEET)** AND A **9" FIR N8°W 0.084 CHS. (5.54 FEET)**.
- [03] CORNER RESTORATION BOOK NO. 1, PAGE 185 BY W. C. GALLOWAY, C.S., DATED MAY 2, 1927. SET 1" FORD AXLE. FOUND BOTH GLO OAK BTS DEAD. MARKED A **50" FIR S60°E 0.370 CHS. (24.42 FEET)** TO CENTER AND A **9" FIR N8°W 0.084 CHS. (5.54 FEET)** TO CENTER.
- [04] CORNER RESTORATION NO. 389. *TRANSCRIBED FROM RECORD [03] AND MAY CONTAIN ERRORS AND/OR OMISSIONS.*
- [05] BENTON COUNTY MAP NO. 10-6-00016, NO DATE OR DRAFTSMAN GIVEN. FORD AXLE. **50" FIR S60°E 0.370 CHS. (24.42 FEET)** AND A **9" FIR N8°W 0.084 CHS. (5.54 FEET)**.

**NOTES:**

THIS IS A MICROSOFT WORD 2000 DOCUMENT NAMED "06400100" CREATED FROM A BOILER PLATE DOCUMENT NAMED "HISTORY", WHICH HAS A STYLESHEET NAMED "CORNER" ATTACHED TO IT.

**FIRM/AGENCY:** BENTON COUNTY SURVEYOR'S OFFICE  
**ADDRESS:** 360 S.W. AVERY AVE. CORVALLIS OR 97333; PH. 766-6821  
**RESEARCH BY:** BERNARD S. ALTENBACH, ENGINEER/SURVEY TECH.  
**DATA ENTRY BY:** BSA

**BENTON COUNTY CORNER RESTORATION FORM, PAGE 1 OF 2, 106400100R2**

**SEE CORNER HISTORY FORM FOR RECORDS ETC.**

CORNER RESTORATION FIELD BOOK NUMBER 27 PAGE(S) 38 DATE 10/08/2008  
TOWNSHIP 10 SOUTH, RANGE 6 WEST, WILLAMETTE MERIDIAN; SECTION 33 CORNER SOUTHEAST  
DONATION LAND CLAIM NONE CORNER NONE  
CONDITION REPORT     ; REFERENCED OUT     ; RENEWED XX; SURVEYED IN     

**LOCATION AND COMMENTS:**

CORNER IS LOCATED IN A STAND OF MATURE ±70 YEAR OLD D. FIR TIMBER ON A SOUTHERLY FACING SLOPE. TO REACH CORNER FROM THE PARKING LOT OF BEAZELL MEMORIAL FOREST PARK, WALK EASTERLY ON TRAIL FOR APPROXIMATELY 1/4 MILE TO LOCATION TAG ON A 6" MAPLE ON NORTHERLY SIDE OF TRAIL; THEN N61°E, ±11 CHAINS TO CORNER. CORNER IS POOR FOR PREMARKING AND GPS CONTROL.

**MONUMENTS AND ACCESSORIES FOUND (CONDITION AND SOURCE):**

1. FOUND 1" X 30" AXLE, 3" BELOW GROUND LEVEL FOR CORNER POSITION.  
(SET POST PER RECORD [01]).  
(SET 1" FORD AXLE FROM GENERAL LAND OFFICE BEARING TREES PER RECORDS [02] AND [03]).  
(FORD AXLE PER RECORD [05]).
2. FOUND ±54" ROTTEN D. FIR STUMP, S60°E, 24.43 FEET TO CENTER. SEARCH FOR BUT FOUND NO VISIBLE SCRIBING ON THIS COUNTY SURVEYOR'S ACCESSORY. **BASIS OF BEARINGS FOR THIS RESTORATION.**  
(MARKED 50" FIR, S60°E, 24.42 FEET PER RECORDS [02] AND [03]).  
(50" FIR, S60°E, 24.42 FEET PER RECORD [05]).
3. FOUND ROOT HOLE OF DOWN AND VERY ROTTEN AND BURNT ±12" D. FIR, N8°W, 5.5 FEET TO APPROXIMATE CENTER OF ROOT HOLE. BEARING AND DISTANCE BY COMPASS AND TAPE.  
(MARKED 9" FIR, N8°W, 5.54 FEET PER RECORDS [02] AND [03]).  
(9" FIR, N8°W, 5.54 FEET PER RECORD [05]).

**MONUMENT SET (PROCEDURES AND DESCRIPTION):**

THE 1" X 30" AXLE WAS FOUND FIRMLY SET AND UNDISTURBED AND COMPARING WELL WITH THE REMAINS OF BOTH COUNTY SURVEYOR'S BEARING TREES. BOTH GLO ACCESSORIES ARE NOW MISSING. WE HELD THE CENTER OF THE 1" AXLE FOR THE EXACT CORNER POSITION. REMOVED AXLE AND SET A 2" X 31 1/2" GALVANIZED IRON PIPE WITH A 3 1/4" ALUMINUM DISK CONCRETED IN THE TOP, 1" BELOW GROUND LEVEL AND MARKED A SHOWN ON PAGE 2 OF 2. BURIED AXLE ON THE SOUTH SIDE OF NEW MONUMENT, 3" BELOW GROUND LEVEL IN HORIZONTAL POSITION. SET A 6 FOOT ORANGE CARSONITE "SURVEY MARKER" POST 0.5 FEET NORTH OF NEW MONUMENT.

MATURE D. FIR TIMBER

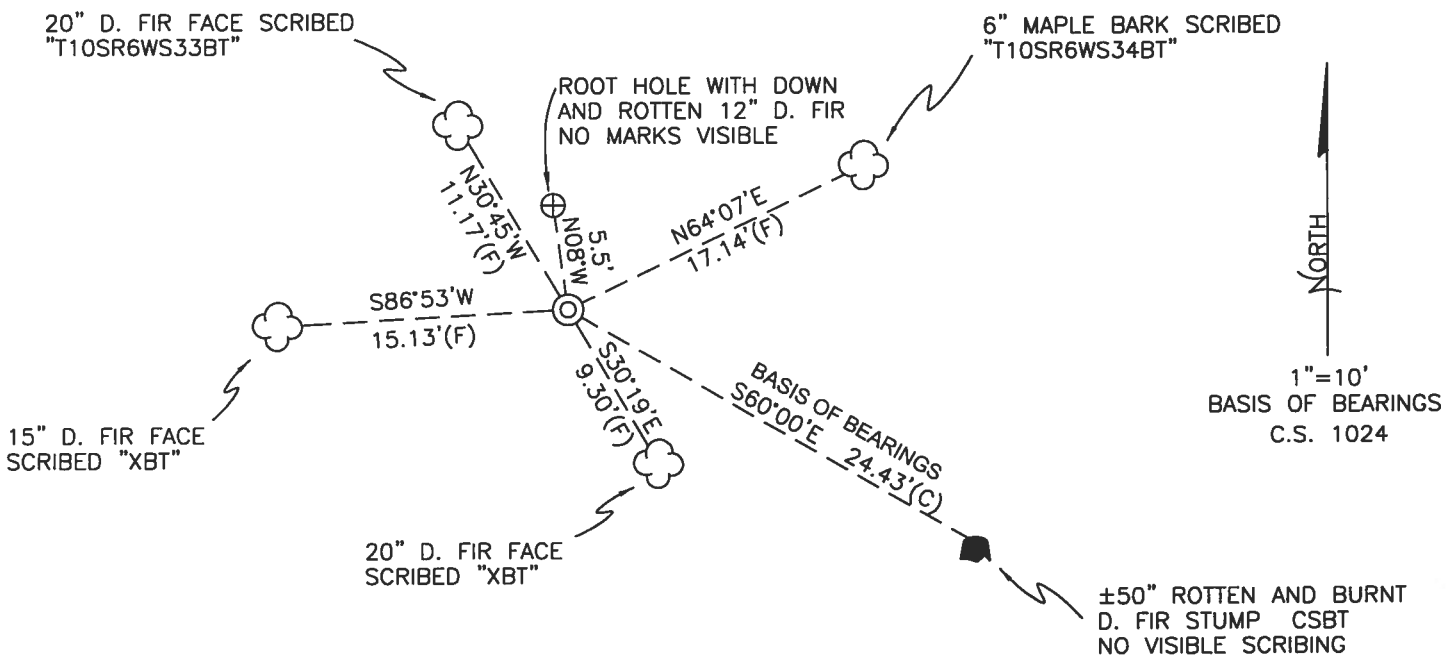

MATURE D. FIR TIMBER

MONUMENT DETAIL

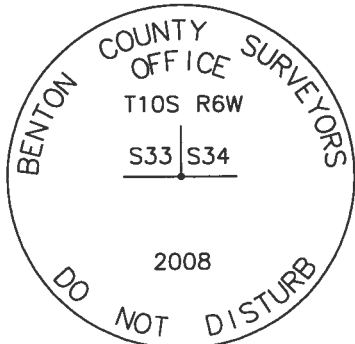

3 1/4" ALUMINUM DISK

LEGEND

- SET 5/8" X 30" REBAR WITH YELLOW PLASTIC CAP MKD "BENTON COUNTY SURVEYOR"
- (F) MEASUREMENT TO FACE
- (C) MEASUREMENT TO CENTER
- ⊙ GOVERNMENT MONUMENT SET AS SHOWN
- ☼ BEARING TREE AS NOTED
- C.S.B.T. COUNTY SURVEYORS BEARING TREE
- C.S. COUNTY SURVEY
- ♣ BEARING TREE STUMP AS NOTED
- ⊕ FOUND ROOT HOLE OF COUNTY SURVEYOR'S BEARING TREE

NEW ACCESSORIES:

1. 6" MAPLE BARK SCRIBED "T10SR6WS34BT" N64°07'E, 17.14 FEET TO FACE. SET ALUMINUM NAIL AND PLASTIC WASHER BELOW SCRIBING FOR DISTANCE AND ANGLE MEASUREMENT.
2. 20" D. FIR FACE SCRIBED "XBT" S30°19'E, 9.30 FEET TO FACE. SET ALUMINUM NAIL AND PLASTIC WASHER BELOW SCRIBING FOR DISTANCE AND ANGLE MEASUREMENT.
3. 15" D, FIR FACE SCRIBED "XBT" S86°53'W, 15.13 FEET TO FACE. SET ALUMINUM NAIL AND PLASTIC WASHER BELOW SCRIBING FOR DISTANCE AND ANGLE MEASUREMENT.
4. 20" D. FIR FACE SCRIBED "T10SR6WS33BT" N30°45'W, 11.17 FEET TO FACE. SET ALUMINUM NAIL AND PLASTIC WASHER BELOW SCRIBING FOR DISTANCE AND ANGLE MEASUREMENT.

NOTES:

COMPASS DECLINATION IS 20° EAST. ALL MEASURED DISTANCES AND BEARINGS ARE TO THE CENTER OF THE OBJECT, UNLESS OTHERWISE NOTED. ALL BEARING TREES ARE PAINTED AND HAVE A B.T. TAG ATTACHED, FACING THE CORNER UNLESS OTHERWISE NOTED. ALL NEW BEARING TREES HAVE A PLASTIC WASHER (STAMPED "SURVEYOR MARKER DO NOT REMOVE") ATTACHED BY AN ALUMINUM NAIL TO THE FACE, BELOW THE "BT" FOR DISTANCE AND ANGLE MEASUREMENT UNLESS OTHERWISE NOTED. THE DRAWING IS FROM AUTOCAD RELEASE 2008.

THIS RESTORATION WAS PERFORMED AT THE DIRECTION AND APPROVAL OF THE BENTON COUNTY SURVEYOR David M. Dean

REGISTERED  
PROFESSIONAL  
LAND SURVEYOR

10/20/08 *David M. Dean*

FIRM/AGENCY: BENTON COUNTY SURVEYOR'S OFFICE  
 ADDRESS: 360 S.W. AVERY AVE. CORVALLIS, OR. 97333; PH. 766-6821  
 PRESENT: DAVID M. DEAN, P.L.S., JOE MARDIS, P.L.S. AND  
 BERNIE ALTENBACH, SURVEY TECH.  
 EQUIPMENT: LEICA TCR 1105 WITH TDS ON BOARD

OREGON  
JULY 13, 1984  
DAVID M. DEAN  
2090

RENEWAL DATE: 12/31/09

106400100

REMONUMENTING 33/34 T105 R 6 W

Found 1" x 30" AXLE 3" BELOW GROUND  
 LEVEL FOR CORNER POSITION AS SET  
 PER CS. 1024 FM GLO B.T.S. AXLE WAS  
 FOUND FIRMLY SET, UNDISTURBED IN PLUMB  
 POSITION. Fd  $1\frac{1}{4}$ " x  $1\frac{1}{4}$ " IRON BAR  
 NORTH AND TIPPED 05' S'LY. GLO  
 ACCESSORIES ARE BOTH MISSING. Fd  
 ± 50" VERY ROTTEN D. FIR STUMP CSBT  
 w/ NO V.S. Fd DOWN & VERY ROTTEN  
 ± 12" D. FIR C.S. SET w/ NO V.S. BOTH  
 C.S. B.T.'S COMPARE WELL WITH RECORD  
 BNG & DIST. REMOVED AXLE AND SET  
 2" x 3 1/2" G.I.P. w/ 3/4" ALUM. DISK  
 CONG. IN TOP 1" & AND MKD. AS  
 SHOWN. REMOVED IRON BAR AND  
 BURIED AXLE & I. BAR ON S SIDE OF  
 NEW MON. IN HORIZ  
 POSITION 4" & SET  
 6' ORANGE CARSONITE  
 "SURVEY MARKER"  
 POST 05' N OF  
 NEW MON.

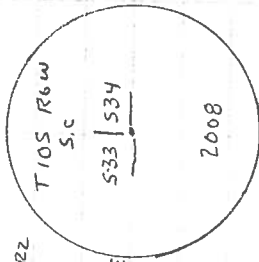

3/4" ALUM. DISK

CLEAR, MILD  
 60°F, 29.8" Hg (P.M.)  
 LEICA TCR1105/TDS

10/8/08 27/38  
 D. DEAN  
 B. ALTENBACH  
 J. MARDIS

T @ 3324 (±13) BS ±12

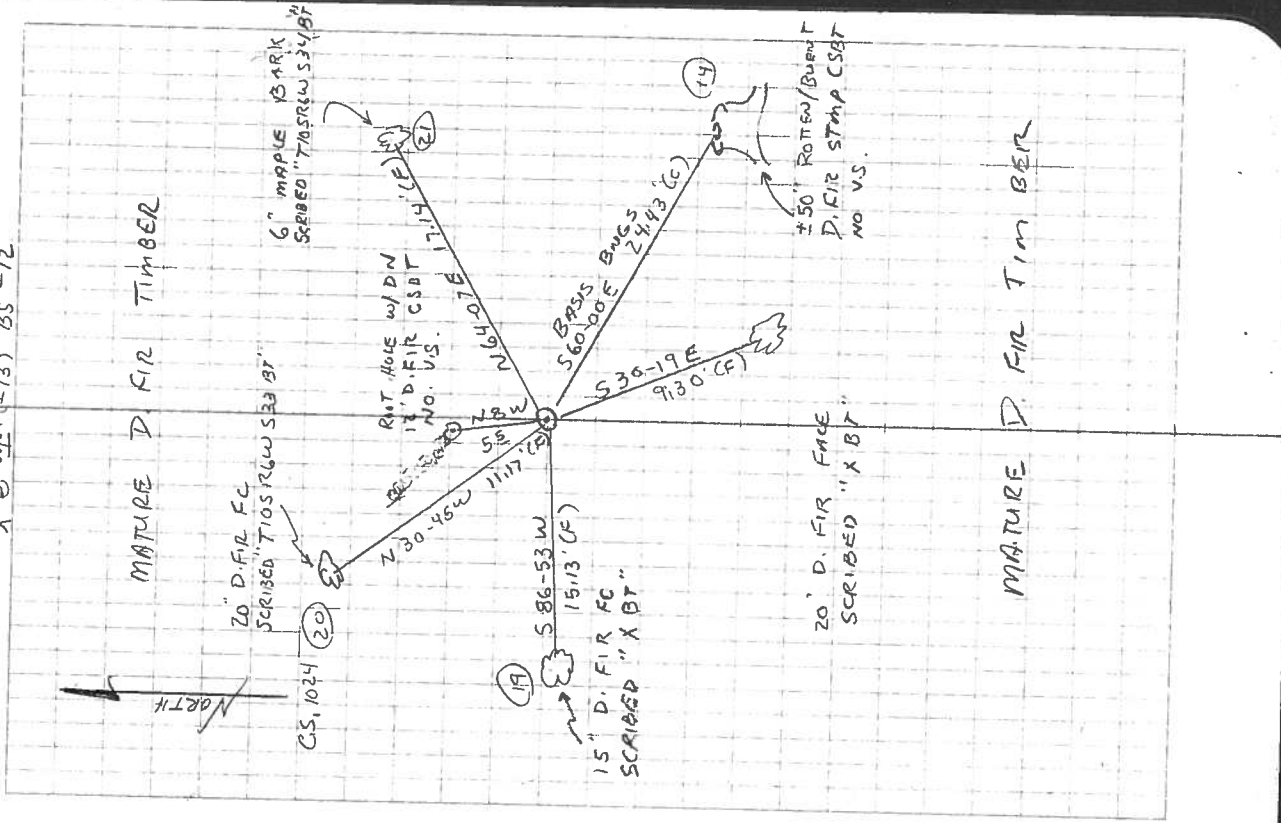

1/4 cor. on E. of sec 24, T. 14 S. R. 8 W. M.  
 Set oak stake from which  
 Oak 20" in dia. bears N 25° W 2.68 down.  
 Marked Oak 12" " " South .58 chains  
 " " 16" " " N 25° W 2.26 "

C.S. #351 m.c.g.

Cor. to secs. 25, 26, 35 & 36 T. 14 S. R. 8 W. Will. Mer.  
 Set 3/4" x 3/4" x 36" steel bar Found sandstone mound.  
 Fir stump N. 82° E. 1.87 to center  
 Dead fir 30" in dia. bears N. 73 1/2° E 2.29 chs. center  
 " " stump S. 62 1/2° W. 1.58 " "  
 " " 36" " " N. 18 1/2° W. 1.09 " "  
 Mkd. fir 18" " " " N. 20 1/2° W. 1.080 " "

Witnesses  
 Albert Taylor  
 Chas. Small

1/4 Sec. Cor. bet. secs. 26 & 35 T. 14 S. R. 8 W. W. M.

Set a 1/4" x 1 1/2" iron, spring.  
 Fir stump 8" in. in dia. S. 40° W. .45 B.T. found  
 Marked Cedar stump 60° N. 8° 20' E .553 chs.  
 " Alder 8" in dia. S. 26° E. .060 "  
 " Fir 15" " " S. 18° 50' W. .430 "

C.S. #352 m.c.g.

Corner to Sections 27, 28, 33 & 34 T. 10 S. R. 6 W. W. M.  
 Set 1 1/4" x 32" galv. pipe Found what seemed to be stake hole  
 Fir 9" in dia. bears North .062 center <sup>All oaks found & checked.</sup> Would be N. 4° E according to Hinkle  
 " 10" " " " N. 88° 30' E. .520 "  
 " 15" " " " S. 3° 45' W. .709 "  
 " 20" " " " S. 42° 30' W. .497 "

Witnesses  
 O. A. Reynolds  
 Henry Plunkett  
 Apr. 27, 1927.

May 3, 1927.  
 Henry Plunkett

1/4 sec. cor. bet. secs. 33 & 34 T. 10 S. R. 6 W. W. M.  
 Set Ford axle set proportional dist. on line.  
 Oak 6" in dia. bears S. 53° 15' W. .446 chs. to cent.  
 " 8" " " " N. 30° W. .875 " " " 206-1230'

May 2, 1927.  
 Henry Plunkett

Sec. cor. on 2nd std. parallel between secs. 33 & 34 T. 10-6  
 Set 1" ford axle both oaks dead, check.  
 Fir 50" in dia. bears S. 60° E. .370 chs. to cen.  
 " 9" " " " N. 8° W. .084 " " "

Henry Plunkett

N. E. corner of Gallatin Adkins D.L.C. 79 T. 10 S. R. 3 W. W. M.  
 W.C. 1" shaft .388 S. 4° 04' W. of corner  
 Balm 14" in dia. bears N 6° 30' E. .130  
 " 17" " " " N. 26° E .083  
 Witness I. D. Merchant Oct. 1927.

C.S. 354  
 T. 10-64, m.c.g.

1/4 sec. cor. bet. secs. 25 & 36 T. 10 S. R. 6 W. W. M.  
 Set 1 1/4" iron rod  
 Maple 14" in dia. bears N. 70° E. .13 chs. std.  
 W. fir 6" " " " S. 70° E. .115 " "  
 Witnesses I. D. Merchant and Jewell Christensen.

Section corner on 2nd std. parallel between sections 33 and 34, Twp. 10-6

Reestablishment by W. C. Galloway

May 2, 1927

389

Set 1" Ford axle, both Oaks dead, check  
Fir 50" in diam bears S 60° E  
Fir 9" in diam bears N 8° W

.370 chains

.084 chains

Witness Henry Plunkett

437