

106500100

BENTON COUNTY CORNER HISTORY FORM, PAGE 1 OF 1, 106500100H2

DATE 11/08/2013

TOWNSHIP 10 SOUTH, RANGE 6 WEST, WILLAMETTE MERIDIAN; SECTION 34 CORNER SOUTHEAST
DONATION LAND CLAIM N/A CORNER N/A

COMMON CORNER(S):

SOUTHWEST CORNER SECTION 35
POINT ON THE NORTH LINE OF SECTION 3, TOWNSHIP 11 SOUTH, RANGE 6 WEST

RECORDS (INFORMATION IN BOLD ITALICS IS COUNTY STAFFS' INTERPRETATION OF THE RECORD)

BASED ON EXTENSIVE RESEARCH AND RECOVERY OF EVIDENCE, THIS OFFICE HAS DETERMINED THAT MOST GENERAL LAND OFFICE SURVEYORS IN BENTON COUNTY MEASURED TO THE FACE OF BEARING TREES.

[01] GENERAL LAND OFFICE (GLO) NOTES BY DANIEL MURPHY, D.S., DATED SEPTEMBER 22, 1854. SET POST FROM WHICH A MAPLE 4" DIA BEARS ***N11-1/2°E, 66 LINKS (43.56 FEET)***; FIR 12" DIA BEARS ***N30°W, 86 LINKS (56.76 FEET)***.

[02] BENTON COUNTY SURVEY NO. 1121 (OLD NO. 214) FIELD NOTES (FIELD BOOK 43, PAGE 7) BY WALTER W. LARSEN, D.C.S., DATED OCTOBER 16, 1929. ***MAPLE 14" DIA (GLO BT) BEARS N11-1/2°E, 0.66 CHAINS (43.56 FEET)***; FIR 24" DIA BEARS ***S87°E, 0.122 CHAINS (8.05 FEET)***.

[03] BENTON COUNTY CORNER RESTORATION BOOK NO. 1, PAGE 188 BY WALTER W. LARSEN, D.C.S., DATED OCTOBER 16, 1929. SET 1" ROD FROM WHICH A MAPLE 14" DIA (GLO BT) BEARS ***N11-1/2°E, 0.66 CHAINS (43.56 FEET)*** STANDING; FIR 24" DIA (CSBT) BEARS ***S87°E, 0.122 CHAINS (8.05 FEET)***.

[04] BENTON COUNTY CORNER RESTORATION NO. 390. TRANSCRIBED FROM RECORD [03] AND MAY CONTAIN ERRORS AND/OR OMISSIONS.

[05] BENTON COUNTY SURVEY NO. 1123 (OLD NO. 220) FIELD NOTES (FIELD BOOK 43, PAGE 21) BY WALTER W. LARSEN, D.C.S., NO DATE GIVEN. 1" ROD. ***MAPLE 14" DIA (GLO BT) BEARS N11-1/2°E, 0.66 CHAINS (43.56 FEET)***; FIR 24" DIA (CSBT) BEARS ***S87°E, 0.122 CHAINS (8.05 FEET)***.

[06] BENTON COUNTY MAP NO. 10-6-00016, UNKNOWN DRAFTSMAN AND DATE. 1" ROD. ***MAPLE 14" DIA (GLO BT) BEARS N11-1/2°E, 0.66 CHAINS (43.56 FEET)***; FIR 24" DIA (CSBT) BEARS ***S87°E, 0.122 CHAINS (8.05 FEET)***.

[07] BENTON COUNTY CORNER RESTORATION NO. 106500100R2 BY JIM S. PETERSON, P.L.S., DATED JUNE 14, 1996. FOUND 1" X 12" IRON ROD LEANING. STOOD UPRIGHT AND CHECKED WITH ONLY REMAINING BEARING TREE. DISTANCE CHECKS REASONABLY. MONUMENT ACCEPTED AS THE TRUE CORNER. FOUND MAPLE 24" DIA (GLO BT) BEARS ***N9°E, 44.03 FEET*** TO SPIKE SET IN EAST SIDE. SAWED OPEN MAPLE AND FOUND AXE WORK FROM 1929. CORE OF TREE IS ROTTED WITH NO ORIGINAL MARKS REMAINING. FOUND FIR STUMP UPROOT 28" DIA (CSBT) BEARS ***S87°E, 8.05 FEET*** TO ROOT HOLE, NO MARKS VISIBLE. SET 2" INSIDE DIAMETER X 30" LONG IRON PIPE WITH 2-1/2" BRASS CAP STAMPED "T10S R6W S34 S35 S3 T11S LS1084 1996". BURIED FOUND IRON ROD ALONGSIDE CAP. D. FIR 16" DIA BEARS ***N33°W, 43.88 FEET*** TO SPIKE IN NORTHEAST SIDE, MARKED "T10S R6W S34 BT"; D. FIR 16" DIA BEARS ***N63-1/2°E, 58.05 FEET*** TO SPIKE IN NORTHWEST SIDE, MARKED "T10S R6W S35 BT"; D. FIR 18" DIA BEARS ***S66°E, 64.90 FEET*** TO SPIKE IN NORTHEAST SIDE, MARKED "X BT"; D. FIR 14" DIA BEARS ***S15°W, 33.03 FEET*** TO SPIKE IN NORTHWEST SIDE, MARKED "X BT". SET ORANGE FIBERGLASS "SURVEY MARKER" POST 0.7 FEET SOUTH OF CAP.

[08] BENTON COUNTY SURVEY NO. 9109 BY JIM S. PETERSON, P.L.S., DATED MARCH 8, 1996. FOUND 2-1/2" BRASS CAP.

[09] BENTON COUNTY SURVEY NO. 9412 BY JIM S. PETERSON, P.L.S., DATED FEBRUARY 25, 1997. FOUND 2-1/2" BRASS CAP.

FIRM/AGENCY: BENTON COUNTY SURVEYOR'S OFFICE
ADDRESS: 360 S.W. AVERY AVE., CORVALLIS, OR 97333; PH. 766-6821
RESEARCH BY: DAVID L. MALONE, P.L.S.
DATA ENTRY BY: SAME

DATE 7/30/1996TOWNSHIP 10 SOUTH, RANGE 6 WEST, WILLAMETTE MERIDIAN; SECTION 34 CORNER SE
DONATION LAND CLAIM _____ CORNER _____**COMMON CORNER(S):**

THE SOUTHWEST CORNER OF SECTION 35.

THE NORTH LINE OF SECTION 3, IN TOWNSHIP 11 SOUTH, RANGE 6 WEST.

UPDATES AND REVISIONS:**CORNER RECORDS (PREVIOUS RENEWALS, SURVEYS, ETC.)**

- [01] ORIGINAL GLO SURVEY BY DANIEL MURPHY DATED SEPTEMBER 22, 1854. *SET POST WITH MAPLE AND FIR FOR BEARING TREES, MEASURED TO THE FACE.*
- [02] COUNTY SURVEY NO. 1121 BY WALTER W. LARSEN DATED OCTOBER 16, 1929, (FIELD BOOK NO. 43 PAGE 7). *FIR AND MAPLE BEARING TREES.*
- [03] OLD CORNER RESTORATION BOOK NO. 1, PAGE 188 BY WALTER W. LARSEN DATED OCTOBER 16, 1929. *FOUND MAPLE, SET 1" ROD, FIR BEARING TREE.*
- [04] CORNER RESTORATION NO. 390. *THIS IS A TRANSCRIBED COPY OF RECORD [03] AND CONTAINS ERRORS AND/OR OMISSIONS.*
- [05] MAP NO. 10-6-00016 BY WALTER W. LARSEN (NO DATE GIVEN). *FOUND MAPLE; 1" ROD; FIR BEARING TREE.*
- [06] COUNTY SURVEY NO. 1123 BY WALTER W. LARSEN (NO DATE GIVEN), (FIELD BOOK NO. 43, PAGE 21). *NO MONUMENT DESCRIPTION.*

COMMENTS/LOCATION/EIC:**NOTES:**

THIS IS A MICROSOFT WORD (VERSION 5.0) DOCUMENT NAMED "06500100" CREATED FROM A BOILER PLATE DOCUMENT NAMED "HISTORY", WHICH HAS A STYLESHEET NAMED "CORNER" ATTACHED TO IT.

INFORMATION IN BOLD ITALICS IS COUNTY STAFFS' INTERPRETATION OF THE RECORD.

FIRM/AGENCY: BENTON COUNTY SURVEYOR'S OFFICE**ADDRESS:** 360 S.W. AVERY AVE. CORVALLIS OR 97333; PH. 757-6821**RESEARCH BY:** CURTIS J. LIESENFELT/MARK E. ANDERSON**DATA ENTRY BY:** ROSE LINDGREN

BENTON COUNTY CORNER RESTORATION FORM, PAGE 1 OF 1
SEE CORNER HISTORY FORM FOR RECORDS, ETC.

CORNER RESTORATION FIELD BOOK NO. _____ PAGE _____ DATE 6-14-96
 TOWNSHIP 10 SOUTH, RANGE 6 WEST, W.M. SECTION 34 CORNER SE
 DONATION LAND CLAIM _____ REFERENCED OUT _____ RENEWED XX SURVEYED IN _____
 CONDITION REPORT _____

LOCATION AND COMMENTS:

FROM THE KINGS VALLEY FIRE STATION DRIVE SOUTH FOR 0.25 MILES TO A GRAVEL ROAD TO THE LEFT. TAKE RIGHT FORK AND FOLLOW GRAVEL ROAD (THROUGH 4 GATES) FOR 2.0 MILES TO FORK. TAKE RIGHT FORK (ACROSS BRIDGE) FOR 0.9 MILES TO TEE. TAKE LEFT FORK FOR 0.65 MILES TO LOCATION TAG AT SWITCHBACK TO LEFT. CORNER LIES ON EAST SLOPE, APPROXIMATELY 260' SOUTHEASTERLY OF GRAVEL ROAD.

MONUMENTS AND ACCESSORIES FOUND (CONDITION AND SOURCE):

FOUND: 1" X 12" IRON ROD (1" ROD AS PER RECORD [3]) LEANING. STOOD UPRIGHT AND CHECKED WITH ONLY REMAINING BEARING TREE. DISTANCE CHECKS REASONABLY, THEREFORE WE HAVE ACCEPTED THIS MONUMENT AS THE TRUE CORNER.

FOUND: 24" MAPLE, N09°E, 44.03 FT. (TO SPIKE SET IN EAST SIDE)
 (14" MAPLE, N11 1/2°E, 43.56 FT. AS PER RECORD [1])
 (14" MAPLE, N11 1/2°E, 43.56 FT. AS PER RECORDS [2]-[5])
 SAWED OPEN MAPLE AND FOUND AXE WORK FROM 1929. CORE OF TREE IS ROTTED WITH NO ORIGINAL MARKS REMAINING.

FOUND: 28" FIR STUMP UPROOT, S87°E, 8.05 FT. (TO ROOT HOLE)
 (24" FIR, S87°E, 8.05 FT. AS PER RECORDS [2]-[5]) - NO MARKS VISIBLE - DID NOT TAG

MONUMENT SET (PROCEDURES AND DESCRIPTION):

SET: 2" INSIDE DIAMETER X 30" LONG IRON PIPE, WITH 2 1/2" BRASS CAP. FOR THE CORNER, STAMPED AS SHOWN. BURIED FOUND IRON ROD ALONGSIDE CAP.

NEW ACCESSORIES:

SET: 16" D. FIR, N33°W, 43.88 FT. (TO SPIKE IN NE SIDE) MARKED: "T10S R6W S34 BT"
 SET: 16" D. FIR, N63 1/2°E, 58.05 FT. (TO SPIKE IN NW SIDE) MARKED: "T10S R6W S35 BT"
 SET: 18" D. FIR, S66°E, 64.90 FT. (TO SPIKE IN NE SIDE) MARKED: "X BT"
 SET: 14" D. FIR, S15°W, 33.03 FT. (TO SPIKE IN NW SIDE) MARKED: "X BT"
 SET: ORANGE FIBERGLASS "SURVEY MARKER" POST 0.7' SOUTH OF CAP
 SET: LOCATION TAG ON 13" D. FIR ON RIGHT SIDE OF GRAVEL ROAD. BEARS APPROXIMATELY N49°W, 260'.

MONUMENT DETAIL

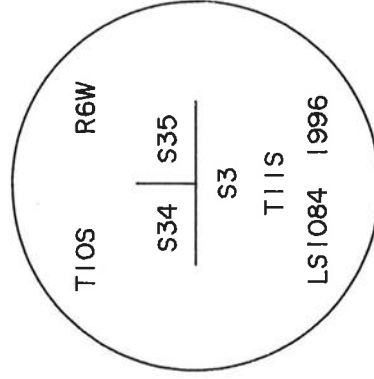

2 1/2" BRASS CAP

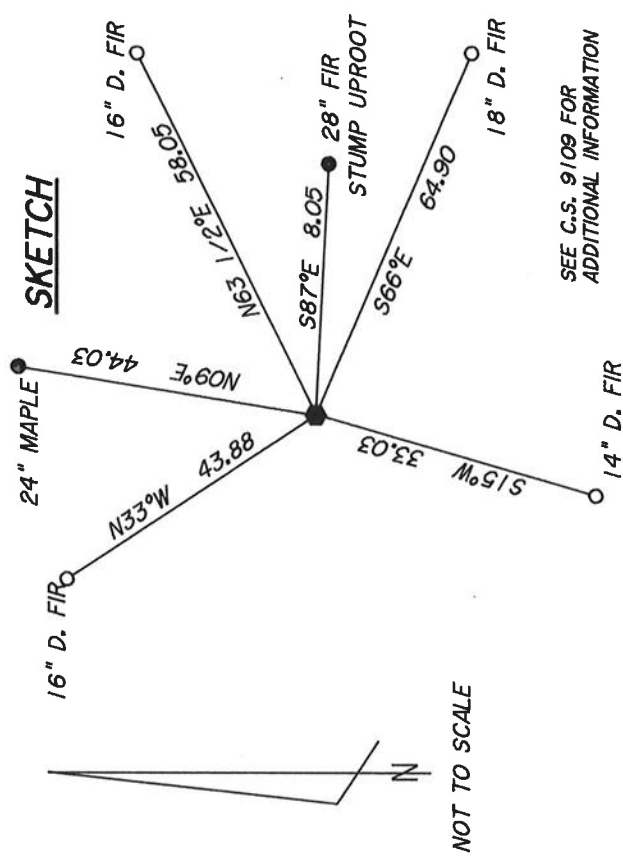

NOT TO SCALE

SEE C.S. 9109 FOR
ADDITIONAL INFORMATION

NOTES:

BASIS OF BEARINGS IS G.H.C. 10-6-00016. ALL MEASURED DISTANCES AND BEARINGS ARE TO THE CENTER OF THE OBJECT. ALL LIVE BEARING TREES ARE PAINTED (WITH A 6" BAND), HAVE A BT TAG ATTACHED, AND HAVE A BRASS WASHER (STAMPED "BENTON COUNTY SURVEYOR") ATTACHED WITH A 6" SPIKE TO THE SIDE CENTER OF THE TREE.

FIRM/AGENCY:

PETERSON & ASSOCIATES

ADDRESS:

8155 NW MITCHEL DR - CORVALLIS, OR

SURVEYOR:

JIM S. PETERSON PH. 757-1794

SURVEY CREW:

COLTER HESSEL - BRIAN PETERSON

REGISTERED
PROFESSIONAL
LAND SURVEYOR

OREGON
JULY 31, 1976
JIM S. PETERSON
1084

EXPIRES: 12-31-96

Aug 17, 1929
 Wm. W. L.

Witness

Oct 16, 1929

W. W. L.

Henry Plunkett

Witness

CORNER RESTORATION BOOK NO. 1

V. W. COR. SEC. 6 T. 11 S. R. 6 W. Stake pulled out RE-SET-DIV. H. ASSELT

Mr. Moore of P.B. Co.

Set 3" stake and small stone from which a

Maple 80" in dia. bears $583\frac{1}{2}^{\circ}$ E 1.00 chains S&E

Fir 24" " " " $553\frac{1}{2}^{\circ}$ W .98 " "

" 7ft " " " 555° E .80 '70 face

" 7ft " " " $N. 16^{\circ}$ E .42 " " "

N. W. Corner of Sec. 8, T. 11 S. R. 6 W.

Set 1" iron rod and stake . . . N. 11.5° W

Maple bears 553° E .85 chains standing

" " " " 574° E .85

" 14" in dia. " $N. 24^{\circ}$ W .096 "

$\frac{1}{4}$ corner on south of Sec 34 T. 10 S. R. 6 W.

Set iron rod and pile of stones from which an

Oak 18" in diameter Bears South $87\frac{1}{2}^{\circ}$ slope ch.

Fir 18" " " " $59\frac{1}{2}^{\circ}$ E 1.84

$\frac{1}{4}$ corner on north of Sec 3 T. 11 S. R. 6 W.

Set 1" rod and pile of stones 15.10 E of 1 rod.

S. E. Corner of Sec. 34 T. 10 S. R. 6 W.

Set 1" rod from which a

Maple 14" in diameter bears $N. 11\frac{1}{2}^{\circ}$ E .66 chains S&E

Fir 24" " " " $587\frac{1}{2}^{\circ}$ E .182 "

N.E. Corner of H.S. Hallock Ch. 59 T. 11 S. R. 6 W.

Set $\frac{1}{2}$ " x $1\frac{1}{2}$ " iron bar .023 W of sec. line

Fir 8" in diameter bears $N. 70^{\circ}$ E .388 chains

Oak 20" " " " $N. 75^{\circ}$ E 1.90 org "

$\frac{1}{4}$ corner on west of Sec 3 T. 11 S. R. 6 W.

Set 3" bolt . . . from which

Fir 12" in diameter bears $N. 76\frac{1}{2}^{\circ}$ E .139 S&S

" 12" " " " 538° E .8.196 "

virg. Oak 20" " " " $570\frac{1}{2}^{\circ}$ E .8.882 "

" 36" " " " $N. 45^{\circ}$ E 4.78 "

S.W. corner of Sec. 8, T. 11 S. R. 6 W.

1" rod 17' 0" W of sec. line

Maple 18" in dia. bears $N. 11.5^{\circ}$ W .85

Oak 15" in dia. bears $N. 11.5^{\circ}$ W .85

" 14" " " " $N. 69^{\circ}$ E .8.40 "

" 20" " " " $N. 26^{\circ}$ W .8.70 "

Fir 24" " " " $N. 26^{\circ}$ E .8.70 "

Aug 16, 1929

W. W. L.

Witness

Oak post of N.W. corner of Sec. 10 T. 11 S. R. 6 W.

Set down 25' 2" 5.71

" 10' 12" " " $N. 74^{\circ}$ E .8.71

" 12' 17" " " $N. 65^{\circ}$ W .8.90 (1.7)

10-6 33

444 390

S. E. corner of section 34, Twp. 10 S. R. 6 W.

Reestablishment by W. C. Galloway

October 1929

Set 1" rod

Maple 14" in diam bears N $11\frac{1}{2}^{\circ}$ E

Fir 24" in diam bears S 87° E

Witness Henry Plunkett

.66 chains(standing)
.122 chains