

The N.E. corner of L.E. Newton D.L.C. #43 T.10 S.R.6 W.

Set a 1 1/4" iron pin oak stump S.W. Alder stump rotted out.

Oak 12" in dia. bears S 53° 18' E. 4.051 chs.

" 15" " " " S 56° 44' W. 6.141 "

The S.E. corner of Rowland Chambers D.L.C. #46 T.10 S.R.6 W.

Set 3/4" iron pin

Ash 7" in dia. bears N. 30° 50' E. 647 chs.

Oak 15" " " " S. 1° 17' W. 4.160 " same oaks N.E. corner

The N.W. cor. of Rowland Chambers D.L.C. #46 T.10 S.R.6 W.

Set a wagon thimble found oak stake Oak 30" N. 36° E. 53 down

Mkd. Fir 15" in dia. bears N. 89° E. 876 chs.

Oak 30" " " " S. 2° 20' E. 81 " std.

The N.E. cor. of Lazarus Vanbebber D.L.C. #44 T.10 S.R.6 W.

Set 1/2"x1/2" I rod N.W. oak 73 stump.

Oak 15" in dia. bears S. 84° W. 1.43 chs. std.

Mkd. " 5" " " " N. 21° 30' E. .364 "

Witnesses Frank Miller J.W. Banks & CH. Bogart Oct. 2, 1916.

The S.E. cor. of Lazarus Vanbebber D.L.C. #44 T.10-6

Set 1/2"x1/2" iron pin stake hole both trees check + dead.

Fir 26" in dia. bears N. 28° E. .292 chs.

" 30" " " " N. 87° 30' W. .390 "

Witnesses C.H. Bogart & Bruce Miller Oct. 4, 1916.

1/4 sec. cor. bet. secs. 22 & 23 T.10 S.R.6 W.

Set 1/2"x1/2" I rod & glass. Found charred oak stake E. of given dist. as 5/16" diam.

Oak 20" at but, sprout is 10" in dia. bears S. 85° 40' W. 2.450 chs. measured on

" 10" " " " N. 40° 40' W. 3.305 "

Witnesses Frank & Bruce Miller & J.W. Banks Oct. 5, 1916.

1/4 sec. cor. between secs. 23 & 24 T.10 S.R.6 W.

Set Qt. bottle 2 willow stumps check.

Fir 22" in dia. bears N 3° E. .050 chs.

" 12" " " " N. 63° W. .662 "

Witnesses J.W. Banks, Bruce Miller & Arlow Allan. Feb. 14, 1917.

Corner to secs. 22, 23, 24 & 27 T.10 S.R.6 W.

Set Qt. bottle 2 stumps & dead oak 20" all check roots not in

Fir 22" in dia. bears N. 3° E. .050 chs.

" 12" " " " N. 63° W. .662 "

Witnesses J.W. Banks, Bruce Miller & Arlow Allan. Feb. 14, 1917.

C.S. 168  
Witnessed by  
E.P. Woods  
Feb 7, 1917.

115  
Continued from  
Page 52

1203

1253  
Continued from  
Page 52

$\frac{1}{4}$ -Corner sections between sections 22 and 23, Twp. 10 S., R. 6 W. 263

Reestablishment by W. C. Galloway

October 5, 1916

Set  $\frac{1}{2}$ " x  $\frac{1}{2}$ " I rod and glass. Found charred Oak stake E. of given dist on li  
Oak 20" at but, sprout is 10" bears S 85°40'W 2.450 chains  
Oak 10" in diam bears N 40° 40' W 3.305 chains

Witnesses Frank and Bruce Miller and J. W. Banks

NO. 105 RAW SEC. 22 E 1/4 COR

NO. 1 END: 1/2" x 7/8" IRON BAR FOR THE COR. (OLD COR. REST. BK. NO. 1 PG. 114). THE BAR IRON BAR IS IN THE CTR. OF A CIRCLE OF STONES

NO OTHER RECORD BEARING OBJECTS WERE RECOVERED

SET: 2" I.D. x 36" LONG IRON PIPE @ A 3/4" BEN. CO. B.C. STAMPED AS SHOWN CENTERED OVER THE RECOVERED IRON BAR

A FIR 27" IN DIA. BEARS N 7° 45' E ~ 95.36'. FACED & SCRIBED "1/4 S 23 BT" SET A PK + B.C. B.W. IN THE NW 1/4 BASE. SET A B.T. TAG ON THE SW 1/4 FACE.

B FIR 22" IN DIA. BEARS S 21° 15' E ~ 170.62'. FACED & SCRIBED "1/4 S 23 BT" SET A PK + B.C. B.W. IN THE NE 1/4 BASE SET A B.T. TAG ON THE NW 1/4 FACE.

SET: 5/8" x 30" REBAR @ A Y.P.C. MKD. "BENTON COUNTY SURVEYOR" BEARS S 19° 30' W ~ 20.61'. THE REBAR IS 2.5' E 1/2" FROM THE TOP OF A CUT BANK

" 5/8" x 30" REBAR @ A Y.P.C. MKD. "BENTON COUNTY SURVEYOR" BEARS N 3° 30' W ~ 12.13'. THE REBAR IS 4.5' E 1/2" FROM THE TOP OF A CUT BANK

" ORANGE FIBERGLASS "SURVEY STAKE" POST 0.8 W 1/4

THE COR. IS LOCATED ON A W 1/4 SLOPING LIGHTLY WOODED MEADOW 5.5' E 1/2" FROM THE TOP OF A CUT BANK 45' N 1/2" FROM THE NE EDGE (150' HIGH CLIFF) SE AN OLD ROCK PIT AND 300 ± W 1/4" FROM A GRAVEL OR TO THE RESIDENCE AT 38515 PIT RD. (CO. RD. NO. 08541). IT IS VERY GOOD FOR PRE-MARKING & GPS CONTROL.

3/19/91, E.J.L. (MHA) @ KUH DATASCOPE, BRUNTON COMP. POPE DEC. SHAWRS, CABL 2/50

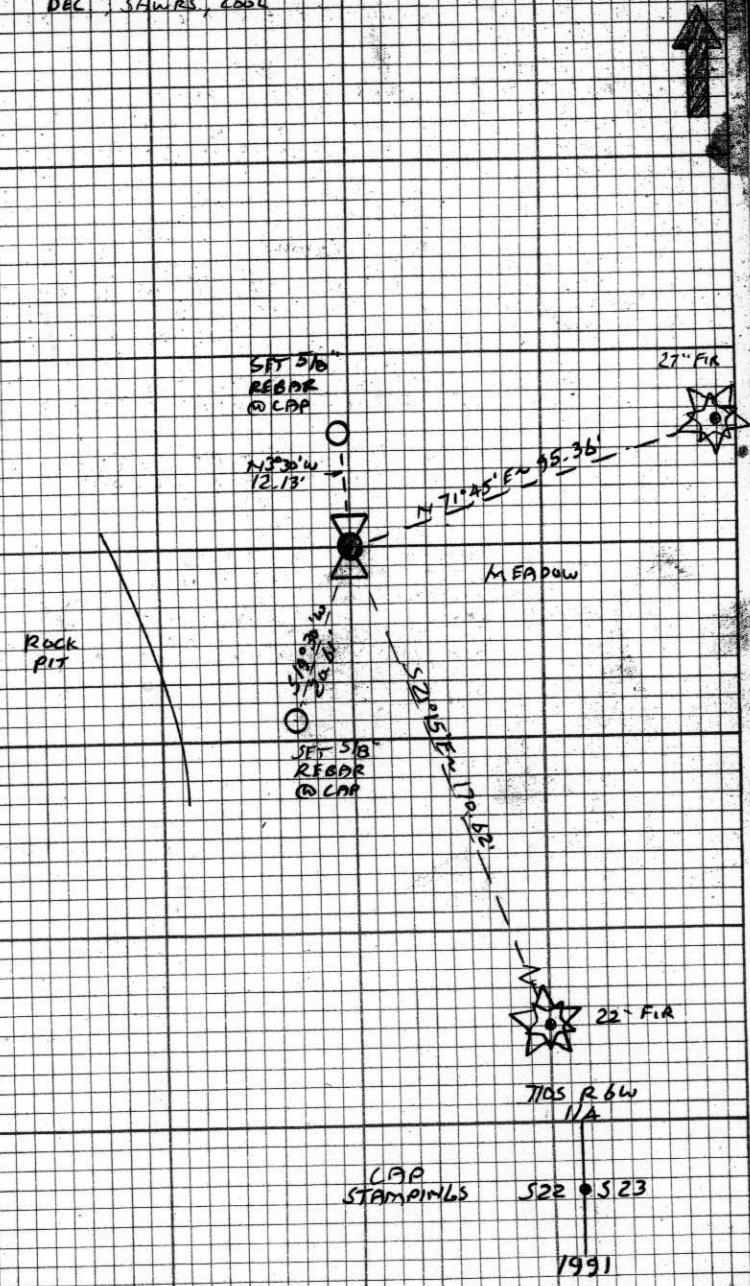

# BENTON COUNTY CORNER RESTORATION FORM

3902

TOWNSHIP 10 S RANGE 6 W SECTION 22 D.L.C.

106500340  
CORNER E 1/4

DATE 3/19/91 CORNER RESTORATION FIELD BOOK NUMBER 2 PAGE(S) 50

## CORNER DESIGNATION:

THE QUARTER CORNER COMMON TO SECTIONS 22 AND 23,  
IN T 10 S, R 6 W, WILLAMETTE MERIDIAN.

S22 ● S23

- CONDITION REPORT ONLY
- REFERENCED OUT
- RENEWED
- SURVEYED IN

## LOCATION AND COMMENTS:

THE CORNER IS LOCATED ON A WESTERLY SLOPING LIGHTLY WOODED MEADOW, 5.5 FEET EASTERLY FROM THE TOP OF A CUT BANK, APPROXIMATELY 45 FEET NORTHEASTERLY FROM THE NORTHEAST TOP EDGE (150 FEET HIGH CLIFF) OF AN OLD ROCK PIT AND APPROXIMATELY 300 FEET WESTERLY FROM A GRAVEL DRIVEWAY TO THE RESIDENCE AT 38515 PIT ROAD (COUNTY ROAD NO. 08541).

## PREVIOUS RENEWALS/SURVEYS, ETC:

ORIGINAL GLO SURVEY BY DANIEL MURPHY DATED 1854  
MAP NO. 10-6-00004 BY W.C. GALLOWAY DATED SEPTEMBER 27, 1916.  
OLD CORNER RESTORATION BOOK NO. 1 PAGE 114 BY W.C. GALLOWAY DATED OCTOBER 5, 1916.  
CORNER RESTORATION NO. 363 BY W.C. GALLOWAY DATED OCTOBER 5, 1916.  
MAP NO. 10-6-00011 BY W.C. GALLOWAY DATED OCTOBER 6, 1916.  
COUNTY SURVEY NO. 581 BY W.C. GALLOWAY DATED FEBRUARY 13, 1917.  
COUNTY SURVEY NO. 6293 BY ARNOLD BRUBAKER DATED FEBRUARY 25, 1977.

## MONUMENTS AND ACCESSORIES FOUND (CONDITION AND SOURCE):

FOUND: 1/2" X 7/8" IRON BAR FOR THE CORNER (OLD CORNER RESTORATION BOOK NO. 1 PAGE 114). THE IRON BAR IS IN THE CENTER OF A CIRCLE OF STONES.

NO OTHER RECORD BEARING OBJECTS WERE RECOVERED.

### MONUMENT DETAIL

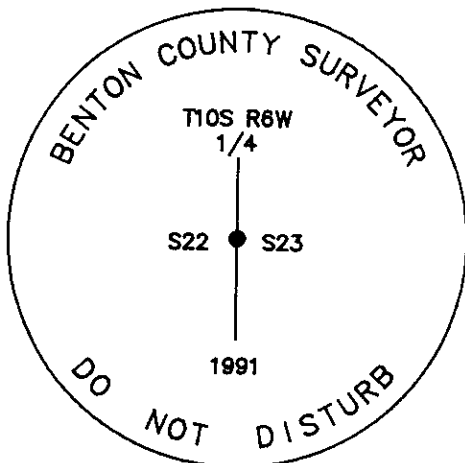

3 1/4" BRASS CAP



### SKETCH

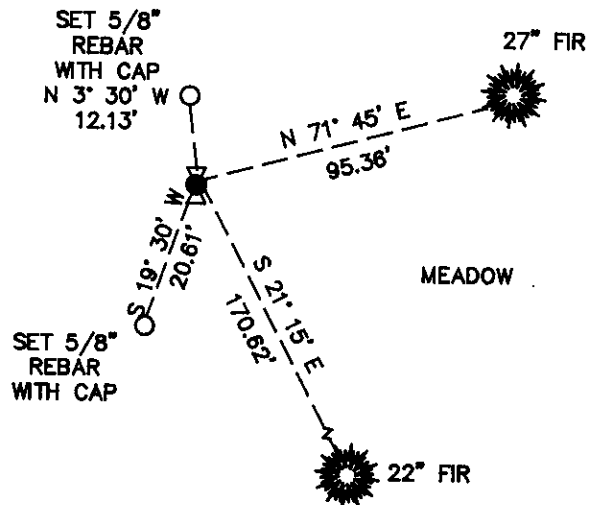

## MONUMENT SET (PROCEDURES AND DESCRIPTION):

SET: 2" INSIDE DIAMETER X 36" LONG IRON PIPE WITH A 3 1/4" BENTON COUNTY BRASS CAP, STAMPED AS SHOWN, CENTERED OVER THE RECOVERED IRON BAR.

## NEW ACCESSORIES:

- A FIR 27" IN DIAMETER BEARS N 71° 45' E 95.36 FEET, FACED AND SCRIBED "1/4 S23 BT". SET A PK NAIL AND B.C.B.W. IN THE NORTHWESTERLY BASE. SET A B.T. TAG ON THE SOUTHWESTERLY FACE.
- A FIR 22" IN DIAMETER BEARS S 21° 15' E 170.62 FEET, FACED AND SCRIBED "1/4 S23 BT". SET A PK NAIL AND B.C.B.W. IN THE NORTHEASTERLY BASE. SET A B.T. TAG ON THE NORTHWESTERLY FACE.
- SET: 5/8" X 30" REBAR WITH A YELLOW PLASTIC CAP MARKED "BENTON COUNTY SURVEYOR", BEARS S 19° 30' W 20.61 FEET. THE REBAR IS 2.5 FEET EASTERLY FROM THE TOP OF A CUT BANK.
- SET: 5/8" X 30" REBAR WITH A YELLOW PLASTIC CAP MARKED "BENTON COUNTY SURVEYOR", BEARS N 3° 30' W 12.13 FEET. THE REBAR IS 2 FEET EASTERLY FROM THE TOP OF A CUT BANK.

SET: ORANGE FIBERGLASS "SURVEY STAKE" POST 0.8 FOOT WESTERLY.

## NOTES:

B.C.B.W. IS A BRASS WASHER STAMPED "BENTON COUNTY SURVEYOR". COMPASS DECLINATION IS 20° EAST. ALL MEASURED DISTANCES AND COMPASS BEARINGS ARE TO THE CENTER OF THE OBJECT, UNLESS OTHERWISE NOTED.

THIS RESTORATION WAS PERFORMED AT THE DIRECTION AND APPROVAL OF THE BENTON COUNTY SURVEYOR. df

FIRM/AGENCY: BENTON COUNTY SURVEYOR

ADDRESS: 360 S.W. AVERY AVE. CORVALLIS OR. 97333; PH. 757-6821

SURVEY CREW: CURTIS J. LIESENFELT & MARK E. ANDERSON

WITNESS:

REGISTERED  
PROFESSIONAL  
LAND SURVEYOR

*Curtis J. Liesenfelt*

OREGON  
JULY 17, 1986  
CURTIS J. LIESENFELT  
2213