

106540300

CORNER FILE TRACKING

S:\Survey Corners\CORNERS\Templates\Filetrac2.doc
10/04/2010

CORNER NUMBER
106540300

STEP	HISTORY	RESTORATION
Form Prepared, DB	12/10/13	8/7/17
Field Inspection, DB	5/00/17	5/00/17
Finish index (count unit)	12/10/13	5/00/17
Counter Index	5/15/17	5/15/17
GIS Index Form	5/15/17	5/15/17
Checked, DB	8/8/17	8/8/17
Form Edited, DB	8/8/17	8/8/17
Form Signed, DB	8/8/17	8/8/17
Authorize Payment, DB	—	—
Archive Digital Files	8/8/17	8/8/17
Collect Documents	8/8/17	8/8/17
PDF File	8/8/17	8/8/17
Copy For Filming	8/8/17	8/8/17
Scanned (pdf to laserfiche)	8/8/17	8/8/17
Filmed (Archived), DB		
Filed, DB		

(DB) = Entry needed in database (Access).

COMMENTS:

DATE 12/18/2013TOWNSHIP 10 SOUTH, RANGE 6 WEST, WILLAMETTE MERIDIAN; SECTION 23 CORNER SOUTH 1/4
DONATION LAND CLAIM N/A CORNER N/A**COMMON CORNER(S):**

NORTH 1/4 CORNER SECTION 26

RECORDS (INFORMATION IN BOLD /ITALICS IS COUNTY STAFFS' INTERPRETATION OF THE RECORD)**BASED ON EXTENSIVE RESEARCH AND RECOVERY OF EVIDENCE, THIS OFFICE HAS DETERMINED THAT MOST GENERAL LAND OFFICE SURVEYORS IN BENTON COUNTY MEASURED TO THE FACE OF BEARING TREES.**

- [01] GENERAL LAND OFFICE (GLO) NOTES BY DANIEL MURPHY, D.S., DATED DECEMBER 1, 1853. SET POST FROM WHICH AN OAK **12" DIA BEARS S17-1/2°E, 236 LINKS (155.76 FEET); A FIR 24" DIA BEARS N68°W, 200 LINKS (132.00 FEET).**
- [02] BENTON COUNTY SURVEY NO. 565 (OLD NO. 253) FIELD NOTES (FIELD BOOK 21, PAGE 81) BY W. C. GALLOWAY, C.S., DATED SEPTEMBER 12, 1916. SET **3/4" X 3/4" X 30" IRON, SOUTHEAST OAK (GLO BT) DOWN. FIR 24" DIA (GLO BT) BEARS N68°W, 2.00 (SIC) CHAINS (44.88 FEET) STANDING; FIR 13" DIA BEARS N65°E, 0.068 CHAINS (4.49 FEET).**
- [03] BENTON COUNTY CORNER RESTORATION BOOK NO. 1, PAGE 111, BY W. C. GALLOWAY, C.S., DATED SEPTEMBER 22, 1916. SET **3/4" X 3/4" X 30" IRON BAR. SOUTHEAST OAK (GLO BT) DOWN, CHECK. FIR 24" DIA (GLO BT) BEARS N68°W, 2.00 CHAINS (132.00 FEET) STANDING; MARKED FIR 13" DIA (CSBT) BEARS N65°E, 0.068 CHAINS (4.49 FEET).**
- [04] BENTON COUNTY CORNER RESTORATION NO. 365. **TRANSCRIBED FROM RECORD [03] AND MAY CONTAIN ERRORS AND/OR OMISSIONS.**
- [05] BENTON COUNTY MAP NO. 10-6-00004 BY W. C. GALLOWAY, C.S., DATED SEPTEMBER 27, 1916. **3/4" X 3/4" IRON ROD 30" LONG. FIR 24" DIA (GLO BT) BEARS N68°W, 2.00 CHAINS (132.00 FEET); FIR 13" DIA (CSBT) BEARS N65°E, 0.068 CHAINS (4.49 FEET).**
- [06] BENTON COUNTY MAP NO. 10-6-00011 BY W. C. GALLOWAY, C.S., DATED OCTOBER 6, 1916. **3/4" X 3/4" X 30" IRON ROD.**
- [07] BENTON COUNTY SURVEY NO. 1120 (OLD NO. 51 OR 354 OR 253) FIELD NOTES (FIELD BOOK 43, PAGE 14) BY WALTER W. LARSEN, D.C.S., DATED 1929. **3/4" ROD. FIR 24" DIA (GLO BT) BEARS N68°W, 2.00 CHAINS (132.00 FEET); FIR 13" DIA (CSBT) BEARS N65°E, 0.068 CHAINS (4.49 FEET).**
- [08] BENTON COUNTY SURVEY NO. 4317 BY RALPH D. WILKINSON, P.E., DATED AUGUST 1966. **FOUND ROD AND BEARING TREE STUMP (GLO BT) BEARS N68°W, 2.00 CHAINS (132.00 FEET); MARKED FIR 11" DIA BEARS N46°W, 13 LINKS (8.58 FEET); MARKED FIR 8" DIA BEARS WEST, 24 LINKS (15.84 FEET).**
- [09] BENTON COUNTY PARTITION PLAT NO. 1992-027 BY THEODORE JAMES LANGTON, P.L.S., DATED APRIL 20, 1992. **3/4" SQUARE ROD IN CLEARCUT 100' NORTH OF RIDGE ROAD. UDELL BEARING TREES FOUND: HIGH CUT D. FIR STUMP 27" DIA (11") BEARS N46°E (N46°W, 8.58 FEET) HEALED; D. FIR STUMP 24" DIA (8") (WEST, 15.84 FEET) HEALED. BEARING TREES MEASURED FROM CENTER OF TREE.**

FIRM/AGENCY: BENTON COUNTY SURVEYOR'S OFFICE**ADDRESS:** 360 S.W. AVERY AVE., CORVALLIS, OR 97333; PH. 766-6821**RESEARCH BY:** DAVID L. MALONE, P.L.S.**DATA ENTRY BY:** SAME

**BENTON COUNTY CORNER RESTORATION FORM, PAGE 1 OF 2, 106540300R2
SEE CORNER HISTORY FORM FOR RECORDS ETC.**

CORNER RESTORATION FIELD BOOK NUMBER 31 PAGE(S) 33 DATE 05/08/2017
TOWNSHIP 10 SOUTH, RANGE 6 WEST, WILLAMETTE MERIDIAN; SECTION 23 CORNER SOUTH 1/4
DONATION LAND CLAIM N/A CORNER N/A
CONDITION REPORT ; REFERENCED OUT ; RENEWED X; SURVEYED IN

LOCATION AND COMMENTS:

CORNER IS LOCATED ON A FLAT RIDGE TOP IN A STAND OF ±25 YEAR OLD D. FIR. TO REACH CORNER FROM THE INTERSECTION OF PRICE CREEK ROAD AND PIT ROAD, FOLLOW PRICE CREEK ROAD SOUTHEASTERLY FOR 0.16 MILES TO A GATE, TRAVEL THROUGH GATE AND CONTINUE FOR 1.52 MILES TO A TEE, TURN LEFT AND FOLLOW ROAD FOR 0.79 MILES TO A 4 WAY INTERSECTION, TURN LEFT FOR 0.06 MILES TO A WYE, STAY LEFT FOR 0.23 MILES TO A 4 WAY INTERSECTION, STAY STRAIGHT FOR 0.08 MILES TO A WYE, STAY RIGHT FOR 0.27 MILES TO A WYE, TURN LEFT FOR 0.13 MILES TO A 4 WAY INTERSECTION, STAY STRAIGHT FOR 0.08 MILES TO A WYE, STAY LEFT FOR 0.17 MILES AND PARK. WALK NORTH ABOUT 100 FEET TO THE CORNER. CORNER IS BAD FOR PREMARKING AND GPS CONTROL.

MONUMENTS AND ACCESSORIES FOUND (CONDITION AND SOURCE):

1. FOUND 3/4" SQUARE IRON ROD, FIRMLY SET AND UNDISTURBED, FLUSH WITH GROUND SURFACE FOR THE CORNER.
(SET POST PER RECORD [01]).
(SET 3/4" X 3/4" X 30" IRON PER RECORD [02]).
(SET 3/4" X 3/4" X 30" IRON BAR PER RECORD [03]).
(3/4" X 3/4" IRON ROD 30" LONG PER RECORD [05]).
(3/4" X 3/4" X 30" IRON ROD PER RECORD [06]).
(3/4" ROD PER RECORD [07]).
(FOUND ROD PER RECORD [08]).
(3/4" SQUARE ROD PER RECORD [09]).
2. FOUND ROTTEN D. FIR STUMP 49" DIA BEARS N68°00'W, 132.62 FEET TO FACE. OPENED STUMP TO REMAINS OF FACE AND NOTCH. FACE DOES NOT ALIGN DIRECTLY TO CORNER. **BASIS OF BEARINGS FOR THIS RESTORATION.**
(FIR 24" DIA BEARS N68°W, 200 LINKS [132.00 FEET] PER RECORD [01]).
(FIR 24" DIA BEARS N68°W, 0.68 CHAINS [44.88 FEET] STANDING PER RECORD [02]).
(FIR 24" DIA BEARS N68°W, 2.00 CHAINS [132.00 FEET] STANDING PER RECORD [03]).
(FIR 24" DIA BEARS N68°W, 2.00 CHAINS [132.00 FEET] PER RECORDS [05] AND [07]).
(BEARING TREE STUMP BEARS N68°W, 2.00 CHAINS [132.00 FEET] PER RECORD [08]).
3. FOUND 6 FOOT TALL ROTTEN D. FIR STUMP 23" DIA WITH OPEN FACE AND VISIBLE SCRIBING "BT" BEARS N45°24'E, 8.76 FEET TO CENTER.
(MARKED FIR 11" DIA BEARS N46°W, 13 LINKS [8.58 FEET] PER RECORD [08]).
(HIGH CUT D. FIR STUMP 27" DIA [11"] BEARS N46°E [N46°W, 8.58 FEET], HEALED PER RECORD [09]).
4. FOUND ROTTEN D. FIR STUMP 19" DIA WITH HEALED FACE BEARS N89°53'W, 16.06 FEET TO CENTER. OPENED TO ROTTEN REMAINS OF FACE WITH ILLEGIBLE SCRIBE MARKS.
(MARKED FIR 8" DIA BEARS WEST, 24 LINKS [15.84 FEET] PER RECORD [08]).
(D. FIR STUMP 24" DIA (8") [WEST, 15.84 FEET], HEALED PER RECORD [09]).

MONUMENT SET (PROCEDURES AND DESCRIPTION):

- FOUND 3/4" SQUARE IRON ROD, FIRMLY SET AND UNDISTURBED, FLUSH WITH GROUND SURFACE FOR THE CORNER. IRON ROD WAS SET BY W. C. GALLOWAY, C.S., IN 1916 FROM A STANDING GENERAL LAND OFFICE (GLO) BEARING TREE AND A DOWN GLO BEARING TREE. THE IRON ROD IS ACCEPTED AS A PERPETUATION OF THE ORIGINAL CORNER POSITION.
1. DROVE IRON ROD DOWN SEVERAL INCHES AND OVER IT IN THE SAME HORIZONTAL POSITION SET A 2" X 31-1/2" GALVANIZED IRON PIPE WITH A 3-1/4" BRASS DISK CEMENTED IN THE TOP, UP 1" ABOVE GROUND SURFACE AND MARKED AS SHOWN ON PAGE 2 OF 2.
 2. SET TWO NEW IRON ROD ACCESSORIES AND BLAZED AND SCRIBED TWO NEW BEARING TREES AS SHOWN ON PAGE 2 OF 2. SET 6 FOOT ORANGE CARSONITE "SURVEY MARKER" POST 1 FOOT SOUTH OF BRASS DISK.

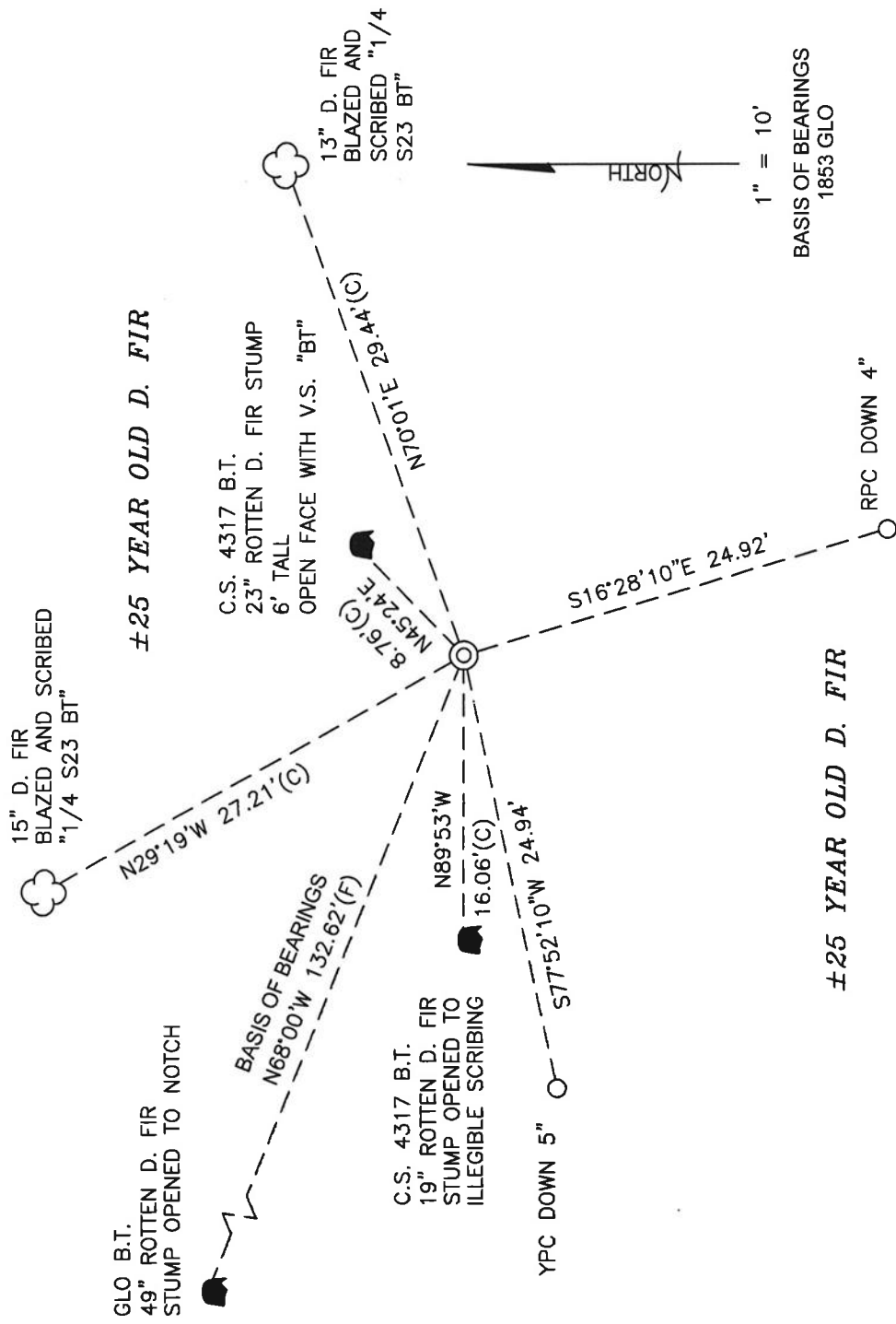

MONUMENT DETAIL

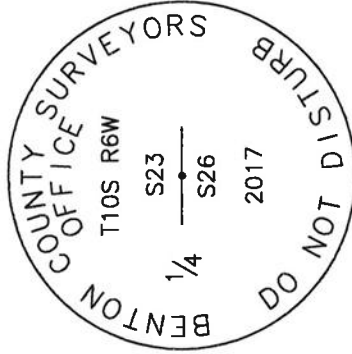

3-1/4" BRASS DISK

LEGEND

- SET 5/8" X 30" REBAR WITH PLASTIC CAP
- YPC YELLOW PLASTIC CAP MARKED "BENTON COUNTY SURVEYOR"
- RPC RED PLASTIC CAP MARKED "BENTON COUNTY SURVEYOR"
- (F) MEASUREMENT TO FACE
- (C) MEASUREMENT TO CENTER
- ⊙ GOVERNMENT MONUMENT SET AS SHOWN
- V.S. VISIBLE SCRIBING
- C.S. COUNTY SURVEY
- GLO GENERAL LAND OFFICE
- B.T. BEARING TREE
- ☛ BEARING TREE STUMP AS NOTED
- ☁ BEARING TREE AS NOTED

NEW ACCESSORIES:

1. SET REBAR (SEE LEGEND) $S16^{\circ}28'10"E$, 24.92 FEET AND 4 INCHES BELOW GROUND LEVEL.
2. SET REBAR (SEE LEGEND) $S77^{\circ}52'10"W$, 24.94 FEET AND 5 INCHES BELOW GROUND LEVEL.
3. D. FIR 13" DIA BEARS $N70^{\circ}01'E$, 29.44 FEET TO CENTER, FACE SCRIBED "1/4 S23 BT". SET ALUMINUM NAIL AND PLASTIC WASHER ON SOUTHERLY BASE FOR DISTANCE MEASUREMENT.
4. D. FIR 15" DIA BEARS $N29^{\circ}19'W$, 27.21 FEET TO CENTER, FACE SCRIBED "1/4 S23 BT". SET ALUMINUM NAIL AND PLASTIC WASHER ON SOUTHWESTERLY BASE FOR DISTANCE MEASUREMENT.

NOTES:

COMPASS DECLINATION IS 16' EAST. ALL MEASURED DISTANCES AND BEARINGS ARE TO THE CENTER OF THE OBJECT. UNLESS OTHERWISE NOTED. ALL BEARING TREES ARE PAINTED AND HAVE A B.T. TAG ATTACHED, FACING THE CORNER UNLESS OTHERWISE NOTED. ALL NEW BEARING TREES HAVE A PLASTIC WASHER (STAMPED "SURVEY MARKER DO NOT REMOVE") ATTACHED BY AN ALUMINUM NAIL TO THE SIDE CENTER OF THE TREE FOR DISTANCE MEASUREMENT, UNLESS OTHERWISE NOTED.

THIS RESTORATION WAS PERFORMED AT THE DIRECTION AND APPROVAL OF THE BENTON COUNTY SURVEYOR *[Signature]*

REGISTERED
PROFESSIONAL
LAND SURVEYOR

[Signature]
2/20/17

OREGON
JANUARY 12, 1999
DAVID L. MALONE
51523

FIRM/AGENCY: BENTON COUNTY SURVEYOR'S OFFICE
ADDRESS: 360 S.W. AVERY AVE., CORVALLIS, OR 97333; PH. 541-766-6821
PRESENT: DAVID L. MALONE, P.L.S. AND BERNARD ALTENBACH, SURVEY TECH.
EQUIPMENT: NIKON NIV03.C WITH SURVEY PRO ONBOARD.

WASH, CLARK
 5/8/2017
 D MANOLE
 B ALTENBACH
 31/33

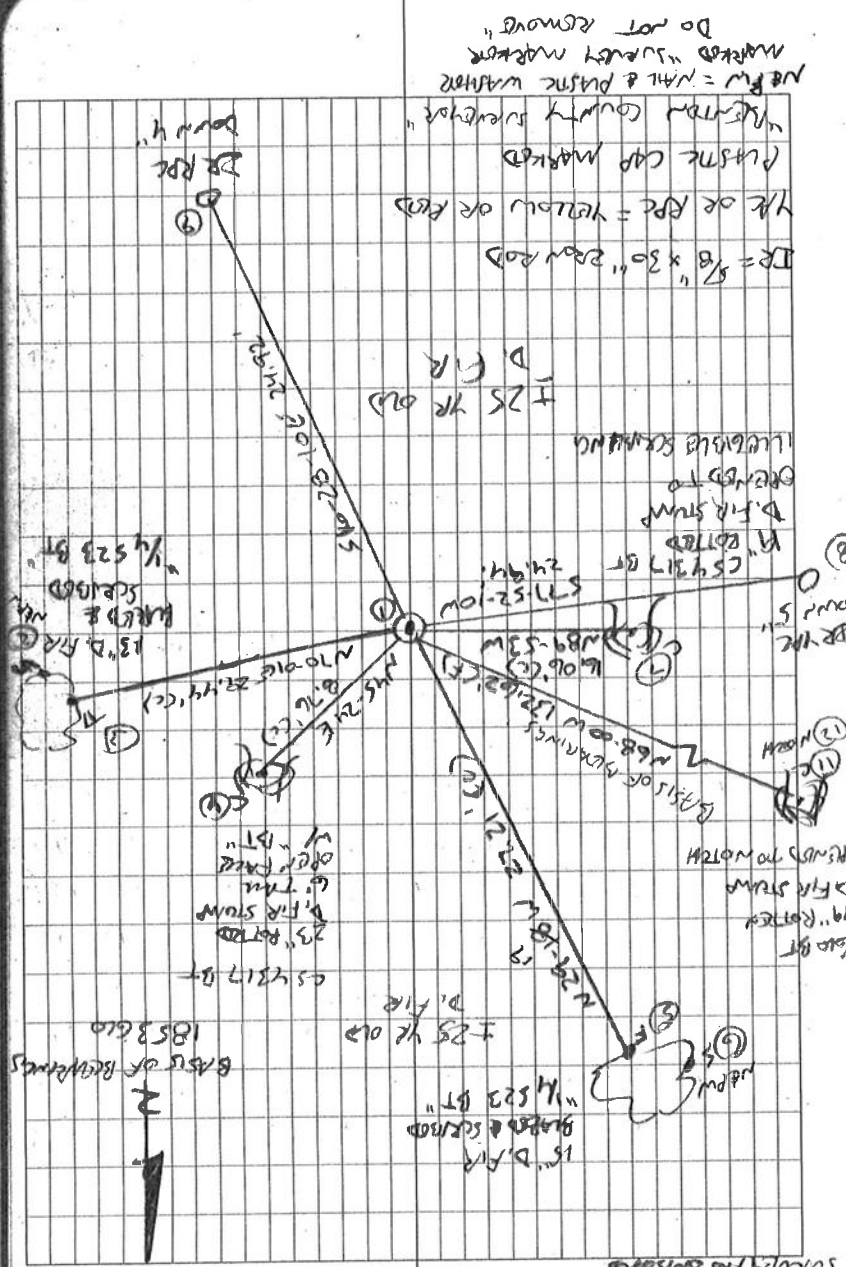

W/NOTH. FACES DOES NOT FACE (CARPENTER HEAD
 FOR BASIS OF BEARINGS. FD CS 4317 BT STUMP
 W/HORNSD FACE TO NW OPENED TO POTTER REMAINS
 OF FACE W/ ILLINOIS SCRIPE MARKS. FD CS 4317
 NIS BT HIT CUT STUMP W/ OPEN LOWER
 FACE W/ SCRIPE MARKS "BT". DROVE SO BEAR ROD
 DOWN SEVERAL INCHES AND OVER IT IN SAME HORIZONTAL
 POSITION SET 2" x 31-1/2" G.E.P. W/ 3-1/4" BRASS DISK
 CEMENTED IN TOP UP 1" ABOVE GROUND SURFACE. SET
 2 BRON ROD ACCESSORIES, AND BUBBLES & SCRIPE
 2 NEW BEARINGS TESTS. SET G
 ORANGE CARBONITE "SURVEY MARKER"
 Post 1' SOUTH OF BRASS DISK.

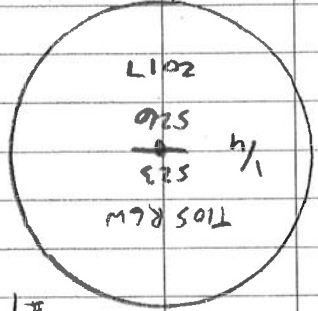

106540300
 523
 1/4 526
 REMONUMENT T105 R6W 1/4 526

CORNER RESTORATION BOOK NO. 1

C.S. # 253 ↓

^{Next S.}
S.W. corner of James Green D.L.C. # 50 T. 10 S. R. 6 W.
Set Stone 6"X10"X18" which had been graded ^{on N. & S. sides} 1.7 ft above 1000 side
Marked There 6" in dia. bears N. 54° 30' E. 557 chs.
" Oak 10" " " " S. 23° E. 5701 "
Orig. " 10" " " N. 21° 59' W. 11.77 " s.d.
Witnesses as last corner. Sept. 17, 1916.

S.E. corner of James Green D.L.C. # 50 T. 10 S. R. 6 W.
Set a 1/2" X 1/2" iron rod
Maple 12" in dia. bears S. 40° E. 228 chs. s.d.
Mkd. in 15" " " S. 23° 40' W. 730 "
Oak 10" " " N. 45° W. 942 " " s.d.
Witnesses H.T. Walter & Elmer Maxfield, Bruce & Frank Miller Sept. 13, 1916.

N.E. Corner of James Green D.L.C. # 50 T. 10 S. R. 6 W. ^{at edge}
Set a Stone 8"X11"X13" hole in top set from Oak stump & old set stamp
Fir 9" in dia. bears N. 62° 30' E. 202 chs.
" 10" " " N. 34° 30' W. 1032 "
Witnesses H.T. & Walter Maxfield, Bruce Miller Sept. 14, 1916.

N.W. corner of James Green D.L.C. # 50 T. 10 S. R. 6 W.
Set a Stone 6"X6"X14" 8" under surface set from oak & stump.
Oak 20" in dia. bears S. 41° E. 464 chs. s.d.
" Stamp 15" " " S. 15° E. 373 " "
Mkd. 12" " " S. 0° 30' W. 2821 "
Witnesses Walter & H.T. Maxfield & C.E. Rice Sept. 15, 1916.

S.E. corner of James W. Bingham D.L.C. # 51 T. 10 S. R. 6 W.
Set a stone 6"X6"X16" orig. stone gone, set from trees.
Mkd. an Oak 5" in dia. bears N. 30° 40' E. 335 chs.
Orig. " 36" " " " S. 68° W. 496 " s.d.
" 15" " " " S. 50° W. 480 " "
Witnesses as NE cor. Sept. 14, 1916.

1/4 sec. cen between secs. 14 & 23 T. 10 S. R. 6 W.
Set 1/2" iron rod. Set from ash and fir stump, checked.
Marked W fir. 30" in dia. bears S. 39° W. 610 chs.
" W. " 12" " " N. 48° 30' W. 512 "
Ash 4" " " N. 21° E. 10 " ^{Forest gone, but Fork Tree S.d.}

Witnesses Bruce & Frank Miller & John Banks. Sept. 21, 1916.
1/4 sec. cor. bet. secs. 23 & 26 T. 10 S. R. 6 W
Set 3/4" X 1/4" X 50" iron bar ^{of oak down} checked.
Mkd. Fir 13" in dia. bears N. 65° E. 065 chs.
" 24" " " N. 65° W. 206 " s.d.
Witnesses as last corner. Sept. 22, 1916.



$\frac{1}{4}$ -Section corner between sections 23 and 26, Twp. 10 S., R. 6 W. 565

Reestablishment by W. C. Galloway

September 22, 1916

Set $\frac{3}{4}$ " x $\frac{3}{4}$ " x 30" iron bar, S. E. Oak down, check

Fir 13" in diam bears N 65° E

Fir 24" in diam bears N 68° W

.068 chains
2.00 chains (standing)

Witnesses Bruce and Frank Miller and John Banks