

S.R.5W.

C.S. # 361 1/4 Sec. Corner between Secs. 35 &amp; 36 T.10 S.R. 6 W. N. M.

by W.C. Galloway  
Sept. 1936  
WitnessesH.B. Auld,  
Philip Auld and  
Rudolph J. Stewart  
Sept. 2, 1936

Set a 3/4" Pipe, Orig. corner.

Fir 8" in dia. bears N. 71° E. .41 chs. std. Magnetic N. 77° E.

Mkd. fir 11" in dia. bears N. 19° W. .256

" " 10" " " N. 25° E. .279

T.10-5

1/4 Sec. Cor. on the south side of Sec. 35 T.10-6

Set a Wrench 18" x 1 1/4" x 3/4", Orig. Corner.

Found fir 8" N. 51° W. .19 chs., lying on ground. Letters on both blades

Mkd. fir 22" S. 88° E. .254 chs., line tree.

" " 12" S. 32 1/2° W. .411 "

" " 28" S. 87° W. .360 " , " "

T.10-6

C.S. #272

July 17, 1936  
by W.C. Galloway C.S.  
Adrian Seitz and  
I. W. Botz

1/4 Sec. Cor. bet. Secs. 10 &amp; 11 T.10 S.R. 7 W.

Set a 1 1/4" Pipe.

Fir 10" S. 2° E. 4.42 down.

From Fir 12" (now 56") S. 13° W. 2.16 std.

Mkd. " 24" in dia. bears S. 86° E. .162 chs.

"

July 1936

Corner bet. Secs. 1, 2, 11 &amp; 12 T. 10-7

Set a 3/4" Pipe

From an Alder 20" N. 45° W. .05, stub std.

" " " 12" N. 75° W. .08, " "

Mkd. a fir 20" in dia. bears S. 9° 10' W. 1.226 chs.

" " " 20" " " S. 61° 20' W. 1.437 "

" " " 16" " " N. 43° 35' E. .918 "

1/2 chs.

1/4 Sec. Cor. bet. Secs. 11 &amp; 14 T. 10-7

Set a 3/4" Galv. pipe,

From a fir 36" in dia. bears N. 51° W. .91 chs. std.

" " " 24" " " S. 84° W. 2.01 " "

"

C.S. #272

Sept. 1936

R. J. Stewart  
Witness

1/4 Sec. Cor. bet. Secs. 14 &amp; 15 T. 10-7

Set a 1 1/2" pipe

Re-marked a Cedar 36" (was 12') S. 85° E. .80 chs, std. dead heart.

" " " 30" (" 9") N. 55° W. .50 " "

Marked a hemlock 9" in dia. bears N. 73° E. .109 "

T.10-7

1/4 Sec. Cor. bet. Secs. 13 &amp; 14 T. 10-7

Set a 1/2" x 20" Galv. pipe

Fir 50" in dia. bears N. 10° E. .69 chs., dead snag

" 40" " " S. 12° W. .66 " "

Mkd. " 22" " " S. 10° W. .129 "

" " 20" " " West .256 "

T.10-8

1/4 Sec. Cor. bet. Secs. 14 &amp; 23 T. 10-7

Set a car axle

Fir 70" in dia. bears S. 30° E. 1.28 chs., hollow stub.

" 9" " " N. 10° W. .99 " 1/4 S on bark

Mkd. " 16" " " N. 32° E. .136 "

" " 16" " " N. 54 1/2° W. .250 "

T.10-8

$\frac{1}{4}$ -Section corner between sections 35 and 36, Twp. 10 S., R. 6 W. W. M

395

Reestablishment by W. C. Galloway

September 1936

Set a  $\frac{3}{4}$ " pipe, original corner

Fir 8" in diam bears N 71° E

.41 chains

Fir 11" in diam bears N 19° W

.256 chains

Fir 10" in diam bears N 25° E

.279 chains

Witnesses H. B. Auld, Philip Auld and Rudolph J. Stewart

1-211  
395

CORNER HISTORY		T 10 S, R 6 W		SECTION 35 D.L.C.		CORNER E 1/4 CORNER		# 600140
NO.	DATE	SOURCE	SURVEYOR	MONUMENTS AND ACCESSORIES		COMMENTS		
1	9/22/1854	ORIG 660	DANIEL MURPHY	SET POST @ MAPLE + FIR FOR BT'S		MEAS. TO FAULT		1
2	8/19/1936	CS # 1285	W. L. GALDWAY	FWD 1 BT + 1 HOLE SET 3/4" PIPE @ 2 NEW BT'S		FB 4A/23		2
3	9/1936	OLD COR. REST. BK # 1, PL. 211	" "	" " " SET 3/4" PIPE @ 2 NEW BT'S (TRANS. FROM)				3
4		REST. 395		TRANS. COPY OF RECORD [03] + MAY CONTAIN E + D				4
5	NONE GIVEN	MAP NO. 10-6-00012	BENTON COUNTY	3/4" PIPE @ 3 BT'S, 1 STD.				5
								6
								7
								8
								9
								10
								11
								12
								13
								14
								15
								16
								17
								18
								19
								20
								21
								22
								23
								24
								25
								26

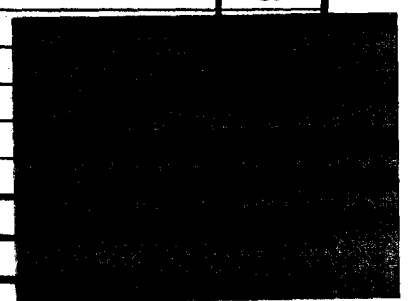

1111

### CORNER FILE TRACKING

F:\Survey\Corners\Misc\Filetrac.doc

8/7/97

106600140

<b>STEP</b>	<b>HISTORY</b>	<b>RESTORATION</b>
<b>FORM PREPARED</b>	✓	✓
<b>FORM CHECKED</b>	✓	✓
<b>FORM EDITED</b>	✓	✓
<b>FORM SIGNED</b>	✓	✓
<b>ARCHIVE DIGITAL FILES</b>	8/7/97	8/2/97
<b>COLLECT DOCUMENTS</b>	4	4
<b>COPY FOR FILMING</b>	4	4
<b>FILMED</b>	8/19/97	8/19/97
<b>SCANNED</b>		
<b>INDEXED</b>		
<b>UPDATE DATABASE</b>		
<b>FILED</b>		

2/26/97 EAST 1/4 CORNER (1)  
JW, NS Between sect 35 | 36 T10SR6W

1936 (2) { Fd 3/4" X 25" I. PIPE - Galloway 1936  
(N 19° W, .256 CH)  
Fd 19" DIA MAPLE STUMP N W, .297  
(N 25° E, .279 CH)  
~~Fd ROTTING FIR STUMP N E, .401, 7.  
(8" FIR N 71° E, .41 CH)~~

ORIGINAL (7" MAPLE N 59° W, .19 CH)

(1) ✓ (8" FIR N 77° E, .41 CH)

SET

(1) SET SPRINGER YPC N 77° E (.41 CH) 27.06'  
IN ROOT HOLE

.256 CH  
(2)  $\frac{66}{1.536}$  SET 6" SPIKE N 19° W (16.90) 17.40'  
15.36 WITH Benton County Surveyor BRASS  
16.896 WASHER IN TOP 19" MAPLE STUMP  
16.90 WITH VISIBLE SCRIBING. NOTE 16.9'  
Fell in Rotted out Portion. BT Tag  
IN TOP.

(3) SET 6" SPIKE W/B/Washer S 61° 07' W, 17.82'  
IN TOP 20" FIR STUMP

(4) SET SPRINGER YPC S 25° 51' E, 10.01'

T10SR6W  
CARSONITE POST 1.0' WEST  
1/4  
SET BC @ COR 335 | 336  
LS1102  
1997

CONT. Pg 1

SET STL POST 1.0 south  
SET LOCATION TAG S 86° W 157'

~~FROM JUNCTION of PIT Road &  
PRICE Creek Rd~~

ON TOP OF KNOLL

100' S. of Gravel Road  
157' N 86° E of <sup>LOCATION TAG at</sup> TURN in Gravel  
Road

100' S. of Gravel Road

157' N 86° E of TURN in Gravel Road

No. 311

**SEE CORNER HISTORY FORM FOR RECORDS ETC.**

CORNER RESTORATION FIELD BOOK NUMBER            PAGE(S)            DATE 02-26-97  
 TOWNSHIP 10 SOUTH, RANGE 6 WEST, WILLAMETTE MERIDIAN; SECTION 35 CORNER             
 DONATION LAND CLAIM            CORNER             
 CONDITION REPORT           ; REFERENCED OUT           ; RENEWED XX; SURVEYED IN           

**LOCATION AND COMMENTS:**

FROM THE ORANGE GATE (ROSEBORO LUMBER) AT THE EAST END OF PRICE CREEK ROAD GO 2.75 MILES TO FORK, GO RIGHT FOR 0.73 MILES TO FORK, STAY LEFT ON MAIN ROAD FOR ANOTHER 0.38 MILES TO FORK, GO RIGHT FOR 0.55 MILES TO LOCATION TAG. THE CORNER IS LOCATED ON TOP OF KNOLL APPROXIMATELY 100 FT. SOUTHWESTERLY OF GRAVEL ROAD.

**MONUMENTS AND ACCESSORIES FOUND (CONDITION AND SOURCE):**

- FOUND: 3/4" X 25" INSIDE DIAMETER IRON PIPE (3/4" IRON PIPE AS PER RECORDS [02], [03], AND [04]).
- FOUND: 19" MAPLE STUMP WITH ILLEGIBLE SCRIBING VISIBLE BEARS N 19° W, 17.4 FT. (ROTTED CENTER IS AT 16.9 FT.) (11" MAPLE N 19° W, 16.9 FT. AS PER RECORDS [02], [03], AND [05]). SET 6" SPIKE WITH BRASS WASHER STAMPED "BENTON COUNTY SURVEYOR" IN TOP OF STUMP.
- FOUND: ROOT HOLE BEARS N 77° E, 27.06 FT. (8" FIR, N 77° E, 27.06 FT. AS PER RECORDS [01], AND [02]).

**MONUMENT SET (PROCEDURES AND DESCRIPTION):**

- SET: 3-1/4" BENTON COUNTY BRASS CAP, STAMPED AS SHOWN, IN TOP CENTER OF 2" INSIDE DIAMETER IRON PIPE. BRASS CAP IS IN THE SAME COORDINATE POSITION AS THE RECOVERED 3/4" IRON PIPE. THE RECOVERED 3/4" IRON PIPE WAS REMOVED AND BURIED HORIZONTALLY ALONGSIDE THE SET BRASS CAP.
- CROSS-REFERENCE: COUNTY SURVEY NO. 9172 IS FILED IN CONJUNCTION WITH THIS RESTORATION.

**NEW ACCESSORIES:**

- SET: 5/8" X 30" IRON ROD WITH YELLOW PLASTIC CAP STAMPED "SPRINGER LS1102", 6" BELOW GROUND SURFACE, IN ROOT HOLE, BEARS N 77° E, 27.06 FT.
- SET: 5/8" X 30" IRON ROD WITH YELLOW PLASTIC CAP STAMPED "SPRINGER LS1102", 6" BELOW GROUND SURFACE, BEARS S 25°51' E, 10.01 FT.
- SET: 6" SPIKE WITH BRASS WASHER STAMPED "BENTON COUNTY SURVEYOR" IN TOP OF 20" DIAMETER D. FIR STUMP, BEARS S 61°07' W, 17.82 FT.
- SET: ORANGE FIBERGLASS "SURVEY MARKER" POST 1 FT. WEST.
- SET: LOCATION TAG ON 30" MAPLE STUMP ON SOUTH SIDE OF GRAVEL ROAD, BEARS S 86° W, 157 FT.

**MONUMENT DETAIL**

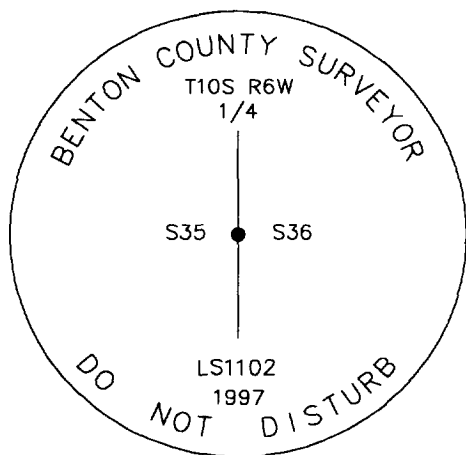

**3 1/4" BRASS CAP**

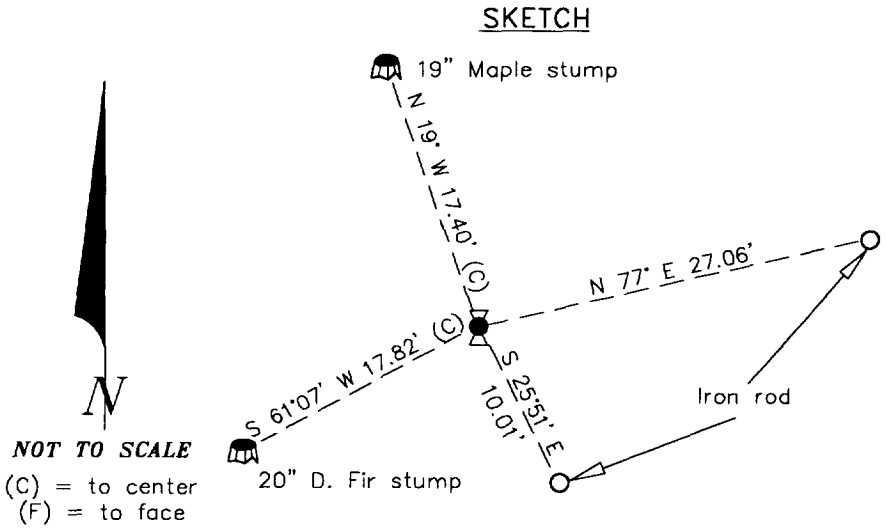

NOT TO SCALE  
 (C) = to center  
 (F) = to face

**NOTES:**

BASIS OF BEARING IS COUNTY SURVEY NO. 9172. MEASURED BEARINGS ARE TO THE CENTER OF THE OBJECT. MEASURED DISTANCES ARE AS NOTED. ALL BEARING TREES ARE PAINTED AND HAVE A B.T. TAG ATTACHED, FACING THE CORNER UNLESS OTHERWISE NOTED.  
 THIS DOCUMENT WAS NAMED AND CREATED IN A MANNER SIMILAR TO THE HISTORY FORM. THE NAME OF THE BOILER PLATE IS "MONUMENT". THE BORDER, STAMP AND SKETCH ARE FROM AUTOCAD RELEASE 13.

THIS RESTORATION WAS DONE BY A PRIVATE SURVEYOR UNDER CONTRACT WITH BENTON COUNTY.

**FIRM/AGENCY:** SPRINGER SURVEYING  
**ADDRESS:** 37056 MOSS ROCK DRIVE, CORVALLIS OREGON 97330  
**SURVEYOR:** NORMAN D. SPRINGER PH. 745-5798  
**SURVEY CREW:** JEFF WHEELER  
**WITNESS(ES):**

REGISTERED  
 PROFESSIONAL  
 LAND SURVEYOR

*Norman D. Springer*

OREGON  
 JULY 22 1977  
 NORMAN D. SPRINGER  
 1102  
 Expires 6/30/98

DATE 07-30-97TOWNSHIP 10 SOUTH, RANGE 6 WEST, WILLAMETTE MERIDIAN; SECTION 35 CORNER E 1/4  
DONATION LAND CLAIM \_\_\_\_\_ CORNER \_\_\_\_\_**COMMON CORNER(S):**

WEST 1/4 CORNER OF SECTION 36.

**UPDATES AND REVISIONS:****CORNER RECORDS (PREVIOUS RENEWALS, SURVEYS, ETC.)**

- [01] ORIGINAL GLO SURVEY BY DANIEL MURPHY, DATED SEPTEMBER 22, 1854. *SET POST WITH TWO BEARING TREES MEASURED TO THE FACE.*
- [02] COUNTY SURVEY NO. 1285 BY W.C. GALLOWAY, DATED JUNE 19, 1936. *FOUND EVIDENCE OF BEARING TREES, SET 3/4" PIPE WITH TWO NEW BEARING TREES (FIELD BOOK NO. 44, PAGE 23).*
- [03] OLD CORNER RESTORATION BOOK NO. 1, PAGE 211 BY W.C. GALLOWAY DATED SEPTEMBER 1936. *FOUND ONE BEARING TREE, SET 3/4" PIPE WITH TWO NEW BEARING TREES (TRANSCRIPTION ERROR).*
- [04] CORNER RESTORATION NO. 395. *TRANSCRIBED COPY OF RECORD [03] AND MAY CONTAIN ERRORS AND OMISSIONS.*
- [05] MAP NO. 10-6-00012 BY BENTON COUNTY (NO DATE GIVEN). *3/4" PIPE WITH THREE BEARING TREES, ONE STANDING.*

**COMMENTS/LOCATION/ETC:****HORIZONTAL AND VERTICAL INFORMATION:****HORIZONTAL DATUM:**

LATITUDE:

LONGITUDE:

**VERTICAL DATUM:**

ELLIPSOID ELEVATION:

ORTHOMETRIC ELEVATION:

GEOID SEPERATION:

**STATE PLANE COORDINATE SYSTEM:**

N (Y):

E (X):

SCALE FACTOR:

COMBINED FACTOR:

CONVERGENCE:

**NOTES:**

THIS IS A MICROSOFT WORD (VERSION 6.0) DOCUMENT NAMED "06600140" CREATED FROM A BOILER PLATE DOCUMENT NAMED "HISTORY", WHICH HAS A STYLESHEET NAMED "CORNER" ATTACHED TO IT.  
INFORMATION IN ***BOLD ITALICS*** IS COUNTY STAFFS' INTERPRETATION OF THE RECORD.

**FIRM/AGENCY:** BENTON COUNTY SURVEYOR'S OFFICE**ADDRESS:** 360 S.W. AVERY AVE. CORVALLIS OR 97333; PH. 757-6821**RESEARCH BY:** CURTIS J. LIESENFELT**DATA ENTRY BY:** ROSE LINDGREN