

106600240

CORNER FILE TRACKING

S:\Survey Corners\CORNERS\Templates\Filetrac2.doc
10/04/2010

| |
|----------------------|
| CORNER NUMBER |
| 106600240 |

| STEP | HISTORY | RESTORATION |
|-----------------------------|----------|-------------|
| Form Prepared, DB | 12/17/13 | 8/7/17 |
| Field Inspection, DB | 5/09/17 | 5/09/17 |
| Finish index (count unit) | 12/17/13 | 5/09/17 |
| Counter Index | 5/15/17 | 5/15/17 |
| GIS Index Form | 5/15/17 | 5/15/17 |
| Checked, DB | 8/8/17 | 8/8/17 |
| Form Edited, DB | 8/8/17 | 8/8/17 |
| Form Signed, DB | 8/8/17 | 8/8/17 |
| Authorize Payment, DB | — | — |
| Archive Digital Files | 8/8/17 | 8/8/17 |
| Collect Documents | 8/8/17 | 8/8/17 |
| PDF File | 8/8/17 | 8/8/17 |
| Copy For Filming | 8/8/17 | 8/8/17 |
| Scanned (pdf to laserfiche) | 8/8/17 | 8/8/17 |
| Filmed (Archived), DB | | |
| Filed, DB | | |

(DB) = Entry needed in database (Access).

COMMENTS:

DATE 12/17/2013

TOWNSHIP 10 SOUTH, RANGE 6 WEST, WILLAMETTE MERIDIAN; SECTION 25 CORNER WEST 1/4
DONATION LAND CLAIM N/A CORNER N/A

COMMON CORNER(S):

EAST 1/4 CORNER SECTION 26

RECORDS (INFORMATION IN BOLD ITALICS IS COUNTY STAFFS' INTERPRETATION OF THE RECORD)

BASED ON EXTENSIVE RESEARCH AND RECOVERY OF EVIDENCE, THIS OFFICE HAS DETERMINED THAT MOST GENERAL LAND OFFICE SURVEYORS IN BENTON COUNTY MEASURED TO THE FACE OF BEARING TREES.

- [01] GENERAL LAND OFFICE (GLO) NOTES BY DANIEL MURPHY, D.S., DATED DECEMBER 1, 1853. SET POST FROM WHICH A FIR 5" DIA BEARS S68°E, 29 LINKS (19.14 FEET); A FIR 7" DIA BEARS S27°W, 36 LINKS (23.76 FEET).
- [02] BENTON COUNTY SURVEY NO. 1039 (OLD NO. 354) FIELD NOTES (FIELD BOOK 36, PAGE 58) BY W. C. GALLOWAY, C.S., DATED 1927. SET 1-1/2" PIPE AND ROCK PILE. W. FIR 5" DIA (GLO BT) BEARS N68°E, 0.39 CHAINS (25.74 FEET) STUMP STANDING; W. FIR 7" DIA (GLO BT) BEARS S47°W, 0.36 CHAINS (23.76 FEET) DEAD; W. FIR 15" DIA BEARS S15-1/2°E, 0.220 CHAINS (14.52 FEET); W. FIR 38" DIA BEARS N1°40'W, 0.260 CHAINS (17.16 FEET); STUMP 60" DIA BEARS S48°45'W, 0.990 CHAINS (65.34 FEET) TO CENTER.
- [03] BENTON COUNTY CORNER RESTORATION BOOK NO. 1, PAGE 186, BY W. C. GALLOWAY, C.S., DATED FEBRUARY 24, 1927. SET 1-1/2" PIPE, PILE OF ROCK. W. FIR 5" DIA (GLO BT) BEARS N68°E, 0.39 CHAINS (25.74 FEET) STUMP STANDING; W. FIR 7" DIA (GLO BT) BEARS S47°W, 0.36 CHAINS (23.76 FEET) DEAD STANDING; W. FIR 15" DIA (CSBT) BEARS S15-1/2°E, 0.220 CHAINS (14.52 FEET); W. FIR 38" DIA (CSBT) BEARS N1°40'W, 0.260 CHAINS (17.16 FEET); RED FIR STUMP 60" DIA (CSBT) BEARS S48°45'W, 0.990 CHAINS (65.34 FEET) TO CENTER OF TOP OF STUMP.
- [04] BENTON COUNTY CORNER RESTORATION NO. 371. TRANSCRIBED FROM RECORD [03] AND MAY CONTAIN ERRORS AND/OR OMISSIONS.
- [05] BENTON COUNTY MAP NO. 10-6-00012, NO DATE OR DRAFTSMAN GIVEN. 1-1/2" PIPE AND STONES. W. FIR 5" DIA (GLO BT) BEARS N68-1/2°E, 0.39 CHAINS (25.74 FEET) STUMP STANDING; W. FIR 7" DIA (GLO BT) BEARS S47-1/2°W, 0.36 CHAINS (23.76 FEET) STANDING DEAD; W. FIR 15" DIA (CSBT) BEARS S16°E, 0.220 CHAINS (14.52 FEET); W. FIR 38" DIA (CSBT) BEARS N1°W, 0.260 CHAINS (17.16 FEET); STUMP 60" DIA (CSBT) BEARS S49°15'W, 0.990 CHAINS (65.34 FEET) TO CENTER.

FIRM/AGENCY: BENTON COUNTY SURVEYOR'S OFFICE
ADDRESS: 360 S.W. AVERY AVE., CORVALLIS, OR 97333; PH. 766-6821
RESEARCH BY: DAVID L. MALONE, P.L.S.
DATA ENTRY BY: SAME

**BENTON COUNTY CORNER RESTORATION FORM, PAGE 1 OF 2, 106600240R2
SEE CORNER HISTORY FORM FOR RECORDS ETC.**

CORNER RESTORATION FIELD BOOK NUMBER 31 PAGE(S) 35 DATE 05/09/2017
TOWNSHIP 10 SOUTH, RANGE 6 WEST, WILLAMETTE MERIDIAN; SECTION 25 CORNER WEST 1/4
DONATION LAND CLAIM N/A CORNER N/A
CONDITION REPORT ; REFERENCED OUT ; RENEWED X; SURVEYED IN

LOCATION AND COMMENTS:

CORNER IS LOCATED ON A STEEP NORTHWEST FACING SLOPE IN AN AREA OF ±25 YEAR OLD D. FIR. TO REACH CORNER FROM THE INTERSECTION OF PRICE CREEK ROAD AND PIT ROAD, FOLLOW PRICE CREEK ROAD SOUTHEASTERLY FOR 0.16 MILES TO A GATE, TRAVEL THROUGH GATE AND CONTINUE FOR 1.52 MILES TO A TEE, TURN LEFT AND FOLLOW ROAD FOR 0.36 MILES AND PARK. WALK NORTH ABOUT 310 FEET TO CORNER. CORNER IS BAD FOR PREMARKING AND GPS CONTROL.

MONUMENTS AND ACCESSORIES FOUND (CONDITION AND SOURCE):

1. FOUND 1-1/2" INNER DIAMETER X 28" LONG IRON PIPE WITH FLARED TOP, FIRMLY SET AND UNDISTURBED, UP 7" ABOVE GROUND SURFACE FOR THE CORNER, WITH SCATTERED STONES AROUND IT.
(SET POST PER RECORD [01]).
(SET 1-1/2" PIPE AND ROCK PILE PER RECORDS [02] AND [03]).
(1-1/2" PIPE AND STONES PER RECORD [05]).
2. FOUND ROTTEN D. FIR STUMP 60" DIA WITH NO VISIBLE MARKS BEARS S48°45'W, 64.48 FEET TO CENTER. **BASIS OF BEARINGS FOR THIS RESTORATION.**
(STUMP 60" DIA BEARS S48°45'W, 0.990 CHAINS [65.34 FEET] TO CENTER PER RECORD [02]).
(RED FIR STUMP 60" DIA BEARS S48°45'W, 0.990 CHAINS [65.34 FEET] TO CENTER OF TOP OF STUMP PER RECORD [03]).
(STUMP 60" DIA BEARS S49°15'W, 0.990 CHAINS [65.34 FEET] TO CENTER PER RECORD [05]).

MONUMENT SET (PROCEDURES AND DESCRIPTION):

FOUND 1-1/2" INNER DIAMETER X 28" LONG IRON PIPE WITH FLARED TOP, FIRMLY SET AND UNDISTURBED, UP 7" ABOVE GROUND SURFACE FOR THE CORNER, WITH SCATTERED STONES AROUND IT. THE IRON PIPE WAS SET BY W. C. GALLOWAY, C.S., IN 1927. FROM A GENERAL LAND OFFICE (GLO) STUMP AND A DEAD GLO BEARING TREE. FOUND ROTTEN REMAINS OF A STUMP RING AT RECORD BEARING AND DISTANCE TO THE NORTHEAST GLO BEARING TREE USING A COMPASS AND TAPE. FOUND BURNT WOOD REMAINS IN A STUMP HOLE AT RECORD BEARING AND DISTANCE TO THE NORTHWEST COUNTY SURVEYOR'S BEARING TREE USING A COMPASS AND TAPE. THE IRON PIPE IS ACCEPTED AS A PERPETUATION OF THE ORIGINAL CORNER POSITION.

REMOVED IRON PIPE FROM THE AREA AND IN THE SAME HORIZONTAL POSITION SET A 2" X 31-1/2" GALVANIZED IRON PIPE WITH A 3-1/4" BRASS DISK CEMENTED IN THE TOP, 4" ABOVE GROUND SURFACE, AND MARKED AS SHOWN ON PAGE 2 OF 2. SET TWO NEW IRON ROD ACCESSORIES AND BLAZED AND SCRIBED TWO NEW BEARING TREES AS SHOWN ON PAGE 2 OF 2. PLACED STONES AROUND PIPE AND BRASS DISK. SET 6 FOOT ORANGE CARSONITE "SURVEY MARKER" POST 1 FOOT SOUTH OF BRASS DISK.

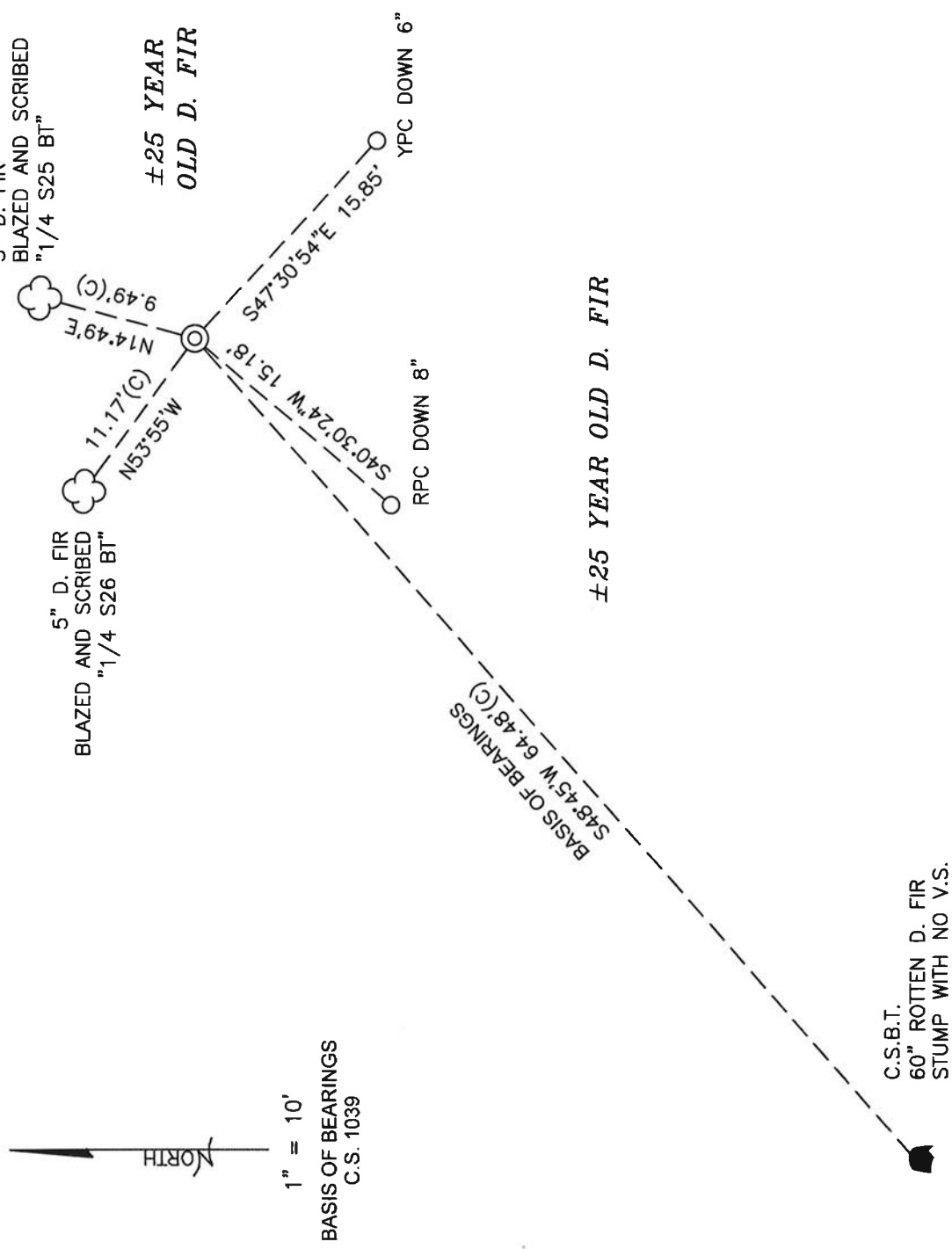

MONUMENT DETAIL

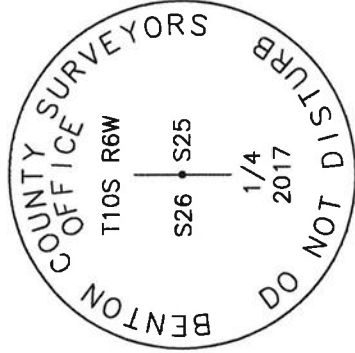

3-1/4" BRASS DISK

C.S.B.T.
60" ROTTEN D. FIR
STUMP WITH NO V.S.

LEGEND

- SET 5/8" X 30" REBAR WITH PLASTIC CAP
- YPC YELLOW PLASTIC CAP MARKED "BENTON COUNTY SURVEYOR"
- RPC RED PLASTIC CAP MARKED "BENTON COUNTY SURVEYOR"
- (C) MEASUREMENT TO CENTER
- ⊙ GOVERNMENT MONUMENT SET AS SHOWN
- V.S. VISIBLE SCRIBING
- C.S. COUNTY SURVEY
- C.S.B.T. COUNTY SURVEYOR'S BEARING TREE
- ☙ BEARING TREE STUMP AS NOTED
- ☘ BEARING TREE AS NOTED

NEW ACCESSORIES:

1. SET REBAR (SEE LEGEND) S47°30'54"E, 15.85 FEET AND 6 INCHES BELOW GROUND LEVEL.
2. SET REBAR (SEE LEGEND) S40°30'24"W, 15.18 FEET AND 8 INCHES BELOW GROUND LEVEL.
3. D. FIR 5" DIA BEARS N14°49'E, 9.49 FEET TO CENTER, FACE SCRIBED "1/4 S25 BT". SET ALUMINUM NAIL AND PLASTIC WASHER ON SOUTHEASTERLY BASE FOR DISTANCE MEASUREMENT.
4. D. FIR 5" DIA BEARS N53°55'W, 11.17 FEET TO CENTER, FACE SCRIBED "1/4 S26 BT". SET ALUMINUM NAIL AND PLASTIC WASHER ON SOUTHWESTERLY BASE FOR DISTANCE MEASUREMENT.

NOTES:

COMPASS DECLINATION IS 16' EAST. ALL MEASURED DISTANCES AND BEARINGS ARE TO THE CENTER OF THE OBJECT, UNLESS OTHERWISE NOTED. ALL BEARING TREES ARE PAINTED AND HAVE A B.T. TAG ATTACHED, FACING THE CORNER UNLESS OTHERWISE NOTED. ALL NEW BEARING TREES HAVE A PLASTIC WASHER (STAMPED "SURVEY MARKER DO NOT REMOVE") ATTACHED BY AN ALUMINUM NAIL TO THE SIDE CENTER OF THE TREE FOR DISTANCE MEASUREMENT, UNLESS OTHERWISE NOTED.

THIS RESTORATION WAS PERFORMED AT THE DIRECTION AND APPROVAL OF
THE BENTON COUNTY SURVEYOR *Jean*

REGISTERED
PROFESSIONAL
LAND SURVEYOR

8/08/17 *David L. Malone*

OREGON
JANUARY 12, 1999
DAVID L. MALONE
51523

FIRM/AGENCY: BENTON COUNTY SURVEYOR'S OFFICE
ADDRESS: 360 S.W. AVERY AVE., CORVALLIS, OR 97333; PH. 541-766-6821
PRESENT: DAVID L. MALONE, P.L.S. AND BERNARD ALTENBACH, SURVEY TECH.
EQUIPMENT: NIKON NIVO3.C WITH SURVEY PRO ONBOARD.

RENEWAL DATE: 12/31/18

C. S. 354

Witness I. D. Merchant

1927

CORNER RESTORATION BOOK NO. 1

1/4 sec. cor. bet. Secs. 24 & 25 T. 10 - 6
 Set 1" x 70" pipe 4" in ground set from 4" fir. bezel gone
 Fir 40" in dia. bears S. 71° E. .338 cks.
 " 4" " " S. 50° W. .59 cks. std.

Corner to secs. 23, 24, 25 & 26 T. 10 - 6

Set 1 1/2" pipe 65" long 7' in ground Orig. cor.
 Fir 20" in dia. bears N. 30° 40' E. .126 face std.
 " 8" " " S. 30° 40' W. .657 "
 " 14" " " S. 12° 50' E. .615 center
 " 6" " " N. 33° 30' W. .060 "

Witness Roy Swanson Feb. 23, 1927.

1/4 sec. cor. bet. secs. 25 & 26 T. 10 - 6

Set 1 1/2" pipe, pile of rock
 W. fir 5" in dia. bears N. 68° E. .39 cks. stump std.
 " 7" " " S. 47° W. .92 " dead "
 " 15" " " S. 15 1/2° E. .220 "
 " 38" " " N. 140° W. .260 "

Red " 60" "stump" S. 48° 45' W. .990 " cen. of hp of stump

Witness Roy Swanson Feb. 24, 1927.

C. S. #121

Witness J. D.
Merchant

Nov. 1927

N. W. corner of Solemm K. Brown D.L. C #54 T. 12 S. R. 5 W.

Set a 2 1/2 x 54" iron rod S. of gate post

Oak 15" in dia. bears N. 23° E. 1.20 cks. std. ^{Set. fir gone}

Black walnut 4" " S. 8° W. .313 "

" 3" " N. 58° W. .254 "

Cor. to Bales claim S. 89° 20' W. 3.11 "

SW corner of Chas. Bales D.L.C. #53 T. 12 S. R. 5 W.

Set 2 1/2" bolt in a 1 1/2" pipe in a 1 1/2" pipe

Oak stump 12" in dia. bears N. 2° 30' W. 6.07 cks.

Walnut 9" " " N. 16° 20' E. 6.67 "

" 4 " " N. 53° 55' E. 6.42 "

" 4 " " S. 68° 08' E. 8.28 "

" 4 " " S. 22° 03' W. 3.54 "

E. corner of wing of abutment of concrete bridge N. 7° 32' W. 5.923 cks.

N. E. cor. of Elijah Liggett D.L.C. #52 T. 12 S. R. 5 W.

Stone in place

Corner fence post bears N. 52° 25' E. .588

" " " S. 44° W. .657

" " " N. 32° 55' W. .544

Oak 17" in dia. " N. 67° 50' W. 1.164

1/4-Section corner between sections 25 and 26, Twp. 10-6

371

Reestablishment by W. C. Galloway

Set 1 1/2" pipe, pile of rock.

W. Fir 5" in diam bears N 68° E
W. Fir 7" in diam bears S 47° W
W. Fir 15" in diam bears S 15 1/2° E
Fir 38" in diam bears N 1° 40' W
Fir 60" in diam bears S 48° 45' W

Witnessed by I. D. Merchant

February 24, 1927

.39 chains (stump)
.36 chains
.220 chains
.26 chains
.990 chains