

106600300

CORNER FILE TRACKING

S:\Survey Corners\CORNERS\Templates\Filetrac2.doc
10/04/2010

CORNER NUMBER
106600300

STEP	HISTORY	RESTORATION
Form Prepared, DB	12/23/13	8/07/17
Field Inspection, DB	5/09/17	5/09/17
Finish index (count unit)	12/23/13	5/09/17
Counter Index	5/15/17	5/15/17
GIS Index Form	5/15/17	5/15/17
Checked, DB	8/10/17	8/10/17
Form Edited, DB	8/10/17	8/10/17
Form Signed, DB	8/10/17	8/10/17
Authorize Payment, DB	—	—
Archive Digital Files	8/10/17	8/10/17
Collect Documents	8/10/17	8/10/17
PDF File	8/10/17	8/10/17
Copy For Filming	8/10/17	8/10/17
Scanned (pdf to laserfiche)	8/10/17	8/10/17
Filmed (Archived), DB		
Filed, DB		

(DB) = Entry needed in database (Access).

COMMENTS:

DATE 12/23/2013

TOWNSHIP 10 SOUTH, RANGE 6 WEST, WILLAMETTE MERIDIAN; SECTION 23 CORNER SOUTHEAST
DONATION LAND CLAIM N/A CORNER N/A

COMMON CORNER(S):

SOUTHWEST CORNER SECTION 24
NORTHWEST CORNER SECTION 25
NORTHEAST CORNER SECTION 26

RECORDS (INFORMATION IN BOLD ITALICS IS COUNTY STAFFS' INTERPRETATION OF THE RECORD)

BASED ON EXTENSIVE RESEARCH AND RECOVERY OF EVIDENCE, THIS OFFICE HAS DETERMINED THAT MOST GENERAL LAND OFFICE SURVEYORS IN BENTON COUNTY MEASURED TO THE FACE OF BEARING TREES.

[01] GENERAL LAND OFFICE (GLO) NOTES BY DANIEL MURPHY, D.S., DATED DECEMBER 1, 1853. SET POST FROM WHICH A FIR 20" DIA BEARS ***N28°E, 13 LINKS (8.58 FEET)***; A FIR 8" DIA BEARS ***S31°W, 66 LINKS (43.56 FEET)***; A WILLOW 4" DIA BEARS ***N47-1/2°W, 60 LINKS (39.60 FEET)***; A WILLOW 3" DIA BEARS ***S12°E, 75 LINKS (49.50 FEET)***.

[02] BENTON COUNTY SURVEY NO. 1039 (OLD NO. 354) FIELD NOTES (FIELD BOOK 36, PAGE 58) BY W. C. GALLOWAY, C.S., DATED 1927. ORIGINAL CORNER. SET 1-1/2" PIPE 65" LONG. FIR 20" DIA (GLO BT) BEARS ***N30°40'E, 0.126 CHAINS (8.32 FEET)*** TO FACE STANDING; FIR 8" DIA (GLO BT) BEARS ***S30°40'W, 0.657 CHAINS (43.36 FEET)*** TO FACE STANDING; W. FIR 14" DIA BEARS ***S12°50'E, 0.615 CHAINS (40.59 FEET)*** TO CENTER; W. FIR 6" DIA BEARS ***N33°30'W, 0.060 CHAINS (3.96 FEET)*** TO CENTER. BEARINGS ACCORDING TO LINE.

[03] BENTON COUNTY CORNER RESTORATION BOOK NO. 1, PAGE 186, BY W. C. GALLOWAY, C.S., DATED FEBRUARY 23, 1927. SET 1-1/2" PIPE 65" LONG 4 FEET IN GROUND. ORIGINAL CORNER. FIR 20" DIA (GLO BT) BEARS ***N30°40'E, 0.126 CHAINS (8.32 FEET)*** TO FACE STANDING; FIR 8" DIA (GLO BT) BEARS ***S30°40'W, 0.657 CHAINS (43.36 FEET)*** TO FACE STANDING; W. FIR 14" DIA (CSBT) BEARS ***S12°50'E, 0.615 CHAINS (40.59 FEET)*** TO CENTER; W. FIR 6" DIA (CSBT) BEARS ***N33°30'W, 0.060 CHAINS (3.96 FEET)*** TO CENTER.

[04] BENTON COUNTY CORNER RESTORATION NO. 367. TRANSCRIBED FROM RECORD [03] AND MAY CONTAIN ERRORS AND/OR OMISSIONS.

[05] BENTON COUNTY MAP NO. 10-6-00012, NO DATE OR DRAFTSMAN GIVEN. ORIGINAL CORNER. 1-1/2" PIPE 65" LONG. FIR 20" DIA (GLO BT) BEARS ***N31°E, 0.126 CHAINS (8.32 FEET)*** ORIGINAL STANDING; FIR 8" DIA (GLO BT) BEARS ***S31°W, 0.657 CHAINS (43.36 FEET)*** ORIGINAL STANDING; W. FIR 14" DIA (CSBT) BEARS ***S12°20'E, 0.615 CHAINS (40.59 FEET)***; W. FIR 6" DIA (CSBT) BEARS ***N33°W, 0.060 CHAINS (3.96 FEET)***.

FIRM/AGENCY: BENTON COUNTY SURVEYOR'S OFFICE
ADDRESS: 360 S.W. AVERY AVE., CORVALLIS, OR 97333; PH. 766-6821
RESEARCH BY: DAVID L. MALONE, P.L.S.
DATA ENTRY BY: SAME

**BENTON COUNTY CORNER RESTORATION FORM, PAGE 1 OF 2, 106600300R2
SEE CORNER HISTORY FORM FOR RECORDS ETC.**

CORNER RESTORATION FIELD BOOK NUMBER 31 PAGE(S) 34 DATE 05/09/2017
TOWNSHIP 10 SOUTH, RANGE 6 WEST, WILLAMETTE MERIDIAN; SECTION 23 CORNER SOUTHEAST
DONATION LAND CLAIM N/A CORNER N/A
CONDITION REPORT _____ REFERENCED OUT _____ RENEWED X; SURVEYED IN _____

LOCATION AND COMMENTS:

CORNER IS LOCATED ON A MODERATE NORTH FACING SLOPE IN AN AREA OF ±25 YEAR OLD D. FIR AND SCATTERED HARDWOODS. TO REACH CORNER FROM THE INTERSECTION OF PRICE CREEK ROAD AND PIT ROAD, FOLLOW PRICE CREEK ROAD SOUTHEASTERLY FOR 0.16 MILES TO A GATE, TRAVEL THROUGH GATE AND CONTINUE FOR 1.52 MILES TO A TEE, TURN LEFT AND FOLLOW ROAD FOR 0.79 MILES TO A 4 WAY INTERSECTION, TURN LEFT FOR 0.06 MILES TO A WYE, STAY LEFT FOR 0.23 MILES TO A 4 WAY INTERSECTION AND PARK. WALK NORTH ALONG OVERGROWN ROAD ABOUT 550 FEET TO WHERE ROAD CURVES WEST. CORNER IS ABOUT 40 FEET NORTH OF ROAD. CORNER IS BAD FOR REMARKING AND GPS CONTROL.

MONUMENTS AND ACCESSORIES FOUND (CONDITION AND SOURCE):

1. FOUND 1-1/2" INNER DIAMETER IRON PIPE, TOP VERY CORRODED, FIRMLY SET AND UNDISTURBED, UP 1" ABOVE GROUND SURFACE FOR THE CORNER.
(SET POST PER RECORD [01]).
(ORIGINAL CORNER: SET 1-1/2" PIPE 65" LONG PER RECORD [02]).
(ORIGINAL CORNER: SET 1-1/2" PIPE 65" LONG 4 FEET IN GROUND PER RECORD [03]).
(ORIGINAL CORNER: 1-1/2" PIPE 65" LONG PER RECORD [05]).
2. FOUND ROTTEN D. FIR STUMP 48" DIA WITH HEALED FACE BEARS N28°00'E, 9.88 FEET TO CENTER. BASIS OF BEARINGS FOR THIS RESTORATION.
(FIR 20" DIA BEARS N28°E, 13 LINKS [8.58 FEET] PER RECORD [01]).
(FIR 20" DIA BEARS N30°40'E, 0.126 CHAINS [8.32 FEET] TO FACE STANDING PER RECORDS [02] AND [03]).
(FIR 20" DIA BEARS N31°E, 0.126 CHAINS [8.32 FEET] ORIGINAL STANDING PER RECORD [05]).
3. FOUND ROTTEN WHITE FIR STUMP 12" DIA BEARS N38°26'W, 3.23 FEET TO CENTER. OPENED BUT FOUND NO VISIBLE SCRIBING OR MARKS.
(W. FIR 6" DIA BEARS N33°30'W, 0.060 CHAINS [3.96 FEET] TO CENTER PER RECORDS [02] AND [03]).
(W. FIR 6" DIA BEARS N33°W, 0.060 CHAINS [3.96 FEET] PER RECORD [05]).

MONUMENT SET (PROCEDURES AND DESCRIPTION):

FOUND 1-1/2" INNER DIAMETER IRON PIPE, TOP VERY CORRODED, FIRMLY SET AND UNDISTURBED, UP 1" ABOVE GROUND SURFACE FOR THE CORNER. THE IRON PIPE WAS SET BY W. C. GALLOWAY, C.S., IN 1927 FROM TWO GENERAL LAND OFFICE (GLO) BEARING TREES. THERE ARE REMAINS OF A DOWN FENCE RUNNING EAST FROM THE IRON PIPE AND RUNNING TO THE NORTHWEST BEARING TREE STUMP AND THEN NORTH FROM THE STUMP. THE IRON PIPE IS ACCEPTED AS A PERPETUATION OF THE ORIGINAL CORNER POSITION.

OVER THE 1-1/2" IRON PIPE IN THE SAME HORIZONTAL POSITION SET A 2" X 31-1/2" GALVANIZED IRON PIPE WITH A 3-1/4" BRASS DISK CEMENTED IN THE TOP, UP 1" ABOVE GROUND SURFACE, AND MARKED AS SHOWN ON PAGE 2 OF 2. SET TWO NEW IRON ROD ACCESSORIES AND BLAZED AND SCRIBED TWO NEW BEARING TREES AS SHOWN ON PAGE 2 OF 2. SET 6 FOOT ORANGE CARSONITE "SURVEY MARKER" POST 1 FOOT WEST OF NEW MONUMENT.

9" D. FIR
BLAZED AND SCRIBED
"T10SR6WS23BT"

±25 YEAR OLD D. FIR

10" D. FIR
BLAZED AND SCRIBED
"T10SR6WS24BT"

GLO B.T.
48" ROTTEN D. FIR
STUMP WITH
HEALED FACE

N28.00'E 9.88'(C)
BASIS OF BEARINGS

N48.03'E 19.59'(C)

N45.12'W 15.53'(C)

C.S.B.T.
12" ROTTEN W. FIR
STUMP
OPENED TO NO V.S.
N38°26'W 3.23'(C)

S42.47'00"W 19.38'

S59.32'03"E 24.12'

±25 YEAR OLD D. FIR
AND SCATTERED HARDWOODS

RPC DOWN 5"

YPC DOWN 6"

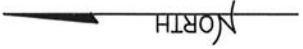

1" = 5'
BASIS OF BEARINGS
1853 GLO

MONUMENT DETAIL

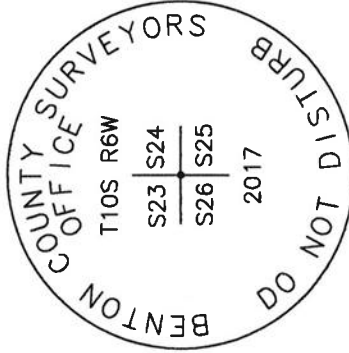

3-1/4" BRASS DISK

LEGEND

- SET 5/8" X 30" REBAR WITH PLASTIC CAP
- YPC YELLOW PLASTIC CAP MARKED "BENTON COUNTY SURVEYOR"
- RPC RED PLASTIC CAP MARKED "BENTON COUNTY SURVEYOR"
- (C) MEASUREMENT TO CENTER
- ⊙ GOVERNMENT MONUMENT SET AS SHOWN
- V.S. VISIBLE SCRIBING
- C.S.B.T. COUNTY SURVEYOR'S BEARING TREE
- GLO GENERAL LAND OFFICE
- B.T. BEARING TREE
- BEARING TREE STUMP AS NOTED
- BEARING TREE AS NOTED

NEW ACCESSORIES:

1. SET REBAR (SEE LEGEND) S59°32'03"E, 24.12 FEET AND 6 INCHES BELOW GROUND LEVEL.
2. SET REBAR (SEE LEGEND) S42°47'00"W, 19.38 FEET AND 5 INCHES BELOW GROUND LEVEL.
3. D. FIR 9" DIA BEARS N45°12'W, 15.53 TO CENTER, FACE SCRIBED "T10SR6WS23BT". SET ALUMINUM NAIL AND PLASTIC WASHER ON NORTHEASTERLY BASE FOR DISTANCE MEASUREMENT.
4. D. FIR 10" DIA BEARS N48°03'E, 19.59 TO CENTER, FACE SCRIBED "T10SR6WS24BT". SET ALUMINUM NAIL AND PLASTIC WASHER ON NORTHWESTERLY BASE FOR DISTANCE MEASUREMENT.

NOTES:

COMPASS DECLINATION IS 16' EAST. ALL MEASURED DISTANCES AND BEARINGS ARE TO THE CENTER OF THE OBJECT, UNLESS OTHERWISE NOTED. ALL BEARING TREES ARE PAINTED AND HAVE A B.T. TAG ATTACHED, FACING THE CORNER UNLESS OTHERWISE NOTED. ALL NEW BEARING TREES HAVE A PLASTIC WASHER (STAMPED "SURVEY MARKER DO NOT REMOVE") ATTACHED BY AN ALUMINUM NAIL TO THE SIDE CENTER OF THE TREE FOR DISTANCE MEASUREMENT, UNLESS OTHERWISE NOTED.

THIS RESTORATION WAS PERFORMED AT THE DIRECTION AND APPROVAL OF
THE BENTON COUNTY SURVEYOR *gpa*

REGISTERED
PROFESSIONAL
LAND SURVEYOR

David L. Malone

8/28/17

OREGON
JANUARY 12, 1999
DAVID L. MALONE
51523

FIRM/AGENCY: BENTON COUNTY SURVEYOR'S OFFICE
ADDRESS: 360 S.W. AVERY AVE., CORVALLIS, OR 97333; PH. 541-766-6821
PRESENT: DAVID L. MALONE, P.L.S. AND BERNARD ALTENBACH, SURVEY TECH.
EQUIPMENT: NIKON NIV03.C WITH SURVEY PRO ONBOARD.

RENEWAL DATE: 12/31/18

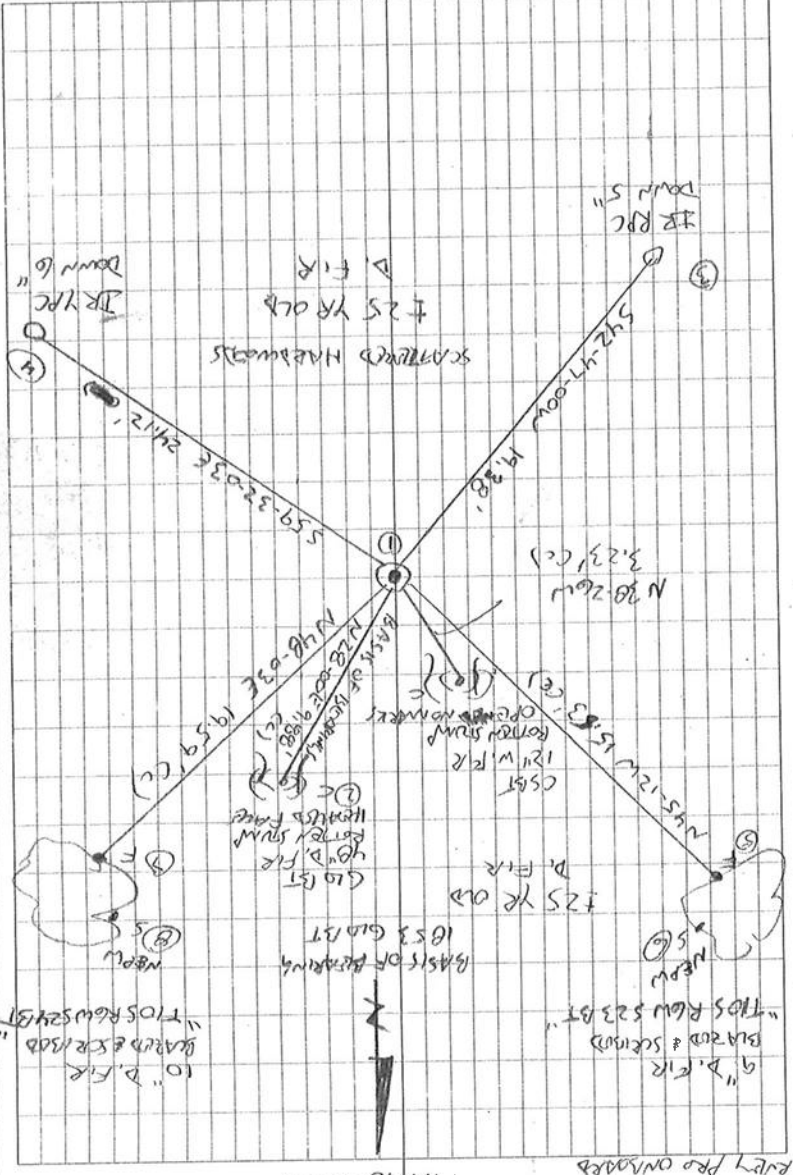

3/31

5/9/2017
D. MADRUE
E. ANTONRACH

Nikon N103C
SURVEY PRO ONSHORE

W/AM, CLEAR

106600300
2324
2625
REMOVEMENT T105 Row

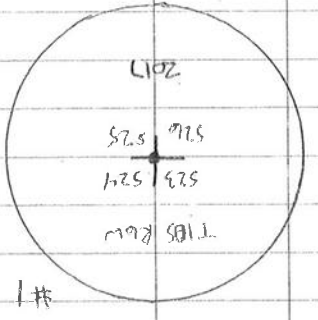

BR = $\frac{5}{8}$ " = 30" BRON ROD
YPC OR RPC = Yellow OR Red
PLASTIC CAP MARKERS
"US Army COUNTRY SURVEYOR"
N & PW = NATL & PLASTIC WASHER
MARKED "SURVEY MARKER"
DO NOT REMOVE"
3-1/4" GRASS DISK

FD 1-1/2" I.D. BRON PIPE TOP CORRECTED, FINELY SET
& UNDISTURBED, UP 1" ABOVE GROUND SURFACE FOR
THE CORNER. FD NE 60 GT AND HD FOR BASIS
OF SURVIVAL. FD NW 60 GT, FATHER DOWN
FENCE RUNS NORTH AND EAST FROM THE CORNER.
NW 60 GT VERY CORNER W/ FENCE ATTACHED TO IT.
CUT FENCE AND OPENED STUMP. INSIDE ROTTEN, OVER
BRON PIPE DRIVE 2" x 3-1/2" G.I. P. W/ 3-1/4"
BRASS DISK (CEMENTED IN TOP UP 1" ABOVE GROUND)
SURFACE, SET 2 FROM ROD ACCESSORIES AND BARED
& SCARDED 2 NEW BURNING TREES, SET TO CRABBLE
& CARSONITE "SURVEY MARKER" POST 1' WEST OF
GRASS DISK.

CORNER RESTORATION BOOK NO. 1

C.S. 354

Witness I. D. Merchant

1927

1/4 sec. cor. bet. secs. 24 & 25 T. 10-6
 Set 1" x 70" pipe 4" in ground set from 4" fir. head gone
 Fir 40" in dia. bears S. 71° E. .338 chs.
 " 4" " S. 50° W. .53 chs. std.

Corner to secs. 23, 24, 25 & 26 T. 10-6

Set 1 1/2" pipe 65" long 4" in ground Orig. cor.
 Fir 20" in dia. bears N. 30° 40' E. .126 face std.
 " 8" " " S. 30° 40' W. .657 " "
 " 14" " " S. 12° 50' E. .615 center
 " 6" " " N. 33° 30' W. .060 "

Witness Roy Swanson Feb. 23, 1927.

1/4 sec. cor. bet. secs. 25 & 26 T. 10-6

Set 1 1/2" pipe, pile of rock
 W. fir 5" in dia. bears N. 68° E. .39 chs. stump std.
 " 7" " " S. 47° W. .36 " dead
 " 15" " " S. 15 1/2° E. .220 "
 " 38" " " N. 140 W. .260 "
 Red " 60" " stump " S. 48° 45' W. .990 " cen. of tip of stump
 Witness Roy Swanson Feb. 24, 1927.

C.S. #121

Witness I. D.
Merchant

Nov. 1927.

N.W. corner of Salem K. Brown D.L. C. #54 T. 12 S. R. 5 W.

Set a 3/4 x 54" iron rod S. of gate post
 Oak 15" in dia. bears N. 23° E. 1.20 chs. std. ^{S.E. tree gone}
 Black walnut 4" " S. 8° W. .313 "
 " 3" " N. 58° W. .254 "
 Cor. to Bales claim S. 89° 20' W. 3.11 "

SW corner of Chas. Bales D.L.C. #53 T. 12 S. R. 5 W.

Set 3/4" bolt in a 1 1/4" pipe in a 1 1/4" pipe
 Oak stump 12" in dia. bears N. 2° 30' W. 6.07 chs.
 Walnut 4" " " N. 16° 20' E. .667 "
 " 4 " " N. 53° 55' E. .642 "
 " 4 " " S. 68° 08' E. .828 "
 " 4 " " S. 22° 03' W. .354 "

E. corner of wing of abutment of concrete bridge N. 7° 32' W. 5.923 chs.

N.E. cor. of Elijah Ligger D.L.C. #52 T. 12 S. R. 5 W.
 Stone in place

Corner fence post bears N. 52° 25' E. .588
 " " S. 44° W. .657
 " " N. 32° 55' W. .544
 Oak 17" in dia. " N. 67° 30' W. 1.164

C.S.
W. J.
RoyC.
Fir
Roy
W. J.C.
M.
C.C.
W.C.
O.
M.
W.
W.
W.

Corner to sections 23, 24, 25 and 26, Twp. 10-6

Reestablishment by W. C. Galloway

February 23, 1927

507

Set $1\frac{1}{2}$ " pipe, 65" long 4' in ground, original corner

Fir 20" in diam bears N 30° 40' E

Fir 8" in diam bears S 30° 40' W

W. Fir 14" in diam bears S 12° 00' E

W. Fir 6" in diam bears N 33° 30' W

Witness Roy Swanson

.126 chains
.657 chains
.615 chains
.060 chains