

107340320

REWITNESSED CORNER FOR STATE OF OREGON--DEPARTMENT OF FORESTRY

Center South one sixteenth corner for Section  
21, T10S, R7W, W.M., Benton County, Oregon.

ORIGINAL

1 1/4" pipe - county survey No. 150 (in place) from which a:

- 26" Fir bears N49°E 38.6 lks.; (1962, rotted 24" stump scribe "B" visible) (now 22" rotted stump - 2 piece face in bark).
- 17" Fir bears S7°20'E 37.3 lks.; (in place, now 24" rotted stump, axe work visible as bottom of face).

REWITNESSED by State of Oregon - Department of Forestry, April 20, 1962, by Elbert Driver P.L.S. 559

- 12" Fir bears N65E 27.9 ft.; scribed CS1/16 S21 BT RS559 (in place, now "16" rotted stump, scribe "5" visible).
- 4"x4"x72" white painted post 1.0' S.E. of pipe (now 4"x4"x18" wpcp in place).

REWITNESSED

VAR. 21°E

- 12" Fir bears S56E 27.4 ft. to face; scribed CS 1/16 S21 BT.
- 16" Fir bears N68W 44.1 ft. to face; scribed C 1/16 S21 RS401 BT.

Set 5' white fiber glass post 0.5 ft. South of corner pipe.  
Oregon State Forestry Department metal location poster on new 16" Fir B.T.  
Corner bears N45°W 19.0' from edge of cat road.

DATED: January 14, 1982

RESTORED BY: William E. Seeley under my direction.  
W. E. Seeley, Compassman



PRESENT AND WITNESSED BY: S. Elefant

BENTON COUNTY SURVEYORS OFFICE - CORNER RESTORATION

541

T. 10 S. R. 7 W. W. B. & M., BENTON COUNTY, OREGON

REPORTED BY Richard A. Morris

SECTION 21

TITLE Land Surveyor

DATE January 14, 1982

FOR ADDITIONAL INFORMATION SEE THE T10S R7W FILE IN THE CORNER RESTORATION CORRESPONDENCE FILE DRAWER (CJL 7/10/90).

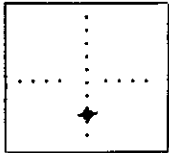

- OFFICIAL CORNER FOUND
- CORNER SET

CS1/16 CORNER COMMON TO SEC. \_\_\_\_\_ & 21  
 IS 1 1/4" pipe, CS#150  
 DESCRIBE

RE-WITNESSED: ADDITIONAL INFORMATION

- 12" Fir S56E 27.4' to face; scribed CS1/16 S21 BT.
- 16" Fir N68 W 44.1' to face; scribed CS1/16 S21 RS401 BT.
- Set 5' white fiberglass post 0.5' south B.T. Tag Posted on 16" Fir BT.
- 26" Fir N49E, now rotted stump
- 17" Fir S7°20'E, now rotted stump
- 12" Fir N65°E, now rotted stump

LEGIBLE MARKS ON BEARING OBJECTS

	AXE WORK	"5"	
KIND	Fir	Fir	Fir
SIZE	26"	17"	12"
BEARING	N49°E	S7°20'E	N65°E
DISTANCE	38.6 Lks.	37.3 Lks.	27.9'
BT TAG POSTED			

OVER

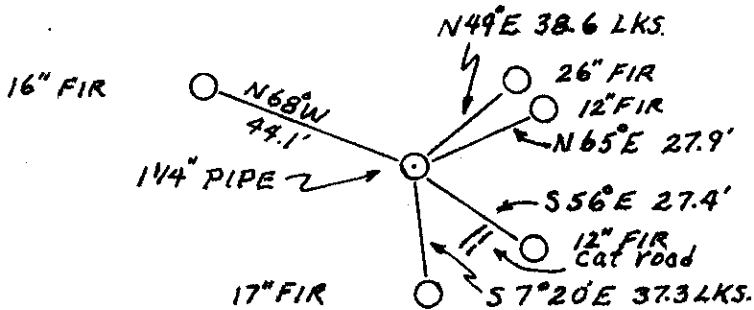

REGISTERED PROFESSIONAL LAND SURVEYOR

*Richard A. Morris*

OREGON  
 MAY 10, 1957  
 RICHARD A. MORRIS  
 401