

**107500100**

## CORNER FILE TRACKING

S:\Survey Corners\CORNERS\Templates\Filetrac2.doc  
10/04/2010

<b>CORNER NUMBER</b>
<b>107500100</b>

STEP	HISTORY	RESTORATION
Form Prepared, DB	9/7/17	6/5/19
Field Inspection, DB	5/30/19	5/30/19
Finish index (count unit)	9/7/17	5/30/19
Counter Index	5/31/19	5/31/19
GIS Index Form	5/31/19	5/31/19
Checked, DB	6/07/19	6/07/19
Form Edited, DB	6/11/19	6/11/19
Form Signed, DB	6/14/19	6/14/19
Authorize Payment, DB	—	—
Archive Digital Files	6/11/19	6/11/19
Collect Documents	6/11/19	6/11/19
PDF File	6/27/19	6/27/19
Copy For Filming	6/27/19	6/27/19
Scanned (pdf to laserfiche)	6/27/19	6/27/19
Filmed (Archived), DB		
Filed, DB		

(DB) = Entry needed in database (Access).

### COMMENTS:

DATE 09/07/2017

TOWNSHIP 10 SOUTH, RANGE 7 WEST, WILLAMETTE MERIDIAN; SECTION 34 CORNER SOUTHEAST  
DONATION LAND CLAIM N/A CORNER N/A

**COMMON CORNER(S):**

SOUTHWEST CORNER SECTION 35, TOWNSHIP 10 SOUTH, RANGE 7 WEST  
POINT ON NORTH LINE SECTION 3, TOWNSHIP 11 SOUTH, RANGE 7 WEST

**RECORDS (INFORMATION IN *BOLD ITALICS* IS COUNTY STAFFS' INTERPRETATION OF THE RECORD)**

BASED ON EXTENSIVE RESEARCH AND RECOVERY OF EVIDENCE, THIS OFFICE HAS DETERMINED THAT MOST GENERAL LAND OFFICE SURVEYORS IN BENTON COUNTY MEASURED TO THE FACE OF BEARING TREES.

[01] GENERAL LAND OFFICE (GLO) NOTES BY DENNIS HATHORN, D.S., DATED AUGUST 26, 1856. *SET POST FROM WHICH A FIR 15" DIA BEARS N10°W, 100 LINKS (66.00 FEET); A FIR 18" DIA BEARS N10°E, 170 LINKS (112.20 FEET).*

[02] SURVEY NO. 38 FROM PAGE 47 OF THE RECORD BOOK OF SURVEYS BY ANDREW L. PORTER, C.S., DATED JULY 19, 1889. *CORNER TO SECTIONS 34 AND 35. CORNER NOT DESCRIBED.*

**FIRM/AGENCY:** BENTON COUNTY SURVEYOR'S OFFICE  
**ADDRESS:** 360 S.W. AVERY AVE., CORVALLIS, OR 97333; PH. 541-766-6821  
**RESEARCH BY:** DAVID L. MALONE, P.L.S.  
**DATA ENTRY BY:** SAME

**BENTON COUNTY CORNER RESTORATION FORM, PAGE 1 OF 2, 107500100R1**

**SEE CORNER HISTORY FORM FOR RECORDS ETC.**

CORNER RESTORATION FIELD BOOK NUMBER 32 PAGE(S) 40 DATE 05/30/2019  
TOWNSHIP 10 SOUTH, RANGE 7 WEST, WILLAMETTE MERIDIAN; SECTION 34 CORNER SOUTHEAST  
DONATION LAND CLAIM N/A CORNER N/A  
CONDITION REPORT    ; REFERENCED OUT    ; RENEWED X; SURVEYED IN    

**LOCATION AND COMMENTS:**

CORNER IS LOCATED ON A SMALL FLAT AREA, POSSIBLY AN OLD LOGGING LANDING, IN AN AREA OF ±15 YEAR OLD D. FIR REPROD. TO REACH CORNER FROM THE INTERSECTION OF NORTON CREEK ROAD AND HIGHWAY 20, TRAVEL NORTH ALONG NORTON CREEK ROAD FOR 2.58 MILES TO A TIMBER ACCESS ROAD ON THE LEFT, TURN LEFT AND FOLLOW FOR 0.09 MILES THROUGH A STARKER FORESTS GATE TO A WYE, TURN RIGHT FOR 0.79 MILES TO A WYE, TURN LEFT FOR 0.22 MILES TO A WYE, STAY RIGHT FOR 0.19 MILES TO A WYE, TURN LEFT FOR 0.14 MILES TO A WYE, TURN LEFT FOR 0.07 MILES AND PARK. WALK SOUTH ABOUT 430 FEET TO THE CORNER. CORNER IS BAD FOR PREMARKING AND GPS CONTROL.

**MONUMENTS AND ACCESSORIES FOUND (CONDITION AND SOURCE):**

1. FOUND ROTTEN REMAINS OF D. FIR 36" DIA STUMP BEARS N10°00'E, 112.20 FEET TO FACE. OPENED TO SCRIBING "BT". **BASIS OF BEARINGS FOR THIS RESTORATION.**  
(FIR 18" DIA BEARS N10°E, 170 LINKS [112.20 FEET] AS PER RECORD [01]).
2. FOUND ROTTEN REMAINS OF D. FIR 36" DIA STUMP BEARS N9°07'W, 66.63 FEET TO CENTER. OPENED TO POSSIBLE REMAINS OF A FACE WITH OVERGROWTH.  
(FIR 15" DIA BEARS N10°W, 100 LINKS [66.00 FEET] AS PER RECORD [01]).

**MONUMENT SET (PROCEDURES AND DESCRIPTION):**

FOUND THE ROTTEN REMAINS OF TWO 1856 GENERAL LAND OFFICE (GLO) BEARING TREE STUMPS. OPENED THE NORTHEAST STUMP TO SCRIBING "BT". OPENED THE NORTHWEST STUMP TO THE REMAINS OF A POSSIBLE FACE WITH OVERGROWTH. WHILE SAWING OPEN THE NORTHWEST STUMP, IT WAS DIFFICULT TO IDENTIFY EXACTLY WHERE IN THE STUMP THE REMAINS OF THE POSSIBLE FACE CAME FROM IN RELATION TO THE CENTER OF THE STUMP, THEREFORE HELD THE GLO RECORD DISTANCE TO THE BEARING TREE AS A FACE DISTANCE AND CALCULATED THE ADDITIONAL MEASUREMENT TO THE CENTER OF THE STUMP FROM THE RECORD GLO TREE DIAMETER. THEN INTERSECTED THAT CENTER DISTANCE WITH THE GLO RECORD DISTANCE TO THE FACE OF THE NORTHEAST BEARING TREE. HELD THE DISTANCE-DISTANCE INTERSECTION POSITION AS A PERPETUATION OF THE ORIGINAL CORNER POSITION.

AT THE DISTANCE-DISTANCE INTERSECTION SET A 2" X 31-1/2" GALVANIZED IRON PIPE WITH A 3-1/4" BRASS DISK CEMENTED IN THE TOP, 1" ABOVE GROUND SURFACE AND MARKED AS SHOWN ON PAGE 2 OF 2. SET TWO NEW IRON ROD ACCESSORIES AND BLAZED AND SCRIBED TWO NEW BEARING TREES AS SHOWN ON PAGE 2 OF 2. SET 6 FOOT ORANGE CARSONITE "SURVEY MARKER" POST 1 FOOT NORTH OF BRASS DISK.

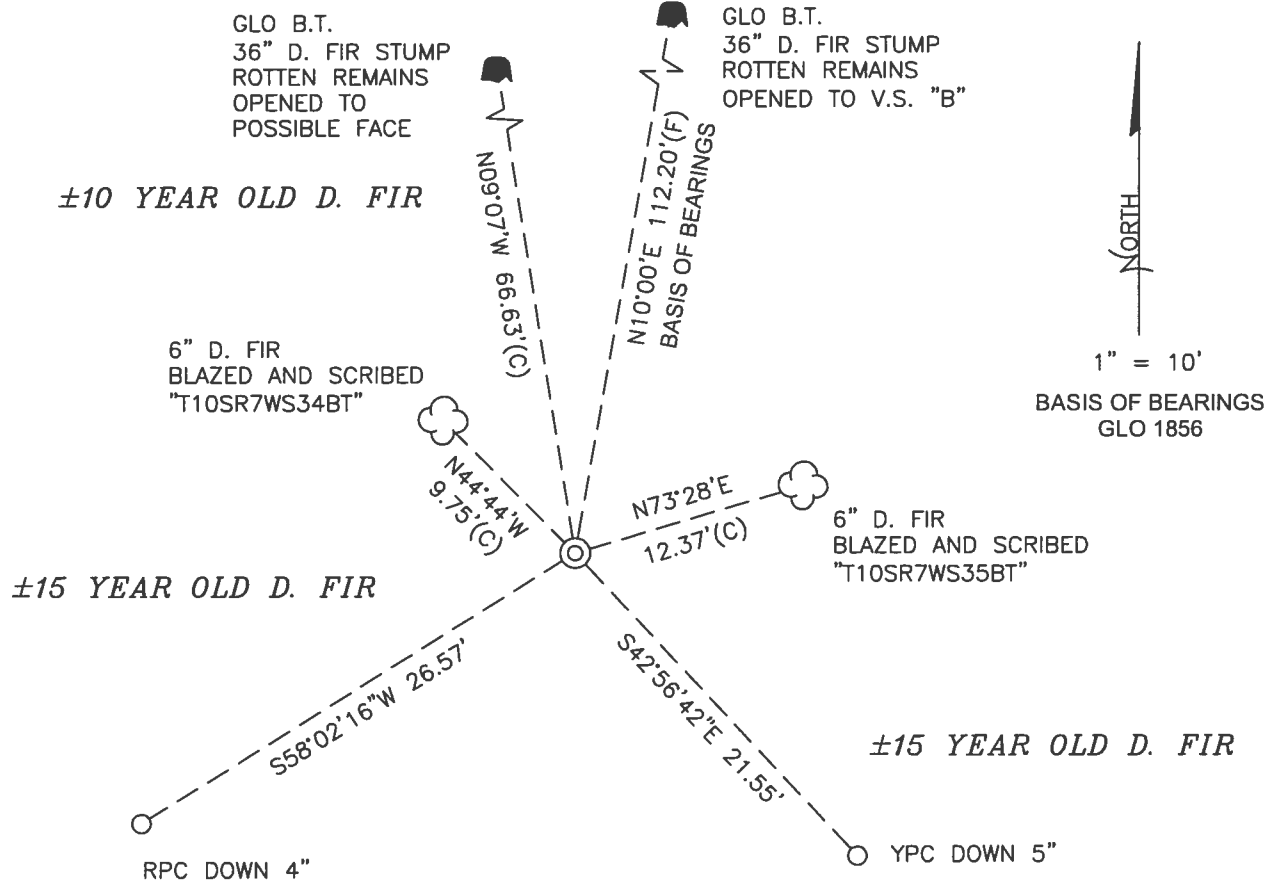

MONUMENT DETAIL

LEGEND

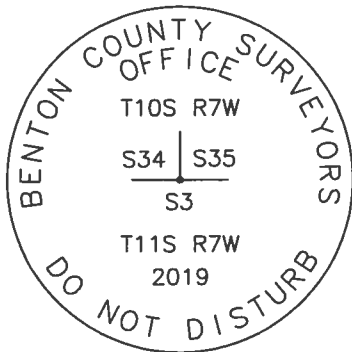

3-1/4" BRASS DISK

- SET 5/8" X 30" REBAR WITH PLASTIC CAP
- YPC YELLOW PLASTIC CAP MARKED "BENTON COUNTY SURVEYOR"
- RPC RED PLASTIC CAP MARKED "BENTON COUNTY SURVEYOR"
- (F) MEASUREMENT TO FACE
- (C) MEASUREMENT TO CENTER
- ⊙ GOVERNMENT MONUMENT SET AS SHOWN
- V.S. VISIBLE SCRIBING
- GLO GENERAL LAND OFFICE
- B.T. BEARING TREE
- 🌲 BEARING TREE STUMP AS NOTED
- ☁ BEARING TREE AS NOTED

**NEW ACCESSORIES:**

1. SET REBAR (SEE LEGEND) S42°56'42"E, 21.55 FEET AND 5 INCHES BELOW GROUND LEVEL.
2. SET REBAR (SEE LEGEND) S58°02'16"W, 26.57 FEET AND 4 INCHES BELOW GROUND LEVEL.
3. D. FIR 6" DIA BEARS N73°28'E, 12.37 FEET TO CENTER, FACE SCRIBED "T10SR7WS35BT". SET ALUMINUM NAIL AND PLASTIC WASHER IN NORTHWESTERLY BASE FOR DISTANCE MEASUREMENT.
4. D. FIR 6" DIA BEARS N44°44'W, 9.75 FEET TO CENTER, FACE SCRIBED "T10SR7WS34BT". SET ALUMINUM NAIL AND PLASTIC WASHER IN SOUTHWESTERLY BASE FOR DISTANCE MEASUREMENT.

**NOTES:**

COMPASS DECLINATION IS 15° EAST. ALL MEASURED DISTANCES AND BEARINGS ARE TO THE CENTER OF THE OBJECT, UNLESS OTHERWISE NOTED. ALL BEARING TREES ARE PAINTED AND HAVE A B.T. TAG ATTACHED, FACING THE CORNER UNLESS OTHERWISE NOTED. ALL NEW BEARING TREES HAVE A PLASTIC WASHER (STAMPED "SURVEY MARKER DO NOT REMOVE") ATTACHED BY AN ALUMINUM NAIL TO THE SIDE CENTER OF THE TREE FOR DISTANCE MEASUREMENT, UNLESS OTHERWISE NOTED.

THIS RESTORATION WAS PERFORMED AT THE DIRECTION AND APPROVAL OF THE BENTON COUNTY SURVEYOR *JLM*

REGISTERED  
PROFESSIONAL  
LAND SURVEYOR

FIRM/AGENCY: BENTON COUNTY SURVEYOR'S OFFICE  
 ADDRESS: 360 S.W. AVERY AVE., CORVALLIS, OR 97333; PH. 541-766-6821  
 PRESENT: DAVID L. MALONE, P.L.S., AND BERNARD ALTENBACH, SURVEY TECH.  
 EQUIPMENT: NIKON NIVO3.C WITH SURVEY PRO ONBOARD.

6/11/19 *David L. Malone*

OREGON  
JANUARY 12, 1999  
DAVID L. MALONE  
51523

RENEWAL DATE: 12/31/20

107500100

REMOVEMENT TLOS RTW 34/35

FD NE 60 FT ROTTED STUMP OPENED TO U.S. "B"  
 FD ROTTED REMAINS OF NW 60 FT STUMP OPENED TO  
 POSSIBLE FACE. CALC CENTER AT DIST-DIST  
 INTERSECTION FROM FACE OF NE PT & CENTER  
 ADJUSTED TO 60 DIA FROM CENTER OF NW ST.  
 AT CALC. POSITION SET 2" x 3 1/2" G.I. P W/  
 3-1/4" BRASS DISK CENTER IN THE TOP, 1"  
 ABOVE GROUND SURFACE. SET TWO NEW 1/8"  
 ROD ACCESSORIES AND SURFED & SCRIBED TWO  
 NEW BEARING TRIPS. SET 6" ORANGE CARBONITE  
 "SURVEY MARKER" POST 1' NORTH OF BRASS  
 DISK. HOLD NW 60 FT FOR BASIS OF SURVING.



DR = 5/8" x 30" DRW ROD  
 1/8" OR RPC = (YELLOW OR RED)  
 PLASTIC CAP MARKED  
 "PELTON COUNTY SURVEYOR"  
 NEW = NAIL & PLASTIC WASHER  
 MARKED "SURVEY MARKER"  
 DO NOT REMOVE

WINDY, CLEAR

5/30/19

MIKON NIVOLIC (CUBET PROGNOSTIC) D. MARONE B. AURUMBACH

32/40

