

## CORNER FILE TRACKING

H:\Survey\Corners\Misc\Filetrac2.doc  
06/15/2003

<b>CORNER NUMBER</b>
<b>107500340</b>

STEP	HISTORY()	RESTORATION()
Form Prepared, DB	11/03/05	7/21/07
Field Inspection, DB	7/15/08	7/15/08
Form Checked, DB	7/24/08	7/24/08
Form Edited, DB	7/25/08	7/25/08
Form Signed, DB	7/25/08	7/25/08
Counter Index	7/25/08	7/25/08
GIS Index	7/28/08	7/28/08
Authorize Payment, DB	—	—
Archive Digital Files	7/28/08	7/28/08
Collect Documents	7/28/08 ✓	7/28/08 -
Scanned	7/30/08	7/30/08
Copy For Filming	7/28/08	7/28/08
Filed, DB		
Finish index (count unit)	7/15/08	7/15/08
Filmed (Archived), DB		
Document No's to Andrew		

(DB) = Entry needed in database (Access).

### COMMENTS:

**107500340**

DATE 11/03/2005TOWNSHIP 10 SOUTH, RANGE 07 WEST, WILLAMETTE MERIDIAN; SECTION 22 CORNER EAST 1/4  
DONATION LAND CLAIM N/A CORNER N/A**COMMON CORNER(S):**

WEST 1/4 OF SECTION 23

**RECORDS (INFORMATION IN BOLD ITALICS IS COUNTY STAFFS' INTERPRETATION OF THE RECORD)**

BASED ON EXTENSIVE RESEARCH AND RECOVERY OF EVIDENCE, THIS OFFICE HAS DETERMINED THAT MOST GENERAL LAND OFFICE SURVEYORS MEASURED TO THE FACE OF BEARING TREES.

- [01] GENERAL LAND OFFICE (GLO) NOTES BY DENNIS HATHORN, D.S., DATED AUGUST 26, 1856. SET A POST. MARKED A 40" FIR N07°E 470 LKS. (310.20 FT.) AND A 40" FIR N50°W 59 LKS. (38.94 FT.).
- [02] CORNER RESTORATION BOOK NO. 1, PAGE 202 BY W. C. GALLOWAY, C.S., DATED JULY 28, 1934. SET A 1 1/4" SHAFT. FOUND A 40" FIR (GLO BT) N07°E 479 LKS. (316.14 FT.) WITH LOWER BLAZE ON SNAG AND A 40" FIR (GLO BT) N50°W 59 LKS. (38.94 FT.), CUT INTO MARKS. MARKED A 13" FIR N34°E 0.222 CHS. (14.65 FT.) TO NAIL IN SIDE, A 20" ALDER S84 3/4°E 0.552 CHS. (36.43 FT.) AND A 20" ALDER S19°W 0.0915 CHS. (6.04 FT.) TO NAIL IN SIDE.
- [03] CORNER RESTORATION NO. 542. TRANSCRIBED FROM RECORD [02] AND MAY CONTAIN ERRORS AND/OR OMISSIONS.
- [04] BENTON COUNTY MAP NO. 10-7-00009, NO DRAFTSMAN OR DATE GIVEN. 1 1/4" SHAFT. 40" FIR (GLO BT) N07°E 4.79 CHS. (316.14 FT.) STANDING. MARKED A 13" FIR (CSBT) N34°E 0.222 CHS. (14.65 FT.) NAIL, A 20" ALDER (CSBT) S84 3/4°E 0.552 CHS. (36.43 FT.) AND A 20" ALDER (CSBT) S19°W 0.0915 CHS. (6.04 FT.) NAIL.
- [05] BENTON COUNTY MAP NO. 10-7-00006, NO DRAFTSMAN OR DATE GIVEN. 1 1/4" SHAFT.
- [06] BENTON COUNTY MAP NO. 10-7-00011, NO DRAFTSMAN OR DATE GIVEN. 1 1/4" SHAFT.
- [07] CORNER RESTORATION CORRESPONDENCE FILE FOR 10-7 BY BRUCE STARKER, P.L.S., DATED APRIL 26, 1955. SET CAR SPRING AT CORNER. FOUND BOTH GLO BT'S, THE SECTION 22 BT IS A ROTTEN STUMP, WITH NO EVIDENCE OF A FACE AND THE SECTION 23 BT IS A SOUND STUMP WITH A BURNED FACE. MARKED A 17" FIR S54°E 122.30 FT., MARKED "1/4S23BT" AND A 19" FIR N87°W 92.00 FT., MARKED "1/4S22BT".
- [08] CORNER RESTORATION NO. 542. TRANSCRIBED FROM RECORD [07] AND MAY CONTAIN ERRORS AND/OR OMISSIONS.
- [09] COUNTY SURVEY NO. 3649 BY ELBERT DRIVER, P.L.S., DATED APRIL 19, 1962. FOUND 24" LONG PORTION OF POST WITH SCRIBES "S23" REMAINING, OUT OF PLACE. FOUND A 1 1/4" SHAFT IN PLACE. SET A 1 1/2"x36" GALVANIZED IRON PIPE WITH 3" BRONZE CAP. FOUND A 68" FIR STUMP (GLO BT) N07°E 470 LKS. (310.20 FT.) WITH FACE EXPOSED AND BURNT, A 20" ROTTED FIR STUB (GLO BT) N50°W 59 LKS. (38.94 FT.) WITH OLD AXE WORK VISIBLE, A ROTTED ALDER STUB (CSBT), ONE FOOT HIGH S84 3/4°E 52.20 LKS. (36.432 FT.), ROTTED PIECES OF ALDER (CSBT) S19°W 9.15 LKS. (6.04 FT.), AN 18" FIR S56°E 120.10 FT., WITH PORTION OF SCRIBES VISIBLE AND A 21" FIR N86 1/2°W 92.00 FT., WITH PORTION OF SCRIBES VISIBLE. SET A 4"x4"x72" WHITE PAINTED CEDAR POST 1' SOUTHWEST.
- [10] CORNER RESTORATION NO. 542. TRANSCRIBED FROM RECORD [09] AND MAY CONTAIN ERRORS AND/OR OMISSIONS.
- [11] PARTITION PLAT NO. 2000-11 BY JAMES T. EDWARDS, P.L.S., DATED AUGUST 30, 1999. FOUND 3" BRASS CAP. NO EVIDENCE OF BTS.

**NOTES:**

THIS IS A MICROSOFT WORD 2003 DOCUMENT NAMED "07500340" CREATED FROM A BOILER PLATE DOCUMENT NAMED "HISTORY", WHICH HAS A STYLESHEET NAMED "CORNER" ATTACHED TO IT.

**FIRM/AGENCY:** BENTON COUNTY SURVEYOR'S OFFICE**ADDRESS:** 360 S.W. AVERY AVE. CORVALLIS OR 97333; PH. 766-6821**RESEARCH BY:** BERNARD S. ALTENBACH, SURVEY TECH.**DATA ENTRY BY:** SAME

**SEE CORNER HISTORY FORM FOR RECORDS ETC.**

CORNER RESTORATION FIELD BOOK NUMBER 27 PAGE(S) 02 DATE 07/15/2008  
TOWNSHIP 10 SOUTH, RANGE 07 WEST, WILLAMETTE MERIDIAN; SECTION 22 CORNER EAST 1/4  
DONATION LAND CLAIM N/A CORNER N/A  
CONDITION REPORT \_\_\_\_\_; REFERENCED OUT \_\_\_\_\_; RENEWED XX; SURVEYED IN \_\_\_\_\_

**LOCATION AND COMMENTS:**

CORNER IS LOCATED ON A GENTLE SOUTHEASTERLY SLOPE IN A STAND OF MATURE HARDWOOD AND CONIFERS. TO REACH THE CORNER FROM THE JUNCTION OF HOSKINS ROAD AND SHINGLE CREEK ROAD, TRAVEL NORTHWESTERLY ON SHINGLE CREEK ROAD FOR 1.05 MILES AND PARK; THEN WALK NORTH APPROXIMATELY 6 1/2 CHAINS. CORNER IS POOR FOR PREMARKING AND GPS.

**MONUMENTS AND ACCESSORIES FOUND (CONDITION AND SOURCE):**

1. FOUND A 2" X 36" IRON PIPE WITH A 3" BRASS CAP ATTACHED, FLUSH WITH THE GROUND FOR THE CORNER POSITION. THE TOP 10" OF THE PIPE WERE BENT 0.2' SOUTHERLY.  
(SET A POST PER RECORD [01]).  
(SET A 1 1/4" SHAFT PER RECORD [02]).  
(FOUND A 1 1/4" SHAFT PER RECORD [09]).  
(SET A 1 1/2" X 36" GALVANIZED IRON PIPE WITH A 3" BRONZE CAP PER RECORD [09]).  
(FOUND A 3" BRASS CAP PER RECORD [11]).
2. FOUND A CAR SPRING LYING LOOSE ON THE GROUND SURFACE, APPROXIMATELY 20 FEET WESTERLY OF THE FOUND IRON PIPE AND BRASS CAP.  
(SET CAR SPRING AT CORNER PER RECORD [07]).
3. FOUND A 60" D. FIR STUMP, N07°E, 310.2 FEET TO BURNT OUT FACE (BEARING AND DISTANCE BY COMPASS AND STEEL TAPE).  
(MARKED A 40" FIR, N07°E, 310.20 FEET PER RECORD [01])  
(FOUND A 40" FIR SNAG, N07°E, 316.14 FEET PER RECORD [02]).  
(FOUND A SOUND STUMP PER RECORD [07])  
(FOUND A 68" FIR STUMP, N07°E, 310.20 FEET PER RECORD [09]).
4. FOUND A 30" ROTTEN D. FIR STUMP, N48°20'W, 40.46 FEET TO CENTER, NO VISIBLE SCRIBING FOUND.  
(MARKED A 40" FIR, N50°W, 38.94 FEET PER RECORD [01]).  
(FOUND A 40" FIR, N50°W, 38.94 FEET PER RECORD [02]).  
(FOUND A ROTTEN STUMP PER RECORD [07])  
(FOUND A 20" ROTTED FIR STUB, N50°W, 38.94 FEET PER RECORD [09]).
5. FOUND A 30" D. FIR STUMP, S56°00'E, 120.47 FEET TO CENTER. CHOPPED OPEN FACE TO ILLEGIBLE SCRIBING. **BASIS OF BEARINGS FOR THIS RESTORATION.**  
(MARKED A 17" FIR, S54°E, 122.30 FEET PER RECORD [07]).  
(FOUND AN 18" FIR, S56°E 120.10 FEET PER RECORD [09]).
6. FOUND A 26" D. FIR STUMP, N86°01'W, 92.34 FEET TO CENTER. CHOPPED OPEN FACE TO ILLEGIBLE SCRIBING.  
(MARKED A 19" FIR N87°W, 92.00 FEET PER RECORD [07]).  
(FOUND A 21" FIR N86 1/2°E, 92.00 FEET PER RECORD [09]).

**MONUMENT SET (PROCEDURES AND DESCRIPTION):**

THE FOUND IRON PIPE AND 3" BRASS CAP WERE SET TO PERPETUATE THE CORNER POSITION AS ESTABLISHED BY THE COUNTY SURVEYOR PER RECORD [02]. WE HELD THE IRON PIPE AND BRASS CAP PER RECORD [09] AS THE TRUE CORNER POSITION.

WE REMOVE THE IRON PIPE AND BRASS CAP AND SET A 2" X 31 1/2" GALVANIZED IRON PIPE WITH A 3 1/4" ALUMINUM DISK CONCRETED IN THE TOP, 5" BELOW GROUND LEVEL AND MARKED AS SHOWN ON PAGE 2 OF 2. WE BURIED THE IRON PIPE AND BRASS CAP IN A HORIZONTAL POSITION ON THE EAST SIDE OF THE NEW MONUMENT AND 5" BELOW GROUND LEVEL. SET A 6 FOOT ORANGE CARSONITE "SURVEY MARKER" POST, 0.5 FEET SOUTH OF THE NEW MONUMENT.

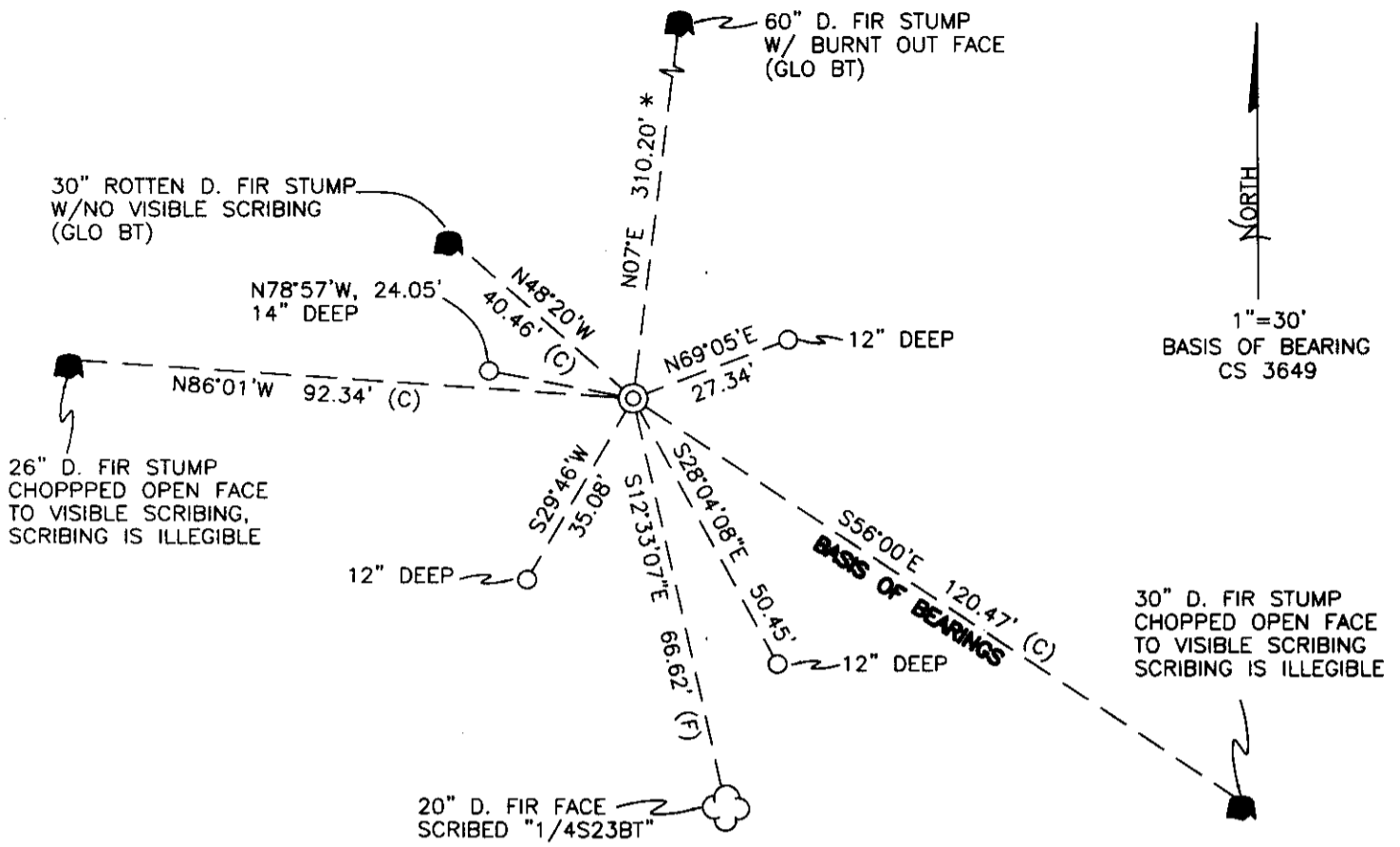

MONUMENT DETAIL

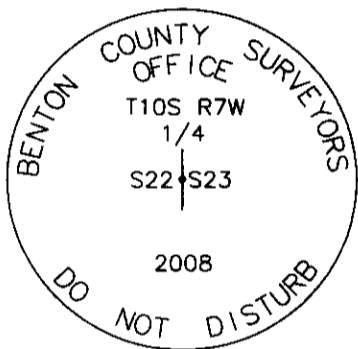

3 1/4" ALUMINUM DISK

LEGEND

- SET 5/8" X 30" REBAR WITH YELLOW PLASTIC CAP MKD "BENTON COUNTY SURVEYOR"
- FOUND MONUMENT AS NOTED.
- (F) MEASUREMENT TO FACE
- (C) MEASUREMENT TO CENTER
- ⊙ GOVERNMENT MONUMENT SET AS SHOWN
- ☼ BEARING TREE AS NOTED
- C.S.B.T. COUNTY SURVEYORS BEARING TREE
- GLO GENERAL LAND OFFICE
- ♣ BEARING TREE STUMP AS NOTED
- \* BY COMPASS & STEEL TAPE

NEW ACCESSORIES:

1. SET REBAR (SEE LEGEND) 12" BELOW GROUND LEVEL, S29°46'W, 35.08 FEET.
2. SET REBAR (SEE LEGEND) 14" BELOW GROUND LEVEL, N78°57'W, 24.05 FEET.
3. SET REBAR (SEE LEGEND) 12" BELOW GROUND LEVEL, N69°05'E, 27.34 FEET.
4. SET REBAR (SEE LEGEND) 12" BELOW GROUND LEVEL, S28°04'08"E, 50.45 FEET.
5. 20" D. FIR FACE SCRIBED "1/4S23BT" S12°33'07"E, 66.62 FEET TO FACE. SET ALUMINUM NAIL AND PLASTIC WASHER BELOW SCRIBING FOR DISTANCE AND ANGLE MEASUREMENT.

NOTES:

COMPASS DECLINATION IS 20° EAST. ALL MEASURED DISTANCES AND BEARINGS ARE TO THE CENTER OF THE OBJECT, UNLESS OTHERWISE NOTED. ALL BEARING TREES ARE PAINTED AND HAVE A B.T. TAG ATTACHED, FACING THE CORNER UNLESS OTHERWISE NOTED. ALL NEW BEARING TREES HAVE A PLASTIC WASHER (STAMPED "SURVEYOR MARKER DO NOT REMOVE") ATTACHED BY AN ALUMINUM NAIL TO THE FACE, BELOW THE "BT" FOR DISTANCE AND ANGLE MEASUREMENT UNLESS OTHERWISE NOTED. THE DRAWING IS FROM AUTOCAD RELEASE 2008.

THIS RESTORATION WAS PERFORMED AT THE DIRECTION AND APPROVAL OF THE BENTON COUNTY SURVEYOR Ree

REGISTERED  
PROFESSIONAL  
LAND SURVEYOR

7/25/08 *David M. Dean*

FIRM/AGENCY: BENTON COUNTY SURVEYOR'S OFFICE  
 ADDRESS: 360 S.W. AVERY AVE. CORVALLIS, OR. 97333; PH. 766-6821  
 PRESENT: BERNIE ALTENBACH AND TYLER OTT, SURVEY TECH.  
 EQUIPMENT: LEICA TCR 1105 WITH TDS ON BOARD

OREGON  
JULY 13, 1984  
DAVID M. DEAN  
2090

RENEWAL DATE: 12/31/09

107500340

RENUMERATION 22/23 10-7

3" D.S. R.F.  
 FO A LEON PIPE & BRASS CAP SET FLUSH WITH THE  
 GROUND WITH THE TOP 9" SLIGHTLY BENT IN A  
 SOUTHERLY DIRECTION. WE REFERENCE THE  
 STRAIGHT PORTION OF THE PIPE & SET A 2' X 3 1/2"  
 GALV. I.P. WITH A 3 1/4" ALUM. DISK MARKED AS  
 SHOWN AND CONCRETE IN TOP OF THE PIPE LEVEL  
 TO BOTH GLO RTS. NE: 60' ROTTED D.F. FIRE  
 STUMP W/BOUNT OUT FACE NW: 30' ROTTED D.F. FIRE  
 STUMP, NB MARKS VISIBLE. FOUND BOTH RTS  
 BY B STARKER: BOTH ARE STUMPS, CHOPPED OUT  
 FACES TO FIND ILLIGIBLE SCRIBING ON BOTH  
 STUMPS  
 HORIZONTALLY  
 BURIED OLD MONUMENT ON THE EAST SIDE OF  
 THE NEW MON, 5" BELOW GROUND LEVEL.  
 SET A 6 FOOT CANTONITE "S SURVEY  
 MARKER" POST 0.5 FEET SOUTH OF NEW  
 MONUMENT.

3 1/4" ALUM DISK



CLEAR/10/24/24  
76°F, 29.4" Hg

LEICA TC2105/TDS

7/14/08  
B. ALTENBACH  
T.O.T.

27/2

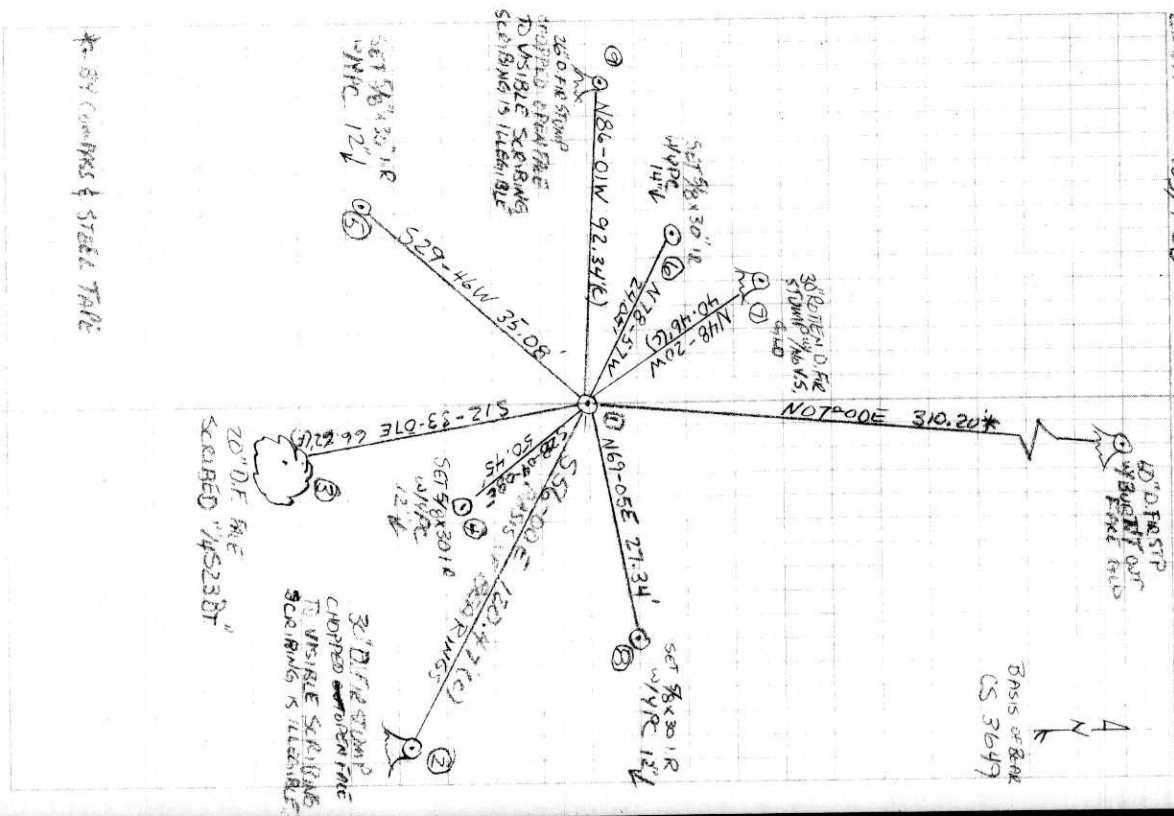

C.S. Road #591  
Decker Road  
Wilkessee  
Emile E. Larkin  
Harold Merryman  
by W.C. Galloway

1/4 Sec. Cor. between secs. 32 & 33 T. 12 S. R. 6 W.  
Set a 3/4" iron rod (windshield brace) both stumps with letters found  
Orig. Fir 6" in dia. bears N. 61° E. 14 stump rotten  
" " 6" " " " N. 27° W. .05 " good condition  
Mkd. " 30" " " " 5 68° 10' W. 2.102  
June 1934

C.S.  
Arthur  
J.F.B  
Arthur  
Fred L  
by W.  
Oct. 21  
C.S.

Witnesses as above

Interior Corner of Hilkiak Banks D.L.C. 66 & 48 T. 28/35  
Set a 1" Pipe Found brick bats at corner R. 6 W.  
found Oak 24 N 65° W .34 dead  
" " 18.5 25° W. .84 "  
Marked a fir 20" in dia. bears N 17° E .045 chains  
" " " 40" " " N 68° W. 1.313 " + 1' 15" = 1.309  
" " " 10" " " S 46° W. .122 "  
June 1934

Witness  
student  
Prof. T.  
by W.  
May 1  
C.S  
Witness  
by W.  
July

Marks Road #596  
Frank Bottger  
and Emile E. Larkin  
by W.C. Galloway  
July 28, 1934

1/4 Sec. Cor. bet. Secs. 22 & 23 T. 10 S. R. 7 W.  
Set a 1 1/4" Shaft (1/2 of an axle)  
Set from Fir 40" N 50° W. 59 lks. lower blaze on snag  
" " " 40" N 7° E 479 " Cut into marks. Good tree.  
Marked a fir 13" in dia. bears N 34° E. .222 chain to nail inside  
" an Alder 20" " " " S 84 3/4° E .552 "  
" " " 20" " " " S 19° W. .0915 " Nail inside

C.S.  
Witness  
James  
Emile  
F.M.

C.S. #53 cont.  
Witnesses  
G. Mark Gragg  
Emile E. Larkin  
by W.C. Galloway  
Oct. 1, 1932

Most South S.W. Corner of John Kellum D.L.C. #41114-7  
Set a 1/2" Galv. pipe on Range line 10.50 S. of Interior Corner.  
Marked a Willow 20" in dia. bears S. 83° W. .730  
" an Alder 17" " " " N. 7° E. .417  
A 1" Pipe on S.L. Rycraft Claim line S. 0° 13' W. 2.430

Witness  
June

Oct 1, 1932

S.E. Cor. of John Kellum D.L.C. # 418 46 T. 14 S. R. 7 W.  
Set a buggy axle found print or evidence of corner of former survey.

Witness  
above  
June

C.S. #128  
by W.C. Galloway  
Witnesses  
Frank Spencer and  
Geo. Sabrill & Sam Munkling  
March 20, 1912

N.E. corner of Section 4 T. 14 S. R. 7 W on std. line.  
Set a wagon spring (leaf) fir down, dogwood with sprouts (ok. in 1932)  
Fir 48" in dia. bears S. 55° E. 1.145 chains.  
" 54" " " " S 14° W. .384 "

Witness  
Emile  
Witness  
Cly  
et.

Witnesses as above  
March 3, 1912

N.W. corner of Sec. 4 T. 14 S. R. 7 W.  
Set a 1 1/2" x 14" Iron pin  
Fir 12" in dia. bears S. 65° E. .53 std.  
" 15" " " " S. 10° W. .80 chs. std.

(ok. in 1932)

C.S. #128  
Witnesses as above  
B.E. Martin  
& S.W. Fander  
Aug. 1912  
Oct. 1938  
Trees mkd. and  
stone replaced

1/4 Sec. Cor. on N. of Sec. 4 on 3rd Std. parallel T. 14-7  
Set a 1" x 2 1/2" x 26" Iron bar  
Cedar stump 48" in dia. bears S 60° E. .30 chs. std.  
Mkd. fir 5" in dia. bears N. 97 1/4° E. .334 "  
" " 4" " " " S 70 3/4° E. .133 "

Witness  
Lar  
J

107500340

$\frac{1}{4}$ -Section corner between sections 22 and 23, Twp. 10 S., R. 7 W.  
Reestablishment by W. C. Galloway July 28, 1934

Set a  $1\frac{1}{4}$ " shaft ( $\frac{1}{2}$  of an axle)

Fir 40" in diam bears N 50° W	59 links
Fir 40" in diam bears N 7° E	479 links
Fir 13" in diam bears N 34° E	.222 chains
Alder 20" in diam bears S 84 $\frac{3}{4}$ ° E	.552 chains
Alder 20" in diam bears S 19° W	.0915 chains

Witnesses Frank Bottger and Emile E. Larkin

543

By Bruce Starker

Scribed a **Fir** 19" N 87° W 92.0 feet marked  $\frac{1}{4}$ " S 22 BT

Scribed a **Fir** 17" S 54° E 122.3 feet marked  $\frac{1}{4}$ " S 23 BT

Drove a **car** spring leaf at the corner. Section 22 bearing tree is now a rotten stump with no evidence of a face. The section 23 bearing tree is a sound stump with a burned out face.

4/26/1955

Restored by Elbert Driver  
Found  $1\frac{1}{4}$ " shaft

April 19, 1962

C.S. 3649

Fir 13" N 34° E .222 chains; missing  
 Alder 20" S 84° 3/4' E .552 chains; rotted stub  
 Alder 20" S 19° W .0915 chains; rotted pieces remaining  
 Fir 21" N 86 $\frac{1}{2}$ ° W 92.0 ft. partly grown over  
 Fir 18" S 56° E 120.1 ft. Partly grown over

Set  $1\frac{1}{2}$ " x 36" iron pipe bronze cap marked "OREGON STATE BOARD OF FORESTRY 1/4

S22 S23 1962 RS559" over shaft.

Set 4" x 4" white **pst** 1.0' SW of corner pipe.



14/7  
12/7

Corner between sections 34, 35, T11S R7W, sections 2, 3, T12S R7W.  
Scribed a fir 16" S28°E 1.17 Links  
Marked #310 S 2 BT SEE COR. REST. NO. 1154 (CJL 7/11/90).

1/4 Corner between sections 35, 36, T10S R7W. W. M.  
Scribed a fir 15" S64°30'W 20.5 feet  
Marked 1/4 S35 BT

Scribed a fir 15" S37°20'E 24.1 feet  
Marked #310 1/4 S36 BT

Original bearing trees are now rotten stumps with no scribes in evidence, Bearings and distances check perfectly. Line topography checks with original survey. Drove a 1/2 x 30 iron rod at the corner.

1/4 corner between sections 2, 3, T11S R7W, W. M.

Scribed fir 8" S77°30'E 37.5 feet  
Marked #310 1/4 S 2 BT

Scribed fir 8" N68°W 66.9 feet  
Marked 1/4 S 3 BT

Found original section 3 bearing tree with some scribing in evidence. Maple bearing tree in section 2 is gone.

1/4 corner between sections 22, 23, T10S R7W, W. M.

Scribed a fir 19" N87°W 92.0 feet  
Marked 1/4 S 22 BT

Scribed a fir 17" S54°E 122.3 feet  
Marked 1/4 S 23 BT

Drove a car spring ~~and shackle~~ at the corner.  
Section 22 bearing tree is now a rotten stump with no evidence of a face. The section 23 bearing tree is a sound stump with a burned out face.

SEE COR. REST. NO. 593 (CJL 7/11/90)

5

SEE COR. REST. NO. 976 (CJL 7/11/90)

6

SEE COR. REST. NO. 542 (CJL 7/11/90)

7

10/7

11/7

12/7

4-26-55

107500340

REGISTERED  
OREGON  
LAND SURVEYOR

Bruce Starker

NOV. 6, 1953  
BRUCE STARKER  
310

## RESTORED CORNER FOR STATE OF OREGON--DEPARTMENT OF FORESTRY

One Quarter corner common to Sections 22 and 23, T10S,  
R7W, W.M., Benton County, Oregon.

## ORIGINAL

Post (found portion 24" long, out of place, scribes S23 remaining) from which a:

- 40" Fir bears N50W 59 lks.; now 20" rotted stub, old axe work visible.
- 40" Fir bears N70E 470 lks.; now 68" stump, face exposed and burnt, bears N7E.

RESTORATION by W. C. Galloway, April, 1928

1 $\frac{1}{4}$ " shaft (found in place) from which a:

- 13" Fir bears N34E 22.2 lks.; missing, point falls in skid road.
- 20" Alder bears S84 3/4E 52.2 lks.; now a rotted stub 1 ft. high.
- 20" Alder bears S19W 9.15 lks.; rotted pieces of Alder remaining.

RESTORATION by unknown party

- 21" Fir bears N86 $\frac{1}{2}$ W 92.0 ft.; face partly grown over, portion of scribes visible.
- 18" Fir bears S56E 120.1 ft.; face partly grown over, portion of scribes visible.

RESTORED

Var. 20 $\frac{1}{2}$ °E

Set 1 $\frac{1}{2}$ " x 36" galvanized iron pipe with 3" bronze cap marked "OREGON STATE BOARD OF FORESTRY 1/4 S22 S23 1962 RS559", 33 inches in ground, over above shaft.

Set 4" x 4" x 72" white painted Cedar post 1.0' SW of corner pipe.  
Oregon State Forestry Department metal location poster on 3" Fir S4W 10.0 ft.

Dated April 19, 1962

Restored by

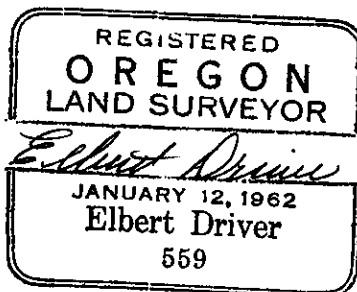

Present and witnessed by Billie Davis  
John Hollingsworth

C.S. Road #591  
Decker Road  
Witnesses  
Emile E. Larkin  
Harold Merryman  
by W.C. Galloway

1/4 Sec. Cor. between secs. 32 & 33 T. 12 S. R. 6 W.  
Set a 3/4" iron rod (windshield brace) both stumps with letters found  
Orig. Fir 6" in dia. bears N. 61° E. 14 stump rotten  
" " 6" " " " N. 27° W. .05 " good condition  
Mkd. " 30" " " " S 68° 10' W. 2.102  
June 1934

Witnesses as above

Interior Corner of Hitchhik Banks D.L.C. 66848 T. 128/135 R. 6 W.  
Set a 1" Pipe Found brick bats at corner  
found Oak 24 N 65° W .34 dead  
" " 18.5 25° W .84 "  
Marked a fir 20" in dia. bears N 17° E .045 chains  
" " 40" " " N 68° W. 1.313 " + 1.15 = 1.309  
" " 10" " " S 46° W. .122 "  
June 1934

Marks Road #596  
Frank Bottger  
and Emile E. Larkin  
by W.C. Galloway  
July 28, 1934

1/4 Sec. Cor. bet. Secs. 22 & 23 T. 10 S. R. 7 W.  
Set a 1 1/4" Shaft (1/2 of an axle)  
Set from Fir 40" N 50° W. 59 lks. lower blaze on snag  
" " " 40" N 7° E 479 " Cut into marks. Good Tree  
Marked a fir 13" in dia. bears N 34° E. .222 chain & nail inside  
" an Alder 20" " " S 84 3/4° E .552 "  
" " " 20" " " S 19° W. .0915 " Nail in side

C.S. #53 cont.  
Witnesses  
G. Mark Grogg  
Emile E. Larkin  
by W. C. Galloway  
Oct. 1, 1932

Most South S.W. Corner of John Kellum D.L.C. #41714-7  
Set a 1/2" Galv. pipe on Range line 10.50 S. of Interior Corner.  
Marked a Willow 20" in dia. bears S. 83° W. .730  
" an Alder 17" " " " N. 7° E. .417  
A 1" Pipe on S.L. Rycraft Claim line S. 0° 13' W. 2.430

Oct 1, 1932

S.E. Cor. of John Kellum D.L.C. # 41846 Tpa. 14 S. R. 788 W.  
Set a buggy axle found print or evidence of Corner of former survey.

C.S. #128  
by W.C. Galloway

N.E. corner of Section 4 T. 14 S. R. 7 W on Std. line.  
Set a wagon spring (leaf) fir dead, dogwood with sprouts (O.K. in 1938)  
Fir 48" in dia. bears S. 55° E. 1.145 chains  
" 54" " " " S 14° W. .384 "

Witnesses  
Frank Soeacker and  
Geo. Sabrill & Son Wharfing  
Brook 20, 1912

Witnesses as above  
March 3, 1912

N.W. corner of Sec. 4 T. 14 S. R. 7 W.  
Set a 1 1/2" x 14" Iron pin  
Fir 12" in dia. bears S. 65° E. .53 std.  
" 15" " " " S. 10° W. .80 chs. std.

C.S. #128  
Witnesses as above  
B.E. Martin  
& S.W. Fender  
Aug. 1912  
Oct. 1938  
Trees mkd. and  
stone replaced

1/4 Sec. Cor. on N. of Sec. 4 on 3rd Std. parallel T. 14-7  
Set a 1" x 2 1/2" x 26" Iron bar  
Cedar stump 48" in dia. bears S 60° E. .30 chs. std.  
Mkd. fir 5" in dia. bears N. 97 1/4° E. .334 "  
" " 4" " " " S 70 3/4° E. .133 "

1/4-Section corner between sections 22 and 23, Twp. 10 S., R. 7 W.  
Reestablishment by W. C. Galloway July 28, 1934

Set a 1 1/4" shaft (1/2 of an axle)  
Fir 40" in diam bears N 50° W 59 links  
Fir 40" in diam bears N 7° E 479 links  
Fir 13" in diam bears N 34° E .222 chains  
Alder 20" in diam bears S 84 3/4° E .552 chains  
Alder 20" in diam bears S 19° W .0915 chains

Witnesses Frank Bottger and Emile E. Larkin

948

By Bruce Starker  
Scribed a **Fir** 19" N 87° W 92.0 feet marked 1/4 S 22 BT  
Scribed a **Fir** 17" S 54° E 122.3 feet marked 1/4 S 23 BT  
Drove a **car** spring leaf at the corner. Section 22 bearing tree is now a rotten stump with no evidence of a face. The section 23 bearing tree is a sound stump with a burned out face.

4/26/1955

Restored by Elbert Driver April 19, 1962 C.S. 3649  
Found 1 1/4 shaft

Fir 13" N 34° E .222 chains; missing  
Alder 20" S 84° 3/4' E .552 chains; rotted stub  
Alder 20" S 19° W .0915 chains; rotted pieces remaining  
Fir 21" N 86 1/2° W 92.0 ft. partly grown over  
Fir 18" S 56° E 120.1 ft. Partly grown over

Set 1 1/2" x 36" iron pipe bronze cap marked "OREGON STATE BOARD OF FORESTRY 1/4  
S22 S23 1962 RS559" over shaft.  
Set 4" x 4" white pps 1.0' SW of corner pipe.

14/7 }  
3/7 }  
12/7 }  
Corner between sections 34, 35, T11S R7W, sections 2, 3, T12S R7W.  
Scribed a fir 16" S28°E 1.17 Links  
Marked #310 S 2 BT SEE COR. REST. NO. 1154 (CJL 7/11/90).

1/4 Corner between sections 35, 36, T10S R7W, W. M.  
Scribed a fir 15" S64°30'W 20.3 feet  
Marked 1/4 S35 BT

10/7 →  
Scribed a fir 15" S37°20'E 24.1 feet  
Marked #310 1/4 S36 BT

SEE COR. REST. NO. 593 (CJL 7/11/90)  
⑤  
Original bearing trees are now rotten stumps with no scribes in evidence, Bearings and distances check perfectly. Line topography checks with original survey. Drove a 1/2 x 30 iron rod at the corner.

1/4 corner between sections 2, 3, T11S R7W, W. M.

Scribed fir 8" S77°30'E 37.5 feet  
Marked #310 1/4 S 2 BT

11/7 }  
SEE COR. REST. NO. 976 (CJL 7/11/90).  
⑥  
Scribed fir 8" N68°W 66.9 feet  
Marked 1/4 S 3 BT

Found original section 3 bearing, tree with some scribing in evidence. Maple bearing tree in section 2 is gone.

1/4 corner between sections 22, 23, T10S R7W, W. M.

Scribed a fir 19" N87°W 92.0 feet  
Marked 1/4 S 22 BT

10/7 →  
Scribed a fir 17" S54°E 122.3 feet  
Marked 1/4 S 23 BT

SEE COR. REST. NO. 542 (CJL 7/11/90).  
⑦  
Drove a car spring ~~and stake~~ at the corner.  
Section 22 bearing tree is now a rotten stump with no evidence of a face. The section 23 bearing tree is a sound stump with a burned out face.

107500340

REGISTERED  
OREGON  
LAND SURVEYOR

Bruce Starker

NOV. 6, 1953  
BRUCE STARKER  
310