

107600440

DATE 10/25/2017TOWNSHIP 10 SOUTH, RANGE 7 WEST, WILLAMETTE MERIDIAN; SECTION 13 CORNER WEST 1/4
DONATION LAND CLAIM N/A CORNER N/ACOMMON CORNER(S):
EAST 1/4 CORNER SECTION 14**RECORDS (INFORMATION IN BOLD ITALICS IS COUNTY STAFFS' INTERPRETATION OF THE RECORD)**

BASED ON EXTENSIVE RESEARCH AND RECOVERY OF EVIDENCE, THIS OFFICE HAS DETERMINED THAT MOST GENERAL LAND OFFICE SURVEYORS IN BENTON COUNTY MEASURED TO THE FACE OF BEARING TREES.

- [01] GENERAL LAND OFFICE (GLO) NOTES BY DENNIS HATHORN, D.S., DATED AUGUST 26, 1856. SET POST FROM WHICH A FIR 50" DIA BEARS S12°W, 41 LINKS (27.06 FEET); A FIR 40" DIA BEARS N10°E, 69 LINKS (45.54 FEET).
- [02] BENTON COUNTY SURVEY NO. 1290 (OLD NO. 272) FIELD NOTES (FIELD BOOK 46, PAGE 19) BY W. C. GALLOWAY, C.S., DATED JULY 16, 1936. SET 1/2" X 20" GALVANIZED PIPE. FIR 50" DIA (GLO BT) BEARS N10°E, 0.69 CHAINS (45.54 FEET), DEAD SNAG, NOTCH AND BLAZE; FIR 40" DIA (GLO BT) BEARS S12°W, 0.66 CHAINS (43.56 FEET), DEAD SNAG, "1/4S BT"; MARKED FIR 22" DIA BEARS S10°W, 0.129 CHAINS (8.51 FEET); MARKED FIR 20" DIA BEARS WEST, 0.256 CHAINS (16.90 FEET).
- [03] BENTON COUNTY CORNER RESTORATION BOOK NO. 1, PAGE 211, BY W. C. GALLOWAY, C.S., DATED SEPTEMBER, 1936. SET 1/2" X 20" GALVANIZED PIPE. FIR 50" DIA (GLO BT) BEARS N10°E, 0.69 CHAINS (45.54 FEET), DEAD SNAG; FIR 40" DIA (GLO BT) BEARS S12°W, 0.66 CHAINS (43.56 FEET), DEAD SNAG; MARKED FIR 22" DIA (CSBT) BEARS S10°W, 0.129 CHAINS (8.51 FEET); MARKED FIR 20" DIA (CSBT) BEARS WEST, 0.256 CHAINS (16.90 FEET).
- [04] BENTON COUNTY CORNER RESTORATION NO. 490. TRANSCRIBED FROM RECORD [03] AND MAY CONTAIN ERRORS AND/OR OMISSIONS.
- [05] BENTON COUNTY SURVEY NO. 1290 (OLD NO. 227) BY UNKNOWN DRAFTSMAN, DATED NOVEMBER 21, 1936. 1/2" X 20" PIPE.
- [06] BENTON COUNTY MAP NO. 10-7-00020 BY W. C. GALLOWAY, C.S., NO DATE GIVEN. 1/2" X 20" GALVANIZED PIPE. FIR 50" DIA (GLO BT) BEARS N10°E, 0.69 CHAINS (45.54 FEET), SNAG; FIR 40" DIA (GLO BT) BEARS S12°W, 0.66 CHAINS (43.56 FEET), SNAG; MARKED FIR 22" DIA (CSBT) BEARS S10°W, 0.129 CHAINS (8.51 FEET); MARKED FIR 20" DIA (CSBT) BEARS WEST, 0.256 CHAINS (16.90 FEET).
- [07] BENTON COUNTY MAP NO. 10-7-00006 BY UNKNOWN DRAFTSMAN, NO DATE GIVEN. 1/2" X 20" GALVANIZED PIPE. FIR 50" DIA (GLO BT) BEARS N10°E, 0.69 CHAINS (45.54 FEET), SNAG; FIR 40" DIA (GLO BT) BEARS S12°W, 0.66 CHAINS (43.56 FEET), SNAG; MARKED FIR 22" DIA (CSBT) BEARS S10°W, 0.129 CHAINS (8.51 FEET); MARKED FIR 20" DIA (CSBT) BEARS WEST, 0.256 CHAINS (16.90 FEET).
- [08] BENTON COUNTY SURVEY NO. 7397 BY JOHN D. HOWELL, P.L.S., DATED APRIL 23, 1982. FOUND 1/2" PIPE. TWO ORIGINAL SNAGS STILL STANDING, SCRIBING ROTTED AWAY. FIR 20" DIA (CSBT) WEST OF CORNER IS NOW A STUMP; FIR 22" DIA (CSBT) BEARS S10°W, 8.51 FEET IS DOWN AND ROTTED. SCRIBED TWO NEW BEARING TREES: FIR 8" DIA BEARS N56°W, 4.3 FEET; FIR 10" DIA BEARS N59°E, 13.3 FEET.
- [09] BENTON COUNTY SURVEY NO. 8417 BY NORMAN D. SPRINGER, P.L.S., DATED MAY 24, 1990. FOUND 1/2" IRON PIPE.
- [10] BENTON COUNTY CORNER RESTORATION NO. 4004 BY CURTIS J. LIESENFELT, P.L.S., DATED OCTOBER 2, 1991. FOUND 1/2" INSIDE DIAMETER IRON PIPE FOR THE CORNER. FOUND A MOSTLY ROTTED D. FIR SNAG 35" DIA BEARS N14°E, 46.6 FEET. FOUND A MOSTLY ROTTED D. FIR SNAG 38" DIA BEARS S15°W, 45.2 FEET. FOUND A MOSTLY ROTTED D. FIR STUMP 24" DIA BEARS S14°W, 8.5 FEET, WITH THE SCRIBING "CS272" AND "B" VISIBLE ON THE UPPER AND LOWER FACES; FOUND A DOWNED D. FIR 14" DIA LYING IN A NORTHEASTERLY DIRECTION. THE BASE OF THE TREE BEARS N87°W, 18 FEET. FOUND A D. FIR 8" DIA BEARS N56°W, 4.30 FEET, WITH UPPER AND LOWER HEALED FACES. SET A PK NAIL AND A BRASS WASHER STAMPED "BENTON COUNTY SURVEYOR" (BCBW) IN THE NORTHEASTERLY BASE. FOUND A D. FIR 12" DIA BEARS N56°E, 13.30 FEET, WITH UPPER AND LOWER HEALED FACES. SET A PK NAIL AND BCBW IN THE NORTHWESTERLY BASE. SET 2" INSIDE DIAMETER X 36" LONG IRON PIPE WITH A 3-1/4" BENTON COUNTY BRASS CAP STAMPED "T10S R7W 1/4 S14 S13 1991", CENTERED OVER THE RECOVERED 1/2" PIPE. A D. FIR 16" DIA BEARS S15°E, 16.76 FEET, FACED AND SCRIBED "1/4 S13 BT". SET A PK NAIL AND BCBW IN THE WESTERLY BASE. A D. FIR 14" DIA BEARS S34°30'W, 38.36 FEET, FACED AND SCRIBED "1/4 S14 BT". SET A PK NAIL AND BCBW IN THE SOUTHEASTERLY BASE. SET ORANGE FIBERGLASS "SURVEY STAKE" POST 1 FOOT SOUTHERLY.
- [11] BENTON COUNTY SURVEY NO. 9535 BY JIM S. PETERSON, P.L.S., DATED FEBRUARY 22, 2000. FOUND 3-1/4" BRASS CAP. FOUND FIR SNAG 36" DIA (GLO BT) BEARS N14°E, 46.6 FEET, NO MARKS VISIBLE; FIR UPROOT 14" DIA (CSBT) BEARS N87°W, 18 FEET, NO MARKS VISIBLE; FIR SNAG 38" DIA (GLO BT) BEARS S15°W, 45.2 FEET, NO MARKS VISIBLE; FIR STUMP 24" DIA (CSBT) BEARS S14°W, 8.5 FEET, SCRIBING VISIBLE; FIR UPROOT 16" DIA BEARS S15°E, 16.76 FEET, LYING ON FACE; FIR UPROOT 14" DIA BEARS S34°30'W, 38.36 FEET, LYING ON FACE; FIR STUMP 8" DIA BEARS N56°W, 4.3 FEET, HEALED FACE; FIR STUMP 12" DIA BEARS N56°E, 13.3 FEET, HEALED FACE. FIR 18" DIA BEARS S87°E, 32.1 FEET, MARKED "1/4 S13 BT".
- [12] BENTON COUNTY SURVEY NO. 9894 BY JIM S. PETERSON, P.L.S., DATED FEBRUARY 22, 2000. FOUND 3-1/4" BRASS CAP. FOUND FIR SNAG 36" DIA (GLO BT) BEARS N14°E, 46.6 FEET, NO MARKS VISIBLE; FIR UPROOT 14" DIA (CSBT) BEARS N87°W, 18 FEET, NO MARKS VISIBLE; FIR SNAG 38" DIA (GLO BT) BEARS S15°W, 45.2 FEET, NO MARKS VISIBLE; FIR STUMP 24" DIA (CSBT) BEARS S14°W, 8.5 FEET, SCRIBING VISIBLE; FIR UPROOT 16" DIA BEARS S15°E, 16.76 FEET, LYING ON FACE; FIR UPROOT 14" DIA BEARS S34°30'W, 38.36 FEET, LYING ON FACE; FIR STUMP 8" DIA BEARS N56°W, 4.3 FEET, HEALED FACE; FIR STUMP 12" DIA BEARS N56°E, 13.3 FEET, HEALED FACE. FIR 18" DIA BEARS S87°E, 32.1 FEET, MARKED "1/4 S13 BT".

FIRM/AGENCY: BENTON COUNTY SURVEYOR'S OFFICE

ADDRESS: 360 S.W. AVERY AVE., CORVALLIS, OR 97333; PH. 541-766-6821

RESEARCH BY: DAVID L. MALONE, P.L.S.

DATA ENTRY BY: SAME

BENTON COUNTY CORNER RESTORATION FORM

4004

107600440

TOWNSHIP 10 SOUTH, RANGE 7 WEST, WILLAMETTE MERIDIAN; SECTION 13 CORNER W 1/4 DONATION LAND CLAIM

DATE 10/2/91 CORNER RESTORATION FIELD BOOK NUMBER 11 PAGE(S) 38
CONDITION REPORT ONLY; REFERENCED OUT; XX RENEWED; SURVEYED IN LOCATION AND COMMENTS:

THE CORNER IS LOCATED ON A STEEP, NORTHERLY FACING, HEAVILY WOODED HILLSIDE, APPROXIMATELY 250 FEET SOUTHERLY FROM A PASSABLE LOGGING ROAD. THERE IS AN EAST-WEST LINE FLAGGED WITH BLUE RIBBON AND BLAZED RUNNING THRU THE CORNER.

PREVIOUS RENEWALS/SURVEYS, ETC:

- [01] ORIGINAL GLO SURVEY BY DENNIS HATHORN DATED DECEMBER 5, 1856.
- [02] COUNTY SURVEY NO. 1290 BY W.C. GALLOWAY DATED JULY 16, 1936.
- [03] OLD CORNER RESTORATION BOOK NO. 1 PAGE 211 BY W.C. GALLOWAY DATED SEPTEMBER OF 1936.
- [04] CORNER RESTORATION NO. 490 BY W.C. GALLOWAY DATED SEPTEMBER OF 1936.
- [05] MAP NO. 10-7-00006 BY BENTON COUNTY SURVEYORS OFFICE (NO DATE GIVEN).
- [06] COUNTY SURVEY NO. 7397 BY JOHN HOWELL DATED APRIL 23, 1982.
- [07] COUNTY SURVEY NO. 8417 BY NORMAN SPRINGER DATED MAY 24, 1990.

MONUMENTS AND ACCESSORIES FOUND (CONDITION AND SOURCE):

- FOUND: 1/2" INSIDE DIAMETER IRON PIPE FOR THE CORNER (AS PER [2]).
- FOUND: A MOSTLY ROTTED D. FIR SNAG 35" IN DIAMETER; BEARS N 14° E 46.6 FEET (40" DIAM., N 10° E 45.54 FEET FACE MEASURE AS PER [1]). SET A B.T. TAG ON THE SOUTHERLY FACE.
- FOUND: A MOSTLY ROTTED D. FIR SNAG 38" IN DIAMETER; BEARS S 15° W 45.2 FEET (50" DIAM., S 12° W 27.06 FEET FACE MEASURE AS PER [1], 40" DIAM., S 12° W 43.56 FEET AS PER [2]). SET A B.T. TAG ON THE NORTHERLY FACE.
- FOUND: A MOSTLY ROTTED D. FIR STUMP 24" IN DIAMETER WITH THE SCRIBING "CS 272" AND "B" VISIBLE ON THE UPPER AND LOWER FACES; BEARS S 14° W 8.5 FEET (22" DIAM., S 10° W 8.51 FEET AS PER [2]). SET A B.T. TAG ON THE NORTHERLY FACE.
- FOUND: A DOWNED D. FIR 14" IN DIAMETER LYING IN A NORTHEASTERLY DIRECTION. THE BASE OF THE TREE BEARS N 87° W 18 FEET (20" DIAM., WEST 16.90 FEET AS PER [2]). SET A B.T. TAG ON THE BASE OF THE TREE.
- FOUND: A D. FIR 8" IN DIAMETER WITH UPPER AND LOWER HEALED FACES; BEARS N 56° W 4.30 FEET (8" DIAM., N 56° W 4.3 FEET AS PER [6]). SET A PK NAIL AND B.C.B.W. IN THE NORTHEASTERLY BASE. SET A B.T. TAG ON THE SOUTHEASTERLY FACE.
- FOUND: A D. FIR 12" IN DIAMETER WITH UPPER AND LOWER HEALED FACES; BEARS N 56° E 13.30 FEET (10" DIAM., N 59° E 13.3 FEET AS PER [6]). SET A PK NAIL AND B.C.B.W. IN THE NORTHWESTERLY BASE. SET A B.T. TAG ON THE SOUTHWESTERLY FACE.

NO OTHER RECORD BEARING OBJECTS WERE RECOVERED.

MONUMENT DETAIL

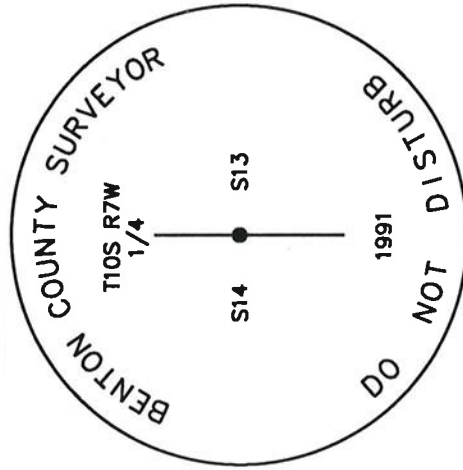

3 1/4" BRASS CAP

SKETCH

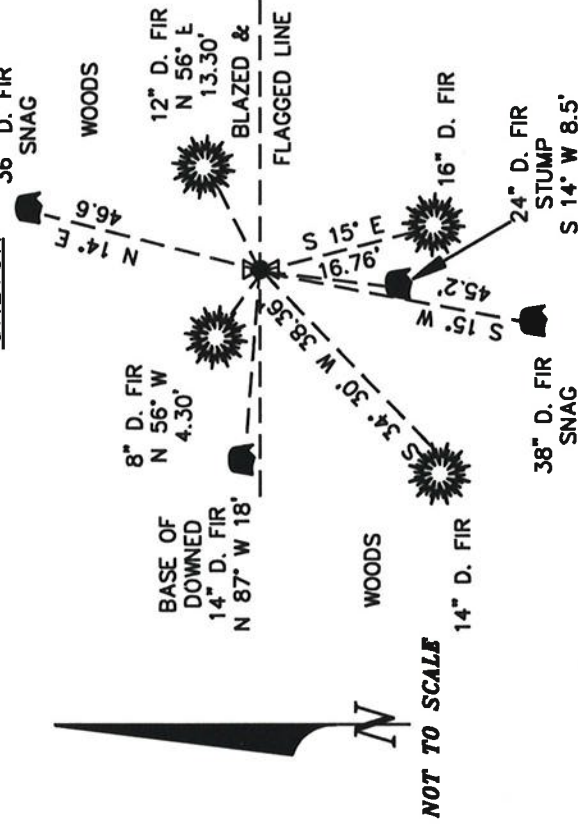

NOT TO SCALE

MONUMENT SET (PROCEDURES AND DESCRIPTION):

SET: 2" INSIDE DIAMETER X 36" LONG IRON PIPE WITH A 3 1/4" BENTON COUNTY BRASS CAP, STAMPED AS SHOWN, CENTERED OVER THE RECOVERED 1/2" PIPE.

NEW ACCESSORIES:

- A D. FIR 16" IN DIAMETER, BEARS S 15° E 16.76 FEET, FACED AND SCRIBED "1/4 S13 BT". SET A PK NAIL AND B.C.B.W. IN THE WESTERLY BASE. SET A B.T. TAG ON THE NORTHERLY FACE.
- A D. FIR 14" IN DIAMETER, BEARS S 34° 30' W 38.36 FEET, FACED AND SCRIBED "1/4 S14 BT". SET A PK NAIL AND B.C.B.W. IN THE SOUTHEASTERLY BASE. SET A B.T. TAG ON THE NORTHEASTERLY FACE.
- SET: ORANGE FIBERGLASS "SURVEY STAKE" POST 1 FOOT SOUTHERLY.

NOTES:

B.C.B.W. IS A BRASS WASHER STAMPED "BENTON COUNTY SURVEYOR". COMPASS DECLINATION IS 20° EAST. ALL MEASURED DISTANCES AND COMPASS BEARINGS ARE TO THE CENTER OF THE OBJECT, UNLESS OTHERWISE NOTED.

THIS RESTORATION WAS PERFORMED AT THE DIRECTION AND APPROVAL OF THE BENTON COUNTY SURVEYOR. *df*

FIRM/AGENCY: BENTON COUNTY SURVEYOR

ADDRESS: 360 S.W. AVERY AVE. CORVALLIS OR 97333; PH. 757-6821

SURVEY CREW: CURTIS J. LIESENFELT/MARK E. ANDERSON

WITNESS:

REGISTERED
PROFESSIONAL
LAND SURVEYOR

Curtis J. Liesenfelt

OREGON
JULY 17, 1986
CURTIS J. LIESENFELT
2213

11/38

10/2/91. CTI 31 MEAD. LVH DATASCOPE 20° E. DEC. SUNNY WARM

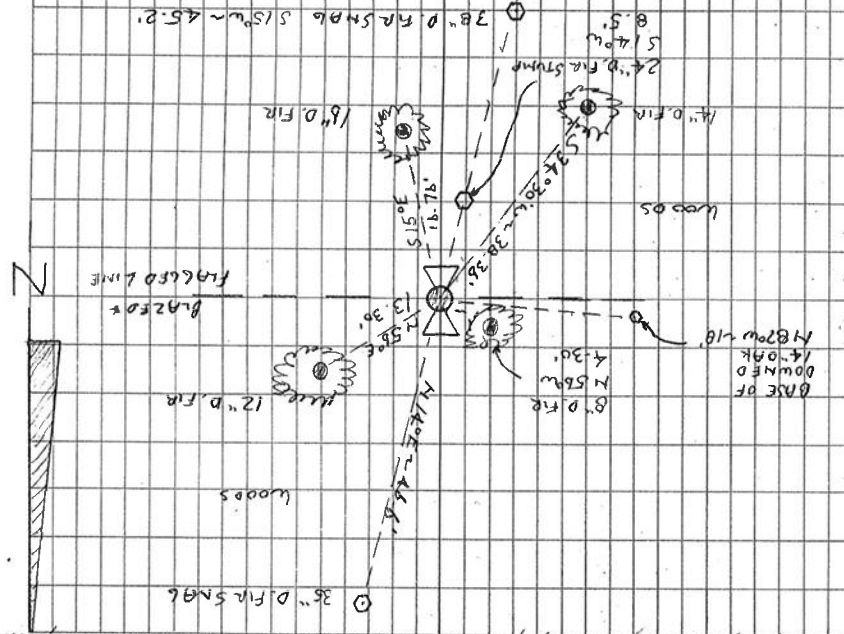

SET = 2" DIA 36" LONG IRON PIPE @ A 3 1/4" GEN CO. B.C. STOPPED

AS SHOWN CENTERED OVER THE RECOVERED 12" PIPE

A P. FIR 16" IN DIAM. BEARS S 15° E ~ 16.76' FLAGGED + SCRIBED

" 14.518 BT" SET A PK + BCB IN THE WY BASE. SET A

BT TAB ON THE H^Y FACE.

A D. FIR 14" IN DIAM. BEARS S 34.30° W ~ 38.36' FLAGGED + SCRIBED

" 14.514 BT" SET A PK + BCB IN THE SBY BASE. SET A

BT TAB ON THE N^Y FACE.

SET: ORANGE FLAGGERS "SURVEY STAKE" POST 15" H

THE COP IS LOCATED ON A STEEP N^Y FACING,

HEAVILY WOODED HILLSIDE, 250' ± S^Y FROM

A PASSABLE LOGGING RD. THERE IS AN F.W.

LIME FLAGGED @ BLUE RIBBON + BLACK RUNNING

THRU THE COP. IT IS FOR PRE-MARKING @ 5 PS

CONTROL.

11/4

TLOS RW

814 5/3

STAMPINGS

1991

TLOS RW SEC 13 W 14 COP

FIND "12" L.O.L.P. FOR THE COP (CS# 1290)

" A MOSTLY ROTTED FIR SNAG 35" IN DIAM. BEARS

N 14° E ~ 46.8' (40" DIAM. N 10° E ~ 45.54

ORIG GLO FAKE MEAS) SET A BT TAB ON THE

S^Y FACE

" A D. FIR SNAG 38" IN DIAM. BEARS S 15° W

45.2' (50" DIAM. S 12° W ~ 27.08' ORIG. GLO FAKE

ON THE N^Y FACE

MEAS; 40" DIAM. S 12° W ~ 43.56' CS# 1290) SET A BT TAB

" A MOSTLY ROTTED D. FIR STUMP 24" IN DIAM. @ THE

SCRIBING "CS 272" + "B" VISIBLE ON AN UPPER + LOWER

FACES. BEARS S 14° W ~ 8.5' (22" DIAM. S 10° W

B. ST. CS# 1290). SET A BT TAB ON THE N^Y FACE.

" A DOWNED D. FIR 14" IN DIAM LYING IN A N^Y FACE

DIRECTION. THE BASE OF THE TREE BEARS N 87° W

18' (20° WEST, 16.90' CS# 1290) SET A BT TAB ON

THE BASE OF THE TREE.

" A D. FIR B" IN DIAM. @ UPPER + LOWER HEALD FACES,

BEARS N 56° W ~ 4.30' (B" N 56° W ~ 4.3' CS# 7397)

SET A PK + BCB IN THE N^Y BASE. SET A BT

TAB ON THE S^Y FACE.

" A D. FIR 12" IN DIAM. @ UPPER + LOWER HEALD FACES,

BEARS N 56° E ~ 13.30'. (10° N 59° E ~ 13.3' CS# 7397).

SET A PK + BCB IN THE N^Y BASE. SET A BT TAB ON

THE S^Y FACE.

" AND OTHER RECORD BEARINGS OBJECTS WERE RECOVERED

1:03 S

1:37 W

CORNER RESTORATION BOOK NO. 1

211

C.S. # 361

by W.C. Gallaway
Sept. 1936
Witnesses

H.B. Auld,

Philip Auld and

Rudolph J. Stewart

Sept. 2, 1936

1/4 Sec. Corner between Secs. 35 & 36 T.10 S.R. 6 W. M. M.
Set a 3/4" Pipe, Orig. corner.

Fir 8" in dia. bears N.71°E. 41 chs. std. Magnetic N.77°E.

Mkd. fir 11" in dia. bears N.19°W. .256

" " 10" " " N.25°E. .279

1/4 Sec. Cor. on the south side of Sec. 35 T.10-6

Set a Wrench 18 1/2 x 3/4", Orig. Corner.

Found fir 8" N.51°W. .19 chs., lying on ground. Letters on both blades

Mkd. fir 22" S.88°E. .254 chs., line tree.

" " 12" S.32 1/2° N. 411 "

" " 28" S.87°W. .360 " " "

C.S. #272

July 17, 1936
by W.C. Gallaway CS
Adrian Seitz and
I. W. Bath

1/4 Sec. Cor. bet. Secs. 10 & 11 T.10 S.R. 7 W.

Set a 1/4" Pipe Fir 10' S. 2° E. 442 down.

From Fir 12" (now 56") S. 13° W. 2.16 std.

Mkd. " 24" in dia. bears S. 86° E. 162 chs.

Corner bet. Secs. 1, 2, 11 & 12 T. 10-7

Set a 3/4" Pipe

From an Alder 20" N.45° N. .05, stub std.

" " 12" N.75° W. .08, " "

Mkd. a fir 20" in dia. bears S. 9° 10' W. 1.226 chs.

" " 28" " " S. 61° 20' W. 1.437 "

" " 16" " " N. 43° 35' E. .918 "

1/4 Sec. Cor. bet. Secs. 11 & 14 T. 10-7

Set a 3/4" Galv. Pipe.

From a fir 36" in dia. bears N. 51° N. .91 chs. std.

" " 24" " " S. 84° N. 2.01 " "

C.S. #272

Sept. 1936

R. J. Stewart
Witness

1/4 Sec. cor. bet. Secs. 14 & 15 T.10-7

Set a 1 1/2" pipe

Re marked a Cedar 36" (was 12') S. 85° E. .80 chs. std. dead heart.

" " 30" (" 9") N. 55° W. .50 " "

Marked a hemlock 9" in dia. bears N. 73° E. 1.09 "

1/4 Sec. Cor. bet. Secs. 13 & 14 T. 10-7

Set a 3/4 x 20" Galv. pipe

Fir 50" in dia. bears N. 10° E. .69 chs., dead snag

" 40" " " S. 12° W. .66 " "

Mkd. " 22" " " S. 10° W. .129 "

" " 20" " " West .256 "

1/4 Sec. Cor. bet. Secs. 14 & 13 T.10-7

Set a car axle

Fir 70" in dia. bears S. 30° E. 1.28 chs., hollow stub.

" 9" " " N. 10° W. .99 " 1/4 S. on bark

Mkd. " 16" " " N. 32° E. .126 "

" " 16" " " N. 56 1/2° W. .250 "



400
1/4-Section corner between sections 13 and 14, Twp. 10-7,

Reestablishment by W. C. Galloway

September 1936

Set a 1/2" x 20" galvanized pipe
Fir 50" in diam bears N 10° E
Fir 40" in diam bears S 12° W
Fir 22" in diam bears S 10° W
Fir 20" in diam bears West

.69 chains
.66 chains
.129 chains
.256 chains