

SEE C.S. 2071

22 November, 1954

County Surveyor
Benton County
Corvallis, Oregon

Dear Curt:

The following refers to Section 24, T 10 S, R 7 W, W.M.:

At the West 1/16th corner on the E-W centerline:

| | |
|--|---|
| I found | I set |
| 5/8-in. pin bent over | long car leaf spring $\frac{1}{4}$ " x $2\frac{1}{2}$ " |
| Fir 16-in. S 06° W.114, slabbed stump | |
| Fir 12-in. S 70° E.217, buried snag | |
| | Fir 16-in. S $69\frac{1}{2}^{\circ}$ W 17.1 Ft. |
| | Fir Stump 51x55" N 52° W.1 chain m/l with 5/8-in. hex bolt driven in center. |

At the 1/16th corner in center of SW quarter section:

| | |
|---|--------------------------------------|
| I found | I marked |
| 5/8-in. pin | |
| Fir 4 in. N 45° E .023 dead std. | Fir 20 in. N 60° E 36.7 ft. |
| Fir 5 in N 80° W .140 down | |

At the 1/16th corner at center of NW quarter
no accessories found

At the 1/16th corner on the north on the N-S centerline

I found:
1 inch bolt
Hemlock 16" N 16° E .586

Very truly yours,

REGISTERED
OREGON
LAND SURVEYOR
Bruce Starker
NOV. 6, 1953
BRUCE STARKER
310

107620340

3917

BENTON COUNTY CORNER RESTORATION FORM

DATE 4/17/91

SECTION 24 TOWNSHIP 10S RANGE 7W DLC CORNER CW1/16

CONDITION REPORT ONLY REFERENCED OUT X RENEWED SURVEYED IN

RESTORED CORNER FOR STATE OF OREGON - DEPARTMENT OF FORESTRY

Center West sixteenth corner to Section 24, Township 10 South, Range 7 West, W.M. Benton County, Oregon.

ORIGINAL: H.Wells 1948, C.S.# 2071

- Set 5/8" pin (now missing) from which a:
16" fir bears S06°W .114 ch. (now missing)
12" fir bears S70°E .217 ch. (now missing)

RESTORED: Bruce Starker 1954, Corner Restoration # 549

- Set long car leaf spring 1/4"x2 1/2" (now missing) from which a:
16" fir bears S69 1/2°W 17.1 ft. (now rotten stump in place no scribe).
51"x55" fir stump with 5/8" hex bolt in center bears N52°W 1 ch.m/l (now rotten stump with bolt in center, no marks, bears N52°45'W 64.48 ft..)

RESTORED:

Set 1 1/2"x30" aluminum pipe with 3 1/2" aluminum cap marked "Oregon State Department of Forestry T.10S., R.7W., S24, 1991, RS2016", 28 inches in the ground, and from which a:

- 20" fir bears S13°E 35.75 ft. to a washer marked RS2016 and nailed to bottom of face scribed CW1/16 S24 B.T..
17" fir bears N32°W 32.32 ft. to a washer marked RS2016 and nailed to bottom of face scribed CW1/16 S24 B.T..

Set 4"x4"x72" white painted cedar post 1.0 ft. East of the corner pipe. Oregon State Forestry Department metal location poster nailed to 20" B.T.. The corner is located on ridge top in the center of old logging road. Ridge top S40°W - N25°E. Placed magnet under cap.

Dated April 17, 1991

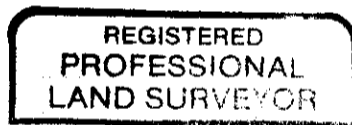

Handwritten signature: Mark E. Steele

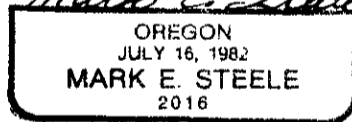

24533 Alsea Highway Philomath, Oregon 97370

Present and witnessed by Chris J. Humcke

MONUMENT DETAIL

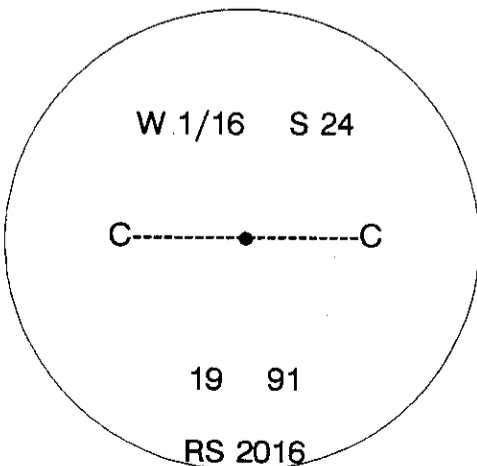

SKETCH

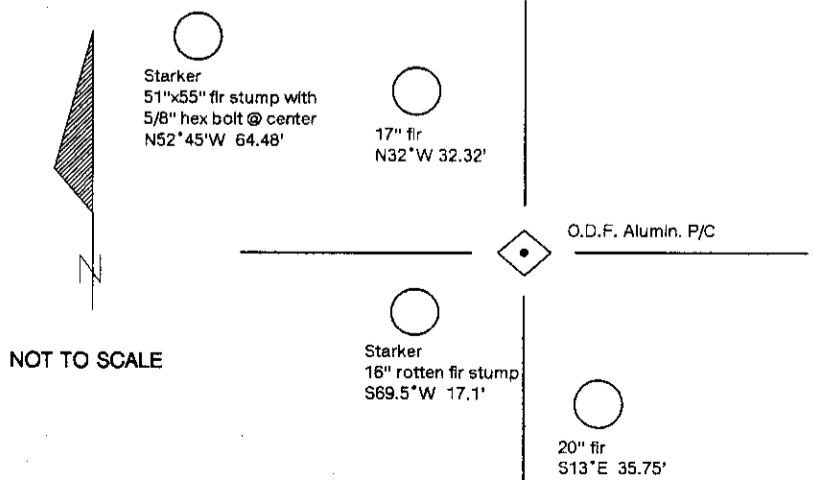

NOT TO SCALE