

**107640200**

**CORNER FILE TRACKING**

S:\Survey Corners\CORNERS\Templates\Filetrac2.doc  
10/04/2010

<b>CORNER NUMBER</b>
<b>107640200</b>

<b>STEP</b>	<b>HISTORY</b>	<b>RESTORATION</b>
Form Prepared, DB	5/15/17	8/30/17
Field Inspection, DB	5/10/17	5/10/17
Finish index (count unit)	5/15/17	5/10/17
Counter Index	5/15/17	5/15/17
GIS Index Form	5/15/17	5/15/17
Checked, DB	8/31/17	8/31/17
Form Edited, DB	8/31/17	8/31/17
Form Signed, DB	9/5/17	9/05/17
Authorize Payment, DB	—	—
Archive Digital Files	9/5/17	9/5/17
Collect Documents	8/31/17	8/31/17
PDF File	9/6/17	9/6/17
Copy For Filming	9/6/17	9/6/17
Scanned (pdf to laserfiche)	9/6/17	9/6/17
Filmed (Archived), DB		
Filed, DB		

(DB) = Entry needed in database (Access).

**COMMENTS:**

DATE 05/15/2017

TOWNSHIP 10 SOUTH, RANGE 7 WEST, WILLAMETTE MERIDIAN; SECTION 25 CORNER SOUTH 1/4  
DONATION LAND CLAIM N/A CORNER N/A

COMMON CORNER(S):  
NORTH 1/4 CORNER SECTION 36

**RECORDS (INFORMATION IN BOLD ITALICS IS COUNTY STAFFS' INTERPRETATION OF THE RECORD)**  
BASED ON EXTENSIVE RESEARCH AND RECOVERY OF EVIDENCE, THIS OFFICE HAS DETERMINED THAT MOST GENERAL LAND OFFICE SURVEYORS IN BENTON COUNTY MEASURED TO THE FACE OF BEARING TREES.

[01] GENERAL LAND OFFICE (GLO) NOTES BY DENNIS HATHORN, D.S., DATED AUGUST 26, 1856. SET POST FROM WHICH A FIR 30" DIA BEARS N79°W, 220 LINKS (145.20 FEET); A FIR 36" DIA BEARS S88°E, 438 LINKS (289.08 FEET).

[02] SURVEY NO. 34 FROM PAGE 42 OF THE RECORD BOOK OF SURVEYS BY ANDREW L. PORTER, C.S., DATED JUNE 27, 1889. SET NEW POST. BEARING TREES IN GOOD ORDER.

[03] REESTABLISHMENT NOTES FROM PAGE 49 OF THE RECORD BOOK OF SURVEYS BY ANDREW L. PORTER, C.S., DATED JULY 20, 1889. SET NEW POST. TREES IN GOOD CONDITION.

[04] BENTON COUNTY CORNER RESTORATION NO. 551. TRANSCRIBED FROM RECORD [03] AND MAY CONTAIN ERRORS AND/OR OMISSIONS.

[05] BENTON COUNTY SURVEY NO. 9158 BY THEODORE JAMES LANGTON, P.L.S., DATED DECEMBER 6, 1996. SET 5/8" X 30" REBAR WITH A RED PLASTIC CAP STAMPED "NORTHSTAR PLS 1823" BY SINGLE PROPORTION. D. FIR 16" DIA BEARS N20°E, 17.5 FEET, SCRIBED "1/4S25" ABOVE "BT"; D. FIR 14" DIA BEARS N81°E, 21.6 FEET, SCRIBED "1/4S25" ABOVE "BT"; D. FIR 15" DIA BEARS S8°E, 8.0 FEET, SCRIBED "1/4S36" ABOVE "BT"; D. FIR 15" DIA BEARS S66°W, 23.2 FEET, SCRIBED "1/4S36" ABOVE "BT".

FIRM/AGENCY: BENTON COUNTY SURVEYOR'S OFFICE  
ADDRESS: 360 S.W. AVERY AVE., CORVALLIS, OR 97333; PH. 541-766-6821  
RESEARCH BY: DAVID L. MALONE, P.L.S.  
DATA ENTRY BY: SAME

**BENTON COUNTY CORNER RESTORATION FORM, PAGE 1 OF 2, 107640200R2  
SEE CORNER HISTORY FORM FOR RECORDS ETC.**

CORNER RESTORATION FIELD BOOK NUMBER 31 PAGE(S) 36 DATE 05/10/2017

TOWNSHIP 10 SOUTH, RANGE 7 WEST, WILLAMETTE MERIDIAN; SECTION 25 CORNER SOUTH 1/4

DONATION LAND CLAIM N/A CORNER N/A

CONDITION REPORT       ; REFERENCED OUT       ; RENEWED X; SURVEYED IN       

**LOCATION AND COMMENTS:**

CORNER IS LOCATED ON A STEEP SOUTH FACING SLOPE ABOUT 50 NORTH OF BOTTOM OF DRAW IN A STAND OF ±40 YEAR OLD D. FIR. TO REACH CORNER FROM THE INTERSECTION OF HOSKINS ROAD AND ALEXANDER ROAD, FOLLOW HOSKINS ROAD WESTERLY FOR 0.93 MILES TO A TIMBER ROAD ON THE LEFT, TURN LEFT AND FOLLOW ROAD FOR 0.68 MILES TO A WYE, STAY RIGHT FOR 0.01 MILES TO A WYE, STAY LEFT FOR 0.22 MILES TO A WYE, STAY RIGHT FOR 0.20 MILES TO A WYE, TURN RIGHT AND FOLLOW SMALL ROAD FOR 0.09 MILES AND PARK. WALK SOUTH FOR ABOUT 100 FEET TO THE CORNER. CORNER IS BAD FOR PREMARKING AND GPS CONTROL.

**MONUMENTS AND ACCESSORIES FOUND (CONDITION AND SOURCE):**

1. FOUND 5/8" IRON ROD WITH RED PLASTIC CAP MARKED "NORTHSTAR PLS 1823", FIRMLY SET AND UNDISTURBED, UP 1" ABOVE GROUND SURFACE FOR THE CORNER.  
(SET POST PER RECORD [01]).  
(SET NEW POST PER RECORDS [02] AND [03]).  
(SET 5/8" X 30" REBAR WITH A RED PLASTIC CAP STAMPED "NORTHSTAR PLS 1823" BY SINGLE PROPORTION PER RECORD [05]).
2. FOUND D. FIR 20" DIA WITH HEALED FACE BEARS S66°00'W, 23.28 FEET TO CENTER. SET ALUMINUM NAIL AND PLASTIC WASHER IN NORTHWESTERLY BASE FOR DISTANCE MEASUREMENT. BASIS OF BEARINGS FOR THIS RESTORATION.  
(D. FIR 15" DIA BEARS S66°W, 23.2 FEET, SCRIBED "1/4S36" ABOVE "BT" PER RECORD [05]).
3. FOUND D. FIR 23" DIA WITH HEALED FACE BEARS N20°45'E, 17.22 FEET TO CENTER. SET ALUMINUM NAIL AND PLASTIC WASHER IN SOUTHEASTERLY BASE FOR DISTANCE MEASUREMENT.  
(D. FIR 16" DIA BEARS N20°E, 17.5 FEET, SCRIBED "1/4S25" ABOVE "BT" PER RECORD [05]).
4. FOUND D. FIR SNAG 21" DIA WITH HEALED FACE BEARS N81°24'E, 21.61 FEET TO CENTER. SET ALUMINUM NAIL AND PLASTIC WASHER IN SOUTHERLY BASE FOR DISTANCE MEASUREMENT.  
(D. FIR 14" DIA BEARS N81°E, 21.6 FEET, SCRIBED "1/4S25" ABOVE "BT" PER RECORD [05]).
5. FOUND D. FIR 20" DIA WITH HEALED FACE BEARS S3°59'E, 8.06 FEET TO CENTER. SET ALUMINUM NAIL AND PLASTIC WASHER IN WESTERLY BASE FOR DISTANCE MEASUREMENT.  
(D. FIR 15" DIA BEARS S8°E, 8.0 FEET, SCRIBED "1/4S36" ABOVE "BT" PER RECORD [05]).

**MONUMENT SET (PROCEDURES AND DESCRIPTION):**

FOUND 5/8" IRON ROD WITH RED PLASTIC CAP MARKED "NORTHSTAR PLS 1823", FIRMLY SET AND UNDISTURBED, UP 1" ABOVE GROUND SURFACE FOR THE CORNER. THE 5/8" IRON ROD WAS SET BY PROPORTION BY THEODORE JAMES LANGTON, P.L.S., IN 1996. NO ORIGINAL GENERAL LAND OFFICE (GLO) EVIDENCE WAS FOUND. LANGTON USED PROPER PROCEDURE BY ESTABLISHING THE CORNER POSITION USING PROPORTION. THE 5/8" IRON ROD IS ACCEPTED AS THE CORNER POSITION.

DROVE IRON ROD SEVERAL INCHES DOWN AND OVER IT IN THE SAME HORIZONTAL POSITION SET 2" X 31-1/2" GALVANIZED IRON PIPE WITH 3-1/4" BRASS DISK CEMENTED IN TOP, UP 1" ABOVE GROUND SURFACE AND MARKED AS SHOWN ON PAGE 2 OF 2. SET TWO NEW IRON ROD ACCESSORIES AS SHOWN ON PAGE 2 OF 2. FOUND WHITE FIBERGLASS POST 4" NORTHWEST OF IRON ROD. RESET WHITE FIBERGLASS POST 1 FOOT WEST OF BRASS DISK. SET 6 FOOT ORANGE CARSONITE "SURVEY MARKER" POST 1 FOOT NORTH OF BRASS DISK.

**±40 YEAR OLD D. FIR**

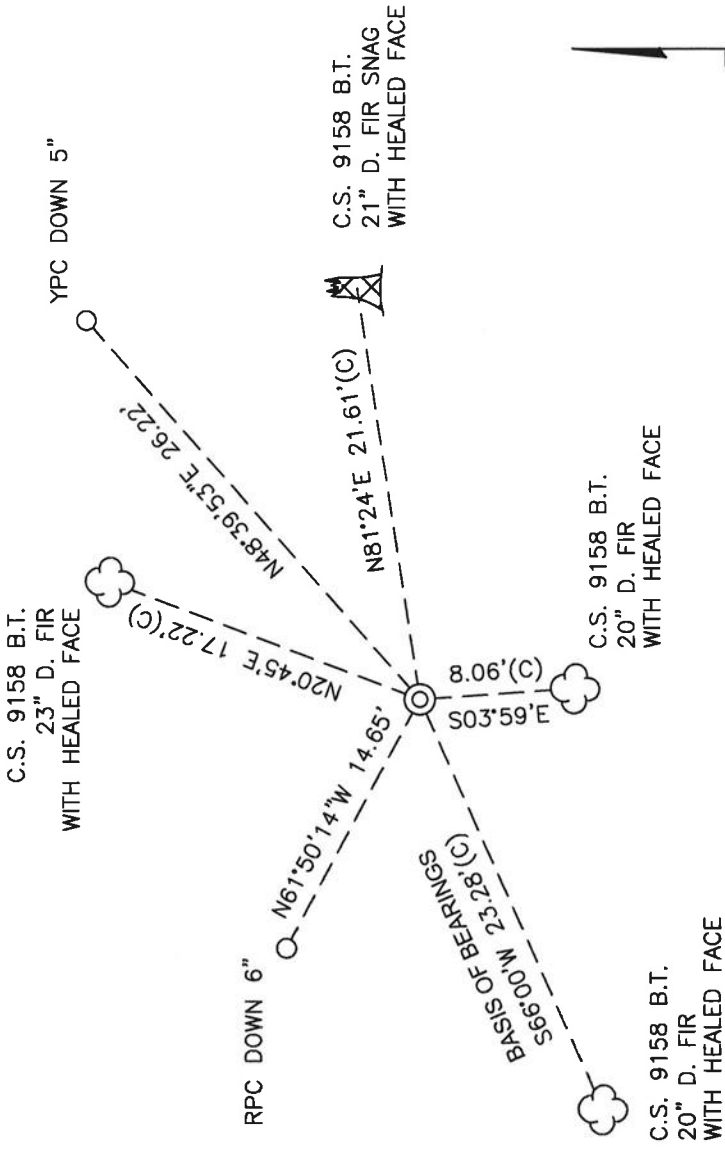

**±40 YEAR OLD D. FIR**

1" = 10'  
BASIS OF BEARINGS  
C.S. 9158

MONUMENT DETAIL

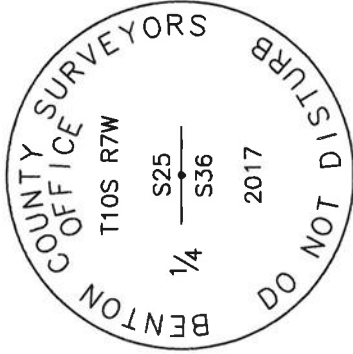

3-1/4" BRASS DISK

LEGEND

- SET 5/8" X 30" REBAR WITH PLASTIC CAP
- YPC
- RPC
- (C) MEASUREMENT TO CENTER
- ⊙ GOVERNMENT MONUMENT SET AS SHOWN
- C.S. COUNTY SURVEY
- B.T. BEARING TREE
- ☁ BEARING TREE AS NOTED
- ⚡ BEARING TREE SNAG AS NOTED

**NEW ACCESSORIES:**

1. SET REBAR (SEE LEGEND) N48°39'53"E, 26.22 FEET AND 5 INCHES BELOW GROUND LEVEL.
2. SET REBAR (SEE LEGEND) N61°50'14"W, 14.65 FEET AND 6 INCHES BELOW GROUND LEVEL.

**NOTES:**

COMPASS DECLINATION IS 16" EAST. ALL MEASURED DISTANCES AND BEARINGS ARE TO THE CENTER OF THE OBJECT, UNLESS OTHERWISE NOTED. ALL BEARING TREES ARE PAINTED AND HAVE A B.T. TAG ATTACHED, FACING THE CORNER UNLESS OTHERWISE NOTED. ALL NEW BEARING TREES HAVE A PLASTIC WASHER (STAMPED "SURVEY MARKER DO NOT REMOVE") ATTACHED BY AN ALUMINUM NAIL TO THE SIDE CENTER OF THE TREE FOR DISTANCE MEASUREMENT, UNLESS OTHERWISE NOTED.

THIS RESTORATION WAS PERFORMED AT THE DIRECTION AND APPROVAL OF  
THE BENTON COUNTY SURVEYOR *[Signature]*

REGISTERED  
PROFESSIONAL  
LAND SURVEYOR

*[Signature]*

OREGON  
JANUARY 12, 1999  
DAVID L. MALONE  
51523

FIRM/AGENCY: BENTON COUNTY SURVEYOR'S OFFICE  
ADDRESS: 360 S.W. AVERY AVE., CORVALLIS, OR 97333; PH. 541-766-6821  
PRESENT: DAVID L. MALONE, P.L.S. AND BERNARD ALTENBACH, SURVEY TECH.  
EQUIPMENT: NIKON NIVO3.C WITH SURVEY PRO ONBOARD.

RENEWAL DATE: 12/31/18

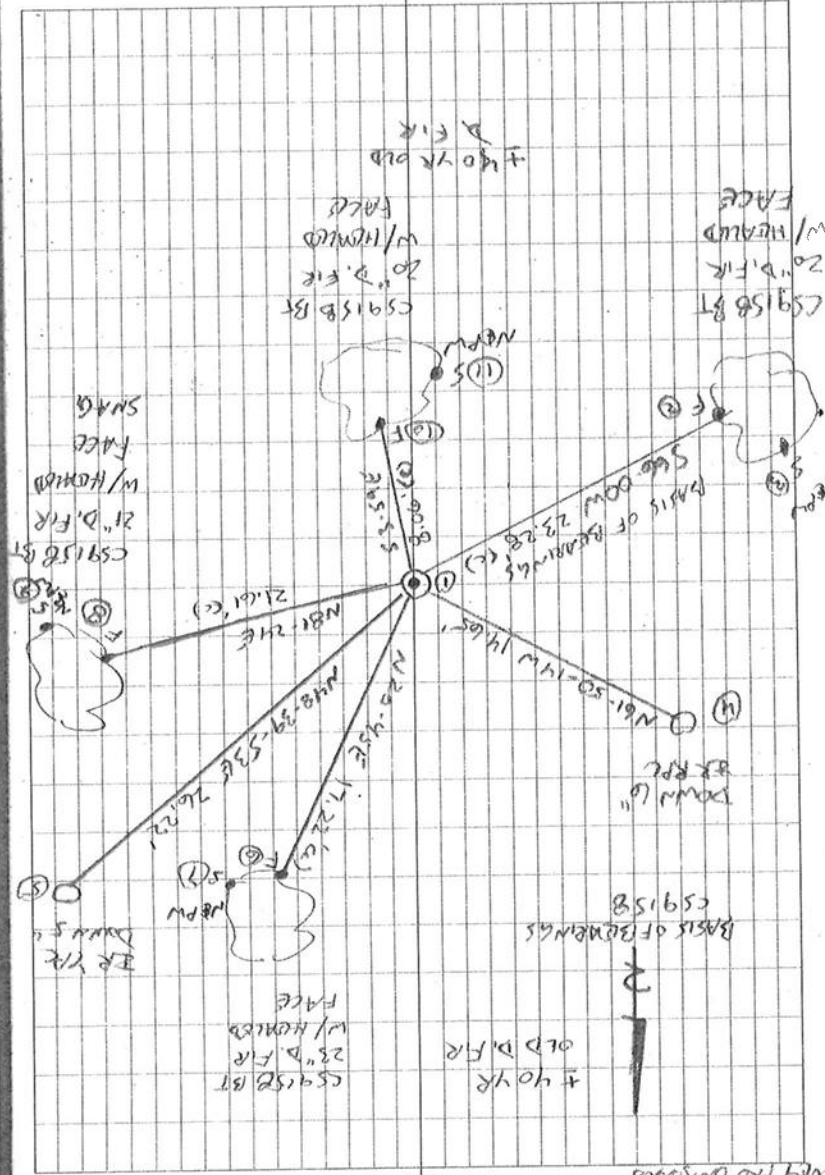

WASH. CLARK  
5/10/77  
D. M. MOORE  
B. ARTHUR BACH  
NIPON NV03.C  
SURVEY PRO OVERSEER

3/1/76

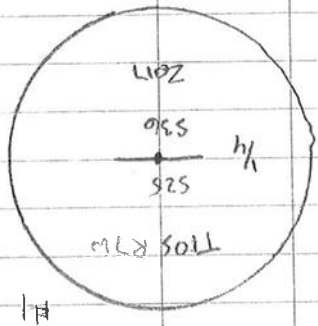

5/8" DEON ROD W/ ROD PLASTIC CAP MARKED  
"NORTHSTAR PLS 1023", FINELY SET & UNDISTURBED,  
UP 1" ABOVE GROUND SURFACE, ACCEPTED AS THE  
PROPERLY POSITIONED POINT FOR CS 9158.  
TO WHITE FINGERGLASS POST 4" NW OF DEON ROD.  
PD 4 B.T.S PER CS 9158. HILD SW BT FOR BASIS  
AND OVER IT IN SAME HORIZONTAL POSITION SET  
2" x 31-1/2" C.I.P. W/ 3-1/4" BRASS DISK, REMOUNTED  
IN TOP UP 1" ABOVE GROUND SURFACE, SET TO  
NEW IRON ROD ACCESSORIES, SET TO ORANGE CAPMOUNT  
"SURVEY MARKER" POST 1' NORTH OF BRASS DISK, RE SET  
WHITE FINGERGLASS POST 1' WEST OF BRASS DISK,  
#1

107640200  
REMOVEMENT T105 R7W 1/4 536  
525

BR = 5/8" x 30" DEON ROD  
YR OR PCE = YELLOW OR RED  
PLASTIC CAP MARKED  
"RESUME CUM SURVEY"  
N&PW = NAIL & PLASTIC  
WAS HERE MARKED "SURVEY"  
MARKER DO NOT REMOVE"  
3-1/4" BRASS DISK

BENTON COUNTY SURVEYORS OFFICE - CORNER RESTORATION

T 10 S, R 7 W, W. B. & M., BENTON COUNTY, OREGON

REPORTED BY A. L. Porter

SECTION 25

TITLE Benton Co. Surveyor

DATE July 1889

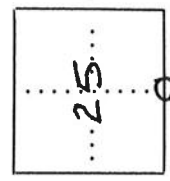

● OFFICIAL CORNER FOUND

○ CORNER SET

1/4 CORNER COMMON TO SEC. 25, 36 &           
IS Post

DESCRIBE

ADDITIONAL INFORMATION

" Set New Post trees in good Order "

Surveys of A. L. Porter, pg. 49

\_\_\_\_\_

\_\_\_\_\_

\_\_\_\_\_

\_\_\_\_\_

\_\_\_\_\_

\_\_\_\_\_

LEGIBLE MARKS ON BEARING OBJECTS

KIND	SIZE	BEARING	DISTANCE	BT TAG POSTED

OVER