

115100400

CORNER FILE TRACKING

S:\Survey Corners\CORNERS\Templates\Filetrac2.doc
10/04/2010

CORNER NUMBER
115100400

STEP	HISTORY	RESTORATION
Form Prepared, DB	01/16/15	02/12/16
Field Inspection, DB	02/03/16	02/03/16
Finish index (count unit)	01/16/15	02/03/16
Counter Index	02/03/16	02/03/16
GIS Index Form	02/12/16	02/12/16
Checked, DB	2/18/16	2/18/16
Form Edited, DB	3/07/16	3/07/16
Form Signed, DB	3/07/16	3/07/16
Authorize Payment, DB	—	—
Archive Digital Files	3/07/16	3/07/16
Collect Documents	3/07/16	3/07/16
PDF File	3/07/16	3/07/16
Copy For Filming	3/07/16	3/07/16
Scanned (pdf to laserfiche)	3/07/16	3/07/16
Filmed (Archived), DB	3/07/16	3/07/16
Filed, DB		

(DB) = Entry needed in database (Access).

COMMENTS:

DATE 01/16/2015TOWNSHIP 11 SOUTH, RANGE 5 WEST, WILLAMETTE MERIDIAN; SECTION 18 CORNER SOUTHWEST
DONATION LAND CLAIM N/A CORNER N/A**COMMON CORNER(S):**

NORTHWEST CORNER SECTION 19, TOWNSHIP 11 SOUTH, RANGE 5 WEST
SOUTHEAST CORNER SECTION 13, TOWNSHIP 11 SOUTH, RANGE 6 WEST
NORTHEAST CORNER SECTION 24, TOWNSHIP 11 SOUTH, RANGE 6 WEST

RECORDS (INFORMATION IN BOLD ITALICS IS COUNTY STAFFS' INTERPRETATION OF THE RECORD)

BASED ON EXTENSIVE RESEARCH AND RECOVERY OF EVIDENCE, THIS OFFICE HAS DETERMINED THAT MOST GENERAL LAND OFFICE SURVEYORS IN BENTON COUNTY MEASURED TO THE FACE OF BEARING TREES.

- [01] GENERAL LAND OFFICE (GLO) NOTES BY G. W. HYDE, D.S., DATED MAY 25, 1852. SET POST FROM WHICH A CHERRY 6" DIA BEARS S50°W, 11 LINKS (7.26 FEET); A MAPLE 4" DIA BEARS N43°W, 30 LINKS (19.80 FEET); A MAPLE 10" DIA BEARS N24°E, 30 LINKS (19.80 FEET); A CHERRY 4" DIA BEARS S50°E, 10 LINKS (6.60 FEET).
- [02] BENTON COUNTY SURVEY NO. 846 (OLD NO. 314) FIELD NOTES (FIELD BOOK 32, PAGE 29) BY WALTER W. LARSEN, D.C.S., DATED FEBRUARY, 1923. SET WAGON SPINDLE. MAPLE 12" DIA BEARS N11°30'E, 0.33 CHAINS (21.78 FEET); MAPLE 10" DIA BEARS N47°W, 0.29 CHAINS (19.14 FEET); FIR 8" DIA BEARS N83°W, 0.064 CHAINS (4.22 FEET). FOUND MARKS ON MAPLE NORTHWEST.
- [03] BENTON COUNTY SURVEY NO. 851 (OLD NO. 314) LOOSE LEAF NOTES BY WALTER W. LARSEN, D.C.S., DATED FEBRUARY, 1923. CORNER IS WAGON AXLE. MAPLE 12" DIA BEARS N11°30'E, 0.33 CHAINS (21.78 FEET); MAPLE 10" DIA BEARS N47°W, 0.29 CHAINS (19.14 FEET); FIR 8" DIA BEARS N83°W, 0.064 CHAINS (4.22 FEET).
- [04] BENTON COUNTY CORNER RESTORATION BOOK NO. 1, PAGE 166, BY WALTER W. LARSEN, D.C.S., DATED FEBRUARY, 1923. SET WAGON SPINDLE. FOUND ORIGINAL MAPLE NORTHWEST MARKED. MAPLE 12" DIA (CSBT) BEARS N11-1/2°E, 0.33 CHAINS (21.78 FEET); MAPLE 10" DIA (CSBT) BEARS N47°W, 0.29 CHAINS (19.14 FEET); FIR 8" DIA (CSBT) BEARS N83°W, 0.064 CHAINS (4.22 FEET).
- [05] BENTON COUNTY CORNER RESTORATION NO. 717. TRANSCRIBED FROM RECORD [04] AND MAY CONTAIN ERRORS AND/OR OMISSIONS.
- [06] BENTON COUNTY SURVEY NO. 846 (OLD NO. 314) MAP BY UNKNOWN DRAFTSMAN, NO DATE GIVEN. WAGON SPINDLE. MAPLE 12" DIA (CSBT) BEARS N11-1/2°E, 0.33 CHAINS (21.78 FEET); MAPLE 10" DIA (CSBT) BEARS N47°W, 0.29 CHAINS (19.14 FEET); FIR 8" DIA (CSBT) BEARS N83°W, 0.064 CHAINS (4.22 FEET).
- [07] BENTON COUNTY MAP NO. 11-6-00011 BY UNKNOWN DRAFTSMAN, DATED MARCH, 1923. WAGON SPINDLE. MAPLE 12" DIA (CSBT) BEARS N11-1/2°E, 0.33 CHAINS (21.78 FEET); MAPLE 10" DIA (CSBT) BEARS N47°W, 0.29 CHAINS (19.14 FEET); FIR 8" DIA (CSBT) BEARS N83°W, 0.064 CHAINS (4.22 FEET).
- [08] BENTON COUNTY SURVEY NO. 1187 (OLD NO. 255) FIELD NOTES (FIELD BOOK 54, PAGE 22) BY WALTER W. LARSEN, D.C.S., DATED JULY, 1932. CORNER NOT DESCRIBED.
- [09] BENTON COUNTY SURVEY NO. 242 (OLD NO. 314) FIELD NOTES (FIELD BOOK 32, PAGE 35) BY W. C. GALLOWAY, C.S., DATED AUGUST, 1942. FOUND WAGON SPINDLE AND TREES STANDING.
- [10] BENTON COUNTY SURVEY NO. 8420 BY THEODORE JAMES LANGTON, P.L.S., DATED APRIL 1, 1990. FOUND 2" WAGON SPINDLE 100 FEET WEST OF ALDER CREEK. D. FIR 30" DIA (CSBT) BEARS N83°W, 4.2 FEET, HEALED; MAPLE 24" DIA (CSBT) BEARS N11°30'E, 21.8 FEET, HEALED; MAPLE 20" DIA (CSBT) BEARS N47°W, 19.1 FEET, HEALED.
- [11] BENTON COUNTY CORNER RESTORATION NO. 3790 BY DANNA L. FEHRENBACHER, C.S., DATED AUGUST 1, 1990. FOUND 4" INSIDE DIAMETER X 16" LONG IRON WAGON SPINDLE FOR THE CORNER. FOUND A FIR STUMP 33" DIA (CSBT) WITH A HEALED FACE BEARS N80°W, 4.2 FEET. FOUND A MAPLE 18" DIA (CSBT) WITH A HEALED FACE BEARS N47°W, 19.51 FEET. SET A PK NAIL AND BENTON COUNTY BRASS WASHER STAMPED "BENTON COUNTY SURVEYOR" (BCBW) IN THE NORTHEASTERLY BASE. FOUND A MAPLE 25" DIA (CSBT) WITH A HEALED FACE BEARS N21°E, 22.01 FEET. SET A PK NAIL AND BCBW IN THE WESTERLY BASE. SET A 2" INSIDE DIAMETER X 36" LONG IRON PIPE WITH A 3-1/4" BRASS CAP STAMPED "BENTON COUNTY SURVEYOR T11S R6W R5W S13 S18 S24 S19 1990 DO NOT DISTURB" IN THE SAME POSITION AS THE RECOVERED WAGON SPINDLE. BURIED THE WAGON SPINDLE HORIZONTALLY ALONG THE EASTERLY SIDE OF THE NEW MONUMENT. MAPLE 15" DIA BEARS S37°E, 27.40 FEET, FACED AND SCRIBED "T11S R5W S19 BT". SET A PK NAIL AND BCBW IN THE SOUTHWESTERLY BASE. MAPLE 11" DIA BEARS S61°W, 66.78 FEET, FACED AND SCRIBED "T11S R6W S24 BT". SET A PK NAIL AND BCBW IN THE SOUTHEASTERLY BASE. SET ORANGE FIBERGLASS "SURVEY MARKER" POST 1 FOOT EASTERLY.
- [12] BENTON COUNTY SURVEY NO. 8699 BY CURTIS J. LIESENFELT, P.L.S., DATED MARCH 22, 1993. THIS SURVEY WAS DRAFTED AND A LETTER WRITTEN TO ILLUSTRATE MEASUREMENT ERRORS IN C.S. 846 AND C.S. 851, AND POSSIBLE INCORRECT LOCATIONS OF THE EAST AND NORTH QUARTER CORNERS OF SECTION 24, TOWNSHIP 11 SOUTH, RANGE 6 WEST. NO SURVEYING WAS PERFORMED. THE LOCATION OF THE SOUTHWEST CORNER OF SECTION 18, TOWNSHIP 11 SOUTH, RANGE 5 WEST WAS AFFIRMED.

FIRM/AGENCY: BENTON COUNTY SURVEYOR'S OFFICE**ADDRESS:** 360 S.W. AVERY AVE., CORVALLIS, OR 97333; PH. 541-766-6821**RESEARCH BY:** DAVID L. MALONE, P.L.S.**DATA ENTRY BY:** SAME

**BENTON COUNTY CORNER RESTORATION FORM, PAGE 1 OF 2, 115100400R3
SEE CORNER HISTORY FORM FOR RECORDS ETC.**

CORNER RESTORATION FIELD BOOK NUMBER 30 PAGE(S) 66

DATE 02/03/2016

TOWNSHIP 11 SOUTH, RANGE 5 WEST, WILLAMETTE MERIDIAN; SECTION 18 CORNER SOUTHWEST

DONATION LAND CLAIM N/A CORNER N/A

CONDITION REPORT ; REFERENCED OUT X; RENEWED ; SURVEYED IN ;

LOCATION AND COMMENTS:

CORNER IS LOCATED ON A STEEP EAST FACING SLOPE ABOUT 100 FEET WEST OF ALDER CREEK IN AN AREA OF MIXED HARDWOODS, SCATTERED FIRS AND BRUSH, WITH A ± 20 YEAR OLD D. FIR REPROD. STAND TO THE WEST. TO REACH CORNER FROM THE INTERSECTION OF SKILLINGS DRIVE AND OAK CREEK DRIVE, FOLLOW SKILLINGS DRIVE FOR 1.25 MILES, HAVING PASSED THROUGH A STARKER FORESTS GATE, TO AN EAST-WEST FENCE. PARK AND WALK WEST ABOUT 300 FEET CROSSING ALDER CREEK TO THE CORNER. CORNER IS BAD FOR PREMARKING AND POOR FOR GPS CONTROL.

MONUMENTS AND ACCESSORIES FOUND (CONDITION AND SOURCE):

1. FOUND 3-1/4" BRASS DISK IN A 2" IRON PIPE, UP 2" ABOVE GROUND SURFACE, FIRMLY SET AND UNDISTURBED FOR THE CORNER.
(SET POST AS PER RECORD [01]).
(SET WAGON SPINDLE AS PER RECORDS [02] AND [04]).
(CORNER IS WAGON AXLE AS PER RECORD [03]).
(WAGON SPINDLE AS PER RECORDS [06], [07] AND [09]).
(FOUND 2" WAGON SPINDLE AS PER RECORD [10]).
(FOUND 4" INSIDE DIAMETER X 16" LONG IRON WAGON SPINDLE FOR THE CORNER. SET A 2" INSIDE DIAMETER X 36" LONG IRON PIPE WITH A 3-1/4" BRASS CAP STAMPED "BENTON COUNTY SURVEYOR T11S R6W R5W S13 S18 S24 S19 1990 DO NOT DISTURB" IN THE SAME POSITION AS THE RECOVERED WAGON SPINDLE AS PER RECORD [11]).
2. FOUND MAPLE 22" DIA BEARS S37°00'E, 27.69 FEET TO CENTER WITH VISIBLE SCRIBING "T11S R". SET ALUMINUM NAIL AND PLASTIC WASHER IN NORTHEASTERLY BASE FOR DISTANCE MEASUREMENT. BASIS OF BEARINGS FOR THIS RESTORATION.
(MAPLE 15" DIA BEARS S37°E, 27.40 FEET, FACED AND SCRIBED "T11S R5W S19 BT" AS PER RECORD [11]).
3. FOUND MAPLE 28" DIA BEARS N25°54'E, 22.52 FEET TO CENTER, WITH HEALED FACE ON THE MIDDLE TRUNK OF 4 TRUNKS. SET ALUMINUM NAIL AND PLASTIC WASHER IN NORTHWESTERLY BASE FOR DISTANCE MEASUREMENT.
(MAPLE 12" DIA BEARS N11°30'E, 0.33 CHAINS [21.78 FEET] PER RECORDS [02]-[03]).
(MAPLE 12" DIA BEARS N11-1/2°E, 0.33 CHAINS [21.78 FEET] PER RECORDS [04], [06], AND [07]).
(MAPLE 24" DIA BEARS N11°30'E, 21.8 FEET, HEALED PER RECORD [10]).
(FOUND MAPLE 25" DIA WITH A HEALED FACE BEARS N21°E, 22.01 FEET PER RECORD [11]).
4. FOUND ROTTEN REMAINS OF MAPLE STUMP 17" DIA BEARS S62°27'W, 66.66 FEET TO CENTER. REMAINS OF TREE ON GROUND WITH BEARING TREE TAG ATTACHED.
(MAPLE 11" DIA BEARS S61°W, 66.78 FEET, FACED AND SCRIBED "T11S R6W S24 BT" AS PER RECORD [11]).
5. FOUND 6 FOOT TALL ROTTEN D. FIR STUMP 22" DIA BEARS N81°25'W, 4.41 FEET TO CENTER WITH POSSIBLE HEALED FACE.
(FIR 8" DIA BEARS N83°W, 0.064 CHAINS [4.22 FEET] AS PER RECORDS [02]-[04], [06] AND [07]).
(D. FIR 30" DIA BEARS N83°W, 4.2 FEET, HEALED AS PER RECORD [10]).
(FOUND FIR STUMP 33" DIA WITH A HEALED FACE BEARS N80°W, 4.2 FEET AS PER RECORD [11]).
6. FOUND ROTTEN MAPLE STUMP 20" DIA BEARS N48°33'W, 18.87 FEET TO CENTER, WITH HEALED FACE AND NEW TRUNKS GROWING OUT OF STUMP.
(MAPLE 10" DIA BEARS N47°W, 0.29 CHAINS [19.14 FEET] PER RECORDS [02]-[04], [06] AND [07]).
(MAPLE 20" DIA BEARS N47°W, 19.1 FEET, HEALED PER RECORD [10]).
(FOUND MAPLE 18" DIA WITH A HEALED FACE BEARS N47°W, 19.51 FEET PER RECORD [11]).

MONUMENT SET (PROCEDURES AND DESCRIPTION):

FOUND 3-1/4" BRASS DISK MARKED AS SHOWN ON PAGE 2 OF 2, IN A 2" IRON PIPE, UP 2" ABOVE GROUND SURFACE, FIRMLY SET AND UNDISTURBED FOR THE CORNER. THE IRON PIPE AND BRASS DISK WERE SET BY DANNA L. FEHRENBACHER, C.S., IN 1990 IN THE SAME POSITION AS A WAGON SPINDLE SET BY WALTER W. LARSEN, D.C.S., IN 1923 FROM A GLO BEARING TREE. THE BEARING TREES MARKED IN 1923 ARE STILL IN EXISTENCE AND THE BRASS CAP IS WITHIN EXPECTED TOLERANCE OF THOSE BEARING TREES. THE NORTHWEST AND NORTHEAST MAPLES MAY BE REGROWTH FROM THE ORIGINAL GLO BEARING TREES. I ACCEPTED THE BRASS DISK AS THE PERPETUATION OF THE CORNER POSITION.

SET TWO NEW IRON ROD ACCESSORIES AS SHOWN ON PAGE 2 OF 2. FOUND ORANGE CARSONITE "SURVEY MARKER" POST 1 FOOT EAST OF MONUMENT.

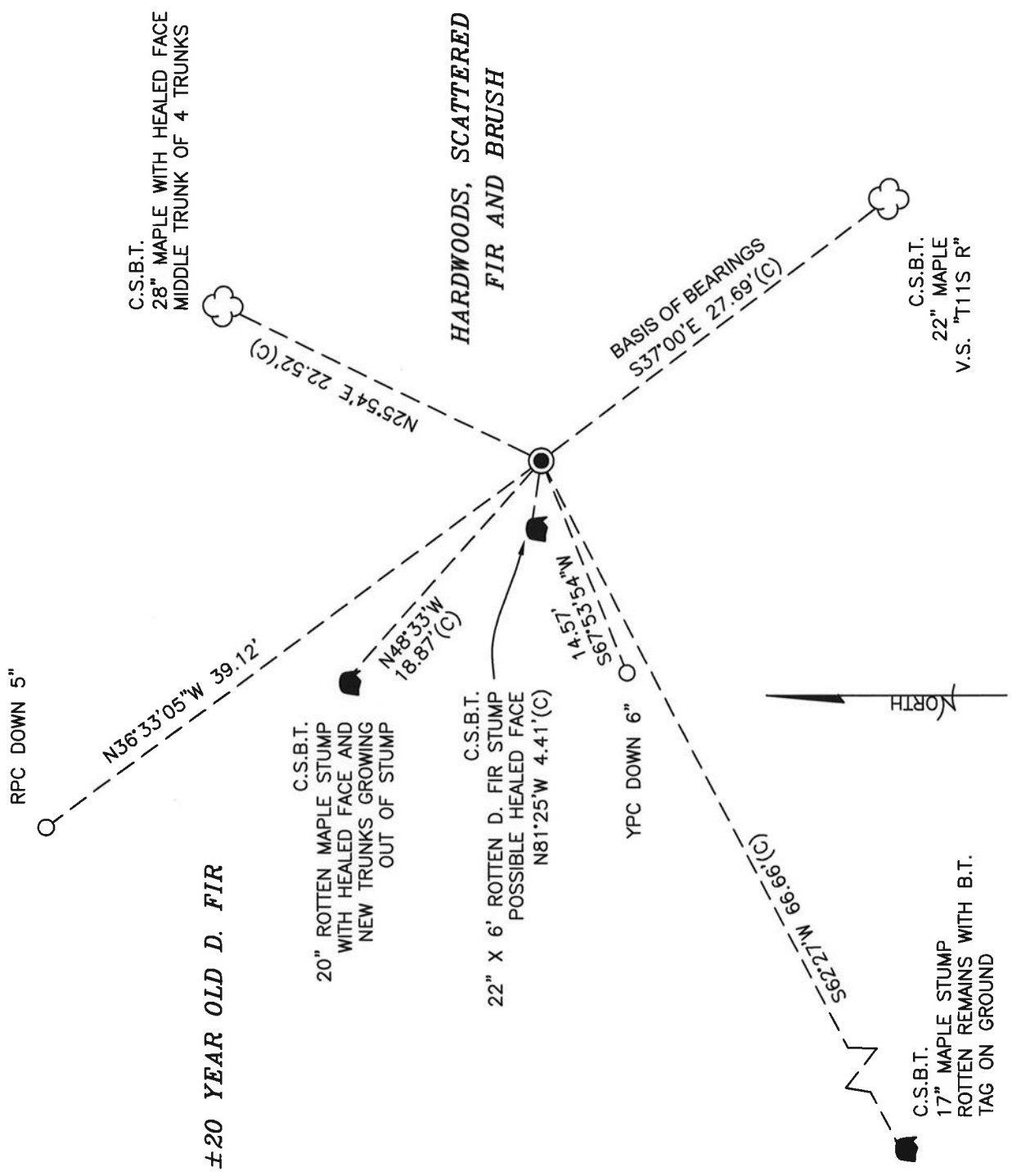

±20 YEAR OLD D. FIR

MONUMENT DETAIL

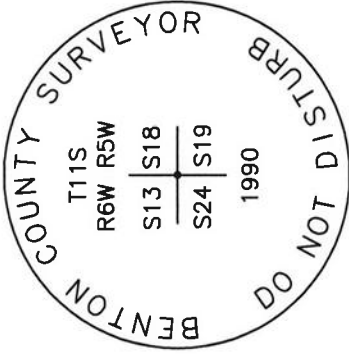

3-1/4" BRASS DISK

NEW ACCESSORIES:

1. SET REBAR (SEE LEGEND) S67°53'54"W, 14.57 FEET AND 6 INCHES BELOW GROUND LEVEL.
2. SET REBAR (SEE LEGEND) N36°33'05"W, 39.12 FEET AND 5 INCHES BELOW GROUND LEVEL.

NOTES:

COMPASS DECLINATION IS 16° EAST. ALL MEASURED DISTANCES AND BEARINGS ARE TO THE CENTER OF THE OBJECT, UNLESS OTHERWISE NOTED. ALL BEARING TREES ARE PAINTED AND HAVE A B.T. TAG ATTACHED, FACING THE CORNER UNLESS OTHERWISE NOTED. ALL NEW BEARING TREES HAVE A PLASTIC WASHER (STAMPED "SURVEY MARKER DO NOT REMOVE") ATTACHED BY AN ALUMINUM NAIL TO THE SIDE CENTER OF THE TREE FOR DISTANCE MEASUREMENT, UNLESS OTHERWISE NOTED.

THIS RESTORATION WAS PERFORMED AT THE DIRECTION AND APPROVAL OF
THE BENTON COUNTY SURVEYOR *gjm*

REGISTERED
PROFESSIONAL
LAND SURVEYOR

01/12/16 David L. Malone

OREGON
JANUARY 12, 1999
DAVID L. MALONE
51523

FIRM/AGENCY: BENTON COUNTY SURVEYOR'S OFFICE
ADDRESS: 360 S.W. AVERY AVE., CORVALLIS, OR 97333; PH. 541-766-6821
PRESENT: DAVID L. MALONE, P.L.S. AND BERNARD ALTENBACH, SURVEY TECH.
EQUIPMENT: NIKON NIV03.C WITH SURVEY PRO ONBOARD.

RENEWAL DATE: 12/31/16

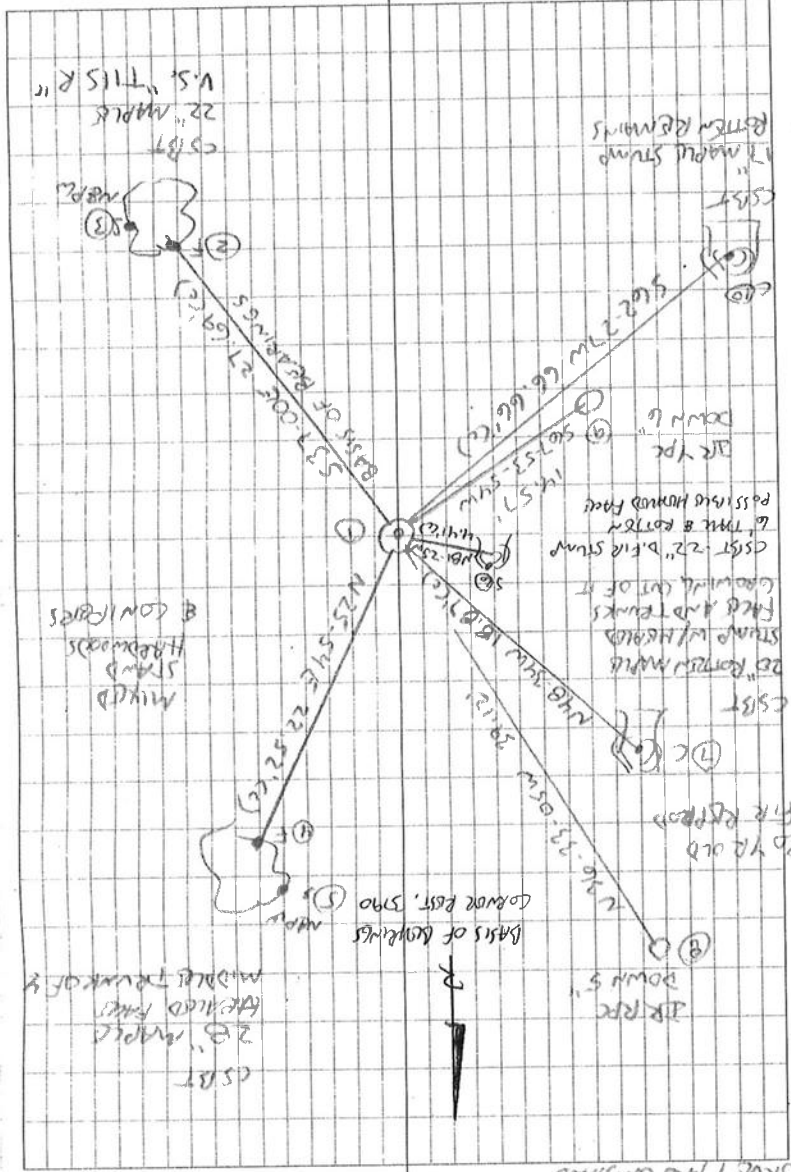

30/6

2/03/2016
D. MASON
B. ALLENBACH
SURVEY PRO ON GRID
NIKON M103C
SURVEY PRO ON GRID



3-1/4" BRASS DISK

FD 3-1/4" BRASS DISK IN 2" I.P. UP 2" ABOVE
GROUND SURFACE. FINELY SET & UNDISTURBED
FOR THE COVER. FD 2 RTS FROM COVER
RESTORATION 1990. HEDS SET FOR BASIS
OF SURVEYS. BUT RT WAS RETURN STUMP
W/ REMAINS OF TRAIL ON GROUND. FD 2
CSST STUMPS AND NE RT FD ORANGE
CAR MARK "SURVEY MARKER" POST 1' EAST
OF MONUMENT. SET 2 NEW R/W PDS
ACCROSS,

115100400
R/W 13/18 RSW
24/19
REFERENCE THIS

IR = 5/8" x 30" BRASS PDS
YPC = YELLOW PLASTIC CAP MARKED
"ABOVE COUNTRY SURVEYOR"
RPC = RED PLASTIC CAP MARKED
"ABOVE CO. CONTROL PT."
N&P W = NAIL & PLASTIC WASHER
MARKED "SURVEY MARKER"
DO NOT REMOVE
DO NOT REMOVE

BENTON COUNTY CORNER RESTORATION FORM 115100400 3790
SECTION 18 TOWNSHIP 11 S RANGE 5 W DLC _____ CORNER SW
DATE 8/1/1990 CORNER RESTORATION FIELD BOOK NUMBER 8 PAGE 14

CORNER DESIGNATION:

THE CORNER COMMON TO SECTIONS 18 AND 19 IN T 11 S S 13 S 18 _____ CONDITION REPORT ONLY
R 5 W, AND 13 AND 24 IN T 11 S, R 6 W, S 24 S 19 _____ REFERENCED OUT
WILLAMETTE MERIDIAN. _____ XX _____ RENEWED
LOCATION AND COMMENTS: _____ SURVEYED IN _____

THE CORNER IS LOCATED ON AN EASTERLY SLOPE AT THE EASTERLY EDGE OF A CLEARCUT, APPROXIMATELY 100 FEET WESTERLY OF ALDER CREEK AND APPROXIMATELY 250 FEET WESTERLY OF THE SECOND GATE ON STARKER ROAD NO. 1000.

PREVIOUS RENEWALS/SURVEYS, ETC.:

ORIGINAL GLO SURVEY BY GEORGE W. HYDE IN 1852.
CORNER RESTORATION NO. 717 BY W.C. GALLOWAY IN FEBRUARY OF 1923.
COUNTY SURVEY NO. 8420 BY TED LANGTON ON APRIL 1, 1990.

MONUMENTS AND ACCESSORIES FOUND (CONDITION AND SOURCE):

FOUND: 4" INSIDE DIAMETER X 16" LONG IRON WAGON SPINDLE FOR THE CORNER (CORNER RESTORATION NO. 717).
FOUND: A FIR STUMP 33" IN DIAMETER WITH A HEALED FACE BEARS N 80° W 4.2 FEET (N 83° W 4.22 FEET CORNER RESTORATION NO. 717). FOUND A B.T. TAG ON THE EASTERLY FACE. SET A NEW TAG BELOW IT.
FOUND: A MAPLE 18" IN DIAMETER WITH A HEALED FACE BEARS N 47° W 19.51 FEET (N 47° W 19.14 FEET CORNER RESTORATION NO. 717). SET A P.K. NAIL AND B.C.B.W. IN THE NORTHEASTERLY BASE. SET A B.T. TAG ON THE SOUTHEASTERLY FACE.
FOUND: A MAPLE 25" IN DIAMETER WITH A HEALED FACE BEARS N 21° E 22.01 FEET (N 11° 30' E 21.78 FEET CORNER RESTORATION NO. 717). SET A P.K. NAIL AND B.C.B.W. IN THE WESTERLY BASE. FOUND A B.T. TAG ON THE SOUTHERLY FACE. SET A NEW TAG ABOVE IT.

NO OTHER RECORD BEARING OBJECTS WERE RECOVERED.

MONUMENT DETAIL

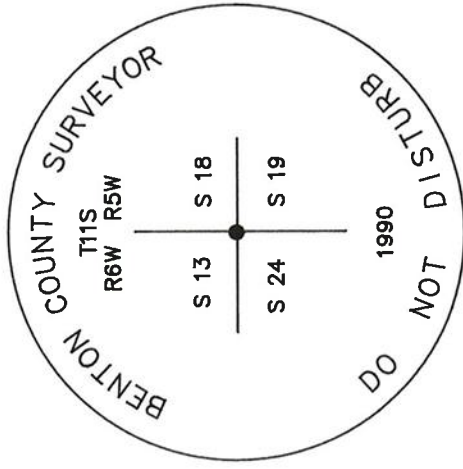

3 1/4" BRASS CAP

SKETCH

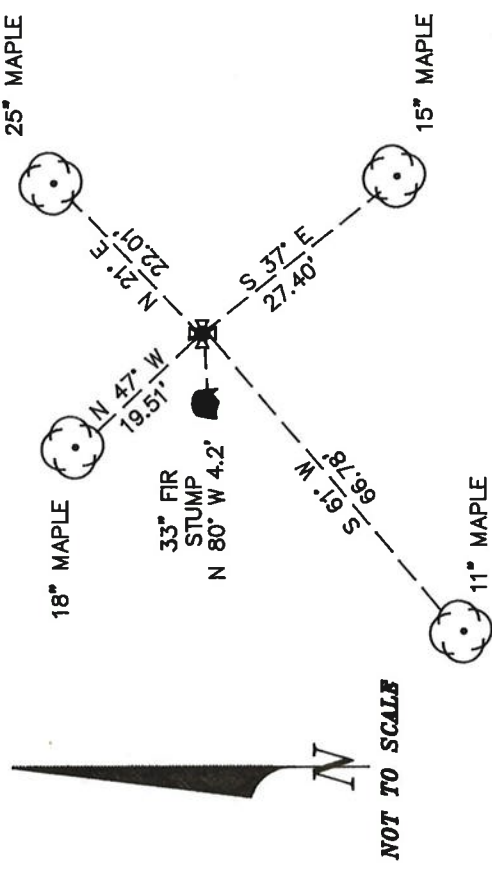

NOT TO SCALE

MONUMENT SET (PROCEDURES AND DESCRIPTION):

SET: 2" INSIDE DIAMETER X 36" LONG IRON PIPE WITH A 3 1/4" BENTON COUNTY BRASS CAP STAMPED AS SHOWN IN THE SAME POSITION AS THE RECOVERED WAGON SPINDLE, BURIED THE WAGON SPINDLE HORIZONTALLY ALONG THE EASTERLY SIDE OF THE NEW MONUMENT.

NEW ACCESSORIES:

A MAPLE 15" IN DIAMETER BEARS S 37° E 27.40 FEET, FACED AND SCRIBED "T11S R5W S19 BT". SET A P.K. NAIL AND B.C.B.W. IN THE SOUTHWESTERLY BASE. SET A B.T. TAG ON THE NORTHWESTERLY FACE.

A MAPLE 11" IN DIAMETER BEARS S 61° W 66.78 FEET FACED AND SCRIBED "T11S R6W S24 BT". SET A PK NAIL AND B.C.B.W. IN THE SOUTHEASTERLY BASE. SET A BT TAG ON THE NORTHEASTERLY FACE.

SET: ORANGE FIBERGLASS "SURVEY MARKER" POST 1 FOOT EASTERLY.

NOTES:

B.C.B.W. IS A BRASS WASHER STAMPED "BENTON COUNTY SURVEYOR". COM-PASS DECLINATION IS 20° EAST. ALL MEASURED DISTANCES AND COMPASS BEARINGS ARE TO THE CENTER OF THE OBJECT, UNLESS OTHERWISE NOTED.

FIRM/AGENCY: BENTON COUNTY PUBLIC WORKS

ADDRESS: 360 S.W. AVERY AVE. CORVALLIS OR. 97333; PH. 757-6821

PARTY CHIEF: CURTIS J. LIESENFELT

CREW: MARK E. ANDERSON

WITNESS:

REGISTERED
PROFESSIONAL
LAND SURVEYOR

Danna G. Fehrenbacher

OREGON

JULY 16, 1982

DANNA L. FEHRENBACHER

1995

1585w
L63NW

T115 R5W SEC 18 SW COR.
 FND: 4" x 10" x 16" LONG IRON WAGON SPINDLE FOR THE COR. (COR.
 REST. NO. 717)
 " A FIR STUMP 33" IN DIA. @ A HEATED FACE BEARS N 80° W ~
 4.2' (N 83° W ~ 4.22' COR. REST. NO. 717). FOUND A B.T.
 TAB ON THE ELY FACE. SET A NEW TAB BELOW IT.
 " A MAPLE 18" IN DIA. @ A HEATED FACE BEARS N 47° W ~
 19.51' (N 47° W ~ 19.14' COR. REST. NO. 717). SET A PK
 NAIL + BCBW IN THE NE 1/4 BASE SET A BT TAB ON THE
 SE 1/4 FACE.
 " A MAPLE 25" IN DIA. @ A HEATED FACE BEARS N 21° E ~
 22.01' (N 11° 30' E ~ 21.78' COR. REST. NO. 717). SET A
 PK NAIL + BCBW IN THE W 1/4 BASE FOUND A BT TAB ON
 THE S 1/4 FACE. SET A NEW TAB ABOVE IT.
 NO OTHER RELEASO GEARING OBJECTS WERE RECOVERED
 SET: 2" I.D. x 36" LONG IRON PIPE @ A 3 1/4" GEN. CO. B.C. STAMPED
 AS SHOWN IN THE SAME POSITION AS THE RECOVERED WAGON
 SPINDLE. BURIED THE WAGON SPINDLE A HORIZ. BLOCK AT THE
 ELY SIDE OF THE NEW MON
 A MAPLE 15" IN DIA. BEARS S 37° E ~ 27.40' FACED +
 SCRIBED "T115 R5W S19 BT". SET A PK NAIL + BCBW IN THE
 SW 1/4 BASE SET A BT TAB ON THE NW 1/4 FACE.

1990

T115
 R5W
 S18
 S13
 S19
 S24
 S19
 CDP
 STAMPINGS

PREPARING + GPS CONTROL.
 SECOND GATE ON STRAKER RD. NO. 1000. IT MAY BE OK FOR
 A CLEARCUT, 100' ± W 1/4 OF ALDER CREEK + 250' ± W 1/4 OF THE
 THE COR. IS LOCATED ON AN ELY SLOPE AT THE ELY EDGE OF
 SRT: ORANGE RIGERGLASS "SURVEY MARKER" POST 1' ELY.
 BASE SET A BT TAB ON THE NE 1/4 FACE.
 " T115 R5W S24 BT" SET A PK NAIL + BCBW IN THE SE 1/4
 A MAPLE 11" IN DIA. BEARS S 61° W ~ 66.78' FACED + SCRIBED

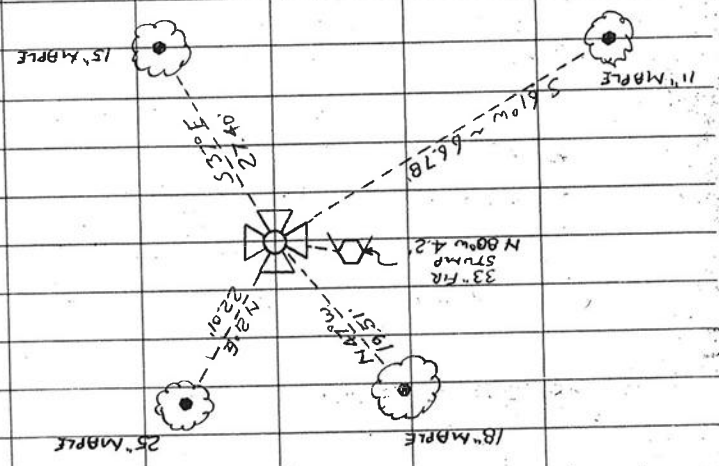

8/11/90; COL M. MAD. SILVA CORR. 20° E. DEC. 1; CLOT, W/BRK

8/14

C.S. 226
CONTINUED BY M.C.G.

CORNER RESTORATION BOOK NO. 1

1/4 Sec. CORNER between secs. 4 & 9 T. 15-5
 Stone 8" X 10" X 1/2" Mkd. C.S. in proper place. 3" under surface
 Apple tree 4" in dia. bears N. 73° E. .737 cks. distant
 Pine stump 30" " S. 3° W. 1.07 " " Orig. tree
 Stone at corner post S. 34° W. .706 " " cen. stake
 2' X 2' X 1/2' N. 77° W. .644 " " crack in stone
 Road fence South .581 " " to wire
 Witness H. E. Wilbert. Feb. 17, 1923.

1/4 sec. corner between secs. 9 & 10 T. 15-5
 Set 1/2" galv. pipe also strap iron on North side and east from ^{top of} ~~top of~~
 with book, lying East with hook around pipe.
 Gov. stumps check, as, Oak 20" N. 35° E. 1.64 cks.
 " " 20" N. 34° W. 1.29 "
 Oak 12" Mashed C.S. BT. N. 31° 15' E. .684 "
 " 12" " " S. 77° 35' E. 1.013 "
 To E. rail of R.R. N. 80° W. 1.312 "
 Witness S. J. Galloway. Feb. 19, 1923.

C.S. 43
 by F.H. Mills
 May 1909
 D.B. Farley witness

sec 11 & 12
 Corner to sections 33 & 34 T. 14 S. R. 5 W. 7/15-5
 Set 3" X 4" heart oak stake
 Pipe on sec. line North #50 rds.

Corner to secs. 2, 3, 34 & 35 Tps. 14 & 15 S. R. 5 W.
 Set 1" black pipe for cor. no trees near. pipe near fence.

1/4 sec. cor. between Secs. 2 & 3 T. 15-5
 Set Sand stone 16" X 8" X 8" At N gate post at end of lane; 100' N. W. end of barn.
 Oak 12" in dia. bears S. 39° 30' W. 43.0 cks. ()
 Ash 9" " " N. 19° W. 4.493 " ()

C.S. 293
 Road survey

S.E. corner of Lewis Morris D.L.C. 70 T. 10-4
 Set a 1/2" galvanized pipe placed 1/2" galv. pipe at E. N. 1/4 line N.
 Oak 24" in dia. bears S. 34° E. .41 cks. sid. dead
 " 7" " " S. 79° W. .591 " blazed by former survey.
 Witness Byron K. Taylor March 3, 1923.

C.S. 314
 M.W.L.
 Feb. 1923

Sec cor. 13, 18, 24, 19 T. 11 S. R. 5 & 6 W.
 Set wagon spindle - Found original maple N.W. mtd
 Maple 12" N. 112° E. .33 cks
 " 10" N. 47° W. .129 "
 Fir 8" N. 88° W. .064 "
 Witness: Geo. Linton



11-5-18, 19 and 11-5-19, 27

Section corner 13, 18, 24, and 19, Twp. 11 S., R. 5 and 6 W.

717

Reestablishment by ~~W. C. Galloway~~ *

February 1923

Set wagon spindle, found original maple N. W. marked

Maple 12" in diam bears N 11 $\frac{1}{2}$ ° E

Maple 10" in diam bears N 47° W

Fir 8" in diam bears N 83° W - d

.33 chains

.29 chains

.064 chains

Witness George Linnnton

* WALTER W. LARSEN, SEE FIELD BOOK NO. 32 PAGE 29 AND OLD CORNER BOOK NO. 1 PAGE 166
(MEA 7/22/92).