

115200500

CORNER FILE TRACKING

S:\Survey Corners\CORNERS\Templates\Filetrac2.doc
10/04/2010

CORNER NUMBER
115200500

STEP	HISTORY	RESTORATION
Form Prepared, DB	01/09/15	02/25/16
Field Inspection, DB	03/23/16	03/23/16
Finish index (count unit)	01/09/15	03/23/16
Counter Index	02/24/16	03/24/16
GIS Index Form	03/24/16	03/24/16
Checked, DB	3/30/16	3/30/16
Form Edited, DB	4/11/16	4/11/16
Form Signed, DB	4/11/16	4/11/16
Authorize Payment, DB	—	—
Archive Digital Files	4/11/16	4/11/16
Collect Documents	3/25/16	3/25/16
PDF File	4/11/16	4/11/16
Copy For Filming	4/11/16	4/11/16
Scanned (pdf to laserfiche)	4/11/16	4/11/16
Filmed (Archived), DB	4/11/16	4/11/16
Filed, DB		

(DB) = Entry needed in database (Access).

COMMENTS:

DATE 01/09/2013

TOWNSHIP 11 SOUTH, RANGE 5 WEST, WILLAMETTE MERIDIAN; SECTION 7 CORNER SOUTHEAST
DONATION LAND CLAIM N/A CORNER N/A

COMMON CORNER(S):

SOUTHWEST CORNER SECTION 8
NORTHWEST CORNER SECTION 17
NORTHEAST CORNER SECTION 18

RECORDS (INFORMATION IN BOLD /ITALICS IS COUNTY STAFFS' INTERPRETATION OF THE RECORD)

BASED ON EXTENSIVE RESEARCH AND RECOVERY OF EVIDENCE, THIS OFFICE HAS DETERMINED THAT MOST GENERAL LAND OFFICE SURVEYORS IN BENTON COUNTY MEASURED TO THE FACE OF BEARING TREES.

- [01] GENERAL LAND OFFICE (GLO) NOTES BY G. W. HYDE, D.S., DATED JULY 3, 1852. SET POST FROM WHICH A W. OAK 12" DIA BEARS **N72°W, 21 LINKS (13.86 FEET)**; A W. OAK 14" DIA BEARS **S25°W, 46 LINKS (30.36 FEET)**; A MAPLE 16" DIA BEARS **S42-1/2°E, 170 LINKS (112.20 FEET)**; A MAPLE 18" DIA BEARS **N63°E, 75 LINKS (49.50 FEET)**.
- [02] BENTON COUNTY SURVEY NO. 594 (OLD NO. 259) FIELD NOTES (FIELD BOOK 22, PAGE 78) BY W. C. GALLOWAY, C.S., DATED JUNE 19, 1917. SET PINT BOTTLE, STAKE BY IT. OAK 18" DIA (GLO BT) BEARS **N63°E, 0.75 CHAINS (49.50 FEET) STANDING; FIR 10" DIA BEARS S41°15'E, 0.800 CHAINS (52.80 FEET); MAPLE 7" DIA BEARS S36°W, 0.585 CHAINS (38.61 FEET); MAPLE 18" DIA BEARS N53°W, 0.130 CHAINS (8.58 FEET)**. SOUTHEAST MAPLE CHECK, DEAD. SOUTHWEST OAK CHECK, DEAD. NORTHWEST GONE.
- [03] BENTON COUNTY CORNER RESTORATION BOOK NO. 1, PAGE 124, BY W. C. GALLOWAY, C.S., DATED AUGUST 9, 1917. SET PINT BOTTLE, ALSO STAKE. SOUTHEAST MAPLE CHECKS, DEAD. SOUTHWEST OAK CHECKS, DEAD. OAK 18" DIA (GLO BT) BEARS **N63°E, 0.75 CHAINS (49.50 FEET) STANDING; FIR 10" DIA (CSBT) BEARS S41°15'E, 0.800 CHAINS (52.80 FEET); MAPLE 7" DIA (CSBT) BEARS S36°W, 0.585 CHAINS (38.61 FEET); MAPLE 18" DIA (CSBT) BEARS N53°W, 0.130 CHAINS (8.58 FEET)**.
- [04] BENTON COUNTY CORNER RESTORATION NO. 696. TRANSCRIBED FROM RECORD [03] AND MAY CONTAIN ERRORS AND/OR OMISSIONS.
- [05] BENTON COUNTY SURVEY NO. 594 (OLD NO. 259) BY W. C. GALLOWAY, C.S., DATED AUGUST 17, 1917. OAK 18" DIA (GLO BT) BEARS **N63°E, 0.75 CHAINS (49.50 FEET); FIR 10" DIA (CSBT) BEARS S41°15'E, 8.00 [sic.] CHAINS (528.00 FEET); MAPLE 7" DIA (CSBT) BEARS S36°W, 5.85 [sic.] CHAINS (386.10 FEET); MAPLE 18" DIA (CSBT) BEARS N53°W, 1.30 [sic.] CHAINS (85.80 FEET)**.
- [06] BENTON COUNTY MAP NO. 11-5-00034 BY W. C. GALLOWAY, C.S., DATED AUGUST 17, 1917, AND REVISED BY W. W. LARSEN DATED 1933 AND W. C. GALLOWAY DATED 1939. PINT BOTTLE. OAK 18" DIA (GLO BT) BEARS **N63°E, 0.75 CHAINS (49.50 FEET) STANDING; FIR 10" DIA (CSBT) BEARS S41-1/4°E, 0.800 CHAINS (52.80 FEET); MAPLE 7" DIA (CSBT) BEARS S36°W, 0.585 CHAINS (38.61 FEET); MAPLE 18" DIA (CSBT) BEARS N53°W, 0.130 CHAINS (8.58 FEET)**.

FIRM/AGENCY: BENTON COUNTY SURVEYOR'S OFFICE
ADDRESS: 360 S.W. AVERY AVE., CORVALLIS, OR 97333; PH. 541-766-6821
RESEARCH BY: DAVID L. MALONE, P.L.S.
DATA ENTRY BY: SAME

BENTON COUNTY CORNER RESTORATION FORM, PAGE 1 OF 2, 115200500R2
SEE CORNER HISTORY FORM FOR RECORDS ETC.

CORNER RESTORATION FIELD BOOK NUMBER 31 PAGE(S) 5-6 DATE 03/23/2016
TOWNSHIP 11 SOUTH, RANGE 5 WEST, WILLAMETTE MERIDIAN; SECTION 7 CORNER SOUTHEAST
DONATION LAND CLAIM N/A CORNER N/A
CONDITION REPORT _____; REFERENCED OUT _____; RENEWED X; SURVEYED IN _____

LOCATION AND COMMENTS:

CORNER IS LOCATED IN A STAND OF ± 90 YEAR OLD FIRS WITH SOME SCATTERED HARDWOODS. TO REACH CORNER FROM THE OSU COLLEGE FORESTS GATE AT THE END OF OAK CREEK DRIVE, PASS THROUGH GATE ON OSU COLLEGE FORESTS ROAD 600 AND DRIVE 0.48 MILES, PASS ROAD 670 ON THE RIGHT AND CONTINUE 0.10 MILES, PASS ROAD 6020 ON THE LEFT AND CONTINUE 1.10 MILES AND TURN LEFT ONTO ROAD 680, DRIVE 0.30 MILES TO A WYE AND TURN LEFT ONTO ROAD 681, DRIVE 0.52 MILES AND PARK. WALK WEST ABOUT 380 FEET. CORNER IS BAD FOR PREMARKING AND GPS CONTROL.

MONUMENTS AND ACCESSORIES FOUND (CONDITION AND SOURCE):

1. FOUND ROTTED REMAINS OF D. FIR 10" DIA BEARS S41°15'E, 52.80 FEET TO CENTER. FOUND PARTIAL FACE WITH A PARTIAL SCRIBE MARK BELIEVED TO BE THE TOP SLASH OF A "T". BASIS OF BEARINGS FOR THIS RESTORATION.
(FIR 10" DIA BEARS S41°15'E, 0.800 CHAINS [52.80 FEET] PER RECORDS [02] AND [03]).
(FIR 10" DIA BEARS S41°15'E, 8.00 CHAINS [SIC.] [528.00 FEET] PER RECORD [05]).
(FIR 10" DIA BEARS S41-1/4°E, 0.800 CHAINS [52.80 FEET] PER RECORD [06]).
2. FOUND REMAINS OF OAK STUMP BEARS N64°25'E, 50.25 FEET TO CENTER. THE REMAINS WERE IN THE FORM OF ONE LARGE PIECE FORMING ABOUT A THIRD OF THE OUTSIDE SHELL OF THE OAK, WITH OAK PIECES IN THE REMAINING CIRCULAR PATTERN AROUND A SMALL DEPRESSION.
(MAPLE 18" DIA BEARS N63°E, 75 LINKS [49.50 FEET] PER RECORD [01]).
(OAK 18" DIA BEARS N63°E, 0.75 CHAINS [49.50 FEET] STANDING PER RECORDS [02], [03] AND [06]).
(OAK 18" DIA BEARS N63°E, 0.75 CHAINS [49.50 FEET] PER RECORD [05]).
3. FOUND BROKEN, LEANING AND ROTTEN REMAINS OF A MAPLE STUMP BEARS N42°04'W, 8.13 FEET TO APPROXIMATE CENTER. THE 20" TREE IS LYING ON THE GROUND. NO MARKS VISIBLE.
(MAPLE 18" DIA BEARS N53°W, 0.130 CHAINS [8.58 FEET] PER RECORDS [02], [03], AND [06]).
(MAPLE 18" DIA BEARS N53°W, 1.30 CHAINS [SIC.] [85.80 FEET] PER RECORD [05]).

MONUMENT SET (PROCEDURES AND DESCRIPTION):

CALCULATED POSITION OF CORNER BY DISTANCE – DISTANCE INTERSECTION FROM THE CENTER OF THE SOUTHEAST FIR BEARING TREE BLAZED AND SCRIBED BY W. C. GALLOWAY, C.S., IN 1917, AND THE CENTER OF THE NORTHEAST OAK GLO BEARING TREE ADJUSTED FROM THE GLO FACE MEASUREMENT USING THE ORIGINAL DIAMETER OF THE TREE. THE GLO CALLED THIS AS A MAPLE BEARING TREE, BUT GALLOWAY CALLED IT AN OAK AND I FOUND IT TO BE AN OAK. GALLOWAY HAD ALSO FOUND TWO OTHER GLO BEARING TREES SO I BELIEVE HE WAS CORRECT IN ACCEPTING THIS AS THE GLO BEARING TREE EVEN THOUGH THE SPECIES WAS DIFFERENT. THE NORTHWEST MAPLE GALLOWAY BEARING TREE HAD BROKEN OFF AND WAS LYING ON THE GROUND. THE STUMP WAS LEANING; BROKEN AND VERY ROTTEN, MAKING IT DIFFICULT TO ESTIMATE THE ORIGINAL CENTER OF THE TREE. THEREFORE I DID NOT USE THIS STUMP IN CALCULATING THE CORNER POSITION. AT RECORD BEARING AND DISTANCE TO THE SOUTHEAST GLO MAPLE BEARING TREE AND THE SOUTHWEST GALLOWAY MAPLE BEARING TREE I FOUND A CIRCULAR PATTERN OF MAPLES, INDICATING THE TREES HAD RESPROUTED NEW MAPLES BEFORE ROTTING AWAY. IN THE AREA OF THE CALCULATED CORNER POSITION I DUG A 4' DIAMETER HOLE ABOUT 8" TO 12" DEEP LOOKING FOR THE GLASS PINT BOTTLE. I FOUND A LOT OF DIFFERENT COLORED RIBBON, A DEPARTMENT OF FORESTRY LOCATION TAG, BARB WIRE, AND GLASS FRAGMENTS (INCLUDING THE NECK OF THE BOTTLE) SCATTERED AROUND THE ENTIRE DIG AREA, MOSTLY AT THE SURFACE. I ACCEPTED MY CALCULATED POSITION AS THE BEST AVAILABLE EVIDENCE OF THE ORIGINAL CORNER POSITION.

AT THE CALCULATED CORNER POSITION I SET A 2" X 31-1/2" GALVANIZED IRON PIPE WITH A 3-1/4" BRASS DISK CEMENTED IN THE TOP, AT GROUND SURFACE, AND MARKED AS SHOWN ON PAGE 2 OF 2. BURIED THE GLASS FRAGMENTS AROUND THE PIPE AND THE LOCATION TAG ON THE WEST SIDE OF THE BRASS DISK. SET FOUR NEW IRON ROD ACCESSORIES AND BLAZED AND SCRIBED ONE NEW BEARING TREE AS SHOWN ON PAGE 2 OF 2. SET 6 FOOT ORANGE CARSONITE "SURVEY MARKER" POST 1 FOOT SOUTH OF NEW MONUMENT.

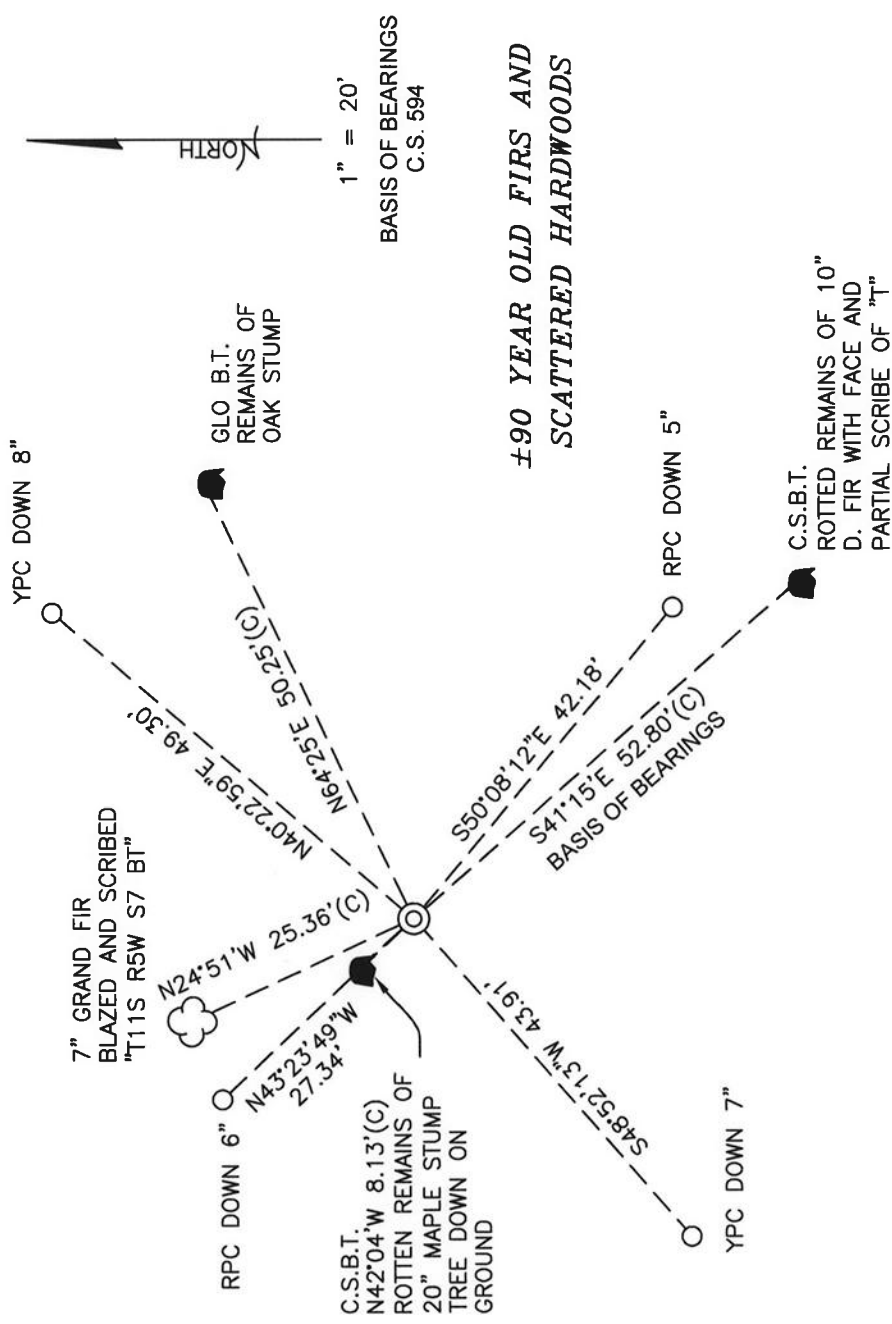

MONUMENT DETAIL

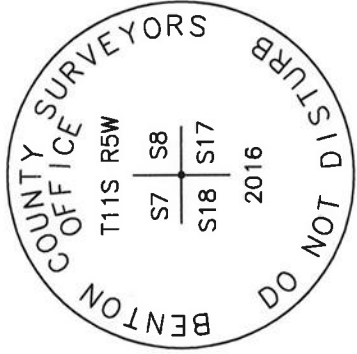

3-1/4" BRASS DISK

LEGEND

- SET 5/8" X 30" REBAR WITH PLASTIC CAP YELLOW PLASTIC CAP MARKED "BENTON COUNTY SURVEYOR"
- YPC
- RPC
- (C)
- (C) MEASUREMENT TO CENTER
- (C) GOVERNMENT MONUMENT SET AS SHOWN
- C.S. COUNTY SURVEY
- C.S.B.T. COUNTY SURVEYOR'S BEARING TREE
- GLO GENERAL LAND OFFICE
- B.T. BEARING TREE
- BEARING TREE STUMP AS NOTED
- BEARING TREE AS NOTED

NEW ACCESSORIES:

1. SET REBAR (SEE LEGEND) S50°08'12"E, 42.18 FEET AND 5 INCHES BELOW GROUND LEVEL.
2. SET REBAR (SEE LEGEND) S48°52'13"W, 43.91 FEET AND 7 INCHES BELOW GROUND LEVEL.
3. SET REBAR (SEE LEGEND) N43°23'49"W, 27.34 FEET AND 6 INCHES BELOW GROUND LEVEL.
4. SET REBAR (SEE LEGEND) N40°22'59"E, 49.30 FEET AND 8 INCHES BELOW GROUND LEVEL.
5. GRAND FIR 7" DIA BEARS N24°51'W, 25.36 FEET TO CENTER, FACE SCRIBED "T11S R5W S7 BT". SET ALUMINUM NAIL AND PLASTIC WASHER ON NORTHEASTERLY BASE FOR DISTANCE MEASUREMENT.

NOTES:

COMPASS DECLINATION IS 16' EAST. ALL MEASURED DISTANCES AND BEARINGS ARE TO THE CENTER OF THE OBJECT, UNLESS OTHERWISE NOTED. ALL BEARING TREES ARE PAINTED AND HAVE A B.T. TAG ATTACHED, FACING THE CORNER UNLESS OTHERWISE NOTED. ALL NEW BEARING TREES HAVE A PLASTIC WASHER (STAMPED "SURVEY MARKER DO NOT REMOVE") ATTACHED BY AN ALUMINUM NAIL TO THE SIDE CENTER OF THE TREE FOR DISTANCE MEASUREMENT, UNLESS OTHERWISE NOTED.

THIS RESTORATION WAS PERFORMED AT THE DIRECTION AND APPROVAL OF THE BENTON COUNTY SURVEYOR *gma*

REGISTERED
PROFESSIONAL
LAND SURVEYOR

4/16/16 David L. Malone

OREGON
JANUARY 12, 1999
DAVID L. MALONE
51523

FIRM/AGENCY: BENTON COUNTY SURVEYOR'S OFFICE
ADDRESS: 360 S.W. AVERY AVE., CORVALLIS, OR 97333; PH. 541-766-6821
PRESENT: DAVID L. MALONE, P.L.S., BERNARD ALTENBACH, SURVEY TECH.,
STEVE PILKERTON, P.E., AND CHASE BERG, OSU INTERN.
EQUIPMENT: NIKON NIVO3.C WITH SURVEY PRO ONBOARD.

RENEWAL DATE: 12/31/16

115200500

CONT. FROM PREVIOUS PAGE

HEAD CALIBRATED POSITION AND SET 2" x 31-1/2" G.I.P.
W/ 3-1/4" BRASS DISK CEASED IN THE TOP, FINISH
W/ GROUND SURFACE, SURROUND GLASS FRAGMENT
AROUND PIPE AND LOCATED TRK. ON WEST SIDE
OF BRASS DISK. SET 4 NEW IRON ROD ACCESSORIES
& BURIED AND SECURED IN NEW BEARING HOLES. SET 6"
ORANGE CASING "SURVEY MARKER" POST 1' SOUTH
OF BRASS DISK.

3/23/16

3/16

BR = 5/8" x 30" IRON ROD
HPC OR PFC = YELLOW OR RED PLASTIC CAP
MARKER "GENCO COUNTY SURVEY"
N & PLW = NAIL & PLASTIC WASTHER MARKER
"SURVEY MARKER DO NOT REMOVE"

Corner to sections 7, 8, 17, and 18, Twp. 11 S. R. 5 W

896

Reestablishment by W. C. Galloway

August 7, 1917.

Set pt. bottle, also stake, S. E. Maple checks, dead.

S. W. Oak checks, dead.

Oak 18" in diam bears N 63° E

.75 chains (standing)

Fir 10" in diam bears S. 41° 15' E

.800 chains

Maple 7" in diam bears S 36° W

.585 chains

Maple 13 18" in diam bears N 53° W

.130 chains

Witnesses Hiram Parker, Fred Wetherford