

CORNER FILE TRACKING

H:\Survey\Corners\Misc\Filetrac.doc

11/23/98

CORNER NUMBER
115200640

STEP	HISTORY()	RESTORATION()
Form Prepared, DB	10/20/03	10/25/03
Field Inspection, DB	10/20/03	10/20/03
Form Checked, DB	11/29/03	11/29/03
Form Edited, DB	11/30/03	11/03/03
Form Signed, DB	12/03/03	12/03/03
Authorize Payment, DB	—	—
Archive Digital Files		
Collect Documents	12/03/03	12/03/03
Scanned	12/11/03	12/11/03
Copy For Filming	12/10/03	12/10/03
Filed, DB		
Finish index (count unit)	10/20/03	10/20/03
Filmed (Archived), DB		

(DB) = Entry needed in database (Access).

COMMENTS:

115 400640

REMOVING 1/4 6/5 T115, RSW

Fd 3/4 x 24 SHAFET w/ FILING on TOP

9 ABOVE GR LEVEL DRIVEN IN PART OF
40" D FIR STAMP (ROTTEN) AS SET

PER CS 1226 Fd ROTTER REMAINS

OF SW. GLO BT NOW ± 20 DIA

SET NAIL & PLASTIC WASH IN CTR

NO OTHER ACCESSORIES REMAIN POSITION

OF SHAFET FITS GLO CHILL

HELD SHAFET FOR TRUE GR POSITION.

REMOVED SHAFET AND SET 2" X 36" GIP

w/ 3/4" BRASS DISK CONC IN TOP

4" ABOVE GR LEVEL, MKD AS SHOWN

SHAVED FIRE ROOT AND SET NEW NOW.

AT SAME XY POSITION AS SHAFET 4" ↓

SET 6 CARBONITE POST 0.5 SOUTH

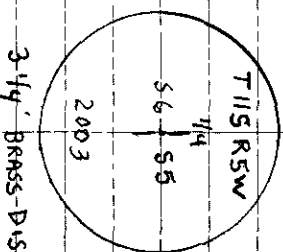

LEICA TCR 1105/70S

PRIV CLD

60' ± 30.1' N

10-23-03 2/58
D DEAN
B ALTBACK

CRK SHOTS 7-9

MATURE CANIFER FOREST

NORTH

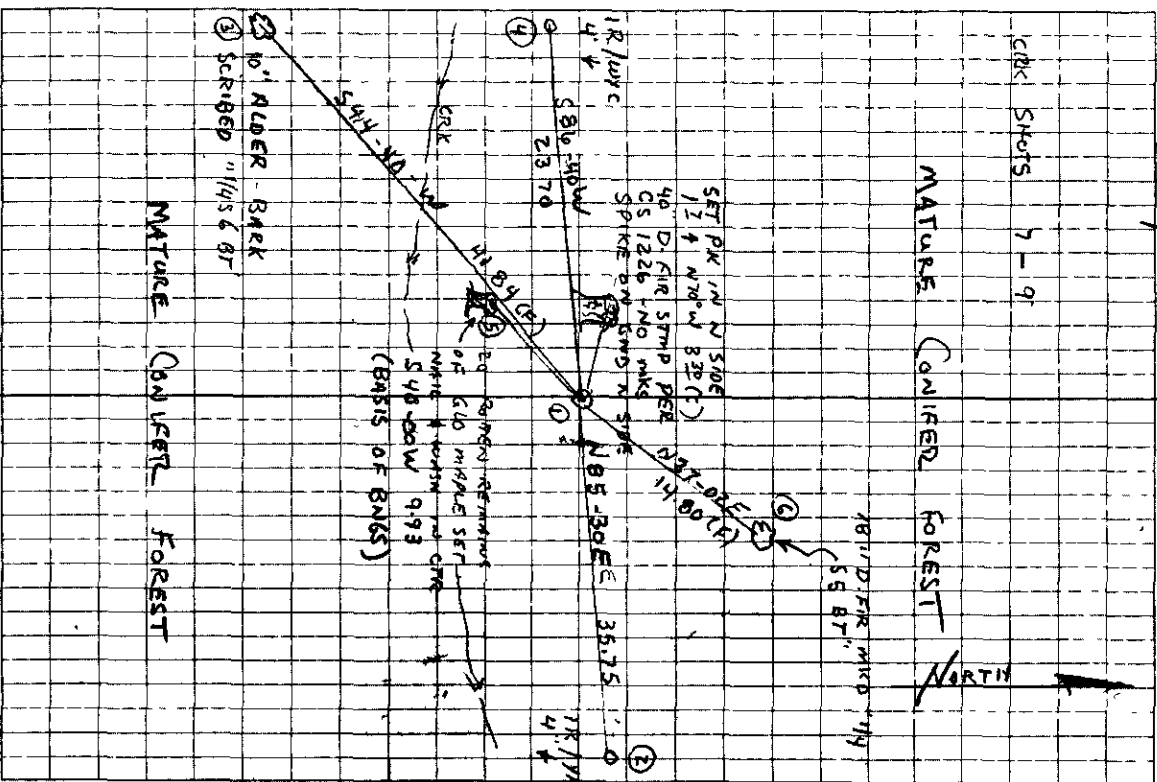

(4)

For Road #3022 Sec cor to sec 10, 11, 14 & 15 Tp 11 S R 6 W
 Set a barometath between two brick under a brick (35 unpts. 79)
 Fir 6" dia base S 5° 40' W 798 ch
 Oak 16" " " N 55° 45' W 2.326
 Witness W.H. Ellenburgh & A.C. Johnson June 27, 1912

Cor. sec 34 & 35 Tp 10 S R 5 W
 Set 4" x 4" x 30" Oak stake for cor. from which
 an Oak 12" dia base N 27° 15' E 2.17 lbs dist
 an Oak 16" " " N 54° 30' W 2.22

1/4 cor. sec 34 Tp 10 S R 5 W Tp line
 Set 4" x 4" x 30" Oak stake for cor. from which
 an Oak 30" dia base N 3° 45' E 78 lbs dist
 a fir 4" dia base N 29° 30' W 227 " "

Cor. sec 33 & 34 Tp 10 S R 5 W Tp line
 Set 4" x 8" x 8" stone for cor. from which
 an Oak 10" dia base N 79° 25' E 98 lbs dist
 " " 8" " " N 32° 45' W 69.8 " "

1/4 cor. sec 3 Tp 11 S R 5 W Tp line
 Set a 4" x 4" x 30" Oak stake from which
 an Oak } N 56° W 65 ch
 " Oak } all original trees
 " " } 550° W 366

1/4 cor. sec 2 & 3 Tp 11 S R 5 W
 Set 4" x 4" x 36" Oak stake from which
 an Oak 24" dia base N 9° 45' E 278 lbs dist.
 " Fir 17" 18" " " N 27° 30' W 257 " "
 " " 24" " " " N 20° E 0.44 " "
 " " " " " N 27° E 1.58 " "

1/4 cor. sec 3 & 4 T 11 S R 5 W
 Set 5" x 5" x 36" Yew stake for cor. from which
 a Maple 4" dia base N 27° 30' E 97.4 lbs dist.
 N.W. original tree standing

1/4 sec cor. sec 4 & 5 T 11 S R 5 W
 Removed stake Set 2" x 30" Car axle in place of stone, stone removed and set out
 Set a stone 8" x 8" x 16" for cor. from which
 an Oak 5" dia base N 88° 45' E 2.14 lbs dist
 " " 4" " " N 7° 30' W 68.4 " "
 " " 16" " " S 88° E 10.95 std.
 " " 14" " " N 5° W 2.785 stump std.

1/4 sec. cor. sec 5 & 6 T 11 S R 5 W
 Set 4" x 4" x 36" fir limit for cor. from which
 a Maple 12" dia base S 12° 20' E 63.3 lbs dist.
 N.W. original standing

1/4 cor. sec 5. Tp line Tp 11 S R 5 W
 Set 4" x 4" x 30" fir stake for cor. from which
 a fir 6" dia base N 23° E 274 lbs dist
 Both original trees standing

W.C.G.
 April 1936

1912.
 1912.
 1912.
 1912.
 1912.
 1912.

C.S. #260
Aug. 7, 1937
Witnesses
Rudolph J. Stewart
by W.C. Galloway

Most East S.E. corner of Alfred Wilham D.L.C. #55 T41-5
Set 1 1/2" housing of Dodge car axle
Oak 30" in dia. bears S. 15° E. 18 chains std.
" 15" " " N. 49 1/2° W. 45 " hole of stump
S.W. cor of Cl. 54 S. 1° 10' W. 1.194

C.S. #287
Sept. 1937
Rudolph Stewart
& Adrian Seits
W.C. Galloway

1/4 Sec. corner between Secs. 5 & 6 T. 11-5
Set 3/4" shaft in root of a 45" fir
Maple 12" in dia. bears S. 40° W. 15 chn. std.
Mkd. W. fir 8" " " N. 47° E. 371 "
" Fir 45" in " " N 70° W. 1.050 "

1/4 6/5 11-5

C.S. #220
Oct. 6, 1937
by W.C. G.
Witnesses
Rudolph J. Stewart
and Adrian Seits

1/4 Sec. Cor. bet. Secs. 9 & 10 T. 11-6
Set 4"x2" Iron (wagon tire) From
Oak 10" in dia. bears N. 45° W. 68 dead
" 12" " " " N. 74° E. 95 " down
Mkd. Fir 60" " " S. 30° E. 399 chains nail in s. for measure
" " 28" " " N. 52 1/4° W. 623 " " " W " "
" " 40" " " N. 19 1/4° W. 683 " " " E " "

C.S. #220
Oct. 7, 1937
Witnesses as above

1/4 Sec. cor. bet. Secs. 3 & 10 T. 11S. R 6 W.
Set 1/2"x2" Iron (wagon tire) & mound of stone
Fir 30" in dia. bears S. 24 1/2° W. 44 std.
W. " 24" " " " N. 13° 20' W. 1.14 " (glass face corner
Same as 1/4 in W. of 10
Distances correct)

C.S. 336
Dec. 7, 1936
by W.C. Galloway
Witnesses Rudolph Stewart
H.C. Hoffer

S.W. corner of James McCoy D.L.C. #60 T 14-6
Set a 1 1/2"x 20" bolt set from
Fir 6" N 52° 25' E. 33 links stump
" 9" S. 27° E. 2.2 "
Mkd. fir 5" in dia. bears N. 23 1/2° E. 109 chn.
" " 3" " " " N. 80° W. 037 "

Witnesses
As above
Dec. 7, 1936

N.W. corner of James McCoy D.L.C. #60 T44-6
Set 5/8"x 1 1/2"x 31" Iron bar
Fir 24" in dia. bears N. 27° W. 49 lks. stump found B.T.
Mkd. " 28" " " " N. 29 1/2° E. 492 " To spike in N. side for measure
" " 8" " " " " N. 43° 20' W. 622 " con. of tree

Aug. 1937
7/11/36
E.C. G. & W.C. G.
corrected bearings & measures
H.C.G.
H.C.G.

C.S. 336
Dec. 7, 1936
Witnesses as above

S.W. corner of Samuel Haptenstall D.L.C. # 55 T 14-6
Set 1 1/2"x 20" bolt From
Fir 24" in dia. bears N 12° E. 64 links, stump
" 20" " " " S 13° E. 89 " "
Mkd. " 6" " " " N 35° E. 086 "
" " 6" " " " N 43 1/2° W. 19.7 "

SEE CORNER HISTORY FORM FOR RECORDS ETC.

CORNER RESTORATION FIELD BOOK NUMBER 21 PAGE(S) 58 DATE 10/20/2003
TOWNSHIP 11 SOUTH, RANGE 5 WEST, WILLAMETTE MERIDIAN; SECTION 05 CORNER WEST 1/4
DONATION LAND CLAIM NONE CORNER N/A
CONDITION REPORT ; REFERENCED OUT ; RENEWED XX; SURVEYED IN

LOCATION AND COMMENTS:

CORNER IS LOCATED IN A MATURE CONIFER FOREST, 20 FEET NORTH OF SOAP CREEK TO REACH CORNER FROM THE JUNCTION OF SOAP CREEK AND SULPHUR SPRINGS ROADS, TRAVEL WESTERLY ON SULPHUR SPRINGS ROAD FOR 0.68 MILES TO "Y" JUNCTION BEAR LEFT (WEST) THROUGH LOCKED (OSU) GATE FOR 0.51 MILES TO LOCATION TAG ON A ±12" D FIR AT THE NORTH SIDE OF ROAD; THEN NORTH 3.6 CHAINS TO CORNER. CORNER IS POOR FOR PREMARKING AND GPS CONTROL

MONUMENTS AND ACCESSORIES FOUND (CONDITION AND SOURCE):

- 1 FOUND 3/4" X 24" SHAFT WITH FITTING ON TOP, DRIVEN IN ROOT OF 42" D FIR STUMP, 6" ABOVE GROUND LEVEL FOR CORNER POSITION
(SET 3/4" SHAFT IN ROOT OF 45" FIR PER RECORDS [06] AND [07])

- 2 FOUND ROTTEN REMAINS OF ±20" MAPLE STUMP, GLO BEARING TREE, S40°00'W, 9.93 FEET TO CENTER. SET ALUMINUM NAIL AND PLASTIC WASHER IN CENTER FOR DISTANCE AND ANGLE MEASUREMENT **THIS IS THE BASIS OF BEARINGS FOR THIS CORNER RESTORATION.**
(12" MAPLE BEARS S40°W, 9.90 FEET PER RECORD [01])
(ONE TREE STANDING PER RECORD [02])
(NORTHWEST ORIGINAL STANDING PER RECORD [04])
(SET 3/4" SHAFT FROM 12" STANDING MAPLE PER RECORD [06])
(12" MAPLE BEARS S40°W, 9.90 FEET PER RECORD [07])

- 3 FOUND 42" BUCK SKINNED D FIR STUMP, N70°W, 3.30 FEET TO CENTER FOUND SPIKE LYING ON NORTH SIDE OF STUMP AS SET PER RECORD [06] NO VISIBLE MARKS OR HEALED BLAZE COULD BE FOUND SET ALUMINUM NAIL AND PLASTIC WASHER IN NORTHERLY BASE FOR DISTANCE MEASUREMENT
(45" FIR BEARS N70°W, 3.30 FEET PER RECORDS [06] AND [07])

MONUMENT SET (PROCEDURES AND DESCRIPTION):

HELD THE 3/4" SHAFT FOR THE TRUE CORNER POSITION WHICH IS IN GOOD AGREEMENT WITH THE ABOVE NOTED ACCESSORIES. REMOVED SAID SHAFT, CHOPPED AWAY ROTTEN ROOT AND SET A 2" X 36" GALVANIZED IRON PIPE WITH A 3 1/4" BRASS DISK CONCREATED IN THE TOP, 4" ABOVE GROUND LEVEL AND MARKED AS SHOWN ON PAGE 2 OF 2 SET 6 FOOT ORANGE CARSONITE "SURVEY MARKER" POST, 0.5 FEET SOUTH OF NEW MONUMENT. DEPOSITED 3/4" SHAFT ON THE SOUTH SIDE OF NEW MONUMENT IN A HORIZONTAL POSITION AND 6" BELOW GROUND LEVEL

DATE 10/20/2003TOWNSHIP 11 SOUTH, RANGE 05 WEST, WILLAMETTE MERIDIAN; SECTION 5 CORNER WEST 1/4
DONATION LAND CLAIM NONE CORNER NONE**COMMON CORNER(S):**

EAST 1/4 SECTION 6

RECORDS (INFORMATION IN *BOLD ITALICS* IS COUNTY STAFFS' INTERPRETATION OF THE RECORD)

BASED ON EXTENSIVE RESEARCH AND RECOVERY OF EVIDENCE, THIS OFFICE HAS DETERMINED THAT MOST GENERAL LAND OFFICE SURVEYORS MEASURED TO THE FACE OF BEARING TREES

- [01] GENERAL LAND OFFICE (GLO) NOTES BY GEORGE HYDE, D.S , DATED JUNE 1852 *SOUTH 00°17' EAST ON TRUE LINE BETWEEN SECTIONS 5 & 6 . . . 41.80 CHAINS TO FOOT OF SLOPE SET QR SEC POST FROM WHICH A MAPLE 12 IN DIA BEARS S40°W, 15 LINKS (9.90 FEET). AN ALDER 14 IN DIA BEARS S20 1/2°E, 52 LKS (34.32 FEET).*
- [02] COUNTY SURVEY NO 189 (OLD NO. 91) FIELD NOTES (FIELD BOOK NO 7, PAGE 22) BY J A GANONG, D C S , DATED OCTOBER 24, 1910 *1/4 COR 5 & 6, ONE TREE STANDING.*
- [03] COUNTY SURVEY NO 189 (OLD NO 91) MAP BY J A GANONG, D C S , NO DATE GIVEN *1/4 SEC COR -- ORIGINAL.*
- [04] CORNER RESTORATION BOOK NO 1, PAGE 39 BY BENTON COUNTY, NO DATE GIVEN *1/4 SEC COR. SECS. 5 & 6, T11S, R5W SET 4" X 4" X 36" FIR LIMB FOR COR. FROM WHICH A MAPLE 12" DIA. BRS. S12°20'E, 63.3 LKS DIST (41.78 FEET). N.W. ORIGINAL STANDING.*
- [05] BENTON COUNTY CORNER RESTORATION NO 689 *TRANSCRIBED FROM RECORD NO. [04] AND MAY CONTAIN ERRORS AND/OR OMISSIONS.*
- [06] COUNTY SURVEY NO 1226 (OLD NO 287) FIELD NOTES (FIELD BOOK NO 83, PAGE 15) BY W C GALLOWAY, C S , DATED MAY 5, 1934 *SET 3/4" SHAFT IN ROOT OF 45" FIR FROM MAPLE 12" S40°W, 0.15 CHS STANDING. MARKED W. FIR 8" N47°E, 0.371 CHS (24.49 FEET). FIR 45" N70°W, 0.05 CHS (3.30 FEET) SPIKE N.*
- [07] CORNER RESTORATION BOOK NO 1, PAGE 215 BY W. C. GALLOWAY, C S , DATED SEPTEMBER 1937 *1/4 SEC. CORNER BETWEEN SECS. 5 & 6, T. 11-5. SET 3/4" SHAFT IN ROOT OF A 45" FIR. MAPLE 12" IN DIA. BEARS S40°W, 0.15 CHS. STD. MKD. W. FIR 8" DIA BEARS N47°E, 0.371 CHS. MKD FIR 45" IN DIA. BEARS N70°W, 0.050 CHS.*
- [08] BENTON COUNTY CORNER RESTORATION NO 691 *TRANSCRIBED FROM RECORD NO. [07] AND MAY CONTAIN ERRORS AND/OR OMISSIONS.*

NOTES.

THIS IS A MICROSOFT WORD 2000 DOCUMENT NAMED "15200640" CREATED FROM A BOILER PLATE DOCUMENT NAMED "HISTORY", WHICH HAS A STYLESHEET NAMED "CORNER" ATTACHED TO IT

FIRM/AGENCY: BENTON COUNTY SURVEYOR'S OFFICE
ADDRESS: 360 S W AVERY AVE CORVALLIS OR 97333, PH 766-6821
RESEARCH BY: DAVID M DEAN, P L S
DATA ENTRY BY: DEAN

CONIFERS, HARDWOODS
AND BRUSH

CONIFERS, HARDWOODS
AND BRUSH

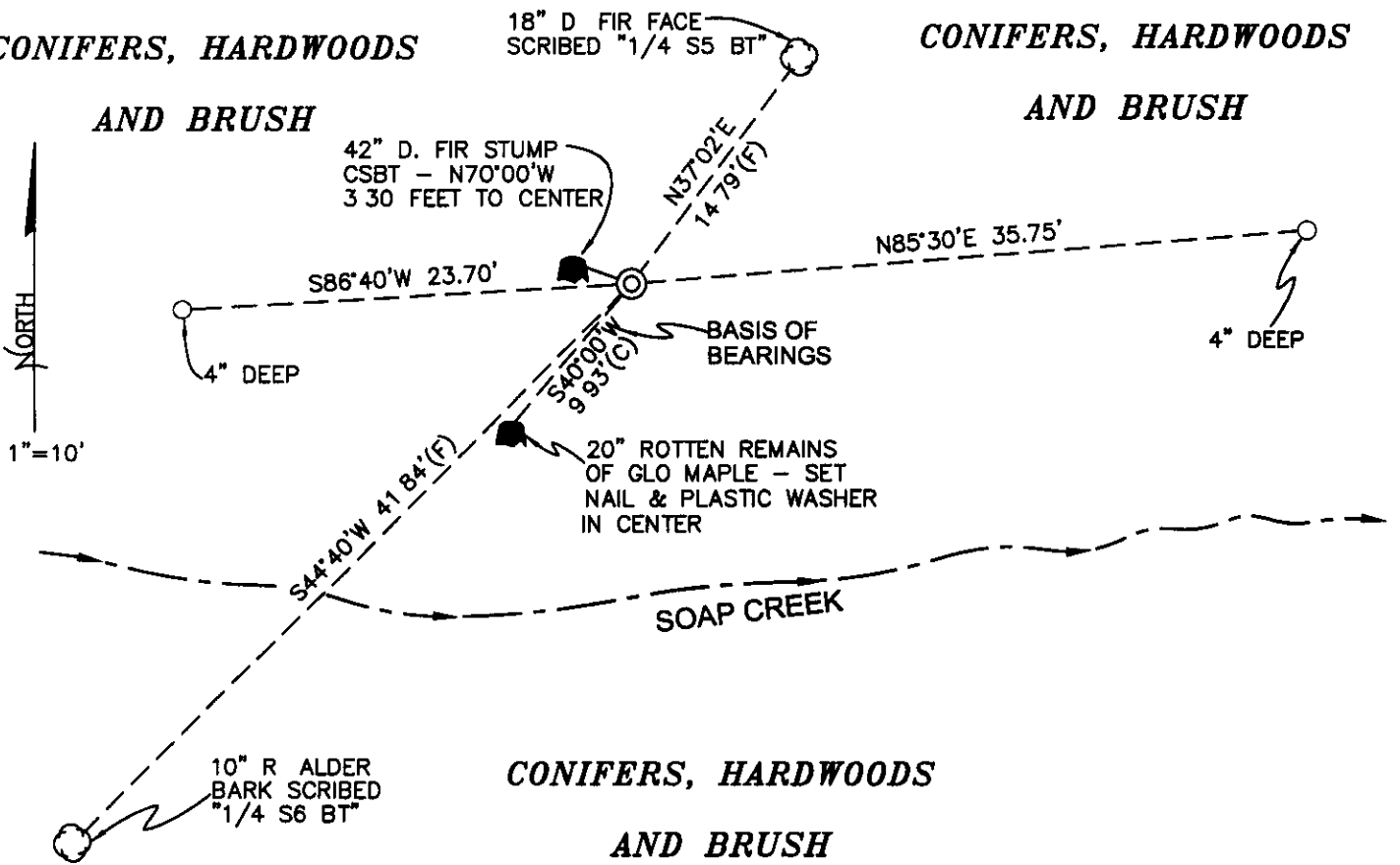

MONUMENT DETAIL

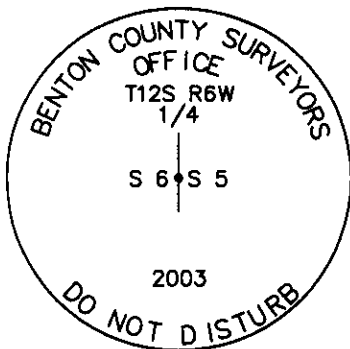

3 1/4" BRASS DISK

LEGEND

- SET 5/8" X 30" REBAR WITH YELLOW PLASTIC CAP MKD "BENTON COUNTY SURVEYOR"
- (F) MEASUREMENT TO FACE
- (C) MEASUREMENT TO CENTER
- ⊙ GOVERNMENT MONUMENT SET AS SHOWN
- ⊙ BEARING TREE AS NOTED
- GLO GENERAL LAND OFFICE

NEW ACCESSORIES

- 1 SET REBAR (SEE LEGEND) S86°40'W, 23.70 FEET, 4" BELOW GROUND LEVEL
- 2 SET REBAR (SEE LEGEND) N85°30'E, 35.75 FEET, 4" BELOW GROUND LEVEL.
- 3 18" D. FIR N37°02'E, 14.79 FEET TO ALUMINUM NAIL AND PLASTIC WASHER ON FACE (15.7' TO CENTER), MARKED "1/4 S5 BT".
- 4 10" R ALDER S44°40'W, 41.84 FEET TO ALUMINUM NAIL AND PLASTIC WASHER ON FACE, BELOW SCRIBING (42.2' TO CENTER). BARK SCRIBED "1/4 S6 BT".

NOTES

COMPASS DECLINATION IS 20' EAST. ALL MEASURED DISTANCES AND BEARINGS ARE TO THE CENTER OF THE OBJECT, UNLESS OTHERWISE NOTED. ALL BEARING TREES ARE PAINTED AND HAVE A B.T. TAG ATTACHED, FACING THE CORNER UNLESS OTHERWISE NOTED. ALL NEW BEARING TREES HAVE A PLASTIC WASHER (STAMPED "BENTON COUNTY SURVEYOR CORNER RESTORATION") ATTACHED (BY ALUMINUM NAIL) TO THE FACE, BELOW THE "BT" FOR DISTANCE AND ANGLE MEASUREMENT UNLESS OTHERWISE NOTED. THE DRAWING IS FROM AUTOCAD RELEASE 2002.

THIS RESTORATION WAS PERFORMED AT THE DIRECTION AND APPROVAL OF THE BENTON COUNTY SURVEYOR, David M. Dean

REGISTERED
PROFESSIONAL
LAND SURVEYOR

12/3/03 David M. Dean

FIRM/AGENCY BENTON COUNTY SURVEYOR'S OFFICE
ADDRESS 360 SW AVERY AVE. CORVALLIS OR 97333; PH 766-6821
PRESENT. DAVID M. DEAN, PLS AND BERNIE ALTENBACH, SURVEY TECH.

OREGON
JULY 13, 1984
DAVID M. DEAN
2090

RENEWAL DATE: 12/31/03