

115340600

CORNER FILE TRACKING

S:\Survey Corners\CORNERS\Templates\Filetrac2.doc
10/04/2010

CORNER NUMBER
115340600

STEP	HISTORY	RESTORATION
Form Prepared, DB	02/13/1998	12/29/17
Field Inspection, DB	12/27/2017	12/27/2017
Finish index (count unit)	02/13/1998	12/27/2017
Counter Index	12/27/2017	12/27/2017
GIS Index Form	12/28/2017	12/28/2017
Checked, DB	12/29/17	12/29/17
Form Edited, DB	1/02/18	1/02/18
Form Signed, DB	1/02/18	1/02/18
Authorize Payment, DB	—	—
Archive Digital Files	1/02/18	1/02/18
Collect Documents	1/02/18	1/02/18
PDF File	1/02/18	1/02/18
Copy For Filming	1/02/18	1/02/18
Scanned (pdf to laserfiche)	1/02/18	1/02/18
Filmed (Archived), DB		
Filed, DB		

(DB) = Entry needed in database (Access).

COMMENTS:

**BENTON COUNTY CORNER RESTORATION FORM, PAGE 1 OF 2, 115340600R2
SEE CORNER HISTORY FORM FOR RECORDS ETC.**

CORNER RESTORATION FIELD BOOK NUMBER 31 PAGE(S) 52 DATE 12/27/2017
TOWNSHIP 11 SOUTH, RANGE 5 WEST, WILLAMETTE MERIDIAN; SECTION 4 CORNER SOUTH 1/4
DONATION LAND CLAIM N/A CORNER N/A
CONDITION REPORT ; REFERENCED OUT ; RENEWED X; SURVEYED IN

LOCATION AND COMMENTS:

CORNER IS LOCATED ON A STEEP NORTHWEST FACING SLOPE IN AN AREA OF MIXED HARDWOODS AND FIRS. TO REACH CORNER FROM THE "SADDLE" PARKING LOT ON SULPHUR SPRINGS ROAD WHERE OSU RESEARCH FORESTS ROAD NO. 600 INTERSECTS SULPHUR SPRINGS ROAD, TRAVEL THROUGH GATE WESTERLY ON ROAD NO. 600 FOR 0.03 MILES TO A WYE, STAY RIGHT ON ROAD NO. 600 FOR 0.03 MILES TO A TRAIL ACCESS ON THE RIGHT AND PARK. WALK ALONG THE TRAIL FOR ABOUT 900 FEET. LEAVE THE TRAIL AND WALK ABOUT 470 FEET S70°W TO THE CORNER. CORNER IS BAD FOR PREMARKING AND GPS CONTROL.

MONUMENTS AND ACCESSORIES FOUND (CONDITION AND SOURCE):

1. FOUND 5/8" IRON ROD WITH YELLOW PLASTIC CAP STAMPED "LS 1084" FOR THE CORNER, FLUSH WITH GROUND SURFACE, FIRMLY SET AND UNDISTURBED.
(SET POST PER RECORD [01]).
(SET 3/4" PIPE PER RECORD [02]).
(CORNER IS 0.70 CHAINS [46.20 FEET] SOUTH OF PIPE SET BY FENCE CORNER PER RECORDS [03] AND [04]).
(48.05 FEET SOUTH OF PIPE AT FENCE CORNER PER RECORD [05]).
(SET A PIPE FROM ORIGINAL OAK PER RECORD [06]).
(PIPE PER RECORD [08]).
(SET 5/8" X 30" IRON ROD WITH PLASTIC CAP MARKED "LS 1084". FOUND REMNANTS OF SQUARED WOOD POST LYING ON GROUND AT CORNER POINT PER RECORD [09]).
2. FOUND DOUBLE TRUNK MAPLE, THE FRONT 16" DIA TRUNK OF WHICH BEARS N22°00'E, 24.45 FEET TO FOUND NAIL IN OPEN FACE. FACE HAS POSSIBLE REMNANTS OF SCRIBE MARKS. **BASIS OF BEARINGS FOR THIS RESTORATION.**
(MAPLE 14" DIA BEARS N28°E, 0.378 CHAINS [24.95 FEET] PER RECORD [03]).
(MAPLE 16" DIA BEARS N22°E, 24.5 FEET TO FACE PER RECORD [05]).
(MARKED MAPLE 16" DIA BEARS N22°E, 0.371 CHAINS [24.49 FEET] TO FACE PER RECORD [06]).
(MAPLE 16" DIA BEARS N22°E, 3.71 [SIC.] CHAINS [244.86 FEET] PER RECORD [08]).
(FOUND MAPLE 18" DIA WITH HEALED FACE BEARS N22°E, 0.371 CHAINS [24.49 FEET] TO FACE. CHOPPED INTO MAPLE, FOUND FACE AND POSSIBLE SCRIBES PER RECORD [09]).
3. FOUND D. FIR 43" DIA WITH HEALED FACE BEARS S84°16'E, 27.88 FEET TO CENTER. FOUND NAIL IN NORTHERLY BASE FOR DISTANCE MEASUREMENT.
(FIR 16" DIA BEARS S80°E, 0.455 CHAINS [30.03 FEET] PER RECORD [03]).
(FIR 16" DIA BEARS S83°E, 28 FEET TO CENTER PER RECORD [05]).
(MARKED FIR 16" DIA BEARS S83°E, 0.424 CHAINS [27.98 FEET] TO CENTER PER RECORD [06]).
(FIR 16" DIA BEARS S83°E, 0.424 CHAINS [27.98 FEET] PER RECORD [08]).
(FOUND FIR 30" DIA WITH HEALED FACE BEARS S83°E, 0.424 CHAINS [27.98 FEET] TO CENTER PER RECORD [09]).
4. FOUND ROTTEN AND BUG EATEN FIR STUMP 24" DIA BEARS N23°05'E, 42.04 FEET TO CENTER. STUMP HAS BEEN CUT OPEN AND THERE IS POSSIBLY A FLAT REVERSE FACE, BUT NO SCRIBE MARKS ARE EVIDENT.
(FIR STUMP BEARS N25°E, 63 LINKS [41.58 FEET] PER RECORD [03]).
5. FOUND GRAND FIR 16" DIA WITH HEALED FACE BEARS N47°13'W, 23.20 FEET TO CENTER. SET ALUMINUM NAIL AND PLASTIC WASHER IN NORTHEASTERLY BASE FOR DISTANCE MEASUREMENT.
(W. FIR 14" DIA BEARS N44°W, 23.2 FEET, MARKED "1/4 S4 BT" PER RECORD [09]).
6. FOUND GRAND FIR 12" DIA WITH HEALED FACE BEARS S24°21'W, 55.99 FEET TO CENTER. SET ALUMINUM NAIL AND PLASTIC WASHER IN SOUTHEASTERLY BASE FOR DISTANCE MEASUREMENT.
(W. FIR 10" DIA BEARS S24°W, 55.7 FEET, MARKED "1/4 S9 BT" PER RECORD [09]).
7. FOUND 2-1/2" BRASS CAP AT THE SOUTHWEST CORNER OF SECTION 4 BEARS N89°06'12"W, 2633.45 FEET AS PER BENTON COUNTY CORNER RESTORATION NO. 115300600R3.
8. FOUND 2-1/4" BRASS CAP AT THE SOUTHEAST CORNER OF SECTION 4 BEARS S89°16'08"E, 2638.54 FEET AS PER BENTON COUNTY CORNER RESTORATION NO. 115400600R2.

MONUMENT SET (PROCEDURES AND DESCRIPTION):

FOUND 5/8" IRON ROD WITH YELLOW PLASTIC CAP STAMPED "LS 1084" FOR THE CORNER, FLUSH WITH GROUND SURFACE, FIRMLY SET AND UNDISTURBED. THE 5/8" IRON ROD WAS SET BY JIM S. PETERSON, P.L.S., IN 1997 FROM TWO BEARING TREES MARKED BY W. C. GALLOWAY, C.S., IN 1936. GALLOWAY REESTABLISHED THE CORNER POSITION FROM AN ORIGINAL GENERAL LAND OFFICE (GLO) BEARING TREE, ALTHOUGH THE SPECIES IS REVERSED FROM THE GLO NOTES. THE 5/8" IRON ROD IS ALSO VERY CLOSE TO THE MIDPOINT OF THE LINE BETWEEN THE SOUTHEAST AND SOUTHWEST CORNERS OF SECTION 4. THE 5/8" IRON ROD IS ACCEPTED AS THE PERPETUATION OF THE ORIGINAL CORNER POSITION.

FOUND WHITE FIBERGLASS POST 5" SOUTHEAST OF 5/8" IRON ROD. OVER THE 5/8" IRON ROD AND IN THE SAME HORIZONTAL POSITION SET A 2" X 31-1/2" GALVANIZED IRON PIPE WITH A 3-1/4" BRASS DISK CEMENTED IN THE TOP, UP 2" ABOVE GROUND SURFACE, AND MARKED AS SHOWN ON PAGE 2 OF 2. SET TWO NEW IRON ROD ACCESSORIES AS SHOWN ON PAGE 2 OF 2. SET 6 FOOT ORANGE CARSONITE "SURVEY MARKER" POST 1 FOOT NORTH OF BRASS DISK.

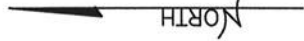

1" = 10'

BASIS OF BEARINGS
COR. REST. BOOK 1, PAGE 214

**HARDWOODS AND
FIR MIX**

C.S.B.T.
16" DOUBLE TRUNK
MAPLE WITH OPENED
FACE AND POSSIBLE
SCRIBE MARKS

N22°00'E 24.45'(F)
BASIS OF BEARINGS

N41°02'03"E 37.73'
N23°05'E 42.04'(C)

N41°02'03"E 37.73'
RPC DOWN 5"

N47°13'W 23.20'(C)

N89°06'12"W 2633.45'

C.S. 9256 B.T.
16" GRAND FIR WITH
HEALED FACE

S89°16'08"E 2638.54'
S84°16'E 27.88'(C)
C.S.B.T.
43" D. FIR WITH
HEALED FACE

FOUND 2-1/4" BRASS
CAP AT THE SOUTHWEST
CORNER OF SECTION 4 AS
PER CORNER RESTORATION
115300600R3

N89°06'12"W 2633.45'

S52°48'22"E 27.84'

S89°16'08"E 2638.54'

S24°21'W 55.99'(C)

FOUND 2-1/2" BRASS
CAP AT THE SOUTHWEST
CORNER OF SECTION 4 AS
PER CORNER RESTORATION
115300600R3

**HARDWOODS AND
FIR MIX**

YPC DOWN 4"

MONUMENT DETAIL

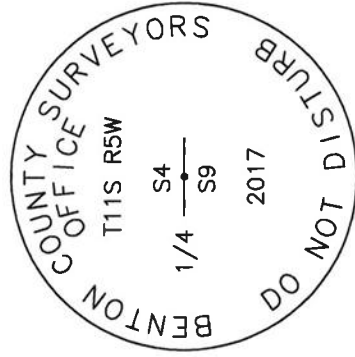

3-1/4" BRASS DISK

LEGEND

- O SET 5/8" X 30" REBAR WITH PLASTIC CAP
- YPC YELLOW PLASTIC CAP MARKED "BENTON COUNTY SURVEYOR"
- RPC RED PLASTIC CAP MARKED "BENTON COUNTY SURVEYOR"
- (F) MEASUREMENT TO FACE
- (C) MEASUREMENT TO CENTER
- ⊙ GOVERNMENT MONUMENT SET AS SHOWN
- GOVERNMENT MONUMENT FOUND AS SHOWN
- C.S. COUNTY SURVEY
- C.S.B.T. COUNTY SURVEYOR'S BEARING TREE
- B.T. BEARING TREE
- 🌳 BEARING TREE STUMP AS NOTED
- 🌳 BEARING TREE AS NOTED

NEW ACCESSORIES:

1. SET REBAR (SEE LEGEND) N41°02'03"E, 37.73 FEET AND 5 INCHES BELOW GROUND LEVEL.
2. SET REBAR (SEE LEGEND) S52°48'22"E, 27.84 FEET AND 4 INCHES BELOW GROUND LEVEL.

NOTES:

COMPASS DECLINATION IS 16' EAST. ALL MEASURED DISTANCES AND BEARINGS ARE TO THE CENTER OF THE OBJECT, UNLESS OTHERWISE NOTED. ALL BEARING TREES ARE PAINTED AND HAVE A B.T. TAG ATTACHED, FACING THE CORNER UNLESS OTHERWISE NOTED. ALL NEW BEARING TREES HAVE A PLASTIC WASHER (STAMPED "SURVEY MARKER DO NOT REMOVE") ATTACHED BY AN ALUMINUM NAIL TO THE SIDE CENTER OF THE TREE FOR DISTANCE MEASUREMENT, UNLESS OTHERWISE NOTED.

THIS RESTORATION WAS PERFORMED AT THE DIRECTION AND APPROVAL OF
THE BENTON COUNTY SURVEYOR *[Signature]*

REGISTERED
PROFESSIONAL
LAND SURVEYOR

01/02/18 *[Signature]*

OREGON
JANUARY 12, 1999
DAVID L. MALONE
51523

FIRM/AGENCY: BENTON COUNTY SURVEYOR'S OFFICE
ADDRESS: 360 S.W. AVERY AVE., CORVALLIS, OR 97333; PH. 541-766-6821
PRESENT: DAVID L. MALONE, P.L.S., BERNARD ALTENBACH, SURVEY TECH.,
AND TREVOR SARTNURAK, OSU RESEARCH FORESTS INTERN.

EQUIPMENT: NIKON NIVO3.C WITH SURVEY PRO ONBOARD.

RENEWAL DATE: 12/31/18

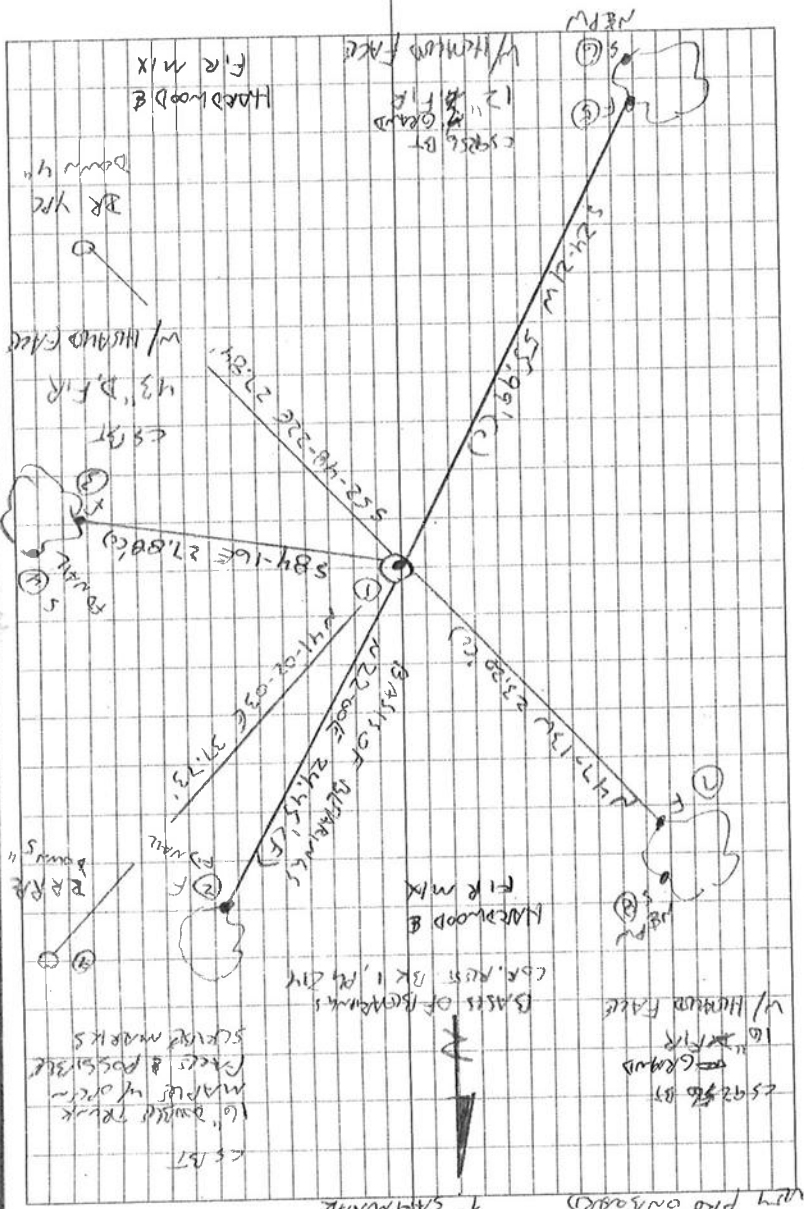

12/27/2017
 D. MONTGOMERY
 G. ALLENBACH
 T. SAMPSON
 Nikon n303c
 Survey pro onboard
 3/52

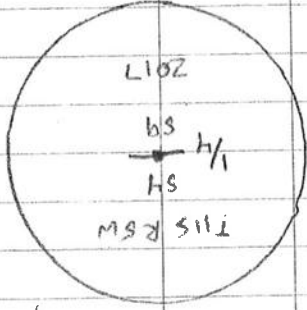

3-1/4" BRASS DISK
 THIS RSW
 1/4
 SH
 SQ
 2017
 PLASTIC CAP MARKED
 "ASTORIA COUNTY SURVEYOR"
 NBPW = MAIL B PLASTIC WAGON
 STAMPED "SURVEY MARKER"
 DO NOT REMOVE

FD 5/8" IR W/ YPC MARKED "LS 1084"
 FLUSH W/ GROUND SURFACE, FIRMLY SET
 & UNDISTURBED FOR THE CORNER. FD WITHIN
 FIREGLASS POST 5" SE OF YPC. FD COSTS.
 HEAD NE MAPLE BT FOR BASIS OF BERRANKS.
 FD C9256 BT. OVER THE IRAN ROD, IN THE
 SAME HORIZONTAL POSITION, SET 2" x 3 1/2" G.I.P.
 W/ 3-1/4" BRASS DISK CEMENTED IN THE TOP UP 2"
 ABOVE GROUND SURFACE, SET TWO NEW IRAN ROD.
 ACCESSORIES. FD BARR W/ IR REMAINS ABOUT 0.70 CHAINS
 NORTH. FD FIRE STUMP THAT HAS NEVER PREVIOUSLY OPENED.
 POSSIBLY STUMP THD BY LARSEN AT ORIGINAL G.O. ST. POSSIBLE
 REVERSE FACE NOT NO VISIBLE SCISSOR MARKS. STAMP IS
 ROTARY & PUL. PATERN. SET 6 FEET ORANGE CARBORUNDUM
 "SURVEY MARKER" POST 1' NORTH OF BRASS DISK.

REMOVEMENT T 115 RSW 1/4
 115340600
 9/4

DATE 02/13/1998TOWNSHIP 11 SOUTH, RANGE 5 WEST, WILLAMETTE MERIDIAN; SECTION 4 CORNER S 1/4
DONATION LAND CLAIM CORNER**COMMON CORNER(S):**

THE NORTH QUARTER CORNER OF SECTION 9.

CORNER RECORDS (PREVIOUS RENEWALS, SURVEYS, ETC.)

- [01] ORIGINAL GLO SURVEY BY GEORGE W. HYDE, APPROVED AUGUST 12, 1852. **SET POST WITH TWO BEARING TREES MEASURED TO THE FACE.**
- [02] COUNTY SURVEY NO. 1305 BY WALTER W. LARSEN (NO DATE GIVEN, FIELD BOOK NO. 51, PAGE 5). **SET 3/4" PIPE AT 1/4 CORNER (FIELD BOOK NO. 51, PAGE 8), THEN "MOVED" 1/4 CORNER TO MID-POINT.**
- [03] COUNTY SURVEY NO. 1203 BY WALTER W. LARSEN DATED APRIL 5, 1933 (FIELD BOOK NO. 52, PAGE 14, OLD SURVEY NO. 287). **FOUND ORIGINAL BEARING TREES (REVERSED SPECIES), CORNER IS 0.70 CHAINS SOUTH OF PIPE SET BY FENCE CORNER ESTABLISHED TWO NEW BEARING TREES.**
- [04] MAP NO. 11-5-00005 BY BENTON COUNTY (NO DATE GIVEN). **CORNER IS 0.70 CHAINS SOUTH OF PIPE SET BY FENCE CORNER.**
- [05] COUNTY ROAD NO. 612 (OLD NO.) BY W. C. GALLOWAY, DATED JANUARY 20, 1936, (FIELD BOOK NO. 89, PAGE 48). **REVERSED SPECIES ON ORIGINAL BEARING TREES, SHOWS RECORD [03] BEARING TREES WITH DIFFERENT TIES, SHOWS ADDITIONAL INFORMATION AND TIES.**
- [06] OLD CORNER RESTORATION BOOK NO. 1, PAGE 214 BY W. C. GALLOWAY, DATED JANUARY 20, 1936. **FOUND ORIGINAL BEARING TREE (REVERSED SPECIES), SET PIPE, USED RECORD [03] BEARING TREES WITH DIFFERENT TIES.**
- [07] CORNER RESTORATION NO. 688. **THIS IS A TRANSCRIBED COPY OF RECORD [06] AND MAY CONTAIN ERRORS AND OMISSIONS.**
- [08] MAP NO. 11-5-00006 BY BENTON COUNTY (NO DATE GIVEN). **PIPE WITH THREE BEARING TREES, ONE DISTANCE IS DIFFERENT.**
- [09] COUNTY SURVEY NO. 9256 BY JIM PETERSON, DATED AUGUST 26, 1997. **FOUND TWO RECORD [03] BEARING TREES, SET REBAR AND CAP WITH RECORD [06] TIES, ESTABLISHED TWO NEW BEARING TREES.**

COMMENTS/LOCATION/EIC:

RECORD [02]: WALTER LARSEN INITIALLY SETS A 3/4" PIPE, FOR THE QUARTER CORNER, AT THE NORTHERLY END OF HIS TRAVERSE THROUGH THE CENTER OF SECTION 9. THIS POINT MAY HAVE BEEN AT A FENCE CORNER. HE THEN RESETS THE QUARTER CORNER 36.23' EASTERLY AND 49.89' NORTHERLY OF A HUB ON HIS EAST-WEST TRAVERSE LINE BETWEEN SECTIONS 4 AND 9. HE BELIEVES THE QUARTER CORNER IS NOW AT THE MID-POINT OF THE SECTION LINE BETWEEN SECTIONS 4 AND 9, WITHOUT OFFERING AN EXPLANATION FOR THE CHANGE. THIS POSITION IS S 40° 41' 55" E ~ 59.89' FROM THE 3/4" PIPE.

RECORD [03]: LARSEN CLAIMS TO HAVE FOUND THE ORIGINAL BEARING TREES AT THE MID-POINT, EXCEPT HE REVERSES THE SPECIES CALLED FOR IN THE ORIGINAL NOTES. HE GOES ON TO SAY THE QUARTER CORNER IS 46.2' SOUTH OF A PIPE BY A FENCE CORNER AND DESCRIBES TWO NEW BEARING TREES FOR THE QUARTER CORNER.

RECORD [05]: W. C. GALLOWAY SHOWS THE ORIGINAL BEARING TREES WITH THE SPECIES REVERSED. HE ALSO SHOWS DIFFERENT TIES TO LARSENS NEW BEARING TREES FROM RECORD [03] THAT INDICATE THE POSITION OF THE QUARTER CORNER WILL MOVE ABOUT S 60° E ~ 2.1'.

RECORD [06]: GALLOWAY SETS A PIPE FOR THE QUARTER CORNER, FROM AN ORIGINAL BEARING TREE (SPECIES REVERSED) AND REFERENCES IT WITH HIS TIES FROM RECORD [05]. TO LARSENS NEW BEARING TREES FROM RECORD [03], WITH THE SAME EFFECT IN POSITION AS RECORD [05].

RECORD [09]: JIM PETERSON AND CURT LIESENFELT DID NOT FIND THE PIPE PURPORTED TO BE AT THE CORNER OR THE PIPE 46.2' NORTHERLY, EVEN THOUGH THE CONDITION OF THE FOREST INDICATED THEY SHOULD BE THERE. THEY DID FIND EVIDENCE OF A BARBED WIRE FENCE 46' NORTHERLY AND A SMALL PIECE OF OAK LAYING ON TOP OF THE GROUND NEAR THE POSITION OF THE ORIGINAL SOUTHEAST BEARING TREE..

BOTH LARSEN AND GALLOWAY CLAIM TO HAVE FOUND ORIGINAL EVIDENCE THAT WOULD PUT THE QUARTER CORNER AT WHAT THEY BELIEVE TO BE THE MID-POINT OF THE SECTION LINE. THE DIFFERENCE BETWEEN THEIR POSITIONS (2.1') CAN BE ACCOUNTED BY LARSEN USING MOVES RELATED TO HIS EAST-WEST TRAVERSE (36.23' EASTERLY AND 49.89' NORTHERLY), WHILE GALLOWAY USED CARDINAL MOVES RELATED TO LARSENS NORTH-SOUTH TRAVERSE (46.2' SOUTHERLY AND 41.91' EASTERLY) TO POSITION THE QUARTER CORNER.

IN NOVEMBER OF 1997 CURT LIESENFELT RECOMPUTED RECORD [02] FROM THE FIELD NOTES. SOME OF THESE CORNERS WERE COMMON TO CORNERS TIED IN RECORD [09]. COMPARING THE BEARINGS AND DISTANCES BETWEEN THEM INDICATED THE CORNER COMMON TO SECTIONS 3, 4, 9, AND 10 AND THE QUARTER CORNER BETWEEN SECTIONS 9 AND 10 ARE ABOUT 33' FARTHER EAST THAN WHAT RECORD [04] SHOWS. THE FIELD NOTES WERE EXAMINED WITHOUT SUCCESS FOR AN ERROR THAT WOULD ACCOUNT FOR THIS. ON DECEMBER 10, 1997 CURT LIESENFELT MEASURED BY HIP CHAIN (STRING BOX) 2704' FROM THE RECORD [09] MONUMENT AT/NEAR THIS QUARTER CORNER TO THE CORNER COMMON TO SECTIONS 3, 4, 9, AND 10. THIS IS ABOUT 70' LONGER THAN RECORD [04].

AT THIS TIME BENTON COUNTY IS NOT PREPARED TO ACCEPT THE RECORD [03] BEARING TREES OR THE RECORD [09] MONUMENT AS BEST EVIDENCE OF THE CORNER. IT APPEARS THAT WHATEVER ACTION REMOVED THE TWO PIPES SET IN RECORDS [02] AND [09] WAS DONE SO DELIBERATELY AS OPPOSED TO ACCIDENTLY. THIS OFFICE BELIEVES THE QUARTER CORNER BETWEEN SECTIONS 3 AND 4 AND THE CORNER COMMON TO SECTIONS 3, 4, 9, AND 10 SHOULD BE TIED INTO RECORD [09]. THIS INFORMATION SHOULD BE ANALYZED FOR CONFORMANCE TO RECORDS [02] AND [04]. NEW SEARCH AREAS SHOULD BE IDENTIFIED AND SEARCHED FOR PHYSICAL EVIDENCE. THE BEARING TREES RECOVERED IN RECORD [09] SHOULD EXAMINED FOR IDENTIFYING MARKS. THE RESTORATION PROCESS MAY NOT BE LIMITED TO THE PREVIOUSLY DESCRIBED TASKS.

NOTES:

THIS IS A MICROSOFT WORD (VERSION 6.0) DOCUMENT NAMED "15340600" CREATED FROM A BOILER PLATE DOCUMENT NAMED "HISTORY", WHICH HAS A STYLESHEET NAMED "CORNER" ATTACHED TO IT.
INFORMATION IN ***BOLD ITALICS*** IS COUNTY STAFFS' INTERPRETATION OF THE RECORD.

FIRM/AGENCY: BENTON COUNTY SURVEYOR'S OFFICE**ADDRESS:** 360 S.W. AVERY AVE. CORVALLIS OR 97333; PH. 757-6821**RESEARCH BY:** CURTIS J. LIESENFELT**DATA ENTRY BY:** ROSE LINDGREN

CORNER RESTORATION BOOK NO. 1

C.S. #249
W.C. Galloway
Witnesses
Rudolph Stewart
Geo. Harris
Gerald Harris
Oct 5, 1936

Witnesses as
above except
Geo. Harris
Oct. 6, 1936

1/4 C 1/4 Sec. Corner between Secs. 30 & 31 T 11-6
Set a 1" Pipe
Mtd. a fir 14" in dia. bears N 4° 30' E. 325 cks.
" " " " " N 66° 30' W. 214 " "
" " " " " S. 29° W. 80 " " std.
" " " " " N. 33° W. 141 " " lying down.

1/4 Section Corner between Sections 31 T. 11-6 & 6 T-12-6
Set a 3/4" x 20" bolt set from an
Oak 10" in dia. bears S. 28° W. .35 std. green (found 870 ft. 30" & 14" ^{mp})
Marked fir 22" in dia. bears N 27° E. .495
" " 14" " " " S. 86° W. .433

Witnesses
R.T. Stewart
Gerald Harris
Oct. 9, 1936

1/4 Sec. Corner between Sections 31 T 11-6 & 36 T 11-7
Set a 3/4" iron rod 56" long from (in same direction before getting to corner)
Fir 80" N. 4° E. .70 cks. burned down. (Maple gone)
Mtd. a fir 28" in dia. bears N. 66° E. .487
" " 4" " " " S. 31° 45' E. .434
" " 1" Maple 15" " " " N. 85° 30' W. .360
" " fir 17" " " " " N. 88° 30' W. .989

C.S. 205
W.C. Galloway
Rudolph J. Stewart
Adrian Seils
Sept. 1937.

S.E. corner of Smiley Carter D.L.C. 50 T 10-4
Set a 1 1/2" shaft set from orig. trees,
Marked Fir 22" in dia. bears N. 75° E. .230 (marked for measure N)
" " 22" " " " S. 20° E. .198 (marked on N. for measure)
" Forked Oak 24" " " " N. 86° 30' W. 1.104 (spike on N.)

C.S. #131
Witness
Rudolph Stewart
by W.C. Galloway
Jan. 1936

Corner to Secs. 24, 25, 19 & 30 T. 10 S Rs. 4 & 5 W.
Set an angle iron 46" long from orig. trees.
Oak 20" in dia. bears S. 58° 20' E. 2.20 cks. std.
" 18" " " " N. 41° 30' W. 2.13 " "

C.S. #337
Oct. 13, 1937
Witnesses
R.J. Stewart
Adrian Seils
by W.C.G.

Corner to Sections 28, 29, 32 & 33 T 10-5
Set a 3/4" Galv.
Fir 8" in dia. bears N. 53° 15' E. 2.72 std. to face.
" 8" " " " S. 70° E. .328 " measure to face
Mtd. Maple 9" " " S. 18° 20' W. .202
Oak 24" in dia. " " N. 47° W. .95 " "
Sand stone 2 Ft. x 4 Ft. x 8" North .060 center
Cherry stub 8" in dia. bears S 72° W. .20 std.

C.S. 287
by W.C. Galloway
James Johnson and
Adrian Seils
Jan. 20, 1936

1/4 Sec. Cor. between Secs. 4 & 9 T 11-5
Set a pipe from orig. Oak 12" S. 5° E. 100 lks.
Marked Maple 16" in dia. bears N. 22° E. .371 to face
" " " " " S. 83° E. .424 chr. to center.



$\frac{1}{4}$ -Section corner between sections 4 and 9, Twp. 11-5

Reestablishment by W. C. Galloway

Set a pipe, from original Oak 12" S 5° E
Maple 16" in diam bears N 22° E
Fir 16" in diam bears S 83° E

Witness James Johnston

January 20, 1936

100 links
.371 chains
.424 chains

688
2016