

CORNER FILE TRACKING

F:\Survey\Corners\Misc\Filetrac.doc

8/11/97

CORNER NUMBER
115500400

STEP	HISTORY()	RESTORATION()
Form Prepared, DB	12/16/97	—
Field Inspection, DB	—	
Form Checked, DB	12/22/97	5/2/96
Form Edited, DB	"	—
Form Signed, DB	—	—
Authorize Payment, DB	—	—
Archive Digital Files	12/22/97	—
Collect Documents	"	12/22/97
Copy For Filming	"	"
Filmed	6/30/98	6/30/98
Scanned (Archived), DB	7/16/98	7/16/98
Indexed		
Update Database		
Filed, DB		

(DB) = Entry needed in database (Access).

COMMENTS:

246

E.S. 54
 by W.C. Galloway
 1/4 Sec. Cor. bet. Secs. 18 & 19, T. 14 S. R. 7 W.
 Set 1" X 40" Shaft, found original stake
 Cedar 36" in dia. bears N. 45° W. 60, Nail N. 38° 49' W. 594
 " 36" " " S. 25° W. 095, Screw S. 5° 20' W. 090
 Lower near corner of stone S. 55° 45' W. 0585

C.S. 105
 by W.C. Galloway
 V.M. Fallerson Chn.
 Apr. 16, 1946
 S.W. Corner of John Robinson D.L.C. #44 T. 11 S. R. 5 W.
 Set a Stone 6" X 10" X 16"
 Oak 24" in dia. bears S. 52° 30' E. 2.52 chn. std.
 " 24" " " S. 31° 30' W. 2.95 " " dead.
 Mk'd. " 20" " " S. 11° 20' W. .769 "

"
 Apr. 17, 1946
 Corner to section 14, 15, 22 & 23 T. 11 S. R. 5 W.
 Set 1 1/2" Pipe, 24" long
 Oak Stump N. 32° E. .53
 " " S. 37° E. .43 b. 16 blazes
 " " 40" S. 56 1/2° W. 1.33 lower blaze
 " " 36" N 70° W. 1.25 " "
 Mk'd. " 10" in dia. bears N. 28° E. .110
 " Fir 5" " " N. 64° E. .177
 " " 24" " " S. 35° E. .362
 " " 12" " " S. 73° W. .022

1/4 Sec. Corner bet. Secs. 22 & 23 T. 11 S. R. 5 W.
 (cont. on) L.H. in center. 10" under.

Corner to section 14, 15, 22 and 23, Twp. 11 S., R. 5 W.

711

Reestablishment by W. C. Galloway

April 17, 1946

Set $1\frac{1}{2}$ " pipe, 24" long

Oak stump N 32° E

Oak stump S 37° E

Oak stump 40" bears S 56 $\frac{1}{4}$ ° W

Oak stump 36" in diam bears N 70° W

Oak 10" in diam bears N 28° E

Fir 5" in diam bears N 64° E

Fir 24" in diam bears S 35° E

Fir 12" in diam bears S 73° W

.53 chains

.43 chains

1.33 chains

1.25 chains

.110 chains

.177 chains

.362 chains

.022 chains

Witness V. M. Patterson

T. 11 S, R. 5 W, W. B. & M., BENTON COUNTY, OREGON

SECTION 14

REPORTED BY PETE McDowell

TITLE SURVEY TECH.

DATE 4-11-1986

D. INGRAM, B.C.S.

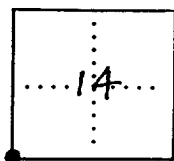

● OFFICIAL CORNER FOUND

○ CORNER SET

SEC CORNER COMMON TO SEC. 14, 15, 22 & 23
 2 1/2" O.D. X 36" PIPE W/ 2 1/2" BRASS CAP
 DESCRIBE

ADDITIONAL INFORMATION

(SEE DETAIL ON REVERSE), 40" IN GROUND
 IN CONCRETE WATER METER BOX. 4/3/86
 FD. 1/4" I.D. X 24" PIPE LYING HORIZONTAL
 1° BELOW SURFACE OF RECENT FILL. USED
 RECENT FIELD NOTES TIE FROM CS 7786
 & SWING TIES FROM BTs, EXCAVATED & FD.
 ORIGINAL RUST HOLE, SET NEW MON. FD.
 ROTTED REMAINS OF GALLOWAY BT SW'LY
 1.5'. COR. LIES 33' S. OF GARAGE
 FOUNDATION SITE (UNDER CONST.) @
 1863 NW LESTER AVE.

OVER

LEGIBLE MARKS ON BEARING OBJECTS

	FD	FD	SET
	HEALED FACE	HEALED FACE	SET RR SPIKE IN E. BASE
	SET RR SPIKE IN S. BASE	SET RR SPIKE IN G. BASE	
KIND	D. FIR	D. FIR	D. FIR
SIZE	30"	28"	24"
*BEARING	N 66° 28' W	N 64° E	S 3° 10' E
*DISTANCE	18.88'	11.85	72.47
BT TAG POSTED	YES	YES	YES

* DIST. TO SPIKE, BRG TO TREE &

LEGEND

- () RECORD DATA
- R1 COR. REST. #711
- R2 CS 6605

● BLAZED & SCRIBED "BT" ON D. FIR AS SHOWN, SET RR SPIKE IN BASE, DIST. TO SPIKE, BRG. TO TREE & POSTED TAG.

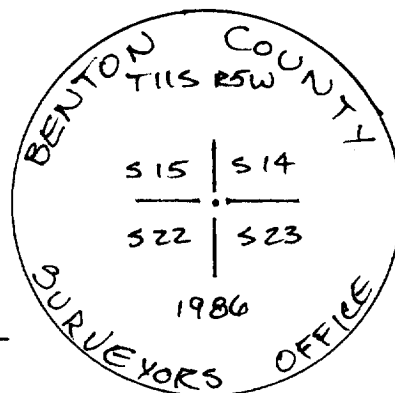
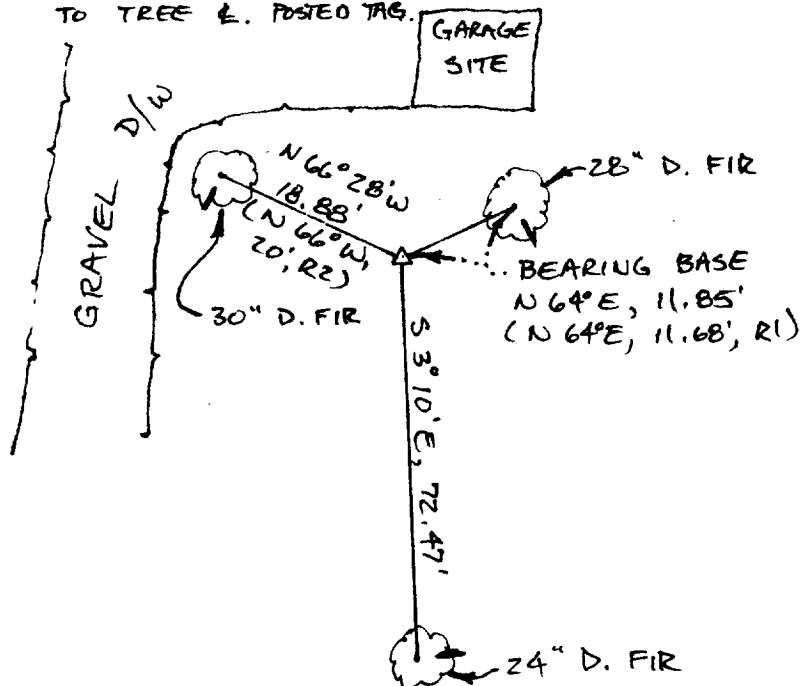

BRASS CAP DETAIL

REGISTERED PROFESSIONAL LAND SURVEYOR
 Danna L. Ingram
 OREGON JULY 16, 1982
 DANNA L. INGRAM 1995

DATE 12/16/1997TOWNSHIP 11 SOUTH, RANGE 5 WEST, WILLAMETTE MERIDIAN; SECTION 14 CORNER SW
DONATION LAND CLAIM _____ CORNER _____**COMMON CORNER(S):**

THE SOUTHEAST CORNER OF SECTION 15.
THE NORTHEAST CORNER OF SECTION 22.
THE NORTHWEST CORNER OF SECTION 23.

CORNER RECORDS (PREVIOUS RENEWALS, SURVEYS, ETC.)

- [01] ORIGINAL GLO SURVEY BY GEORGE W. HYDE, DATED AUGUST 12, 1852. *SET POST WITH FOUR BEARING TREES, MEASURED TO THE FACE.*
- [02] COUNTY SURVEY NO. 1768 BY W. C. GALLOWAY, DATED APRIL 15, 1946 (FIELD BOOK NO. 92, PAGE 54). *FOUND ORIGINAL BEARING TREES, SET 1 1/2" X 24" PIPE WITH ONE OAK AND THREE FIR BEARING TREES.*
- [03] OLD CORNER RESTORATION BOOK NO. 1, PAGE 246 BY W. C. GALLOWAY, DATED APRIL 17, 1946. *SAME INFORMATION AS RECORD [02].*
- [04] CORNER RESTORATION NO. 711. *THIS IS A TRANSCRIBED COPY OF RECORD [03] AND MAY CONTAIN ERRORS AND OMISSIONS.*
- [05] MAP NO. 11-5-00012 BY W. C. GALLOWAY, DATED MARCH 30, 1949. *1 1/4" PIPE WITH ONE OAK AND THREE FIR BEARING TREES.*
- [06] COUNTY SURVEY NO. 2463 BY OTTO MEYER, DATED MARCH 15, 1953. *NO MONUMENT DESCRIPTION.*
- [07] COUNTY SURVEY NO. 5014 BY JOHN GANNON, DATED NOVEMBER 10, 1968. *FOUND 1 1/4" PIPE, TIED ONE FIR.*
- [08] COUNTY SURVEY NO. 6605 BY DONALD CORMACK, DATED MARCH, 1978. *FOUND 1 1/2" PIPE AND TWO BEARING TREES, TIED ONE NEW BEARING TREE.*
- [09] COUNTY SURVEY NO. 7279 BY MARVIN ROWLEY, DATED JANUARY 2, 1981. *1 1/4" IRON PIPE.*
- [10] COUNTY SURVEY NO. 7346 BY JIM BLAIR, DATED OCTOBER 15, 1981. *FOUND 1 1/4" IRON PIPE PER RECORD [07].*
- [11] COUNTY SURVEY NO. 7698 BY DANNA INGRAM, DATED SEPTEMBER 24, 1984. *SAME INFORMATION AS RECORD [10].*
- [12] COUNTY SURVEY NO. 7786 BY TED LANGTON, DATED NOVEMBER 27, 1985. *FOUND 1 1/2" IRON PIPE.*
- [13] CORNER RESTORATION NO. 3386 BY DANNA INGRAM, DATED APRIL 11, 1986. *FOUND TWO BEARING TREES AND RUST RING, SET BRASS CAP WITH ONE NEW BEARING TREE.*
- [14] CITY OF CORVALLIS CONTROL BY WARREN DEGLOW, DATED APRIL 7, 1989. *FOUND BRASS CAP, ESTABLISHED STATE PLANE COORDINATES.*
- [15] COUNTY SURVEY NO. 8381 BY DANNA FEHRENBACHER, DATED NOVEMBER 25, 1989. *FOUND 2 1/2" BRASS CAP.*

COMMENTS/LOCATION/ETC:

ON MAY 2, 1996 CURT LIESENFELT VISITED THIS CORNER AT THE LANDOWNERS (BILL FORD) REQUEST. THE NORTHEAST BEARING TREE IS DEAD AND WILL BE REMOVED BY THE OWNER SOMETIME IN THE FUTURE. WE REQUESTED THE LANDOWNER LEAVE A WAIST HIGH STUMP. THE TAG WAS LOWERED ACCORDINGLY.

NOTES:

THIS IS A MICROSOFT WORD (VERSION 6.0) DOCUMENT NAMED "15500400" CREATED FROM A BOILER PLATE DOCUMENT NAMED "HISTORY", WHICH HAS A STYLESHEET NAMED "CORNER" ATTACHED TO IT.
INFORMATION IN ***BOLD ITALICS*** IS COUNTY STAFFS' INTERPRETATION OF THE RECORD.

FIRM/AGENCY: BENTON COUNTY SURVEYOR'S OFFICE
ADDRESS: 360 S.W. AVERY AVE. CORVALLIS OR 97333; PH. 757-6821
RESEARCH BY: CURTIS J. LIESENFELT
DATA ENTRY BY: ROSE LINDGREN