

CORNER FILE TRACKING

H:\Survey\Corners\Misc\Filetrac.doc

11/23/98

CORNER NUMBER
115844010

STEP	HISTORY(H)	RESTORATION()
Form Prepared, DB	1/24/00	N/A
Field Inspection, DB	N/A	N/A
Form Checked, DB	1/24/00	N/A
Form Edited, DB	1/24/00	N/A
Form Signed, DB	N/A	N/A
Authorize Payment, DB	N/A	N/A
Archive Digital Files	2/8/00	—
Collect Documents	"	2/8/00
Scanned	2/11/00	2/11/00
Copy For Filming	2/8/00	2/8/00
Filed, DB		
Finish index (count unit)		
Filmed (Archived), DB		

(DB) = Entry needed in database (Access).

COMMENTS:

2/9/00 SCAN INTO NEW FILE

N. W. Corner of William Knotts DLC 45, Twp 11 S R 5 W

761

Reestablishment by W. C. Galloway

Date 4-5-1909

Set Oak stake 3 x 4 x 36" for corner. Tree and stumps standing
Ash 6" in diam bears N. 71° 50' E 7.6 feet distant
Ash 15" in diam bears S 22° 50' E 121.4 feet distant
Ash 8" in diam bears S 62° 30' W 6.5 feet distant
Witnesses, William Knotts, Birt Reed and W. F. Gay.

BENTON COUNTY CORNER RESTORATION FORM

3864

SECTION 14 TOWNSHIP 11 S RANGE 5 W DLC JOHN ROBINSON NO. 44 CORNER NE
 DATE 12/13/90 CORNER RESTORATION FIELD BOOK NUMBER 2 PAGE 18

CORNER DESIGNATION:

THE NORTHEAST CORNER OF THE JOHN ROBINSON DLC NO. 44, IN T 11 S, R 5 W, WILLAMETTE MERIDIAN.

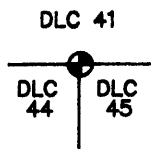

- CONDITION REPORT ONLY
- REFERENCED OUT
- RENEWED
- SURVEYED IN

LOCATION AND COMMENTS:

THE CORNER IS LOCATED 2.5 FEET NORTHERLY FROM AN OLD EAST-WEST WOVEN AND BARBED WIRE FENCE, APPROXIMATELY 3 FEET EASTERLY FROM A NORTH-SOUTH WOVEN AND BARBED WIRE FENCE LINE PROJECTED NORTHERLY AND 10 FEET NORTHERLY FROM AN EAST WEST OVERHEAD POWER LINE.

PREVIOUS RENEWALS/SURVEYS, ETC.:

- ORIGINAL GLO SURVEY BY DENNIS HATHORN IN 1861.
- CORNER RESTORATION NO. 761 BY F. MARION WILKES ON APRIL 5, 1909.
- COUNTY SURVEY NO. 113 BY F. MARION WILKES ON APRIL 5, 1909.
- MAP NO. 11-5-00004 BY W.C. GALLOWAY (NO DATE GIVEN).
- COUNTY SURVEY NO. 2436 BY MARTIN BEYERLEIN ON NOVEMBER 5, 1952.
- COUNTY SURVEY NO. 2463 BY OTTO MEYER ON MARCH 15, 1953.
- COUNTY SURVEY NO. 3722 BY FRED LEMKE ON AUGUST 8, 1962.
- COUNTY SURVEY NO. 3948 BY HOWARD TAYLOR ON JULY 10, 1964.
- COUNTY SURVEY NO. 4256 BY HOWARD TAYLOR ON APRIL 12, 1966.
- COUNTY SURVEY NO. 7975 BY DARRYL HARMS ON FEBRUARY 24, 1987.

MONUMENTS AND ACCESSORIES FOUND (CONDITION AND SOURCE):

- FOUND: 1/2" INSIDE DIAMETER IRON PIPE WITH THE TOP 0.9 FOOT BENT 0.1 FOOT EASTERLY FOR THE CORNER (MAP NO. 11-5-00004).
 - FOUND: A STUMP HOLE WITH THE MOSTLY ROTTED REMAINS OF AN ASH STUMP ABOUT 12" IN DIAMETER LAYING TO THE SOUTH, BEARS S 68° W 6.5 FEET (N 62° 30' W 6.5 FEET CORNER RESTORATION NO. 761).
 - FOUND: A STUMP HOLE WITH SOME PIECES OF ASH NEAR BY, BEARS N 76° E 7.6 FEET (N 71° 50' E 7.6 FEET CORNER RESTORATION NO. 761).
- NO OTHER RECORD BEARING OBJECTS WERE RECOVERED.

MONUMENT DETAIL

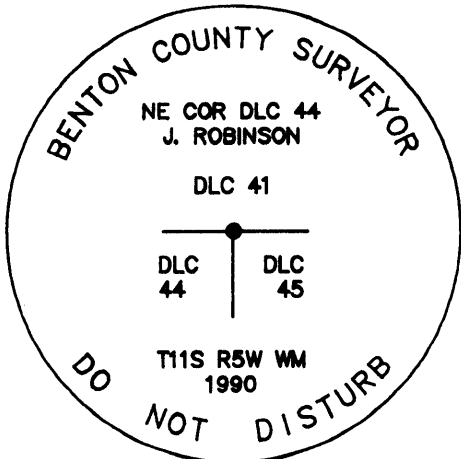

3 1/4" BRASS CAP



SKETCH

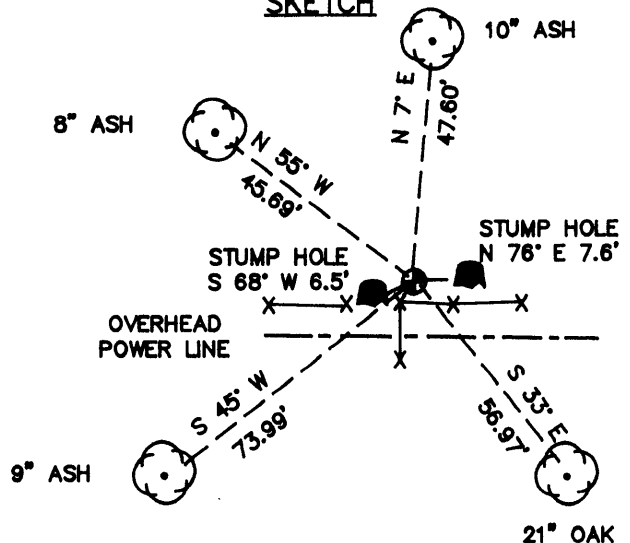

MONUMENT SET (PROCEDURES AND DESCRIPTION):

SET: 2" INSIDE DIAMETER X 36" LONG IRON PIPE WITH A 3 1/4" BENTON COUNTY BRASS CAP STAMPED AS SHOWN CENTERED OVER THE STRAIGHT BASE OF THE RECOVERED 1/2" IRON PIPE.

NEW ACCESSORIES:

- AN ASH 10" IN DIAMETER BEARS N 7° E 47.60 FEET FACED AND SCRIBED "DLC 41 BT". SET A PK NAIL AND B.C.B.W. IN THE WESTERLY BASE. SET A B.T. TAG ON THE SOUTHERLY FACE.
- AN OAK 21" IN DIAMETER BEARS S 33° E 56.97 FEET FACED AND SCRIBED "DLC 45 BT". SET A PK NAIL AND B.C.B.W. IN THE NORTHEASTERLY BASE. SET A B.T. TAG ON THE NORTHWESTERLY FACE.
- AN ASH 9" IN DIAMETER BEARS S 45° W 73.99 FEET FACED AND SCRIBED "DLC 44 BT". SET A PK NAIL AND B.C.B.W. IN THE SOUTHEASTERLY BASE. SET A B.T. TAG ON THE NORTHEASTERLY FACE.
- AN ASH 8" IN DIAMETER BEARS N 55° W 45.69 FEET FACED AND SCRIBED "DLC 41 BT". SET A PK NAIL AND B.C.B.W. IN THE SOUTHWESTERLY BASE. SET A B.T. TAG ON THE SOUTHEASTERLY FACE.

SET: ORANGE FIBERGLASS "SURVEY MARKER" POST 1 FOOT NORTHERLY.

NOTES:

B.C.B.W. IS A BRASS WASHER STAMPED "BENTON COUNTY SURVEYOR". COMPASS DECLINATION IS 20° EAST. ALL MEASURED DISTANCES AND COMPASS BEARINGS ARE TO THE CENTER OF THE OBJECT, UNLESS OTHERWISE NOTED.

FIRM/AGENCY: BENTON COUNTY PUBLIC WORKS
ADDRESS: 380 S.W. AVERY AVE. CORVALLIS OR. 97333; PH. 757-8821
PARTY CHIEF: CURTIS J. LIESENFELT
CREW: MARK E. ANDERSON
WITNESS:

REGISTERED
 PROFESSIONAL
 LAND SURVEYOR

Danna L. Fehrenbacher

OREGON
 JULY 16, 1982
 DANNA L. FEHRENBACHER
 1995

DATE 01/24/2000TOWNSHIP 11 SOUTH, RANGE 05 WEST, WILLAMETTE MERIDIAN; SECTION 14 CORNER N/A
DONATION LAND CLAIM JOHN ROBINSON NO. 44 CORNER NORTHEAST**COMMON CORNER(S):**THE NORTHWEST CORNER OF THE WILLIAM KNOTTS DLC NO. 45.
THE SOUTH LINE OF THE ABRAM N. LOCKE DLC NO. 41.**RECORDS (INFORMATION IN BOLD ITALICS IS COUNTY STAFFS' INTERPRETATION OF THE RECORD)**

- [01] ORIGINAL GLO SURVEY BY DENNIS HATHORN, D.S., APPROVED AUGUST 27, 1861. **SET POST WITH 3 ASH BEARING TREES, MEASURED TO THE FACE.**
- [02] COUNTY SURVEY NO. 113 NOTES (FIELD BOOK NO. 3, PAGE 34) BY F. MARION WILKES, C.S., DATED APRIL 5, 1909. **FOUND 2 BEARING TREES, SET STAKE WITH 3 NEW BEARING TREES.**
- [03] OLD CORNER RESTORATION BOOK NO. 1, PAGE 49 BY F. MARION WILKES, NO DATE GIVEN. **SAME INFORMATION AS RECORD [02].**
- [04] CORNER RESTORATION NO. 761. **TRANSCRIBED COPY OF RECORD [03] AND MAY CONTAIN ERRORS AND OMISSIONS.**
- [05] MAP NO. 11-5-00008 BY W. C. GALLOWAY, C.S., NO DATE GIVEN. **NO DESCRIPTION.**
- [06] MAP NO. 11-5-00012 BY W. C. GALLOWAY, NO DATE GIVEN. **3/4" PIPE.**
- [07] MAP NO. 11-5-00004 BY BENTON COUNTY, NO DATE GIVEN. **3/4" PIPE.**
- [08] COUNTY SURVEY NO. 2247 BY MARTIN BEYERLEIN, DATED JANUARY, 1951. **FOUND 3/4" PIPE.**
- [09] COUNTY SURVEY NO. 2436 BY MARTIN BEYERLEIN, DATED NOVEMBER 5, 1952. **FOUND PIPE.**
- [10] COUNTY SURVEY NO. 2463 BY OTTO MEYER, P.E., DATED MARCH 15, 1953. **NO DESCRIPTION.**
- [11] COUNTY SURVEY NO. 3722 BY FRED LEMKE, P.L.S., DATED AUGUST 8, 1962. **3/4" PIPE.**
- [12] COUNTY SURVEY NO. 3948 BY HOWARD TAYLOR, P.E., DATED JULY 10, 1964. **FOUND 3/4" PIPE.**
- [13] COUNTY SURVEY NO. 4256 BY HOWARD TAYLOR, DATED APRIL 12, 1966. **FOUND 3/4" PIPE AND PIPE EASTERLY.**
- [14] COUNTY SURVEY NO. 7975 BY DARRYL HARMS, P.L.S., DATED FEBRUARY 24, 1987. **FOUND 3/4" PIPE.**
- [15] CORNER RESTORATION NO. 3864 BY DANNA L. FEHRENBACHER, C.S., DATED DECEMBER 13, 1990. **FOUND 1/2" PIPE AND TREE REMAINS, SET BRASS DISC WITH 4 NEW BEARING TREES.**
- [16] COUNTY SURVEY NO. 8884 BY C. HENRY COLE, P.L.S., DATED OCTOBER 10, 1994. **FOUND 3 1/4" BRASS DISC.**
- [17] BENTON COUNTY GIS/DEA MAPPING PROJECT BY RAY WILSON, D.C.S., DATED JULY, 1997. **FOUND BRASS DISC, ESTABLISHED STATE PLANE COORDINATES WITH RTK/GPS.**

COMMENTS/LOCATION/ETC:**NOTES:**

THIS IS A MICROSOFT WORD 97 DOCUMENT NAMED "15844010" CREATED FROM A BOILER PLATE DOCUMENT NAMED "HISTORY", WHICH HAS A STYLESHEET NAMED "CORNER" ATTACHED TO IT.

FIRM/AGENCY: BENTON COUNTY SURVEYOR'S OFFICE
ADDRESS: 360 S.W. AVERY AVE. CORVALLIS OR 97333; PH. 766-6821
RESEARCH BY: CURTIS J. LIESENFELT, P.L.S.
DATA ENTRY BY: SAME

CORNER HISTORY		T 11 S, R 5 W		SECTION 14 D.L.C. JOHN ROBINSON NO. 44		CORNER N/A CORNER NE		# 844010	TOTAL NO. OF OBJ'S.
NO.	DATE	SOURCE	SURVEYOR	MONUMENTS AND ACCESSORIES		COMMENTS			
1	8/27/1861	ORIG. GLO	DENNIS HATHORN	SET POST @ 3 ASH BT'S MEAS. TO THE FACE				1 4	
2	4/5/1909	CS# 113 NOTES	F. MARION WILKE	FND. 2 BT'S, SET STK. @ 3 NEW BT'S, FB 3/34				2 3 8	
3	-	OLD COR. REST. BK. #1, PL. 49	" " "	SAME INFORMATION AS REC [02]				4 5	
4	-	REST. 761	-	TRANS. COPY OF REC. [03] + MAY CONTAIN ERRORS + OMISSIONS				6 7	
5	7/8/1921	MAP NO. 11-5-0000B	W. L. GALLOWAY	NO DESC.				8 9	
6	-	MAP NO. 11-5-0001Z	" "	3/4" PIPE				10 11 9	
7	-	MAP NO. 11-5-00004	BENTON COUNTY	" "				12	
8	1/1/1951	CS# 2247	MARTIN BEYERLEIN	FND. 3/4" PIPE				13 14	
9	11/5/1952	CS# 2436	" "	" PIPE				15 16	
10	3/15/1953	CS# 2463	OTTO MEYER (E)	NO DESC.				17 18	
11	8/8/1962	CS# 3722	FRED LEMKE	3/4" PIPE				19 20	
12	7/10/1964	CS# 3948	HOWARD TAYLOR (E)	FND. 3/4" PIPE				21 22	
13	4/12/1966	CS# 4256	" " "	" " " + PIPE E 1/4				23 24	
14	2/24/1987	CS# 7975	DARAYL HARMS	" " "				25 26	
15	12/13/1990	REST. 3864	BANNA L. FETRENBACHER	" 1/2" PIPE + TREE REMAINS, SET BD @ 4 ACES.				27 14 28	
16	10/10/1994	CS# BBB4	C. HENRY COLE	" 3/4" BD				29 30	
17	7/19/97	BEN. CO. GIS/DPA MAPPING PROJ.	RAY WILSON	" " " EST. ST. PLN. COORD @ RTK 16PS				31	



Witnesses, C.C. Bell, and - Carey.

Surrey # 39 \searrow N.W. Cor. of Wm Knotts D.L.C., # 45 in T 115 R 5 W.

Set oak stake 3x4x36" for Cor. tree and stump standing

Marked, Ash 6" bears N 71° 50' E, 7.6 ft dist.

Ash 15" " S 82° 50' E, 121.4 ft " to face of blaze.

Ash 8" " S 62° 30' W, 6.5 " "

Witnesses, Wm Knotts, Bert Read + W.F. Gay.

" # 30 Cont. N.W. Cor. of the Elizabeth Herbert D.L.C., # 41 in T 13 S, R 5 W.

Set $\frac{5}{8}$ " x $\frac{3}{8}$ " I. Rod \uparrow (Stone is under the fill)
Set stone 18x12x8 for Cor. Under bridge, old trees gone.

Marked, Thorn 6" bears N 69° 50' E, 28.3' dist.

Oak 10" " S 27° 10' W, 48.7' " "

Ash 13" " S 82° 30' W, 77.9 " "

Witnesses, Dick Scott, R. Gissman and A. Lutes.

" # 40 S.W. Cor. of Jesse H. Catron D.L.C., # 37 in T 15 S R 5 W.

Set 1" x 30" iron pin in old stake hole for Cor. S.E. tree standing.

Marked. Chittim 7" bears N 30° E, .5 ft dist.

Witnesses W.H. Deary, Oscar Gustafson, and - Whitford.

40 $\frac{1}{4}$ Sec Cor bet Secs 36 + 1
~~Cor. of Secs 1, 2, 35 + 36~~ in Tps 14 + 15 S R 6 W.

Set sandstone 16x10x3" for Cor, one tree standing.

Marked fir, 28" bears N 61° 30' W, 22.0 ft dist.