

CORNER FILE TRACKING

H:\Survey\Corners\Misc\Filetrac.doc
11/23/98

CORNER NUMBER
116100300

STEP	HISTORY()	RESTORATION()
Form Prepared, DB	12/28/05	2/10/06
Field Inspection, DB	2/10/06	2/10/06
Form Checked, DB	3-9-06	3-9-06
Form Edited, DB	3-9-06	3-9-06
Form Signed, DB	3-9-06	3-9-06
Counter Index	2/10/06	2/10/06
GIS Index	2/10/06	2/10/06
Authorize Payment, DB	—	—
Archive Digital Files	3-10-06	3-10-06
Collect Documents		
Scanned	3/14/06	3/14/06
Copy For Filming		
Filed, DB		
Finish index (count unit)	2/10/06	2/10/06
Filmed (Archived), DB		

(DB) = Entry needed in database (Access).

COMMENTS:

11-6-19, 30 and 11-7-24, 25

Corner to sections 24, 19, 25 and 30, Twp. 11 S., Rs. 6 and 7 W.

864

Reestablishment by W. C. Galloway

April 13, 1916

Set **L** iron about 16" long

Maple 8" in diam bears N 32° E

.42 chains (standing)

Maple 10" in diam bears S 67° E

.40 chains (standing)

Maple 12" in diam bears S 41° W

.10 chains (standing)

Fir 8" in diam bears N 65° W

.40 chains (standing)

Witness E. C. King

DATE 12/28/2005TOWNSHIP 11 SOUTH, RANGE 06 WEST, WILLAMETTE MERIDIAN; SECTION 19 CORNER SOUTHWEST
DONATION LAND CLAIM N/A CORNER N/A**COMMON CORNER(S):**NORTHWEST OF SECTION 30 T.11S., R.06W.
NORTHEAST OF SECTION 25 T.11S., R.07W.
SOUTHEAST OF SECTION 24 T.11S., R.07W.**RECORDS (INFORMATION IN BOLD ITALICS IS COUNTY STAFFS' INTERPRETATION OF THE RECORD)**

BASED ON EXTENSIVE RESEARCH AND RECOVERY OF EVIDENCE, THIS OFFICE HAS DETERMINED THAT MOST GENERAL LAND OFFICE SURVEYORS MEASURED TO THE FACE OF BEARING TREES.

- [01] GERNERAL LAND OFFICE (GLO) NOTES BY H. GORDON, D.S. AND I. PRESTON, D.S., DATED JULY 20, 1854. SET POST. MARKED AN 8" MAPLE N37°E 42 LKS. (27.72 FT.), A 10" MAPLE S67°E 40 LKS. (26.40 FT.), A 12" MAPLE S31°W 10 LKS. (6.60 FT.) AND A 8" FIR N65°W 43 LKS (28.38 FT.).
- [02] COUNTY SURVEY NO. 547 (OLD NO. 249) FIELD NOTES (BOOK 21, PAGE 9) BY W. C. GALLOWAY, C.S., DATED APRIL 13, 1916. SET AN IRON. FOUND AN 8" MAPLE (GLO BT) N32°E 0.420 CHS. (27.72 FT.) STANDING. FOUND A 10" MAPLE (GLO BT) S67°E 0.400 CHS. (26.40 FT.) STANDING AND REMARKED TREE. FOUND A 12" MAPLE (GLO BT) S41°W 0.100 CHS. (6.60 FT.) STANDING AND REMARKED TREE. FOUND AN 8" FIR (GLO BT) N65°W 0.400 CHS. (26.40 FT.) STANDING.
- [03] CORNER RESTORATION BOOK NO. 1, PAGE 105 BY W. C. GALLOWAY, C.S., DATED APRIL 13, 1916. SET AN IRON, 16" LONG. FOUND AN 8" MAPLE (GLO BT) N32°E 0.420 CHS. (27.72 FT.) STANDING. FOUND A 10" MAPLE (GLO BT) S67°E 0.400 CHS. (26.40 FT.) STANDING AND REMARKED TREE. FOUND A 12" MAPLE (GLO BT) S41°W 0.100 CHS. (6.60 FT.) STANDING AND REMARKED TREE. FOUND AN 8" FIR (GLO BT) N65°W 0.400 CHS. (26.40 FT.) STANDING.
- [04] CORNER RESTORATION NO. 864. TRANSCRIBED FROM RECORD [03] AND MAY CONTAIN ERRORS AND/OR OMISSIONS.
- [05] BENTON COUNTY MAP NO. 11-6-00015 BY W. C. GALLOWAY, C.S., DATED 1916. IRON. 8" MAPLE (GLO BT) N32°E 0.420 CHS. (27.72 FT.) STANDING. 10" MAPLE (GLO BT) S67°E 0.400 CHS. (26.40 FT.) STANDING, REMARKED. 12" MAPLE (GLO BT) S41°W 0.100 CHS. (6.60 FT.) STANDING. 8" FIR (GLO BT) N65°W 0.400 CHS. (26.40 FT.) STANDING.
- [06] COUNTY SURVEY NO. 608 (OLD NO. 233) FIELD NOTES (BOOK 24, PAGE 32) BY BURT WILKES, D.C.S., DATED OCTOBER 19, 1917. CORNER TIED BUT NOT DESCRIBED.
- [07] BENTON COUNTY MAP NO. 11-7-00012 BY W. C. GALLOWAY, C.S., DATED DECEMBER 4, 1917. IRON.
- [08] COUNTY SURVEY NO. 5728 BY FRED I. LEMKE, P.L.S., DATED MAY 1, 1974. FOUND 5/8" I. ROD WITH HOOK, BADLY BENT. SET 5/8" ROD ALONG SIDE. FOUND 30" FIR STUMP (GLO BT) N60°W 26.4 FT., MARKED "BT". MARKED A 35" FIR N14°57'E 67.31 FT. TO PK, A 8" OAK S60°28'E 60.30 FT. TO PK, A 8" FIR S42°48'W 41.05 FT. TO PK AND A 14" FIR N61°12'W 28.38 FT. TO PK.
- [09] COUNTY SURVEY NO. 7600 BY FRED I. LEMKE, P.L.S., DATED JUNE 2, 1975. FOUND 5/8" ROD.
- [10] CORNER RESTORATION CORRESPONDENCE FILE FOR 11-6 BY D. CLAASSEN, DATED OCT. 1986. FOUND 5/8" REBAR.

COMMENTS/LOCATION/ETC:**NOTES:**

THIS IS A MICROSOFT WORD 2000 DOCUMENT NAMED "16100300" CREATED FROM A BOILER PLATE DOCUMENT NAMED "HISTORY", WHICH HAS A STYLESHEET NAMED "CORNER" ATTACHED TO IT.

FIRM/AGENCY: BENTON COUNTY SURVEYOR'S OFFICE
ADDRESS: 360 S.W. AVERY AVE. CORVALLIS OR 97333; PH. 766-6821
RESEARCH BY: BERNARD S. ALTENBACH, ENGINEER/SURVEY TECH.
DATA ENTRY BY: SAME

BENTON COUNTY CORNER RESTORATION FORM, PAGE 1 OF 2, 116100300R2**SEE CORNER HISTORY FORM FOR RECORDS ETC.**

CORNER RESTORATION FIELD BOOK NUMBER 23 PAGE(S) 67 DATE 02/10/2006
TOWNSHIP 11 SOUTH, RANGE 6 WEST, WILLAMETTE MERIDIAN; SECTION 19 CORNER SOUTHWEST
DONATION LAND CLAIM NONE CORNER N/A
CONDITION REPORT _____; REFERENCED OUT _____; RENEWED XX; SURVEYED IN _____

LOCATION AND COMMENTS:

CORNER IS LOCATED IN A MATURE STAND OF D. FIR TIMBER ON A GENTLE SOUTH FACING SLOPE. TO REACH CORNER FROM THE JUNCTION OF LILLY HILL ROAD AND HIGHWAY 20, TRAVEL WESTERLY ON HIGHWAY 20 FOR 0.57 MILES; THEN LEFT ON PRIVATE GRAVEL ROAD, SOUTHERLY FOR 0.97 MILES TO SCALE SHACK AT ROCK PIT; THEN SOUTHERLY ALONG THE EASTERLY SIDE OF ROCK PIT FOR 0.15 MILES TO 3 WAY ROAD JUNCTION; THEN BEAR LEFT ON SPUR FOR 0.12 MILES TO SUPR ON RIGHT AND LOCATION TAG ON 27" D. FIR; THEN $\pm S64^{\circ}W$, APPROXIMATELY 22 CHAINS THROUGH MATURE TIMBER TO CORNER. CORNER IS POOR FOR PREMARKING AND GPS CONTROL.

MONUMENTS AND ACCESSORIES FOUND (CONDITION AND SOURCE):

1. FOUND 5/8" X 30" IRON ROD FLUSH WITH GROUND LEVEL FOR CORNER POSITION.
(SET 5/8" IRON ROD ALONG SIDE 5/8" BADLY BENT IRON ROD WITH HOOK PER RECORD [08]).
(FOUND 5/8" IRON ROD PER RECORDS [09] AND [10]).
2. FOUND 5/8" X 16" LONG IRON CRANK WITH LOOP ON TOP. IRON WAS TIPPED SOUTHERLY WITH THE TOP 6" BADLY BENT. THE BOTTOM OF THIS IRON WAS IN THE SAME X,Y POSITION AS THE ABOVE NOTED 5/8" X 30" IRON ROD.
(SET AN IRON FROM 4 GLO BEARING TREES PER RECORDS [02] AND [03]).
(IRON PER RECORDS [05] AND [07]).
(FOUND 5/8" IRON ROD WITH HOOK, BADLY BENT, SET 5/8" ROD ALONG SIDE PER RECORD [08]).
3. FOUND ± 30 " ROTTEN D. FIR STUMP WITH VISIBLE SCRIBING "BT" ON OPENED FACED, $N63^{\circ}23'W$, 26.42 FEET TO FACE. SET ALUMINUM NAIL AND PLASTIC WASHER BELOW SCRIBING FOR DISTANCE AND ANGLE MEASUREMENT.
(8" FIR, $N65^{\circ}W$, 28.4 FEET PER RECORD [01]).
(STANDING 8" FIR $N65^{\circ}W$, 26.4 FEET PER RECORDS [02], [03] AND [05]).
(30" FIR STUMP, $N60^{\circ}W$, 26.4 FEET WITH SCRIBING "BT", PER RECORD [08]).
4. FOUND 26" D. FIR WITH HEALED DOUBLE BLAZE, $N60^{\circ}48'W$, 28.80 FEET TO CENTER. SET ALUMINUM NAIL AND PLASTIC WASHER IN NE BASE FOR DISTANCE MEASUREMENT.
(MARKED 14" FIR $N61^{\circ}12'W$, 28.38 FEET TO PK PER RECORD [08]).
5. FOUND 27" D. FIR WITH HEALED DOUBLE BLAZE, $N14^{\circ}57'E$, 67.41 FEET TO CENTER. SET ALUMINUM NAIL AND PLASTIC WASHER IN SE BASE FOR DISTANCE MEASUREMENT. **BASIS OF BEARINGS FOR THIS RESTORATION.**
(MARKED 35" FIR $N14^{\circ}57'E$, 67.31 FEET TO PK PER RECORD [08]).
6. FOUND 10" DEAD DOUBLE W. OAK WITH HEALED FACE, $S58^{\circ}43'E$, 60.90 FEET TO CENTER. SET ALUMINUM NAIL AND PLASTIC WASHER IN SW BASE FOR DISTANCE MEASUREMENT.
(MARKED 8" OAK, $S60^{\circ}28'E$, 60.30 FEET TO PK PER RECORD [08]).
7. FOUND 22" D. FIR WITH HEALED DOUBLE BLAZE, $S43^{\circ}37'W$, 41.59 FEET TO CENTER. SET ALUMINUM NAIL AND PLASTIC WASHER IN NE BASE FOR DISTANCE MEASUREMENT.
(MARKED 8" FIR, $S42^{\circ}48'W$, 41.05 FEET TO PK PER RECORD [08]).

MONUMENT SET (PROCEDURES AND DESCRIPTION):

HELD THE 5/8" IRON ROD AS SET PER COUNTY SURVEY NO. 5728 FOR TRUE CORNER POSITION. NO EVIDENCE REMAINS OF THE 3 GLO MAPLE BEARING TREES. NO EVIDENCE WAS FOUND OF THE ORIGINAL GLO MONUMENT (POST) AFTER A THOROUGH SEARCH OF THE AREA.

REMOVED THE 5/8" X 30" IRON ROD AS SET PER SAID COUNTY SURVEY NO. 5728 AND THE 5/8" BENT IRON CRANK. SET 2" X 31.5" GALVANIZED IRON PIPE WITH A 3 1/4" BRASS DISK CONCRETED IN THE TOP, 1" ABOVE GROUND LEVEL AND MARKED AS SHOWN ON PAGE 2 OF 2. RESET 5/8" X 30" IRON ROD ON THE NORTH SIDE OF NEW MONUMENT IN PLUMB POSITION AND 6" BELOW GROUND LEVEL. BURIED 5/8" X 16" IRON CRANK ON THE WEST SIDE OF NEW MONUMENT IN HORIZONTAL POSITION AND 4" BELOW GROUND LEVEL. SET 6 FOOT ORANGE CARSONITE "SURVEY MARKER" 0.5 FEET SOUTH ON NEW MONUMENT.

CONIFER AND HARDWOODS

CONIFER AND HARDWOODS

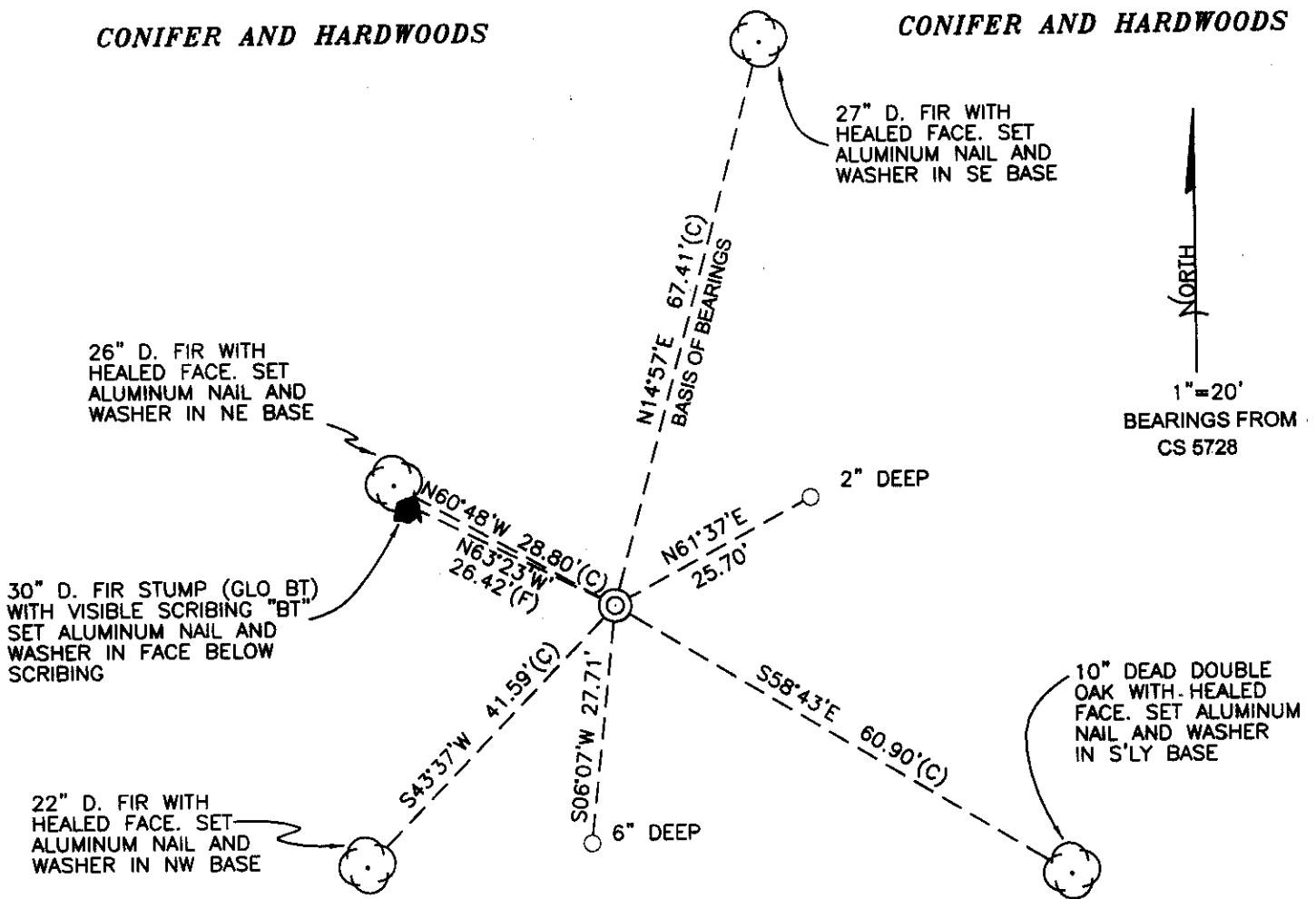

CONIFER AND HARDWOODS

CONIFER AND HARDWOODS

MONUMENT DETAIL

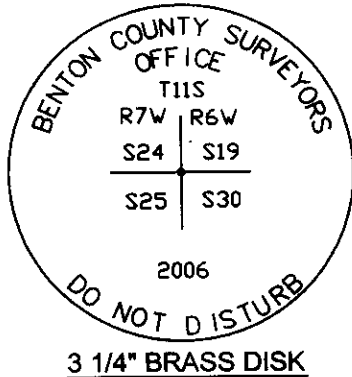

LEGEND

- SET 5/8" X 30" REBAR WITH YELLOW PLASTIC CAP MKD "BENTON COUNTY SURVEYOR"
- (F) MEASUREMENT TO FACE
- (C) MEASUREMENT TO CENTER
- ⊙ GOVERNMENT MONUMENT SET AS SHOWN
- ⊙ BEARING TREE AS NOTED
- GLO GENERAL LAND OFFICE
- ⊙ BEARING TREE STUMP AS NOTED

NEW ACCESSORIES:

1. SET REBAR (SEE LEGEND) 2" BELOW GROUND LEVEL N61°37'E, 25.70 FEET.
2. SET REBAR (SEE LEGEND) 6" BELOW GROUND LEVEL S6°07'W, 27.71 FEET.

NOTES:

COMPASS DECLINATION IS 20° EAST. ALL MEASURED DISTANCES AND BEARINGS ARE TO THE CENTER OF THE OBJECT, UNLESS OTHERWISE NOTED. ALL BEARING TREES ARE PAINTED AND HAVE A B.T. TAG ATTACHED, FACING THE CORNER UNLESS OTHERWISE NOTED. ALL NEW BEARING TREES HAVE A PLASTIC WASHER (STAMPED "BENTON COUNTY SURVEYOR CORNER RESTORATION") ATTACHED (BY ALUMINUM NAIL) TO THE FACE, BELOW THE "BT" FOR DISTANCE AND ANGLE MEASUREMENT UNLESS OTHERWISE NOTED. THE DRAWING IS FROM AUTOCAD RELEASE 2002.

THIS RESTORATION WAS PERFORMED AT THE DIRECTION AND APPROVAL OF THE BENTON COUNTY SURVEYOR, David M. Dean

FIRM/AGENCY: BENTON COUNTY SURVEYOR'S OFFICE
 ADDRESS: 360 S.W. AVERY AVE. CORVALLIS OR 97333; PH. 766-6821
 PRESENT: DAVID M. DEAN, P.L.S. AND BERNIE ALTENBACH, SURVEY TECH.
 EQUIPMENT: 5' USHIKATA COMPASS/TRANSIT AND STEEL TAPE

REGISTERED
 PROFESSIONAL
 LAND SURVEYOR

3/9/06 David M. Dean

OREGON
 JULY 13, 1984
 DAVID M. DEAN
 2090

RENEWAL DATE: 12/31/07