

11-6-7

BENTON COUNTY SURVEYORS OFFICE - CORNER RESTORATION

1033

T 11 S, R 7 W, W. B. & M., BENTON COUNTY, OREGON  
SECTION 12 and 11-6-7

REPORTED BY Arnold Brubaker  
TITLE R. P. L. S. #992  
DATE 12/5/80



1/4 CORNER COMMON TO SEC. 12 & 7  
IS 3/4" Iron Rod  
DESCRIBE

ADDITIONAL INFORMATION

Set 3/4" Iron Rod in roots Orig. NW BT and  
7.75' N. of E-W fence. Used distances  
from faces of BT's (Orig.)

New BT's:

5" D-fir S35°W 16.1 ft. "T11SR7WS12" BT/Tag  
10" D-fir S50°E 32.75 ft. "T11SR6WS7" BT/Tag  
Fd. 3 stones that could have been one  
at distances from faces of Orig. BT's

OVER

LEGIBLE MARKS ON BEARING OBJECTS			
	Stump with no marks visible	Stump with visible "BT" mark	
KIND	<u>D-fir</u>	<u>D-fir</u>	
SIZE	<u>24"</u>	<u>20"</u>	
BEARING	<u>N30°W</u>	<u>N14°E</u>	
DISTANCE	<u>2.64'</u>	<u>5.94'</u>	
BT TAG POSTED	<u>No</u>	<u>No</u>	

BENTON COUNTY CORNER RESTORATION FORM 116100540 3797

SECTION 7 TOWNSHIP 11 S RANGE 6 W DLC \_\_\_\_\_ CORNER W1/4  
 DATE 5-10-90 CORNER RESTORATION FIELD BOOK NUMBER \_\_\_\_\_ PAGE \_\_\_\_\_

CORNER DESIGNATION:

The 1/4 corner of section 12, T11S, R7W and section 7, T11S, R6W.

- 1/4 \_\_\_\_\_ CONDITION REPORT ONLY  
 S12 | S7 \_\_\_\_\_ REFERENCED OUT  
 XX \_\_\_\_\_ RENEWED  
 \_\_\_\_\_ SURVEYED IN

LOCATION AND COMMENTS:

Corner lies on ridge top 8' North of East-West fence line, at end of dirt road from the SE.

PREVIOUS RENEWALS/SURVEYS, ETC.:

- 1854 - Original Survey by H. Gordon and J. Preston
- 1952 - CS #2365 by M. Beyerlein
- 1980 - Corner restoration #1033 by A. Brubaker

MONUMENTS AND ACCESSORIES FOUND (CONDITION AND SOURCE):

Found 3/4" iron rod as per BCCR #1033

BT's Found:

- 1) 48" Fir Stump, N14°E, 5.9 ft. (N14°E, 9 Lks-1854) Scribing visible ("T") - Set BT tag
- 2) 54" Fir Stump, N30°W, 2.6 ft. (N30°W, 4 Lks-1854) No marks visible. - Set BT tag
- \*3) 8" Fir, S35°W, 15.95 ft. (S35°W, 16.1 ft.-1980) Healed face. - Set BT tag
- \*4) 14" Fir, S54°E, 32.47 ft. (S50°E, 32.75 ft.-1980) Healed face. - Set BT tag
- 5) 28" Fir Stump, N48°E, 75.0 ft. (N48° 04'E, 1.137 ch-1952) No marks visible. - Set BT tag

Distance measured to BT's 1) and 2) is to face.

Also found 4" X 6" X 36" wood post scribed "1/4S" "7 and 12" (unknown origin). Laid wood post alongside brass cap set.

MONUMENT DETAIL

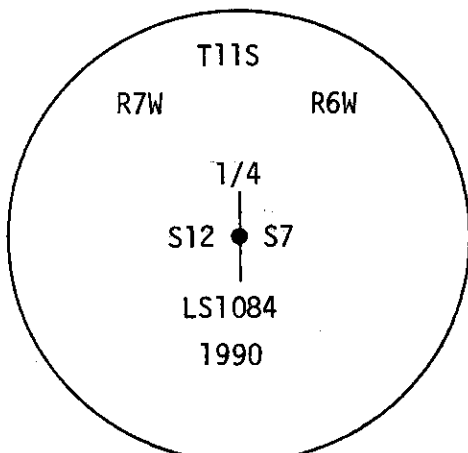

2 1/2" BRASS CAP

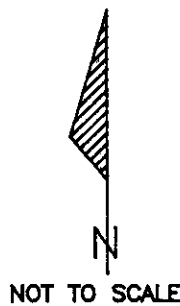

SKETCH

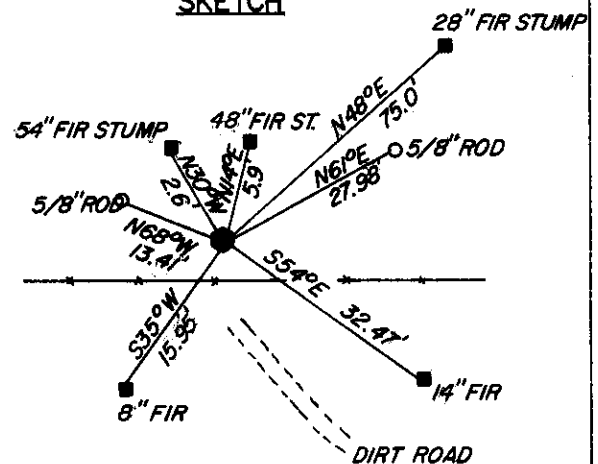

MONUMENT SET (PROCEDURES AND DESCRIPTION):

Set a 2" X 30" galvanized iron pipe with a 2 1/2" brass cap stamped as shown. Brass cap is 0.5ft. above ground. Buried 3/4" iron rod along side brass cap. (Brass cap was set to replace found iron rod).

NEW ACCESSORIES :

- Set 5/8" iron rod with plastic cap (LS1084), N61°E, 27.98ft.
- Set 5/8" iron rod with plastic cap (LS1084), N68°W, 13.41ft.
- Iron rods are set flush with ground, and are 30" long.

Accessory bearings are determined using a hand compass (Decl = 20° East)  
 Set orange fiberglass "Survey Marker" post 1.5 feet Easterly.

NOTES:

\*Set PK nails with stainless steel washers in side center of base of BT's. BT distances are to side center of trees, except as noted.

FIRM/AGENCY: J. Peterson & Associates, Land Surveyors  
ADDRESS: 8155 NW Mitchel Drive  
PARTY CHIEF: Corvallis, Oregon 97330 Phone 757-1794  
CREW:  
WITNESS: Jim S. Peterson - Joe B. Hinds

**REGISTERED  
 PROFESSIONAL  
 LAND SURVEYOR**



**OREGON**  
 JULY 31, 1976  
**JIM S. PETERSON**  
 1084