

35/36  
2/1

CORNER HISTORY		T 11 S, R 6 W		SECTION 35 D.L.C.		CORNER SE CORNER		#
								16600 100
NO.	DATE	SOURCE	SURVEYOR	MONUMENTS AND ACCESSORIES		COMMENTS		
①	2/28/1855	ORIG. G.L.O.	HARVEY GARDON + JOSIAH PRESTON	SET POST @ 3 OAK B.T.S + TRENCH				1
								2
②	3/28/1972	CS# 5229	MARTIN BEYERLEIN	SET 3/4" I.R.				3
								4
	3/7/1975	CS# 5840	NICK YINGER	FND. 5/8" ROD		N 89° 03' W ~ 2676.07		5
								6
								7
								8
								9
								10
								11
								12
								13
								14
								15
								16
								17
								18
								19
								20
								21
								22
								23
								24
								25
								26
								27
								28
								29
								30
								31

Plot File: RECMOD2.PLT  
Summary File: RECMOD2.CMD

ACTIVE FILES:

Job File: RECMOD2.JOB  
Coord File: RECMOD2.CRD  
Field Data File: RECMOD2.FLD  
Plot File: RECMOD2.PLT  
Summary File: RECMOD2.CMD

ACTIVE FILES:

Job File: RECMOD2.JOB  
Coord File: RECMOD1.CRD  
Field Data File: RECMOD2.FLD  
Plot File: RECMOD2.PLT  
Summary File: RECMOD2.CMD

ACTIVE FILES:

Job File: RECMOD2.JOB  
Coord File: RECMOD2.CRD  
Field Data File: RECMOD2.FLD  
Plot File: RECMOD2.PLT  
Summary File: RECMOD2.CMD

BENTON COUNTY CORNER RESTORATION PROGRAM  
360 SW AVERY AVE., CORVALLIS, OR. 97333-1192  
PHONE (503) 757-6821; FAX 757-6891  
WILD/LEICA T1610, DI1600, REC MODULE & WILDISOFT

Date: 07-17-95  
Time: 17:41:18  
Page: 1

NOTE: THIS FILE WAS DELETED FROM C:\T-11  
ON 7/17/95 CJL

Coordinate File: 116TWNLN.CRD  
List of Coordinate Points

Point ID	NORTH	EAST	ELEV	Descriptor
1	1000.0000	1000.0000	**	f 3/4" rb near sec cor
2	1080.6150	966.5980	**	s rndm spk
3	1075.7200	1036.7949	**	ctr 29" orig ne bt
4	837.6713	1111.4264	**	ctr 28" orig se bt
5	954.7950	987.1290	**	s rb & cap sw acces
6	1015.5940	964.7210	**	s rb & cap nw acces
9	1151.0555	935.9326	**	ctr nw orig bt
10	1023.6495	971.1487	**	d-d frm 3 & 4
3B	1074.6360	1036.2690	**	brg to ne orig bt
3D	1075.1230	1037.9990	**	dist to s spk ne orig bt
4B	838.6750	1110.7210	**	brg to se orig bt
4D	838.4790	1112.5940	**	dist to s pk se orig bt
7B	1008.5200	1002.6250	**	brg to ne unrec oak bt
7D	1009.7590	1001.9030	**	dist to s spk unrec oak
8B	993.4740	1007.1570	**	brg to se unrec d fir bt
8D	993.6310	1008.1130	**	dist to s spk se d fir bt
9B	1149.6630	936.5020	**	brg to nw orig bt
9D	1150.4660	934.5600	**	dist to s spk nw orig bt

TOWNSHIP 11 SOUTH, RANGE 6 WEST, WILLAMETTE MERIDIAN; SECTION 35 CORNER SE  
DONATION LAND CLAIM \_\_\_\_\_ CORNER \_\_\_\_\_

**COMMON CORNER(S):**

THE SOUTHWEST CORNER OF SECTION 36.  
THE NORTHWEST CORNER OF SECTION 1 IN TOWNSHIP 12 SOUTH RANGE 6 WEST.  
THE NORTHEAST CORNER OF SECTION 2 IN TOWNSHIP 12 SOUTH RANGE 6 WEST.

**UPDATES AND REVISIONS:**

THE STATE PLANE COORDINATE INFORMATION WAS DERIVED FROM GPS PROJECT BALD AND ENTERED INTO THIS FORM ON  
NOVEMBER 1, 1995 BY MARK ANDERSON.

**CORNER RECORDS (PREVIOUS RENEWALS, SURVEYS, ETC.)**

- [01] ORIGINAL GLO SURVEY BY HARVEY GORDON AND JOSIAH PRESTON DATED FEBRUARY 28, 1855.
- [02] COUNTY SURVEY NO. 5229 BY MARTIN BEYERLEIN DATED MARCH 28, 1972.
- [03] COUNTY SURVEY NO. 5840 BY NICK YINGER DATED MARCH 7, 1975.

**COMMENTS/LOCATION/ETC:**

**HORIZONTAL AND VERTICAL INFO.**

GEO. DAT: NAD 83 (91)	VERT. DATUM: NGVD (29) 47
LAT.: N 44° 33' 47.15235"	ELLIPSOID ELEV:
LONG.: W 123° 22' 26.52924"	ORTHO ELEV: 620.00 (SCALED FROM QUAD. MAP)
ST. PLANE COORD. SYS: OREGON NORTH	GEOID SEPERATION:
N (Y): 340138.516 I.F.	NOTES: THE RELATIVE HORIZONTAL POSITIONAL
E (X): 7453200.116 I.F.	ACCURACY OF THIS COR. IS ABOUT 0.26'
SCALE FACTOR: 0.99995006	
COMB. FACTOR: 0.99992376	
CONVERGENCE: 2° 02' 17.61386"	

**NOTES:**

THIS IS A MICROSOFT WORD (VERSION 5.0) DOCUMENT NAMED "16600100" CREATED FROM A BOILER PLATE DOCUMENT NAMED  
"HISTORY", WHICH HAS A STYLESHEET NAMED "CORNER" ATTACHED TO IT.

**FIRM/AGENCY:** BENTON COUNTY SURVEYOR'S OFFICE  
**ADDRESS:** 360 S.W. AVERY AVE. CORVALLIS OR 97333; PH. 757-6821  
**RESEARCH BY:** CURTIS J. LIESENFELT/MARK E. ANDERSON  
**DATA ENTRY BY:** COLETTE MONACO

REGISTERED  
PROFESSIONAL  
LAND SURVEYOR

*Curtis J. Liesenfelt*

OREGON  
JULY 17, 1986  
CURTIS J. LIESENFELT  
2213

**BENTON COUNTY CORNER RESTORATION FORM, PAGE 1 OF 1, 116600100R1**

**SEE CORNER HISTORY FORM FOR RECORDS ETC.**

CORNER RESTORATION FIELD BOOK NUMBER 14 PAGE(S) 49, 52 DATE 9/23/1993  
 TOWNSHIP 11 SOUTH, RANGE 6 WEST, WILLAMETTE MERIDIAN; SECTION 35 CORNER SE  
 DONATION LAND CLAIM \_\_\_\_\_ CORNER \_\_\_\_\_  
 CONDITION REPORT \_\_\_\_\_; REFERENCED OUT \_\_\_\_\_; RENEWED XX; SURVEYED IN \_\_\_\_\_

**LOCATION AND COMMENTS:**

THE CORNER IS LOCATED IN A WOODED AND BRUSHY AREA ON A GENTLY SLOPING, SOUTHERLY FACING HILLSIDE, APPROXIMATELY 100 FEET EASTERLY FROM THE EASTERLY EDGE OF A MEADOW AND APPROXIMATELY 650 FEET EASTERLY AT RIGHT ANGLES TO A WOVEN AND BARBED WIRE FENCE.

**MONUMENTS AND ACCESSORIES FOUND (CONDITION AND SOURCE):**

- FOUND: 3/4" REBAR FOR THE CORNER (3/4" IRON ROD AS PER [02]).
- FOUND: 29" OAK, BEARS N 22° 59' W 164.18 FEET (12", N 23° W 163.68 FEET FACE MEASUREMENT AS PER RECORD [01]). CUT OPEN AND FOUND THE SCRIBING "S 35 11S" ON THE UPPER FACE. SET A 5 1/2" SPIKE AND BRASS WASHER IN THE NORTHWESTERLY BASE.
- FOUND: 29" OAK WITH A CHOPPED OUT UPPER FACE, BEARS N 25° 55' E 84.19 FEET (15", N 26° 15' E 83.16 FEET FACE MEASUREMENT AS PER RECORD [01]). CUT OPEN AND FOUND THE SCRIBING "BT" ON A LOWER FACE. SET A 5 1/2" SPIKE AND BRASS WASHER IN THE SOUTHEASTERLY BASE.
- FOUND: 28" OAK, BEARS S 34° 28' E 196.89 FEET (15", S 35° E 232.32 FEET FACE MEASUREMENT AS PER RECORD [01]). CUT OPEN AND FOUND SCRIBING ON A LOWER FACE. SET A 5 1/2" SPIKE AND BRASS WASHER IN THE NORTHEASTERLY BASE.
- FOUND: 14" DOUGLAS FIR WITH A HEALED FACE, BEARS S 47° 38' E 10.31 FEET. SET A 5 1/2" SPIKE AND BRASS WASHER IN THE NORTHEASTERLY BASE. THERE IS NO RECORD OF THIS TREE.
- FOUND: 18" OAK WITH A HEALED FACE, BEARS N 17° 07' E 9.94 FEET. SET A 5 1/2" SPIKE AND BRASS WASHER IN THE WESTERLY BASE. THERE IS NO RECORD OF THIS TREE.

NO OTHER RECORD EVIDENCE WAS RECOVERED.

**MONUMENT SET (PROCEDURES AND DESCRIPTION):**

SET: 2" INSIDE DIAMETER X 36" LONG IRON PIPE WITH A 3 1/4" BENTON COUNTY BRASS CAP, STAMPED AS SHOWN, CENTERED OVER THE RECOVERED 3/4" REBAR.

**NEW ACCESSORIES:**

- SET: REBAR (SEE NOTES), BEARS N 66° 09' 00" W 38.57 FEET.
- SET: REBAR (SEE NOTES), BEARS S 15° 53' 30" W 47.00 FEET.
- SET: ORANGE FIBERGLASS "SURVEY MARKER" POST 1 FOOT NORTHERLY.

**MONUMENT DETAIL**

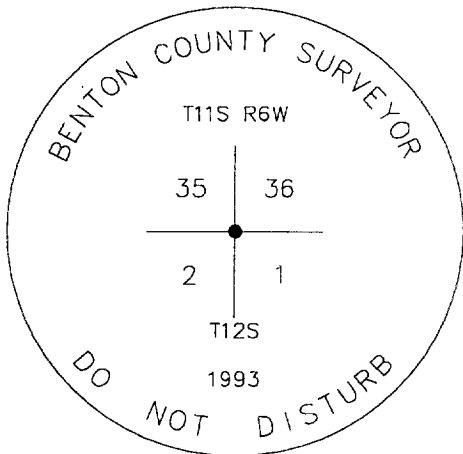

3 1/4" BRASS CAP



NOT TO SCALE

**SKETCH**

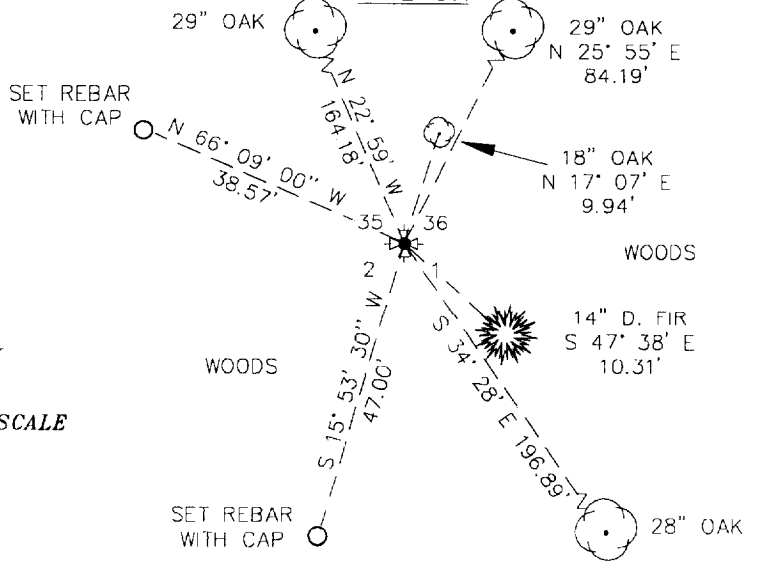

**NOTES:**

COMPASS DECLINATION IS 20° EAST. ALL MEASURED DISTANCES AND COMPASS BEARINGS ARE TO THE CENTER OF THE OBJECT, UNLESS OTHERWISE NOTED. ALL BEARING TREES ARE PAINTED AND HAVE A B.T. TAG ATTACHED, FACING THE CORNER UNLESS OTHERWISE NOTED. ALL NEW BEARING TREES HAVE A BRASS WASHER (STAMPED "BENTON COUNTY SURVEYOR") ATTACHED TO A SIDE CENTER UNLESS OTHERWISE NOTED. ALL LIVE BEARING TREES HAVE A PLASTIC WASHER (STAMPED "BENTON COUNTY SURVEYOR CORNER RESTORATION") ATTACHED TO THE BACK OF THE TREE OPPOSITE THE CORNER UNLESS OTHERWISE NOTED. ALL SET REBAR ARE 5/8" X 30" AND HAVE A YELLOW PLASTIC CAP (STAMPED "BENTON COUNTY SURVEYOR") ATTACHED TO THE TOP.

THIS DOCUMENT WAS NAMED AND CREATED IN A MANNER SIMILAR TO THE HISTORY FORM. THE NAME OF THE BOILER PLATE IS "MONUMENT". THE BORDER, STAMP AND SKETCH ARE FROM AUTOCAD RELEASE 12.

THIS RESTORATION WAS PERFORMED AT THE DIRECTION AND APPROVAL OF THE BENTON COUNTY/DEPUTY COUNTY SURVEYOR. *JB*

**FIRM/AGENCY:** BENTON COUNTY SURVEYOR'S OFFICE  
**ADDRESS:** 360 S.W. AVERY AVE. CORVALLIS OR 97333; PH. 757-6821  
**SURVEYOR:** CURTIS J. LIESENFELT  
**SURVEY CREW:** MARK E. ANDERSON

**REGISTERED  
 PROFESSIONAL  
 LAND SURVEYOR**

*Curtis J. Liesenfelt*

**OREGON  
 JULY 17, 1986  
 CURTIS J. LIESENFELT  
 2213**

**LICENSE EXPIRES 12/31/1994**