

C.S. #147

S.E. cor. John W. Gearhart D.L.C. #56 Tp 10 S R 5 W.
Set fir stake 30x5x5" for cor. from which
Fir 15" dia. br. N 45° 50' W 23.7 lbs dist.
S.W. tree S.E. stump, Witnesses A.J. Price & Matfield 3/4/12.

#124 v

1/2" pipe for S.E. cor. of A. S. Horne's D.L.C. #43 Tp. 12-5
Oak 24" in dia. bears S 36° 50' E. 8.282'
Horne cor. of concrete bears S. 61° 30' W. 8.821'
Witnesses C.L. Huff, J.H. Cooper. 2/19/12

#124 v

use. cor. to sec. 5, 6, 7, 8, Tp. 12-5
Set 2 granite stones 6x6, 6x5" stump std.
Oak 14" in dia. bears N. 57° E. 5.65'
Oak 19" " " N. 9° W. 1.09' W. of 6 oak
Oak 19" " " S. 60° 05' E. 2.642' Straight, cor. of 8 oak, SPIKE N.
Witnesses, C.L. Huff, J.H. Cooper. 2/20/12
Feb. 5, 1917, W.C.C. Found both stones, vertical
1 set 12" under, other 12" under
and 18" pipe at surface. Stake 36" 4.700
Kory's Peak Lookout 5.75"
St. N. Bais 5.75"
St. N. Bais 5.75"
Feb. 5, 1917

#125 v

S.W. cor. N.B. Carter's D.L.C. #47. Tp. 11-6.
Set 3/4" pipe.
Oak 10" in dia brs. S. 62° W. 4.65' std.
" 6" " " S. 89° W. .305'
Witnesses, Frank, M.A., W.E. Wyatt. 2/23/12

#126 v

S.E. cor. of ¹⁰⁰⁰⁰Claim #47 Tp. 11-6
Set 4" x 30" oak stake stump std.
Fir 11" in dia. brs. N. 55° E. .060'
" 11" " " S. 83° W. .213'
Oak 15" " " N. 80° W. .97' std. dead.
Witnesses, Frank, M.A., W.E. Wyatt & Geo. Dixon. 2/24/12

#126 v

S.W. cor. of Jeremiah Mason #42. Tp. 14-8.
Set 5/8" rod stump std.
Oak 14" in dia. brs. S. 29° E. .363'
" 16" " " N. 89° 20' W. 1.243'
Witnesses Harry Jimbman, C.C. Bick, M.B. Patterson. 2/25/12.

#126 v

N.W. cor. of Jeremiah Mason D.L.C. #42. Tp. 14-8.
Set 3/8" x 1 1/4" iron with casting on top.
Fir 72" in dia brs. S. 15° W. .94' std.
" 22" " " S. 71° W. .075'
Witnesses, Harry Jimbman, C.C. Bick, M.B. Patterson, J. Spencer. 2/27/12.

#126 v

1/4 sec. cor. between sec. 8 & 9. Tp. 14-8 Set gun barrel.
Fir 50" in dia brs. N. 1° 30' E. 8.57' std.
" 30" " " N. 46° 30' E. 1.656"
Witnesses J. Spencer, W.H. Mobby, C.C. Bick. 3/2/10.

C.S. #

#12

#127

#127

#

#72

#72

Southwest corner W. B. Carter's D. L. C. #47, Twp 11-6

915

Reestablishment by W. C. Galloway

February 23, 1912

Set 3/4 " pipe

Oak 10" in diam bears S. 62° W

.465 chains (standing)

Oak 6" in diam bears S. 89° W

.305 chains (standing)

Witnesses Fran,, M. A., W. E. Waytt

CORNER HISTORY		T 11 S, R 6 W		SECTION 26 D.L.C. WM. B. CARTER NO. 47		CORNER CORNER SW		# 16- 847030
NO.	DATE	SOURCE	SURVEYOR	MONUMENTS AND ACCESSORIES		COMMENTS		
①	9/16/1856	ORIG. G.L.D.	DENNIS HATHORN	SET POST @ 2 OAK B.T.'S				1
								2
②	2/23/1912	CS# 291	W. C. GALLOWAY	FND BOTH OAKS SET 3/4" PIPE		FB 10/61		3
								4
3	"	OLD COR. REST. BK. # 1 PL. 30	" "	" " " " " "				5
								6
4	"	REST. 915	" "	" " " " " "		TRANS. COPY @ OMISSIONS		7
								8
5	3/1923	MAP NO. 11-6-00011	BENTON COUNTY SUR- VEYOR'S OFFICE	3/4" PIPE				9
6	5/29/1940	CS# 1477	BURT WILKES	PIPE		FB 68/22		10
7	6/1940	MAP NO. 11-6-00018	BURT WILKES	" " @ 2 OAK B.T.'S				11
								12
8	6/10/1973	CS# 5492	FRED LEMKE	FND 3/4" IRON PIPE + 1 B.T.				13
								14
9	12/20/1985	M.L.P. # 69	TEO LANGTON	" " " "				15
								16
10	1/10/1986	REST. 3356	" "	" " PIPE @ PINCHED END + 2 OAK B.T.'S				17
								18
								19
								20
								21
								22
								23
								24
								25
								26
								27
								28
								29
								30
								31

1-30
915
3356

SEE CORNER HISTORY FORM FOR RECORDS ETC.

CORNER RESTORATION FIELD BOOK NUMBER 14 PAGE(S) 18 DATE 6/15/1993
 TOWNSHIP 11 SOUTH, RANGE 6 WEST, WILLAMETTE MERIDIAN; SECTION 26 CORNER
 DONATION LAND CLAIM WM. B. CARTER NO. 47 CORNER SW
 CONDITION REPORT _____; REFERENCED OUT _____; RENEWED XX; SURVEYED IN _____

LOCATION AND COMMENTS:

THE CORNER IS LOCATED ON A GENTLY SLOPING, HEAVILY WOODED AND BRUSHY, NORTHWESTERLY FACING HILLSIDE, 0.5 FOOT SOUTHERLY AT RIGHT ANGLES TO A PARTLY DOWN WOVEN AND BARBED WIRE FENCE, 90 FEET WESTERLY FROM AN OLD LOGGING ROAD. IT IS UNSUITABLE FOR PREMARKING AND G.P.S. CONTROL.

MONUMENTS AND ACCESSORIES FOUND (CONDITION AND SOURCE):

FOUND: 3/4" INSIDE DIAMETER IRON PIPE WITH THE TOP PINCHED SHUT FOR THE CORNER (3/4" PIPE AS PER RECORD [02]).
 FOUND: A PARTLY ROTTED 21" OAK STUMP, BEARS S 63° 30' W 31.44 FEET (10", S 62° W 31.02 FEET, FACE MEASUREMENT AS PER RECORD [01]). SET A PK NAIL AND WASHER IN THE NORTHWESTERLY BASE.
 NO OTHER RECORD EVIDENCE WAS RECOVERED.

MONUMENT SET (PROCEDURES AND DESCRIPTION):

SET: 2" INSIDE DIAMETER X 36" LONG IRON PIPE WITH A 3 1/4" BENTON COUNTY BRASS CAP, STAMPED AS SHOWN, CENTERED OVER THE RECOVERED 3/4" PIPE.

NEW ACCESSORIES:

SET: REBAR (SEE NOTES), 5" BELOW GROUND SURFACE, BEARS N 69° 00' W 22.18 FEET.
 SET: REBAR (SEE NOTES), 4" BELOW GROUND SURFACE, BEARS N 51° 25' E 26.05 FEET.
 SET: REBAR (SEE NOTES), 4" BELOW GROUND SURFACE, BEARS S 5° 05' E 23.85 FEET.
 A 7" DOUGLAS FIR, BEARS S 87° 25' W 32.92 FEET, FACED AND SCRIBED "XBT". SET SPIKE (5") AND WASHER IN THE SOUTHERLY BASE.
 A 13" DOUGLAS FIR, BEARS N 43° 35' W 29.90 FEET, FACED AND SCRIBED "XBT". SET SPIKE (5") AND WASHER IN THE SOUTHWESTERLY BASE.
 SET: A LOCATION TAG ON A 21" DOUGLAS FIR APPROXIMATELY 270 FEET EASTERLY FROM THE CORNER AND ON THE WESTERLY SIDE OF THE NORTHERLY END OF AN APPROXIMATELY 15 YEAR OLD DIRT ROAD.
 SET: ORANGE FIBERGLASS "SURVEY MARKER" POST 1 FOOT EASTERLY.

MONUMENT DETAIL

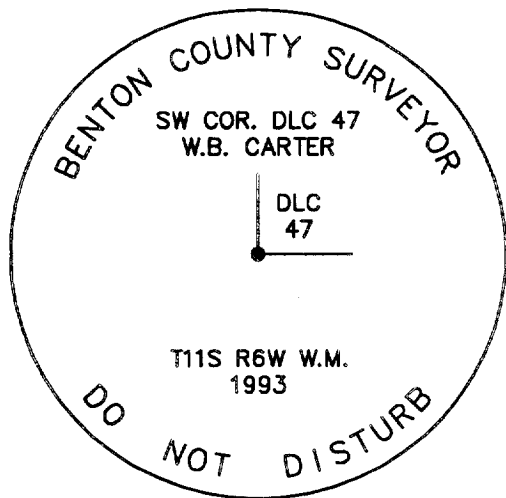

3 1/4" BRASS CAP

SKETCH

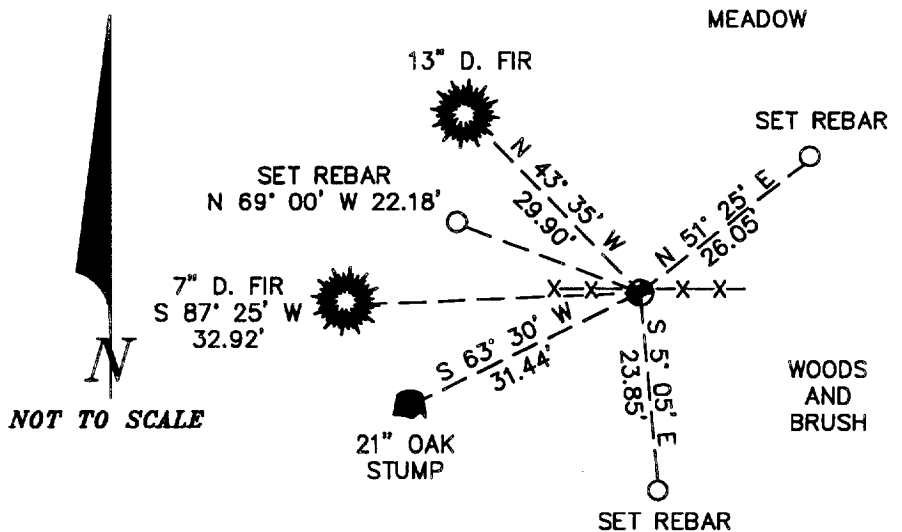

NOTES:

COMPASS DECLINATION IS 20° EAST. ALL MEASURED DISTANCES AND COMPASS BEARINGS ARE TO THE CENTER OF THE OBJECT, UNLESS OTHERWISE NOTED. ALL BEARING TREES ARE PAINTED AND HAVE A B.T. TAG ATTACHED, FACING THE CORNER UNLESS OTHERWISE NOTED. ALL NEW BEARING TREES HAVE A BRASS WASHER (STAMPED "BENTON COUNTY SURVEYOR") ATTACHED TO A SIDE CENTER UNLESS OTHERWISE NOTED. ALL LIVE BEARING TREES HAVE A PLASTIC WASHER (STAMPED "BENTON COUNTY SURVEYOR CORNER RESTORATION") ATTACHED TO THE BACK OF THE TREE OPPOSITE THE CORNER UNLESS OTHERWISE NOTED. ALL SET REBAR ARE 5/8" X 30" AND HAVE A YELLOW PLASTIC CAP (STAMPED "BENTON COUNTY SURVEYOR") ATTACHED TO THE TOP.

THIS DOCUMENT WAS NAMED AND CREATED IN A MANNER SIMILAR TO THE HISTORY FORM. THE NAME OF THE BOILER PLATE IS "MONUMENT". THE BORDER, STAMP AND SKETCH ARE FROM AUTOCAD RELEASE 12.

THIS RESTORATION WAS PERFORMED AT THE DIRECTION AND APPROVAL OF THE BENTON COUNTY/DEPUTY COUNTY SURVEYOR. *OB*

FIRM/AGENCY: BENTON COUNTY SURVEYOR'S OFFICE
ADDRESS: 360 S.W. AVERY AVE. CORVALLIS OR 97333; PH. 757-6821
SURVEYOR: CURTIS J. LIESENFELT
SURVEY CREW: MARK E. ANDERSON

REGISTERED PROFESSIONAL LAND SURVEYOR

Curtis J. Liesenfelt

OREGON
 JULY 17, 1986
CURTIS J. LIESENFELT
 2213

LICENSE EXPIRES 12/31/1994

TOWNSHIP 11 SOUTH, RANGE 6 WEST, WILLAMETTE MERIDIAN; SECTION 26 CORNERDONATION LAND CLAIM WM. B. CARTER NO. 47CORNER SW**COMMON CORNER(S):****UPDATES AND REVISIONS:****CORNER RECORDS (PREVIOUS RENEWALS, SURVEYS, ETC.)**

- [01] ORIGINAL GLO SURVEY BY DENNIS HATHORN DATED SEPTEMBER 16, 1856.
- [02] COUNTY SURVEY NO. 291 BY W.C. GALLOWAY DATED FEBRUARY 23, 1912 (FIELD BOOK NO. 10, PAGE 61).
- [03] OLD CORNER RESTORATION BOOK NO. 1 PAGE 30 BY W.C. GALLOWAY DATED FEBRUARY 23, 1912.
- [04] CORNER RESTORATION NO. 915 BY W.C. GALLOWAY DATED FEBRUARY 23, 1912.
- [05] MAP NO. 11-6-00011 BY BENTON COUNTY SURVEYOR'S OFFICE DATED MARCH OF 1923.
- [06] COUNTY SURVEY NO. 1477 BY BURT WILKES DATED MAY 29, 1940 (FIELD BOOK NO. 68, PAGE 22).
- [07] MAP NO. 11-6-00018 BY BURT WILKES DATED JUNE OF 1940.
- [08] COUNTY SURVEY NO. 5492 BY FRED LEMKE DATED JUNE 10, 1973.
- [09] MINOR LAND PARTITION NO. 69 BY TED LANGTON DATED DECEMBER 20, 1985.
- [10] CORNER RESTORATION NO. 3356 BY TED LANGTON DATED JANUARY 10, 1986.

COMMENTS/LOCATION/ETC:

THE SURVEYOR IN RECORD [01] MEASURED DISTANCES TO THE FACE OF BEARING TREES.
RECORD [04] IS A TRANSCRIBED COPY OF RECORD [03] AND CONTAINS OMISSIONS.

NOTES:

THIS IS A MICROSOFT WORD (VERSION 5.0) DOCUMENT NAMED "16847030" CREATED FROM A BOILER PLATE DOCUMENT NAMED "HISTORY", WHICH HAS A STYLESHEET NAMED "CORNER" ATTACHED TO IT.

FIRM/AGENCY: BENTON COUNTY SURVEYOR'S OFFICE**ADDRESS:** 360 S.W. AVERY AVE. CORVALLIS OR 97333; PH. 757-6821**RESEARCH BY:** CURTIS J. LIESENFELT/MARK E. ANDERSON**DATA ENTRY BY:** COLETTE MONACO