

1 1 6 8 5 0 0 4 0

DATE 07/16/2020TOWNSHIP 11 SOUTH, RANGE 6 WEST, WILLAMETTE MERIDIAN; SECTION 28 CORNER N/A
DONATION LAND CLAIM PERMAN HENDERSON NO. 50 CORNER NORTHWEST**COMMON CORNER(S):**

POINT ON AN INTERIOR LINE OF THE WILLIAM PEARSON DONATION LAND CLAIM NO. 51

RECORDS (INFORMATION IN *BOLD ITALICS* IS COUNTY STAFFS' INTERPRETATION OF THE RECORD)

BASED ON EXTENSIVE RESEARCH AND RECOVERY OF EVIDENCE, THIS OFFICE HAS DETERMINED THAT MOST GENERAL LAND OFFICE SURVEYORS IN BENTON COUNTY BEFORE 1890 MEASURED TO THE FACE OF BEARING TREES.

- [01] GENERAL LAND OFFICE (GLO) NOTES OF THE PERMAN HENDERSON DONATION LAND CLAIM NO. 50 BY DENNIS HATHORN, D.S., DATED MARCH 27, 1855. *SET POST FROM WHICH AN ASH 12" DIA BEARS NORTH, 5 LINKS (3.30 FEET); ASH 15" DIA BEARS N80°W, 3 LINKS (1.98 FEET).*
- [02] BENTON COUNTY SURVEY NO. 893 (OLD NO. 296) FIELD NOTES (FIELD BOOK 30, PAGE 71) BY WALTER W. LARSEN, D.C.S., DATED FEBRUARY, 1924. *SET 1" ROD AND STONE. ASH 10" DIA ON RIVER BANK BEARS N50°W, 0.950 CHAINS (62.70 FEET); MAPLE STUMP BEARS N5°W, 0.150 CHAINS (9.90 FEET).*
- [03] BENTON COUNTY CORNER RESTORATION BOOK NO. 1, PAGE 171 BY WALTER W. LARSEN, D.C.S., NO DATE GIVEN. *SET 1" ROD AND STONE. MAPLE STUMP 30" DIA BEARS N5°W, 0.15 CHAINS (9.90 FEET); ASH 10" DIA BEARS NW, 0.95 CHAINS (62.70 FEET).*
- [04] BENTON COUNTY CORNER RESTORATION NO. 920. *TRANSCRIBED FROM RECORD [03] AND MAY CONTAIN ERRORS AND/OR OMISSIONS.*
- [05] BENTON COUNTY SURVEY NO. 1412 (OLD NO. 296) FIELD NOTES (FIELD BOOK 55, PAGE 91) BY W. C. GALLOWAY, C.S., NO DATE GIVEN. *SET 1-1/4" X 28" SHAFT, 13" UNDER GROUND SURFACE. ASH 10" DIA (CSBT) BEARS N52°45'W, 0.95 CHAINS (62.70 FEET); ALDER 12" DIA BEARS S75°30'W, 1.097 CHAINS (72.40 FEET).*
- [06] BENTON COUNTY MAP NO. 11-6-00016 BY UNKNOWN DRAFTSMAN, NO DATE GIVEN. *1-1/4" SHAFT 13" UNDER SURFACE. ASH 10" DIA (CSBT) BEARS N52-3/4°W, 0.950 CHAINS (62.70 FEET); ALDER 12" DIA (CSBT) BEARS S75-1/2°W, 1.097 CHAINS (72.40 FEET).*
- [07] BENTON COUNTY SURVEY NO. 1803 BY MARTIN P. COOPEY, P.L.S., DATED AUGUST 23, 1946. *FOUND 1-1/4" SHAFT 13" UNDER SURFACE. ASH 10" DIA (CSBT) BEARS N52-3/4°W, 0.950 CHAINS (62.70 FEET); ALDER 12" DIA (CSBT) BEARS S75-1/2°W, 1.097 CHAINS (72.40 FEET).*
- [08] BENTON COUNTY SURVEY NO. 2008 BY OTTO H. MEYER, P.E., DATED APRIL 6, 1948. *IRON IN PLACE.*
- [09] BENTON COUNTY SURVEY NO. 4301 BY B. OSBURN SHAW, P.L.S., DATED AUGUST 26, 1966. *FOUND 1-1/4" SHAFT 12" BELOW GROUND.*
- [10] BENTON COUNTY SURVEY NO. 5539 BY FRED I. LEMKE, P.L.S., DATED JULY 11, 1973. *FOUND 1-1/4" SHAFT 12" UNDER SURFACE.*
- [11] BENTON COUNTY SURVEY NO. 5921 BY KENNETH M. WIGHTMAN, II, P.L.S., DATED AUGUST 4, 1975. *FOUND 1-1/4" SHAFT.*
- [12] BENTON COUNTY SURVEY NO. 6927 BY FRED I. LEMKE, P.L.S., DATED MAY, 1979. *FOUND 1-1/4" ROD.*
- [13] BENTON COUNTY SURVEY NO. 7118 BY MICHAEL D. LEMKE, P.L.S., DATED AUGUST 15, 1980. *FOUND 1-1/4" IRON SHAFT 13" BELOW SURFACE FROM WHICH FOUND 1/2" PIPE WITH FLANGE BEARS NW, 0.25 FEET; IRON FENCE POST GUARD STAKE BEARS SOUTH, 0.5 FEET; 4" X 4" CEDAR POST BEARS SE, 0.5 FEET.*
- [14] BENTON COUNTY CORNER RESTORATION NO. 3934 BY CURTIS J. LIESENFELT, P.L.S., DATED MAY 15, 1991. *FOUND 1-1/2" IRON SHAFT 14" BELOW GROUND SURFACE FOR THE CORNER. FOUND 1/2" INSIDE DIAMETER IRON PIPE WITH A FLANGE ON THE TOP 10" BELOW GROUND SURFACE BEARS N30°E, 0.20 FEET. LOWERED THE PIPE TO A POINT 16" BELOW GROUND SURFACE. FOUND STEEL FENCE POST BEARS S15°E, 0.7 FOOT. FOUND AN ASH 26" DIA (CSBT) WITH A ROTTED OUT FACE BEARS N50°30'W, 63.20 FEET. SET A PK NAIL AND BRASS WASHER STAMPED "BENTON COUNTY SURVEYOR" (BCBW) IN THE SOUTHWESTERLY BASE. USED THE 1-1/2" IRON SHAFT, AS RECOVERED, FOR THE CORNER MONUMENT. GRAND FIR 23" DIA BEARS N86°30'E, 200.14 FEET, FACED AND SCRIBED "DLC 51 BT". SET A PK NAIL AND BCBW IN THE NORTHERLY BASE. FIR 18" DIA BEARS S43°E, 223.15 FEET, FACED AND SCRIBED "DLC 50 BT". SET A PK NAIL AND BCBW IN THE SOUTHWESTERLY BASE. SET 5/8" X 30" REBAR WITH A YELLOW PLASTIC CAP MARKED "BENTON COUNTY SURVEYOR" BEARS S66°15'W, 60.20 FEET. SET ORANGE FIBERGLASS "SURVEY STAKE" POST 1 FOOT NORTHERLY. SET 4" X 4" CEDAR POST 0.70 FOOT EASTERLY.*
- [15] BENTON COUNTY SURVEY NO. 8671 BY PAUL WILLIAM MEYERS, P.L.S., DATED JANUARY 14, 1993. *FOUND 1-1/4" SHAFT 13" BELOW GROUND WITH CEDAR POST, STEEL POST AND FIBERGLASS MARKER.*
- [16] BENTON COUNTY SURVEY NO. 9101 BY PAUL MEYERS, P.L.S., DATED APRIL 10, 1996. *FOUND 1-1/4" IRON SHAFT.*
- [17] BENTON COUNTY SURVEY NO. 9326 BY JIM S. PETERSON, P.L.S., DATED JUNE 25, 1998. *FOUND 1-1/4" SHAFT.*

FIRM/AGENCY: BENTON COUNTY SURVEYOR'S OFFICE
ADDRESS: 360 S.W. AVERY AVE., CORVALLIS, OR 97333; PH. 541-766-6821
RESEARCH BY: DAVID L. MALONE, P.L.S.
DATA ENTRY BY: SAME

BENTON COUNTY CORNER RESTORATION FORM

3934

TOWNSHIP 11 S RANGE 6 W SECTION 28 D.L.C. PERMAN HENDERSON NO. 50 CORNER NW
DATE 5/15/91 CORNER RESTORATION FIELD BOOK NUMBER 9 PAGE(S) 47

CORNER DESIGNATION:

THE NORTHWEST CORNER OF THE PERMAN HENDERSON
DLC NO. 50, IN T 11 S, R 6 W, WILLAMETTE
MERIDIAN.

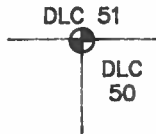

- CONDITION REPORT ONLY
- REFERENCED OUT
- RENEWED
- SURVEYED IN

LOCATION AND COMMENTS:

THE CORNER IS LOCATED IN AN APPROXIMATELY 3 YEAR OLD FIR PLANTATION, APPROXIMATELY 50 FEET EASTERLY FROM THE EASTERLY TOP OF BANK ON THE MARYS RIVER AND APPROXIMATELY 550 FEET SOUTHERLY FROM AN EAST-WEST WOVEN AND BARBED WIRE FENCE.

PREVIOUS RENEWALS/SURVEYS, ETC:

- ORIGINAL GLO SURVEY BY DENNIS HATHORN DATED SEPTEMBER 16, 1856.
- COUNTY SURVEY NO. 893 BY WALTER W. LARSON DATED FEBRUARY OF 1924.
- OLD CORNER RESTORATION BOOK NO. 1 PAGE 171 BY WALTER W. LARSON (NO DATE GIVEN).
- CORNER RESTORATION NO. 920 BY WALTER W. LARSON DATED FEBRUARY OF 1924.
- MAP NO. 11-6-00016 BY UNKNOWN PERSON (NO DATE GIVEN).
- COUNTY SURVEY NO. 1412 BY W.C. GALLOWAY (NO DATE GIVEN).
- COUNTY SURVEY NO. 1803 BY MARTIN P. COOPEY DATED AUGUST 23, 1946.
- COUNTY SURVEY NO. 2008 BY OTTO H. MEYER DATED APRIL 6, 1948.
- COUNTY SURVEY NO. 4301 BY B. OSBURN SHAW DATED AUGUST 26, 1966.
- COUNTY SURVEY NO. 5539 BY FRED LEMKE DATED JULY 11, 1973.
- COUNTY SURVEY NO. 5921 BY KEN WIGHTMAN II DATED AUGUST 4, 1975.
- COUNTY SURVEY NO. 6927 BY FRED LEMKE DATED MAY OF 1979.
- COUNTY SURVEY NO. 7118 BY MICHAEL LEMKE DATED AUGUST 15, 1980.

MONUMENTS AND ACCESSORIES FOUND (CONDITION AND SOURCE):

- FOUND: 1 1/2" IRON SHAFT 14" BELOW GROUND SURFACE FOR THE CORNER (1 1/4" SHAFT COUNTY SURVEY NO. 1412).
- FOUND: 1/2" INSIDE DIAMETER IRON PIPE WITH A FLANGE ON THE TOP 10" BELOW GROUND SURFACE, BEARS N 30° E 0.20 FEET (NW 0.25 FEET COUNTY SURVEY 7118). LOWERED THE PIPE TO A POINT 16" BELOW GROUND SURFACE.
- FOUND: STEEL FENCE POST BEARS S 15° E 0.7 FOOT (SOUTH 0.50 FEET COUNTY SURVEY NO. 7118).
- FOUND: AN ASH 26" IN DIAMETER WITH A ROTTED OUT FACE BEARS N 50° 30' W 63.20 FEET (10" DIAM. N 52° 45' W 62.70 FEET COUNTY SURVEY NO. 1412). SET A PK NAIL AND B.C.B.W. IN THE SOUTHWESTERLY BASE. SET A B.T. TAG ON THE SOUTHEASTERLY FACE.

NO OTHER RECORD BEARING OBJECTS WERE RECOVERED.

MONUMENT DETAIL



SKETCH

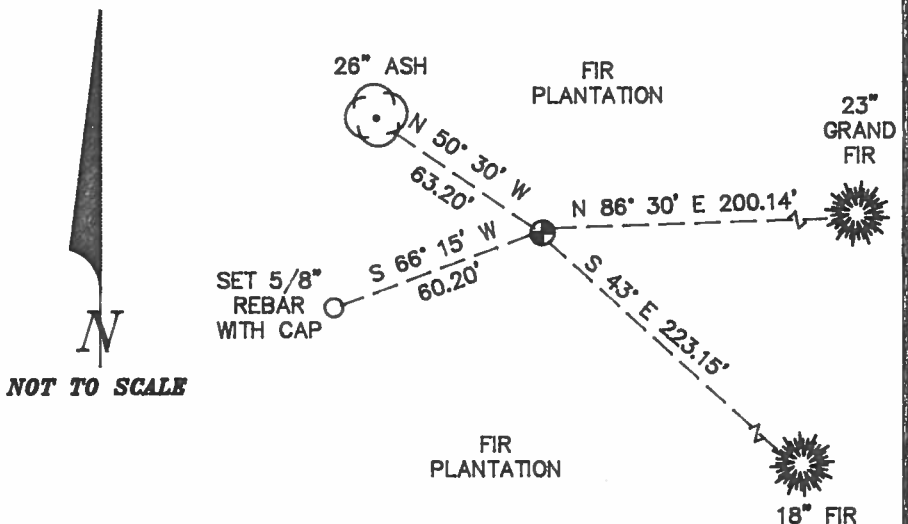

MONUMENT SET (PROCEDURES AND DESCRIPTION):

USED THE 1 1/2" IRON SHAFT, AS RECOVERED, FOR THE CORNER MONUMENT.

NEW ACCESSORIES:

- A GRAND FIR 23" IN DIAMETER BEARS N 86° 30' E 200.14 FEET, FACED AND SCRIBED "DLC 51 BT". SET A PK NAIL AND B.C.B.W. IN THE NORTHERLY BASE. SET A B.T. TAG ON THE WESTERLY FACE.
- A FIR 18" IN DIAMETER BEARS S 43° E 223.15 FEET, FACED AND SCRIBED "DLC 50 BT". SET A PK NAIL AND B.C.B.W. IN THE SOUTHWESTERLY BASE. SET A B.T. TAG ON THE NORTHWESTERLY FACE.
- SET: 5/8" X 30" REBAR WITH A YELLOW PLASTIC CAP MARKED "BENTON COUNTY SURVEYOR", BEARS S 66° 15' W 60.20 FEET.
- SET: ORANGE FIBERGLASS "SURVEY STAKE" POST 1 FOOT NORTHERLY.
- SET: 4" X 4" CEDAR POST 0.70 FOOT EASTERLY.

NOTES:

B.C.B.W. IS A BRASS WASHER STAMPED "BENTON COUNTY SURVEYOR". COMPASS DECLINATION IS 20' EAST. ALL MEASURED DISTANCES AND COMPASS BEARINGS ARE TO THE CENTER OF THE OBJECT, UNLESS OTHERWISE NOTED.
THIS RESTORATION WAS PERFORMED AT THE DIRECTION AND APPROVAL OF THE BENTON COUNTY SURVEYOR. *[Signature]*

FIRM/AGENCY: BENTON COUNTY SURVEYOR
ADDRESS: 360 S.W. AVERY AVE. CORVALLIS OR. 97333; PH. 757-6821
SURVEY CREW: CURTIS J. LIESENFELT & MARK E. ANDERSON
WITNESS:

REGISTERED
PROFESSIONAL
LAND SURVEYOR

Curtis J. Liesenfelt

OREGON
JULY 17, 1986
CURTIS J. LIESENFELT
2213

T115 R6W SEC. 28 NW COR PERMAN HENDERSON DILLCO 5/15/91, SET MEAS. KUH DATASCOPE BRUNTON COMP 20° E. OFC. 9/47

FIND: 1 1/2" IRON SHAFT 14" B.G.S FOR THE COR. (1 1/4" CS #1412)
 10" B.G.S
 1/2" ID. I.P @ A FLANGE ON THE TOP V BEARS N 30° E 10.20'
 (NW 0.25' CS # 7118). LOWERED THE PIPE TO A POINT
 16" B.G.S
 STEEL FENCE POST BEARS S 15° E ~ 0.7' (SOUTH 050'
 CSA 7118)

AN ASH 26" IN DIAM. @ A ROTTED OUT FACE BEARS
 N 50° 30' W ~ 63.20' (10" N 52° 45' W ~ 62.70' CS #1412)
 SET A PK + B.C.B.W. IN THE SW 1/4 BASE. SET A B.T. TAG
 ON THE SE 1/4 FACE.

NO OTHER RECORD BEARING OBJECTS WERE RECOVERED.
 WILL USE THE MON. AS RECOVERED FOR THE COR. MON.
 GRAND
 A FIR 23" IN DIA. BEARS N 86° 30' E ~ 200.14' FACED +
 SCRIBED "DLC 51 BT". SET A PK + B.C.B.W. IN THE N 1/4
 BASE. SET A B.T. TAG ON THE W 1/4 FACE.

A FIR 18" IN DIA. BEARS S 43° E ~ 223.15' FACED +
 SCRIBED "DLC 50 BT". SET A PK + B.C.B.W. IN THE SW 1/4
 BASE. SET A B.T. TAG ON THE NW 1/4 FACE.
 SET: 5/16" REBAR @ A T.P.C. MKD. "BENTON COUNTY SURVEYOR"
 BEARS S 65° 15' W ~ 60.20'

SET: ORANGE FIBERGLASS "SURVEY STAKE" POST 1' N 1/4
 4" x 4" CEDAR POST 0.7' E 1/4
 THE COR. IS LOCATED IN A 3 YEAR OLD FIR PLANTATION 50' E
 1/4 FROM THE E 1/4 TOP OF BANK ON THE MARYS RIVER +
 550' S 1/4 FROM A4 E-W WOOD + BW F.M.L. 17 IS GOOD
 FOR PREMARKING + GPS CONTROL.

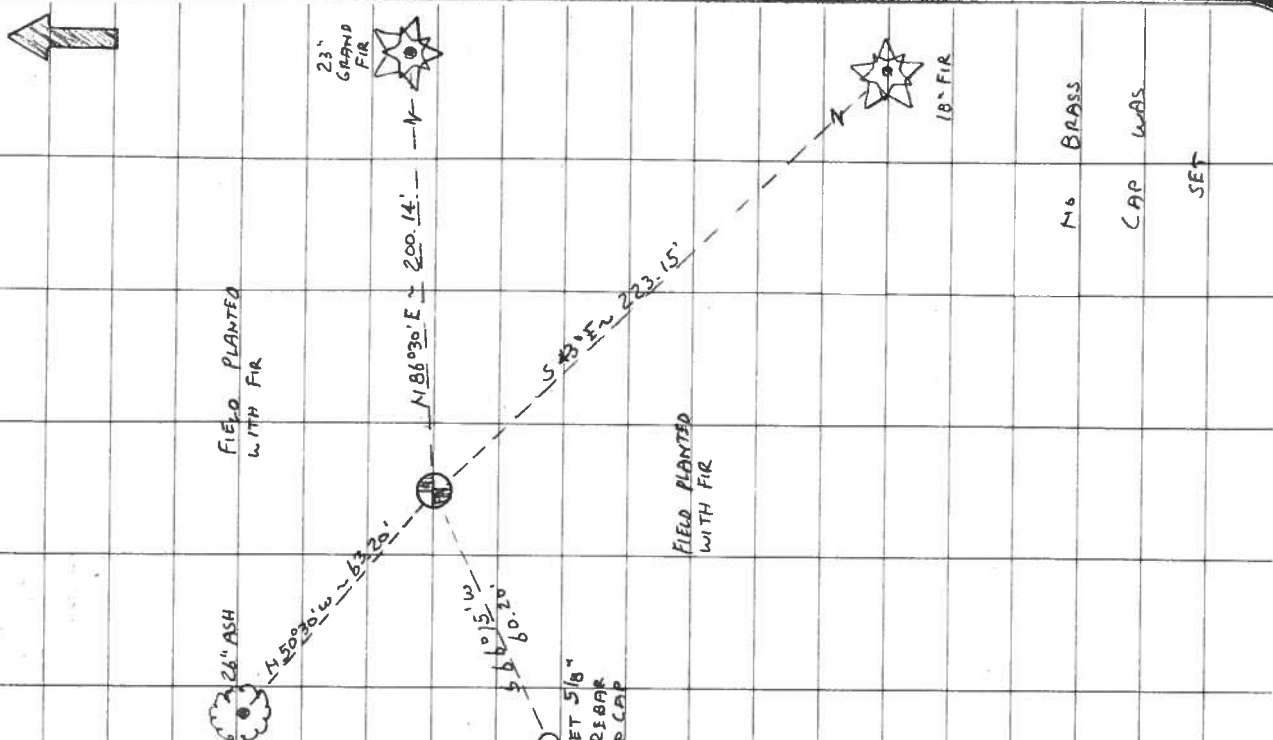

M6 BRASS
 CAP WAS
 SET

BENTON COUNTY CORNER RESTORATION Book NO. 1

W.M.
std.
6 W
W.M.
R & W
W.M.
SW

1/4 Sec. Cor. betw. sec's 10 & 15 T. 13S R. 2W.
Set bottle, shovel, & post.
Fir 50" N57°W 1.46 sta.
" 40" S71°W 1.92 "
Small fir near.

C.S. 81 Con
Nov 26.
1923
W.W.L.
+ Rossmoreans

N.W. Corner of the Arnold Fuller D.L.C. 38, T. 11S R. 5 W.
Set oak stk + buggy axle - old trees standing
Fir 12" in dia. bears S45°E. 1.06 chs. dist.
" 30" " " " N81 1/2°W. .276 " "

Most N. N.W. Cor. of Oscar F. Clark Cl. 42 T. 11 S. R. 5 W.
Set 1 1/4" pipe Found old fir stump.
Oak 12" in dia. bears S. 83°W. .273 chs. dist.
" 14" " " " S. 77°E. .368 " "

S.W. Cor. of Arnold Fuller Cl. 38, T. 11 S. R. 5 W. W.M.
Set 1" rod Found 60 Maple stump S.W.
Orig. Oak 24" in dia. bears S 78°W. .204 chs
" 14" " " " S. 72°E. .54'

N.W. Cor. of Abraham Locke Cl. 41, T. 11 S. R. 5 W. W.M.
Found 4"x6"x8" stone?
1" rod bears west 4.08 chs dist.

C.S. 947
307
W.W.L.
Stanley Trip Wil.
Harty

Most E. N.E. Cor. Stephen Howell Cl. 46, T. 14 S. R. 6 W.
Mkd. Sandstone in 1/2 road
Ash 18" in dia bears N10°W. 1.15 chs
Oak post 12" " " S3°E. .273

C.H. Leonard
Oct. 28, 1916

Set Meander corner 53.74 W. of N.E. Cor. sec. 25 T. 14-5
Set 1 1/2" pipe
Maple 30" South .63
" 14" N. 63°E. .25
Ash 12" S. 76°E. .54

C.S. 296 Con.
W.W. Larson
John Rickard

N.W. corner of Ferman Henderson Cl. 50 T. 11S. R. 6 W.
Set 1" rod + stone
Maple Stump 30" N. 5°W .15
Ash 10" N.W. .95

30" Interior Cor. Wm. Pearson Cl. 51 T. 11 S. R. 6 W.
Set 30# casting 14" under surface of ground.
a gear S89° 32' W .89
N.W. Cor Cl. 50 bears N89° 32' E 8.60

S.W. cor. of Ferman Henderson Cl. 50 T. 11S R. 6 W.
Set 2 stones 6"x8"x6"
Oak 8" in dia. bears N. 3°E. 1.10
" 6" " " " N 62°W. .295
" 24" " " " N 60°E. 2.98 orig.
" 10" " " " S 13°E. 24.87



N. W. corner of Perman Henderson Cl 50, Twp. 11 S., R. 6 W.

920

Reestablishment by W. W. Larsen

Date Feb 1924

Set 1" rod and stone

Maple stump 30" in diam bears N 5° W

.15 chains

Ash 10" in diam bears N. W.

.95 chains

Witness John Rickard