

TOWNSHIP 11 SOUTH, RANGE 6 WEST, WILLAMETTE MERIDIAN; SECTION 22 CORNER _____
DONATION LAND CLAIM WILLIAM CALDWELL NO. 62 _____ CORNER NW

COMMON CORNER(S):

THE EAST LINE OF THE WIDOW AND HEIRS OF SAM HUFFMAN DLC 69, IN TOWNSHIP 11 SOUTH, RANGE 6 WEST, WILLAMETTE MERIDIAN.

THE SOUTHWEST CORNER OF THE J.R. MCCORMICK DLC 66, IN TOWNSHIP 11 SOUTH, RANGE 6 WEST, WILLAMETTE MERIDIAN, NO. 116866030.

UPDATES AND REVISIONS:

CORNER RECORDS (PREVIOUS RENEWALS, SURVEYS, ETC.)

[01] ORIGINAL GLO SURVEY BY DAVID STUMP DATED NOVEMBER 6, 1856.

COMMENTS/LOCATION/ETC:

DAVID STUMP MEASURED HIS BEARING TREES TO THE CENTER.

NOTES:

THIS IS A MICROSOFT WORD (VERSION) DOCUMENT NAMED "16862060" CREATED FROM A BOILER PLATE DOCUMENT NAMED "HISTORY", WHICH HAS A STYLE SHEET NAMED "CORNER" ATTACHED TO IT.

FIRM/AGENCY: BENTON COUNTY SURVEYOR'S OFFICE
ADDRESS: 360 S.W. AVERY AVE. CORVALLIS OR 97333; PH. 757-6821
RESEARCH BY: CURTIS J. LIESENFELT/MARK E. ANDERSON
DATA ENTRY BY: MARK E. ANDERSON

BENTON COUNTY CORNER RESTORATION FORM, PAGE 1 OF 1, 116862060R1

SEE CORNER HISTORY FORM FOR RECORDS ETC.

CORNER RESTORATION FIELD BOOK NUMBER 14 PAGE(S) 7 DATE 5/5/1993
 TOWNSHIP 11 SOUTH, RANGE 6 WEST, WILLAMETTE MERIDIAN; SECTION 22 CORNER
 DONATION LAND CLAIM WILLIAM CALDWELL NO. 62 CORNER NW
 CONDITION REPORT ; REFERENCED OUT ; RENEWED XX; SURVEYED IN

LOCATION AND COMMENTS:

THE CORNER IS LOCATED 0.8 FOOT SOUTHEASTERLY AT RIGHT ANGLES TO A NORTHEAST-SOUTHWEST WOVEN AND BARBED WIRE FENCE AT THE BASE OF A HEAVILY WOODED AND BRUSHY NORTHWESTERLY FACING HILLSIDE. IT IS UNSUITABLE FOR PREMARKING BUT MAY BE OK FOR G.P.S. CONTROL.

MONUMENTS AND ACCESSORIES FOUND (CONDITION AND SOURCE):

FOUND: A 33" OAK, BEARS S 79° 39' E 66.33 FEET (15", S 74° E 66.00 FEET AS PER [1]). CUT OPEN AND FOUND A FACE WITH SOME ILLEGIBLE BACKCAST SCRIBING. SET A PK NAIL AND WASHER IN THE NORHTERLY BASE.
 FOUND: A MOSTLY ROTTED 26" OAK STUMP WITH A ROTTED OUT FACE, BEARS S 38° 31' E 78.22 (24" S 38° E 78.54 FEET AS PER [1]). SET A PK NAIL AND WASHER IN THE NORTHEASTERLY BASE.
 NO OTHER RECORD EVIDENCE WAS RECOVERED.

MONUMENT SET (PROCEDURES AND DESCRIPTION):

SET: 2" INSIDE DIAMETER X 36" LONG IRON PIPE WITH A 3 1/4" BENTON COUNTY BRASS CAP, STAMPED AS SHOWN AT THE RECORD DISTANCES (ALLOWING FOR PLUS OR MINUS ONE HALF LINK OF PRECISION) AS PER RECORD [01].

NEW ACCESSORIES:

A 15" DOUGLAS FIR, BEARS N 75° 56' E 83.02 FEET, FACED AND SCRIBED "DLC 66 BT". SPIKED (5") AND WASHERED THE SOUTHERLY BASE.
 A 15" DOUGLAS FIR, BEARS S 10° 10' E 25.02 FEET, FACED AND SCRIBED "DLC 62 BT". SPIKED (5") AND WASHERED THE EASTERLY BASE.
 SET: REBAR (SEE NOTES), 6" BELOW GROUND SURFACE, BEARS S 64° 37' W 34.58 FEET. SAID REBAR IS 13 FEET NORTHWESTERLY AT RIGHT ANGLES TO A WOVEN AND BARBED WIRE FENCE.
 SET: REBAR (SEE NOTES), 6" BELOW GROUND SURFACE, BEARS N 2° 25' E 24.58 FEET. SAID REBAR IS 15 FEET NORTHWESTERLY AT RIGHT ANGLES TO A WOVEN AND BARBED WIRE FENCE.
 SET: REBAR (SEE NOTES), 4" BELOW GROUND SURFACE, BEARS S 74° 42' E 36.28 FEET.
 SET: ORANGE FIBERGLASS "SURVEY MARKER" POST 1 FOOT SOUTHEASTERLY.

MONUMENT DETAIL

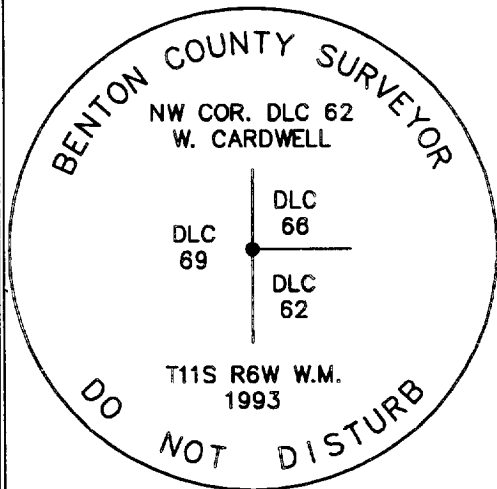

3 1/4" BRASS CAP

SKETCH

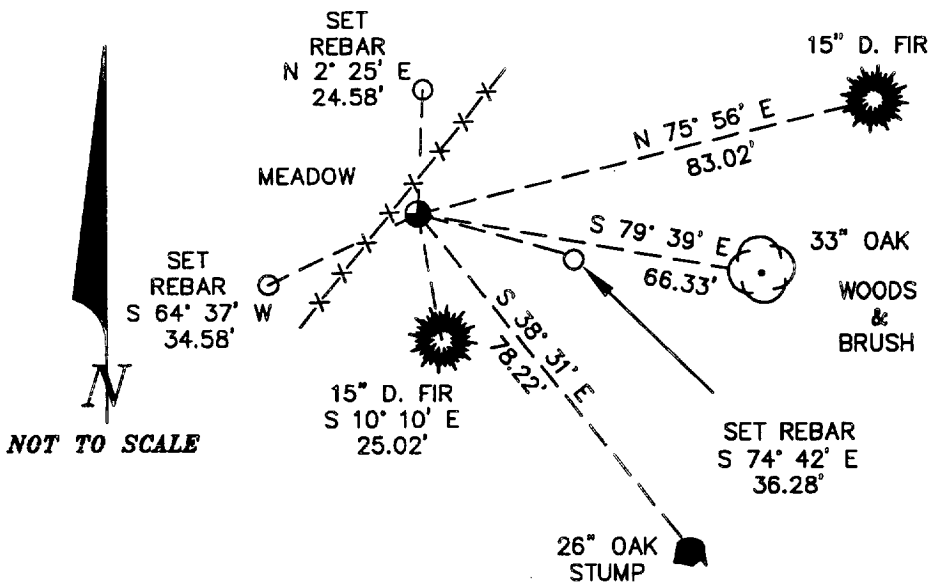

NOTES:

COMPASS DECLINATION IS 20° EAST. ALL MEASURED DISTANCES AND COMPASS BEARINGS ARE TO THE CENTER OF THE OBJECT, UNLESS OTHERWISE NOTED. ALL BEARING TREES ARE PAINTED AND HAVE A B.T. TAG ATTACHED, FACING THE CORNER UNLESS OTHERWISE NOTED. ALL NEW BEARING TREES HAVE A BRASS WASHER (STAMPED "BENTON COUNTY SURVEYOR") ATTACHED TO A SIDE CENTER. ALL LIVE BEARING TREES HAVE A PLASTIC WASHER (STAMPED "BENTON COUNTY SURVEYOR CORNER RESTORATION") ATTACHED TO THE BACK OF THE TREE OPPOSITE THE CORNER. ALL SET REBAR ARE 5/8" X 30" AND HAVE A YELLOW PLASTIC CAP (STAMPED "BENTON COUNTY SURVEYOR") ATTACHED TO THE TOP.

THIS DOCUMENT WAS NAMED AND CREATED IN A MANNER SIMILAR TO THE HISTORY FORM. THE NAME OF THE BOILER PLATE IS "MONUMENT". THE BORDER, STAMP AND SKETCH ARE FROM AUTOCAD RELEASE 12.

THIS RESTORATION WAS PERFORMED AT THE DIRECTION AND APPROVAL OF THE BENTON COUNTY/DEPUTY COUNTY SURVEYOR *LB*.

FIRM/AGENCY: BENTON COUNTY SURVEYOR'S OFFICE
ADDRESS: 360 S.W. AVERY AVE. CORVALLIS OR 97333; PH. 757-6821
SURVEYOR: CURTIS J. LIESENFELT
SURVEY CREW: MARK E. ANDERSON

**REGISTERED
PROFESSIONAL
LAND SURVEYOR**

Curtis J. Liesenfelt

**OREGON
JULY 17, 1986
CURTIS J. LIESENFELT
2213**

LICENSE EXPIRES 12/31/1994