

**1 1 6 8 6 4 0 2 0**

DATE 05/04/2021TOWNSHIP 11 SOUTH, RANGE 6 WEST, WILLAMETTE MERIDIAN; SECTION 18 CORNER N/A  
DONATION LAND CLAIM BRITTAN WOOD NO. 64 CORNER SOUTHEAST**COMMON CORNER(S):**

NONE

**RECORDS (INFORMATION IN *BOLD ITALICS* IS COUNTY STAFFS' INTERPRETATION OF THE RECORD)**

BASED ON EXTENSIVE RESEARCH AND RECOVERY OF EVIDENCE, THIS OFFICE HAS DETERMINED THAT MOST GENERAL LAND OFFICE SURVEYORS IN BENTON COUNTY BEFORE 1890 MEASURED TO THE FACE OF BEARING TREES.

- [01] GENERAL LAND OFFICE (GLO) NOTES OF THE BRITTAN WOOD DONATION LAND CLAIM (DLC) NO. 64 BY DAVID STUMP, D.S., DATED MARCH 24, 1856. *SET POST MARKED AS PER INSTRUCTIONS ON SECTION LINE BETWEEN SECTIONS 18 AND 19 FOR TRUE SOUTHEAST CORNER TO SAID CLAIM NO. 64, FROM WHICH A R. FIR 40" DIA BEARS S86°W, 50 LINKS (33.00 FEET); W. FIR 12" DIA BEARS N6°W, 71 LINKS (46.86 FEET).*
- [02] BENTON COUNTY SURVEY NO. 503 (OLD NO. 196) FIELD NOTES (FIELD BOOK 18, PAGE 73) BY W. C. GALLOWAY, C.S., NO DATE GIVEN. *SET 1/2" X 1/2" IRON BAR, STAKE HOLE. W. FIR 5" DIA BEARS S84°E, 0.194 CHAINS (12.80 FEET); W. FIR 12" DIA (GLO BT) BEARS N6°W, 0.71 CHAINS (46.86 FEET), STANDING.*
- [03] BENTON COUNTY CORNER RESTORATION BOOK NO. 1, PAGE 93, BY W. C. GALLOWAY, C.S., DATED MARCH, 1915. *SET 1/2" X 1/2" IRON BAR, STAKE HOLE. W. FIR 5" DIA (CSBT) BEARS S84°E, 0.194 CHAINS (12.80 FEET); W. FIR 12" DIA (GLO BT) BEARS N6°W, 0.71 CHAINS (46.86 FEET), STANDING.*
- [04] BENTON COUNTY CORNER RESTORATION NO. 961. *TRANSCRIBED FROM RECORD [03] AND MAY CONTAIN ERRORS AND/OR OMISSIONS.*
- [05] BENTON COUNTY MAP NO. 11-6&7-00007 BY W. C. GALLOWAY, C.S., DATED MAY 12, 1915. *1/2" X 1/2" IRON BAR. W. FIR 5" DIA (CSBT) BEARS S84°E, 0.194 CHAINS (12.80 FEET); W. FIR 12" DIA (GLO BT) BEARS N6°W, 0.71 CHAINS (46.86 FEET), STANDING.*
- [06] BENTON COUNTY SURVEY NO. 2648 BY CURTIS C. HANSON, C.S., DATED JANUARY 12, 1955. *CORNER NOT DESCRIBED.*
- [07] BENTON COUNTY SURVEY NO. 7249 BY GARY T. JOHNSTON, P.L.S., DATED MARCH 25, 1981. *FOUND 1/2" X 1/2" IRON BAR. WHITE FIR STUMP 24" DIA (CSBT) BEARS S84°E, 0.194 CHAINS (12.80 FEET), FACE VISIBLE; ROTTED WHITE FIR STUMP 36" DIA (GLO BT) BEARS N6°W, 0.71 CHAINS (46.86 FEET), NO SCRIBES.*
- [08] BENTON COUNTY CORNER RESTORATION NO. 963. *TRANSCRIBED FROM RECORD [07] AND MAY CONTAIN ERRORS AND/OR OMISSIONS.*
- [09] BENTON COUNTY CORNER RESTORATION NO. 3837 BY DANNA L. FEHRENBACHER, C.S., DATED OCTOBER 31, 1990. *FOUND 1/2" X 1/2" X 40" IRON ROD FOR THE CORNER. THE ROD WAS 16" ABOVE GROUND SURFACE AND HAS A 1-1/2" X 6" FLANGE WITH A 45° ANGLE ON TOP. FOUND A MOSTLY ROTTED FIR STUMP ABOUT 36" DIA (GLO BT) BEARS N4°W, 46.9 FEET. FOUND A PARTLY ROTTED FIR STUMP 24" DIA (CSBT) WITH A HEALED OVER FACE BEARS S83°E, 12.86 FEET. FOUND A FIR 16" DIA WITH A HEALED FACE BEARS S8°E, 5.30 FEET, THERE IS NO RECORD OF THIS TREE. SET A PK NAIL AND BRASS WASHER STAMPED "BENTON COUNTY SURVEYOR" (BCBW) IN THE EASTERLY BASE. SET 2" INSIDE DIAMETER X 36" LONG IRON PIPE WITH A 3-1/4" BENTON COUNTY BRASS CAP STAMPED "SE COR DLC 64 B WOOD DLC 64 T11S R6W WM 1990" IN THE SAME POSITION AS THE RECOVERED IRON ROD. BURIED THE ROD HORIZONTALLY ALONG THE NORTH SIDE OF THE NEW MONUMENT. FIR 14" DIA BEARS N37°E, 20.21 FEET, FACED AND SCRIBED "X BT". SET A PK NAIL AND BCBW IN THE NORTHWESTERLY BASE. FIR 16" DIA BEARS N43°W, 36.33 FEET, FACED AND SCRIBED "DLC 64 BT". SET A PK NAIL AND BCBW IN THE NORTHEASTERLY BASE. FIR 24" DIA BEARS S57°W, 44.82 FEET, FACED AND SCRIBED "X BT". SET A PK NAIL AND BCBW IN THE SOUTHEASTERLY BASE. SET ORANGE FIBERGLASS "SURVEY MARKER" POST 0.5 FOOT EASTERLY.*
- [10] BENTON COUNTY PARTITION PLAT NO. 1994-19 BY LOREN F. JAY, P.L.S., DATED FEBRUARY 4, 1994. *BENTON COUNTY BRASS CAP IN CONCRETE POST MARKED 3837.*
- [11] BENTON COUNTY SURVEY NO. 10304 BY DAVID M. DEAN, P.L.S., DATED MAY, 2008. *3-1/4" BRASS DISK ON 2" GALVANIZED IRON PIPE.*

**FIRM/AGENCY:** BENTON COUNTY SURVEYOR'S OFFICE  
**ADDRESS:** 360 S.W. AVERY AVE., CORVALLIS, OR 97333; PH. 541-766-6821  
**RESEARCH BY:** DAVID L. MALONE, P.L.S.  
**DATA ENTRY BY:** SAME

BENTON COUNTY CORNER RESTORATION FORM

3837

SECTION 18 TOWNSHIP 11 S RANGE 6 W DLC BRITTAN WOOD NO. 64 CORNER SE  
 DATE 10/31/90 CORNER RESTORATION FIELD BOOK NUMBER 2 PAGE 10

CORNER DESIGNATION:

THE SOUTHEAST CORNER OF THE BRITTAN WOOD  
 DLC NO. 64 IN T 11 S, R 6 W, WILLAMETTE  
 MERIDIAN.

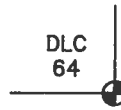

- CONDITION REPORT ONLY
- REFERENCED OUT
- RENEWED
- SURVEYED IN

LOCATION AND COMMENTS:

THE CORNER IS LOCATED IN A LEVEL MODERATELY WOODED AREA, APPROXIMATELY 400 FEET SOUTHWESTERLY FROM A LOGGING ROAD.

PREVIOUS RENEWALS/SURVEYS, ETC.:

ORIGINAL GLO SURVEY BY DAVID STUMP IN 1856.  
 CORNER RESTORATION NO. 961 BY W.C. GALLOWAY IN MARCH OF 1915.  
 CORNER RESTORATION NO. 963 BY GARY JOHNSTON ON MARCH 25, 1981.  
 COUNTY SURVEY NO. 7249 BY GARY JOHNSTON ON MARCH 25, 1981.

MONUMENTS AND ACCESSORIES FOUND (CONDITION AND SOURCE):

- FOUND: 1/2" X 1/2" X 40" IRON ROD FOR THE CORNER (CORNER RESTORATION NO. 961) THE ROD WAS 16" ABOVE GROUND SURFACE AND HAS A 1 1/2" X 6" FLANGE WITH A 45° ANGLE ON TOP.
  - FOUND: A MOSTLY ROTTED FIR STUMP ABOUT 36" IN DIAMETER BEARS N 4° W 46.9 FEET (N 6° W 46.86 FEET ORIGINAL GLO SURVEY). SET A B.T. TAG ON TOP.
  - FOUND: A PARTLY ROTTED FIR STUMP 24" IN DIAMETER WITH A HEALED OVER FACE, BEARS S 83° E 12.86 FEET (S 84° E 12.80 FEET CORNER RESTORATION NO. 961). SET A B.T. TAG ON THE TOP.
  - FOUND: A FIR 16" IN DIAMETER WITH A HEALED FACE BEARS S 8° E 5.30 FEET, THERE IS NO RECORD OF THIS TREE. SET A PK NAIL AND B.C.B.W. IN THE EASTERLY BASE. SET A B.T. TAG ON THE NORTHERLY FACE.
- NO OTHER RECORD BEARING OBJECTS WERE RECOVERED.

MONUMENT DETAIL

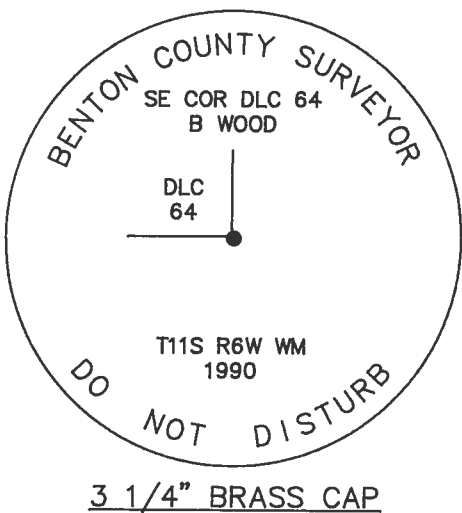

SKETCH

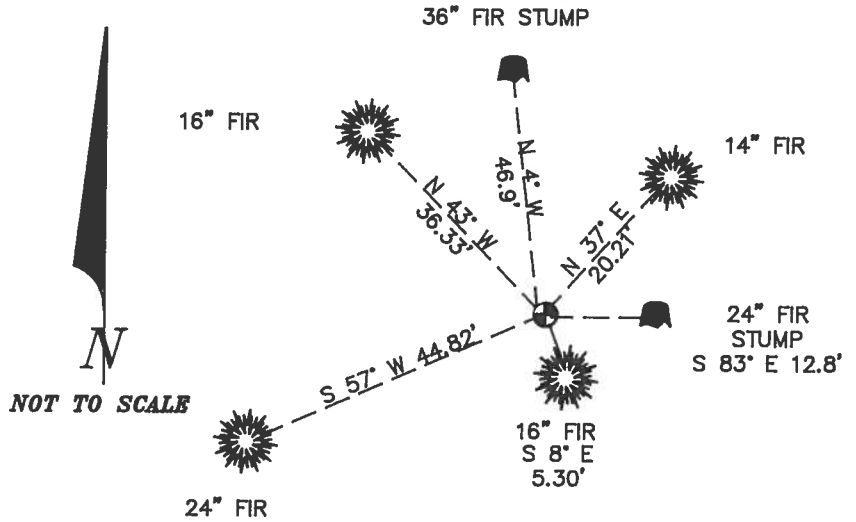

MONUMENT SET (PROCEDURES AND DESCRIPTION):

SET: 2" INSIDE DIAMETER X 36" LONG IRON PIPE WITH A 3 1/4" BENTON COUNTY BRASS CAP STAMPED AS SHOWN IN THE SAME POSITION AS THE RECOVERED IRON ROD, BURIED THE ROD HORIZONTALLY ALONG THE NORTH SIDE OF THE NEW MONUMENT.

NEW ACCESSORIES:

- A FIR 14" IN DIAMETER BEARS N 37° E 20.21 FEET FACED AND SCRIBED "X BT". SET A PK NAIL AND B.C.B.W. IN THE NORTHWESTERLY BASE. SET A B.T. TAG ON THE SOUTHWESTERLY FACE.
- A FIR 16" IN DIAMETER BEARS N 43° W 36.33 FEET, FACED AND SCRIBED "DLC 64 BT". SET A PK NAIL AND B.C.B.W. IN THE NORTHEASTERLY BASE. SET A B.T. TAG ON THE SOUTHEASTERLY FACE.
- A FIR 24" IN DIAMETER BEARS S 57° W 44.82 FEET FACED AND SCRIBED "X BT". SET A PK NAIL AND B.C.B.W. IN THE SOUTHEASTERLY BASE. SET A B.T. TAG ON THE NORTHEASTERLY FACE.

SET: ORANGE FIBERGLASS "SURVEY MARKER" POST 0.5 FOOT EASTERLY.

NOTES:

B.C.B.W. IS A BRASS WASHER STAMPED "BENTON COUNTY SURVEYOR". COMPASS DECLINATION IS 20° EAST. ALL MEASURED DISTANCES AND COMPASS BEARINGS ARE TO THE CENTER OF THE OBJECT, UNLESS OTHERWISE NOTED.

FIRM/AGENCY: BENTON COUNTY PUBLIC WORKS  
ADDRESS: 360 S.W. AVERY AVE. CORVALLIS OR. 97333; PH. 757-6821  
PARTY CHIEF: CURTIS J. LIESENFELT  
CREW: MARK E. ANDERSON  
WITNESS:

REGISTERED  
 PROFESSIONAL  
 LAND SURVEYOR

*Danna L. Fehrenbacher*

OREGON  
 JULY 16, 1982  
 DANNA L. FEHRENBACHER  
 1995

11. A PAIRLY BATTERED FIRE STUMP 24" IN DIA @ A HEAVY  
 OVER HANG BERRS 50' N 120° E (S BAY ~ 12.00  
 COR. REST NR 981) SET A BIT TR6 ON TOP  
 NB OTHER REARO BEARING OBJECTS WERE REMOVE AND  
  
 SET 2" INSIDE DIAMETER X 36" LENS IRON PIPE @ A THE  
 BEN. CO. BIG STAMPED AS SHOWN IN THE SAME  
 POSITION AS THE RECORDED IRON ROD. BURIED  
 THE IRON ROD. HUBB, ABOVE, THE N SIDE OF THE NEW  
 MARK  
  
 A FIRE 1/2" IN DIA. BERRS N 37° E ~ 20.2' FROM S. SCRIBED  
 X BIT SET A BIT X BERRS IN THE NEW BERRS SET  
 A BIT TR6 ON THE S W IN FACE  
  
 A FIRE 1/6" IN DIA. BERRS N 43° W ~ 36.3' FROM S. SCRIBED  
 X BIT SET A BIT X BERRS IN THE NEW BERRS  
 SET A BIT TR6 ON THE SE IN FACE  
  
 A FIRE 24" IN DIA. BERRS S 7° W ~ 44.82' FROM S. SCRIBED  
 X BIT SET A BIT X BERRS IN THE NEW BERRS  
 SET A BIT TR6 ON THE NEW IN FACE  
  
 SET: ORANGE FIBERGLASS "STAVEY MARKER" POST 0.5' E IN

THE COP IS LOCATED LOCATED IN A LEVEL AND DEEPLY  
 GROUND AREA ABOUT 400' SW IN FROM A LOGGING  
 ROAD IT IS POOR FOR FORWARDING AND GPS CONTROL

A FIRE 1/4" IN DIA @ A HEAVY COR. BERRS 50' N 120° E  
 THERE IS NO RECORD OF THIS TREE SET A BIT X BERRS  
 IN THE E IN BERRS SET A BIT TR6 ON THE NEW IN FACE

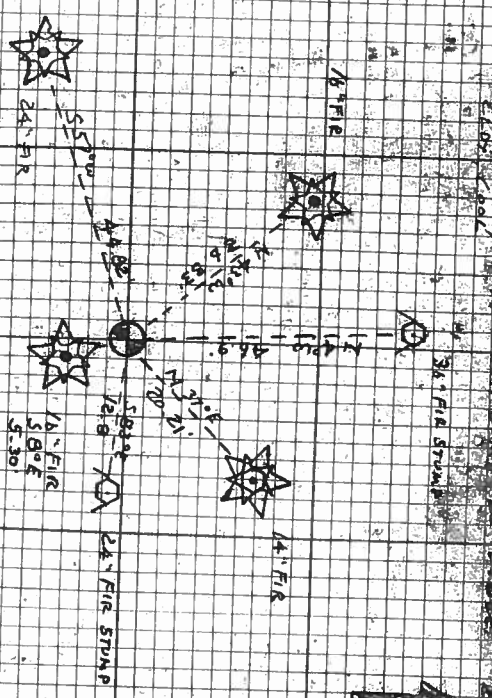

SE COR DEC 64  
 B wood  
 DEC 64  
 STAMPINGS  
 T-115 BERRY MARK  
 1956

11-6-64

BENTON COUNTY SURVEYORS OFFICE - CORNER RESTORATION

963

T. 11 S. R. 6 W. W. B. & M., BENTON COUNTY, OREGON

SECTION 18

REPORTED BY Gary T Johnston

TITLE RPLS 1467

DATE March 25, 1981

The information shown hereon was taken from the referenced county survey. Date: 7/25/90

SE DLE cor no. 64

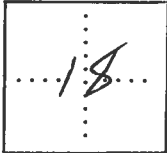

OFFICIAL CORNER FOUND

CORNER SET

LEGIBLE MARKS ON BEARING OBJECTS

found

now 24" stump  
face visible

now 36" rotted stump  
no scribes

white fir

white fir

KIND

5"

12"

SIZE

S84°E

N06°W

BEARING

0.194ch

0.71ch

DISTANCE

BT TAG POSTED

SLC CORNER COMMON TO SEC. 18  
IS 1/2" x 1/2" Iron Bar  
DESCRIBE

ADDITIONAL INFORMATION

Refer to C.S. # 7279

OVER

C.S. #196 cont. S.E. cor. of Britton Wood Cl. # 64 T. 11 S. R. 6 W.  
 Set  $\frac{1}{2}$ " x  $\frac{1}{2}$ " iron bar stake hole  
 W. fir 5" bears. S. 84° E. .194 chs.  
 " " 12" " N. 6° W. .71 " std.  
 Witnesses Edwin Johnson, L.H. Hawley John Hiller March 1915.

S.E. cor. of W<sup>th</sup> Blodgett Cl. #40 T. 11 S. R. 7 W.  
 Set  $\frac{3}{4}$ " pipe 2 stones orig. cor.  
 Oak 10" bears N. 1° W. .51 chs. std.  
 Witness John Hiller March 1915.

Int. cor. of W<sup>th</sup> Blodgett Cl. #40 T. 11 S. R. 7 W.  
 Set  $\frac{3}{4}$ " pipe oak cutdown N. 58° E. 2.23 chs.  
 Fir 24" bears N. 81° E. .093 chs.  
 " 24" " N. 45° W. .043 "  
 Witness John Hiller March 1915.

C.S. Miscellaneous 1/4 sec. cor. between secs. 1 & 6 T. 15 S. R. 8 & 9 W.  
 Set  $\frac{3}{4}$ " x  $\frac{3}{4}$ " iron bar orig. cor.  
 Fir 10" bears S. 27° E. .43 chs. std.  
 Cherry 8" " S. 56° W. .21 " "  
 Witnesses Oliver Davis Lee Anderson, O.C. Johnson Mar. 7, 1915.

C.S. Road #377 1/2 Sec. cor. on S. line of sec. 32, on 2<sup>nd</sup> St. parallel Tps. 10 & 11 S. R. 7 W.  
 Put with C.S. 229 Set  $\frac{3}{4}$ " pipe  
 Burnt snag 50" bears N. 54° W. .810 chs. std.  
 Fir 28" bears N. 4° 20' E. .822 " post bothered in getting bearing.  
 " 28" " N. 84° W. .562 "  
 Witnesses Fred Haidles, Jerry Barchard & Rudolph Long April 1915.

C.S. #245 in C.S. Road #359 S.W. cor. of Nimrod O'Kelly Cl. #59 T. 13 S. R. 5 W.  
 Set  $\frac{3}{8}$ " x 18" iron pin cen. of road  
 Anchor post 10" North .307 chs.  
 Witness J.S. Watkins April 22, 1915.

S.E. cor. of Nimrod O'Kelly Cl. #59 T. 13 S. R. 5 W.  
 Set  $1\frac{1}{4}$ " x 54" shaft by anchor post  
 Maple 28" in dia. bears N. 3° 35' E. 4.455 chs.  
 Ash 15" " " " S. 89° 10' W. 6.540 "  
 Witness Hugh Taylor Apr. 27, 1915.

N.E. cor. of Nimrod O'Kelly Cl. #59 T. 13 S. R. 5 W.  
 Set a  $1\frac{1}{4}$ " pipe for corner.  
 A. Stone the Most South S.W. cor. of R.D. Grimsley Cl. 49.  
 bears S. 0° 26' W. 13.256 chs. a proportional distance on  
 the east line of O'Kelly claim.

N.W. cor. of Nimrod O'Kelly Cl. #59 T. 13 S. R. 5 W.  
 Stone 10" x 12" x 2"  
 Locus 22" bears N. 50° 40' E. .827 chs.  
 " 15" " S. 3° 30' E. .383 "  
 Witness Hugh Taylor April 27, 1915.

S. E. corner of Britton Wood Cl 64, Twp. 11 S R 6 W

961

Reestablishment by W. C. Galloway

March 1915

Set  $\frac{1}{2}$ " x  $\frac{1}{2}$ " iron bar stake hole

W. Fir 5" in diam bears S 84° E

.194 chains

W. Fir 12" in diam bears N 6° W

.71 chains(standing)

Witnesses Edwin Johnson, L. H. Hawley, Hiller