

CORNER FILE TRACKING

H:\Survey\Corners\Misc\Filetrac.doc

11/23/98

CORNER NUMBER
117100340

STEP	HISTORY()	RESTORATION()
Form Prepared, DB	7/22/05	7/29/05
Field Inspection, DB	7/28/05	7/28/05
Form Checked, DB	8/4/05	8/4/05
Form Edited, DB	8/5/05	8/5/05
Form Signed, DB	8/5/05	8/5/05
Counter Index	7/28/05	7/28/05
GIS Index	7/28/05	
Authorize Payment, DB	—	—
Archive Digital Files	8/8/05	8/8/05
Collect Documents	7/28/05	7/28/05
Scanned	8/9/05	8/9/05
Copy For Filming	8/8/05	8/8/05
Filed, DB		
Finish index (count unit)	7/28/05	7/28/05
Filmed (Archived), DB		

(DB) = Entry needed in database (Access).

COMMENTS:

DATE 07/22/2005

TOWNSHIP 11 SOUTH, RANGE 07 WEST, WILLAMETTE MERIDIAN; SECTION 19 CORNER W 1/4
 DONATION LAND CLAIM NONE CORNER N/A

COMMON CORNER(S):

EAST 1/4 SECTION 24, T12S, R8W

RECORDS (INFORMATION IN BOLD ITALICS IS COUNTY STAFFS' INTERPRETATION OF THE RECORD)

BASED ON EXTENSIVE RESEARCH AND RECOVERY OF EVIDENCE, THIS OFFICE HAS DETERMINED THAT MOST GENERAL LAND OFFICE SURVEYORS MEASURED TO THE FACE OF BEARING TREES.

- [01] GENERAL LAND OFFICE (GLO) NOTES BY DENNIS HATHORN, D. S., DATED APRIL 30, 1855. SET 1/4 SEC. POST, 36" DIA. BURNT FIR, BEARS N21°W, 17 LINKS (11.22 FEET), 36" DIA. BURNT FIR, BEARS N12°E, 74 LINKS (48.84).
- [02] BENTON COUNTY SURVEY NO. 549 (OLD NO. 87), FIELD NOTES (FIELD BOOK 21 PAGE 30), BY W. C. GALLOWAY, C. S., DATED JUNE 2, 1916. SET 2 IRON RODS 2 STUMPS STANDING. 12.50 CHAINS (825 FEET) SOUTH OF CREEK. 30" DIA. FIR BEARS, N63°E, 2.515 CHAINS (165.99 FEET), DOUBLE 36" DIA. FIR BEARS, N24°50'W, 3.086 CHAINS (203.68 FEET).
- [03] BENTON COUNTY RESTORATION BOOK NO. 1, PAGE 108, BY W. C. GALLOWAY, C. S., DATED MAY 31, 1916. SET TWO SMALL IRONS WIRED TOGETHER, 2 STUMPS SANDING 12.50 CHAINS (825 FEET) SOUTH OF CREEK, 30" DIA. FIR BEARS, N63°E, 2.515 CHAINS (165.99 FEET), DOUBLE 36" DIA. FIR BEARS, N24°50'W, 3.086 CHAINS (203.68 FEET).
- [04] BENTON COUNTY MAP NO. 11-7-00010, BY W. C. GALLOWAY, C. S., NO DATE GIVEN. TWO IRONS, 30" DIA. FIR BEARS, N63°E, 2.515 CHAINS (165.99 FEET), DOUBLE, 36" DIA. FIR BEARS, N24°50'W, 3.086 CHAINS (203.68 FEET).
- [05] CORISPONDENCE LETTER FROM BRUCE STARKER, P. L. S., (SEE ALSO LINCON COUNTY SURVEY NO. 2614) DATED MARCH 21, 1965. FOUND TWO SMALL IRONS WIRED TOGETHER DOWN 8", 30" DIA. ROTTEN FIR STUMP, BEARS N63°E, 2.515 CHAINS (165.99 FEET), ROTTEN SCRIBES VISIBLE, 36" DIA ROTTEN DOUBLE FIR STUMP, BEARS N24°50' W, 3.086 CHAINS (203.68 FEET), PITCH FACE AND SCRIBES PLAIN, SET 5/8"x4"x36" BLADE RETAINER IRON, UP 22" ALONGSIDE CORNER. SET WHITE PAINTED CEDAR 4X4 GUARD STAKE UP 30". MARKED, 10" DIA. FIR, N68°E, 1.106 CHAINS (73.00 FEET), SCRIBED 1/4 S 19BT, 8" DIA. FIR, N11°W, 0.514 CHAINS (33.92 FEET), FENCE CORNER, BEARS S56°W, .056 CHAINS (3.70 FEET).
- [06] BENTON COUNTY CORNER RESTORATION NO. 1081, BY BRUCE STARKER, P. L. S., DATED MARCH 21, 1965. TRANSCRIBED FROM RECORD [05] AND MAY CONTAIN ERRORS AND/OR OMISSIONS.
- [07] STARKER SECTION MAP BY MARK PHILIPS, DATED AUGUST 29, 1979. FOUND 5/8" PIN NEXT TO FENCE POST.
- [08] BENTON COUNTY SURVEY NO. 7669, BY J. EDWARD HENRICKS, P. L. S., DATED AUGUST 9, 1984. FOUND 2 IRONS 2" BELOW GROUND FROM C. S. 87, WEST/SOUTH FENCE CORNER BEARS, S45°W, 5.5 FEET, 20" DIA FIR, BEARS S28°W, 30.0 FEET, (HELAED FACE), 20" DIA FIR, BEARS S10°E, 27.0 FEET, (HEALED FACE).

NOTES:

THIS IS A MICROSOFT WORD 2000 DOCUMENT NAMED "17100340" CREATED FROM A BOILER PLATE DOCUMENT NAMED "HISTORY", WHICH HAS A STYLESHEET NAMED "CORNER" ATTACHED TO IT.

FIRM/AGENCY: BENTON COUNTY SURVEYOR'S OFFICE
ADDRESS: 360 S.W. AVERY AVE. CORVALLIS OR 97333; PH. 766-6821
RESEARCH BY: DAVID M. DEAN, P.L.S.
DATA ENTRY BY: WILLIAM C. KELLEY, SURVEY TECH.

BENTON COUNTY CORNER RESTORATION FORM, PAGE 1 OF 2, 117100340R2**SEE CORNER HISTORY FORM FOR RECORDS ETC.**

CORNER RESTORATION FIELD BOOK NUMBER 23 PAGE(S) 44 DATE 07/28/2005
TOWNSHIP 11 SOUTH, RANGE 7 WEST, WILLAMETTE MERIDIAN; SECTION 19 CORNER WEST 1/4
DONATION LAND CLAIM NONE CORNER N/A
CONDITION REPORT _____; REFERENCED OUT _____; RENEWED XX; SURVEYED IN _____

LOCATION AND COMMENTS:

CORNER IS LOCATED ON A GENTLE, WESTERLY FACING SLOPE IN A CONIFER AND HARDWOOD FOREST. TO REACH CORNER FROM THE BENTON AND LINCOLN COUNTY LINE ON HIGHWAY 20, TRAVEL NORTHWESTERLY ON HIGHWAY 20 FOR 200± FEET; THEN RIGHT (NORTH) ON PRIVATE GRAVEL ROAD FOR 0.02 MILES; THEN BEAR LEFT ON STARKER FOREST ROAD (PASSING THROUGH LOCKED GATE) FOR 0.42 MILES TO LOCATION TAG ON 34" D. FIR ON WEST (LEFT) SIDE OF ROAD; THEN S67°W, 75 FEET TO CORNER. CORNER IS POOR FOR PREMARKING AND GPS CONTROL.

MONUMENTS AND ACCESSORIES FOUND (CONDITION AND SOURCE):

1. FOUND TWO 5/8" X 13" HARROW TEETH, 8" BELOW GROUND LEVEL FOR CORNER POSITION.
(SET 2 IRON RODS FROM GLO STUMPS PER RECORD [02]).
(SET 2 SMALL IRON WIRED TOGETHER PER RECORD [03]).
(2 IRONS PER RECORD [04]).
(FOUND 2 SMALL IRONS WIRED TOGETHER, DOWN 8" PER RECORD [05]).
(FOUND 5/8" PIN NEXT TO FENCE POST PER RECORD [07]).
(FOUND 2 IRONS, 2" BELOW GROUND ER RECORD [08]).
2. FOUND "BLADE RETAINER" 8" BELOW GROUND LEVEL, S55°E, 0.2 FEET. TOP 24" OF BLADE RETAINER HAS BEEN BROKEN OFF AND LYING 2 FEET WESTERLY.
(SET 5/8" X 4" X 36" BLADE RETAINER IRON, UP 22" ALONGSIDE CORNER PER RECORD [05]).
3. FOUND ROTTEN REMAINS OF 36"± D. FIR STUMP; NO MARKS VISIBLE, N10°51'E, 50.03 FEET TO CENTER.
(36" BURNT FIR, N12°E, 48.84 FEET PER RECORD [01]).
(STUMP STANDING PER RECORDS [02] AND [03]).
4. FOUND ROTTEN REMAINS OF LARGE D. FIR STUMP; NO MARKS VISIBLE, N63°E, 166 FEET TO CENTER. THIS ACCESSORY TIED WITH COMPASS AND TAPE ONLY.
(30" FIR, N63°E, 165.99 FEET PER RECORDS [02], [03] AND [04]).
(30" ROTTEN FIR STUMP, N63°E, 165.99 FEET WITH ROTTEN SCRIBES VISIBLE PER RECORD [05]).
5. FOUND 36"± ROTTEN D. FIR STUMP, N24°50'W, 202.85 FEET TO CENTER WITH VISIBLE SCRIBING "BT". BASIS OF BEARINGS FOR THIS RESTORATION.
(DOUBLE 36" FIR, N24°50'W, 203.68 FEET PER RECORDS [02] - [04]).
(36" ROTTEN FIR STUMP, N24°50'W, 203.68 FEET TO CROTCH, PITCH FACE AND SCRIBES PLAIN PER RECORD [05]).
6. FOUND 34" D. FIR WITH HEALED FACE, N66°48'E, 72.69 FEET TO CENTER. SET ALUMINUM NAIL AND PLASTIC WASHER IN NORTHWEST BASE FOR DISTANCE MEASUREMENT.
(MARKED 10" FIR "1/4 S19 BT", 73.00 FEET TO CENTER PER RECORD [05]).
7. FOUND 24" D. FIR WITH HEALED FACE, N12°45'W, 33.85 FEET TO CENTER. SET ALUMINUM NAIL AND PLASTIC WASHER IN WESTERLY BASE FOR DISTANCE MEASUREMENT.
(MARKED 8" FIR "1/4 S24 BT", N11°W, 33.92 FEET TO CENTER PER RECORD [05]).
8. FOUND 29" D. FIR WITH HEALED FACE, S11°50'E, 34.30 FEET TO CENTER. SET ALUMINUM NAIL AND PLASTIC WASHER IN WESTERLY BASE FOR DISTANCE MEASUREMENT. ORIGIN OF THIS ACCESSORY IS UNKNOWN.
(FOUND 20" FIR, S10°E, 27.0 FEET WITH HEALED FACE PER RECORD [08]).
9. FOUND 32" D. FIR WITH HEALED FACE, S25°23'W, 40.50 FEET TO CENTER. SET ALUMINUM NAIL AND PLASTIC WASHER IN SOUTHEAST BASE FOR DISTANCE MEASUREMENT. ORIGIN OF THIS ACCESSORY IS UNKNOWN.
(FOUND 20" FIR, S28°W, 30.0 FEET WITH HEALED FACE PER RECORD [08]).

MONUMENT SET (PROCEDURES AND DESCRIPTION):

HELD CENTER OF THE TWO HARROW TEETH FOR TRUE CORNER POSITION, WHICH IS IN GOOD AGREEMENT WITH THE ABOVE FOUND ACCESSORIES. REMOVED HARROW TEETH AND SET A 2" X 31 1/2" GALVANIZED IRON PIPE WITH A 3 1/4" BRASS DISK CONCRETED IN THE TOP, 4" BELOW GROUND LEVEL, MARKED AS SHOWN ON PAGE 2 OF 2. BURIED BOTH HARROW TEETH ON NORTHWEST SIDE OF NEW MONUMENT IN HORIZONTAL POSITION AND 10" BELOW GROUND LEVEL. BURIED 24" SECTION OF "BLADE RETAINER" ON SOUTHEAST SIDE OF NEW MONUMENT IN HORIZONTAL POSITION AND 10" BELOW GROUND LEVEL. SET 6 FOOT ORANGE CARSONITE "SURVEY MARKER" POST 0.5 FEET WEST ON NEW MONUMENT.

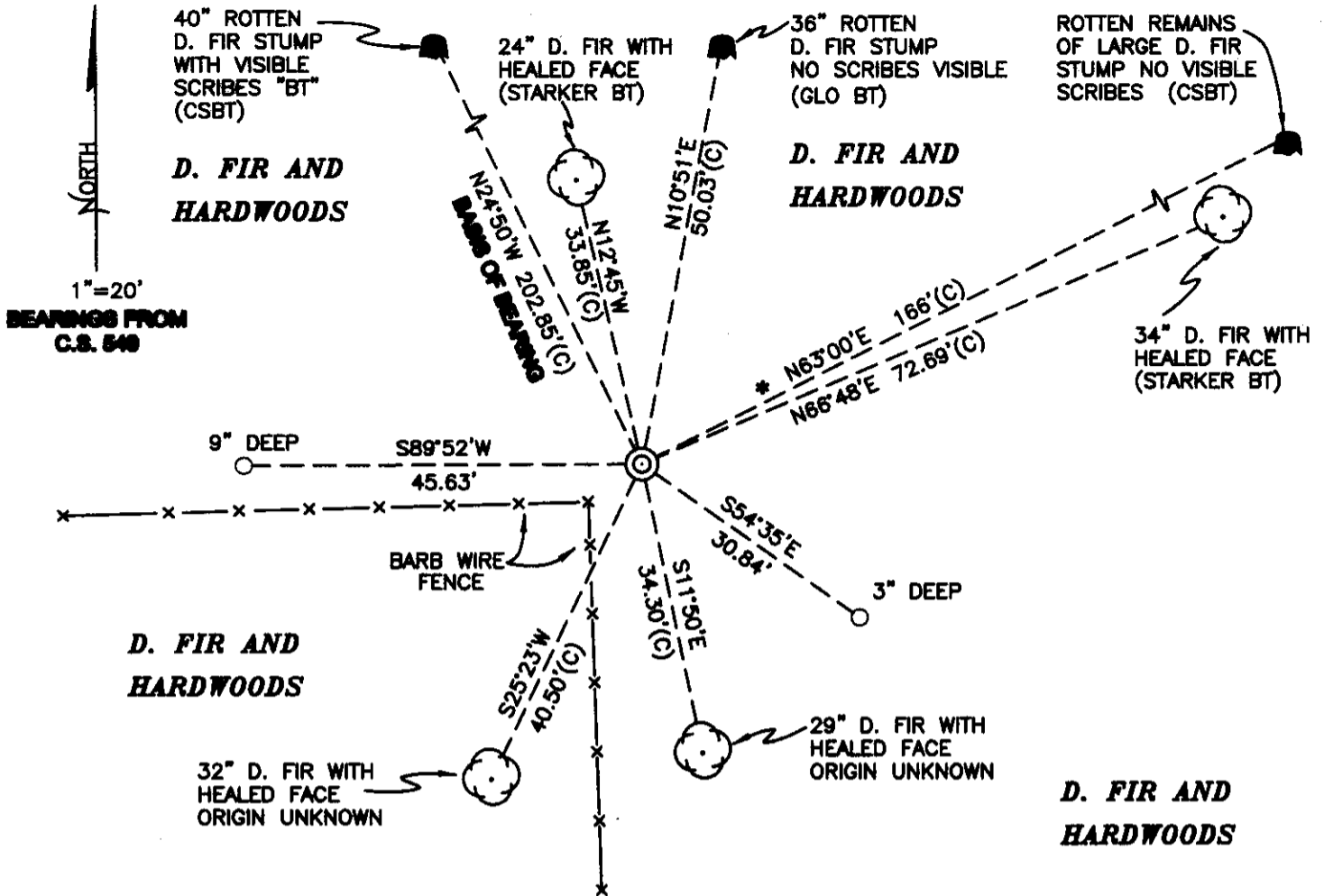

MONUMENT DETAIL

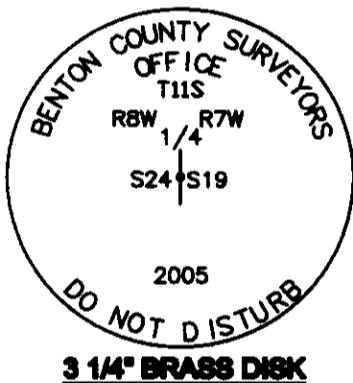

LEGEND

- SET 5/8" X 30" REBAR WITH YELLOW PLASTIC CAP MKD "BENTON COUNTY SURVEYOR"
- (F) MEASUREMENT TO FACE
- (C) MEASUREMENT TO CENTER
- ⊙ GOVERNMENT MONUMENT SET AS SHOWN
- ⊙ BEARING TREE AS NOTED
- C.S.B.T. COUNTY SURVEYORS BEARING TREE
- GLO GENERAL LAND OFFICE
- ⊙ BEARING TREE STUMP AS NOTED
- x-x- BARB WIRE FENCE
- * BEARING AND DISTANCE BY COMPASS AND TAPE

NEW ACCESSORIES:

1. SET REBAR (SEE LEGEND) 3" BELOW GROUND LEVEL S54°35'E, 30.84 FEET.
2. SET REBAR (SEE LEGEND) 9" BELOW GROUND LEVEL S89°52'W, 45.63 FEET.

NOTES:

COMPASS DECLINATION IS 20° EAST. ALL MEASURED DISTANCES AND BEARINGS ARE TO THE CENTER OF THE OBJECT, UNLESS OTHERWISE NOTED. ALL BEARING TREES ARE PAINTED AND HAVE A B.T. TAG ATTACHED, FACING THE CORNER UNLESS OTHERWISE NOTED. ALL NEW BEARING TREES HAVE A PLASTIC WASHER (STAMPED "BENTON COUNTY SURVEYOR CORNER RESTORATION") ATTACHED (BY ALUMINUM NAIL) TO THE FACE, BELOW THE "BT" FOR DISTANCE AND ANGLE MEASUREMENT UNLESS OTHERWISE NOTED. THE DRAWING IS FROM AUTOCAD RELEASE 2002.

THIS RESTORATION WAS PERFORMED AT THE DIRECTION AND APROVAL OF THE BENTON COUNTY SURVEYOR, David M. Dean

FIRMAGENCY: BENTON COUNTY SURVEYOR'S OFFICE
ADDRESS: 360 S.W. AVERY AVE. CORVALLIS OR 97333; PH. 766-6821
PRESENT: DAVID M. DEAN, P.L.S., BERNIE ALTENBACH, SURVEY TECH.
EQUIPMENT: LEICA TCR 1105 WITH TDS ONBOARD

REGISTERED PROFESSIONAL LAND SURVEYOR

8/5/05 David M. Dean

OREGON
 JULY 13, 1984
 DAVID M. DEAN
 2090

RENEWAL DATE: 12/31/05

117100340 T 115
R8W R7W

RENUMERATING 1/4 Cor. 24 + 19

FD 2 5/8" x 13" Row Rods (Harrow Tooth)

8" BELOW GROUND LEVEL & FIRMLY SET

FOR CORNER POSITION, FD BURDE RETRIEVED BT ↓

w/ TOP 24" BROKEN OFF 5.55"E, 0.21" FT, BROKEN

SECTION LYING 2' w/ly.

FD NE 610 BT - NOW ± 36" ROTTEN REMAINS

OF D. FIRE STAMP - NO VS.

FD OS. B.T.S.: NE NOW ROTTEN REMAINS OF D. FIRE

STAMP - NO VS.; NW - NOW ROTTEN ± 40" D. FIRE

STAMP w/VS. "B.T."

FD B. STALKER B.T.S.: NW NOW 24" D. FIRE w/

HEATED FC. NE NOW 36" D. FIRE w/ HEATED FC.

FD 2 UNRECOVERED FIRE'S w/ HEATED FACES

SE 29" D. FIRE 1/2 SW 32" D. FIRE

FENCE COR BRG 5.55 W 7.6' w/ BAR WIRE

RUNNING S 1/4 W. COR LOCATED ON GREAT

W SLOPE IN FIRE & HARROWWOOD FOREST

REMOVED BOTH HARROWS TOOTH'S & SET 2" x 3 1/2"

G.I.P. w/ 3 1/4" GRASS DISK CONC. IN TOP 4" ↓

& MARKED AS SHOWN.

BURRED HARROW TEETH ON NW

SIDE NEW MON 10" ↓ & HOLE

BURRED 24" SECTION OF RETRIEVED

RANGE ON SE SIDE 10" ↓ & HOLE

SET 6" CARBONITE POST 65' W

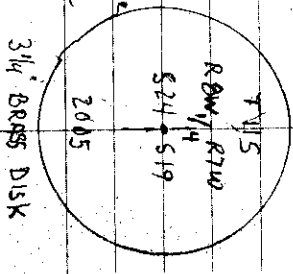

CLEAR, warm
70° F Air
29.9 Hg
LEICA TCR 105/7DS

7/28/05 23/44
D. DEAN
B. ALTENBACH

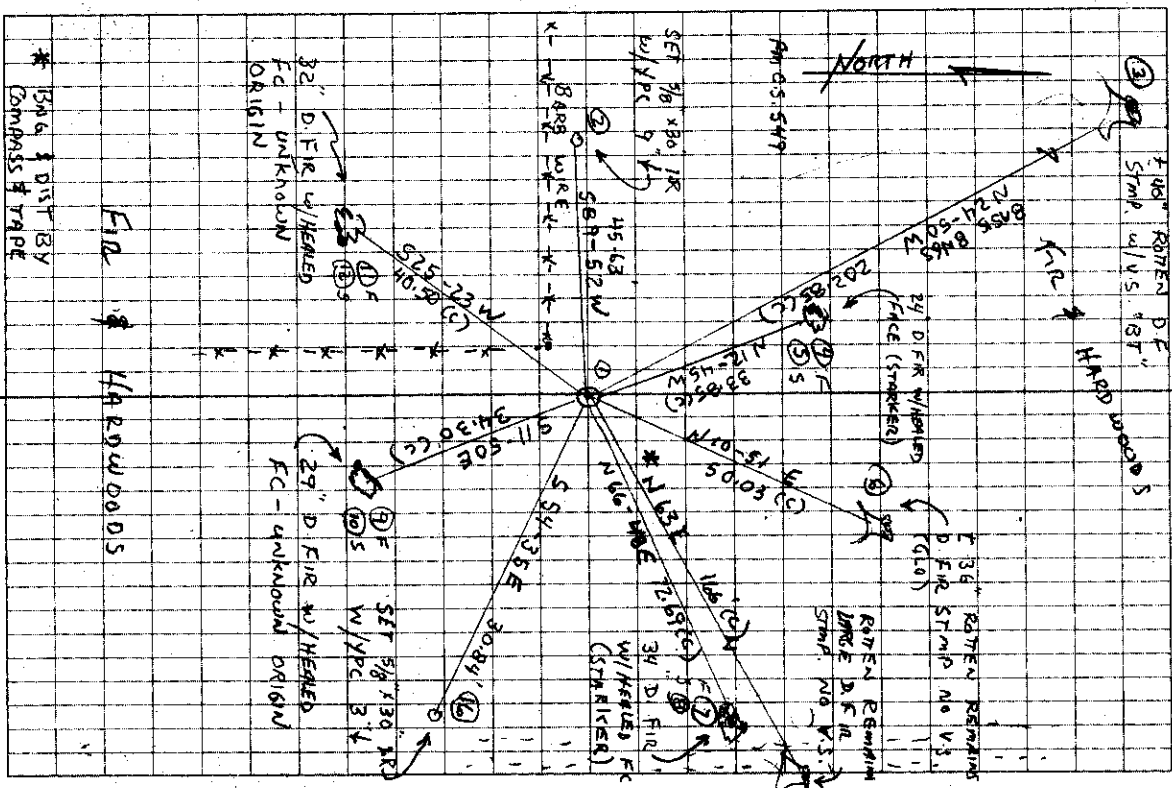

* 1500 & DIST BY
COMPASS & TAPE

FIRE & HARROWWOODS

CS #190

Std. corner bet. Secs. 2 & 3 on 3rd. Std. parallel T. 14 S. R. 6 W.

Set 3/4" pipe 10" under the surface

Oak 20" in dia. bears S. 52° 35' W. 2522 chs.

Witnesses R.L. Jones, M. Richmond.

May 26, 1916.

CS #87
Continued

1/4 sec. cor. bet. Secs. 19 & 30 T. 11 S. R. 7 W.

Set a plow standard 5/8" x 2 1/2" set from old stake
cedar down & maple gone

Maple 30" in dia. bears N. 62° 48' E. 7317 chs.

Cedar snag 42" " " N. 87° 15' W. 3,971 "

May 30, 1916.

Witnesses
L.B. Thurman,
Edward and
John Harmonson.

" | Corner to Secs 24, 25, 19 & 30 T. 11 S. R. 7 & 8 W.

Set a stone 7" x 7" x 20" found indications of other stumps in right
pos. 104.

Fir 26" in dia. bears N. 14° 20' E. 1,463 chs. remkd.

Cedar stump 30" " " N. 70° E. .12 " "

Cherry 11" " " S. 58° 30' W. 3,715 " "

June 2, 1916.

" | 1/4 sec. cor. between Secs. 19 & 24 T. 11 S. R. 7 & 8 W.

Set two small irons wired together. 2 stumps std. 12.50 S. of creek.

Fir 30" in dia. bears N. 63° E. 2,515 chs.

Double " 36" " " N. 24° 50' W. 3,086 "

May 31, 1916.

" | 1/4 sec. cor. between Secs. 18 & 19 T. 11 S. R. 7 W.

Set 1/4" x 1 1/2" x 17" iron

Fir 30" in dia. bears N. 23° 50' E. 725 chs.

Alder 16" " " S. 47° 30' E. 387 "

Burnt fir 40" " " N. 80° W. 48 " Std. good condition.

6

BENTON COUNTY SURVEYORS OFFICE - CORNER RESTORATION

1081

T. 11 S, R. 78 W, W. B. & M., BENTON COUNTY, OREGON

SECTION 19

REPORTED BY Bruce Starker

TITLE Land Surveyor

DATE March 21, 1965

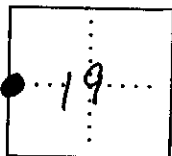

● OFFICIAL CORNER FOUND

○ CORNER SET

44 CORNER COMMON TO SEC. 19 & 24
 IS 5/8" x 4" x 36" blade retainer iron
 DESCRIBE

ADDITIONAL INFORMATION

blade retainer iron (f) up 22" alongside
 corner. white painted cedar 4x4
 gu stake up 30"

Fence corner S56°W .056 chs.

FOR ADDITIONAL INFORMATION SEE THE THIS RTW
 FILE IN THE CORNER RESTORATION CORRESPONDENCE
 FILE DRAWER (OL 7/16/90)

OVER

LEGIBLE MARKS ON BEARING OBJECTS

	44 S19/BT	44 S24/BT	
KIND	Fir	Fir	
SIZE	10"	8"	
BEARING	N68°E	N11°W	
DISTANCE	1.106 chs	.514 chs	
BT TAG POSTED			

BRUCE STARKER
FORESTER
5250 PHILOMATH ROAD
WAVERLY 9-6565
CORVALLIS, OREGON

April 22, 1965

✓ Benton County Surveyor, C. C. Hanson
Lincoln County Surveyor, W. H. "Bud" Burdett

Please record the following information:

March 21, 1965

At $\frac{1}{4}$ Sec. Cor. between Sections 19 and 24, T. 11 S., Rs. 7 and 8 W., W. M.

I found: (set by W. C. Galloway May 31, 1916)

Two small irons wired together down 8"

Rotten fir stump 30" N63°E 2.515 chains - rotten scribes visible

Rotten double fir stump 36" N 24° 50' W 3.086 chains (to crotch) - pitch face and scribes plain

I set:

5/8" X 4" X 36" blade retainer iron (\surd) up 22" alongside corner

White painted cedar 4 X 4 guard stake up 30"

I marked:

Fir 10" $\frac{1}{4}$ S 19 / BT N 68° E 1.106 to center

Fir 8" $\frac{1}{4}$ S 24 / BT N 11° W .514 to center

Fence corner bears S 56° W .056.

SEE COR. REST. No. 1081
(CCL 7/16/90).

Very truly yours,

REGISTERED
OREGON
LAND SURVEYOR

Bruce Starker

EXPIRES 12-31-65
BRUCE STARKER
310

CS. #190

Std. corner bet. Secs. 19 & 20 T. 11 S. R. 6 W.
Set 3/4" pipe 10" under the surface
Oak 20" in dia. bears S. 52° 35' W. 2.522 chs.
Witnesses R. L. Jones, M. Richmond. May 26, 1916.

CS #87
Continued

Witnesses
L. B. Thurman,
Edward and
John Harmon.

1/4 sec. cor. bet. Secs. 19 & 30 T. 11 S. R. 7 W.
Set a plank standard ^{set from old stake.} Cedar down & Maple gone
Maple 30" in dia. bears N. 62° 48' E. 7.317 chs.
Cedar snag 42" " " N. 87° 15' W. 3.971 "
May 30, 1916.

" | Corner to Secs 24, 25, 19 & 30 T. 11 S. R. 7 & 8 W.
Set a stone 7" X 7" X 20" found indications of other stumps in right position.
Fir 26" in dia. bears N. 14° 20' E. 1.463 chs. rankd.
Cedar stump 30" " " N. 70° E. .12 " std.
Cherry 11" " " S. 58° 30' W. 3.715 "
June 2, 1916.

" | 1/4 sec. cor. between Secs. 19 & 24 T. 11 S. R. 7 & 8 W.
Set two small irons wired together 2 stumps std. 12.30 s. of creek
Fir 30" in dia. bears N. 63° E. 2.515 chs.
" 36" " " N. 24° 50' W. 3.086 "
May 31, 1916.

" | 1/4 sec. cor. between Secs. 18 & 19 T. 11 S. R. 7 W.
Set 1/4" X 1 1/2" X 17" iron
Fir 30" in dia. bears N. 23° 50' E. 7.25 chs.
Alder 16" " " S. 47° 30' E. 3.87 "
Burr fir 40" " " N. 80° W. 48 " std. good condition

" | Corner to Secs 18, 19-13 & 24 T. 11 S. R. 7 & 8 W.
Set a stone 6" X 10" X 24" Orig. cor.
Stump 30" N. 47° 30' E. (N. 45° E. given) 48 chs. std. check
Burr fir 30" S. 42° 30' E. (S. 40° E. given) 1.26 " " "
" 40" S. 8° 30' W. (S. 10° W. given) 1.04 " " "
" stump 24" N. 3° 30' W. 1.56 " "
Mkd. Fir 24" S. 62° 10' E. 1.695 "
June 2, 1916.

CS. 245
Continued

1/4 sec. cor. bet. Secs. 17 & 2 T. 14 S. R. 5 W.
Set an iron the end of a buggy shaft 10" below the surface.
Maple 26" in dia. bears S. 55° 45' E. 3.673 chs.
Pine 30" " " S. 18° 30' E. 5.18 " std.
Witness Hugh Taylor June 17, 1916.

CS. 251

Witnesses
Gilas Hart,
R. W. Kirk and
W. E. Wood.

1/4 sec. cor. bet. Secs. 7 & 12 T. 12 S. R. 6 & 7 W.
Set 1/4" pipe
Maple 8" in dia. bears S. 78° E. 1.36 chs. std.
" 4" " " N. 77° W. .52 " " "
Fir 32" " " N. 14° W. .097 " " "
June 26, 1916.

11-7-19 and 11-8-24

$\frac{1}{4}$ -Section corner between sections 19 and 24, Twp. 11 S., Rs. 7 and 8 W.

Reestablishment by W. C. Galloway

May 31, 1916

Set two small irons wired together, two stumps standing

Fir 30" in diam bears N 63° E 2.515 chains

Double Fir 36" in diam bears N 24° 50' W 3.086 chains

1071

117100340

BRUCE STARKER
FORESTER
5250 PHILMATH ROAD
WAVERLY 9-6565
CORVALLIS, OREGON

April 22, 1965

✓ Benton County Surveyor, C. C. Hanson

Lincoln County Surveyor, W. H. "Bud" Burdett

Please record the following information:

March 21, 1965

At $\frac{1}{4}$ Sec. Cor. between Sections 19 and 24, T. 11 S., Rs. 7 and 8 W., W. M.

I found: (set by W. C. Galloway May 31, 1916)

Two small irons wired together down 8"

Rotten fir stump 30" N63°E 2.515 chains - rotten scribes visible

Rotten double fir stump 36" N 24° 50' W 3.086 chains (to crotch) - pitch face and scribes plain

I set:

5/8" X 4" X 36" blade retainer iron (✓) up 22" alongside corner

White painted cedar 4 X 4 guard stake up 30"

I marked:

Fir 10" $\frac{1}{4}$ S 19 / BT N 68° E 1.106 to center

Fir 8" $\frac{1}{4}$ S 24 / BT N 11° W .514 to center

Fence corner bears S 56° W .056.

SEE COR. REST. No. 1081
(CCL 7/16/70).

Very truly yours,

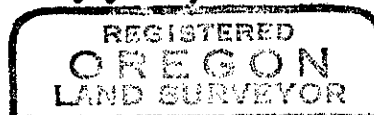

Bruce Starker

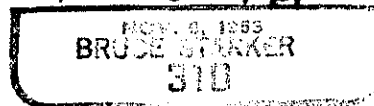

BENTON COUNTY SURVEYORS OFFICE - CORNER RESTORATION

1081

T 11 S, R 78 W, W. B. & M., BENTON COUNTY, OREGON

SECTION 19

REPORTED BY Bruce Starker

TITLE Land Surveyor

DATE March 21, 1965

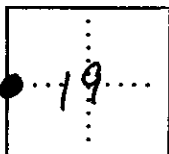

● OFFICIAL CORNER FOUND

○ CORNER SET

1/4 CORNER COMMON TO SEC. 19 & 24
5/8" x 4" x 36" blade retainer iron
DESCRIBE

ADDITIONAL INFORMATION

blade retainer iron (5) up 22" alongside
corner. White painted cedar 4x4
gn stake up 30"

Fence corner S56°W .056 chs.

FOR ADDITIONAL INFORMATION SEE THE T11S R7W
FILE IN THE CORNER RESTORATION CORRESPONDENCE
FILE DRAWER (GL 7116/90)

OVER

LEGIBLE MARKS ON BEARING OBJECTS

	<u>1/4 S19/BT</u>	<u>1/4 S24/BT</u>	
KIND	<u>Fir</u>	<u>Fir</u>	
SIZE	<u>10"</u>	<u>8"</u>	
BEARING	<u>N68°E</u>	<u>N11°W</u>	
DISTANCE	<u>1.106 chs</u>	<u>.514 chs</u>	
BT TAG POSTED			