

C.S. #224 Cont.

Cor. of Secs. 19, 20, 29, 30 - T. 12 S., R. 7 W.  
 Set. 2" Liron 4 1/2' long, from which  
 Oak 5" in diam. bears S. 44° 30' E. 192 Chs. dist.  
 " 9" " " " S. 57° 30' W. 482 " "  
 " 6" " " " N. 26° 15' W. 318 " "  
 " 40" " " " N. 40° E. 1.87 " " Orig - True bearing N 41° E.  
 Witness by - J.R. & S.P. Williamson & Wm. E. Eggy. Dec. 7, 1916 - Bn.

C.S. #228

W.C. to S.W. Cor. Ira Hunter D.L.C. #43 - T. 11 S., R. 4 W.  
 Set. heart oak stake, for W.C. <sup>1508 Chs. N. + 028 Chs. E. of true cor.</sup>  
 From which  
 Fir 10" in diam. bears N. 75 1/2° E. 457 Chs. dist.  
 " 8" " " " N. 2° E. 320 " "  
 Note - This cor. should go West. 148 Chs. to true position -  
 Witnessed by M.H. Bauer, Clair & Elinor Wilkes & Beck. Feb. 4, 1917

C.S. #229

Cor. of Secs. 4 & 5 - T. 11 S., R. 7 W. - on 2<sup>nd</sup> Std. Parallel, South.  
 Set. Fir limb, Orig. Cor.  
 " Fir 12 ins. in diam. bears N. 5° E. 2.71 Chs. dist." Orig  
 " Fir 30 " " " " S. 22° E. .65 " " "  
 " Fir 12 " " " " S. 35° W. 2.75 " " "  
 " Fir 12 " " " " N. 21° W. 2.73 " " "  
 Witnessed by - F.E. Reynolds, J.G. Mustoe & Geo Thral Feb. 8, 1917

"

Cor. of Secs. 32 & 33 - T. 10 S., R. 7 W. - on 2<sup>nd</sup> Std. Par. S.  
 Set stone 12" x 12" x 6", from which  
 " Fir 4 1/2" in diam. bears N. 35° W. .820 Chs. dist." Orig  
 W. Fir 7" " " " N. 26° E. 497 " "  
 Witnessed as above Cor. Feb. 16, 1917

"

Sec. Cor. to Sec. 5 - T. 11 S., R. 7 W. - on 2<sup>nd</sup> Std. Par. S.  
 Set 1 1/2" Galv. pipe, from which  
 " Fir 18" in diam. bears N. 38° E. 4.22 Chs. dist." Orig.  
 Witnessed as above Feb. 17, 1917.

"

Cor. of Secs. 5 & 6 - T. 11 S., R. 7 W. - on 2<sup>nd</sup> Std. Par. S.  
 Set. 1" Pipe, from which  
 " Burnt Fir 4 1/2" in diam. bears N. 13° E. .420 Chs. dist." Orig.  
 Fir 12" " " " N. 41° E. .119 " "  
 Witnessed as above. Feb. 20, 1917

"

Cor. of Secs. 31 & 32 - T. 10 S., R. 7 W. - on 2<sup>nd</sup> Std. Par. S.  
 Set Fir limb 5' x 5" x 32" from which.  
 " Burnt Fir 30" in diam. bears N. 38° W. .520 Chs. dist." Orig.  
 Fir 9" " " " N. 26° 40' W. .279 " "  
 Fir 14" " " " N. 31° 45' E. .237 " "  
 Witnessed as above. Feb. 10, 1917

"

1/4 Sec. Cor. bet Secs. 31 & 32 - T. 10 S., R. 7 W. Stone 18" x 13" x 12" from which  
 Fir 9" in diam. bears N. 30° W. 1.090 Chs. dist. Maple 16" x 12 1/2" W. .475 Chs. dist.  
 Tripple Maple 18" " " " N. 54° E. 1.062 " "  
 Witnessed as above. Feb. 14, 1917

Corner of Sections 5 and 6, Twp. 11 S., R. 7 W. on 2nd std. parallel S.

Reestablishment by W. C. Galloway-

February 20, 1917

Set 1" pipe

Burnt Fir 48" in diam bears N 13° E

.420 chains dist.

Burnt Fir 12" in diam bears N 41° E

.119 chains dist.

Witnessed by F. E. Reynolds, J. G. Mustoe, and George Thral

995

T115 R7W SEC. 5 N.W. COR.

FND. 1" I.P.P. FOR THE COR. (COR. REST NO. 995)

" " BEARS N78°E ~ 178' (N 89°30'E ~ 178' CS 2297)

" PARTLY ROTTED REMAINS OF A BURNT FIR STUMP

15" IN DIA. BEARS N40°E ~ 7.95' (N 41°E ~ 7.85

COR. REST. NO. 995) FACE @ SCRIBING \$ 9' PARTLY

VISIBLE. SET BT TAG DID NOT SET PK OR B.C.W.

" PARTLY ROTTED FIR STUMP 17" IN DIA. BEARS N 24°W

68.6' (N 17°43'W ~ 68.9' CS 2297) PART OF A

FACE @ THE SCRIBING " 2 B" IS VISIBLE SET A

BT TAG, BUT NO PK & WASHER.

" NO OTHER RECORD BEARING OBJECTS WERE RECOVERED

SET A 2" I.D. X 36" LONG IRON PIPE @ A 3/4" BEN. CO.

B.C. STAMPED AS SHOWN CENTERED OVER THE

1" IRON PIPE

SET - 5/8" X 30" REBAR @ A YEL. PLS. CAP MKO. " BEN-

TOWN COUNTY SURVEYOR " BEARS S 61°E ~ 9.00'

" 5/8" X 30" REBAR @ A YEL. PLS. CAP MKO. " BENTON

COUNTY SURVEYOR " BEARS S 77°W 22.25'

AN ALDER 12" IN DIA. BEARS S 1°W X 53.13' FACE @

SCRIBED " T115 R7W S 6 BT " SET PK & B.C.W. IN

W/4 BASE. SET BT TAG ON N/4 FACE

5/14

8/7/89, C. W. M.B.H., SILVA COMP. 20° E DEL., CLEAR W/4

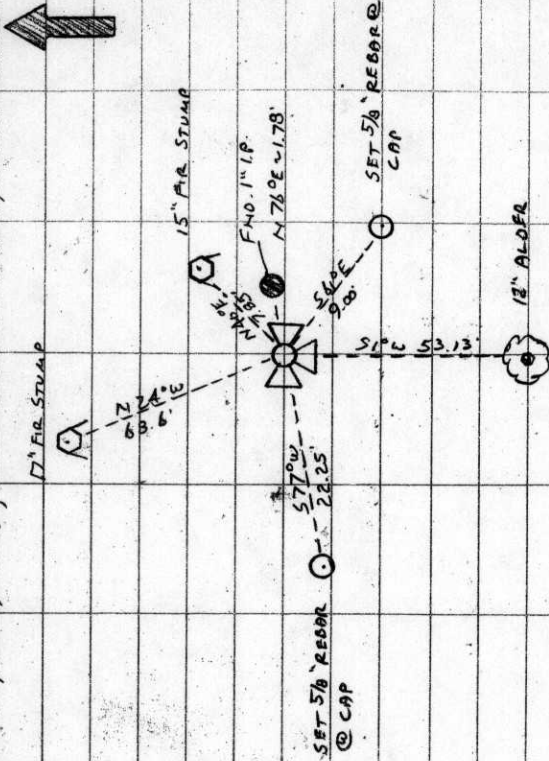

SET ORANGE CARBONITE SURVEY MARKER POST 1' W/4

THE COR. IS LOCATED AT THE NE COR. OF A NEW CLEAR ACCESS IS VIA THE SOUTH PLACE OFF THE SUMMIT HWY BUT, ON A STEEP N/4. SLOPING BRUSHY HILLSIDE. IT WOULD BE POOR FOR REMARKING & GPS CONTROL

SC
56
55

STAMPINGS

T115 R7W  
1989

BENTON COUNTY CORNER RESTORATION FORM **117200700** 3645

SECTION 5 TOWNSHIP 11 S RANGE 7 W DLC \_\_\_\_\_ CORNER NW  
 DATE 8/7/89 CORNER RESTORATION FIELD BOOK NUMBER 5 PAGE 14

CORNER DESIGNATION:

THE NORTHWEST CORNER OF SECTION 5,  
 T 11 S R 7 W, WILLAMETTE MERIDIAN.

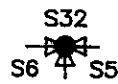

- \_\_\_\_\_ CONDITION REPORT ONLY
- \_\_\_\_\_ REFERENCED OUT
- XX RENEWED
- \_\_\_\_\_ SURVEYED IN

LOCATION AND COMMENTS:

THE CORNER IS LOCATED AT THE NORTHEAST CORNER OF A NEW CLEAR CUT, ON A STEEP NORTHERLY HILLSIDE. ACCESS IS VIA THE JAMES SMITH RESIDENCE AT 19731 SUMMIT HIGHWAY (STATE HIGHWAY NO. 180), SUMMIT.

PREVIOUS RENEWALS/SURVEYS, ETC.:

CORNER RESTORATION NO. 995 BY W. C. GALLOWAY IN 1917.  
 SURVEY NO. 11-7-2 BY W. C. GALLOWAY IN 1920.  
 COUNTY SURVEY NO. 2297 BY C. HANSON IN 1951.  
 COUNTY SURVEY NO. 2881 BY J. HANNA IN 1957.

MONUMENTS AND ACCESSORIES FOUND (CONDITION AND SOURCE):

- FOUND: 1" INSIDE DIAMETER IRON PIPE FOR THE CORNER (CORNER RESTORATION NO. 995).
  - FOUND: 1" INSIDE DIAMETER IRON PIPE BEARS N 76° E 1.78 FEET (N 89° 30' E 1.78 FEET, COUNTY SURVEY NO. 2297).
  - FOUND: PARTLY ROTTEN REMAINS OF A BURNT FIR STUMP 15" IN DIAMETER, BEARS N 40° E 7.85 FEET (N 41° E 7.85 FEET, CORNER RESTORATION NO. 995). FACE WITH SCRIBING "S 9" PARTLY VISIBLE. SET A B.T. TAG. DID NOT SET A P.K. NAIL OR B.C.B.W.
  - FOUND: PARTLY ROTTEN FIR STUMP 17" IN DIAMETER, BEARS N 24° W 68.6 FEET (N 17° 43' W 68.9 FEET, COUNTY SURVEY NO. 2297). PART OF A FACE WITH SCRIBING "2 B" IS VISIBLE. SET A B.T. TAG. DID NOT SET A P.K. NAIL OR B.C.B.W.
- NO OTHER RECORD BEARING OBJECTS WERE RECOVERED.

MONUMENT DETAIL

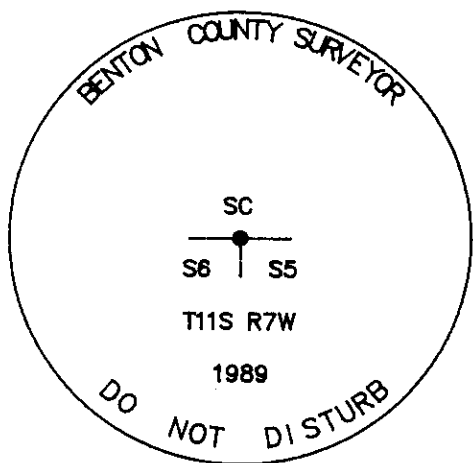

3 1/4" BRASS CAP

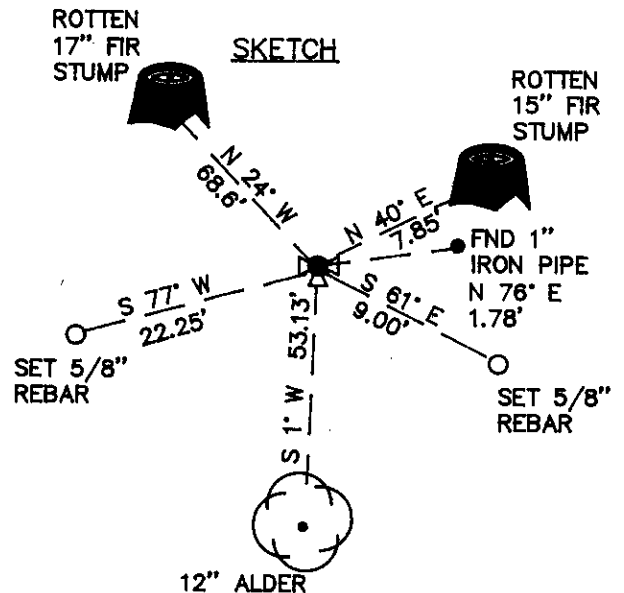
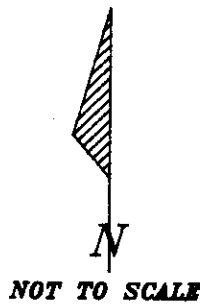

MONUMENT SET (PROCEDURES AND DESCRIPTION):

SET A 2" INSIDE DIAMETER BY 36" LONG IRON PIPE WITH A 3 1/4" BENTON COUNTY BRASS CAP, STAMPED AS SHOWN, CENTERED OVER THE RECOVERED 1" IRON PIPE.

NEW ACCESSORIES :

- SET: 5/8" X 30" REBAR WITH A YELLOW PLASTIC CAP MARKED "BENTON COUNTY SURVEYOR", BEARS S 61° E 9.00 FEET.
- SET: 5/8" X 30" REBAR WITH A YELLOW PLASTIC CAP MARKED "BENTON COUNTY SURVEYOR", BEARS S 77° W 22.25 FEET.
- AN ALDER 12" IN DIAMETER BEARS S 1° W 53.13 FEET. FACED AND SCRIBED "T11S R7W S6 BT". SET A P.K. NAIL AND A B.C.B.W. IN THE WESTERLY BASE. SET A B.T. TAG ON THE NORTHERLY FACE.
- SET: AN ORANGE CARSONITE "SURVEY MARKER" POST 1 FOOT WESTERLY.

NOTES:

B.C.B.W. IS A BRASS WASHER STAMPED "BENTON COUNTY SURVEYOR". COMPASS DECLINATION IS 20° EAST. ALL MEASURED DISTANCES AND COMPASS BEARINGS ARE TO THE CENTER OF THE OBJECT, UNLESS OTHERWISE NOTED.  
 SC - STANDARD CORNER.

FIRM/AGENCY: BENTON COUNTY PUBLIC WORKS  
ADDRESS: 360 S.W. AVERY AVE. CORVALLIS OR. 97333; PH. 757-6821  
PARTY CHIEF: CURTIS J. LIESENFELT  
CREW: MARY BARRON  
WITNESS:

REGISTERED  
 PROFESSIONAL  
 LAND SURVEYOR

*Danna L. Ingram-Fehrenbacher*

OREGON  
 JULY 16, 1982  
 DANNA L. INGRAM-FEHNRENBACHER  
 1995