

117300640

CORNER FILE TRACKING

CORNER NUMBER
117300640

STEP	HISTORY	RESTORATION
Form Prepared, DB	1/8/2019	1/14/19
Field Inspection, DB	1/11/19	1/11/19
Finish index (count unit)	1/8/19	1/11/19
Counter Index	1/11/19	1/11/19
GIS Index Form	1/14/19	1/14/19
Checked, DB	1/14/19	1/14/19
Form Edited, DB	1/23/19	1/23/19
Form Signed, DB	1/23/19	1/23/19
Authorize Payment, DB	---	---
Archive Digital Files	1/23/19	1/23/19
Collect Documents	1/23/19	1/23/19
PDF File	1/23/19	1/23/19
Copy For Filming	1/23/19	1/23/19
Scanned (pdf to laserfiche)	1/23/19	1/23/19
Filmed (Archived), DB		
Filed, DB		

(DB) = Entry needed in database (Access).

COMMENTS:

DATE 01/08/2019

TOWNSHIP 11 SOUTH, RANGE 7 WEST, WILLAMETTE MERIDIAN; SECTION 4 CORNER WEST 1/4
DONATION LAND CLAIM N/A CORNER N/ACOMMON CORNER(S):
EAST 1/4 CORNER SECTION 5RECORDS (INFORMATION IN BOLD ITALICS IS COUNTY STAFFS' INTERPRETATION OF THE RECORD)

BASED ON EXTENSIVE RESEARCH AND RECOVERY OF EVIDENCE, THIS OFFICE HAS DETERMINED THAT MOST GENERAL LAND OFFICE SURVEYORS IN BENTON COUNTY MEASURED TO THE FACE OF BEARING TREES.

- [01] GENERAL LAND OFFICE (GLO) NOTES BY DENNIS HATHORN, D.S., DATED JULY 7, 1856. SET POST FROM WHICH A FIR 24" DIA BEARS S76°E, 117 LINKS (77.22 FEET); FIR 24" DIA BEARS S79°W, 75 LINKS (49.50 FEET).
- [02] BENTON COUNTY SURVEY NO. 370 (OLD NO. 172) FIELD NOTES (FIELD BOOK 14, PAGE 60) BY W. C. GALLOWAY, C.S., DATED APRIL 14, 1913. SET 1" X 1" IRON PIN. ORIGINAL CORNER. 2 STUMPS. OLD STAKE. FIR 36" DIA BEARS S12°55'W, 1.023 CHAINS AT 12°13' SLOPE (65.99 FEET); FIR 32" DIA BEARS S88°40'W, 1.802 CHAINS (118.93 FEET).
- [03] BENTON COUNTY CORNER RESTORATION BOOK NO. 1, PAGE 68, BY W. C. GALLOWAY, C.S., DATED APRIL 16, 1913. SET 1" X 1" IRON PIN. ORIGINAL CORNER. 2 STUMPS, OLD STAKE DOWN. FIR 36" DIA (CSBT) BEARS S12°55'W, 1.023 CHAINS AT 12°13' SLOPE (65.99 FEET); FIR 32" DIA (CSBT) BEARS S88°40'W, 1.802 CHAINS (118.93 FEET).
- [04] BENTON COUNTY CORNER RESTORATION NO. 985. TRANSCRIBED FROM RECORD [03] AND MAY CONTAIN ERRORS AND/OR OMISSIONS.
- [05] BENTON COUNTY MAP NO. 11-7-00001 BY W. C. GALLOWAY, C.S., DATED APRIL 1913 AND FEBRUARY 1915. 1" X 1" IRON PIN. FIR 36" DIA (CSBT) BEARS S12°55'W, 1.023 CHAINS AT 12°13' SLOPE (65.99 FEET); FIR 32" DIA (CSBT) BEARS S88°40'W, 1.802 CHAINS (118.93 FEET).
- [06] BENTON COUNTY SURVEY NO. 1708 (OLD NO. 172 AND 199) BY W. C. GALLOWAY, C.S., NO DATE GIVEN. 1" X 1" IRON PIN. FIR 36" DIA (CSBT) BEARS S12°55'W, 1.023 CHAINS AT 12°13' SLOPE (65.99 FEET); FIR 32" DIA (CSBT) BEARS S88°40'W, 1.802 CHAINS (118.93 FEET).
- [07] BENTON COUNTY SURVEY NO. 725 (OLD NO. 207) FIELD NOTES (FIELD BOOK 25, PAGE 31) BY WALTER W. LARSEN, D.C.S., DATED AUGUST 21, 1920. FOUND CORNER TREE S89°W. OLD CORNER TREE IS 0.223 CHAINS (14.72 FEET) N31°45'E. 89°39' INTERIOR ANGLE TO TREE ON LINE BY 1/4 SECTION CORNER BETWEEN 4 AND 5. MAGNETIC BEARING S89°30'W.
- [08] BENTON COUNTY MAP NO. 11-7-00002 BY W. C. GALLOWAY, C.S., DATED MAY, 1920. 1" X 1" IRON PIN. FIR 36" DIA (CSBT) BEARS S50°55'W [SIC.], 1.023 CHAINS [SIC.](67.52 FEET); FIR 32" DIA (CSBT) BEARS S88°40'W, 1.802 CHAINS (118.93 FEET).
- [09] BENTON COUNTY SURVEY NO. 1710 (OLD NO. 172) FIELD NOTES (FIELD BOOK 82, PAGE 82) BY CURTIS C. HANSON, D.C.S., DATED FEBRUARY 24, 1945. 1" X 1" IRON PIN. FIR 36" DIA (CSBT) BEARS S12°55'W, 1.023 CHAINS [SIC.](67.52 FEET); FIR 32" DIA (CSBT) BEARS S88°40'W, 1.802 CHAINS (118.93 FEET). TREES OK THIS DATE.
- [10] BENTON COUNTY SURVEY NO. 1741 (OLD NO. 286) FIELD NOTES (FIELD BOOK 82, PAGE 119) BY W. C. GALLOWAY, C.S., DATED DECEMBER 28, 1945. CORNER NOT DESCRIBED.
- [11] BENTON COUNTY SURVEY NO. 8281 BY THEODORE JAMES LANGTON, P. L.S., DATED APRIL 5, 1989. 1" X 1" POINTED ROD AT CORNER. A BENT 3/4" ROD IS NEXT TO IT. FIR STUMP (36" DIA FIR) (CSBT) BEARS S12°55'W, 1.023 CHAINS SLOPE (65.99 FEET); FIR STUMP (32" DIA FIR) (CSBT) BEARS S88°40'W, 1.802 CHAINS (118.93 FEET), SCRIBING VISIBLE.
- [12] BENTON COUNTY CORNER RESTORATION NO. 3644 BY DANNA L. INGRAM-FEHRENBACHER, C.S., DATED AUGUST 2, 1989. FOUND 1" X 1" SQUARE IRON BAR FOR THE CORNER, POINTED AT THE TOP. FOUND 3/4" REBAR ALONGSIDE AS A GUARD. FOUND REMAINS OF OLD STAKE, POSSIBLY OAK. BURIED ALONGSIDE NEW MONUMENT. FOUND THE PARTIALLY ROTTED REMAINS OF A FIR STUMP 72" DIA (CSBT) BEARS S17°W, 65.3 FEET. FOUND THE PARTIALLY ROTTED REMAINS OF A FIR STUMP 48" DIA (CSBT) WITH THE REMAINS OF A FACE AND VISIBLE SCRIBING BEARS S88°W, 119.4 FEET. SET A 2" INSIDE DIAMETER BY 36" LONG IRON PIPE WITH A 3-1/4" BENTON COUNTY BRASS CAP STAMPED "1/4 S5 S4 T11S R7W 1989", CENTERED OVER THE RECOVERED 1" X 1" SQUARE IRON BAR. FIR 8" DIA BEARS S29°E, 25.74 FEET, FACED AND SCRIBED "1/4 S4 BT". SET A PK NAIL AND A BRASS WASHER STAMPED "BENTON COUNTY SURVEYOR" (BCBW) IN THE SOUTHWESTERLY BASE. FIR 10" DIA BEARS S45°W, 4.02 FEET, FACED AND SCRIBED "1/4 S5 BT". SET A PK NAIL AND BCBW IN THE NORTHWESTERLY BASE. SET AN ORANGE CARSONITE "SURVEY MARKER" POST 1 FOOT WESTERLY.
- [13] BENTON COUNTY SURVEY NO. 8855 BY MARK E. STEELE, P. L.S., DATED JUNE 28, 1994. FOUND BENTON COUNTY PIPE AND CAP, 4 BEARING TREES.

FIRM/AGENCY: BENTON COUNTY SURVEYOR'S OFFICE
ADDRESS: 360 S.W. AVERY AVE., CORVALLIS, OR 97333; PH. 541-766-6821
RESEARCH BY: DAVID L. MALONE, P.L.S.
DATA ENTRY BY: SAME

**BENTON COUNTY CORNER RESTORATION FORM, PAGE 1 OF 2, 117300640R3
SEE CORNER HISTORY FORM FOR RECORDS ETC.**

CORNER RESTORATION FIELD BOOK NUMBER 32 PAGE(S) 27 DATE 01/11/2019
TOWNSHIP 11 SOUTH, RANGE 7 WEST, WILLAMETTE MERIDIAN; SECTION 4 CORNER WEST 1/4
DONATION LAND CLAIM N/A CORNER N/A
CONDITION REPORT ; REFERENCED OUT X; RENEWED ; SURVEYED IN ;

LOCATION AND COMMENTS:

CORNER IS LOCATED ON THE EDGE OF A RIDGELINE ABOVE A STEEP SOUTH FACING SLOPE IN AN AREA OF ±30 YEAR OLD D. FIR. TO REACH CORNER FROM THE INTERSECTION OF MARYS RIVER ROAD AND LONG ROAD, TRAVEL EAST ON LONG ROAD FOR 0.34 MILES TO THE END COUNTY MAINTENANCE SIGN, CONTINUE FOR 0.19 MILES TRAVELING THROUGH A GATE TO A WYE, TURN LEFT AND FOLLOW FOR 0.07 MILES TO A WYE, STAY RIGHT FOR 0.03 MILES TO A WYE, STAY LEFT FOR 0.06 MILES TO A WYE, TURN LEFT FOR 0.08 MILES AND PARK. WALK NORTH ABOUT 250 FEET TO THE CORNER. CORNER IS BAD FOR PREMARKING AND GPS CONTROL.

MONUMENTS AND ACCESSORIES FOUND (CONDITION AND SOURCE):

1. FOUND 3-1/4" BRASS DISK CEMENTED IN 2" IRON PIPE UP 1" ABOVE GROUND SURFACE, FIRMLY SET AND UNDISTURBED FOR THE CORNER, MARKED AS SHOWN ON PAGE 2 OF 2.
(SET POST AS PER RECORD [01]).
(SET 1" X 1" IRON PIN. ORIGINAL CORNER. OLD STAKE AS PER RECORD [02]).
(SET 1" X 1" IRON PIN. ORIGINAL CORNER. OLD STAKE DOWN AS PER RECORD [03]).
(1" X 1" IRON PIN AS PER RECORDS [05], [06], [08] AND [09]).
(1" X 1" POINTED ROD AT CORNER. BENT 3/4" ROD NEXT TO IT AS PER RECORD [11]).
(FOUND 1" X 1" SQUARE IRON BAR FOR THE CORNER, POINTED AT THE TOP. FOUND 3/4" REBAR ALONGSIDE AS A GUARD. FOUND REMAINS OF OLD STAKE, POSSIBLY OAK. SET 2" INSIDE DIAMETER BY 36" LONG IRON PIPE WITH A 3-1/4" BENTON COUNTY BRASS CAP STAMPED "1/4 S5 S4 T11S R7W 1989", CENTERED OVER THE RECOVERED 1" X 1" SQUARE IRON BAR AS PER RECORD [12]).
(FOUND BENTON COUNTY PIPE AND CAP AS PER RECORD [13]).
2. FOUND D. FIR 17" DIA WITH HEALED FACE BEARS S29°00'E, 25.72 FEET TO CENTER. **BASIS OF BEARINGS FOR THIS RESTORATION.** SET ALUMINUM NAIL AND PLASTIC WASHER IN THE NORTHEASTERLY BASE FOR DISTANCE MEASUREMENT. (FIR 8" DIA BEARS S29°E, 25.74 FEET, FACED AND SCRIBED "1/4 S4 BT" AS PER RECORD [12]).
3. FOUND D. FIR 22" DIA WITH HEALED FACE BEARS S42°38'W, 4.08 FEET TO CENTER. SET ALUMINUM NAIL AND PLASTIC WASHER IN NORTHWESTERLY BASE FOR DISTANCE MEASUREMENT.
(FIR 10" DIA BEARS S45°W, 4.02 FEET, FACED AND SCRIBED "1/4 S5 BT" AS PER RECORD [12]).
4. FOUND ROTTED REMAINS OF D. FIR STUMP 67" DIA WITH NO VISIBLE SCRIBES BEARS S18°10'W, 65.62 FEET TO CENTER.
(FIR 36" DIA BEARS S12°55'W, 1.023 CHAINS AT 12°13' SLOPE [65.99 FEET] AS PER RECORDS [02], [03], [05] AND [06]).
(FIR 36" DIA BEARS S50°55'W, 1.023 CHAINS [67.52 FEET] AS PER RECORD [08]).
(FIR 36" DIA BEARS S12°55'W, 1.023 CHAINS [67.52 FEET] AS PER RECORD [09]).
(FIR STUMP BEARS S12°55'W, 1.023 CHAINS SLOPE [65.99 FEET] AS PER RECORD [11]).
(FOUND THE PARTIALLY ROTTED REMAINS OF A FIR STUMP 72" DIA BEARS S17°W, 65.3 FEET AS PER RECORD [12]).
5. FOUND ROTTEN D. FIR STUMP 50" DIA BEARS N86°30'W, 119.08 FEET TO CENTER. THE STUMP CONTAINED A PIECE OF WOOD WITH ILLEGIBLE SCRIBE MARKS.
(FIR 32" DIA BEARS S88°40'W, 1.802 CHAINS [118.93 FEET] AS PER RECORDS [02], [03], [05], [06], [08], AND [09]).
(FIR STUMP BEARS S88°40'W, 1.802 CHAINS [118.93 FEET], SCRIBING VISIBLE AS PER RECORD [11]).
(FOUND THE PARTIALLY ROTTED REMAINS OF A FIR STUMP 48" DIA WITH THE REMAINS OF A FACE AND VISIBLE SCRIBING BEARS S88°W, 119.4 FEET AS PER RECORD [12]).

MONUMENT SET (PROCEDURES AND DESCRIPTION):

FOUND 3-1/4" BRASS DISK CEMENTED IN 2" IRON PIPE UP 1" ABOVE GROUND SURFACE, FIRMLY SET AND UNDISTURBED FOR THE CORNER, MARKED AS SHOWN ON PAGE 2 OF 2. THE BRASS DISK AND IRON PIPE WERE SET BY DANNA L. INGRAM-FEHNENBACHER, C.S., IN 1989, OVER A 1" X 1" SQUARE IRON BAR THAT WAS SET BY W. C. GALLOWAY, C.S., IN 1913. GALLOWAY SET THE IRON BAR AT THE ORIGINAL CORNER FROM AN OLD STAKE AND TWO ORIGINAL STUMPS. NO ORIGINAL GENERAL LAND OFFICE (GLO) EVIDENCE WAS FOUND. THE BRASS DISK IS ACCEPTED AS THE PERPETUATION OF THE ORIGINAL CORNER POSITION.

SET TWO NEW IRON ROD ACCESSORIES AS SHOWN ON PAGE 2 OF 2. FOUND ORANGE CARSONITE "SURVEY STAKE" 1 FOOT SOUTH OF THE BRASS DISK.

±30 YEAR OLD D. FIR

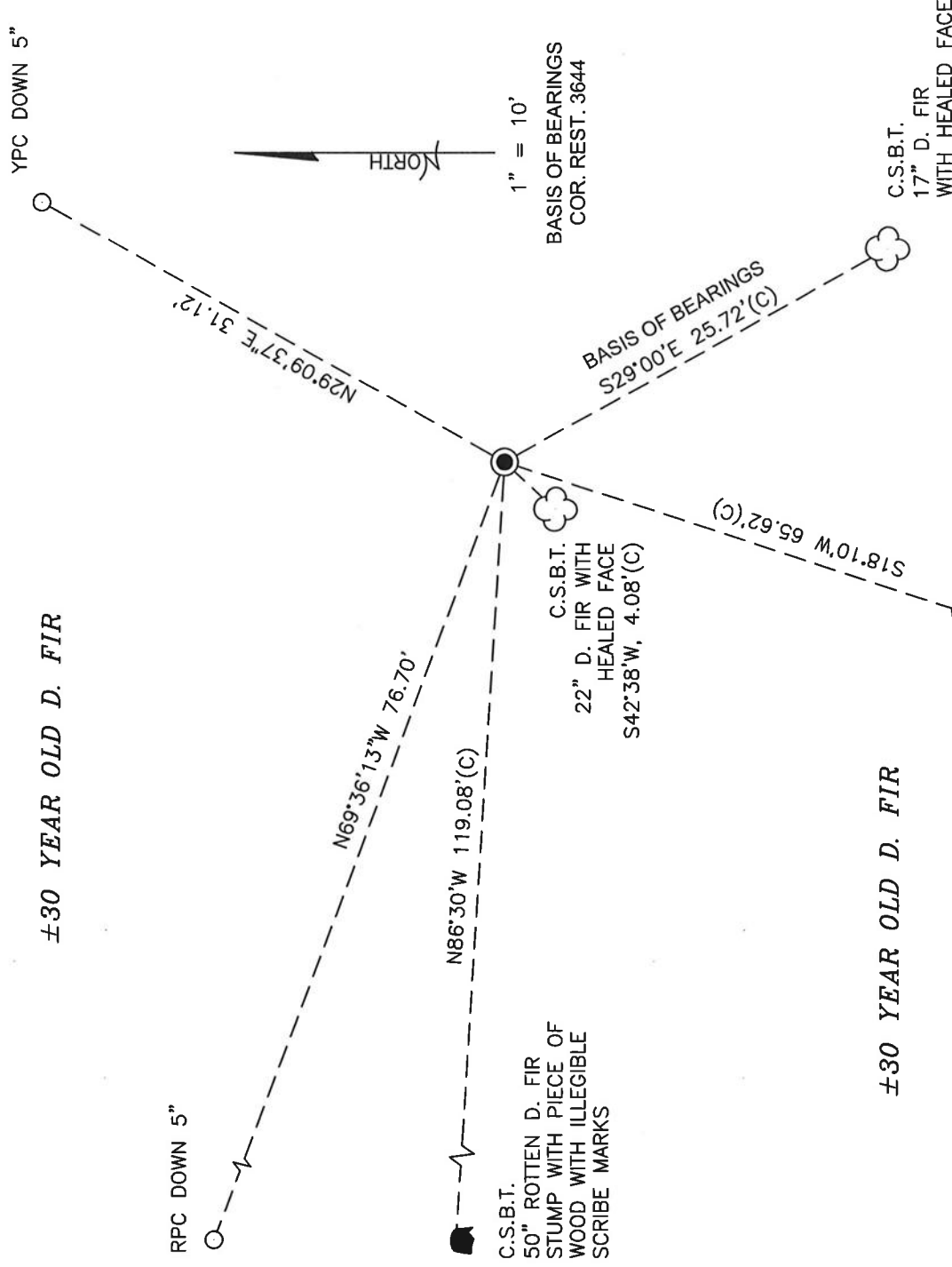

±30 YEAR OLD D. FIR

MONUMENT DETAIL

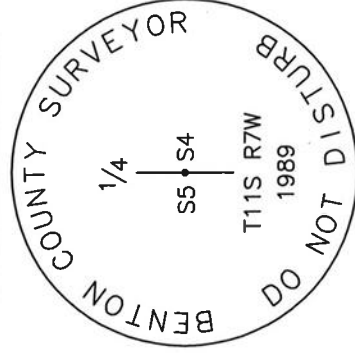

3-1/4" BRASS DISK

LEGEND

- SET 5/8" X 30" REBAR WITH PLASTIC CAP YELLOW PLASTIC CAP MARKED "BENTON COUNTY SURVEYOR"
- RPC RED PLASTIC CAP MARKED "BENTON COUNTY SURVEYOR"
- (C) MEASUREMENT TO CENTER
- GOVERNMENT MONUMENT FOUND AS SHOWN V.S. VISIBLE SCRIBING
- COR. REST. CORNER RESTORATION
- C.S.B.T. COUNTY SURVEYOR'S BEARING TREE BEARING TREE STUMP AS NOTED
- ☁ BEARING TREE AS NOTED

NEW ACCESSORIES:

1. SET REBAR (SEE LEGEND) N29°09'37"E, 31.12 FEET AND 5 INCHES BELOW GROUND LEVEL.
2. SET REBAR (SEE LEGEND) N69°36'13"W, 76.70 FEET AND 5 INCHES BELOW GROUND LEVEL.

NOTES:

COMPASS DECLINATION IS 15° EAST. ALL MEASURED DISTANCES AND BEARINGS ARE TO THE CENTER OF THE OBJECT, UNLESS OTHERWISE NOTED. ALL BEARING TREES ARE PAINTED AND HAVE A B.T. TAG ATTACHED, FACING THE CORNER UNLESS OTHERWISE NOTED. ALL NEW BEARING TREES HAVE A PLASTIC WASHER (STAMPED "SURVEY MARKER DO NOT REMOVE") ATTACHED BY AN ALUMINUM NAIL TO THE SIDE CENTER OF THE TREE FOR DISTANCE MEASUREMENT, UNLESS OTHERWISE NOTED.

THIS RESTORATION WAS PERFORMED AT THE DIRECTION AND APPROVAL OF
 THE BENTON COUNTY SURVEYOR *[Signature]*

REGISTERED
 PROFESSIONAL
 LAND SURVEYOR

David L. Malone

OREGON
 JANUARY 12, 1999
 DAVID L. MALONE
 51523

FIRM/AGENCY: BENTON COUNTY SURVEYOR'S OFFICE
 ADDRESS: 360 S.W. AVERY AVE., CORVALLIS, OR 97333; PH. 541-766-6821
 PRESENT: DAVID L. MALONE, P.L.S., AND BERNARD ALTENBACH, SURVEY TECH.
 EQUIPMENT: NIKON NIVO3.C WITH SURVEY PRO ONBOARD.

RENEWAL DATE: 12/31/20

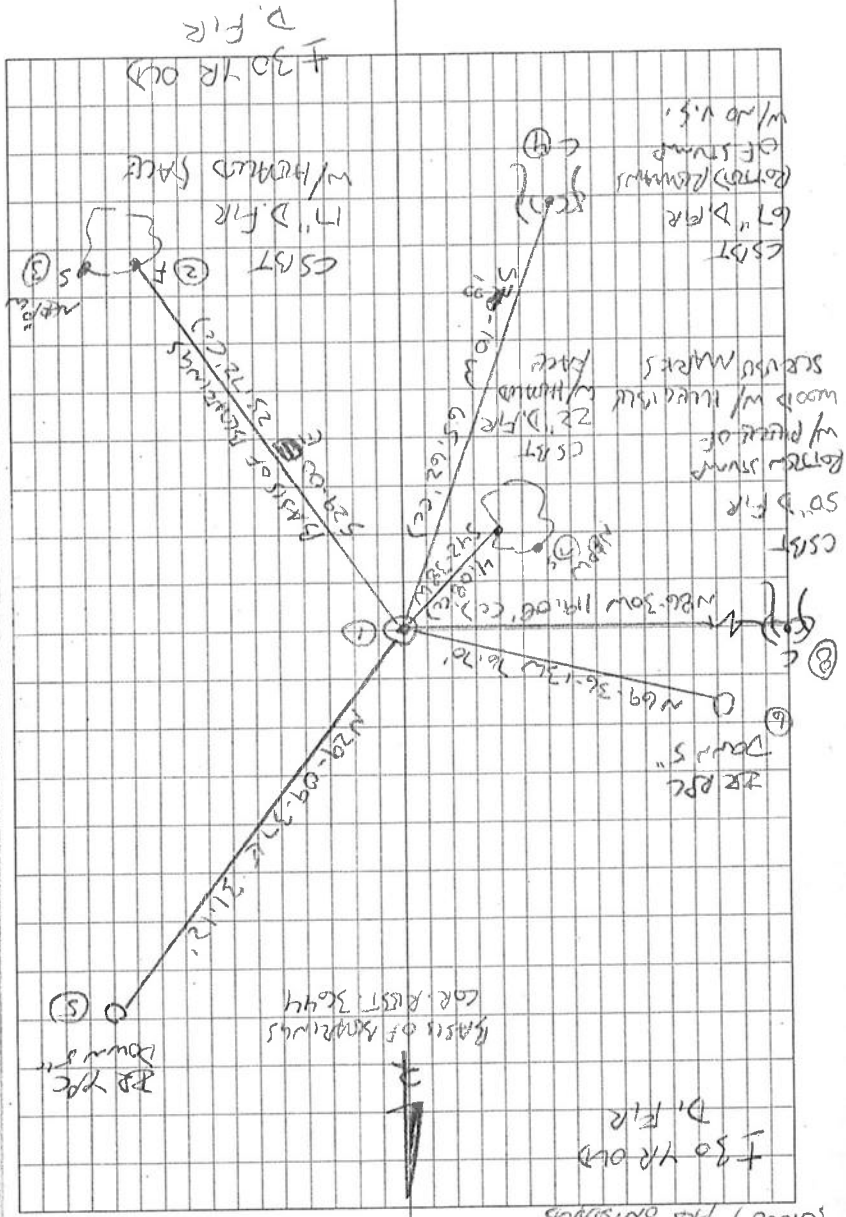

cold. unpaired
 1/1/2016
 D. MANNING
 B. MANNING
 3/27



117300640
 1/4
 REFERENCE THIS RW 5/4

FD 3-1/4" BRASS DISK CONTAINED IN 2" DP,
 UP 1" ABOVE GROUND, FIRMLY SET & UNDISTURBED
 FD ORANGE FIBERGLASS "SURVEY STAKE" 1'
 SOUTH OF BRASS DISK. FD 2 CSST STUMP
 PRE CORNER RESTORATION ROOF NO 1 PAGE 10, FD
 2 CSST'S PRE CORNER RESTORATION 3644. (H22)
 SE CSST PRE COR. REST. 3644 FOR BASIS
 OF BENCHMARK SET TWO NEW 1" PINE ROD
 ACCESSORIES.

BR = 5/8" x 30" IRON ROD
 YPC OR RPC = YELLOW OR RED
 PLASTIC CAP MARKED
 "BENTON COUNTY SUPERVISOR"
 NOT PINE NAIL & PLASTIC W/ MARKER
 MARKED "SURVEY MARKER"
 DO NOT REMOVE
 3-1/4" BRASS DISK

BENTON COUNTY CORNER RESTORATION FORM

117300640 3644

SECTION 5 TOWNSHIP 11 S RANGE 7 W DLC CORNER E 1/4
DATE 8/2/89 CORNER RESTORATION FIELD BOOK NUMBER 5 PAGE 13

CORNER DESIGNATION:

THE EAST 1/4 CORNER OF SECTION 5,
T 11 S R 7 W, WILLAMETTE MERIDIAN.

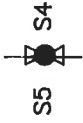

___ CONDITION REPORT ONLY
___ REFERENCED OUT
XX RENEWED
___ SURVEYED IN

LOCATION AND COMMENTS:

THE CORNER IS LOCATED NEAR THE TOP OF A SOUTHEASTERLY SLOPING, WOODED HILLSIDE AND ON A NORTHSTAR TRAVERSE LINE.

PREVIOUS RENEWALS/SURVEYS, ETC.:

CORNER RESTORATION NO. 985 BY W. C. GALLOWAY IN 1913.
COUNTY SURVEY NO. 8281 BY T. LANGTON IN 1989.

MONUMENTS AND ACCESSORIES FOUND (CONDITION AND SOURCE):

FOUND: 1" X 1" SQUARE IRON BAR FOR THE CORNER, POINTED AT THE TOP (CORNER RESTORATION NO. 985).

FOUND: 3/4" REBAR ALONGSIDE AS A GUARD.

FOUND: REMAINS OF OLD STAKE, POSSIBLY OAK. BURIED ALONGSIDE NEW MONUMENT.

FOUND: THE PARTIALLY ROTTED REMAINS OF A FIR STUMP 72" IN DIAMETER, BEARS S 17° W 65.3 FEET (S 12° 55' W 65.99 FEET, CORNER RESTORATION NO. 985). SET A B.T. TAG ON TOP. DID NOT SET A P.K. NAIL OR B.C.B.W.

FOUND: THE PARTIALLY ROTTED REMAINS OF A FIR STUMP 48" IN DIAMETER WITH THE REMAINS OF A FACE AND VISIBLE SCRIBING, BEARS S 88° W 119.4 FEET (S 88° 40' W 118.93 FEET, CORNER RESTORATION NO. 985). SET A B.T. TAG ON THE EASTERLY FACE. DID NOT SET A P.K. NAIL OR B.C.B.W.

NO OTHER RECORD BEARING OBJECTS WERE RECOVERED.

MONUMENT DETAIL

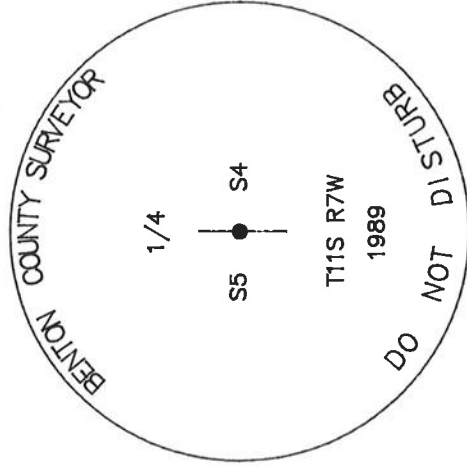

SKETCH

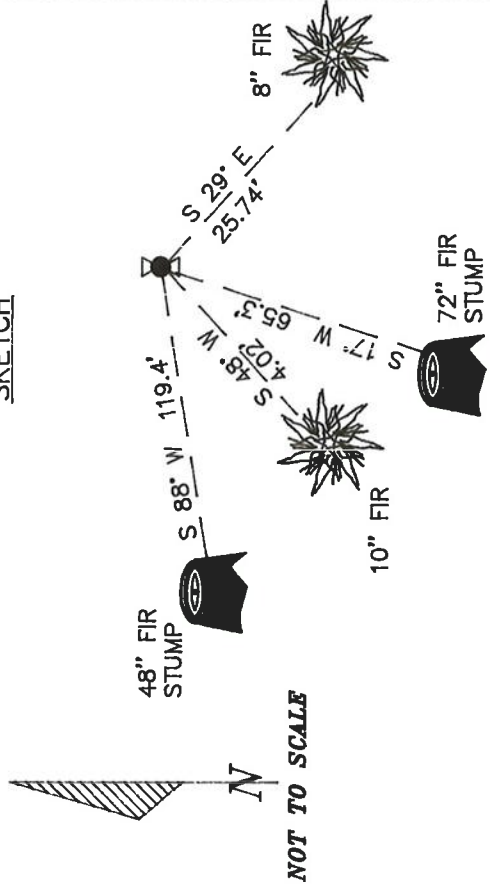

3 1/4" BRASS CAP

MONUMENT SET (PROCEDURES AND DESCRIPTION):

SET A 2" INSIDE DIAMETER BY 36" LONG IRON PIPE WITH A 3 1/4" BENTON COUNTY BRASS CAP, STAMPED AS SHOWN, CENTERED OVER THE RECOVERED 1" X 1" SQUARE IRON BAR.

NEW ACCESSORIES :

A FIR 8" IN DIAMETER BEARS S 29° E 25.74 FEET. FACED AND SCRIBED "1/4 S4 BT". SET A P.K.

NAIL AND A B.C.B.W. IN THE SOUTHWESTERLY BASE. SET A B.T. TAG ON THE NORTHWESTERLY FACE.

A FIR 10" IN DIAMETER BEARS S 45° W 4.02 FEET. FACED AND SCRIBED "1/4 S5 BT". SET A P.K.

NAIL AND A B.C.B.W. IN THE NORTHWESTERLY BASE. SET A B.T. TAG ON THE NORTHEASTERLY FACE.

SET: AN ORANGE CARSONITE "SURVEY MARKER" POST 1 FOOT WESTERLY.

NOTES:

B.C.B.W. IS A BRASS WASHER STAMPED "BENTON COUNTY SURVEYOR". COM-PASS DECLINATION IS 20° EAST. ALL MEASURED DISTANCES AND COMPASS BEARINGS ARE TO THE CENTER OF THE OBJECT, UNLESS OTHERWISE NOTED.

REGISTERED
PROFESSIONAL
LAND SURVEYOR

Danna K. Ingraham

FIRM/AGENCY: BENTON COUNTY PUBLIC WORKS

ADDRESS: 360 S.W. AVERY AVE. CORVALLIS OR. 97333; PH. 757-6821

PARTY CHIEF: CURTIS J. LIESENFELT

CREW: MARY BARRON

WITNESS:

OREGON
JULY 16, 1982
DANNA L. INGRAM-FEHRNBACHER
1995

T115 RTW SEC. 5 E 1/4

FXD. 1" x 1" 50.12oz BRG @ POINTED TOP FOR THE COP. (COP

REST. NO. 985)

3/4" BEAR ALONGSIDE AS A GUARD

BURIED ALONGSIDE NEW MON.

REMAINS OF OLD STAKE POSSIBLY BARK ALONGSIDE BAR

" THE PARTLY ROTTED REMAINS OF A FIR STUMP 72"

IN DIA. BEARS 517" w ~ 65.3 (5.1255' w ~ 65.99' COR.

REST. NO. 985) SET BT TAB ON TOP DIA NOT SET

PK + BCBW

" THE PARTLY ROTTED REMAINS OF A FIR STUMP 48" IN

DIA. @ THE REMAINS OF A FACE & VISIBLE SCRIBING

BEARS 588" w ~ 119.4 (5.8840' w ~ 118.93'

(COR. REST. NO. 985) SET BT TAB ON ELY BOSE.

NO OTHER RECORD BEARING OBJECTS WERE RE-

COVERED

SET: 2" 10. X 3/8" LONG IRON PIPE @ A 3 1/4" BEN. CO.

B.C. STAMPED AS SHOWN CENTERED OVER

THE 1" 50.12oz BRG

A FIR B" IN DIA. BEARS 529" ~ 2574' FACED

+ SCRIBED "1/4 54 BT". SET A PK + BCBW IN

SW 1/4 BOSE SET A BT TAB ON NW 1/4 FACE

5/13

8/2/89 CTRLD M.B. @ SILVER COME 20° E DEC, PC WARM

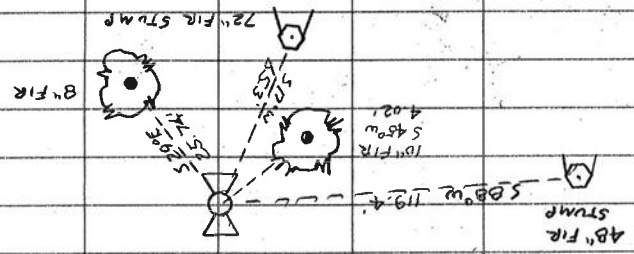

A FIR 10" IN DIA. BEARS 545" w ~ 4.02' FACED &

SCRIBED "1/4 55 BT". SET A PK + BCBW IN NW 1/4

BOSE. SET BT TAB ON NE 1/4 FACE

SET AN ORANGE CHROME "SURVEY MARKER" POST

THE CORNER IS LOCATED NEAR THE TOP OF A SE 1/4

SLOPING WOODED HILLIDE & ON A NORTHEAST

TRaverse LINE IT WOULD BE POOR FOR PRE-

MARKING & GPS CONTROL.

1/4

55-54

CAP

STAMMALS

T115 RTW

1989

CORNER RESTORATION BOOK NO. 1

S.E. cor. of W²¹ H. Johnson lcl. 63 Tp. 10 S. R. 4 W.
 Set 1 1/4" angle iron for cor. from which
 An Oak 16" dia. tree. S. 80° 35' W. 116 lbs. dist.
 Witness Anthony Bros. No other trees available.

Cor. A sec. 36-37-34+35 Tp. 10 S. R. 4 W.
 Set 1 1/4" pipe for cor. from which
 An Oak 12" dia tree. S 77° 30' E. 315.4 lbs dist.
 " " 16" " " S 2°-10' E 362.5 " "
 No other trees available. Witness Anthony Bros.

S.W. cor. Lewis Morris lcl. 70 Tp. 10 S. R. 4 W.
 Set 1 1/4" wagon tire for cor. find which
 An Oak 6" dia tree S 80° 35' W 53.2 lbs dist.
 " " 24" " " S 34° E. 41 lbs dist.
 Original S.E. tree standing, Witness Anthony Bros.

175 N.E. cor. of Polly Silbato D.L.C. # 58 Tp. 14 S. R. 5 W.
 Set 1" pipe oak stump.
 Oak 18" in dia. tree S. 22° 45' W. 1.84 lbs std.
 Thorn 14" " " S. 45° 30' W. .857 lbs
 Witness F.P. + Lu Swinson. Apr. 9. 1913.

172 Sec. cor. to sec. 4, 5, 8 + 9. Tp. 11-7
 Set 3/4 x 20" bolt. Stamp N.W.
 3 in 36" in dia. tree S. 30° E. 2.52 lbs std.
 " 12" " " S. 66° W 1.53 lbs std.
 " 17" " " N. 43° 50' W 1.557 "
 Witness F.W. Barnhard. Apr. 14, 1913.

172 1/4 cor. lat. sec. 4+9 Tp. 11-7. Orig. cor. 2 stamps
 Set 1/2" pipe
 Fir stump 24" in dia. tree S. 70° E .78' std.
 " 19" " " N. 47° W .518 "
 Witness Jas. Miller, E. Perry, F.W. Barnhard Apr. 10, '13

172 1/4 sec. cor. lat. sec. 4+5. Tp. 11-7
 Set 1" x 1" iron pin. Orig. cor. 2 stamps, old stake down
 Fir 36" in dia. tree S. 12° 55' W. 1.023' slope 12° 13'
 " 32" " " S. 88° 40' W. 1.802 "
 Witness J. Miller, E. Perry + F.W. Barnhard 4/16/13

172 1/4 cor. lat. sec. 3+4 Tp. 11-7.
 Set 1/2" galv. pipe. Orig. cor.
 Fir. 12 in dia. tree S. 20° E. .528' std.
 " 24" " " N. 27° W. .46' "
 Witness J. Miller, E. Perry, F.W. Barnhard. 4/16/13

1/4-section corner between sections 4 and 5, Twp. 11-7

985 1160

Reestablishment by W. C. Galloway

April 16, 1913

Set 1" x 1" iron pin, original corner, 2 stumps, old stake down.

Fir 36" in diam bears S 12° 55' W 1.023 chains (slope)

Fir 28" in diam bears S 88° 40' W 1.802 chains

Witnesses J. Miller, E. Perry, and F. W. Barnhard