

117340400

CORNER FILE TRACKING

CORNER NUMBER
117340400

STEP	HISTORY	RESTORATION
Form Prepared, DB	2/25/20	3/29/22
Field Inspection, DB	3/28/22	3/28/22
Finish index (count unit)	2/25/20	3/28/22
Counter Index	3/29/22	3/29/22
GIS Index Form	3/29/22	3/29/22
Checked, DB	3/30/22	3/30/22
Form Edited, DB	3/30/22	3/30/22
Form Signed, DB	3/30/22	3/30/22
Authorize Payment, DB	—	—
Archive Digital Files	3/30/22	3/30/22
Collect Documents	3/30/22	3/30/22
PDF File	3/30/22	3/30/22
Copy For Filming	3/30/22	3/30/22
Scanned (pdf to laserfiche)	3/30/22	3/30/22
Filmed (Archived), DB		
Filed, DB		

(DB) = Entry needed in database (Access).

COMMENTS:

DATE 02/25/2020TOWNSHIP 11 SOUTH, RANGE 7 WEST, WILLAMETTE MERIDIAN; SECTION 16 CORNER SOUTH 1/4
DONATION LAND CLAIM N/A CORNER N/A**COMMON CORNER(S):**

NORTH 1/4 CORNER SECTION 21

RECORDS (INFORMATION IN *BOLD ITALICS* IS COUNTY STAFFS' INTERPRETATION OF THE RECORD)

BASED ON EXTENSIVE RESEARCH AND RECOVERY OF EVIDENCE, THIS OFFICE HAS DETERMINED THAT MOST GENERAL LAND OFFICE SURVEYORS IN BENTON COUNTY BEFORE 1890 MEASURED TO THE FACE OF BEARING TREES.

- [01] GENERAL LAND OFFICE (GLO) NOTES BY DENNIS HATHORN, D.S., DATED JULY 7, 1856. *SET POST FROM WHICH A BURNT FIR 36" DIA BEARS S22°W, 40 LINKS (26.40 FEET); BURNT FIR 24" DIA BEARS N62°W, 107 LINKS (70.62 FEET).*
- [02] REESTABLISHED CORNER FORM FOR OREGON STATE BOARD OF FORESTRY BY ARNOLD G. GIBSON, P.L.S., DATED JUNE 1, 1956. *BURNT FIR 8 FOOT HIGH STUB (GLO BT) BEARS S22°W, 40 LINKS (26.40 FEET), SCRIBES "1/4S" REMAINING; BURNT FIR STUMP (GLO BT) BEARS N62°W, 107 LINKS (70.62 FEET). SET 1-1/2" X 36" GALVANIZED IRON PIPE WITH 3" BRONZE CAP MARKED "OREGON STATE BOARD OF FORESTRY 1/4 S16 S21 1956 RS 359", 34" IN GROUND, FROM WHICH A FIR 25" DIA BEARS N71°W, 70.0 FEET, SCRIBED "1/4 S16 BT RS 359"; FIR 39" DIA BEARS S28-1/2°W, 25.0 FEET, SCRIBED "1/4 S21 BT". METAL LOCATION POSTER ON FIR 42" DIA BEARS S82°E, 23.5 FEET. SET 4" X 4" X 60" WHITE PAINTED CEDAR POST 1.5 FEET NORTHEAST OF PIPE.*
- [03] BENTON COUNTY CORNER RESTORATION NO. 1055. *TRANSCRIBED FROM RECORD [02] AND MAY CONTAIN ERRORS AND/OR OMISSIONS.*
- [04] BENTON COUNTY SURVEY NO. 3392 BY ARNOLD G. GIBSON, P.L.S., DATED JULY, 1960. *1/4 CORNER FOUND.*

FIRM/AGENCY: BENTON COUNTY SURVEYOR'S OFFICE
ADDRESS: 360 S.W. AVERY AVE., CORVALLIS, OR 97333; PH. 541-766-6821
RESEARCH BY: DAVID L. MALONE, P.L.S.
DATA ENTRY BY: SAME

BENTON COUNTY CORNER RESTORATION FORM, PAGE 1 OF 2, 117340400R1
SEE CORNER HISTORY FORM FOR RECORDS ETC.

CORNER RESTORATION FIELD BOOK NUMBER 33 PAGE(S) 96-97 DATE 03/28/2022
TOWNSHIP 11 SOUTH, RANGE 7 WEST, WILLAMETTE MERIDIAN; SECTION 16 CORNER SOUTH 1/4
DONATION LAND CLAIM N/A CORNER N/A
CONDITION REPORT ; REFERENCED OUT X; RENEWED ; SURVEYED IN

LOCATION AND COMMENTS:

CORNER IS LOCATED IN A CLEAR CUT ON A SMALL FLAT AREA AT THE END OF A RIDGELINE. TO REACH CORNER FROM THE INTERSECTION OF HIGHWAY 20 AND BYRD LANE (A PRIVATE GATED ROAD), TRAVEL WEST 0.22 MILES ALONG BYRD LANE TO THE END OF THE LANE, TURN RIGHT ONTO A TIMBER ROAD FOR 0.01 MILES TO A WYE, STAY RIGHT PASSING THROUGH A GATE FOR 0.10 MILES TO A WYE, STAY RIGHT FOR 0.10 MILES TO A WYE, STAY LEFT FOR 0.20 MILES TO A WYE, STAY RIGHT FOR 0.35 MILES TO A WYE, TURN RIGHT FOR 0.64 MILES TO A WYE, STAY LEFT FOR 0.65 MILES TO A SMALL RIDGE AND PARK. WALK NORTHWEST ALONG THE TOP OF RIDGE FOR ABOUT 240 FEET TO THE CORNER. CORNER IS GOOD FOR PREMARKING AND GPS CONTROL.

MONUMENTS AND ACCESSORIES FOUND (CONDITION AND SOURCE):

1. FOUND 3" BRASS CAP MARKED AS SHOWN ON PAGE 2 OF 2, ON 1-1/2" IRON PIPE, FIRMLY SET AND UNDISTURBED, FLUSH WITH GROUND SURFACE FOR THE CORNER.
(SET POST AS PER RECORD [01]).
(SET 1-1/2" X 36" GALVANIZED IRON PIPE WITH 3" BRONZE CAP MARKED "OREGON STATE BOARD OF FORESTRY 1/4 S16 S21 1956 RS 359", 34" IN GROUND AS PER RECORD [02]).
(1/4 CORNER FOUND AS PER RECORD [04]).
2. FOUND ROTTEN D. FIR STUMP 24" DIA BEARS N71°00'W, 71.05 FEET TO CENTER. OPENED FACE TO VISIBLE SCRIBE MARKS "S16B". **BASIS OF BEARINGS FOR THIS RESTORATION.**
(FIR 25" DIA BEARS N71°W, 70.0 FEET, SCRIBED "1/4 S16 BT RS 359" AS PER RECORD [02]).
3. FOUND ROTTEN D. FIR STUMP 40" DIA WITH NO VISIBLE MARKS BEARS S29°46'W, 26.46 FEET TO CENTER.
(FIR 39" DIA BEARS S28-1/2°W, 25.0 FEET, SCRIBED "1/4 S21 BT" AS PER RECORD [02]).
4. FOUND 8' TALL D. FIR STUMP 40" DIA BEARS S81°26'E, 25.19 FEET TO CENTER.
(METAL LOCATION POSTER ON FIR 42" DIA BEARS S82°E, 23.5 FEET AS PER RECORD [02]).

MONUMENT SET (PROCEDURES AND DESCRIPTION):

FOUND 3" BRASS CAP MARKED AS SHOWN ON PAGE 2 OF 2, ON 1-1/2" IRON PIPE, FIRMLY SET AND UNDISTURBED, FLUSH WITH GROUND SURFACE FOR THE CORNER. BRASS CAP AND IRON PIPE WERE SET IN 1956 BY ARNOLD G. GIBSON, P.L.S., FROM BOTH ORIGINAL GENERAL LAND OFFICE (GLO) BEARING TREES. THE GLO BEARING TREES ARE NOW NOTHING MORE THAN WOOD REMAINS. THE BEARING TREES MARKED BY GIBSON FIT WELL WITH THE BRASS CAP, AND IT APPEARS THAT GIBSON USED FACE MEASUREMENTS WHEN MARKING NEW BEARING TREES. THE BRASS CAP AND IRON PIPE ARE ACCEPTED AS THE PERPETUATION OF THE ORIGINAL CORNER POSITION.

SET FOUR NEW IRON ROD ACCESSORIES AS SHOWN ON PAGE 2 OF 2. FOUND THE BROKEN STUB OF A WHITE FIBERGLASS POST ON THE SOUTHWEST SIDE OF THE BRASS CAP. SET 6 FOOT ORANGE CARSONITE "SURVEY MARKER" POST 1 FOOT NORTH OF THE BRASS CAP.

CLEAR CUT

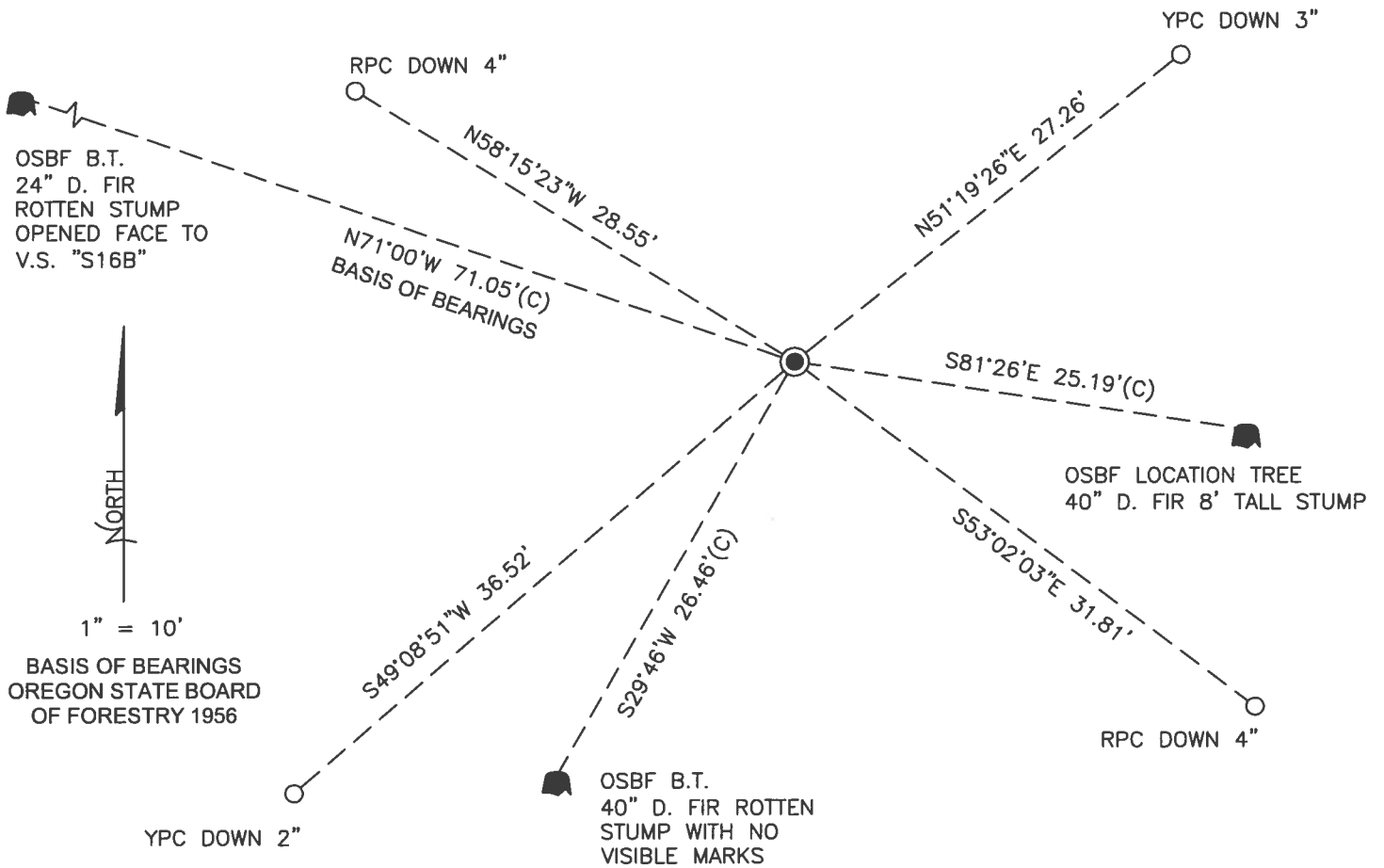

CLEAR CUT

MONUMENT DETAIL

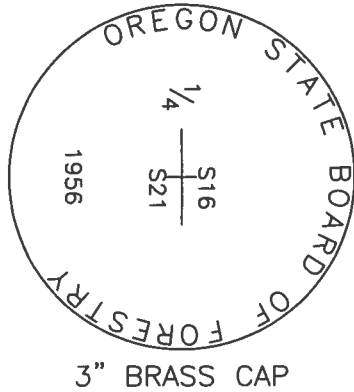

LEGEND

- SET 5/8" X 30" REBAR WITH PLASTIC CAP
- YPC YELLOW PLASTIC CAP MARKED "BENTON COUNTY SURVEYOR"
- RPC RED PLASTIC CAP MARKED "BENTON COUNTY SURVEYOR"
- OSBF OREGON STATE BOARD OF FORESTRY
- (C) MEASUREMENT TO CENTER
- GOVERNMENT MONUMENT FOUND AS SHOWN
- V.S. VISIBLE SCRIBING
- B.T. BEARING TREE
- BEARING TREE STUMP AS NOTED

NEW ACCESSORIES:

1. SET REBAR (SEE LEGEND) N51°19'26"E, 27.26 FEET AND 3 INCHES BELOW GROUND LEVEL.
2. SET REBAR (SEE LEGEND) S53°02'03"E, 31.81 FEET AND 4 INCHES BELOW GROUND LEVEL.
3. SET REBAR (SEE LEGEND) S49°08'51"W, 36.52 FEET AND 2 INCHES BELOW GROUND LEVEL.
4. SET REBAR (SEE LEGEND) N58°15'23"W, 28.55 FEET AND 4 INCHES BELOW GROUND LEVEL.

NOTES:

COMPASS DECLINATION IS 15' EAST. ALL MEASURED DISTANCES AND BEARINGS ARE TO THE CENTER OF THE OBJECT, UNLESS OTHERWISE NOTED. ALL BEARING TREES ARE PAINTED AND HAVE A B.T. TAG ATTACHED, FACING THE CORNER UNLESS OTHERWISE NOTED. ALL NEW BEARING TREES HAVE A PLASTIC WASHER (STAMPED "SURVEY MARKER DO NOT REMOVE") ATTACHED BY AN ALUMINUM NAIL TO THE SIDE CENTER OF THE TREE FOR DISTANCE MEASUREMENT, UNLESS OTHERWISE NOTED.

THIS RESTORATION WAS PERFORMED AT THE DIRECTION AND APPROVAL OF THE BENTON COUNTY SURVEYOR *Jess*

REGISTERED
PROFESSIONAL
LAND SURVEYOR

FIRM/AGENCY: BENTON COUNTY SURVEYOR'S OFFICE
 ADDRESS: 360 S.W. AVERY AVE., CORVALLIS, OR 97333; PH. 541-766-6821
 PRESENT: DAVID L. MALONE, P.L.S., BERNARD ALTENBACH, SURVEY TECH., AND ANEURIN L. MALONE, VOLUNTEER
 EQUIPMENT: NIKON NIVO3.C WITH SURVEY PRO ONBOARD.

3/3/22 David L Malone

OREGON
JANUARY 12, 1999
DAVID L. MALONE
51523

RENEWAL DATE: 12/31/22

117340400

10
21

REFERENCE

T15 R7W

1/4

FD 3" BRASS CAP ON 1-1/2" DR. FAMILY
 SET. & UNDISTURBED, FLUSH W/ GROUND
 SURFACE. FD BROKEN WITH FIREWORKS
 POST ON SW SIDE OF CAP. FD 3RD STUMP
 AND HOLD NW GIBSON STUMP FOR MAIL
 OF NEARBY LOST STUMP OF TROOP GIBSON TEAMWOOD
 W/ LEADER POSTER. SET 4' FROM 1" NW ROD ALLEGEDLY
 SET 6' ORANGE CARBONITE "SURVEY MARKER" POST
 1' NORTH OF BRASS CAP

DR = 5/16" x 30" DRUM ROD

-RPC OR RPC = YELLOW OR RED PLASTIC

CAP MARKER "NORTH COUNTY SURVEYOR"

NEEW = NAIL & PLAIN WOOD

MARKERS "SURVEY MARKER"

DO NOT REMOVE"

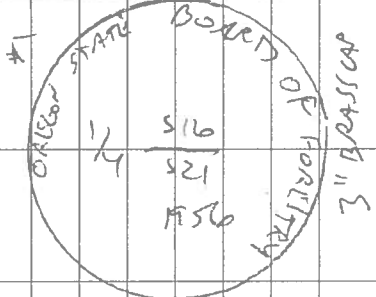

3" BRASS CAP

Notes in the Rain

COOL, RAIN, SLOW

MIKON N103.2

SURVEY PRO ENDED

3/28/22

D. MARONE

B. AUSTIN/SM

A. MARONE

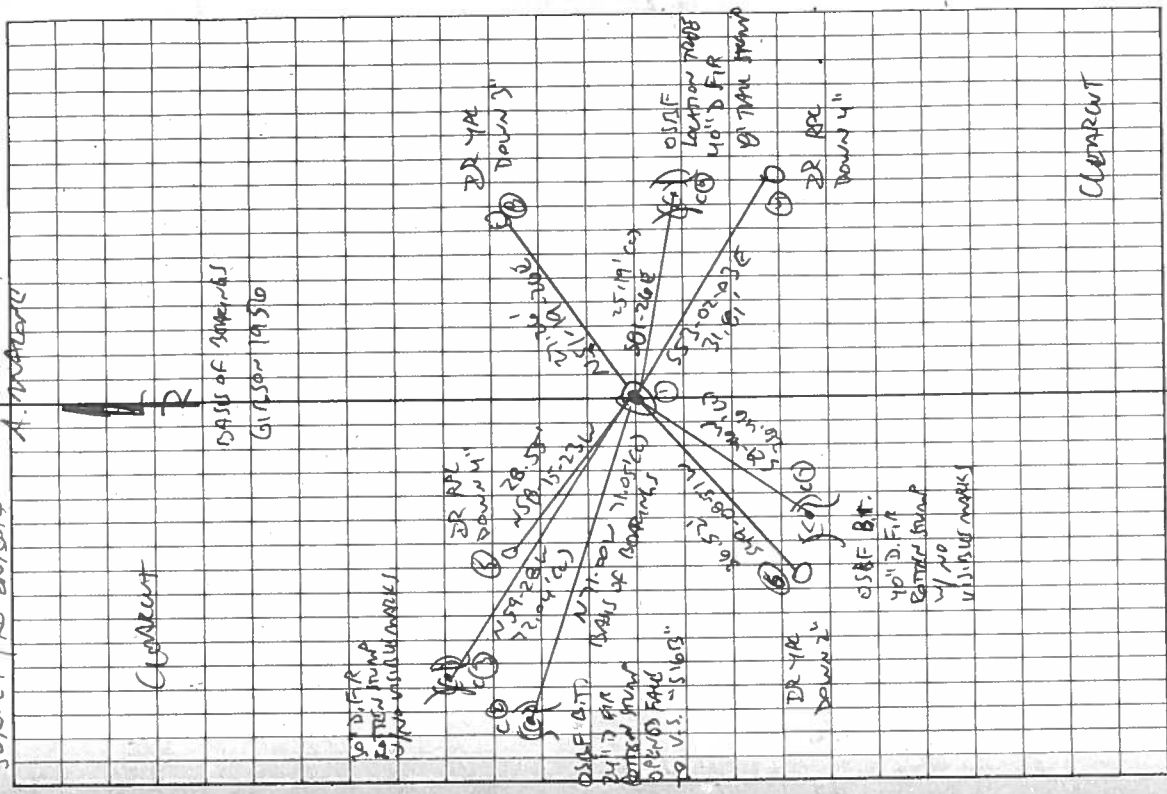

CLEARCUT

CLEARCUT

RESTORED CORNER FOR OREGON STATE BOARD OF FORESTRY

One quarter corner common to Sections 16 and 21
Township 11 South, Range 7 West, W.M., Benton County, Oregon.

ORIGINAL

Post (now missing) from which a:

36" Burnt fir bears S22°W 40 lks.; now 8 ft. high stub, scribes
 $\frac{1}{4}$ " S remaining.

24" Burnt fir bears N62°W 107 lks.; 2 ft. high rotted, burnt stump.

RESTORED

Var. 21°

Set 1 $\frac{1}{2}$ " x 36" galvanized iron pipe with 3" bronze cap marked
"OREGON STATE BOARD OF FORESTRY $\frac{1}{4}$ " S16 S21 1956 RS 359,"
34 inches in ground, and from which a:

25" Fir bears N71°W 70.0 ft.; scribed $\frac{1}{4}$ " S16 BT RS 359.

39" Fir bears S28 $\frac{1}{2}$ °W 25.0 ft.; scribed $\frac{1}{4}$ " S21 BT.

Oregon State Board of Forestry metal location poster on 42" Fir
S82°E 23.5 ft.

Set 4"x4"x60" white painted Cedar post 1.5 ft. NE of pipe.

Dated June 1, 1956.

Restored by

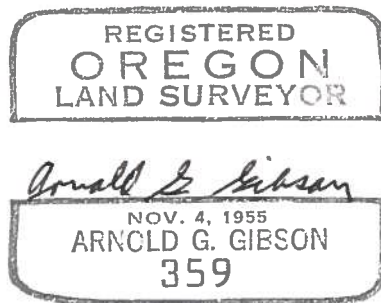

Present and witnessed by Gerald Smith
David Crumb
Clyde Ratliff

$\frac{1}{4}$ -Section corner to Sections 16 and 21, Twp. 11 S., R. 7 W.

1053

ORIGINAL

36" Burnt fir bears S 22° W. 40 lks; now 8 ft. high stub, scribes $\frac{1}{4}$ S remain.

24" Burnt Fir bears N 62° W 107 lks.; 2 ft. high rotted, burnt stump.

Restored by Arnold G. Gibson

June 1, 1956

Set $1\frac{1}{2}$ " x 36" galvanized iron pipe with 3" bronze cap marked "Oregon State Board of Forestry $\frac{1}{2}$ S 16 S 21 1956 RS 359" 34 inches in ground,

25" Fir bears N 71° W 70.0 ft.; scribed $\frac{1}{4}$ S 16 BT RS 359.

39" Fir bears S 28 $\frac{1}{2}$ ° W 25.0 ft.; scribed $\frac{1}{4}$ S 21 BT

Oregon State Board of Forestry metal location poster on 42" Fir S 82° E 23.5 ft.

Set 4" x 4" x 60" white painted Cedar post 1.5 ft. NE of pipe.