

**117340700**

## CORNER FILE TRACKING

S:\Survey Corners\CORNERS\Templates\Filetrac2.doc  
10/04/2010

<b>CORNER NUMBER</b>
117340700

<b>STEP</b>	<b>HISTORY</b>	<b>RESTORATION</b>
Form Prepared, DB	02/10/2017	3/21/17
Field Inspection, DB	3/17/2017	3/17/2017
Finish index (count unit)	02/10/2017	3/17/2017
Counter Index	3/20/2017	3/20/2017
GIS Index Form	3/20/2017	3/20/2017
Checked, DB	3/22/2017	3/22/2017
Form Edited, DB	3/20/2017	3/20/17
Form Signed, DB	3/20/17	3/20/17
Authorize Payment, DB	—	—
Archive Digital Files	3/20/17	3/20/17
Collect Documents	3/20/17	3/20/17
PDF File	3/20/17	3/20/17
Copy For Filming	3/20/17	3/20/17
Scanned (pdf to laserfiche)	3/20/17	3/20/17
Filmed (Archived), DB		
Filed, DB		

(DB) = Entry needed in database (Access).

### COMMENTS:

**BENTON COUNTY CORNER HISTORY FORM, PAGE 1 OF 1,**

**117340700H**

DATE 02/10/2017

TOWNSHIP 11 SOUTH, RANGE 7 WEST, WILLAMETTE MERIDIAN; SECTION 4 CORNER NORTH 1/4  
DONATION LAND CLAIM N/A CORNER N/A

**COMMON CORNER(S):**

POINT ON SOUTH LINE OF SECTION 33, TOWNSHIP 10 SOUTH, RANGE 7 WEST

**RECORDS (INFORMATION IN BOLD ITALICS IS COUNTY STAFFS' INTERPRETATION OF THE RECORD)**

BASED ON EXTENSIVE RESEARCH AND RECOVERY OF EVIDENCE, THIS OFFICE HAS DETERMINED THAT MOST GENERAL LAND OFFICE SURVEYORS IN BENTON COUNTY MEASURED TO THE FACE OF BEARING TREES.

- [01] GENERAL LAND OFFICE (GLO) NOTES BY DENNIS HATHORN, D.S., DATED JULY 7, 1856. SET POST FROM WHICH A **BURNT FIR 36" DIA BEARS N18°E, 95 LINKS (62.70 FEET); A BURNT FIR 24" DIA BEARS S40°E, 57 LINKS (37.62 FEET).**
- [02] GENERAL LAND OFFICE (GLO) NOTES BY DENNIS HATHORN, D.S., DATED DECEMBER 5, 1856. STANDARD **1/4 SECTION POST.**
- [03] BENTON COUNTY SURVEY NO. 370 (OLD NO. 172) FIELD NOTES (FIELD BOOK 14, PAGE 62) BY W. C. GALLOWAY, C.S., DATED APRIL 14, 1913. SET **1/2" PIPE. FIR 36" DIA (GLO BT) BEARS N18°E, 0.95 CHAINS (62.70 FEET), STANDING; BURNT FIR 48" DIA (GLO BT) BEARS S40°E, 0.55 CHAINS (36.30 FEET), STANDING.**
- [04] BENTON COUNTY CORNER RESTORATION BOOK NO. 1, PAGE 69, BY W. C. GALLOWAY, C.S., DATED APRIL 17, 1913. SET **1/2" PIPE. FIR 36" DIA (GLO BT) BEARS N18°E, 0.95 CHAINS (62.70 FEET), STANDING; BURNT FIR 48" DIA (GLO BT) BEARS S40°E, 0.55 CHAINS (36.30 FEET), STANDING.**
- [05] BENTON COUNTY SURVEY NO. 1710 (OLD NO. 172) FIELD NOTES (FIELD BOOK 82, PAGE 86) BY CURTIS C. HANSON, D.C.S., DATED FEBRUARY 24, 1945. **1/2" PIPE. FIR STUMP 16" DIA BEARS N25°E, 12 LINKS (7.92 FEET), BLAZE, NO SCRIBE.**
- [06] BENTON COUNTY CORNER RESTORATION NO. 986. TRANSCRIBED FROM RECORD [05] AND MAY CONTAIN ERRORS AND/OR OMISSIONS.
- [07] BENTON COUNTY MAP NO. 11-7-00001 BY W. C. GALLOWAY, C.S., DATED FEBRUARY, 1915. **1/2" PIPE. FIR 36" DIA (GLO BT) BEARS N18°E, 0.95 CHAINS (62.70 FEET), STANDING; BURNT FIR 48" DIA (GLO BT) BEARS S40°E, 0.55 CHAINS (36.30 FEET), STANDING; FIR STUMP 16" DIA (CSBT) BEARS N25°E, 12 LINKS (7.92 FEET).**
- [08] BENTON COUNTY SURVEY NO. 6684 BY ARNOLD BRUBAKER, P.L.S., DATED JULY 4, 1978. FOUND **1/2" PIPE. FIR 36" DIA (GLO BT) BEARS N18°E, 62.7 FEET; BURNT FIR 48" DIA (GLO BT) BEARS S40°E, 36.3 FEET; FIR STUMP 16" DIA (CSBT) BEARS N25°E, 7.92 FEET.**
- [09] BENTON COUNTY CORNER RESTORATION BY WILJO E. GREEN, P.L.S., DATED DECEMBER 5, 1980. ROTTED STUMP **34" DIA (GLO BT) BEARS S40°E, 37.6 FEET, AGAINST A 50" ROTTED SNAG ON NORTHWEST EDGE OF FLAT IN CORNER OF LOGGING; GREEN FIR 60" DIA (GLO BT) BEARS N17°E, 63.7 FEET TO CENTER, BADLY SCARRED. 1/2" IRON PIPE IN PLACE FROM WHICH A ROTTED STUMP 16" DIA (CSBT) BEARS N32°E, 8.2 FEET. ALDER 10" DIA BEARS S69°W, 23.3 FEET TO FACE, SCRIBED IN BARK "SC1/4 S4 BT RS 563"; ALDER 15" DIA BEARS N27°E, 13.0 FEET TO FACE, SCRIBED "S33 BT" IN BARK. SET A WHITE FIBER GLASS FENCE POST 1.0 FEET NORTHEAST OF CORNER PIPE.**
- [10] BENTON COUNTY CORNER RESTORATION NO. 991. TRANSCRIBED FROM RECORD [09] AND MAY CONTAIN ERRORS AND/OR OMISSIONS.
- [11] BENTON COUNTY CORNER RESTORATION NO. 117340700N2 BY MARK E. STEELE, P.L.S., DATED JUNE 28, 1994. LIVE FIR **63" DIA (GLO BT) BEARS N18°E, 61.41 FEET TO FACE OF TREE; STUMP (GLO BT) BEARS S40°E, 38.03 FEET TO CENTER. FOUND 1/2" PIPE IN PLACE. ROTTEN FIR STUMP 16" DIA (CSBT) BEARS N31°E, 8.13 FEET. ALDER 10" DIA BEARS S69°W, 23.3 FEET; ALDER 15" DIA BEARS N27°E, 13.0 FEET. SET 1-1/2" X 36" ALUMINUM PIPE WITH 3-1/4" CAP MARKED "1/4 S4 T11S R7W SC 1994", OVER 1/2" PIPE, 28" IN GROUND, FROM WHICH A FIR 19" DIA BEARS N30°W, 30.23 FEET TO A WASHER MARKED "RS2016" AND NAILED INTO BOTTOM OF FACE SCRIBED "X BT"; FIR 17" DIA BEARS S79°E, 22.93 FEET TO A WASHER MARKED "RS2016" AND NAILED INTO BOTTOM OF FACE SCRIBED "1/4 S4 BT". SET 4" X 4" X 72" WHITE PAINTED CEDAR POST 1.0 FEET SOUTHWEST.**
- [12] BENTON COUNTY SURVEY NO. 8855 BY MARK E. STEELE, P.L.S., DATED JUNE 28, 1994. FOUND OREGON STATE DEPARTMENT OF FORESTRY **1-1/2" INNER DIAMETER X 30" ALUMINUM PIPE WITH 3-1/2" ALUMINUM CAP AND MAGNET. 7 BEARING TREES.**
- [13] BENTON COUNTY SURVEY NO. 9938 BY JIM S. PETERSON, P.L.S., DATED JULY 18, 2003. FOUND **3-1/2" OREGON STATE DEPARTMENT OF FORESTRY ALUMINUM CAP.**

**FIRM/AGENCY:** BENTON COUNTY SURVEYOR'S OFFICE

**ADDRESS:** 360 S.W. AVERY AVE., CORVALLIS, OR 97333; PH. 541-766-6821

**RESEARCH BY:** DAVID L. MALONE, P.L.S.

**DATA ENTRY BY:** SAME

**BENTON COUNTY CORNER RESTORATION FORM, PAGE 1 OF 2, 117340700R3  
SEE CORNER HISTORY FORM FOR RECORDS ETC.**

CORNER RESTORATION FIELD BOOK NUMBER 31 PAGE(S) 32 DATE 03/17/2017  
TOWNSHIP 11 SOUTH, RANGE 7 WEST, WILLAMETTE MERIDIAN; SECTION 4 CORNER NORTH 1/4  
DONATION LAND CLAIM N/A CORNER N/A  
CONDITION REPORT   ; REFERENCED OUT X; RENEWED   ; SURVEYED IN   

**LOCATION AND COMMENTS:**

CORNER IS LOCATED ON A STEEP NORTHWEST FACING SLOPE IN AN AREA OF MIXED HARDWOODS AND FIRS. TO REACH CORNER FROM THE INTERSECTION OF MARYS RIVER ROAD AND LONG ROAD, FOLLOW LONG ROAD EAST FOR 0.34 MILES TO THE "END COUNTY MAINTENANCE" SIGN. THEN CONTINUE EAST PASSING THROUGH A STARKER FORESTS GATE FOR 0.19 MILES TO A WYE, TURN LEFT FOR 0.11 MILES TO A WYE, STAY LEFT FOR 0.05 MILES TO A WYE, STAY RIGHT FOR 0.21 MILES TO A WYE, STAY LEFT FOR 0.07 MILES TO A WYE, TAKE RIGHT FOR 0.20 MILES TO A WYE, STAY RIGHT FOR 0.20 MILES TO END OF ROCK. PARK AND FOLLOW DIRT ROAD FOR 0.16 MILES TO END OF ROAD. FOLLOW LEVEL GRADE EAST AND NORTHEAST THROUGH THE D. FIR REPROD, UNTIL ENTERING A MIXED STAND OF OLDER FIR AND HARDWOODS. THEN HEAD NORTH-NORTHEAST TO THE CORNER. TOTAL DISTANCE FROM END OF ROAD IS ABOUT 450 FEET. CORNER IS BAD FOR PREMARKING AND GPS CONTROL.

**MONUMENTS AND ACCESSORIES FOUND (CONDITION AND SOURCE):**

1. FOUND 3-3/4" ALUMINUM CAP ON A 1-1/2" ALUMINUM PIPE, FIRMLY SET, UNDISTURBED, FLUSH WITH THE GROUND SURFACE FOR THE CORNER.  
(SET POST PER RECORD [01]).  
(STANDARD 1/4 SECTION POST PER RECORD [02]).  
(SET 1/2" PIPE PER RECORDS [03] AND [04]).  
(1/2" PIPE PER RECORDS [05] AND [07] - [09]).  
(FOUND 1/2" PIPE IN PLACE. SET 1-1/2" X 36" ALUMINUM PIPE WITH 3-1/4" CAP MARKED "1/4 S4 T11S R7W SC 1994" OVER 1/2" PIPE; 28" IN GROUND PER RECORD [11]).  
(FOUND OREGON STATE DEPARTMENT OF FORESTRY 1-1/2" INNER DIAMETER X 30" ALUMINUM PIPE WITH 3-1/2" ALUMINUM CAP AND MAGNET PER RECORD [12]).  
(FOUND 3-1/2" OREGON STATE DEPARTMENT OF FORESTRY ALUMINUM CAP PER RECORD [13]).
2. FOUND D. FIR 63" DIA WITH PARTIALLY HEALED PREVIOUSLY OPENED FACE BEARS N18°00'E, 63.03 FEET TO CENTER. **BASIS OF BEARINGS FOR THIS RESTORATION.**  
(BURNT FIR 36" DIA BEARS N18°E, 95 LINKS [62.70 FEET] PER RECORD [01]).  
(FIR 36" DIA BEARS N18°E, 0.95 CHAINS [62.70 FEET], STANDING PER RECORDS [03], [04] AND [07]).  
(FIR 36" DIA BEARS N18°E, 62.7 FEET PER RECORD [08]).  
(GREEN FIR 60" DIA BEARS N17°E, 63.7 FEET TO CENTER, BADLY SCARRED PER RECORD [09]).  
(LIVE FIR 63" DIA BEARS N18°E, 61.41 FEET TO FACE OF TREE PER RECORD [11]).
3. FOUND ROTTEN AND BROKEN REMAINS OF A 12 FOOT TALL D. FIR STUMP 72" DIA BEARS S39°47'E, 40.87 FEET TO CENTER.  
(BURNT FIR 24" DIA BEARS S40°E, 57 LINKS [37.62 FEET] PER RECORD [01]).  
(BURNT FIR 48" DIA BEARS S40°E, 0.55 CHAINS [36.30 FEET], STANDING PER RECORDS [03], [04] AND [07]).  
(BURNT FIR 48" DIA BEARS S40°E, 36.3 FEET PER RECORD [08]).  
(ROTTED STUMP 34" DIA BEARS S40°E, 37.6 FEET, AGAINST A 50" ROTTED SNAG PER RECORD [09]).  
(STUMP BEARS S40°E, 38.03 FEET TO CENTER PER RECORD [11]).
4. FOUND ALDER 21" DIA BEARS N28°09'E, 13.57 FEET TO CENTER, WITH VISIBLE BARK SCRIBING "B". SET ALUMINUM NAIL AND PLASTIC WASHER IN NORTHWESTERLY BASE FOR DISTANCE MEASUREMENT.  
(ALDER 15" DIA BEARS N27°E, 13.0 FEET TO FACE, SCRIBED "S33 BT" IN BARK PER RECORD [09]).  
(ALDER 15" DIA BEARS N27°E, 13.0 FEET PER RECORD [11]).
5. FOUND D. FIR 27" DIA WITH HEALED FACE BEARS N32°47'W, 31.90 FEET TO CENTER. SET ALUMINUM NAIL AND PLASTIC WASHER IN SOUTHWESTERLY BASE FOR DISTANCE MEASUREMENT.  
(FIR 19" DIA BEARS N30°W, 30.23 FEET TO A WASHER MARKED "RS2016" AND NAILED INTO BOTTOM OF FACE SCRIBED "X BT" PER RECORD [11]).
6. FOUND D. FIR 29" DIA WITH HEALED FACE BEARS S83°22'E, 23.63 FEET TO CENTER. SET ALUMINUM NAIL AND PLASTIC WASHER IN NORTHERLY BASE FOR DISTANCE MEASUREMENT.  
(FIR 17" DIA BEARS S79°E, 22.93 FEET TO A WASHER MARKED "RS2016" AND NAILED INTO BOTTOM OF FACE SCRIBED "1/4 S4 BT" PER RECORD [11]).

**MONUMENT SET (PROCEDURES AND DESCRIPTION):**

FOUND 3-3/4" ALUMINUM CAP, MARKED AS SHOWN ON PAGE 2 OF 2, ON A 1-1/2" ALUMINUM PIPE, FIRMLY SET, UNDISTURBED, FLUSH WITH THE GROUND SURFACE FOR THE CORNER. THIS MONUMENT WAS SET BY MARK E. STEELE, P.L.S., IN 1994 OVER THE 1/2" IRON PIPE SET BY W. C. GALLOWAY, C.S., IN 1913, WHICH WAS REESTABLISHED FROM THE ORIGINAL GENERAL LAND OFFICE (GLO) BEARING TREES. THE ALUMINUM CAP IS ACCEPTED AS A PERPETUATION OF THE ORIGINAL CORNER POSITION.

FOUND A 4" X 4" WHITE PAINTED CEDAR POST STICKING 54" OUT OF THE GROUND ABOUT 1 FOOT SOUTHWEST OF THE ALUMINUM CAP. FOUND A WHITE FIBERGLASS POST LYING ON THE GROUND AND SET POST 1 FOOT EAST OF ALUMINUM CAP. SET 6 FOOT ORANGE CARBONITE "SURVEY MARKER" POST 1 FOOT NORTH OF ALUMINUM CAP. SET TWO NEW IRON ROD ACCESSORIES AS SHOWN ON PAGE 2 OF 2.

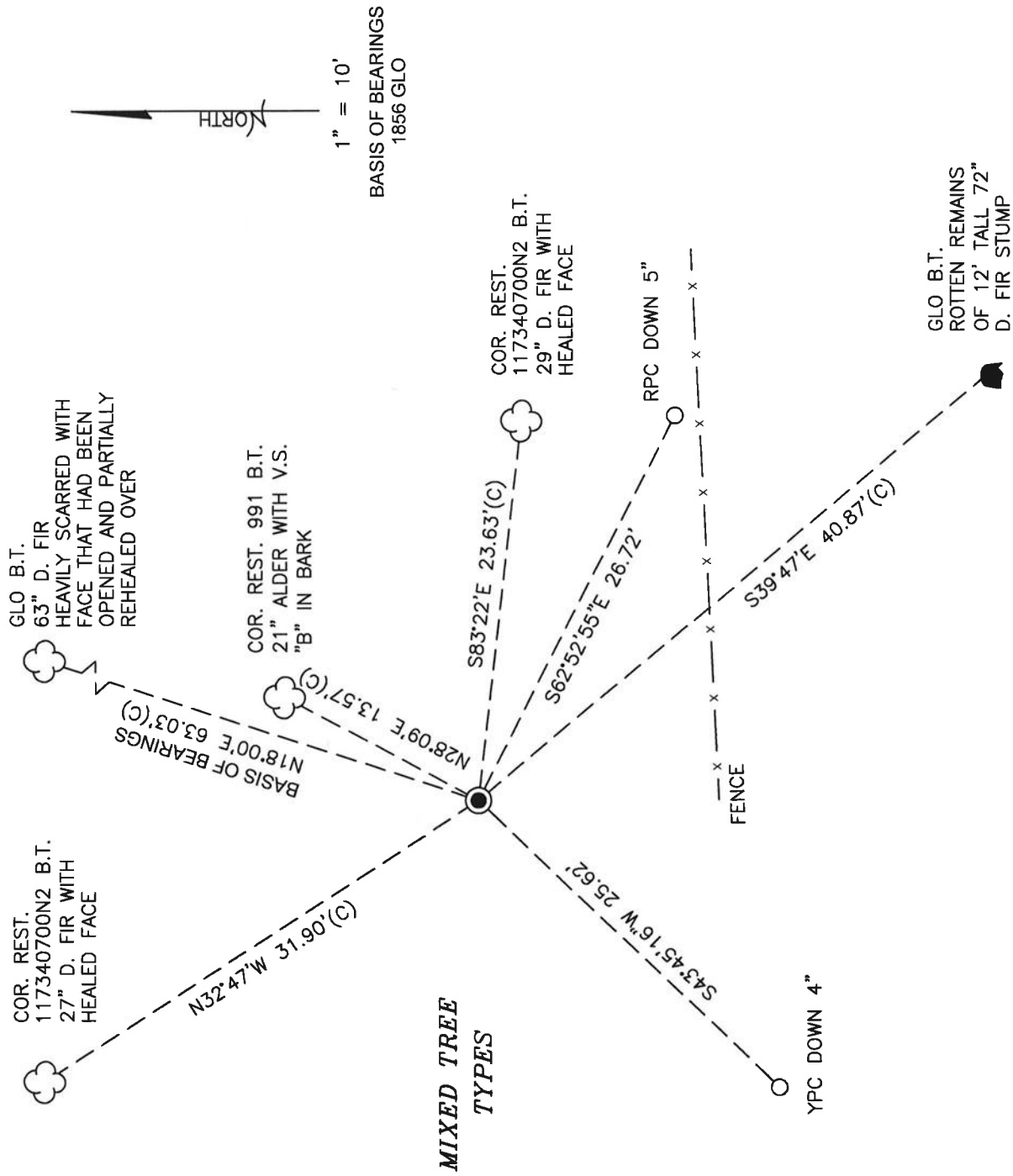

1" = 10'  
BASIS OF BEARINGS  
1856 GLO

MONUMENT DETAIL



3--3/4" ALUMINUM CAP

LEGEND

- SET 5/8" X 30" REBAR WITH PLASTIC CAP
- YPC YELLOW PLASTIC CAP MARKED "BENTON COUNTY SURVEYOR"
- RPC RED PLASTIC CAP MARKED "BENTON COUNTY SURVEYOR"
- (C) MEASUREMENT TO CENTER
- GOVERNMENT MONUMENT FOUND AS SHOWN VISIBLE SCRIBING
- CORNER RESTORATION
- GENERAL LAND OFFICE
- BEARING TREE
- BEARING TREE STUMP AS NOTED
- BEARING TREE AS NOTED

NEW ACCESSORIES:

1. SET REBAR (SEE LEGEND) S62°52'55"E, 26.72 FEET AND 5 INCHES BELOW GROUND LEVEL.
2. SET REBAR (SEE LEGEND) S43°45'16"W, 25.62 FEET AND 4 INCHES BELOW GROUND LEVEL.

NOTES:

COMPASS DECLINATION IS 16° EAST. ALL MEASURED DISTANCES AND BEARINGS ARE TO THE CENTER OF THE OBJECT, UNLESS OTHERWISE NOTED. ALL BEARING TREES ARE PAINTED AND HAVE A B.T. TAG ATTACHED, FACING THE CORNER UNLESS OTHERWISE NOTED. ALL NEW BEARING TREES HAVE A PLASTIC WASHER (STAMPED "SURVEY MARKER DO NOT REMOVE") ATTACHED BY AN ALUMINUM NAIL TO THE SIDE CENTER OF THE TREE FOR DISTANCE MEASUREMENT, UNLESS OTHERWISE NOTED.

THIS RESTORATION WAS PERFORMED AT THE DIRECTION AND APPROVAL OF  
THE BENTON COUNTY SURVEYOR *[Signature]*

REGISTERED  
PROFESSIONAL  
LAND SURVEYOR

*3/23/17 David L. Malone*

OREGON  
JANUARY 12, 1999  
DAVID L. MALONE  
51523

FIRM/AGENCY: BENTON COUNTY SURVEYOR'S OFFICE  
ADDRESS: 360 S.W. AVERY AVE., CORVALLIS, OR 97333; PH. 541-766-6821  
PRESENT: DAVID L. MALONE, P.L.S. AND BERNARD ALTENBACH, SURVEY TECH.  
EQUIPMENT: NIKON NIVO3.C WITH SURVEY PRO ONBOARD.

RENEWAL DATE: 12/31/18

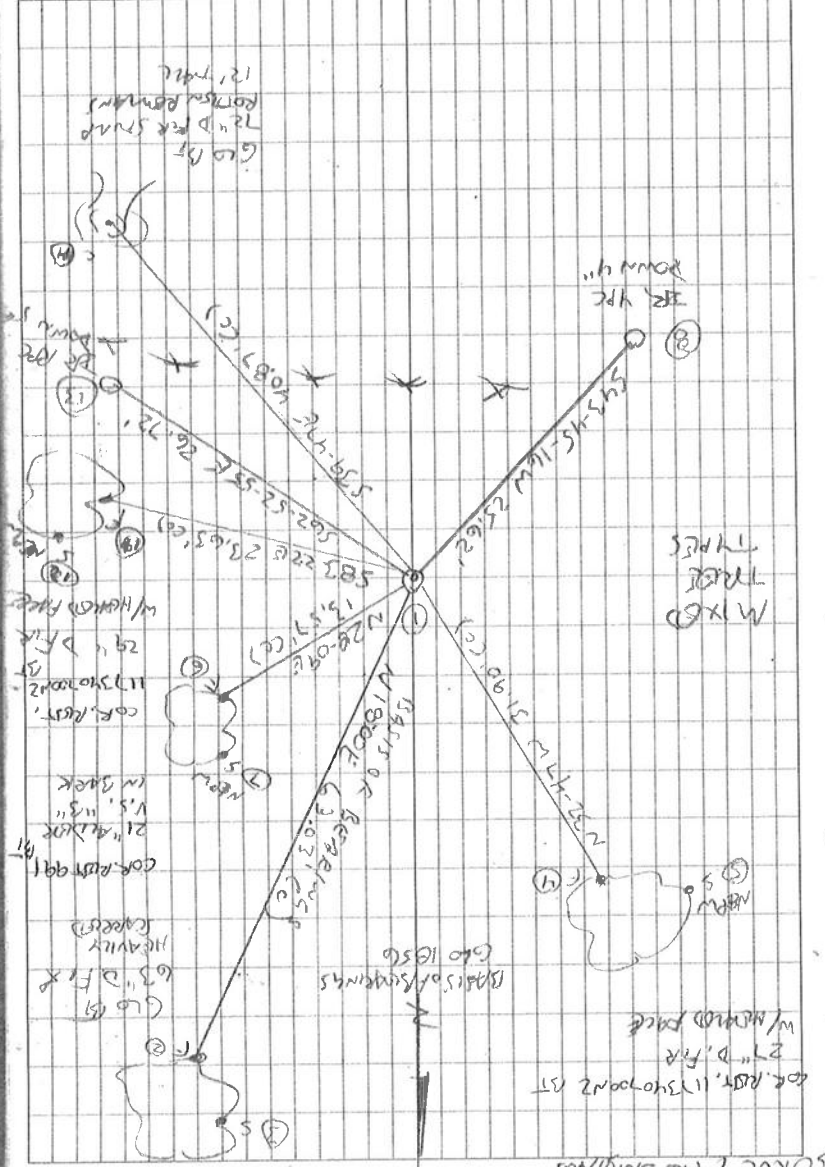

3/17/2017  
 D. MATHIAS  
 B. A. REYNOLDS  
 SURVEY PRODIGERS  
 NIKON NIVOS  
 CODE, RAIN SITES

3/1/32



#1  
 BR = 5/8" x 30" BEAM ROD  
 YPC OR RBC = YELLOW OR RED  
 PLASTIC CAP MARKED  
 "BENTON COUNTY SURVEYOR"  
 N & P U = NAIL & PLASTIC WAFER  
 MARKED "SURVEY MARKER"  
 DO NOT REMOVE

17340700  
 REFERENCE THIS RTW N 1/4 SECTION 4  
 FD 3-3/4" ALUMINUM CAP ON 1/2" ALUMINUM PIPE  
 FRAME SET, UNDERGROUND FOR THE CORNER, FD  
 4" x 4" x 4.5" WHITE PAINTED CORNER POST FOR  
 1' SOUTHWEST. FD NE GO BT AND HEAD FOR  
 BASIS OF BEARINGS, FD NE BT COR. REST, 991.  
 NW BT PER COR REST 991 (ONE). FD NE BT STUMP  
 AT RECORD REMAIN & DISTANCE PER COR REST, 986.  
 FORTEN AND LEARNING NW DOWNHILL, DID NOT TRS.  
 FD NW & SEE BT PER COR. REST, 117340700Z,  
 FD SE GO BT TRAIL STUMP, SET 2 NEW IRON ROD  
 ACCESSORIES, SET 6 OPPOSITE CORNER THE "SURVEY  
 ALUMINUM CAP  
 MARKER" POST 1' NORTH OF ~~MARKER~~ (7)  
 WHITE FINGERGLASS POST 1/4" ON GROUND, SET  
 1' EAST OF ~~MARKER~~ DISK  
 ALUMINUM CAP

CODE, RAIN SITES  
 3/17/2017  
 D. MATHIAS  
 B. A. REYNOLDS  
 SURVEY PRODIGERS  
 NIKON NIVOS  
 CODE, RAIN SITES

BENTON COUNTY  
CORNER RESTORATION FORM

117340700N2

SECTION 4 TOWNSHIP 11S RANGE 2W W.M. BLM ID -----

DLC ----- CORNER ONE QUARTER

DATE 6/28/94 CORNER RESTORATION FIELD BOOK --- PAGE ---

ORIGINAL:

POST, NOW MISSING  
36" BURNT FIR N18°E 95 LKS, NOW 63" LIVE FIR N 18°E 61.41' TO  
FACE OF TREE.  
24" BURNT FIR S40°E 57 LKS., NOW STUMP S40°E 38.03' TO CENTER.

RESTORATION: COUNTY RESTORATION #986

SET 1/2" PIPE; FOUND IN PLACE.  
36" FIR N18°E 95 LKS.  
48" BURNT FIR S40°E 55 LKS.  
16" FIR STUMP N25°E 12 LKS; NOW A ROTTEN STUMP.

REWITNESSED: COUNTY RESTORATION #991

10" ALDER S69°W 23.3'; FOUND IN PLACE.  
15" ALDER N27°E 13.0'; FOUND IN PLACE.

RESTORATION:

SET 1 1/2" X 36" ALUMINUM PIPE WITH 3 1/4" CAP, MARKED AS ABOVE.  
OVER 1/2" PIPE, 28" IN GROUND AND FROM WHICH A:

19" FIR N30°W 30.23', TO A WASHER MARKED RS2016 AND NAILED INTO  
BOTTOM OF FACE SCRIBED "X BT".  
17" FIR S79°E 22.93', TO A WASHER MARKED RS2016 AND NAILED INTO  
BOTTOM OF FACE SCRIBED "1/4 S4 BT".

63" FIR  
N18°E 61.41'  
SET 4"X4"X72" WHITE PAINTED CEDAR POST 1.0' S.W.  
YELLOW METAL LOCATION PLAQUE NAILED TO N.W. B.T..

NOTE: BEARINGS WERE OBSERVED WITH HAND COMPASS AND DISTANCES  
WERE MEASURED WITH STEEL TAPE.

MONUMENT DETAIL

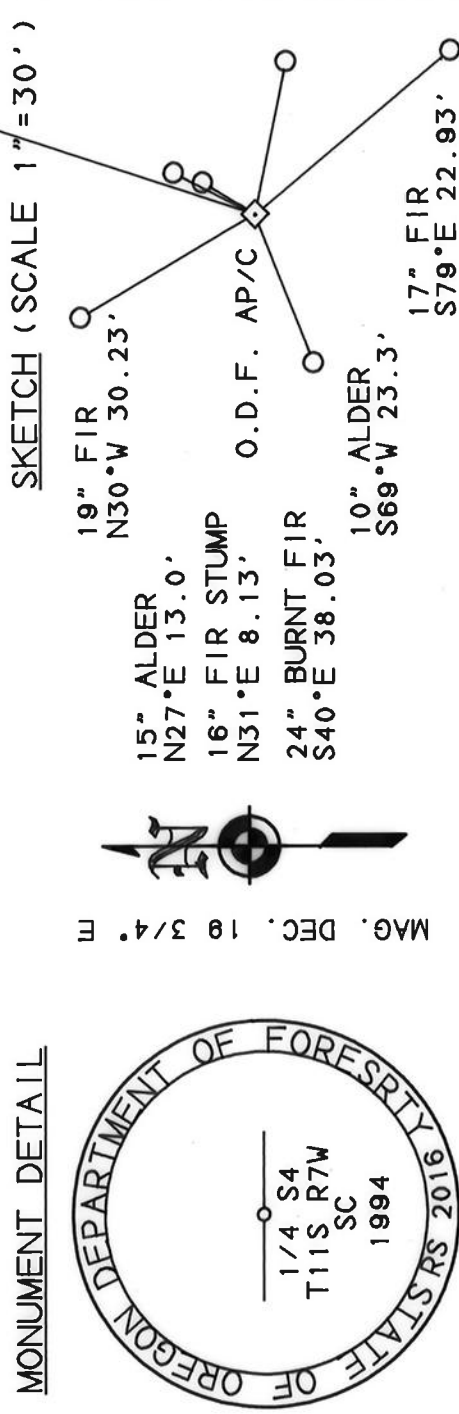

NOTES:

WITNESS:  
CHRIS J. HUMCKE  
FIRM/AGENCY:  
OREGON DEPARTMENT OF FORESTRY  
24533 ALSEA HIGHWAY  
PHILOMATH, OREGON 97370

REGISTERED  
PROFESSIONAL  
LAND SURVEYOR

*Mark E. Steele*

OREGON  
JULY 16, 1982  
MARK E. STEELE  
2016

EXPIRES 12-31-94



*Acids made*  
SEE COR. REST. MD.  
991 CCJL 7/16/90)  
117340700

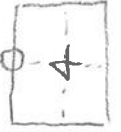

RESTORED CORNER FOR OREGON STATE DEPT. OF FORESTRY

Standard ¼ Corner common to Section 4,  
T11S, R7W, W. M., Benton County, Oregon.

ORIGINAL

Post (missing) from which a:

- 24" Burnt Fir bears S40°E 57 lks.; now 34" rotted stump S40°E 37.6', against a 50" rotted snag on NW edge of flat in corner of logging.
- 36" Burnt Fir bears N18°E 95 lks.; now 60" Green Fir N17°E 63.7' to center, badly scarred.

RESTORATION BY W.C. Galloway C.S. 1915

Set ½" iron pipe (now in place) from which a:

- 24" Burnt Fir bears S40°E 57 lks.; 48" in place (1915).
- 36" Burnt Fir bears N18°E 95 lks.; in place (1915).
- 16" Fir Stump bears N25°E 12 lks.; now 16" rotted stump N32°E 8.2'.

REWITNESSED

- 10" Alder bears S69°W 23.3 ft. to face; scribed in bark, SC ¼ S4 BT RS 563.
  - 15" Alder bears N27°E 13.0 ft. to face; scribed S33 BT, in bark.
- Set a white fiber glass fence post 1.0 ft. NE of corner pipe.  
Oregon State Forestry Department metal location poster on SW Alder Bt.  
Corner is on steep hillside aspect NW.

Dated: December 5, 1980

*William M. Bonsanti*

Restored by William M. Bonsanti, Transitman under my direction.

REGISTERED  
PROFESSIONAL  
LAND SURVEYOR

*W. E. Green*

OREGON  
JANUARY 12, 1962  
WILJO E. GREEN  
563

Present and witnessed by William E. Seeley.



BENTON COUNTY SURVEYORS OFFICE - CORNER RESTORATION 991 107

T 11 S, R 1 W, W. B. & M., BENTON COUNTY, OREGON  
 SECTION 4

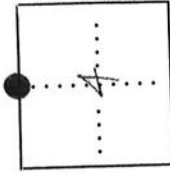

● OFFICIAL CORNER FOUND

○ CORNER SET

1/4 CORNER COMMON TO SEC. \_\_\_\_\_ & \_\_\_\_\_  
 IS white fiber glass fence post  
DESCRIBE

ADDITIONAL INFORMATION

Fence post 1.0 ft. NE of  
corner pipe.  
ADDITIONAL INFORMATION IS IN THE T11S  
R7W FILE IN THE CORNER RESTORATION  
CORRESPONDENCE FILE DRAWER (CJL7/18/90)

OVER

REPORTED BY Wiljo E. Green  
 TITLE Surveyor 563  
 DATE December 5, 1980

LEGIBLE MARKS ON BEARING OBJECTS

scribed: SC 1/4 S4 BT RS 563	scribed: S33 BT
KIND <u>Alder</u>	<u>Alder</u>
SIZE <u>10"</u>	<u>15"</u>
BEARING <u>S69°0'N 27°E</u>	
DISTANCE <u>23.3'</u>	<u>13.0'</u>
BT TAG POSTED	

## CORNER RESTORATION BOOK NO. 1

S.S. 172

1/4 cor. on n. side of sec. 14. Tp. 11-7.

Set 12" pipe

Fir 36" in dia, bears N. 18° E. 195' std.

Burnt fir. 48" " S. 40° E. 155' "

Witnesses E. Perry + F. W. Barnhard. 4/17/13

173

1/4 sec. cor. on S. side of sec. 31. Tp. <sup>13</sup> # 7.

Set 3/4" pipe Orig. cor. fir stump

Fir 9" in dia, bears N. 87° 45' E. 1,211'

Older 10" " N. 80° W. 2,18' std.

Witnesses R. C. Miller, J. W. Kingard. 5/15/13

173

Tp. cor. bet. Tps. 14-7 + 8 on 3<sup>rd</sup> std. parallel  
bet stone

Maple in dia, bears S. 10° 50' E.

Witnesses R. C. Miller, J. W. Kingard. 5/15/13

174

N.E. cor. of Henry Noble D. J. C. # 52. Sp 14-5.

Set 1 1/4" pipe + stone by it.

S.E. cor. of

Witnesses Clyde + W. F. Starr. 9/30/13

bears S. 89° 44' W. 5,347'

174

N.W. cor. of Henry Noble D. J. C. # 52. Tp 14-5

bet stone 6x6x8"

Oak 20" in dia, bears S. 35° 30' E. 1,655' std.

" 12" " " S. 52° W. 1,813'

Witnesses Clyde + W. F. Starr. 9/13

174

S.W. cor. of Henry Noble D. J. C. # 52 Tp. 14-5

Set 5/8" iron pin stump + stump hole, 1/2" x 30" Oak pipe 6-74"

Oak 10" in dia, bears N. 23° E. 1,574' <sup>64" x 1 hole D. J. C. # 204</sup>

24" " in dia, bears N. 13° 35' W. 3,511'

Witnesses Clyde + W. F. Starr 5/13

174

S.E. cor. of Thos. D. Pease DLC # 40. Sp 14-5.

Set 1 1/4" pipe Orig. cor. ash stump S. 71° W. 10,891'

Oak 11" in dia, bears S. 72° 30' E. 1,866'

" 5" " " N. 8° 30' W. 2,255' std.

Witnesses W. F. Starr, C. W. Elston. 5/23/13

174

N.E. cor. of John Loose D. J. C. # 53 Tp 14-5

Set 16" iron pin Orig. cor. Oak stump, check.

Oak 18" in dia, bears N. 7° 15' E. 4,449' std.

Oak 16" " " S. 41° E. 865'

Oak 15" " " S. 50° 30' W. 2,480'

Witnesses Clyde Starr + W. F. Starr. 5/24/13

BENTON COUNTY SURVEYORS OFFICE - CORNER RESTORATION

986

T. 11 S, R. 7 W, W. B. & M., BENTON COUNTY, OREGON

REPORTED BY W. C. Galloway

SECTION 4

TITLE Surveyor

The information shown hereon was taken from <sup>Cal</sup> the referenced county survey. Date: 7/25/90

DATE FEB 1915

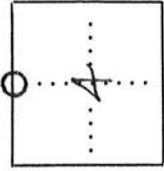

OFFICIAL CORNER FOUND

CORNER SET

1/4 CORNER COMMON TO SEC. 4 & 33  
IS 1/2" iron pipe  
DESCRIBE

ADDITIONAL INFORMATION

See C.S. 1710

LEGIBLE MARKS ON BEARING OBJECTS

KIND	Burnt Fir	Burnt Fir	rotted Stump
SIZE	48"	36"	16"
BEARING	S 40° E	N 18° E	N 32° E
DISTANCE	57 1/2 Ks.	95 1/2 Ks.	8.2'
BT TAG POSTED			

OVER