

## CORNER FILE TRACKING

H:\Survey\Corners\Misc\Filetrac.doc

11/23/98

<b>CORNER NUMBER</b>
<b>117440500</b>

<b>STEP</b>	<b>HISTORY()</b>	<b>RESTORATION()</b>
Form Prepared, DB	6/17/05	6/23/05
Field Inspection, DB	6/21/05	6/21/05
Form Checked, DB	7/13/05	7/13/05
Form Edited, DB	7/13/05	7/13/05
Form Signed, DB	7/13/05	7/13/05
Counter Index	6/24/05	6/24/05
GIS Index	6/24/05	6/24/05
Authorize Payment, DB	—	—
Archive Digital Files		
Collect Documents	7/14/05	7/14/05
Scanned	7/15/05	7/15/05
Copy For Filming	7/14/05	7/14/05
Filed, DB		
Finish index (count unit)	6/21/05	6/21/05
Filmed (Archived), DB		

(DB) = Entry needed in database (Access).

### COMMENTS:

DATE 06/17/2005

TOWNSHIP 11 SOUTH, RANGE 7 WEST, WILLAMETTE MERIDIAN; SECTION 10 CORNER S 1/4  
 DONATION LAND CLAIM NONE CORNER N/A

**COMMON CORNER(S):**

NORTH 1/4 SECTION 15

**RECORDS (INFORMATION IN *BOLD ITALICS* IS COUNTY STAFFS' INTERPRETATION OF THE RECORD)**

BASED ON EXTENSIVE RESEARCH AND RECOVERY OF EVIDENCE, THIS OFFICE HAS DETERMINED THAT MOST GENERAL LAND OFFICE SURVEYORS MEASURED TO THE FACE OF BEARING TREES.

- [01] GENERAL LAND OFFICE (GLO) NOTES BY HARVEY GORDON D. S., DATED MAY 14, 1855. *SET 1/4 SECTION POST FROM WHICH A FIR 12" DIA. BEARS N25°W, 77 LKS (50.82 FEET), A FIR 6" DIA. BEARS S64°E, 390 LKS (257.40 FEET).*
- [02] BENTON COUNTY SURVEY NO. 598 (OLD NO. 258) FIELD NOTES (FIELD BOOK NO. 22 PG 76-77) BY W. C. GALLOWAY C. S., DATED JUNE 12, 1917. *SET 3/4" X 28" BOLT, FIR 18" DIA. BEARS N62°E AT A SLOPE OF 6°45' WITH A DISTANCE OF 1.157 CHS (76.36 FEET), FIR (GLO) 12" DIA. BEARS N25°W, .77 CHS (50.82 FEET) STANDING AND REMARKED. S.E. GLO FIR GONE.*
- [03] BENTON COUNTY CORNER RESTORATION BOOK NO. 1 PAGE 124 BY W. C. GALLOWAY D. S., DATED JUNE 12-13 1917. *1/4 SEC 10 AND 15, SET 3/4" X 28" BOLT S.E. GLO FIR GONE, FIR 18" DIA. BEARS N62°E, 1.149 CHS (75.83 FEET) FIR (GLO) 12" DIA. BEARS N25°W, .77 LKS (50.82 FEET).*
- [04] BENTON COUNTY CORNER RESTORATION NO. 1026 DATED JUNE 13, 1917. *THIS IS TRANSCRIBED FROM RECORD NO [03] AND MAY CONTAIN ERRORS AND OR OMISSIONS.*
- [05] BENTON COUNTY MAP NO. 11-7-00005 BY BENTON COUNTY SURVEYORS OFFICE, NO DATE GIVEN. *3/4" BOLT FIR 18" DIA. BEARS N62°E, 1.149 CHS (75.83 FEET) FIR (GLO) 12" DIA. BEARS N25°W, .77 CHS (50.82 FEET)*
- [06] SURVEY FROM CORRESPONDENCE FILE 11-7 BY HOWARD E. TAYLOR P. E., DATED MARCH 1958. *FOUND GALLOWAY'S 3/4" BOLT, SET PIECE OF RAILROAD RAIL ON NORTH EDGE OF IT. ALL PREVIOUS BTS ROTTED STUMPS, SCRIBED 20" FIR N47°W 175 FEET DROVE R.R. SPIKE BENEATH SCRIBE "1/4s10bt", 12" FIR S48°30'W, 90 FEET, DROVE BRIDGE SPIKE BENEATH SCRIBE "1/4s15bt", THIS CORNER IS ABOUT 50 FEET EAST OF OLD FENCE CORNER.*
- [07] BENTON COUNTY CORNER RESTORATION NO. 1026 BY HOWARD E. TAYLOR DATED MARCH 1958. *THIS IS TRANSCRIBED FROM RECORD NO. [06] AND MAY CONTAIN ERRORS AND/OR OMISSIONS.*
- [08] BENTON COUNTY SURVEY NO. 8890 BY JIM S. PETERSON P. L. S., DATED OCTOBER 24, 1994. *1/4" CORNER OF SECTIONS 10 AND 15, FOUND 3/4" IRON BOLT PER GALLOWAY HARDCOPY 11-7-00005*  
*BT'S FOUND:*  
*34" FIR STUMP, N47°W, 175.2 FEET (TAYLOR BT) AXE MARKS VISIBLE*  
*24" ROTTED FIR STUMP N62°E, 1.149 CHS (75.83 FEET) C.S.B.T., NO MARKS VISIBLE*  
*40" ROTTED FIR STUMP N25°W, .77 CHS (50.82 FEET) GLO BT, NO MARKS VISIBLE*  
*BT'S SET:*  
*18" FIR, N68°E, 29.8 FEET MARKED "1/4s10bt"*  
*6" ALDER S04°E, 26.7 FEET MARKED "1/4s15bt" (IN BARK)*  
*CORNER LIES ON A BENCH, 30 FEET SOUTH OF TOE OF A SLOPE, AND 200' SOUTH OF GRAVEL ROAD.*

**COMMENTS/LOCATION/ETC:****NOTES:**

THIS IS A MICROSOFT WORD 2000 DOCUMENT NAMED "17440500" CREATED FROM A BOILER PLATE DOCUMENT NAMED "HISTORY", WHICH HAS A STYLESHEET NAMED "CORNER" ATTACHED TO IT.

**FIRM/AGENCY:** BENTON COUNTY SURVEYOR'S OFFICE  
**ADDRESS:** 360 S.W. AVERY AVE. CORVALLIS OR 97333; PH. 766-6821  
**RESEARCH BY:** DAVID M. DEAN, P.L.S.  
**DATA ENTRY BY:** ADAM CASALEGNO, SURVEY TECH.

**D. FIR AND HARDWOODS**

**D. FIR AND HARDWOODS**

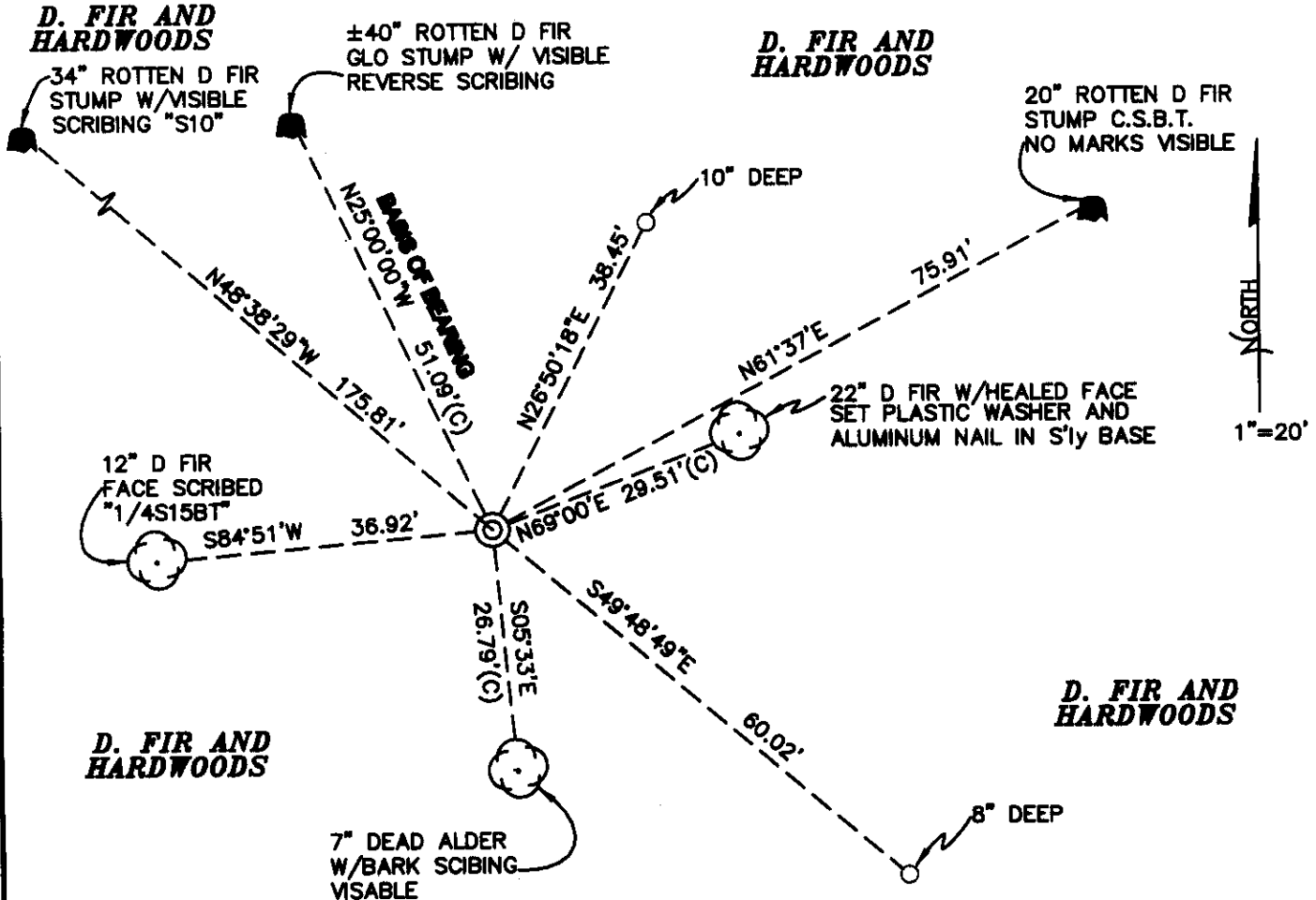

**D. FIR AND HARDWOODS**

**D. FIR AND HARDWOODS**

**MONUMENT DETAIL**

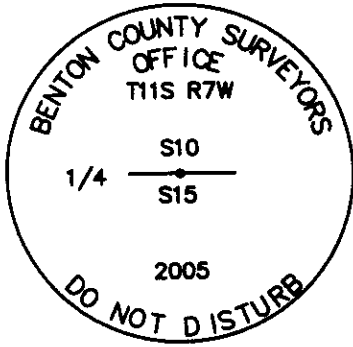

**3 1/4" BRASS DISK**

**LEGEND**

- SET 5/8" X 30" REBAR WITH YELLOW PLASTIC CAP MKD "BENTON COUNTY SURVEYOR"
- (F) MEASUREMENT TO FACE
- (C) MEASUREMENT TO CENTER
- ⊙ GOVERNMENT MONUMENT SET AS SHOWN
- ⊙ BEARING TREE AS NOTED
- C.S.B.T. COUNTY SURVEYORS BEARING TREE
- GLO GENERAL LAND OFFICE

**NEW ACCESSORIES:**

1. SET REBAR (SEE LEGEND) N26°50'E, 38.45 FEET, 10" BELOW GROUND LEVEL
2. SET REBAR (SEE LEGEND) S49°48'49"E, 60.02 FEET, 8" BELOW GROUND LEVEL
3. FACE SCRIBED 12" D FIR "1/4S15BT" S84°51'W, 36.92 FEET. SET PLASTIC WASHER AND ALUMINUM NAIL IN BOTTOM OF FACE FOR DISTANCE AND ANGLE MEASUREMENT.

**NOTES:**

COMPASS DECLINATION IS 20° EAST. ALL MEASURED DISTANCES AND BEARINGS ARE TO THE CENTER OF THE OBJECT, UNLESS OTHERWISE NOTED. ALL BEARING TREES ARE PAINTED AND HAVE A B.T. TAG ATTACHED, FACING THE CORNER UNLESS OTHERWISE NOTED. ALL NEW BEARING TREES HAVE A PLASTIC WASHER (STAMPED "BENTON COUNTY SURVEYOR CORNER RESTORATION") ATTACHED (BY ALUMINUM NAIL) TO THE FACE, BELOW THE "BT" FOR DISTANCE AND ANGLE MEASUREMENT UNLESS OTHERWISE NOTED. THE DRAWING IS FROM AUTOCAD RELEASE 2002.

THIS RESTORATION WAS PERFORMED AT THE DIRECTION AND APPROVAL OF THE BENTON COUNTY SURVEYOR, RW

REGISTERED PROFESSIONAL LAND SURVEYOR

7/13/05 David M. Dean

OREGON  
JULY 13, 1984  
DAVID M. DEAN  
2090

**FIRM/AGENCY:** BENTON COUNTY SURVEYOR'S OFFICE.  
**ADDRESS:** 360 S.W. AVERY AVE. CORVALLIS OR 97333; PH. 766-8821.  
**PRESENT:** DAVID M. DEAN, P.L.S., ADAM CASALEGNO AND WILLIAM KELLEY SURVEY TECHNICIANS.  
**EQUIPMENT:** LEICA TCR 1105 W/TDS ON BOARD.

RENEWAL DATE: 12/31/05

**BENTON COUNTY CORNER RESTORATION FORM, PAGE 1 OF 2, 117440500R2****SEE CORNER HISTORY FORM FOR RECORDS ETC.**

CORNER RESTORATION FIELD BOOK NUMBER 23 PAGE(S) 34 DATE 06/21/2005  
TOWNSHIP 11 SOUTH, RANGE 7 WEST, WILLAMETTE MERIDIAN; SECTION 10 CORNER S 1/4  
DONATION LAND CLAIM NONE CORNER N/A  
CONDITION REPORT     ; REFERENCED OUT     ; RENEWED X; SURVEYED IN     

**LOCATION AND COMMENTS:**

CORNER IS LOCATED AT THE TOE OF A SOUTH FACING SLOPE IN SWAMPY AREA. TO REACH THE CORNER FROM THE JUNCTION OF NORTON CREEK ROAD AND US HIGHWAY 20, DRIVE NORTHERLY ON NORTON CREEK RD FOR 1.97 MILES; THEN LEFT ON PRIVATE STARKER FOREST ROAD FOR 0.63 MILES TO LOCATION TAG ON A 33° D. FIR ON THE SOUTH SIDE OF ROAD; THEN WALK S50°W, ABOUT 200 FEET TO CORNER. CORNER IS POOR FOR PREMARKING AND GPS CONTROL.

**MONUMENTS AND ACCESSORIES FOUND (CONDITION AND SOURCE):**

1. FOUND 1 1/2" SQUARE BOLT 24" LONG 1" BELOW GROUND SURFACE FOR CORNER POSITION.  
(SET 1/4 SECTION POST PER RECORD [01])  
(SET 3/4" X 28" BOLT PER RECORD [02] - [04]).  
(3/4" BOLT PER RECORD [05]).  
(FOUND GALLOWAYS 3/4" BOLT PER RECORD [06])  
(FOUND 3/4" IRON BOLT PER RECORD [08]).
2. FOUND RAILROAD RAIL LAYING HORIZONTALLY ON GROUND SURFACE NORTH 1 FOOT FROM CORNER.  
(SET PIECE OF RAILROAD IRON ON NORTH EDGE OF CORNER PER RECORD [06]).
3. FOUND 40" ROTTEN D. FIR STUMP GLO BEARING TREE, N25°W, 51.09 FEET TO CENTER. **BASIS OF BEARING FOR THIS RESTORATION**  
(FIR 12" DIA. BEARS N25°W, 50.82 FEET PER RECORD [01]).  
(FIR 12" DIA. BEARS N25°W, 50.82 FEET PER RECORDS [02] - [05]).  
(40" ROTTED D. FIR STUMP BEARS N25°W, 50.82 FEET PER RECORD [08])
4. FOUND 20" ROTTEN D. FIR STUMP C.S.B.T. N61°37'E, 75.91 FEET TO CENTER.  
(FIR 18" DIA. BEARS N62°E, 75.83 FEET PER RECORD [02]-[05]).  
(24" ROTTED FIR STUMP N62°E, 75.83 FEET NO MARKS PER RECORD [08]).
5. FOUND 34" ROTTEN D. FIR STUMP WITH VISIBLE SCRIBING "S10", RAILROAD SPIKE DRIVEN BEANAETH SCRIBING N48°38'29"W, 175.81 FEET TO CENTER.  
(SCRIBED 20" D. FIR N47°W, 175 FEET DROVE RAILROAD SPIKE BENEATH SCRIBE "1/4S10BT" PER RECORD [06]).  
(FOUND 34" FIR STUMP, N47°W, 175.2 FEET AXE MARKS VISIBLE PER RECORD [08]).
6. FOUND 22" D. FIR WITH HEALED FACE N69°00'E, 29.51 FEET TO CENTER. SET ALUMINUM NAIL AND PLASTIC WASHER IN SOUTHERLY BASE FOR DISTANCE MEASUREMENT.  
(MARKED 18" D. FIR N68°E, 29.80 FEET SCRIBED "1/4S10BT" PER RECORD [08]).
7. FOUND 7" DEAD ALDER WITH BARK SCRIBING VISIBLE S05°33'E, 26.79 FEET TO CENTER.  
(6" ALDER S04°E, 26.70 FEET MARKED "1/4S15BT (IN BARK) PER RECORD [08]).

**MONUMENT SET (PROCEDURES AND DESCRIPTION):**

THE 1/2" SQUARE X 24" LONG BOLT FITS WELL WITH GLO AND COUNTY SURVEYOR'S BEARING TREE. HELD CENTER OF BOLT FOR TRUE CORNER POSITION. REMOVED THE BOLT AND SET A 2" X 31 1/2" GALVANIZED IRON PIPE WITH A 3 1/4" BRASS DISK CONCRETED IN THE TOP, MARKED AS SHOWN ON PAGE 2 OF 2. BURIED BOLT AND THE 3" X 20" RAILROAD IRON IN HORIZONTAL POSITION, 2 FEET EAST OF NEW MONUMENT AND 6" DEEP. SET AN ORANGE CARSONITE "SURVEY MARKER" 0.5 FEET WEST OF NEW MONUMENT

6/21/05 23/34  
 A. CASALEGNO  
 B. KELLEY  
 OLDY, MCD  
 65° F, 29.8° K  
 LEICA TCR 1105/T05

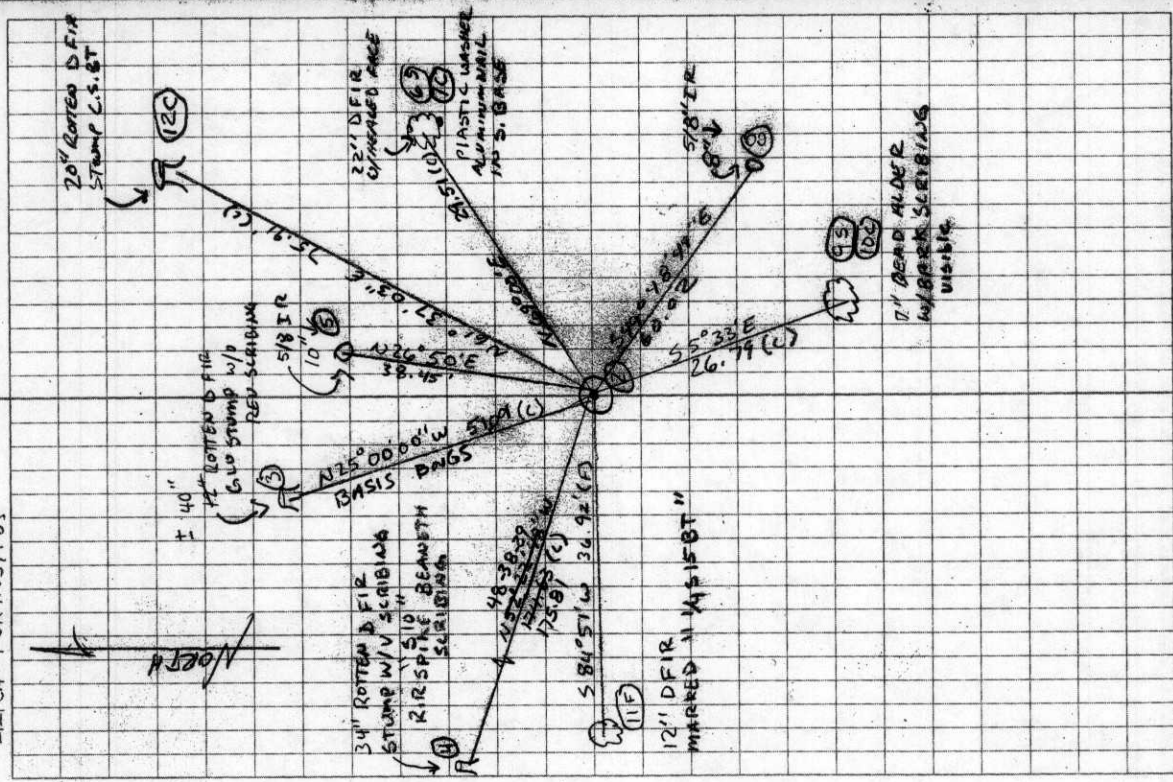

11740500  
 REMONUMENTING 1/4 10 15 T115 R7W  
 FOUND 1/2 SQUARE X 24" BOLT 1" BELOW GROUND  
 SURFACE WITH A 3" X 20" ANGLE BAR BESIDE LAYING  
 HORIZONTALLY. REMOVED AND SET 2" X 3 1/2" G.I.P.  
 W/ 3/4" B.C. BURIED BOLT AND IRON 2' EAST  
 6" DEEP HORIZONTALLY, SET A ORANGE CARBONITE  
 "SURVEY MARKER" POST 6" WEST OF DEW MON.  
 MONUMENT IS 4" DEEP IN SWAMPY AREA.  
 PUT LOCATION TAG ON 30" D.F. FIR.  
 USPOE, 200 FT FROM DEN. MEN.  
 Fd NW (SEC 10) GLO BT - NOW ROTTEN STUMP  
 w/ VISIBLE BACKCAST SCRIBING "BT"  
 Fd CS BT - Now ± 20" ROTTEN D.F. STUMP  
 w/-LOWER HEADED BLAZE  
 Fd CS BT - now 34" ROTTEN D.F. FIR  
 STUMP w/ U.S. "S 10"  
 Fd CS BTs - 7 DEAD ALDER w/ VISIBLE  
 BARK SCRIBING ± 22" D.F. FIR w/ MOSTLY  
 HEADED FACE ± U.S.  
 T115 R7W  
 14 510  
 515  
 2005  
 3 1/4" BRASS DISK

C.S. #257  
 witness  
 Frank Bump  
 May 25, 1917

S.W. cor. corner P. Newton Cl. #44 T12 S R 6 W.  
 Set pt. bottle <sup>1/2</sup> in. No trees but cut from 2 fences and 2000.  
 3/4" pipe North 1.75 chs.  
 Oak 15" in dia. bears North 1.987 chs.  
 1" pipe N. 3.015 chs.

CS 259

C.S. #258  
 W.C. Galt  
 Witnesses:-  
 Hiram Parker  
 Fred Welling  
 June 12-13, 1917

Cor. to secs. 10, 11, 14 + 15 T 11 S. R. 7 W.  
 Set 1" x 24" iron rod. Fir stump N. 7° W. 26 letters on.  
 Fir stump N. 31° E. 1.15 chs.  
 " 14" in dia. bears N. 71° 30' E. .300 chs.  
 Maple 16" " " " S. 29° E. .600 chs.  
 Fir 24" " " " S. 7° 20' E. 3.35 " std.  
 " 11" " " " S. 35° W. .433 "  
 " 26" " " " N. 49° W. .150 "

CS #88.

1/4 sec. cor. bet. secs. 10 + 11, T 11 S. R. 7 W.  
 Set 1" x 30" iron rod. Fir 30" S 89 1/2° E. 2.10 chs. stump.  
 Fir 40" N. 60° W. 1.71 chs. burned dirt + hole + wood.  
 Fir 24" in dia. bears S 89° 15' E. 1.250 chs.  
 " 36" " " " S. 19° W. 1.280 "

1/4 sec. cor. bet. secs. 10 + 15 T 11 S R 7 W.  
 Set 3/4" x 25" bolt S.E. fir gone.  
 Fir 15" in dia. bears N. 62° E. 1.149 chs.  
 " 12" " " " N. 25° W. .77 " std.

not charged  
 C.S. #259

Witnesses  
 R.L. Glass  
 John Hyde

Cor. to secs. 7, 8, 17 + 18, T 11 S. R. 6 W.  
 Set pt. bottle, also stake. S.E. maple checks, dead. S.W. oak checks, dead.  
 Oak 15" in dia. bears N. 63° E. .75 chs. std.  
 Fir 10" " " " S. 71° 15' E. .550 chs.  
 Maple 7" " " " S. 36° W. .555 "  
 " 18" " " " N. 53° W. .130 "

not charged  
 yet Nov 8, 17.

1/4 sec. cor. bet. secs. 7, 15 T 11 S. R. 6 W.  
 Set yew stake 4" x 5" x 40" Found 2 old stakes, one rotten.  
 W. Fir 27" in dia. bears N. 61° E. .158 chs.  
 W. " 5" " " " S. 21° E. .362 "  
 Maple 6" " " " S. 20° E. .21 " remarked 1/4 S. B. T.  
 Dogwood sprouts N. 60° W. .35 chs.

C.S. 259

1/4 Sec. corner between secs. 6 + 7 T 11 S R 5 W.  
 Set a 3/4" pipe 33" long + yew stake near Dogwood down check.  
 W. Fir 22" in dia. bears N. 54° E. .101 chs.  
 Rankd. Yew 12" " " N. 20° W. .45 " standing.

Aug. 13, 1917.

1/4 Sec. cor. between secs. 7 + 12 T 11 S R. 5 + 6 W.  
 Set a stone 18" x 12" x 10" + a stone 24" x 30" x 8" bears N 8° E. .612  
 Fir 10" in dia. bears N. 65° E. .45 chs. std.  
 Maple 12" " " N. 61° W. 1.25 " "

Aug. 14, 1917.

117440500

$\frac{1}{4}$ -Section corner between sections 10 and 15, Twp. 11 S., R. 7 W. 1026

Reestablishment by W. C. Galloway

June 13, 1917

Set  $\frac{3}{4}$ " x 28" bolt, S. E. fir gone

Fir 18" in diam bears N 62° E

1.149 chains

Fir 12" in diam bears N 25° W

.77 chains

Witnesses Hiram Parker, Fred Wetherford

-----  
Reestablishment by Howard E. Taylor

March, 1958

Set piece of R.R. rail on North edge of above  $\frac{3}{4}$ " bolt--about 50 ft. E. of old fence cor.

Fir 20" N 47 W 175.2 ft., R.R. spike below scribe

Fir 12" S 48 $\frac{1}{2}$  W 90.5 ft., bridge spike below scribe

All previous BT's rotted stumps.