

117440700

CORNER FILE TRACKING

S:\Survey Corners\CORNERS\Templates\Filetrac2.doc
10/04/2010

CORNER NUMBER
117440700

STEP	HISTORY	RESTORATION
Form Prepared, DB	9/7/17	11/27/18
Field Inspection, DB	11/26/18	11/26/18
Finish index (count unit)	9/7/17	11/26/18
Counter Index	11/27/18	11/27/18
GIS Index Form	11/27/18	11/27/18
Checked, DB	11/30/18	11/30/18
Form Edited, DB	11/30/18	11/30/18
Form Signed, DB	12/03/18	12/03/18
Authorize Payment, DB		
Archive Digital Files	12/03/18	12/03/18
Collect Documents	12/03/18	12/03/18
PDF File	12/03/18	12/03/18
Copy For Filming	12/03/18	12/03/18
Scanned (pdf to laserfiche)	12/03/18	12/03/18
Filmed (Archived), DB		
Filed, DB		

(DB) = Entry needed in database (Access).

COMMENTS:

DATE 09/07/2017TOWNSHIP 11 SOUTH, RANGE 7 WEST, WILLAMETTE MERIDIAN; SECTION 3 CORNER NORTH 1/4
DONATION LAND CLAIM N/A CORNER N/A**COMMON CORNER(S):**

POINT ON SOUTH LINE SECTION 34, TOWNSHIP 10 SOUTH, RANGE 7 WEST

RECORDS (INFORMATION IN BOLD ITALICS IS COUNTY STAFFS' INTERPRETATION OF THE RECORD)**BASED ON EXTENSIVE RESEARCH AND RECOVERY OF EVIDENCE, THIS OFFICE HAS DETERMINED THAT MOST GENERAL LAND OFFICE SURVEYORS IN BENTON COUNTY MEASURED TO THE FACE OF BEARING TREES.****[01]** GENERAL LAND OFFICE (GLO) NOTES BY DENNIS HATHORN, D.S., DATED APRIL 25, 1855. SET POST FROM WHICH A FIR 15" DIA BEARS ***N55°W, 10 LINKS (6.60 FEET)***; A FIR 12" DIA BEARS ***S18°W, 13 LINKS (8.58 FEET)***.**[02]** GENERAL LAND OFFICE (GLO) NOTES BY DENNIS HATHORN, D.S., DATED AUGUST 26, 1856. STANDARD 1/4 SECTION POST ON NORTH BOUNDARY SECTION 3. CORNER NOT DESCRIBED.**[03]** SURVEY NO. 38 FROM PAGE 47 OF THE RECORD BOOK OF SURVEYS BY ANDREW L. PORTER, C.S., DATED JULY 19, 1889. STANDARD 1/4 SECTION NORTH BOUNDARY SECTION 3. CORNER NOT DESCRIBED.**[04]** REESTABLISHMENT NOTES FROM PAGE 49 OF THE RECORD BOOK OF SURVEYS BY ANDREW L. PORTER, C.S., DATED JULY 20, 1889. STANDARD 1/4 SECTION NORTH BOUNDARY SECTION 3. CORNER NOT DESCRIBED.**[05]** LETTER FROM BRUCE STARKER, P.L.S., DATED JANUARY 21, 1955. ORIGINAL WITNESS TREES: NORTHWEST BEARING TREE A ROTTEN STUMP WITH "BT" SCRIBED ON PITCH SEAM; SOUTH BEARING TREE A ROTTEN STUMP. FIR 14" DIA BEARS ***S4°E, 31.9 FEET, MARKED "#310 SEC34 BT"***; FIR 11" DIA BEARS ***N60°E, 13.3 FEET, MARKED "#310 SEC3 BT"***.**[06]** BENTON COUNTY CORNER RESTORATION NO. 982. TRANSCRIBED FROM RECORD [05] AND MAY CONTAIN ERRORS AND/OR OMISSIONS.**[07]** BENTON COUNTY SURVEY NO. 6324 BY ARNOLD BRUBAKER, P.L.S., DATED MARCH 8, 1977. FOUND D. FIR 15" DIA (GLO BT) BEARS ***N55°W, 6.6 FEET, STUMP WITH VISIBLE SCRIBING***; D. FIR 12" DIA (GLO BT) BEARS ***S18°W, 8.58 FEET, GONE -- HOLE. SET 1-3/4" AXLE FOR 1/4 CORNER. FOUND D. FIR 16" DIA BEARS N62°E, 13.2 FEET, MARKED "S" AND BLAZED***; D. FIR 18" DIA BEARS ***S4°W, 31.4 FEET, MARKED "S" AND BLAZED***.**[08]** BENTON COUNTY CORNER RESTORATION NO. 4073 BY CURTIS J. LIESENFELT, P.L.S., DATED MAY 19, 1992. FOUND 1-3/4" AXLE FOR THE CORNER. FOUND A SHALLOW HOLE IN THE GROUND BEARS ***S10°W, 9 FEET. FOUND MOSTLY ROTTED REMAINS OF D. FIR STUMP 32" DIA (GLO BT) BEARS N55°45'W, 6.6 FEET TO CENTER, 6.0 FEET TO FACE, WITH THE SCRIBING "BT" AND THE NOTCH VISIBLE. FOUND D. FIR 25" DIA WITH A HEALED FACE BEARS N62°45'E, 13.25 FEET. SET A PK NAIL AND A BRASS WASHER STAMPED "BENTON COUNTY SURVEYOR" (BCBW) IN THE NORTHWESTERLY BASE. FOUND D. FIR 27" DIA WITH A HEALED FACE BEARS S6°45'W, 31.40 FEET. SET A PK NAIL AND BCBW IN THE WESTERLY BASE. USED THE RECOVERED AXLE FOR THE CORNER MONUMENT EVEN THOUGH FACE MEASUREMENTS FROM THE ORIGINAL BEARING TREES WOULD YIELD A POSITION APPROXIMATELY 1 FOOT EASTERLY FROM ITS PRESENT LOCATION. A D. FIR 8" DIA BEAR S45°30'E, 25.17 FEET, FACED AND SCRIBED "1/4 S3 BT"***. SET A PK NAIL AND BCBW IN THE SOUTHWESTERLY BASE. A D. FIR 24" DIA BEARS ***N72°15'W, 62.63 FEET, FACED AND SCRIBED "XBT"***. SET A PK NAIL AND BCBW IN THE SOUTHERLY BASE. FOUND WHITE WOODEN 4" X 4" POST 2.3 FEET WEST-NORTHWESTERLY. SET ORANGE FIBERGLASS "SURVEY STAKE" POST 1 FOOT SOUTHERLY.**FIRM/AGENCY:** BENTON COUNTY SURVEYOR'S OFFICE
ADDRESS: 360 S.W. AVERY AVE., CORVALLIS, OR 97333; PH. 541-766-6821
RESEARCH BY: DAVID L. MALONE, P.L.S.
DATA ENTRY BY: SAME

BENTON COUNTY CORNER RESTORATION FORM, PAGE 1 OF 2, 117440700R2
SEE CORNER HISTORY FORM FOR RECORDS ETC.

CORNER RESTORATION FIELD BOOK NUMBER 32 PAGE(S) 16 DATE 11/26/2018
TOWNSHIP 11 SOUTH, RANGE 7 WEST, WILLAMETTE MERIDIAN; SECTION 3 CORNER NORTH 1/4
DONATION LAND CLAIM N/A CORNER N/A
CONDITION REPORT ; REFERENCED OUT ; RENEWED X; SURVEYED IN ;

LOCATION AND COMMENTS:

CORNER IS LOCATED IN A FLAT AREA OF ±50 YEAR OLD D. FIR AND SALAL. TO REACH CORNER FROM THE INTERSECTION OF HOSKINS ROAD AND LUCKIAMUTE ROAD, TRAVEL WESTERLY ALONG HOSKINS ROAD FOR 3.89 MILES TO A GRAVEL TIMBER ROAD ON THE LEFT, TURN LEFT AND FOLLOW ROAD FOR 0.02 MILES TO A WYE, TAKE A RIGHT AND FOLLOW FOR 1.06 MILES TO A WYE, STAY LEFT AND FOLLOW FOR 0.17 MILES TO A WYE, STAY LEFT AND FOLLOW 0.16 MILES TO A TEE, TURN RIGHT AND FOLLOW FOR 0.17 MILES TO A WYE, TURN LEFT AND FOLLOW FOR 0.02 MILES TO A WYE, TURN LEFT AND FOLLOW FOR 0.54 MILES TO A WYE, STAY LEFT AND FOLLOW FOR 0.08 MILES TO A WYE, TURN LEFT AND FOLLOW FOR 0.16 MILES AND PARK BY A 5 FOOT TALL D. FIR STUMP ON THE RIGHT MARKED WITH A LOCATION TAG. WALK SOUTHERLY FOR ABOUT 90 FEET TO THE CORNER. CORNER IS BAD FOR PREMARKING AND GPS CONTROL.

MONUMENTS AND ACCESSORIES FOUND (CONDITION AND SOURCE):

1. FOUND 1-3/4" AXLE, FIRMLY SET AND UNDISTURBED, UP 2" ABOVE GROUND SURFACE FOR THE CORNER. (SET POST AS PER RECORD [01]).
(SET 1-3/4" AXLE AS PER RECORD [07]).
(FOUND 1-3/4" AXLE AS PER RECORD [08]).
2. FOUND D. FIR 30" DIA WITH HEALED FACE BEARS N72°15'W, 62.84 FEET TO CENTER. **BASIS OF BEARINGS FOR THIS RESTORATION.** FOUND PK NAIL AND BRASS WASHER MARKED "BENTON COUNTY SURVEYOR" (BCBW) IN THE SOUTHWESTERLY BASE FOR DISTANCE MEASUREMENT.
(D. FIR 24" DIA BEARS N72°15'W, 62.63 FEET, FACE AND SCRIBED "XBT" AS PER RECORD [08]).
3. FOUND ROTTEN REMAINS OF D. FIR STUMP WITH FACE EXPOSED AND VISIBLE SCRIBING "BT" AND A NOTCH BEARS N56°51'W, 5.98 FEET TO FACE.
(FIR 15" DIA BEARS N55°W, 10 LINKS [6.60 FEET] AS PER RECORD [01]).
(NORTHWEST BEARING TREE A ROTTEN STUMP WITH "BT" SCRIBED ON PITCH SEAM AS PER RECORD [05]).
(FOUND D. FIR 15" DIA BEARS N55°W, 6.6 FEET, STUMP WITH VISIBLE SCRIBING AS PER RECORD [07]).
(FOUND MOSTLY ROTTEN REMAINS OF D. FIR STUMP 32" DIA BEARS N55°45'W, 6.6 FEET TO CENTER, 6.0 FEET TO FACE, WITH THE SCRIBING "BT" AND THE NOTCH VISIBLE AS PER RECORD [08]).
4. FOUND D. FIR 33" DIA WITH HEALED FACE BEARS N59°21'E, 13.73 FEET TO CENTER. SET ALUMINUM NAIL AND PLASTIC WASHER IN THE NORTHWESTERLY BASE FOR DISTANCE MEASUREMENT.
(FIR 11" DIA BEARS N60°E, 13.3 FEET, MARKED "#310 SEC3 BT" AS PER RECORD [05]).
(FOUND D. FIR 16" DIA BEARS N62°E, 13.2 FEET, MARKED "S" AND BLAZED AS PER RECORD [07]).
(FOUND D. FIR 25" DIA WITH A HEALED FACE BEARS N62°45'E, 13.25 FEET AS PER RECORD [08]).
5. FOUND D. FIR SNAG 8" DIA WITH HEALED FACE BEARS S48°01'E, 25.22 FEET TO CENTER. FOUND PK NAIL AND BCBW IN THE SOUTHWESTERLY BASE FOR DISTANCE MEASUREMENT.
(D. FIR 8" DIA BEARS S45°30'E, 25.17 FEET, FACED AND SCRIBED "1/4 S3 BT" AS PER RECORD [08]).
6. FOUND D. FIR 32" DIA WITH HEALED FACE BEARS S2°45'W, 31.36 FEET TO CENTER. FOUND PK NAIL AND BCBW IN THE WESTERLY BASE FOR DISTANCE MEASUREMENT.
(FIR 14" DIA BEARS S4°E, 31.9 FEET, MARKED "#310 SEC34 BT" AS PER RECORD [05]).
(D. FIR 18" DIA BEARS S4°W, 31.4 FEET, MARKED "S" AND BLAZED AS PER RECORD [07]).
(FOUND D. FIR 27" DIA WITH A HEALED FACE BEARS S6°45'W, 31.40 FEET AS PER RECORD [08]).

MONUMENT SET (PROCEDURES AND DESCRIPTION):

FOUND 1-3/4" AXLE, FIRMLY SET AND UNDISTURBED, UP 2" ABOVE GROUND SURFACE FOR THE CORNER. THE AXLE WAS SET BY ARNOLD BRUBAKER, P.L.S., IN 1977, AS PER BENTON COUNTY SURVEY 6324 FROM A GENERAL LAND OFFICE (GLO) BEARING TREE STUMP AND A GLO BEARING TREE STUMP HOLE. BRUBAKER APPEARS TO HAVE MEASURED FROM THE CENTER OF THE GLO BEARING TREES INSTEAD OF THE FACE. USING FACE MEASUREMENTS FROM THE GLO BEARING TREES WOULD HAVE MADE A RELATIVELY SMALL CHANGE TO THE CORNER POSITION. IT WAS DECIDED DURING BENTON COUNTY CORNER RESTORATION 4073 BY CURTIS J. LIESENFELT, P.L.S., IN 1992, TO HOLD THE AXLE AS THE PERPETUATED CORNER POSITION. I AGREE THAT BRUBAKER MADE A GOOD FAITH EFFORT TO PROPERLY PERPETUATE THE ORIGINAL CORNER POSITION, AND THE AXLE HAS BEEN HELD EVER SINCE. THE AXLE IS ACCEPTED AS THE PERPETUATION OF THE ORIGINAL CORNER POSITION.

DROVE THE AXLE DOWN SEVERAL INCHES AND OVER THE AXLE IN THE SAME HORIZONTAL POSITION SET A 2" X 31-1/2" GALVANIZED IRON PIPE WITH A 3-1/4" BRASS DISK CEMENTED IN THE TOP, UP 3" ABOVE GROUND SURFACE, AND MARKED AS SHOWN ON PAGE 2 OF 2. SET TWO NEW IRON ROD ACCESSORIES AS SHOWN ON PAGE 2 OF 2. FOUND ORANGE FIBERGLASS "SURVEY STAKE" 1 FOOT SOUTH OF BRASS DISK. FOUND 4" X 4" WHITE PAINTED WOOD POST LYING ON GROUND NEAR THE BRASS DISK.

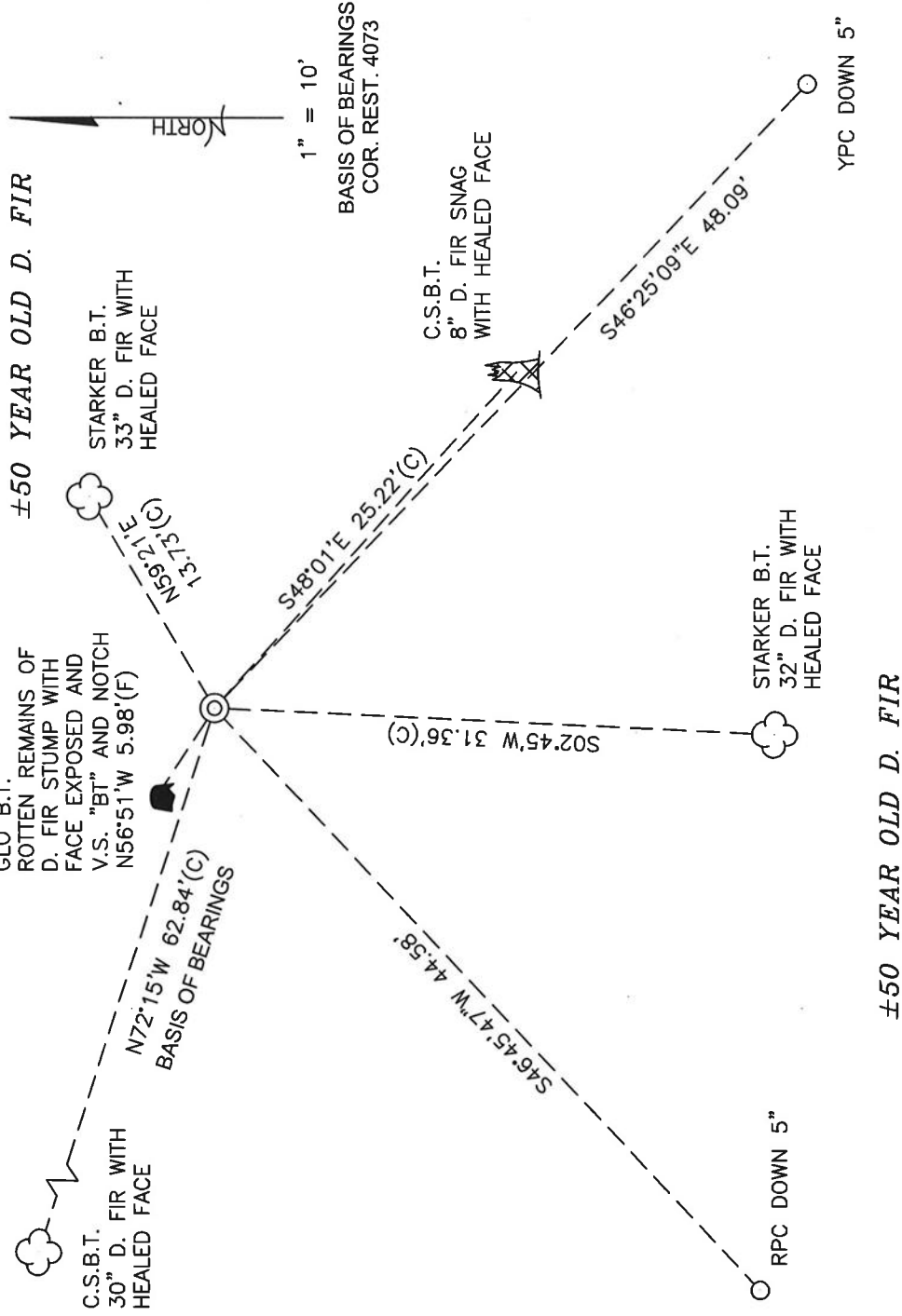

±50 YEAR OLD D. FIR

MONUMENT DETAIL

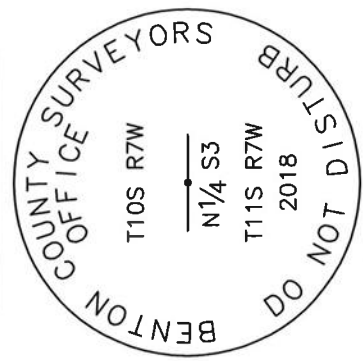

3-1/4" BRASS DISK

LEGEND

- YPC
 - RPC
 - (F) MEASUREMENT TO FACE
 - (C) MEASUREMENT TO CENTER
 - ◎ GOVERNMENT MONUMENT SET AS SHOWN
 - V.S. VISIBLE SCRIBING
 - COR. REST. CORNER RESTORATION
 - C.S.B.T. COUNTY SURVEYOR'S BEARING TREE
 - GLO GENERAL LAND OFFICE
 - B.T. BEARING TREE
 - ☐ BEARING TREE STUMP AS NOTED
 - ☐ BEARING TREE AS NOTED
 - ☐ BEARING TREE SNAG AS NOTED
- SET 5/8" X 30" REBAR WITH PLASTIC CAP
YELLOW PLASTIC CAP MARKED "BENTON COUNTY SURVEYOR"
- RED PLASTIC CAP MARKED "BENTON COUNTY SURVEYOR"
- MEASUREMENT TO FACE
- MEASUREMENT TO CENTER
- GOVERNMENT MONUMENT SET AS SHOWN
- VISIBLE SCRIBING
- COR. REST. CORNER RESTORATION
- C.S.B.T. COUNTY SURVEYOR'S BEARING TREE
- GLO GENERAL LAND OFFICE
- B.T. BEARING TREE
- BEARING TREE STUMP AS NOTED
- BEARING TREE AS NOTED
- BEARING TREE SNAG AS NOTED

NEW ACCESSORIES:

1. SET REBAR (SEE LEGEND) S46°25'09"E, 48.09 FEET AND 5 INCHES BELOW GROUND LEVEL.
2. SET REBAR (SEE LEGEND) S46°45'47"W, 44.58 FEET AND 5 INCHES BELOW GROUND LEVEL.

NOTES:

COMPASS DECLINATION IS 15' EAST. ALL MEASURED DISTANCES AND BEARINGS ARE TO THE CENTER OF THE OBJECT, UNLESS OTHERWISE NOTED. ALL BEARING TREES ARE PAINTED AND HAVE A B.T. TAG ATTACHED, FACING THE CORNER UNLESS OTHERWISE NOTED. ALL NEW BEARING TREES HAVE A PLASTIC WASHER (STAMPED "SURVEY MARKER DO NOT REMOVE") ATTACHED BY AN ALUMINUM NAIL TO THE SIDE CENTER OF THE TREE FOR DISTANCE MEASUREMENT, UNLESS OTHERWISE NOTED.

THIS RESTORATION WAS PERFORMED AT THE DIRECTION AND APPROVAL OF THE BENTON COUNTY SURVEYOR *Jen*

REGISTERED
PROFESSIONAL
LAND SURVEYOR

David L. Malone

OREGON
JANUARY 12, 1999
DAVID L. MALONE
51523

FIRM/AGENCY: BENTON COUNTY SURVEYOR'S OFFICE
ADDRESS: 360 S.W. AVERY AVE., CORVALLIS, OR 97333; PH. 541-766-6821
PRESENT: DAVID L. MALONE, P.L.S., AND BERNARD ALTENBACH, SURVEY TECH.
EQUIPMENT: NIKON NIV03.C WITH SURVEY PRO ONBOARD.

RENEWAL DATE: 12/31/18

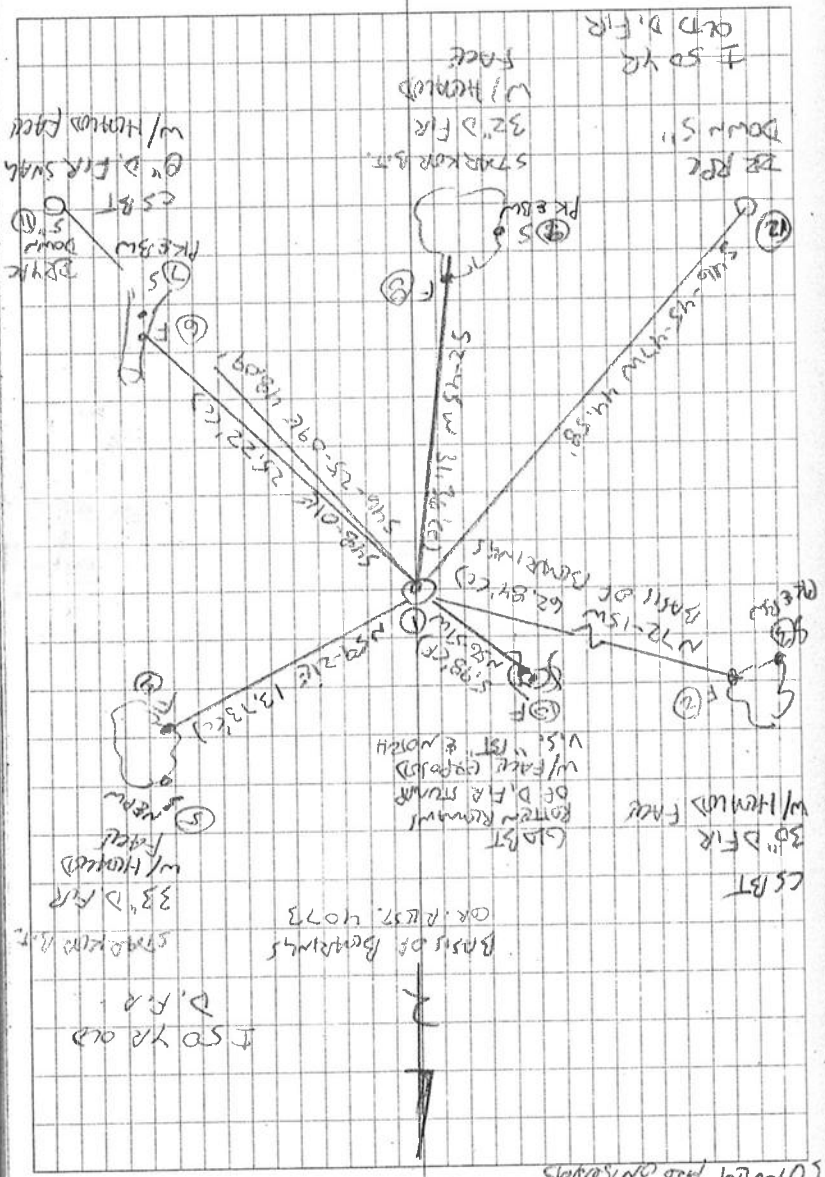

32/116

coln, overcast
11/26/18
D. MATHONE
B. ALTENBACH
N110°W 31°E
S110°W 30°E

REMOVEMENT T115 RW N1/4 S3
117446700

FD 1-3/4" AXLE UP 2" EMPTY SET & UNDISTURBED

FOR THE CORNER, FD 2 CSGT'S AND TRAB
NW CSET FOR BASIS OF BEARINGS PER
COR. RES. 4073, FD TWO BSTS PER 1955 STAKE

LETTER, FD REMAINS OF ONE GOR ST
FD 4"x4" WHITE POST LAYING ON GROUND BY
MONUMENT, FD ORANGE FIBROGLASS "SURVEY STAKE"

1 FOOT SOUTH OF MONUMENT, DRAVE AXLE DOWN
SEVERAL INCHES AND OVER IT IN THE SAME
HORIZONTAL POSITION SET 2"x31-1/2" G.I.P. W/
3-1/4" BRASS DISK CEMENTED IN THE TOP, UP 3"

AVOID GROUND SURFACE, SET 2 NEW IRON ROD
ACCESSORIES

PK BSW = PK NAIL & BRASS WASHOR
MARKED "MILTON COUNTY SUPERVISOR"
IR = 5/8" x 30" IRON ROD
YR OR RPE = YOUNG OF RPD
PLASTIC CAP MARKED
"MILTON COUNTY SUPERVISOR"
NAIL = NAIL & PLASTIC WASHOR
MARKED "SURVEY MARKER"
DO NOT REMOVE



3-1/4" BRASS DISK

BENTON COUNTY CORNER RESTORATION FORM

4073

117440700

TOWNSHIP 11 SOUTH, RANGE 7 WEST, WILLAMETTE MERIDIAN; SECTION 03 CORNER N 1/4
 DONATION LAND CLAIM
 DATE 5/19/92 CORNER RESTORATION FIELD BOOK NUMBER 12 PAGE(S) 30
 _____ CONDITION REPORT ONLY; XX REFERENCED OUT; _____ RENEWED; _____ SURVEYED IN

LOCATION AND COMMENTS:

THE CORNER IS LOCATED IN A FAIRLY LEVEL, BRUSHY AND HEAVILY WOODED AREA, 100 FEET SOUTHERLY FROM THE CENTERLINE OF STARKER FOREST ROAD NO. 1430, A GRAVEL ROAD 10 FEET WIDE.

PREVIOUS RENEWALS/SURVEYS, ETC.:

- [01] ORIGINAL GLO SURVEY BY DENNIS HATHORN DATED JULY 7, 1856.
- [02] ANDREW PORTER SURVEYS BY ANDREW PORTER DATED JULY 18-19, 1889.
- [03] CORNER RESTORATION NO. 982 BY BRUCE STARKER DATED JANUARY 21, 1955.
- [04] COUNTY SURVEY NO. 6324 BY ARNOLD BRUBAKER MARCH 8, 1977.

MONUMENTS AND ACCESSORIES FOUND (CONDITION AND SOURCE):

- FOUND: 1 3/4" AXLE FOR THE CORNER (1 3/4" AXLE AS PER [4]).
- FOUND: A SHALLOW HOLE IN THE GROUND, BEARS S 10° W 9 FEET (FIR 12" IN DIAMETER, S 18° W 8.58 FEET BELIEVED TO BE A FACE MEASUREMENT BY [1]), (HOLE, S 18° W 8.58 FEET AS PER [4]).
- FOUND: MOSTLY ROTTED REMAINS OF A DOUGLAS FIR STUMP 32" IN DIAMETER, WITH THE SCRIBING "BT" AND THE NOTCH VISIBLE, BEARS N 55° 45' W 6.6 FEET TO CENTER, 6.0 FEET TO FACE (15" DIAMETER, N 55° W 6.60 FEET BELIEVED TO BE FACE MEASUREMENT BY [01]), STUMP, N 55° W 6.6 FEET AS PER [04]). SET A B.T. TAG IN THE TOP OF THE STUMP.
- FOUND: A DOUGLAS FIR 25" IN DIAMETER WITH A HEALED FACE, BEARS N 62° 45' E 13.25 FEET (11" DIAMETER, N 60° E 13.3 FEET AS PER [3]), 16" DIAMETER, N 62° E, 13.2 FEET AS PER [4]). SET A PK NAIL AND B.C.B.W. IN THE NORTHWESTERLY BASE. FOUND A LOCATION POSTER TAG ON THE SOUTHWESTERLY FACE. SET A B.T. TAG BELOW THE FOUND TAG.
- FOUND: A DOUGLAS FIR 27" IN DIAMETER WITH A HEALED FACE, BEARS S 6° 45' W 31.40 FEET (14" DIAMETER, S 4° E 31.9 FEET AS PER [3]), 18" DIAMETER, S 4° W 31.4 FEET AS PER [4]). SET A PK NAIL AND B.C.B.W. IN THE WESTERLY BASE. SET A B.T. TAG ON THE NORTHERLY FACE.
- NO OTHER RECORD BEARING OBJECTS WERE RECOVERED.

MONUMENT SET (PROCEDURES AND DESCRIPTION):

USED THE RECOVERED AXLE FOR THE CORNER MONUMENT EVEN THOUGH FACE MEASUREMENTS FROM THE ORIGINAL B.T.'S WOULD YIELD A POSITION APPROXIMATELY 1 FOOT EASTERLY FROM ITS PRESENT LOCATION.

NEW ACCESSORIES:

- A DOUGLAS FIR 8" IN DIAMETER, BEARS S 45° 30' E 25.17 FEET, FACED AND SCRIBED "1/4 S3 BT". SET A PK NAIL AND B.C.B.W. IN THE SOUTHWESTERLY BASE. SET A B.T. TAG ON THE NORTHWESTERLY FACE.
- A DOUGLAS FIR 24" IN DIAMETER, BEARS N 72° 15' W 62.63 FEET, FACED AND SCRIBED "XBT". SET A PK NAIL AND B.C.B.W. IN THE SOUTHERLY BASE. SET A B.T. TAG ON THE EASTERLY FACE.
- FOUND: WHITE WOODEN 4" X 4" POST 2.3 FEET WEST-NORTHWESTERLY.
- SET: ORANGE FIBERGLASS "SURVEY STAKE" POST 1 FOOT SOUTHERLY.

MONUMENT DETAIL

NO BRASS
CAP
WAS SET

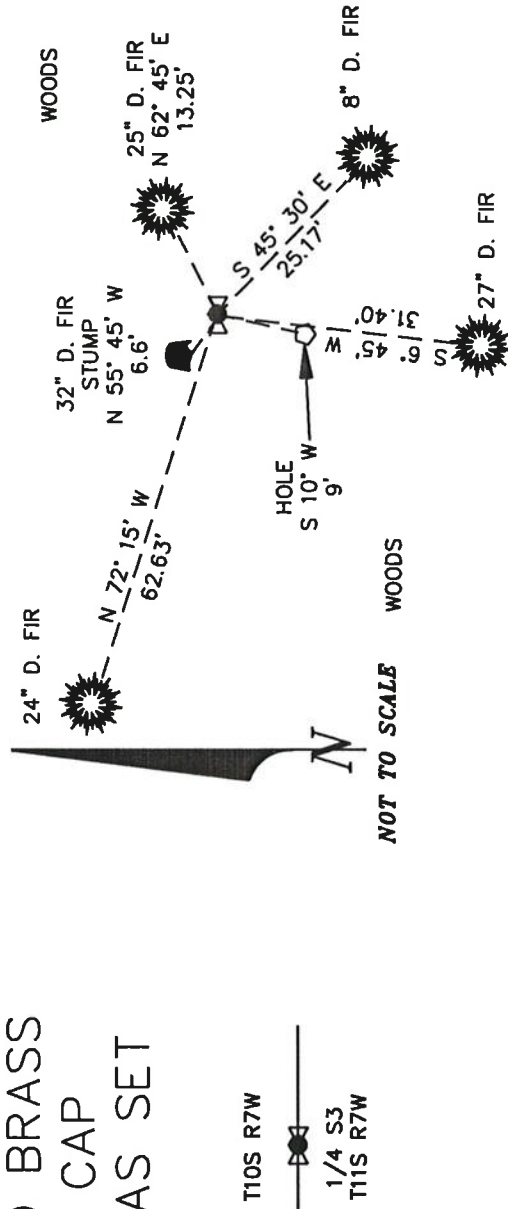
SKETCH**NOTES:**

B.C.B.W. IS A BRASS WASHER STAMPED "BENTON COUNTY SURVEYOR". COMPASS DECLINATION IS 20° EAST. ALL MEASURED DISTANCES AND COMPASS BEARINGS ARE TO THE CENTER OF THE OBJECT, UNLESS OTHERWISE NOTED.

THIS RESTORATION WAS PERFORMED AT THE DIRECTION AND APPROVAL OF THE BENTON COUNTY SURVEYOR. *[Signature]*

FIRM/AGENCY: BENTON COUNTY SURVEYOR

ADDRESS: 360 S.W. AVERY AVE. CORVALLIS OR 97333; PH. 757-6821

SURVEY CREW: CURTIS J. LIESENFELT/MARK E. ANDERSON

REGISTERED
PROFESSIONAL
LAND SURVEYOR

Curtis J. Liesenfelt

OREGON
JULY 17, 1986
CURTIS J. LIESENFELT
2213

T115 RTW SEC 3 N 1/4 COR 5C

FNO: 13/4 AXLE FOR THE COR. (13/4 AXLE AS PER [47])

" A SHALLOW HOLE IN THE GROUND BEARS SIDOW ~

9' (FIR 12" IN DIAM, 5/8" ~ 8/8" BELIEVED TO BE

A FACE MEASUREMENT BY [47]) (HOLE 5/8" ~ 8/8" AS

PER [47])

" THE MOSTLY ROTTED REMAINS OF A D. FIR STUMP 32"

IN DIAM WITH THE SCRAPING "BT" & THE NOTCH VISIBLE,

BEARS N 55° 45' W ~ 8/6' TO CTR, 8/0' TO FACE (15" DIAM,

N 55° ~ 8/60' BELIEVED TO BE FACE MEASUREMENT BY [47])

(STUMP, N 55° W, 6/6" AS PER [47]) SET A BT TAG IN

THE TOP OF THE STUMP

" A D. FIR 25" IN DIAM @ A HEALED FACE, BEARS N 62° 45' E

(13.25" (11" DIAM, N 60° E ~ 13/8" AS PER [47], 18" DIAM, N 62° E,

13.2" AS PER [47]) SET A PKT BCBW IN THE NW BY BASE FNO.

A LOCATION POSTER TAG ON THE SW BY FACE SET A BT TAG

BELOW FNO TAG.

" A D. FIR 27" IN DIAM @ A HEALED FACE, BEARS S 6° 45' W ~

31.40' (14" DIAM, 5/4" E, 31/9" AS PER [47], 18" DIAM, 5/4" ~ 31/4"

AS PER [47]) SET A PKT BCBW IN THE NW BY BASE SET A

BT TAG ON THE NW FACE.

NO OTHER RECORD BEARING OBJECTS WERE RECOVERED.

USED THE RECOVERED AXLE FOR THE COR MON. EVEN THOUGH

FACE MEASUREMENTS FROM THE ORIG. B.T.'S WOULD

12/30

5/19/92, CTL & MEAR, KUH DATASCOPE 20° E DEC. C107 COOL

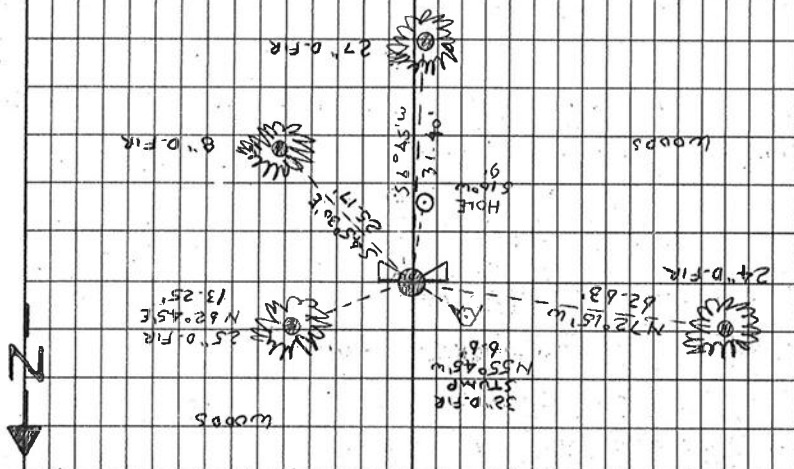

YIELD A POSITION APPROX 1' ELY FROM ITS PRESENT

LOCATION.

A D. FIR 8" IN DIAM. BEARS S 45° 30' E ~ 25.17', FACED W

SCRIBED "A S 3 BT", SET A PKT BCBW IN THE SW W

BASE SET A BT TAG ON THE NW BY FACE

A D. FIR 24" IN DIAM, BEARS N 72° 15' W ~ 62.63', FACED W

SCRIBED "X BT" SET A PKT BCBW IN THE SW BY BASE SET

A BT TAG ON THE ELY FACE.

FNO. WHITE WOODEN 4" x 4" POST 2.3' W-N-W-Y

SET: ORANGE FIBERGLASS "SURVEY STAKE" POST 1' 5" W

" A LOCATION TAG N 8° W ~ 89' ON A D. FIR 8" IN

THE COR IS LOCATED "FLORIDY LEVEL, GROSS WY"

THE GUY WOODEN AREA 100' 5" FROM THE

OF STRAKER FOREST RO. NO. 1489, A BRUW

RO. 10' WIDE. IT IS POOR FOR REMARKING

GPS CONTROL.

BRUCE STARKER
FORESTER
Corvallis Oregon

January 21, 1955.

Remarking of the North Corner of Section 2 and 3,
Twp 11 S, R 7 W, Will. Mer.

Original witness trees:

- S. E. Bearing Tree: rotten stump, scribed "BT" on pitch seam.
- S. W. Bearing Tree: destroyed by skid road.
- N. E. Bearing Tree: rotten stump with blaze.
- N. W. Bearing Tree: rotten stump.

The three remaining stumps fit according to bearing and distance.

Marked four new bearing trees as follows:

- 7" fir N38°E 10.8 feet, #310 Sec. 35 B. T.
- 8" fir S58°E 3.4 feet, #310 Sec. 2 B. T.
- 7" fir S30°W 18.0 feet, #310 Sec 3 B. T.
- 8" fir N80°30'W 39.5 feet, #310 Sec. 35 B. T.

Remarking of the North $\frac{1}{4}$ corner of Section 3, Twp 11 S
R 7 W, Will. Mer.

Original witness trees:

- N. W. Bearing Tree: rotten stump with "BT" scribed on pitch seam.
- S. Bearing Tree: rotten stump.

Marked two new bearing trees as follows:

- 14" fir S 4°E 31.9 feet, #310 Sec. 34 B. T.
- 11" fir N60°E 13.3 feet, # 310 Sec. 3 B. T.

Remarking of the South $\frac{1}{4}$ Corner of Section 35 Twp 10 S,
R 7 W, Will. Mer.

Both original witness trees standing green.

Bark scribed 12" fir S32°W 15.3 feet, #310 Sec. 2 B. T.
Bark scribed original 24" fir (now 46") N16°E 42 links
#310 $\frac{1}{4}$ Sec. 35.

SEE COR. REST. NO.
977 (CJL 7/11/90).

SEE COR. REST. NO.
982 (CJL 7/11/90)



SEE COR. REST. NO.
594 (CJL 7/11/90).

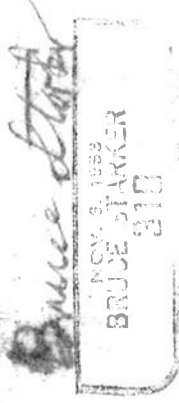
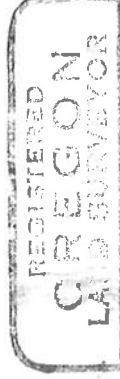

North $\frac{1}{4}$ corner of Section 3, Twp. 11 S., R. 7 W.

982

By Bruce Starker

January 21, 1955

1156

Original witness trees:

NW Bearing tree: rotten stump with BT scribed on pitch seam
S Bearing Tree rotten stump

Marked two new bearing trees as follows:

14" Fir S 4° E 31.9 feet, #310 Sec. 34 BT
11" Fir N 60° E 13.3 feet, #310 Sec. 3 B.T.