

CORNER FILE TRACKING

H:\Survey\Corners\Misc\Filetrac2.doc
06/15/2003

CORNER NUMBER
117500600

STEP	HISTORY()	RESTORATION()
Form Prepared, DB	8/7/08	8/12/08
Field Inspection, DB	8/8/08	8/8/08
Form Checked, DB	8/24/08	8/24/08
Form Edited, DB	8/24/08	8/24/08
Form Signed, DB	8/25/08	8/25/08
Counter Index	8/11/08	8/11/08
GIS Index	8/13/08	8/13/08
Authorize Payment, DB	—	—
Archive Digital Files		
Collect Documents	8/29/08	8/29/08
Scanned	8/29/08	8/29/08
Copy For Filming		
Filed, DB		
Finish index (count unit)	8/8/08	8/8/08
Filmed (Archived), DB		
Document No's to Andrew		

(DB) = Entry needed in database (Access).

COMMENTS:

117500600

117500600

3 1/2
REFERENCE - 10111 11-7

FD 2 1/2" BRASS CAP, 2 1/2" ABOVE GROUND LEVEL,
 FIRMLY SET, AXID MARKED AS STUMP. FD A
 ST77⁰ P. 27. BY COMPASS & STEEL TAPE.
 3/4" RUSTY IRON PIPE, 3" ABOVE GROUND LEVEL,
 ORIGIN UNKNOWN. FD FOUR GLO BITS: NE BT: 33"
 D.F. STUMP WITH HEALED FACE. SE BT: 60" D.F.
 STUMP, NO MARKS VISIBLE. SW BT: ROTTEN D.F.
 REMAINS, NO MARKS VISIBLE. NW BT: 19" REMAINS
 OF A D.F. STUMP. FD FIVE BIT'S PER BOSS 3803:
 NE BT: 18" x 1/2' D.F. STUMP, WITH A HEALED FACE.
 SE BT: 15" x 5 1/2' D.F. STUMP, WITH A HEALED FACE.
 SW BT: 19" x 5' D.F. STUMP, WITH A HEALED FACE.
 NW BT: 22" x 1/2' D.F. STUMP, WITH A HEALED FACE.
 BT OF UNKNOWN ORIGIN: 38" x 5' D.F. STUMP WITH A HEALED BLAZE
 SET ORANGE CARSONITE "SURVEY MARKER" POST 0.5'
 0.5 FEET OF MONUMENT.
 NORTH

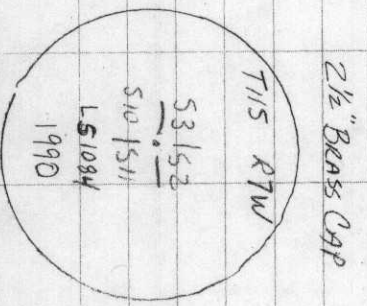

OVERCAST / COOL
50°F, 29.2" Hg.

LEICA TCR 1105TDS

B-8-08
B ALTENBRACH
T. O. T

27/12

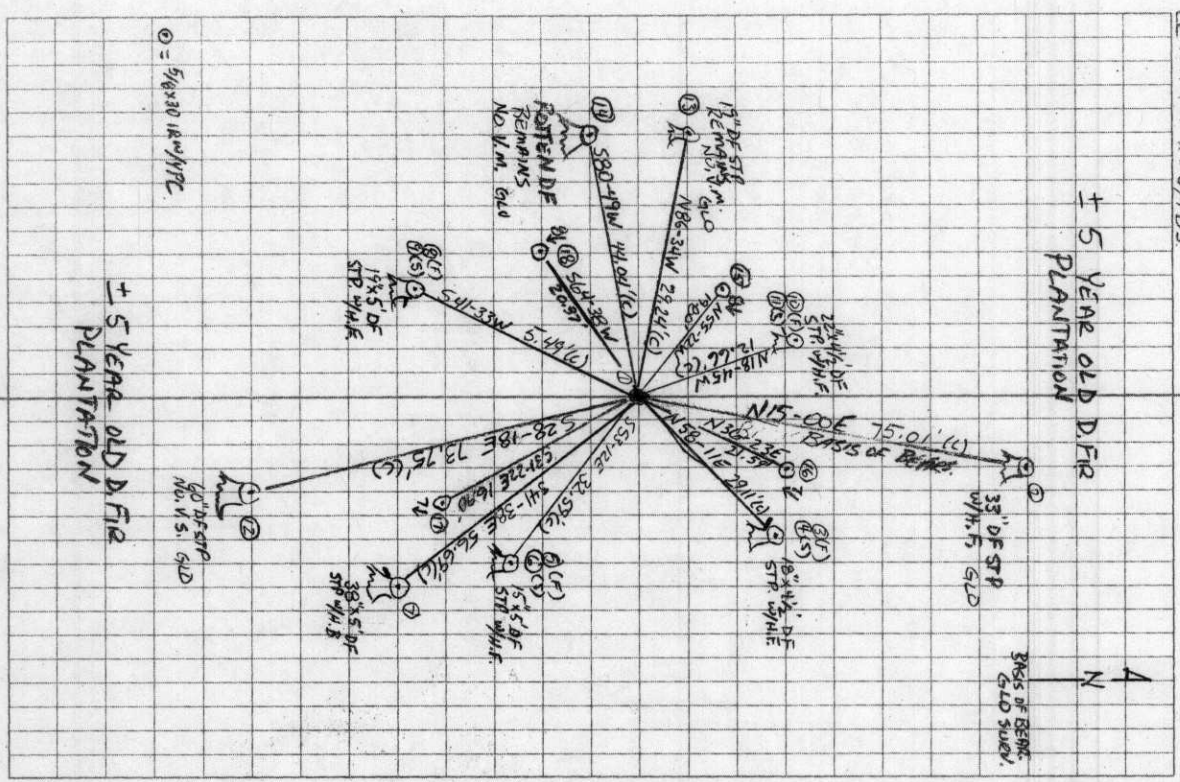

DATE 08/07/2008TOWNSHIP 11 SOUTH, RANGE 07 WEST, WILLAMETTE MERIDIAN; SECTION 02 CORNER SOUTHWEST
DONATION LAND CLAIM N/A CORNER N/A**COMMON CORNER(S):**SOUTHEAST OF SECTION 3
NORTHEAST OR SECTION 10
NORTHWEST OF SECTION 11**RECORDS (INFORMATION IN BOLD ITALICS IS COUNTY STAFFS' INTERPRETATION OF THE RECORD)**

BASED ON EXTENSIVE RESEARCH AND RECOVERY OF EVIDENCE, THIS OFFICE HAS DETERMINED THAT MOST GENERAL LAND OFFICE SURVEYORS MEASURED TO THE FACE OF BEARING TREES.

- [01] GENERAL LAND OFFICE (GLO) NOTES BY D. HATHORN, D.S., DATED MAY 14, 1855. SET A POST. MARKED A 12" FIR N15°E 115 LKS. (75.90 FT.), A 15" FIR S32°E 120 LKS. (79.20 FT.), A 12" FIR S78°W 68 LKS. (44.88 FT.) AND A 12" FIR N84°W 44LKS. (29.04 FT.).
- [02] COUNTY SURVEY NO. 905 (OLD NOS. 258 AND 335) FIELD NOTES (BOOK 34, PAGE 41) BY W. W. LARSEN, D.C.S., NO DATE GIVEN. *FIR LIMB STAKE, ALL MARKS AND TREES.*
- [03] CORNER RESTORATION BOOK NO. 1, PAGE 173 BY W. W. LARSEN, D.C.S., DATED AUGUST 8, 1924. SET A FIR LIMB. FOUND A 12" FIR (GLO BT) N15°E 1.15 CHS. (75.90 FT.), STANDING, A 15" FIR (GLO BT) S32°E 1.20 CHS. (79.20 FT.), STANDING, A 12" FIR (GLO BT) S78°W 0.68 CHS. (44.88 FT.), STANDING AND A 12" FIR (GLO BT) N84°W 0.44 CHS. (29.04 FT.), STANDING.
- [04] CORNER RESTORATION NO. 1028. *TRANSCRIBED FROM RECORD [03] AND MAY CONTAIN ERRORS AND/OR OMISSIONS.*
- [05] COUNTY SURVEY NO. 957 (OLD NO. 258) FIELD NOTES (BOOK 35, PAGE 14) BY W. W. LARSEN, D.C.S., NO DATE GIVEN. *CORNER TIED, BUT NOT DESCRIBED.*
- [06] BENTON COUNTY MAP NO. 11-7-00005 NO DATE OR DRAFTSMAN GIVEN. *FIR STAKE (ORIGINAL). 12" FIR STUMP (GLO BT) N15°E 1.15 CHS. (75.90 FT.). 15" FIR STUMP (GLO BT) S32°E 1.20 CHS. (79.20 FT.). 12" FIR STUMP (GLO BT) S78°W 0.68 CHS. (44.88 FT.). 12" FIR STUMP (GLO BT) N84°W 0.44 CHS. (29.04 FT.).*
- [07] CORNER RESTORATION NO. 3803 BY JIM PETERSON, P.L.S., DATED JULY 19, 1990. SET A 2" X 30" GALVANIZED IRON PIPE WITH A 2 1/2" BRASS CAP, 0.5 FT. ABOVE GROUND. FOUND A 3/4" IRON PIPE (UNKNOWN ORIGIN) S78°E 2.12 FT. FOUND A 36" FIR STUMP (GLO BT) N15°E 74.70 FT. TO FACE, NO VISIBLE MARKS, A 60" FIR STUMP (GLO BT) S28°E 73.90 FT. TO FACE, WITH A HEALED FACE, A 20" FIR STUB (GLO BT) S81°W 44.90 FT. TO FACE, WITH AXE MARKS VISIBLE, A 30" FIR STUB (GLO BT) N84°W 29.00 FT. TO FACE, WITH SCRIBING VISIBLE AND A 36" FIR (UNKNOWN ORIGIN) S44°E 57.00 FT, WITH A SCAR, POSSIBLE BT FACE AND A CRUISER'S MARK ABOVE SCAR. MARKED A 14" FIR N58°E 29.00 FT., SCRIBED "T11SR7WS2BT", A 12" FIR S55°E 32.60 FT., MARKED "T11SR7WS11BT", AN 18" FIR S39°W 5.50 FT., SCRIBED "T11SR7WS10BT" AND A 16" FIR N21°W 12.20 FT., SCRIBED "T11SR7WS3BT".
- [08] COUNTY SURVEY NO. 8493 BY JIM PETERSON, P.L.S., DATED JUNE 1, 1990. FOUND A 2 1/2" BRASS CAP AS PER BCCR 3803.

NOTE: UNABLE TO LOCATE COUNTY SURVEY NO. 1852. THIS SURVEY IS MISPLACED OR LOST AND MAY CONTAIN INFORMATION ABOUT THIS CORNER.

NOTES:

THIS IS A MICROSOFT WORD 2003 DOCUMENT NAMED "17500600" CREATED FROM A BOILER PLATE DOCUMENT NAMED "HISTORY", WHICH HAS A STYLESHEET NAMED "CORNER" ATTACHED TO IT.

FIRM/AGENCY: BENTON COUNTY SURVEYOR'S OFFICE
ADDRESS: 360 S.W. AVERY AVE. CORVALLIS OR 97333; PH. 766-6821
RESEARCH BY: BERNARD S. ALTENBACH, ENGINEER/SURVEY TECH.
DATA ENTRY BY: SAME

BENTON COUNTY CORNER RESTORATION FORM, PAGE 1 OF 2, 117500600R3**SEE CORNER HISTORY FORM FOR RECORDS ETC.**CORNER RESTORATION FIELD BOOK NUMBER 27 PAGE(S) 12DATE 08/08/2008TOWNSHIP 11 SOUTH, RANGE 07 WEST, WILLAMETTE MERIDIAN; SECTION 02 CORNER SOUTHWESTDONATION LAND CLAIM N/ACORNER N/A

CONDITION REPORT _____;

REFERENCED OUT XX _____;

RENEWED _____;

SURVEYED IN _____

LOCATION AND COMMENTS:

CORNER IS LOCATED ON A STEEP NORTHERLY SLOPE IN A ±5 YEAR OLD D. FIR PLANTATION. TO REACH THE CORNER FROM THE JUNCTION OF NORTON CREEK ROAD AND PEAK VIEW LANE (PRIVATE ROAD), TRAVEL NORTH ON NORTON CREEK ROAD FOR 1.65 MILES; THEN LEFT ON PRIVATE ACCESS ROAD (THROUGH LOCKED GATE) FOR 0.09 MILES; THEN LEFT FOR 0.61 MILE; THEN RIGHT AT A THREE WAY INTERSECTION FOR 0.10 MILES; THEN RIGHT FOR 0.24 MILES; THEN RIGHT FOR 0.10 MILES AND PARK; THEN WALK APPROXIMATELY N45°E FOR ± 150 FEET TO CORNER. CORNER WILL BE GOOD FOR PREMARKING AND GPS CONTROL FOR A FEW YEARS.

MONUMENTS AND ACCESSORIES FOUND (CONDITION AND SOURCE):

1. FOUND A 2 1/2" BRASS CAP, 3" ABOVE GROUND LEVEL, FIRMLY SET FOR THE CORNER POSITION.
(SET A POST PER RECORD [01]).
(SET A FIR LIMB PER RECORD [03]).
(FIR STAKE PAR RECORD [06]).
(SET A 2" X 30" GALVANIZED IRON PIPE WITH A 2 1/2" BRASS CAP PER RECORD [07]).
(FOUND A 2 1/2" BRASS CAP PER RECORD [08]).
2. FOUND A 33" D. FIR STUMP, N15°00'E, 75.01 FEET TO CENTER, WITH A HEALED FACE. **BASIS OF BEARINGS FOR THIS RESTORATION.**
(MARKED A 12" FIR, N15°E, 75.90 FEET PER RECORD [01]).
(FOUND A 12" FIR, N15°E, 75.90 FEET PER RECORD [03]).
(12" FIR STUMP, N15°E, 75.90 FEET PER RECORD [06]).
(FOUND A 36" FIR STUMP, N15°E, 74.70 FEET TO FACE PER RECORD [07]).
3. FOUND A 60" D. FIR STUMP, S28°18'E, 73.75 FEET TO CENTER, NO VISIBLE SCRIBES FOUND.
(MARKED A 15" FIR, S32°E, 79.20 FEET PER RECORD [01]).
(FOUND A 15" FIR, S32°E, 79.20 FEET PER RECORD [03]).
(15" FIR STUMP, S32°E, 79.20 FEET PER RECORD [06]).
(FOUND A 60" FIR STUMP, S28°E, 73.90 FEET PER RECORD [07]).
4. FOUND ROTTEN D. FIR REMAINS, S80°49'W, 44.04 FEET TO CENTER, NO VISIBLE MARKS FOUND.
(MARKED A 12" FIR, S78°W, 44.88 FEET PER RECORD [01]).
(FOUND A 12" FIR, S78°W, 44.88 FEET PER RECORD [03]).
(12" FIR STUMP, S78°W, 44.88 FEET PER RECORD [06]).
(FOUND A 20" FIR STUB, S81°W, 44.90 FEET PER RECORD [07]).
5. FOUND 19" D. FIR STUMP REMAINS, N86°34'W, 29.24 FEET TO CENTER, NO VISIBLE MARKS FOUND.
(MARKED A 12" FIR, N84°W, 29.04 FEET PER RECORD [01]).
(FOUND A 12" FIR, N84°W, 29.04 FEET PER RECORD [03]).
(12" FIR STUMP, N84°W, 29.04 FEET PER RECORD [06]).
(FOUND A 30" FIR STUB, N84°W, 29.00 FEET PER RECORD [07]).
6. FOUND AN 18" X 4 1/2' D. FIR STUMP, N58°11'E, 29.11 FEET TO CENTER, WITH A HEALED FACE.
(MARKED A 14" FIR, N58°E, 29.00 FEET PER RECORD [07]).
7. FOUND A 15" X 5' D. FIR STUMP, S53°12'E, 32.59 FEET TO CENTER, WITH A HEALED FACE.
(MARKED A 12" FIR, S55°E, 32.60 FEET PER RECORD [07]).
8. FOUND A 19" X 5' D. FIR STUMP, S41°33'W, 5.49 FEET TO CENTER, WITH HEALED FACE.
(MARKED AN 18" FIR, S39°W, 5.50 FEET PER RECORD [07]).
9. FOUND A 22" X 4 1/2' D. FIR STUMP, N18°45'W, 12.66 FEET TO CENTER, WITH A HEALED FACE.
(MARKED A 16" FIR, N21°W, 12.20 FEET PER RECORD [07]).
10. FOUND A 38" X 5' D. FIR STUMP (UNKNOWN ORIGIN), S41°38'E, 56.69 FEET TO CENTER, WITH A HEALED BLAZE.
(FOUND A 36" FIR (UNKNOWN ORIGIN), S44°E, 57 FEET PER RECORD [07]).
11. FOUND A 3/4" RUSTY IRON PIPE (UNKNOWN ORIGIN), S77°E, 2.72 FEET (DISTANCE AND BEARING BY COMPASS AND TAPE).
(FOUND A 3/4" IRON PIPE (UNKNOWN ORIGIN), S78°E, 2.12 FEET PER RECORD [07]).

MONUMENT SET (PROCEDURES AND DESCRIPTION):

NO NEW MONUMENT WAS SET. HELD THE 2 1/2" BRASS CAP AS SET PER RECORD [07] FOR CORNER POSITION. PIPE AND CAP WAS FOUND IN GOOD CONDITION AND FIRMLY SET. TIED EXISTING ACCESSORIES AND SET 4 NEW IRON ROD REFERENCES.

±5 YEAR OLD
D. FIR PLANTATION

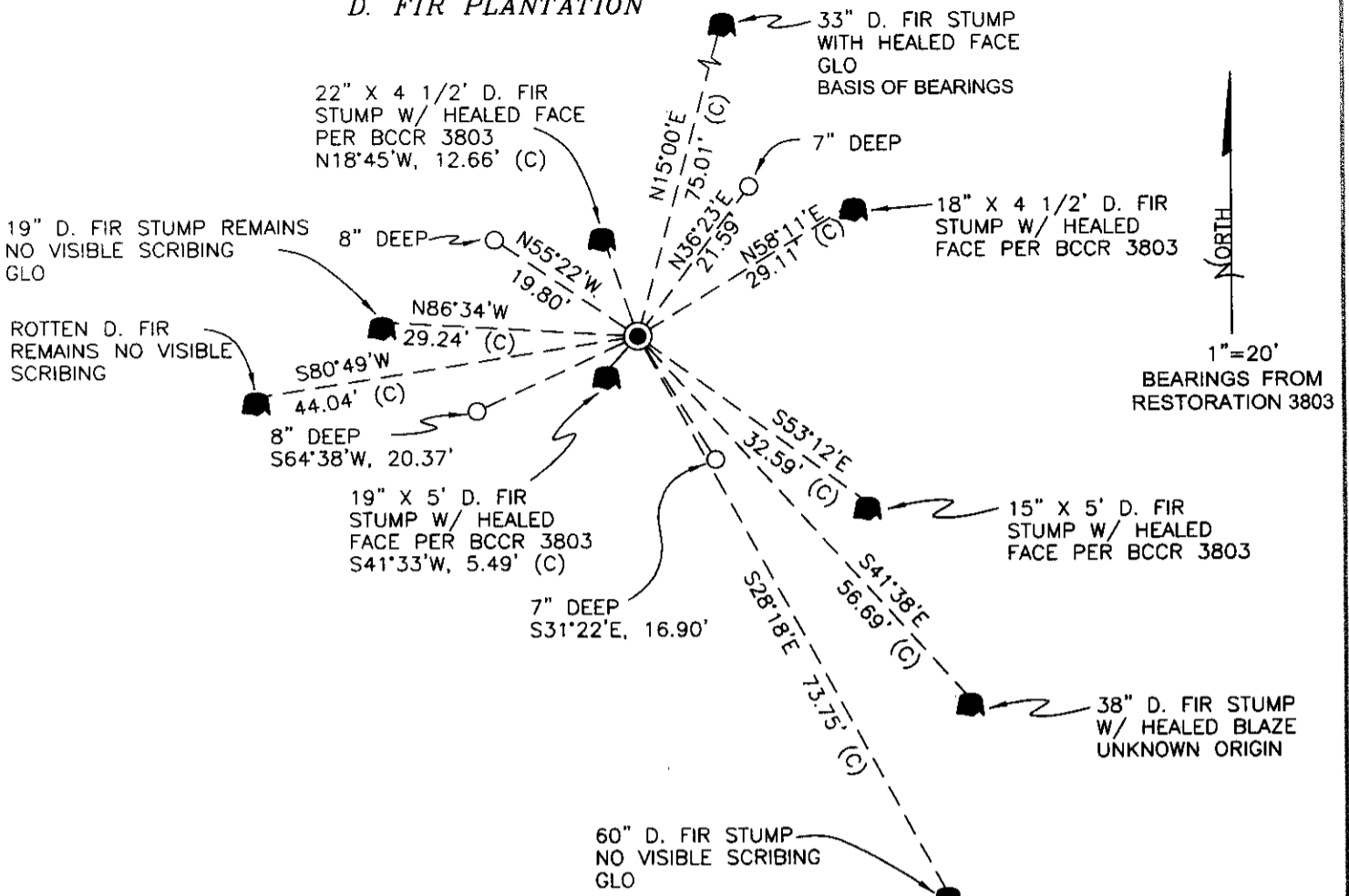

MONUMENT DETAIL

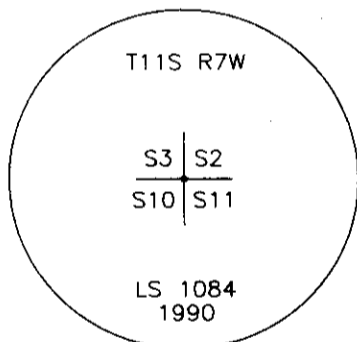

2 1/2" BRASS CAP

±5 YEAR OLD
D. FIR PLANTATION

LEGEND

- SET 5/8" X 30" REBAR WITH YELLOW PLASTIC CAP MKD "BENTON COUNTY SURVEYOR"
- (F) MEASUREMENT TO FACE
- (C) MEASUREMENT TO CENTER
- GOVERNMENT MONUMENT FOUND AS SHOWN
- C.S.B.T. COUNTY SURVEYORS BEARING TREE GENERAL LAND OFFICE
- GLO
- BEARING TREE STUMP AS NOTED

NEW ACCESSORIES:

1. SET REBAR (SEE LEGEND) 7" BELOW GROUND LEVEL, N36°23'E, 21.59 FEET.
2. SET REBAR (SEE LEGEND) 7" BELOW GROUND LEVEL, S31°22'E, 16.90 FEET.
3. SET REBAR (SEE LEGEND) 8" BELOW GROUND LEVEL, S64°38'W, 20.37 FEET.
4. SET REBAR (SEE LEGEND) 8" BELOW GROUND LEVEL, N55°22'W, 19.80 FEET.

NOTES:

COMPASS DECLINATION IS 20' EAST. ALL MEASURED DISTANCES AND BEARINGS ARE TO THE CENTER OF THE OBJECT, UNLESS OTHERWISE NOTED. ALL BEARING TREES ARE PAINTED AND HAVE A B.T. TAG ATTACHED, FACING THE CORNER UNLESS OTHERWISE NOTED. ALL NEW BEARING TREES HAVE A PLASTIC WASHER (STAMPED "SURVEYOR MARKER DO NOT REMOVE") ATTACHED BY AN ALUMINUM NAIL TO THE FACE, BELOW THE "BT" FOR DISTANCE AND ANGLE MEASUREMENT UNLESS OTHERWISE NOTED. THE DRAWING IS FROM AUTOCAD RELEASE 2008.

THIS RESTORATION WAS PERFORMED AT THE DIRECTION AND APPROVAL OF THE BENTON COUNTY SURVEYOR DW

REGISTERED
PROFESSIONAL
LAND SURVEYOR

8/25/08 *David M. Dean*

FIRM/AGENCY: BENTON COUNTY SURVEYOR'S OFFICE
 ADDRESS: 360 S.W. AVERY AVE. CORVALLIS, OR. 97333; PH. 766-6821
 PRESENT: BERNIE ALTENBACH AND TYLER OTT, SURVEY TECH.
 EQUIPMENT: LEICA TCR 1105 WITH TDS ON BOARD

OREGON
 JULY 13, 1984
 DAVID M. DEAN
 2090

RENEWAL DATE: 12/31/09

SECTION 2 TOWNSHIP 11 S RANGE 7 W DLC _____ CORNER SW
 DATE 7-19-90 CORNER RESTORATION FIELD BOOK NUMBER _____ PAGE _____

CORNER DESIGNATION:

The corner common to sections 2, 3, 10, & 11,
 T11S, R7W



- _____ CONDITION REPORT ONLY
- _____ REFERENCED OUT
- XX RENEWED
- _____ SURVEYED IN

LOCATION AND COMMENTS:

Corner lies on steep East facing slope in East - West fence line. Corner is 30' NE of old logging road.

PREVIOUS RENEWALS/SURVEYS, ETC.:

- 1856 - Original survey by D. Hathorn
- 1924 - Corner restoration #1029 by W.C. Galloway
 Galloway Hard Copy 11-7-00005 & 11-7-00006
- 1924 - C.S. 905 by W.C. Galloway
- 1925 - C.S. 957 by W.C. Galloway
- 1947 - C.S. 1852 by C.C. Hanson

MONUMENTS AND ACCESSORIES FOUND (CONDITION AND SOURCE):

BT's found:

- 1) 36" Fir Stump, N15°E, 74.7 ft. to face (N15°E, 115 Lks-1856) No marks visible
- 2) 60" Fir Stump, S28°E, 73.9 ft. to face (S32°E, 120 Lks-1856) Healed face
- 3) 20" Fir Stub, S81°W, 44.9 ft. to face (S78°W, 68 Lks-1856) Axe marks visible
- 4) 30" Fir Stub, N84°W, 29.0 ft. to face (N84°W, 44 Lks-1856) Scribing visible
- 5) 36" Fir, S44°E, 57 ft. (unknown origin) Scar and possible BT face - cruiser's mark above scar... Tied face of existing BT's (1 - 4). Tried to intersect record distances to reestablish corner position but could not get all distances to agree. Therefore reset corner at record distances from the SW and NW BT's, since they are the nearest and have the least ground slope. Bearings of BT's from reestablished corner position are based on Galloway hard copy 11-7-00006

MONUMENT DETAIL

(Set BT tag at above BT's)

SKETCH

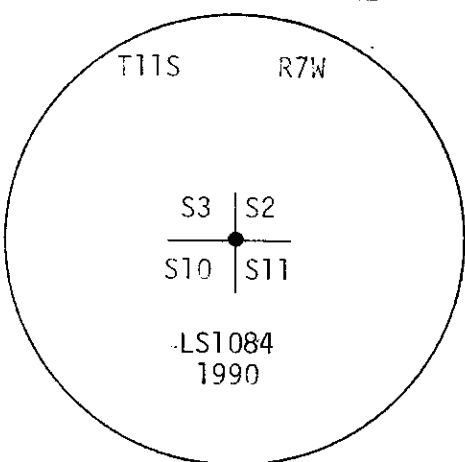

2 1/2" BRASS CAP



NOT TO SCALE

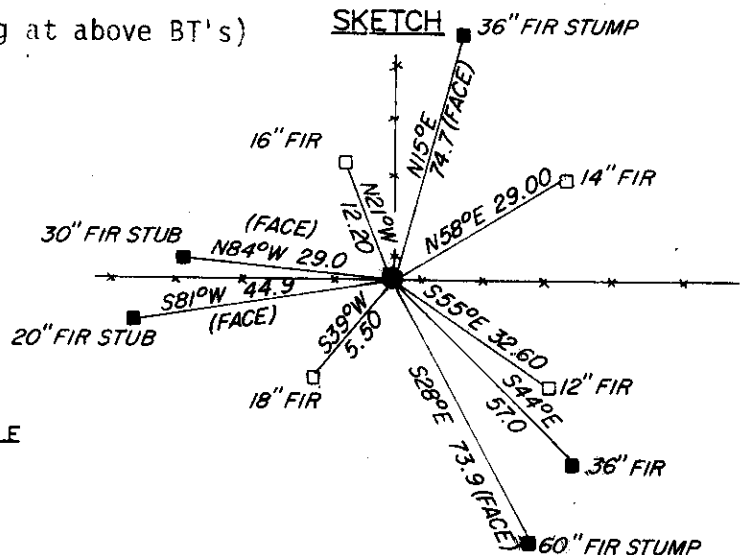

MONUMENT SET (PROCEDURES AND DESCRIPTION):

Set 2" X 30" galvanized iron pipe with a 2 1/2" brass cap stamped as shown. Brass cap is 0.5 ft. above the ground. Found 3/4" iron pipe (unknown origin) S78°E, 2.12 ft. (did not disturb found pipe).

NEW ACCESSORIES:

BT's set:

- *1) 16" Fir, N21°W, 12.20ft. Scribed "T11S R7W S3 BT" - Set BT tag
- *2) 14" Fir, N58°E, 29.00ft. Scribed "T11S R7W S2 BT" - Set BT tag
- *3) 12" Fir, S55°E, 32.60ft. Scribed "T11S R7W S11 BT"- Set BT tag
- *4) 18" Fir, S39°W 5.50ft. Scribed "T11S R7W S10 BT"- Set BT tag

Set orange fiberglass "Survey Marker" post

NOTES:

- * Set PK nails with stainless steel washers in side center of base of BT. BT distances are to side center of tree, except as noted. Accessory bearings are determined using a hand compass (Decl. = 20° East) except as noted.

FIRM/AGENCY: J. Peterson & Associates, Land Surveyors
ADDRESS: 8155 NW Mitchel Drive
PARTY CHIEF: Corvallis, Oregon 97330 Phone 757-1794
CREW: Jim S. Peterson - Joe B. Hinds
WITNESS:

**REGISTERED
 PROFESSIONAL
 LAND SURVEYOR**

OREGON
 JULY 31, 1976
JIM S. PETERSON
 1084

W.W. Larsen
M.S. Woodcock
Savage
Maack

N.W. cor. F.A. Horning Cl. 53 T.115 R.5W
Set stone from which a $\frac{3}{4}$ " pipe
bears south .303 chains.

W.W.L.
Howard - Maack

$\frac{1}{4}$ cor. betw. sec's 2 & 3 T.115 R.4W
Stone 8"x8"x18" on fence line.
Oak 1# in diameter bears N50°W. 1.135 chains
" post 12" " " south .030 "

C.S. 333

$\frac{1}{4}$ sec. cor. betw. sec's 2 & 11 T.115 R.4W.
Set $\frac{1}{2}$ " pipe for witness 3.068 North + .51 West
of true corner
Fir 36" N.75°W. 68
Maple 8" N.15°W. 22

R.7W

$\frac{1}{4}$ cor. between sec's 1 & 2 T.115. R.4 W.
in cherry orchard - nothing set but falls
East 40.00 chains and South .604 chains
from a 1" pipe near the center of sec. 2.
and is also south 40.024 from a $\frac{3}{4}$ " pipe
at N.E. corner thereof.

T.114

C.S. 204
June 7, 1924
Howard Bush
Bud. Alcorn
Doc. + By Frantz

N.E. cor. sec. 20 ^{21/4} T.10 S R.6 W.
Set $\frac{1}{2}$ " iron rod + plate
Oak 12" 574°W. 2.612 chains.
" 12" in dia. bears N.19 $\frac{1}{2}$ °W. 3.488 chains

C.S. 334
July 29, 1924
W.W.L.
H.L. Maack
Byron Taylor

S.W. Corner of Polly Belknap Cl. 39 T.14 S R.6 W.
Set $\frac{3}{4}$ " pipe
Ash 18" in dia bears S46 $\frac{1}{2}$ °E. 658 chs. dis.
Fence west .430 " "

C.S. 335
Aug. 8, 1924
W.W.L.
Langelle

N.E. cor. Sec. 10, T.115. R.7W
Set Fir limb from which a
Fir 12" in dia. bears S.78°W. .68 chs
all standing " 12" " " " N84°W. .44 "
" 12" " " " " N15°E. 1.15 "
" 15" " " " " S.32°E. 1.20 "

$\frac{1}{4}$ cor. between Secs 3 & 10 T.115. R.7W.
Set $\frac{3}{4}$ " rod by post in place of orig
stake from which
a Fir 15" in dia bears N.48°E. .804 chs.
" " " " " N 17°W gone
" " " " " S 84°E (+30) 3.40

Sept 18, 1924
W.W.L.
H. Hubbard
Pete Whitaker

N.W. Cor. Wiley Winkle Cl. 48 T.13 S R.5 W
Set horse shoe + parts of orig stone
N.E. Cor Cl. 50 bears south 9.739 chs.

N. E. corner section 10, Twp. 11 S., R. 7 W.

12-3-10-11

Reestablishment by W. C. Galloway

August 8, 1924

Set Fir limb

Fir 12" in diam bears S 78° W	.68 chains
Fir 12" in diam bears N 84° W	.44 chains
Fir 12" in diam bears N 15° E	1.15 chains
Fir 15" in diam bears S 32° E	1.20 chains

Witness W. W. Larson

SECTION 2 TOWNSHIP 11 S RANGE 7 W DLC _____ CORNER SW
 DATE 7-19-90 CORNER RESTORATION FIELD BOOK NUMBER _____ PAGE _____

CORNER DESIGNATION:

The corner common to sections 2, 3, 10, & 11,
 T11S, R7W

S3	S2
S10	S11

_____ CONDITION REPORT ONLY
 _____ REFERENCED OUT
XX RENEWED
 _____ SURVEYED IN

LOCATION AND COMMENTS:

Corner lies on steep East facing slope in East - West fence line. Corner is 30' NE of old logging road.

PREVIOUS RENEWALS/SURVEYS, ETC:

- 1856 - Original survey by D. Hathorn
- 1924 - Corner restoration #1028 by W.C. Galloway
- Galloway Hard Copy 11-7-00005 & 11-7-00006
- 1924 - C.S. 905 by W.C. Galloway
- 1925 - C.S. 957 by W.C. Galloway
- 1947 - C.S. 1852 by C.C. Hanson

MONUMENTS AND ACCESSORIES FOUND (CONDITION AND SOURCE):

BT's found:

- 1) 36" Fir Stump, N15°E, 74.7 ft. to face (N15°E, 115 Lks-1856) No marks visible
- 2) 60" Fir Stump, S28°E, 73.9 ft. to face (S32°E, 120 Lks-1856) Healed face
- 3) 20" Fir Stub, S81°W, 44.9 ft. to face (S78°W, 68 Lks-1856) Axe marks visible
- 4) 30" Fir Stub, N84°W, 29.0 ft. to face (N84°W, 44 Lks-1856) Scribing visible
- 5) 36" Fir, S44°E, 57 ft. (unknown origin) Scar and possible BT face - cruiser's mark above scar... Tied face of existing BT's (1 - 4). Tried to intersect record distances to reestablish corner position but could not get all distances to agree. Therefore reset corner at record distances from the SW and NW BT's, since they are the nearest and have the least ground slope. Bearings of BT's from reestablished corner position are based on Galloway hard copy 11-7-00006

MONUMENT DETAIL

(Set BT tag at above BT's)

SKETCH

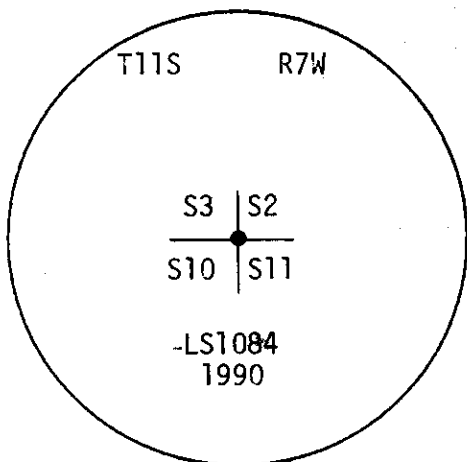

2 1/2" BRASS CAP



NOT TO SCALE

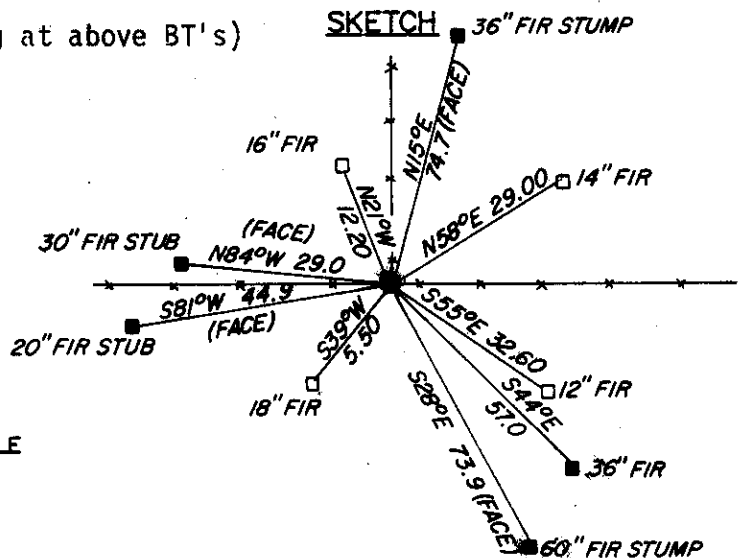

MONUMENT SET (PROCEDURES AND DESCRIPTION):

Set 2" X 30" galvanized iron pipe with a 2 1/2" brass cap stamped as shown. Brass cap is 0.5 ft. above the ground. Found 3/4" iron pipe (unknown origin) S78°E, 2.12 ft. (did not disturb found pipe).

NEW ACCESSORIES

BT's set:

- *1) 16" Fir, N21°W, 12.20ft. Scribed "T11S R7W S3 BT" - Set BT tag
- *2) 14" Fir, N58°E, 29.00ft. Scribed "T11S R7W S2 BT" - Set BT tag
- *3) 12" Fir, S55°E, 32.60ft. Scribed "T11S R7W S11 BT" - Set BT tag
- *4) 18" Fir, S39°W 5.50ft. Scribed "T11S R7W S10 BT" - Set BT tag

Set orange fiberglass "Survey Marker" post

NOTES:

* Set PK nails with stainless steel washers in side center of base of BT. BT distances are to side center of tree, except as noted.

Accessory bearings are determined using a hand compass (Decl = 20° East) except as noted.

FIRM/AGENCY: J. Peterson & Associates, Land Surveyors

ADDRESS: 8155 NW Mitchel Drive

PARTY CHIEF: Corvallis, Oregon 97330 Phone 757-1794

CREW: Jim S. Peterson - Joe B. Hinds

WITNESS:

**REGISTERED
PROFESSIONAL
LAND SURVEYOR**

[Signature]

OREGON
JULY 31, 1976
JIM S. PETERSON
1084