

CORNER FILE TRACKING

H:\Survey\Corners\Misc\Filetrac.doc

11/23/98

CORNER NUMBER
117500700

STEP	HISTORY()	RESTORATION()
Form Prepared, DB	7/28/05	3/14/06
Field Inspection, DB	3/13/05	3/13/05
Form Checked, DB		
Form Edited, DB		
Form Signed, DB		
Counter Index	3/14/05	3/14/05
GIS Index		
Authorize Payment, DB	_____	_____
Archive Digital Files		
Collect Documents	3/14/05	3/14/05
Scanned	4/6/06	4/6/06
Copy For Filming		
Filed, DB		
Finish index (count unit)		
Filmed (Archived), DB		

(DB) = Entry needed in database (Access).

COMMENTS:

117500700

REMONUMENTING 312 T IIS, RTW

Fd ROTTEN 4"x4" x 3 1/2' High CEDAR POST, PAINTED WHITE & LYING LOOSE ON GROUND AT APPROXIMATE COR. POSITION.

FOUND REMAINS OF 3 6LO BTs;
1) ± 36" ROTTEN D. FIR STUMP - WE OPEN TO VS. "T" AND NOTCH -

NW 6LO BT
2) ± 40" D. FIR STUMP w/ ROTTED OUT FACE - NO VS. - SE 6LO BT

3) ± 20" D. FIR x 7" HIGH SNAG ROTTEN NO VS.

FOUND 4 STARKER BTs ALL STANDING
1) 16" D. FIR w/ LARGE SINGLE BURZE - NE
20 " " " " " SE
17 " " " " " SW
26 " " " " " NW

POSITIONED COR. BY DIST/DIST Fm
NW & NE 6LO BTs
SET 2"x3 1/2" GIP w/ 3/4" BRASS DISK CONC. IN TOP 1" MKD AS SHOWN
SET 6' CARSONITE POST 1' SW OF NEW MON.
COR ON SW FACING SLOPE

CUDY, COOL
29.1" Hg 40°F
LEICA TCR 1105/TDS

3/13/06 23/72
D. DEAN
B. ALTENBACH

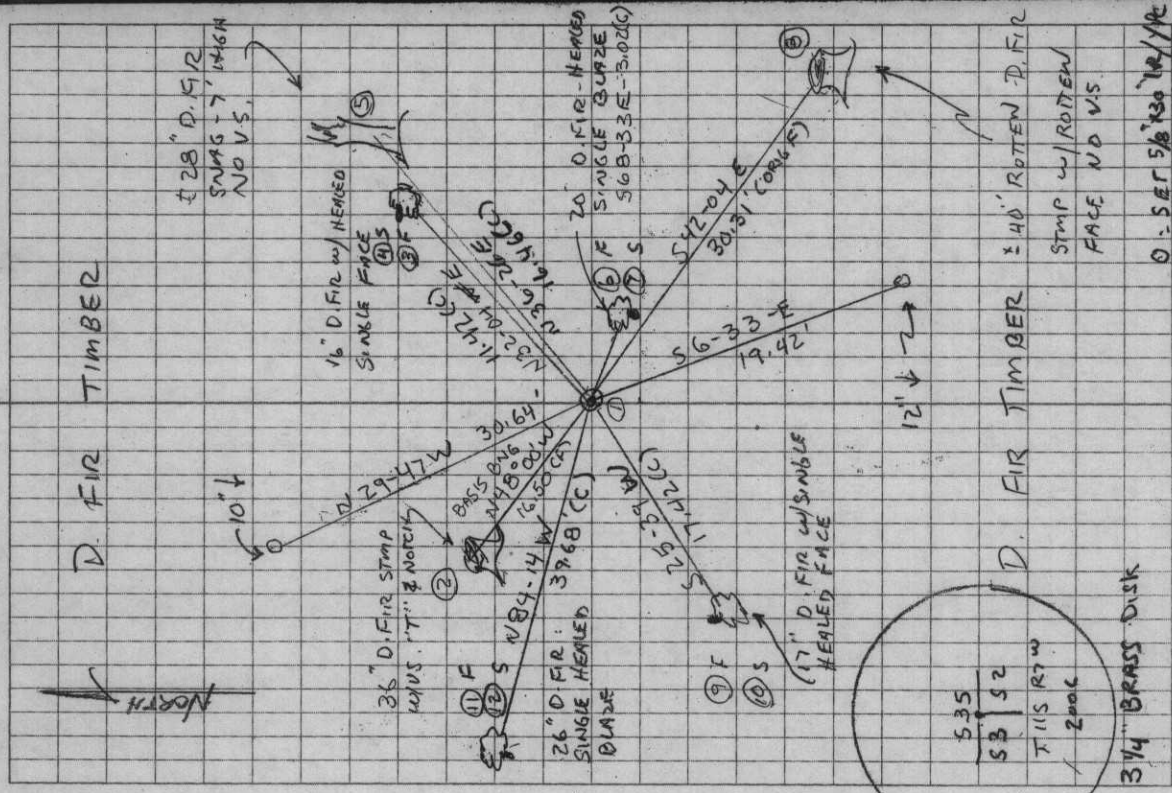

D. FIR TIMBER

D. FIR TIMBER

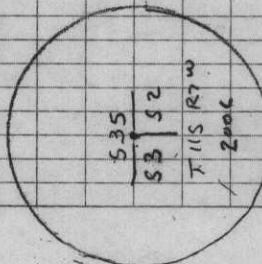

117500700

BRUCE STARKER
FORESTER
Corvallis Oregon

January 21, 1955.

Remarking of the North Corner of Section 2 and 3,
Twp 11 S, R 7 W, Will. Mer.

Original witness trees:

SEE COR. REST. NO.
977 (CJL 7/11/90).

S. E. Bearing Tree: rotten stump, scribed
"BT" on pitch seam.
S. W. Bearing Tree: destroyed by skid road.
N. E. Bearing Tree: rotten stump with blaze.
N. W. Bearing Tree: rotten stump.

The three remaining stumps fit according to bearing
and distance.

Marked four new bearing trees as follows:

7" fir N38°E 10.8 feet, #310 Sec. 35 B. T.
8" fir S58°E 3.4 feet, #310 Sec. 2 B. T.
7" fir S30°W 18.0 feet, #310 Sec 3 B. T.
8" fir N80°30'W 39.5 feet, #310 Sec. 35 B. T.

Remarking of the North $\frac{1}{4}$ corner of Section 3, Twp 11 S
R 7 W, Will. Mer.

SEE COR. REST. NO.
982 (CJL 7/11/90)

Original witness trees:

N. W. Bearing Tree: rotten stump with "BT"
scribed on pitch seam.
S. Bearing Tree: rotten stump.

Marked two new bearing trees as follows:

14" fir S 4°E 31.9 feet, #310 Sec. 34 B. T.
11" fir N60°E 13.3 feet, # 310 Sec. 3 B. T.

Remarking of the South $\frac{1}{4}$ Corner of Section 35 Twp 10 S,
R 7 W, Will. Mer.

SEE COR. REST. NO.
594 (CJL 7/11/90).

Both original witness trees standing green.

Bark scribed 12" fir S32°W 15.3 feet, #310 Sec. 2 B. T.
Bark scribed original 24" fir (now 46") N16°E 42 links
#310 $\frac{1}{4}$ Sec. 35.

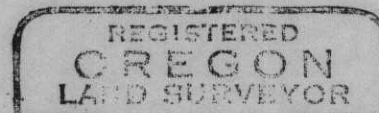

Bruce Starker



North corner of section 2 and 3, Twp. 11 S., R. 7 W.

By Bruce Starker

January 21, 1955

977

Original witness trees:

SE Bearing Tree: rotten stump, scribed BT on pitch seam.

SW Bearing Tree: destroyed by skid road.

NE Bearing Tree: rotten stump with blaze

NW Bearing Tree: rotten stump

The three remaining stumps fit according to bearing distance

Marked four new bearing trees as follows

Fir 7" N 38° E 10.8 feet, #310 35 BT

Fir 8" S 58° E 3.4 feet, #310, Sec. 2 BT

Fir 7" S 30° W 18.0 ft. #310 Sec. 3 BT

Fir 8" N 80° 30' W 39.5 ft., #310 Sec. 35 BT.

DATE 07/28/2005TOWNSHIP 11 SOUTH, RANGE 07 WEST, WILLAMETTE MERIDIAN; SECTION 2 CORNER NORTHWEST
DONATION LAND CLAIM NONE CORNER N/A**COMMON CORNER(S):**

NORTHEAST OF SECTION 3

RECORDS (INFORMATION IN *BOLD ITALICS* IS COUNTY STAFFS' INTERPRETATION OF THE RECORD)

BASED ON EXTENSIVE RESEARCH AND RECOVERY OF EVIDENCE, THIS OFFICE HAS DETERMINED THAT MOST GENERAL LAND OFFICE SURVEYORS MEASURED TO THE FACE OF BEARING TREES.

- [01] GENERAL LAND OFFICE (GLO), NOTES BY DENNIS HATHORN, D. S., DATED APRIL 25, 1855. *SET POST, 24" DIA. FIR, BEARS S42°E, 47 LINKS (31.02 FEET), 18" DIA. FIR, BEARS S20°W, 19 LINKS (12.54 FEET), 15" DIA. FIR, BEARS N40°E, 24 LINKS (15.84 FEET), 18" DIA. FIR, BEARS N48°W, 25 LINKS (16.50 FEET).*
- [02] CORRESPONDENCE LETTER BY, BRUCE STARKER, P. L. S., DATED JANUARY 21, 1955. *ORIGINAL WITNESS TREES: S. E. BEARING TREE, ROTTEN STUMP, SCRIBED "BT" ON PITCH SEAM; S. W. BEARING TREE DESTROYED BY SKID ROAD; N. E. BEARING TREE, ROTTEN STUMP WITH BLAZE; N. W. BEARING TREE, ROTTEN STUMP. THE THREE REMAINING STUMPS FIT ACCORDING TO BEARING AND DISTANCE. MARKED FOUR NEW BEARING TREES: 7" DIA. FIR, BEARS N38°E, 10.8 FEET, SCRIBED "# 310 SEC 35 BT"; 8" DIA. FIR, BEARS S58°E, 3.40 FEET, SCRIBED "#310 SEC 2 BT"; 7" DIA. FIR BEARS S30°W, 18 FEET, SCRIBED "#310 SEC 35 BT"; 8" DIA. FIR, BEARS N80°30'W, 39.5 FEET, SCRIBED "#310 SEC 35 BT".*
- [03] CORNER RESTORATION NO. 977, BY BRUCE STARKER, P. L. S., DATED JANUARY 21, 1955. *TRANSCRIBED FROM RECORD [02] AND MAY CONTAIN ERRORS AND/OR OMISSIONS.*

NOTES:

THIS IS A MICROSOFT WORD 2000 DOCUMENT NAMED "17500700" CREATED FROM A BOILER PLATE DOCUMENT NAMED "HISTORY", WHICH HAS A STYLESHEET NAMED "CORNER" ATTACHED TO IT.

FIRM/AGENCY: BENTON COUNTY SURVEYOR'S OFFICE
ADDRESS: 360 S.W. AVERY AVE. CORVALLIS OR 97333; PH. 766-6821
RESEARCH BY: DAVID M. DEAN, P.L.S.
DATA ENTRY BY: WILLIAM C. KELLEY, SURVEY TECH.

BENTON COUNTY CORNER RESTORATION FORM, PAGE 1 OF 2, 117500700R1
SEE CORNER HISTORY FORM FOR RECORDS ETC.

CORNER RESTORATION FIELD BOOK NUMBER 23 PAGE(S) 72 DATE 03/13/2006
TOWNSHIP 11 SOUTH, RANGE 7 WEST, WILLAMETTE MERIDIAN; SECTION 02 CORNER NORTHWEST
DONATION LAND CLAIM NONE CORNER N/A
CONDITION REPORT ; REFERENCED OUT ; RENEWED XX; SURVEYED IN

LOCATION AND COMMENTS:

CORNER IS LOCATED IN A MATURE STAND OF D. FIR TIMBER ON A SOUTHWEST FACING SLOPE. TO REACH CORNER FROM THE JUNCTION OF NORTON CREEK ROAD AND PEAK VIEW LANE (PRIVATE); TRAVEL NORTHERLY ON NORTON CREEK ROAD FOR 1.65 MILES; THEN LEFT ON PRIVATE LOGGING ROAD FOR 0.10 MILES TO STARKER FOREST GATE; THEN THROUGH GATE AND BEAR RIGHT FOR 0.81 MILES; THEN BEAR LEFT AT "Y" JUNCTION FOR 0.22 MILES; THEN BEAR RIGHT AT "Y" JUNCTION FOR 0.20 MILES; THEN BEAR RIGHT AT "Y" JUNCTION FOR 0.22 MILES; THEN BEAR RIGHT AT "Y" JUNCTION FOR 0.49 MILES AND PARK ON RIDGE TOP WITH DIRT ROAD ON RIGHT; THEN WALK SOUTHEASTERLY ON DIRT ROAD FOR APPROXIMATELY 21 CHAINS TO ROAD JUNCTION; THEN BEAR RIGHT (SOUTHWESTERLY) ON DIRT ROAD FOR APPROXIMATELY 22 CHAINS TO LOCATION TAG ON 30" D. FIR, ON RIGHT SIDE (10 FEET NW OF ROAD EDGE); THEN N68°W, 35 FEET TO CORNER. CORNER IS POOR FOR PREMARKING AND GPS CONTROL.

MONUMENTS AND ACCESSORIES FOUND (CONDITION AND SOURCE):

1. FOUND 4" X 4" X 3.5' CEDAR POST, PAINTED WHITE, LYING AT APPROXIMATE CORNER LOCATION.
(NO RECORD OF WHO SET POST, BUT POSSIBLY SET IN RECORD [02]).
2. FOUND ±36" ROTTEN D. FIR STUMP, WHICH WE OPENED TO VISIBLE SCRIBING "T" AND NOTCH, N48°00'W, 16.50 FEET TO ORIGINAL FACE. SET ALUMINUM NAIL AND PLASTIC WASHER IN ORIGINAL BLAZE FOR DISTANCE AND ANGLE MEASUREMENT.
BASIS OF BEARINGS FOR THIS RESTORATION.
(18" FIR BEARS N48°W, 16.50 FEET PER RECORD [01]).
(NORTHWEST BEARING TREE A ROTTEN STUMP PER RECORD [02]).
3. FOUND ±28" X 7' HIGH D. FIR SNAG, N36°26'E, 16.46 FEET TO CENTER. SOUTHERLY HALF OF TREE IS MISSING, NO VISIBLE SCRIBING COULD BE FOUND.
(15" FIR BEARS N40°E, 15.84 FEET PER RECORD [01]).
(NORTHEAST BEARING TREE A ROTTEN STUMP WITH BLAZE PER RECORD [02]).
4. FOUND ±40" ROTTEN D. FIR STUMP, S42°04'E, 30.31 FEET TO POSITION OF ORIGINAL FACE. STUMP HAS BEEN OPENED BY OTHERS AND FACE IS ROTTEN WITH NO VISIBLE SCRIBING REMAINING.
(24" FIR BEARS S42°E, 31.02 FEET PER RECORD [01]).
(S.E. BEARING TREE, ROTTEN STUMP, SCRIBED "BT" ON PITCH SEAM PER RECORD [02]).
5. FOUND 26" D. FIR WITH SINGLE HEALED BLAZE, N84°14'W, 39.68 FEET TO CENTER. SET ALUMINUM NAIL AND PLASTIC WASHER IN SOUTHERLY BASE FOR DISTANCE MEASUREMENT.
(8" FIR BEARS N80°30'W, 39.5 FEET, SCRIBED "# 310 SEC 35 BT" PER RECORD [02]).
6. FOUND 16" D. FIR WITH SINGLE HEALED BLAZE, N32°04'E, 11.42 FEET TO CENTER. SET ALUMINUM NAIL AND PLASTIC WASHER IN NORTHWEST BASE FOR DISTANCE MEASUREMENT.
(7" FIR BEARS N38°E, 10.8 FEET, SCRIBED "# 310 SEC 35 BT" PER RECORD [02]).
7. FOUND 20" D. FIR WITH SINGLE HEALED BLAZE, S68°33'E, 3.02 FEET TO CENTER. SET ALUMINUM NAIL AND PLASTIC WASHER IN SOUTHERLY BASE FOR DISTANCE MEASUREMENT.
(8" FIR BEARS S58°E, 3.4 FEET, SCRIBED "# 310 SEC 2 BT" PER RECORD [02]).
8. FOUND 17" D. FIR WITH SINGLE HEALED BLAZE, S25°39'W, 17.42 FEET TO CENTER. SET ALUMINUM NAIL AND PLASTIC WASHER IN NORTHWEST BASE FOR DISTANCE MEASUREMENT.
(7" FIR BEARS S30°W, 18 FEET. SCRIBED "# 310 SEC 35 BT" PER RECORD [02]).

MONUMENT SET (PROCEDURES AND DESCRIPTION):

NO EVIDENCE OF ORIGINAL GLO POST COULD BE FOUND AFTER A THOROUGH SEARCH OF THE AREA. THE CORNER POSITION WAS ESTABLISHED BY A DISTANCE/DISTANCE INTERSECTION FROM THE FOUND NORTHWEST AND NORTHEAST GLO BEARING TREES. MEASUREMENT WAS TAKEN FROM THE FACE OF THE OPENED NORTHWEST BEARING TREE, (NOW A STUMP) USING THE GLO DISTANCE OF 16.50 FEET. MEASUREMENT FROM THE NORTHEAST BEARING TREE (NOW A 7 FOOT HIGH SNAG) WAS TAKEN FROM THE EXPOSED CENTER USING A DISTANCE OF 16.46 FEET (15.84 FEET PER GLO, PLUS HALF OF THE ORIGINAL GLO DIAMETER OF 15 INCHES, OR 0.62 FEET (15.84 FEET PLUS 0.62 FEET = 16.46 FEET).

AT SAID DISTANCE/DISTANCE INTERSECTION, WE SET A 2" X 31 1/2" GALVANIZED IRON PIPE WITH A 3 1/4" BRASS DISK CONCRETED IN THE TOP, 1" ABOVE GROUND LEVEL AND MARKED AS SHOWN ON PAGE 2 OF 2. SET A 6 FOOT, ORANGE CARSONITE "SURVEY MARKER" POST, 1 FOOT SOUTHWEST OF NEW CORNER MONUMENT.

D. FIR TIMBER

D. FIR TIMBER

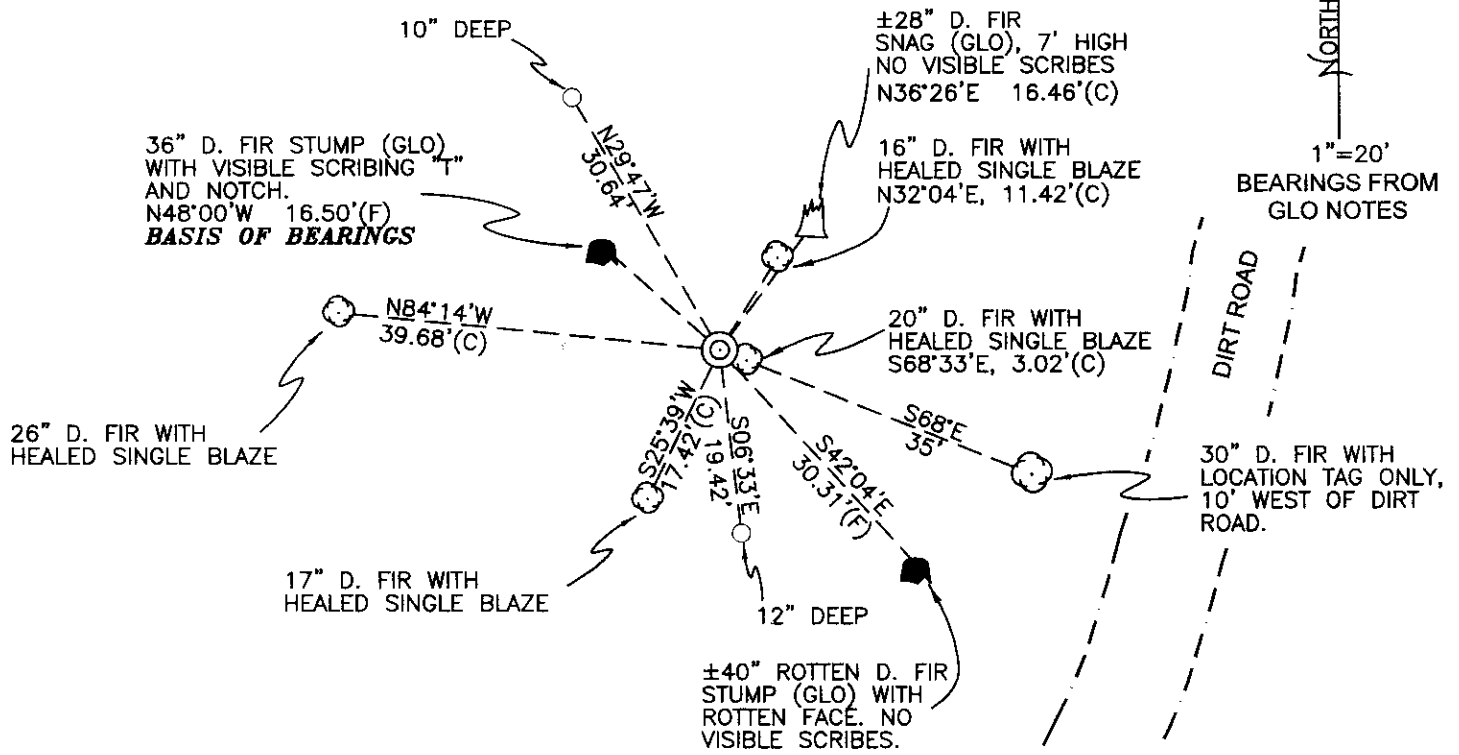

D. FIR TIMBER

D. FIR TIMBER

MONUMENT DETAIL

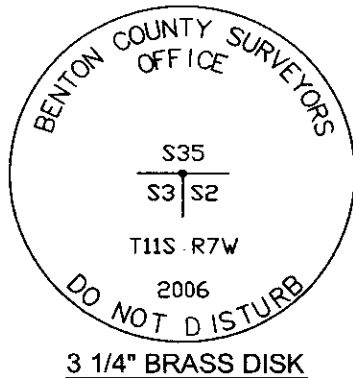

LEGEND

- SET 5/8" X 30" REBAR WITH YELLOW PLASTIC CAP MKD "BENTON COUNTY SURVEYOR"
- (F) MEASUREMENT TO FACE
- (C) MEASUREMENT TO CENTER
- ⊙ GOVERNMENT MONUMENT SET AS SHOWN
- ⊙ BEARING TREE AS NOTED
- GLO GENERAL LAND OFFICE
- BEARING TREE STUMP AS NOTED
- ⚡ BEARING TREE SNAG AS NOTED

NEW ACCESSORIES:

1. SET REBAR (SEE LEGEND) 12" BELOW GROUND LEVEL S06°33'E, 19.42 FEET.
2. SET REBAR (SEE LEGEND) 10" BELOW GROUND LEVEL N29°47'W, 30.64 FEET.

NOTES:

COMPASS DECLINATION IS 20° EAST. ALL MEASURED DISTANCES AND BEARINGS ARE TO THE CENTER OF THE OBJECT, UNLESS OTHERWISE NOTED. ALL BEARING TREES ARE PAINTED AND HAVE A B.T. TAG ATTACHED, FACING THE CORNER UNLESS OTHERWISE NOTED. ALL NEW BEARING TREES HAVE A PLASTIC WASHER (STAMPED "BENTON COUNTY SURVEYOR CORNER RESTORATION") ATTACHED (BY ALUMINUM NAIL) TO THE FACE, BELOW THE "BT" FOR DISTANCE AND ANGLE MEASUREMENT UNLESS OTHERWISE NOTED. THE DRAWING IS FROM AUTOCAD RELEASE 2006.

THIS RESTORATION WAS PERFORMED AT THE DIRECTION AND APPROVAL OF THE BENTON COUNTY SURVEYOR. David M. Dean

FIRM/AGENCY: BENTON COUNTY SURVEYOR'S OFFICE
 ADDRESS: 360 S.W. AVERY AVE. CORVALLIS OR 97333; PH. 766-6821
 PRESENT: DAVID M. DEAN, P.L.S. AND BERNIE ALTENBACH, SURVEY TECH.
 EQUIPMENT: LEICA TCR 1105 WITH TDS ON BOARD

REGISTERED
 PROFESSIONAL
 LAND SURVEYOR

4/3/06 David M. Dean

OREGON
 JULY 13, 1984
 DAVID M. DEAN
 2090

RENEWAL DATE: 12/31/07